

ATTENTION:

- GENERAL MANAGER
- PARTS MANAGER
- CLAIMS PERSONNEL
- SERVICE MANAGER

IMPORTANT - All Service Personnel Should Read and Initial in the boxes provided, right.

© 2017 Subaru of America, Inc. All rights reserved.



QUALITY DRIVEN® SERVICE

SERVICE BULLETIN

APPLICABILITY: 2015-2017MY WRX 2.0L DIT Models

NUMBER: 03-78-17

SUBJECT: Clutch Release Bearing- Design Change

DATE: 01/03/17

REVISED: 05/11/23

INTRODUCTION:

This bulletin announces a design change to the clutch release bearing. The change will address customer concerns of a chirping-type sound which may be heard following initial start-up after a cold soak. The sound normally dissipates after 2-3 minutes of operation.

PRODUCTION CHANGE INFORMATION:

The new clutch release bearing was incorporated into production starting with VIN **H9824973**.

PART INFORMATION:

The part number for the new clutch release bearing is: **30502AA160**. The photos below show the differences between the old and new-style parts. The shape of the outer race has been changed.



Continued...

CAUTION: VEHICLE SERVICING PERFORMED BY UNTRAINED PERSONS COULD RESULT IN SERIOUS INJURY TO THOSE PERSONS OR TO OTHERS.

Subaru Service Bulletins are intended for use by professional technicians ONLY. They are written to inform those technicians of conditions that may occur in some vehicles, or to provide information that could assist in the proper servicing of the vehicle. Properly trained technicians have the equipment, tools, safety instructions, and know-how to do the job correctly and safely. If a condition is described, DO NOT assume that this Service Bulletin applies to your vehicle, or that your vehicle will have that condition.

SUBARU OF AMERICA, INC. IS ISO 14001 COMPLIANT

ISO 14001 is the international standard for excellence in Environmental Management Systems. Please recycle or dispose of automotive products in a manner that is friendly to our environment and in accordance with all local, state and federal laws and regulations.

SERVICE PROCEDURE / INFORMATION:

When replacing the clutch release bearing, follow the procedure in the applicable Service Manual.

IMPORTANT NOTES:

(for Anytime the Clutch Assembly and/or Release Bearing are serviced or replaced)

- Always inspect for any excessive or abnormal wear on the release fork pivot point, operating cylinder rod and release lever pivot points, and the pivot ball.
- Always use the proper grease (Nichimoly N-130, Conoco-Philips Multiplex Red #2 or Subaru p.n. 000041000) when lubricating the contact points of the release bearing and related components as specified in the Service Manual and shown below.

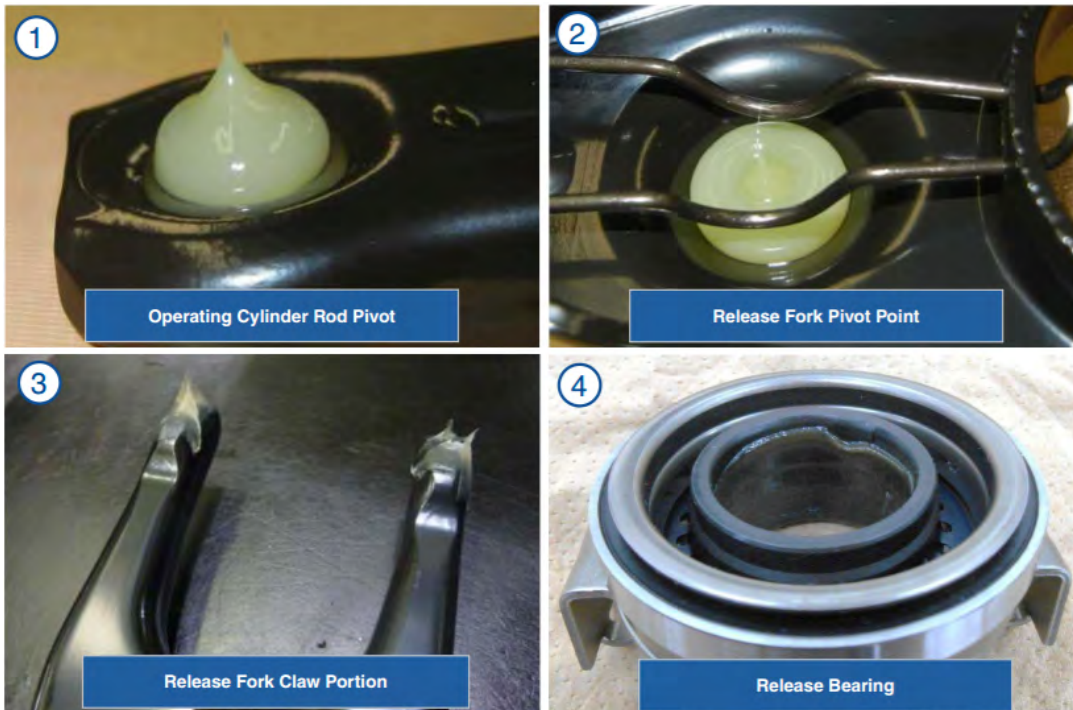
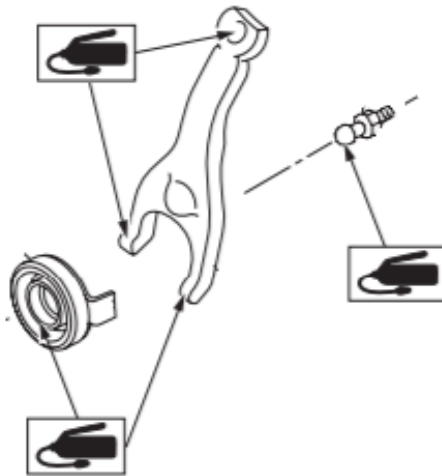

WARRANTY / CLAIM INFORMATION:

For vehicles within the Basic New Car Limited Warranty period or covered by an active Subaru Added Security Gold plan, this repair may be submitted using the following claim information:

Labor Description	Labor Operation #	Labor Time	Fail Code
MANUAL TRANSMISSION R&R	B323-001	3.9	JAD-25
RELEASE FORK, BEARING / SHAFT R&R	C325-121	0.2	

IMPORTANT REMINDERS:

- SOA strongly discourages the printing and/or local storage of service information as previously released information and electronic publications may be updated at any time.
- Always check for any open recalls or campaigns anytime a vehicle is in for servicing.
- Always refer to STIS for the latest service information before performing any repairs.