

ATTENTION:

- GENERAL MANAGER
- PARTS MANAGER
- CLAIMS PERSONNEL
- SERVICE MANAGER

IMPORTANT - All Service Personnel Should Read and Initial in the boxes provided, right.



QUALITY DRIVEN® SERVICE

SERVICE BULLETIN

APPLICABILITY: The Following Models with Auto-Dimming Compass Mirror and HomeLink: Forester, Impreza, WRX and STI Vehicles Produced during the 2008 Calendar Year and Later 2013MY BRZ (with or without HomeLink)

NUMBER: 15-167-13R

DATE: 09/13/13

REVISED: 09/13/13

SUBJECT: Loose Windshield-Mounted Rear-View Mirror

INTRODUCTION

Should you receive a customer concern of a loose windshield mounted auto-dimming compass mirror with HomeLink (with or without HomeLink on BRZ models), the mounting adapter plate should be checked for proper tightness. The applicable vehicles listed above utilize a mirror mount adaptor to secure the mirror to the windshield. Due to improper installation, in some cases, the mirror may loosen over time and begin to rattle. A new Service Kit has been developed to improve retention of the mirror to the windshield mount. The countersink in the cam plate shown in the photo below has been eliminated to make installation easier.

PART INFORMATION

A new Service Kit has been released for this type of repair. Part Number H501SSA042 contains all the mounting hardware necessary to complete the vast majority of these repairs. The kit includes a newly designed cam plate, spring, and two mounting screws.

Please note that Mirror Mount Adapter PN H501SSA041 (replaces H501SSA040) now includes this new service kit in the rare event that the Mount Adapter requires replacement or when initially installing an accessory mirror on the above listed vehicle applications. The new Service Kit H501SSA042 contents are pictured below.

NOTE: The photo below shows both the new and old style cam plates for reference purposes.

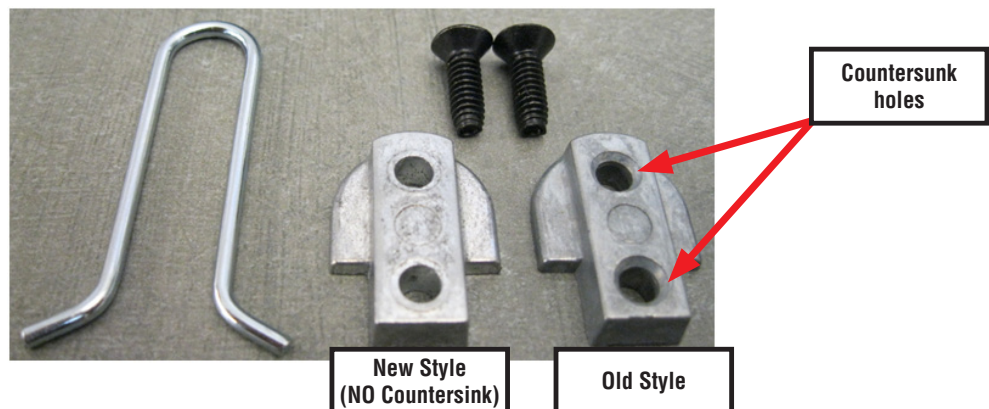

Continued...

CAUTION: VEHICLE SERVICING PERFORMED BY UNTRAINED PERSONS COULD RESULT IN SERIOUS INJURY TO THOSE PERSONS OR TO OTHERS.

Subaru Service Bulletins are intended for use by professional technicians ONLY. They are written to inform those technicians of conditions that may occur in some vehicles, or to provide information that could assist in the proper servicing of the vehicle. Properly trained technicians have the equipment, tools, safety instructions, and know-how to do the job correctly and safely. If a condition is described, DO NOT assume that this Service Bulletin applies to your vehicle, or that your vehicle will have that condition.

SUBARU OF AMERICA, INC. IS "ISO 14001 COMPLIANT"

The international standard for excellence in Environmental Management Systems. Please recycle or dispose of automotive products in a manner that is friendly to our environment and in accordance with all local, state and federal laws and regulations.

SERVICE PROCEDURE / INFORMATION

Move / adjust the mirror assembly while observing the mirror mount. If the mirror mount moves and appears to be loose, follow the steps below to remove the mirror mount adaptor and replace the internal components using Service Kit, part number H501SSA042.

1. Remove the wiring harness cover by sliding it down (away from the headliner) then unclip it from the mirror mount adaptor (base).



2. Unplug the wiring harness from the back of the mirror assembly.
3. Loosen the Torx (T-20) screw at the base of the mirror.
4. Remove the mirror assembly by sliding it up and off of the mirror mount adaptor.

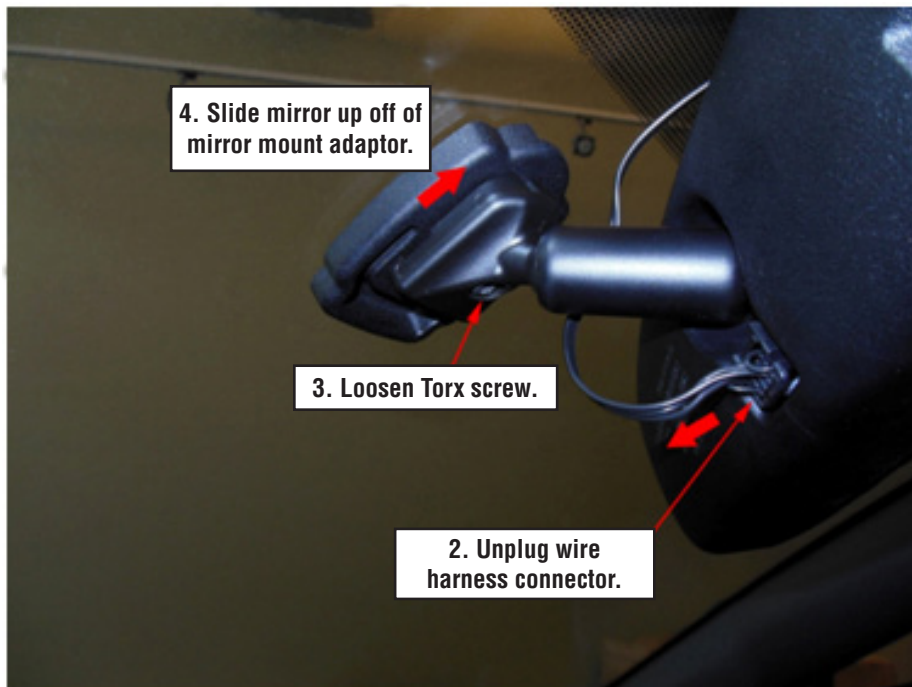

Continued...

- Remove the two Phillips-head retaining screws holding the mirror mount adaptor plate onto the windshield mirror mount button. Discard the old screws as replacements are included in the Service Kit. Do not remove the upper screw as shown in the photo below.



- Remove the mirror mount plate exposing the mounting button which is adhered to the windshield glass, the cam plate and the spring.
- Slide the old cam plate down and out of the mounting button.
- Carefully remove the spring from the mounting button with a small flat-blade screwdriver. Discard the old spring as a replacement is included in the Service Kit.

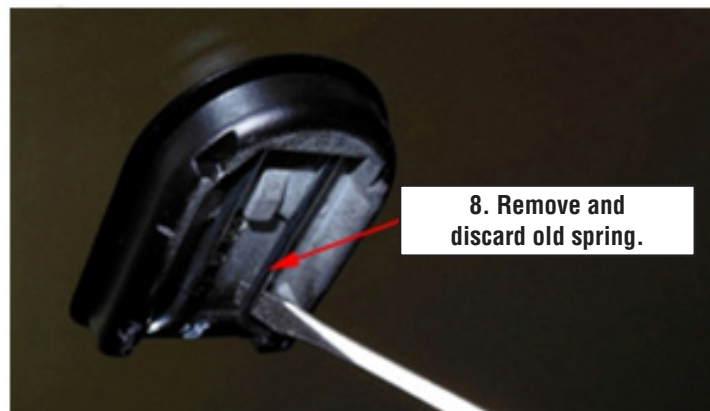

- Install the new spring into the mounting button.
- Install the new cam plate adapter under the spring and into the mounting button as shown below.

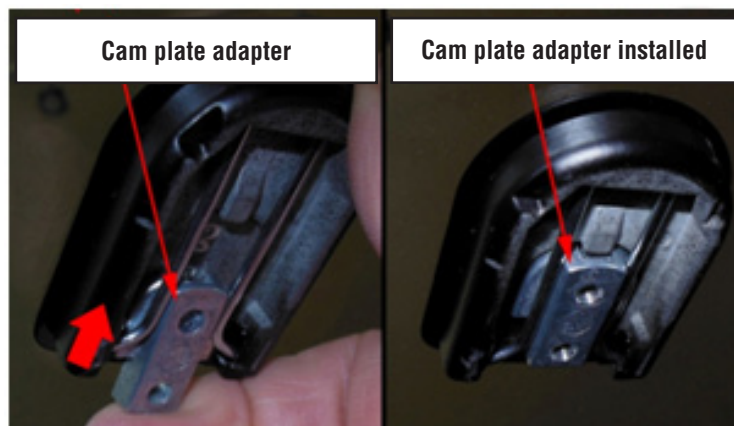

Continued...

11. Slide the mirror mount adapter back over the mounting button and install the 2 new Phillips-head mounting screws. Hand-tighten first then torque to 25 - 27 inch-lbs.
12. Reinstall the mirror assembly to the mount adapter then tighten the T-20 Torx mounting screw to 13.3 – 17.7 inch-lbs.
13. Reconnect the wiring harness to the mirror assembly.
14. Reinstall the harness cover and extend it up to meet the front edge of the head liner.
15. Move / adjust the mirror assembly while observing the mirror mount. Confirm any looseness previously noted has been corrected.
16. In the rare case looseness persists, order and install the H501SSA041 complete Mirror Adapter / Hardware Kit. **NOTE:** Do not reuse the spring, cam plate or screws from any prior repair as they all are one-time use items.

WARRANTY / CLAIM INFORMATION

For vehicles within the Basic New Car Limited Warranty period, this repair may be claimed using the following information:

LABOR DESCRIPTION	LABOR OPERATION #	FAIL CODE	LABOR TIME
Auto-Dimming Compass / Mirror, Repair, W/ or W/O HomeLink	B913-021		0.3
Auto-Dimming Compass / Mirror Adapter / Hardware Kit, Replace	C913-025	XWA-23	0.2