



TECHNICAL SERVICE BULLETIN

Intermittent Power Sliding Door Operation - With or Without DTC U201A

22-2305

29 August
2022

Model:

Ford 2019-2022 Transit

Issue: Some 2019-2022 Transit vehicles may experience intermittent operation of the power sliding door (PSD) which may not open/close properly. It can still be closed manually. Diagnostic trouble code (DTC) U201A may or may not be present in the door control module H (DCMH). The PSD may partially actuate with each press of the remote, dash button, or door handle actuation. To correct the condition, follow the Service Procedure to replace the latch, install conical washers and adjust the door.

Action: Follow the Service Procedure to correct the condition if the vehicle meets the following criteria:

- 2019–2022 Transit
- Intermittent operation of the PSD which may not open/close properly

Parts

Service Part Number	Quantity	Description	Unit of Issue	Piece Quantity
KK3Z-00810-C	3	Conical Washer	1	3
61264A00	1	Sliding Door Latch - Refer To The Parts Catalog For The Vin Specific Application	1	1
XG-3-A	As Needed	Motorcraft® Silicone Brake Caliper Grease and Dielectric Compound		

Quantity refers to the amount of the service part number required to repair the vehicle.

Unit of Issue refers to the number of individual pieces included in a service part number package.

Piece Quantity refers to the total number of individual pieces required to repair the vehicle.

As Needed indicates the amount of the part may vary and/or is not a whole number. Parts can be billed out as non-whole numbers, including less than 1.

Warranty Status: Eligible under provisions of New Vehicle Limited Warranty (NVLW)/Service Part Warranty (SPW)/Special Service Part (SSP)/Extended Service Plan (ESP) coverage. Limits/policies/prior approvals are not altered by a TSB. NVLW/SPW/SSP/ESP coverage limits are determined by the identified causal part and verified using the OASIS part coverage tool.

Labor Times

Description	Operation No.	Time
2019-2022 Transit: Retrieve DTCs, Perform PSD Initialization, Perform Self Test And Check Door Operation (Do not Use With Any Other Labor Operations)	222305A	0.3 Hrs.
2019-2022 Transit: Retrieve DTCs, Replace The Latch On One (1) Door, Following The Service Procedure (Do not Use With Any Other Labor Operations)	222305B	1.7 Hrs.
2019-2022 Transit: Retrieve DTCs, Replace The Latch On Both (2) Doors, Following The Service Procedure (Do not Use With Any Other Labor Operations)	222305C	3.1 Hrs.
2019-2022 Transit: Retrieve DTCs, Perform PSD Initialization, Perform Self Test And Check Door Operation, Replace The Latch On One (1) Door, Following The Service Procedure (Do not Use With Any Other Labor Operations)	222305D	1.8 Hrs.

Repair/Claim Coding

Causal Part:	61264A00
Condition Code:	42

Service Procedure

1. Is DTC U201A present in the DCMH?

(1). Yes - proceed to Step 3.

(2). No - perform sliding door initialization. Refer to Workshop Manual (WSM), Section 501-03 Body Closures > General Procedures > Power Sliding Door (PSD) Initialization. Proceed to Step 2.

2. Once PSD initialization is complete, perform another diagnostic self-test. Is DTC U201A still not present and is the power sliding door working correctly?

(1). Yes - repair is complete.

(2). No - proceed to Step 3.

3. Replace the latch, add conical washers, and adjust the power sliding door:

NOTE: 3 conical washers must be added to the sliding door latch prior to installation.

(1). Refer to WSM, Section 501-14 Handles, Locks, Latches and Entry Systems > Removal and Installation > Sliding Door Latch.

(2). Apply Motorcraft® silicone brake caliper grease and dielectric compound or equivalent to the latch at the fastener/washer locations (x3). (Figure 1)

Figure 1



E390763

(3). Add 1 conical washer at each location where grease was applied. (Figure 2)

Figure 2



E390764

NOTE: 2 technicians may be necessary to verify the conical washers maintain position during installation. (Figure 3)

Figure 3

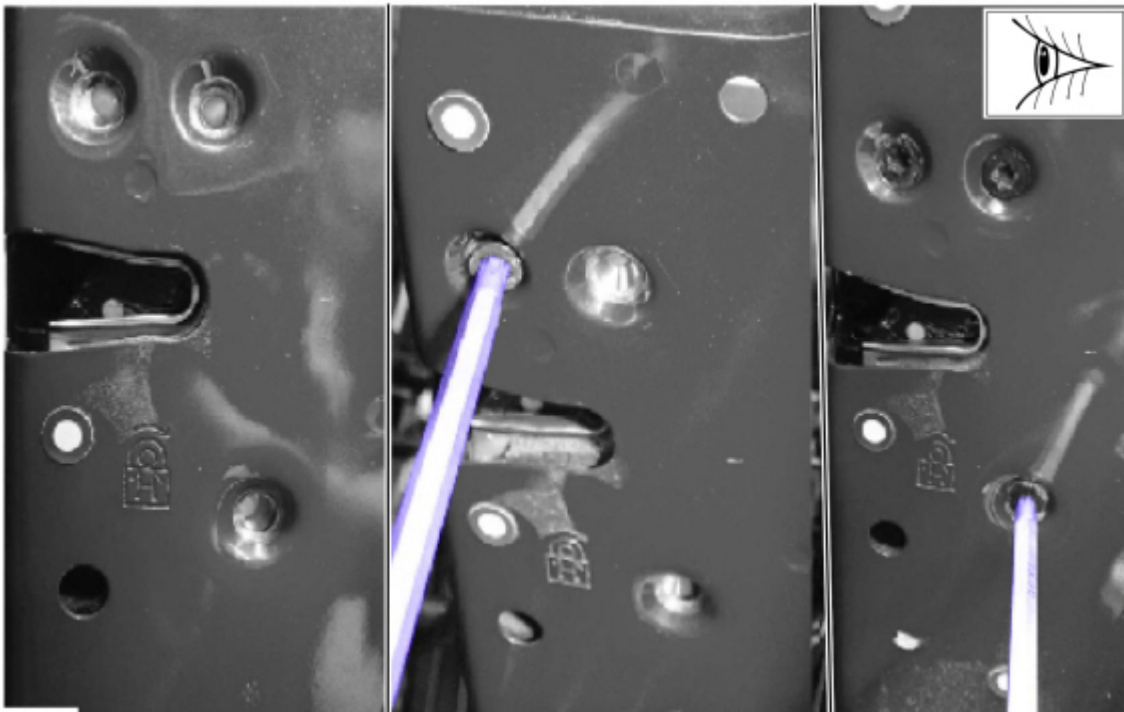

E390765

(4). Install the latch to the sliding door.

(5). Adjust the sliding door center roller downwards. Refer to WSM, Section 501-03 Body Closures > General Procedures > Sliding Door Alignment > Steps 16-17-18.

- To adjust the sliding door downwards, rotate the adjustment bolt counterclockwise 1 full turn, 1 mm (0.039in). (Figure 4)

Figure 4

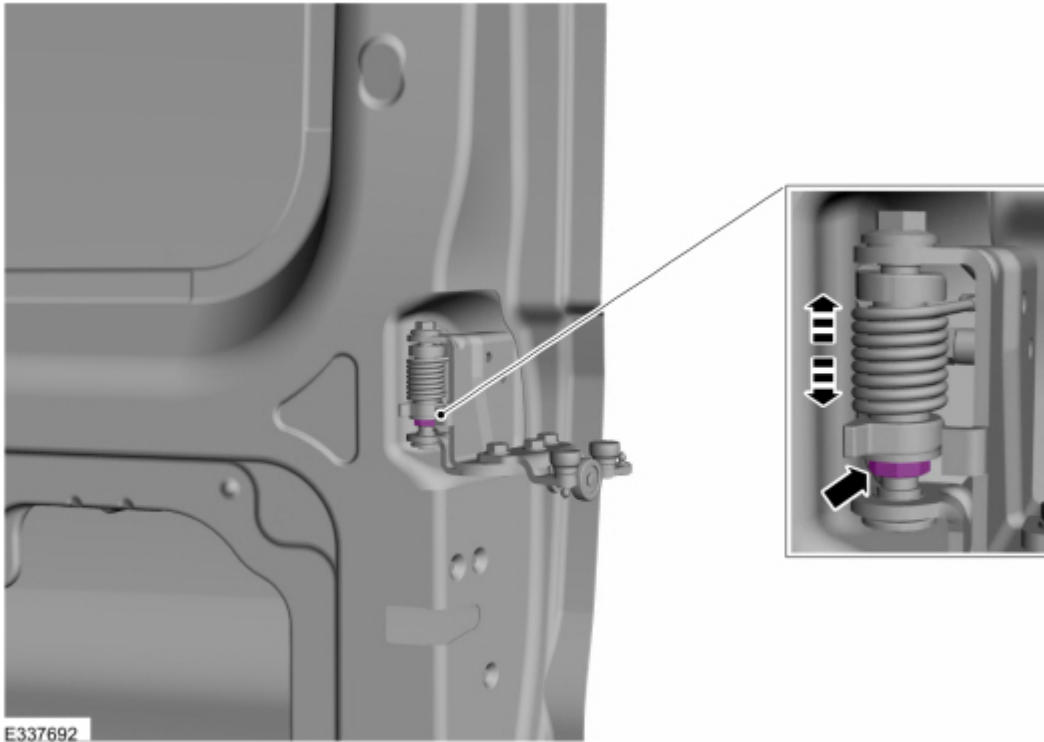

NOTE: Once the sliding door center roller is adjusted, the striker should be off-centered biased towards the upper area of the latch (before latching) with zero interference to the latch. (Figure 5)

Figure 5



4. Perform a PSD initialization. Refer to WSM, Section 501-03 Body Closures > General Procedures > Power Sliding Door (PSD) Initialization.

described affects your car or truck. Contact a Ford or Lincoln dealership to determine whether the Bulletin applies to your vehicle. Warranty Policy and Extended Service Plan documentation determine Warranty and/or Extended Service Plan coverage unless stated otherwise in the TSB article. The information in this Technical Service Bulletin (TSB) was current at the time of printing. Ford Motor Company reserves the right to supersede this information with updates. The most recent information is available through Ford Motor Company's on-line technical resources.