

**FORD:**

2015 Transit

**ISSUE**

Some 2015 Transit vehicles equipped with a 3.7L Duratec engine and built on or before 6/11/2015 may exhibit an illuminated malfunction indicator lamp (MIL) with one or more of the following diagnostic trouble codes (DTCs): P0131, P0141, P0155, P0161, P2627, P2630, P0010, P0013, P0020, P0023, P0103, P0104, P0443 and/or U0401 stored in the powertrain control module (PCM) memory. The vehicle may also exhibit an open fuse F36 in the underhood battery junction box (BJB). These issues may be due to wire chafing at the heated oxygen sensor (HO2S) wire harness.

**ACTION**

Follow the Service Procedure steps to correct the condition.

**SERVICE PROCEDURE**

1. Is fuse F36 open in the underhood BJB?
  - a. Yes - proceed to Step 3.
  - b. No - proceed to Step 2.
2. Use the Integrated Diagnostic System (IDS) or equivalent scan tool to retrieve DTCs. Is DTC P0131, P0141, P0155, P0161, P2627, P2630, P0010, P0013, P0020, P0023, P0103, P0104, P0443, and/or U0401 stored in the PCM memory?
  - a. Yes - proceed to Step 3.
  - b. No - this procedure does not apply. Refer to the Powertrain Control / Emissions Diagnosis (PC/ED) manual for normal diagnosis.
3. Raise the vehicle on a hoist. Refer to Workshop Manual (WSM), Section 100-02.
4. Remove the transmission heat shield located at the right rear of the transmission. Torque: 25 Nm (18 lb-ft)
5. Disconnect transmission electrical connector C1575.
  - a. Rotate the transmission electrical connector counterclockwise.
  - b. Pull the transmission electrical connector out to disconnect.
6. Disconnect both downstream heated oxygen sensors (HO2S), HO2S12 and HO2S22.
7. Detach the wire harness retainers between the transmission electrical connector and right bank HO2S11; including the retainer at the rear of the right valve cover.
8. Lower the vehicle.
9. Remove the right front headlamp. Refer to WSM, Section 417-01.
10. Remove the upper intake manifold. Refer to WSM, Section 303-01.
11. Cover the lower intake ports with a clean shop towel to prevent debris entry.
12. Disconnect HO2S11 connector C1571 and both camshaft position (CMP) bank 1 sensor connectors C1366 and C1367.
13. Detach the harness retainer from the valve cover stud near the CMP bank 1 sensors.

NOTE: The information contained in Technical Service Bulletins is intended for use by trained, professional technicians with the knowledge, tools, and equipment to do the job properly and safely. It informs these technicians of conditions that may occur on some vehicles, or provides information that could assist in proper vehicle service. The procedures should not be performed by "do-it-yourselfers". Do not assume that a condition described affects your car or truck. Contact a Ford, Lincoln, or Mercury dealership to determine whether the bulletin applies to your vehicle. Warranty Policy and Extended Service Plan documentation determine Warranty and/or Extended Service Plan coverage unless stated otherwise in the TSB article. The information in this Technical Service Bulletin (TSB) was current at the time of printing. Ford Motor Company reserves the right to supersede this information with updates. The most recent information is available through Ford Motor Company's on-line technical resources.

14. Position the detached section of the harness on top of the engine to allow harness inspection and repair.
15. Inspect the harness takeout for HO2S11 electrical connector C1571 for chafing or wire worn through that may have been caused by contact on the back of the cylinder head. (Figure 1)

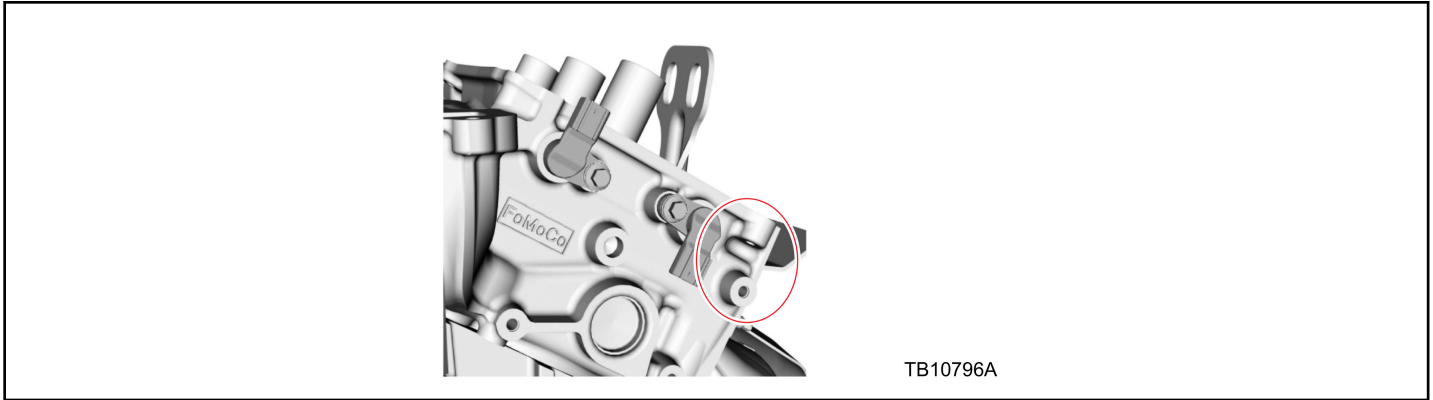

Figure 1 - Article 15-0160

16. Repair any wire chafing found using the solder splicing method. Refer to Wiring Diagram Cell 5-1.
  - a. Use a commercially available sheathing ripper, such as Rotunda Technician Tool Program (RTTP) JSP95978-04 or equivalent, to carefully strip the wire harness tape from the section of wire harness.
  - b. Insert the ball end of the sheathing ripper into the wire harness. Use caution not to damage the wires or wire insulation when stripping the wire harness.
17. Use Coroplast™ tape or equivalent and wrap the affected area of the takeout to H02S11.
18. Properly route the harness and make sure the HO2S11 wire harness takeout is positioned correctly to prevent future chafing. (Figure 2)

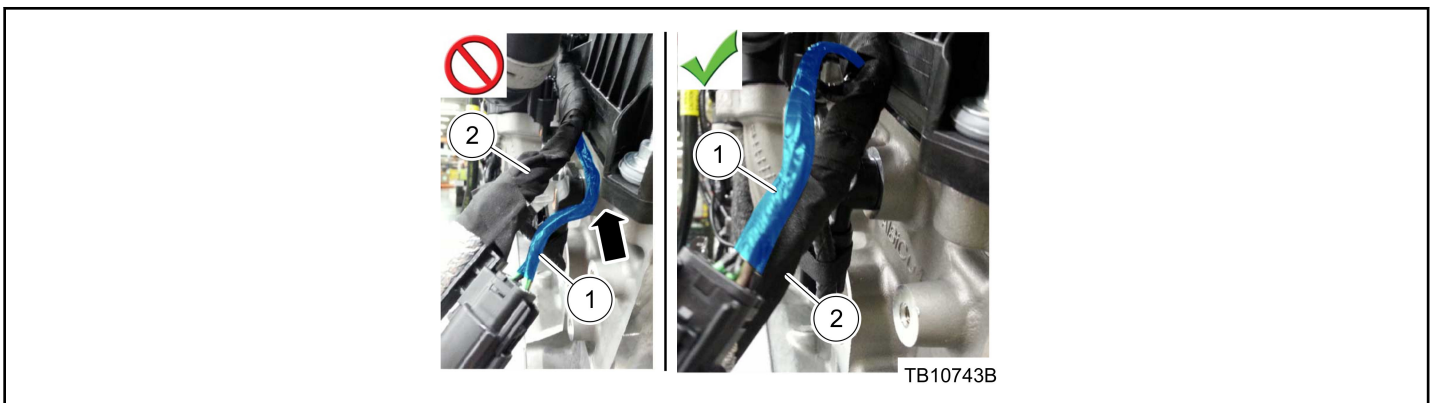

Figure 2 - Article 15-0160

19. To install, reverse the removal procedure.
20. Install a new fuse F36 if necessary and clear DTCs.

Obtain Locally	
Part Number	Part Description
NAI837X	Coroplast™ Electrical Wire Harness Tape
ES-1	RTTP Dual Wall Heat Shrink Tubing

**TSB 15-0160 (Continued)**

<b>PART NUMBER</b>	<b>PART NAME</b>
F2UZ-14526-P	Fuse
AT4Z-9H486-A	Upper Intake Manifold Gasket

<b>OPERATION</b>	<b>DESCRIPTION</b>	<b>TIME</b>
150160A	2015 Transit 3.7L Duratec: Retrieve DTCs, Inspect And Repair Wire Harness Following The Service Procedure (Do Not Use With Any Other Labor Operations)	2.2 Hrs.

**WARRANTY STATUS:**

Eligible Under Provisions Of New Vehicle Limited Warranty Coverage And Emissions Warranty Coverage  
Warranty/ESP coverage limits/policies/prior approvals are not altered by a TSB. Warranty/ESP coverage limits are determined by the identified causal part and verified using the OASIS part coverage tool.

**DEALER CODING**

<b>BASIC PART NO.</b>	<b>CONDITION CODE</b>
12A581	30