

Warranty Extension: MIL Comes On with DTC P0420/P0430, P030x, and/or P219A/B (Without Software Update)

This bulletin replaces 18-025, *MIL Comes On with DTC P0300-P0306 or P219A/B*, and 19-073, *MIL Comes On with DTC P0430 or P0430 with P030X, P219A or P219B (Without Software Update)*.

AFFECTED VEHICLES

Year	Model	Trim Level	VIN Range
2018-19	Odyssey	ALL	Check the iN VIN status for eligibility.
2017-19	Pilot	ALL	Check the iN VIN status for eligibility.
2017-19	Ridgeline	ALL	Check the iN VIN status for eligibility.

BACKGROUND

The PCM software may misinterpret sensor inputs as a deteriorated catalytic converter. Additionally, debris from the high pressure pump or the fuel injector machining process can cause internal wear or clogging inside one or more injectors. One or more of the following DTCs may be stored:

- P0420 (rear bank catalyst system efficiency below threshold [bank 1])
- P0430 (front bank catalyst system efficiency below threshold [bank 2])
- P0300-P0306 (misfire)
- P219A (air-fuel ratio variation of cylinder [bank 1, rear bank])
- P219B (air-fuel ratio variation of cylinder [bank 2, front bank])

American Honda is extending the warranty on these repairs to **10 years** from the original date of purchase or 150,000 miles, whichever comes first.

CUSTOMER NOTIFICATION

Owners of affected vehicles will be sent a notification of this campaign.

Do an iN VIN status inquiry to make sure the vehicle is shown as eligible.

CUSTOMER INFORMATION: The information in this bulletin is intended for use only by skilled technicians who have the proper tools, equipment, and training to correctly and safely maintain your vehicle. These procedures should not be attempted by "do-it-yourselfers," and you should not assume this bulletin applies to your vehicle, or that your vehicle has the condition described. To determine whether this information applies, contact an authorized Honda automobile dealer.

CORRECTIVE ACTION

Do the following repairs depending on the stored DTC:

P0420 or P0430 only - Do the cylinder AF test. If the test fails, replace the fuel injectors.

P0420 or P0430, and any combination of P0300 through P0306, P219A, or P219B - Replace the fuel injectors.

P0300 through P0306, P219A, or P219B only - Replace the fuel injectors.

NOTE: The vehicle must have **5,000 miles or more** on the odometer.

WARRANTY CLAIM INFORMATION

Template IDs were not included because there are multiple repair variations. Document the inspection and test results on the repair order, and manually enter the warranty claim depending on which repair(s) were done.

Odyssey

Operation Number	Description	Flat Rate Time	Defect Code	Symptom Code	Failed Part Number
1105D3	Do the cylinder AF test.	0.2 hr	6E600	N9400	10004-RLV-A00
1211NC	Replace the fuel injectors.	2.6 hr			16010-RLV-315

Pilot

Operation Number	Description	Flat Rate Time	Defect Code	Symptom Code	Failed Part Number
1105D3	Do the cylinder AF test.	0.2 hr	6E600	N9400	10004-RLV-A00
1211NC	Replace the fuel injectors.	2.5 hr			16010-RLV-315

Ridgeline

Operation Number	Description	Flat Rate Time	Defect Code	Symptom Code	Failed Part Number
1105D3	Do the cylinder AF test.	0.2 hr	6E600	N9400	10004-RLV-A00
1211NC	Replace the fuel injectors.	2.2 hr			16010-RLV-315

Skill Level: Repair Technician

PARTS INFORMATION

Part Name	Part Number	Quantity
Fuel Injector Kit*	06160-RLV-305	1

*Includes new fuel injectors and all must-replace parts.

INSPECTION

1. Connect the HDS, and do an all-DTC check.

Are any of the DTCs listed below present?

- P0420
- P0430
- P0300-P0306
- P219A
- P219B

Yes - Do the following depending on the DTC(s) present:

- **P0420 or P0430 only** - Go to the next step to start the cylinder AF test.
- **P0420 or P0430, and any combination of P0300 through P0306, P219A, or P219B** - Go to REPAIR PROCEDURE.
- **P0300 through P0306, P219A, or P219B only** - Go to REPAIR PROCEDURE.

No - This service bulletin does not apply. Continue with normal system troubleshooting.

2. Select **Honda Systems**.

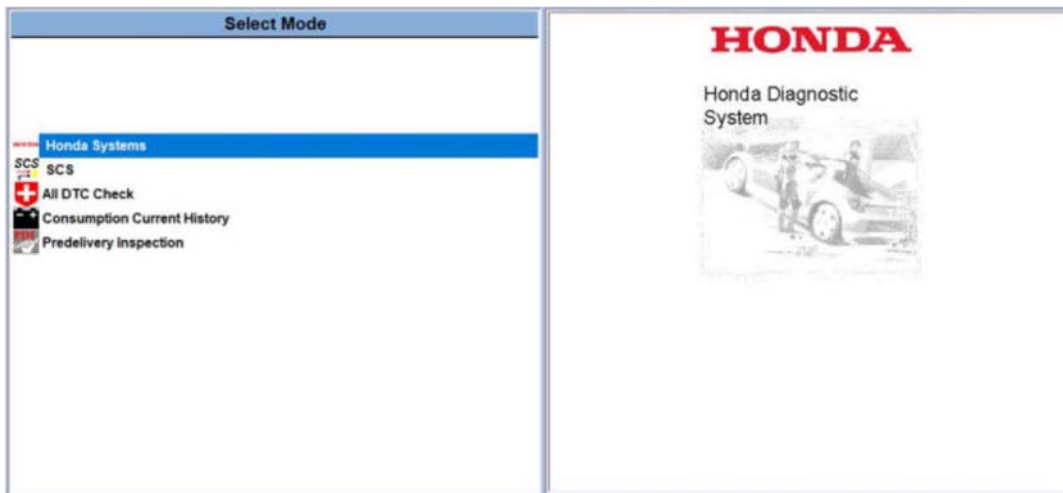

3. Select **PGM FI**.

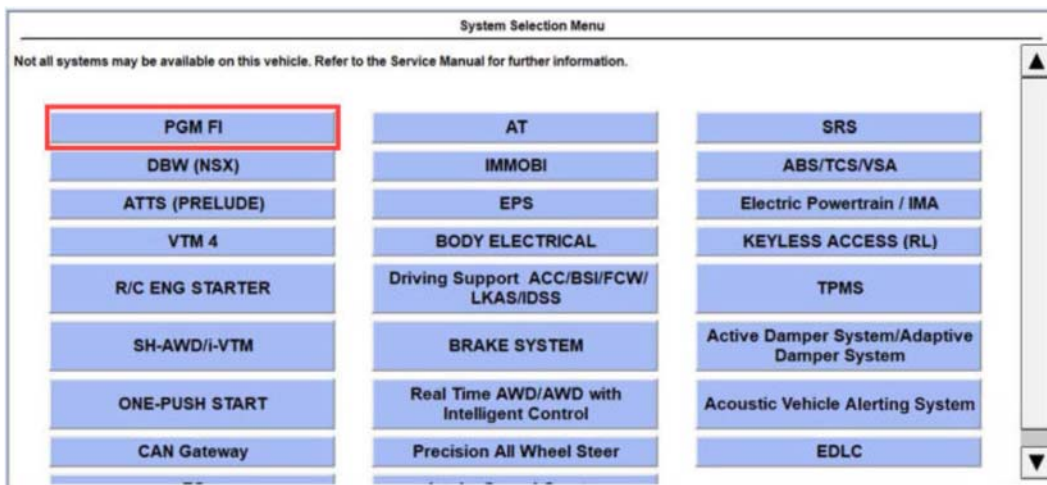

4. Select **PGM FI**.

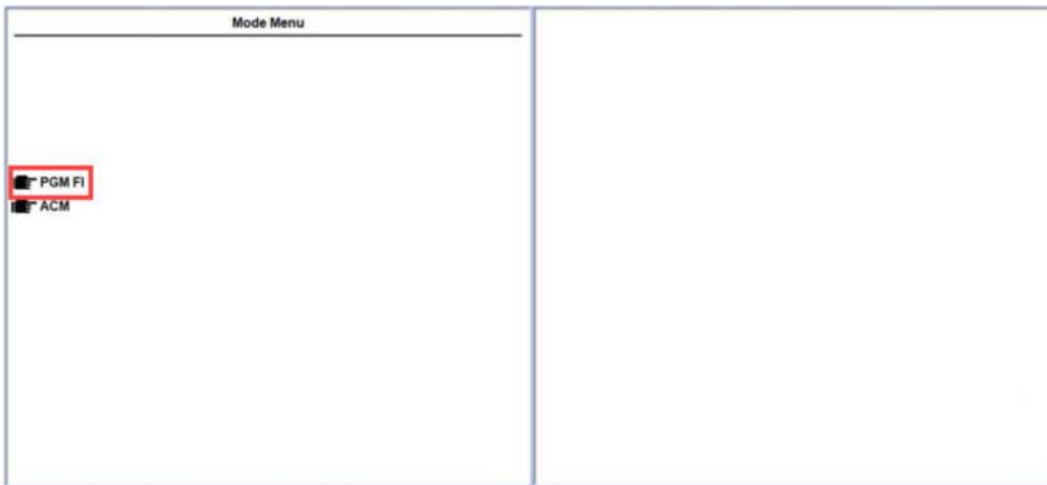

5. Select **Inspection**.

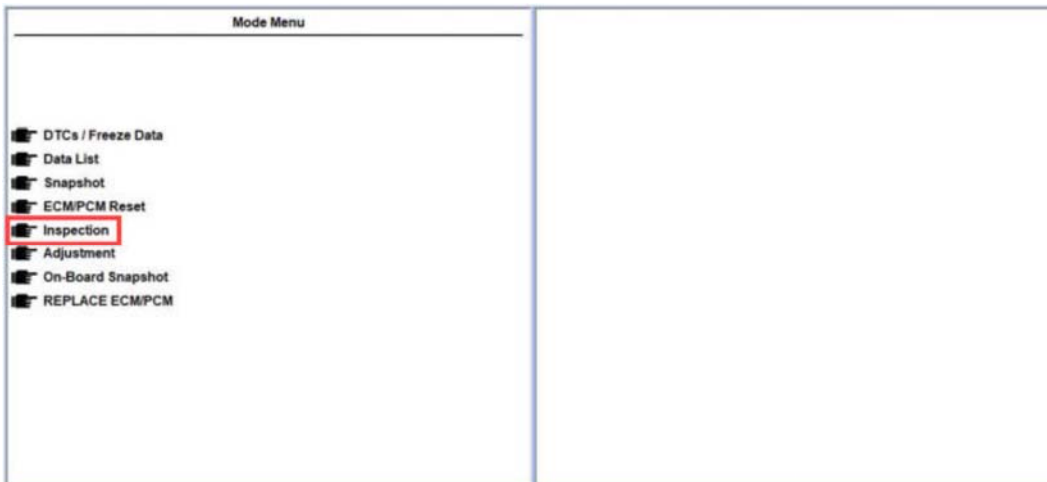

6. Select **Cylinder AF Test**.

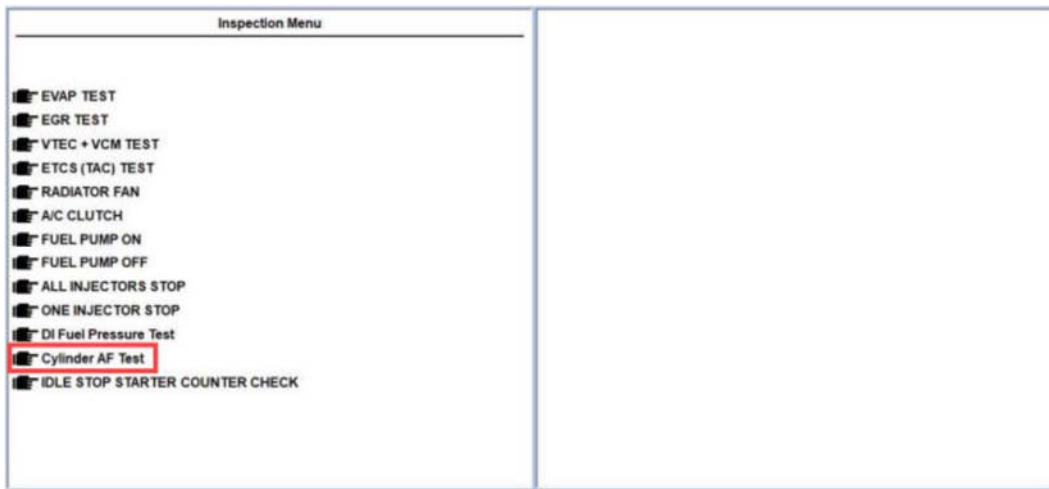

7. Make sure all cylinders pass.

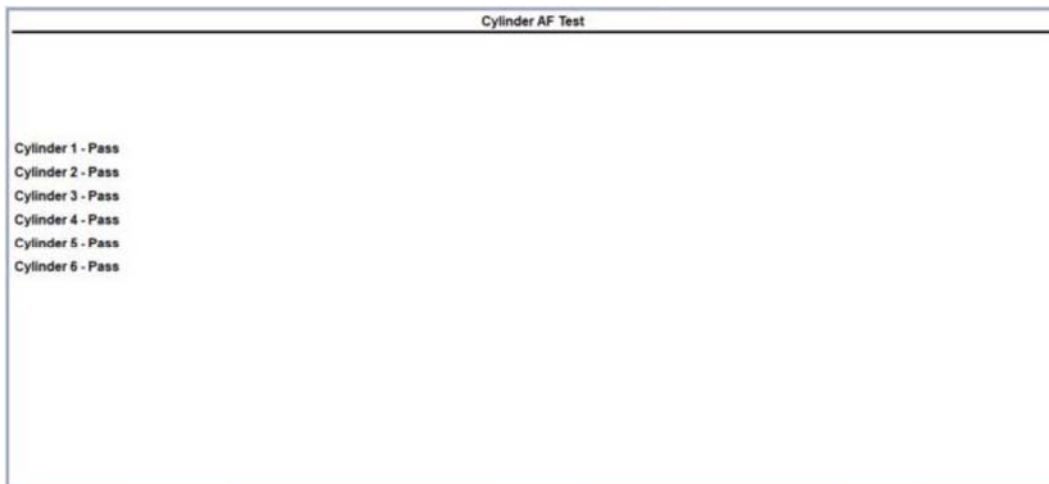

Did all cylinders pass?

Yes - This service bulletin does not apply. Continue with normal system troubleshooting.

No - Go to REPAIR PROCEDURE.

REPAIR PROCEDURE

1. Relieve the fuel pressure.
2. Disconnect the negative terminal from the 12-volt battery.
3. Remove the intake manifold and intake manifold base.
4. Remove the high pressure fuel pump cover.
5. Remove the fuel rail cover.
6. Remove the fuel joint pipe.
7. Remove the fuel rail and fuel injectors.
8. Replace the fuel injectors in the fuel rail.
9. Install the fuel rail and new fuel injectors into the cylinder head.
10. Lubricate the tips of the new fuel joint pipe with polyethylene glycol included in the fuel injector kit.
11. Lubricate the threaded areas of the fuel rails and high pressure fuel pump with polyethylene glycol.

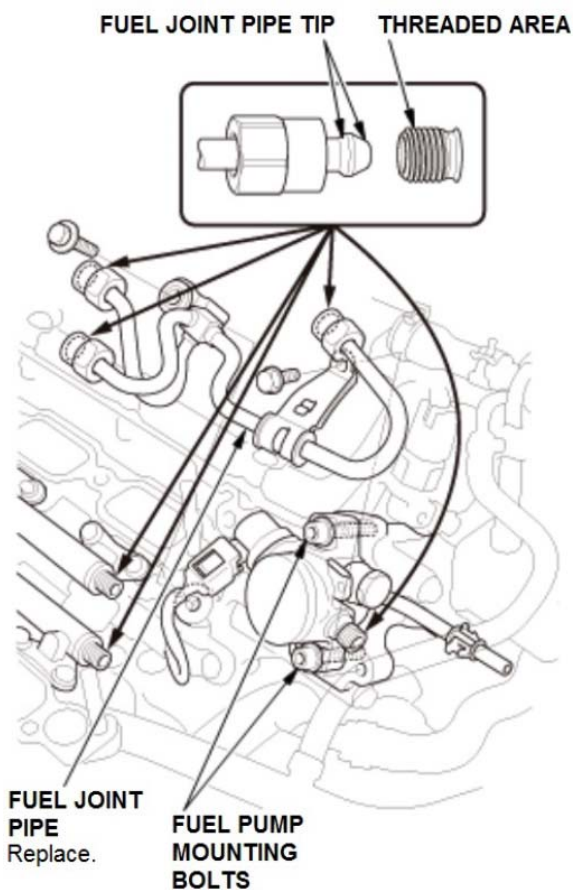

12. Loosen the fuel pump mounting bolts.
13. Install the new fuel joint pipe.

NOTE: Do not reuse the fuel joint pipe. Failure to install a new fuel joint pipe will cause fuel leaks.

14. Tighten the fuel joint pipe nuts by hand until the tips of the fuel joint pipe are seated on the fuel rails and the high pressure fuel pump.

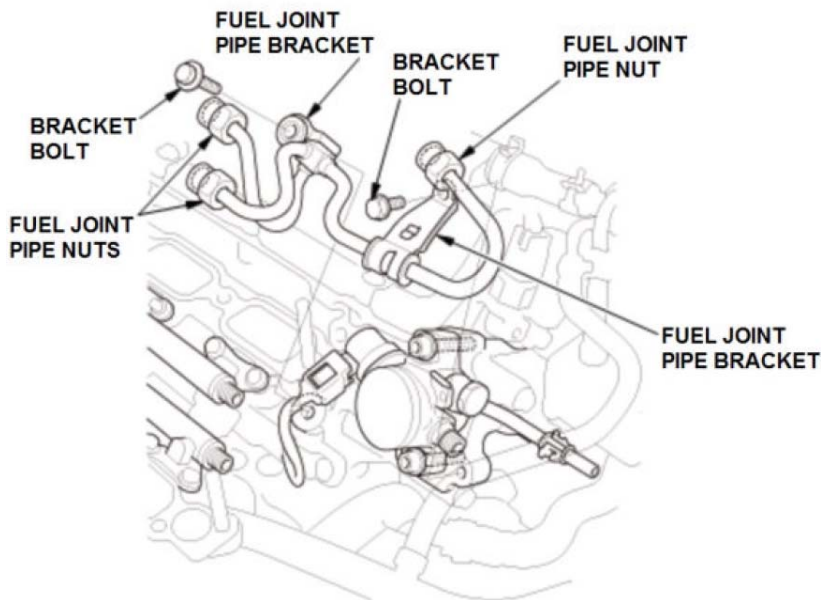

15. Loosely install the bracket bolts to secure the new fuel joint pipe to the cylinder head.
16. Tighten the fuel pump mounting bolts to **25 N·m (18 lb-ft)**.

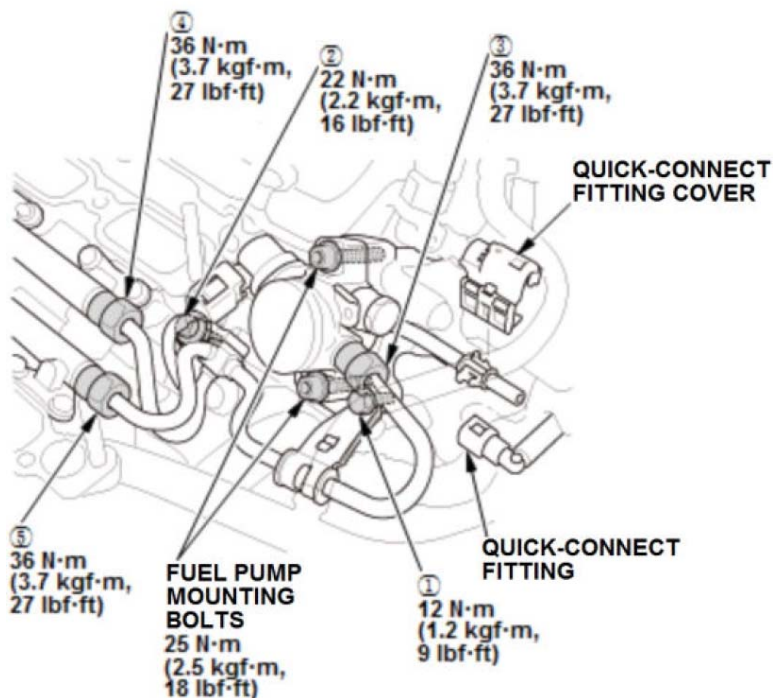

17. Tighten the fuel joint pipe bracket bolts to **12 N·m (9 lb-ft)** and **22 N·m (16 lb-ft)** in the order shown.
18. Tighten the fuel joint pipe nuts to **36 N·m (27 lb-ft)** in the order shown.

NOTE:

- A crowfoot-type special tool increases the torque applied by the torque wrench. Refer to Torque Specifications on SIS for details on how to recalculate the torque wrench setting.
- Failure to tighten the fuel joint pipe nuts to the proper torque will cause a fuel leak.

19. Connect the quick-connect fitting and install the quick-connect fitting cover.
20. Connect the negative terminal to the 12-volt battery.
21. Check for fuel leaks.
22. Install the fuel rail cover.
23. Install the high pressure fuel pump cover.
24. Install the intake manifold base and intake manifold.
25. Do an all-DTC check, and clear any DTCs from all systems.

END