

**LINCOLN:**

2015-2016 MKC

2016 MKX

This article supersedes TSB **16-0022** to remove the production fix date.

**ISSUE**

Some 2015-2016 MKC and 2016 MKX vehicles may exhibit a wind or whistle noise from the exterior mirror(s) at highway speed.

**ACTION**

Follow the Service Procedure steps to correct the condition.

**SERVICE PROCEDURE**

Follow the procedure for the affected side(s).

1. Position the exterior mirror glass for access. (Figure 1)

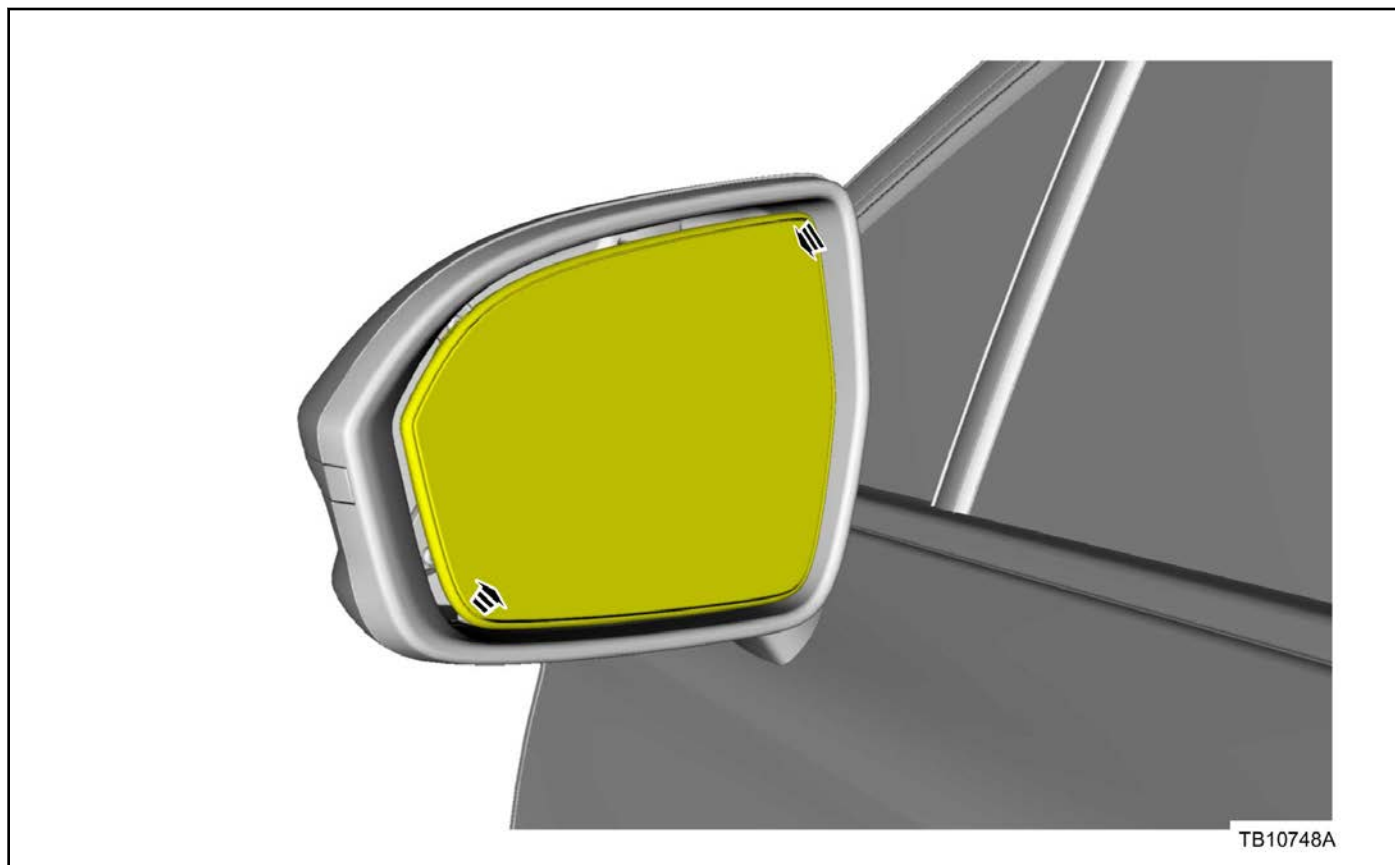

Figure 1 - Article 16-0058

2. Release the mirror glass and disconnect the electrical connectors. Use of a non-marring plastic trim tool is recommended to release the mirror glass. (Figure 2)

NOTE: The information contained in Technical Service Bulletins is intended for use by trained, professional technicians with the knowledge, tools, and equipment to do the job properly and safely. It informs these technicians of conditions that may occur on some vehicles, or provides information that could assist in proper vehicle service. The procedures should not be performed by "do-it-yourselfers". Do not assume that a condition described affects your car or truck. Contact a Ford, Lincoln, or Mercury dealership to determine whether the bulletin applies to your vehicle. Warranty Policy and Extended Service Plan documentation determine Warranty and/or Extended Service Plan coverage unless stated otherwise in the TSB article. The information in this Technical Service Bulletin (TSB) was current at the time of printing. Ford Motor Company reserves the right to supersede this information with updates. The most recent information is available through Ford Motor Company's on-line technical resources.

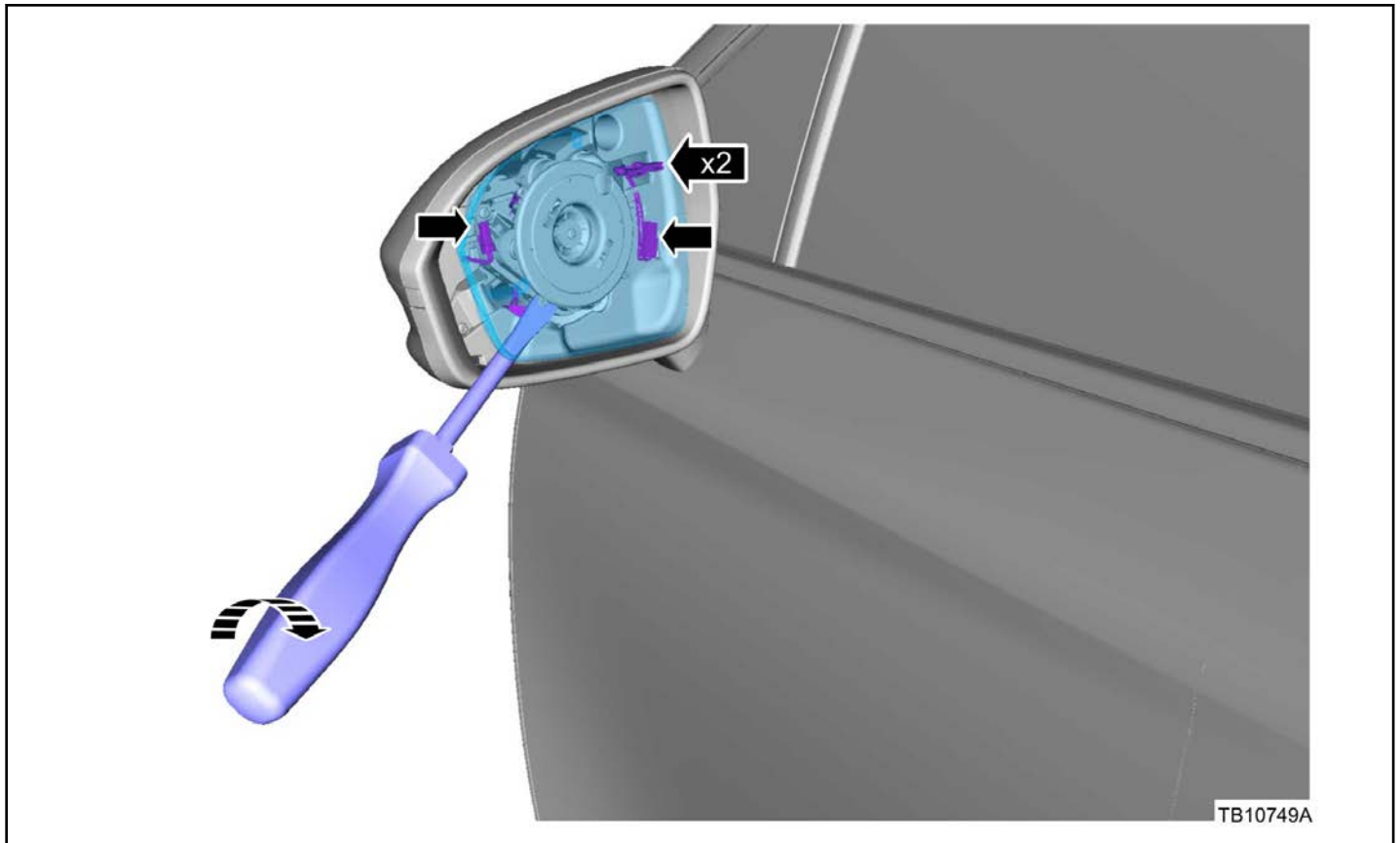

Figure 2 - Article 16-0058

3. Remove the two (2) screws and the mirror glass bezel. It is not necessary to remove the mirror motor. (Figure 3)



Figure 3 - Article 16-0058

4. Remove the screw and position the mirror cover aside. (Figure 4)

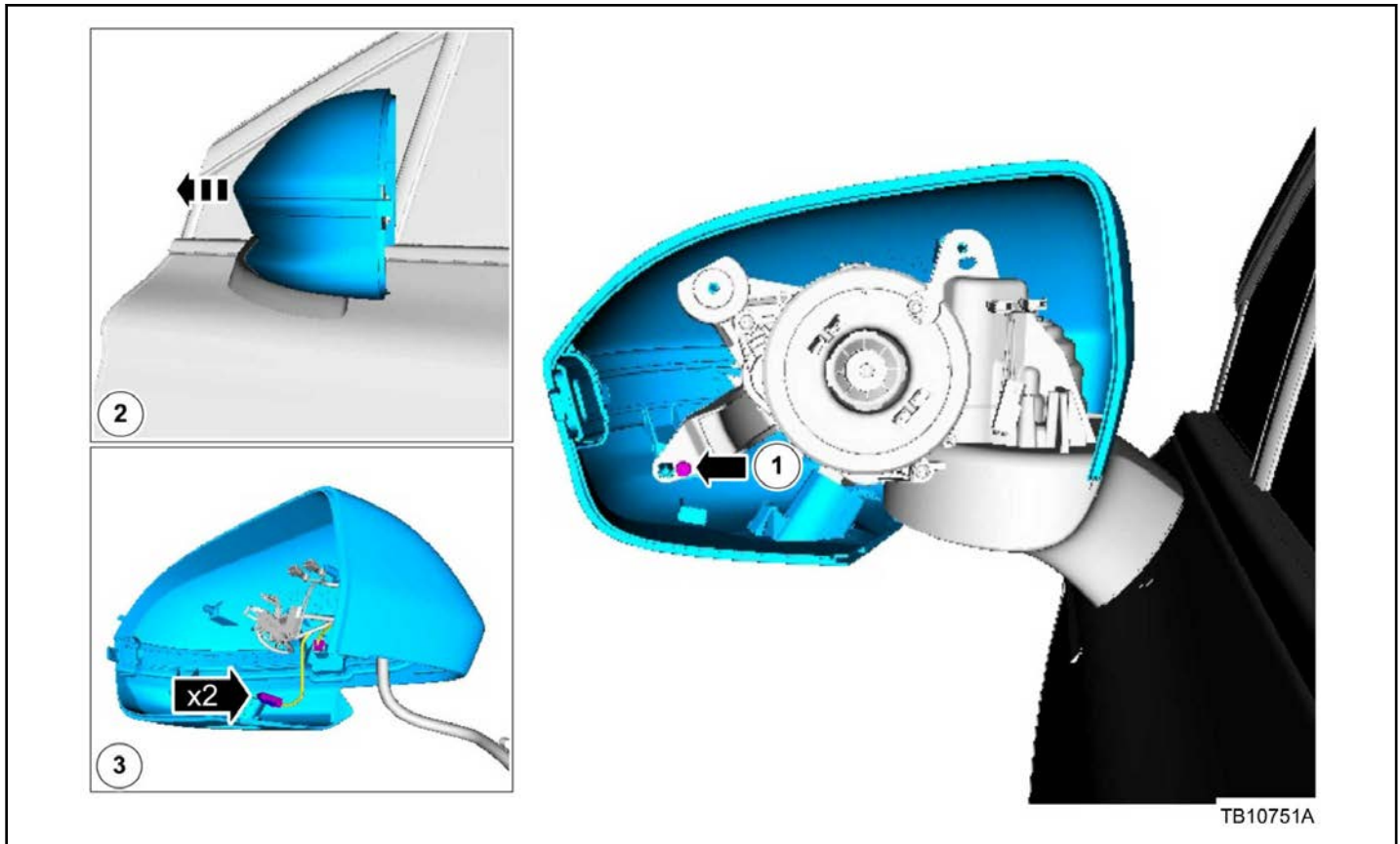

Figure 4 - Article 16-0058

5. Disconnect the two (2) electrical connectors.
6. Remove the foam seal tape if present and clean the location shown with isopropyl alcohol. (Figure 5)



Figure 5 - Article 16-0058

7. Dry the surface using a lint free cloth.
8. Cut one piece of PVC soft foam tape 164-R4901 from Rotunda Squeak and Rattle kit 164-R4900 as shown. (Figure 6)

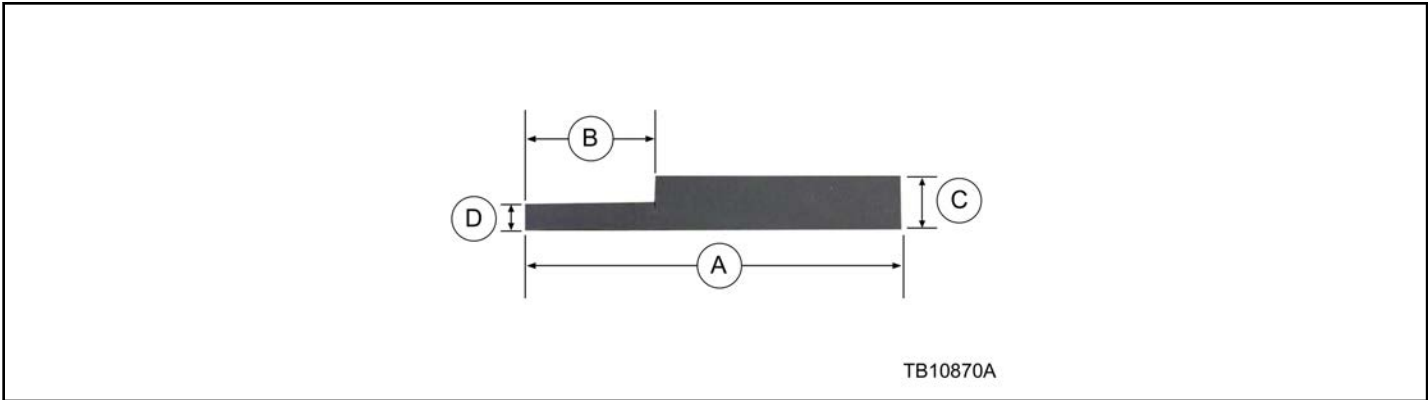

Figure 6 - Article 16-0058

- A - 155 mm (6 inches)
- B - 51 mm (2 inches)
- C - 22 mm (7/8 inch)
- D - 9 mm (3/8 inch)

9. Install the trimmed piece of PVC soft foam tape. (Figure 7)



Figure 7 - Article 16-0058

- a. Position the tape so it will not be visible after reassembly.
10. To assemble, refer to Workshop Manual (WSM), Section 501-09.
- a. Be careful not to damage the foam tape when installing the mirror housing.

| Obtain Locally |  |
|----------------|--|
| Part Number    | Part Description   |
| 164-R4901      | Rotunda PVC Tape Soft Foam - Rotunda Squeak and Rattle Kit 164-R4900 |
|                | Isopropyl Alcohol  |

| OPERATION | DESCRIPTION   | TIME    |
|-----------|---|---------|
| 160058A   | 2015-2016 MKC 2016 MKX: Install Foam Tape Following The Service Procedure On One (1) Exterior Mirror. Includes Time To Road Test (Do Not Use With Any Other Labor Operations)   | 0.6 Hr. |
| 160058B   | 2015-2016 MKC 2016 MKX: Install Foam Tape Following The Service Procedure On Both (2) Exterior Mirrors. Includes Time To Road Test (Do Not Use With Any Other Labor Operations) | 0.8 Hr. |

**WARRANTY STATUS:**

Eligible Under Provisions Of New Vehicle Limited Warranty Coverage

Warranty/ESP coverage limits/policies/prior approvals are not altered by a TSB. Warranty/ESP coverage limits are determined by the identified causal part and verified using the OASIS part coverage tool.

**DEALER CODING**

| BASIC PART NO. | CONDITION CODE |
|----------------|----------------|
| 17682          | 42             |