

VOLVO CAR SERVICE AND PARTS BUSINESS			
<h1>Special Tools Bulletin</h1>			
TITLE: Newsletter 100: Mandatory Tools			
NO: 233	ISSUE DATE: 2019-05-09	CAR MARKET: United States and Canada	Page 1 of 5
	STATUS DATE: 2019-05-09		

“Right first time in Time”

All tools have been classified as required, and will be allocated and billed to all U.S. and Canadian retailers by Volvo.

All tool allocations and tool orders are being handled by the Volvo Parts Operations and the Volvo Parts Distribution Centers.

Overview of content: Kit 33300326

<u>Part Number</u>	<u>Description</u>
9513130	Adaptor
9513131	Adaptor
9814253	Nipple
9997711	Mandrel
9997713	Mandrel
9997714	Mandrel
9997717	Counter Hold
9997718	Counter Hold
9997719	Counter Hold
9997722	Mandrel
9997723	Gauge
9997730	Plug

Service Personnel: Read and initial	SERVICE MANAGER	PARTS MANAGER	WORKSHOP FOREMAN	SERVICE TECHNICIANS												



9513130

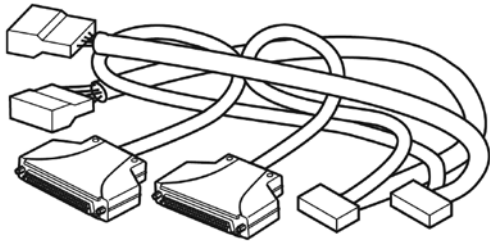

Adapter

VCU1 ECU-adapter, 519A.

Tool standard	C2
Tool group	39
Tool bulletin	421
Model	D420T2, D420T2, B4204T28, B4204T34, B4204T35, B4204T39, B4204T46, B4204T48, B4204T49, B4204T22 and B4204T25
Tool board	39
Weight	524 grams / 1.2 lbs
Material	Mix of plastics and metals
Country of origin	Sweden, SE

9513131

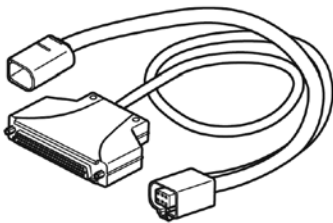

Adapter

Used for the Extended Accessory Module (ESM) or Extended Accessory Module Reverse (ESMR). These modules are mounted in PHEV vehicles or BEV (519A/V331).

Tool standard	C2
Tool group	39
Tool bulletin	421
Model	S60, S90, S90L, V60, V90, XC60, XC90
Tool board	39
Weight	170 grams / 0.4 lbs
Material	Mix of plastics and metals
Country of origin	Sweden, SE

9814253

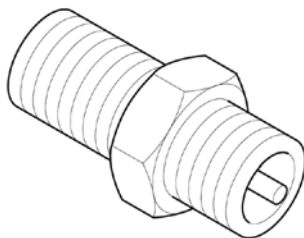

Nipple

Nipple for air suspension.

Tool standard	C1
Tool group	72
Tool bulletin	420
Model	Vehicles equipped with air suspension with standard air filling tool.
Tool board	72
Weight	200 grams / 0.5 lbs
Material	Brass
Country of origin	Germany

9814253 WILL BE SENT OUT SEPARATELY!



9997711

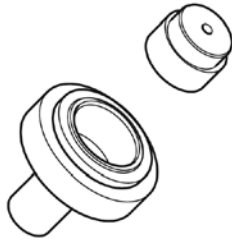

Mandrel

Drive shaft sealing left, 519A.

Tool standard	C1
Tool group	46
Tool bulletin	420
Model	Gearbox AW8G55
Tool board	46
Weight	410 grams / 1 lb
Material	POM
Country of origin	Poland, PL

9997713



Mandrel

Drive shaft sealing left, 619A.

Tool standard	C1
Tool group	46
Tool bulletin	420
Model	Gearbox AW8G30
Tool board	46
Weight	500 grams / 1.1 lbs
Material	POM
Country of origin	Hungary, HU

9997714

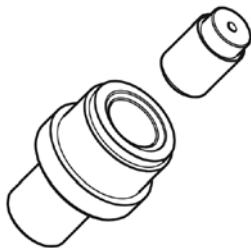

Mandrel

Drive shaft sealing right, 619A.

Tool standard	C1
Tool group	46
Tool bulletin	420
Model	Gearbox AW8G30
Tool board	46
Weight	705 grams / 1.6 lbs
Material	POM
Country of origin	Poland, PL



9997717

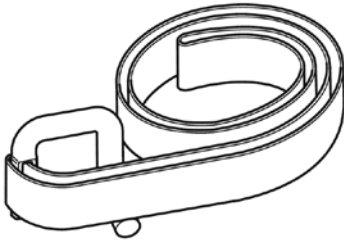

Counter hold

Mounting strap to water pump (belt elastic), 519A.

Tool standard	C1
Tool group	21
Tool bulletin	420
Model	XC90 and XC60 with D420T2 and D420T8 engine. VED Gen3.
Tool board	21
Weight	65 grams / 0.2 lbs
Material	Steel S235JR and polyester/nylon
Country of origin	Sweden, SE

9997718

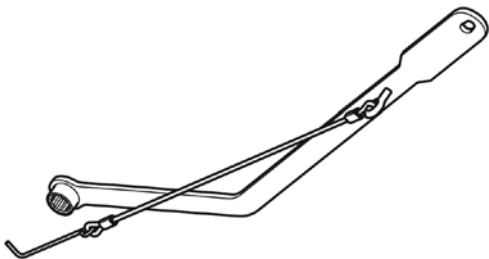

Counter hold

Tool for tension roller, auxiliary roller, 519A.

Tool standard	C1
Tool group	21
Tool bulletin	420
Model	XC90 and XC60 with D420T2 and D420T8 engine. VED Gen3.
Tool board	21
Weight	810 grams / 1.8 lbs
Material	Steel, PVC, nylon cord, aluminium
Country of origin	Sweden, SE

9997719

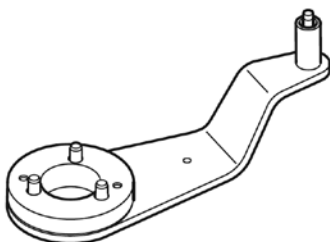

Counter hold

Counter hold to torque the screw to the vibration damper, 519A.

Tool standard	C1
Tool group	21
Tool bulletin	420
Model	XC90 and XC60 with D420T2 and D420T8 engine. VED Gen3.
Tool board	21
Weight	760 grams / 1.7 lbs
Material	Steel, PA66
Country of origin	Sweden, SE



9997722

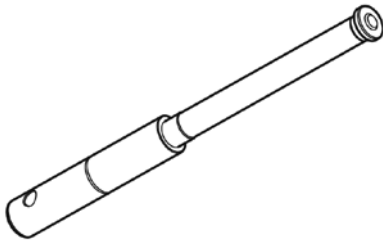

Mandrel

Removal of clamping pin (oil pump), 519A.

Tool standard	C1
Tool group	21
Tool bulletin	420
Model	XC40 with B3154TX engines
Tool board	21
Weight	430 grams / 1 lb
Material	Steel
Country of origin	Sweden, SE

9997723

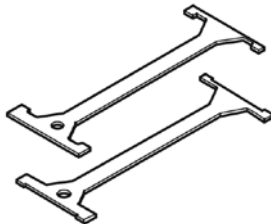

Gauge

Measurement of the wear of the brake pads.

Tool standard	C1
Tool group	51
Tool bulletin	420
Model	All models
Tool board	51
Weight	400 grams / 0.9 lbs
Material	Stainless steel
Country of origin	Hungary, HU

9997730

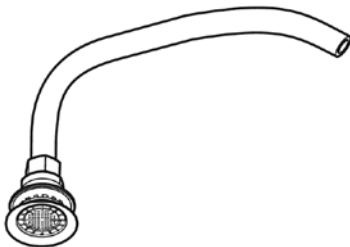

Plug

Suction cup to be used with filling equipment to check the valve sealing, 519A.

Tool standard	C1
Tool group	21
Tool bulletin	420
Model	For all models with VED D4204TX
Tool board	21
Weight	180 grams / 0.4 lbs
Material	Part 1 PU, part 2 nickel-plated brass, part 3 PVC
Country of origin	Sweden, SE