 HYUNDAI Technical Service Bulletin	GROUP BODY ELECTRICAL	NUMBER 19-BE-008H
	DATE MAY, 2019	MODEL(S) SANTA FE (TMa) NEXO (FE) ELANTRA (AD)
SUBJECT: BLIND-SPOT COLLISION WARNING (BCW) MODULE REPLACEMENT INFORMATION		

Description: This bulletin provides information for replacement of the Blind-Spot Collision Warning (BCW) module. Whenever the left or right side BCW module is being replaced, it is required to perform the variant coding procedure. If the variant coding procedure is not performed, a DTC C1743 (S/W mismatch) will be triggered.

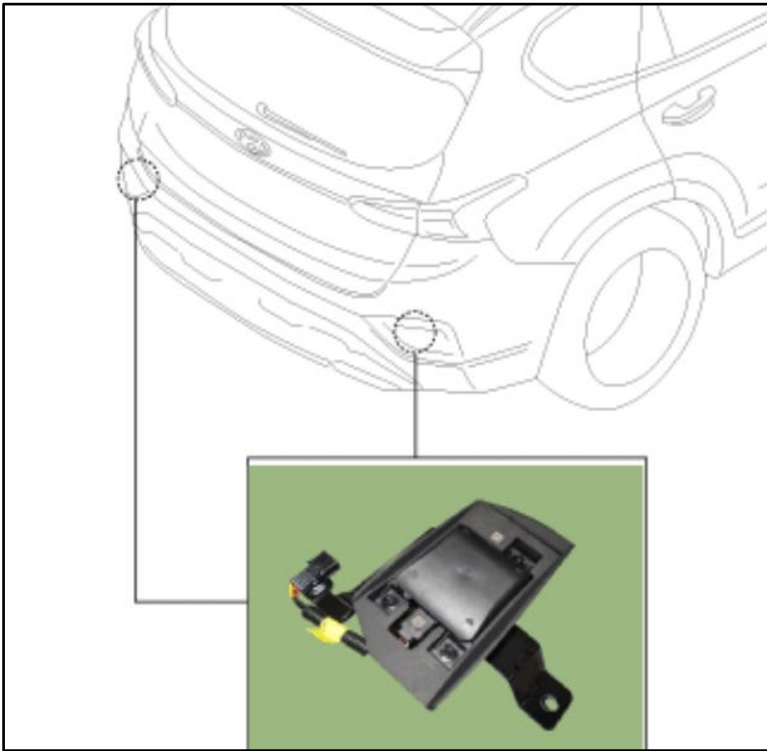

Applicable Vehicles:
2019 Santa Fe (TMa)
2019 Nexo (FE)
2019 Elantra (AD)

Warranty Information:
Normal Warranty Applies

Service Procedure:**VARIANT CODING****NOTICE**

Whenever the left or right side BCW module is being replaced, it is required to perform the variant coding procedure. If the variant coding procedure is not performed, a DTC C1743 will be triggered.

1. Turn the GDS ON.

Locate the data link connector and install the VCI II.

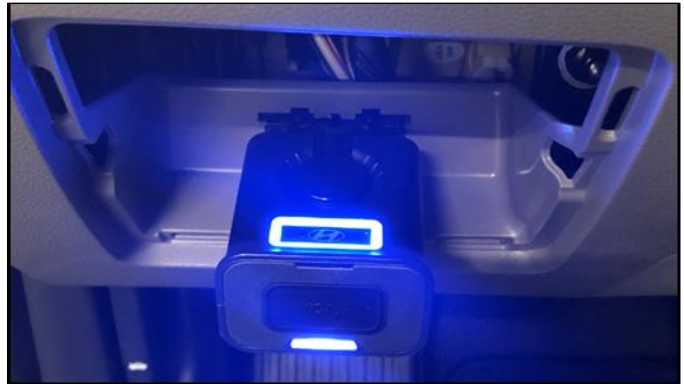

2. Turn ignition ON.



SUBJECT:

**BLIND-SPOT COLLISION WARNING (BCW) MODULE
REPLACEMENT INFORMATION**

3. In the GDS, select “**Vehicle Selection**”.

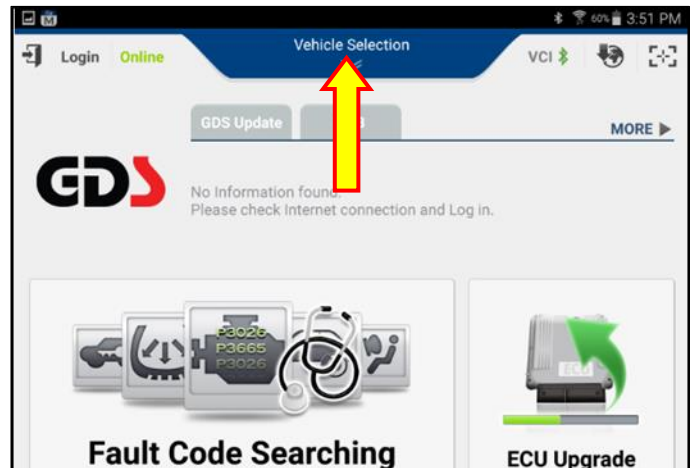

4. Select “**AUTO VIN**”.

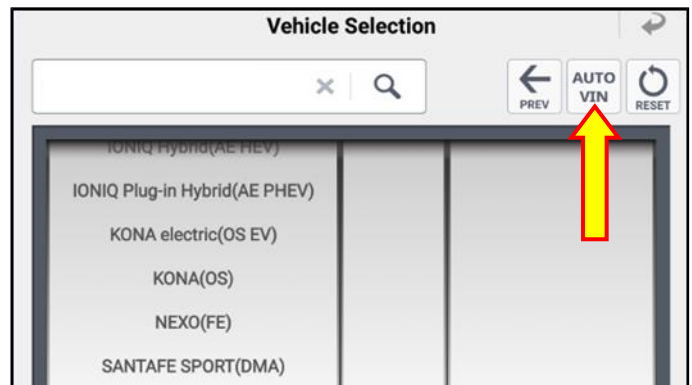

5. Select “**S/W Management**”.

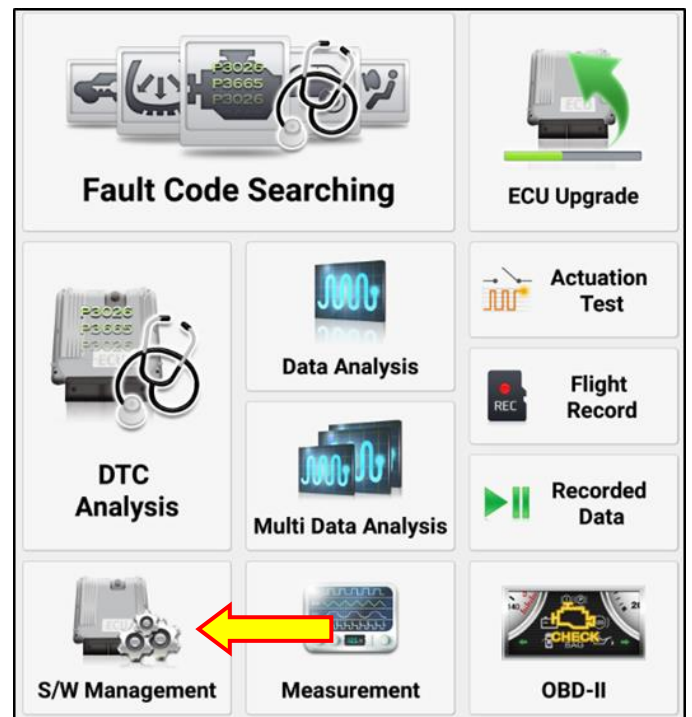

SUBJECT:

BLIND-SPOT COLLISION WARNING (BCW) MODULE REPLACEMENT INFORMATION

6. On S/W Management page, scroll down, and select “Blind-Spot Collision Warning”, followed with “BCW(BSD) variant coding”.



7. Enable/Disable the features that apply to the vehicle and then select “OK”.

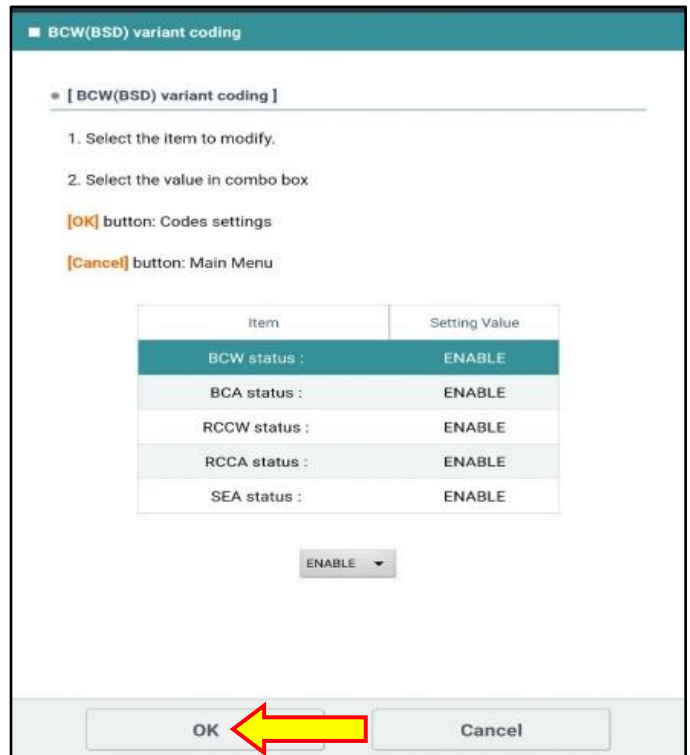

DESCRIPTION OF FEATURES SELECTION

- BCW: Warn the driver about vehicle detected in blind spot zone and approaching at high speed.
- RCCW: Alert for rear crossing vehicle when the vehicle is moving in reverse.
- RCCA: Braking function of collision avoidance or mitigation for rear crossing vehicle.
- BCA: Braking function of collision avoidance or mitigation for vehicle in the blind areas.
- SEA: Alert for vehicles approaching from the rear when the passengers exits the vehicle.

