



Preliminary Information

PIT5386D Back Up Alarm Inoperative and needs to be Connected During PDI

Product Investigation Review Required

Models

Brand:	Model:	Model Years:	VIN:		Engine:	Transmissions:
			from	to		
Chevrolet	Silverado 1500	2014	All	All	All	All
Chevrolet	Silverado	2015 - 2018	All	All	All	All
Chevrolet	Silverado 2500/3500	2019	All	All	All	All
Chevrolet	Silverado LD	2019	All	All	All	All
GMC	Sierra 1500	2014	All	All	All	All
GMC	Sierra	2015 - 2018	All	All	All	All
GMC	Sierra 2500/3500	2019	All	All	All	All
GMC	Sierra Limited	2019	All	All	All	All

Equipped with Back Up Alarm (RPO 8S3)

Supersession Statement

This PI was superseded to update model years. Please discard PIT5386C.

The following diagnosis might be helpful if the vehicle exhibits the symptom(s) described in this PI.

Condition / Concern

During the PDI it may be noticed that the backup alarm is inoperative. On trucks equipped with the Back Up Alarm (RPO 8S3), the alarm will be intentionally left disconnected from the assembly plant.

Recommendations / Instructions

The alarm is located on the right rear of the frame, and the chassis harness alarm connector is located on the left rear of the frame. Route the harness up and over the spare tire hoist tube and connect to the backup alarm.

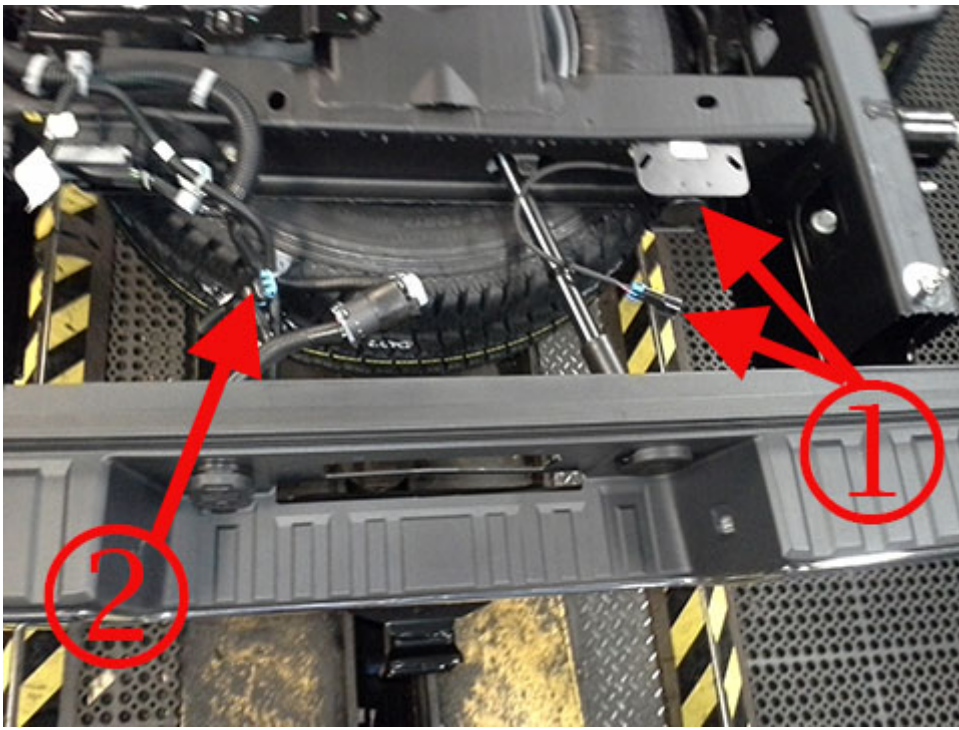

1. Back Up Alarm/Connector
2. Chassis Harness Alarm Connector

Warranty Information

Labor Operation	Description	Labor Time
0590032	PDI - Dealer Installed - Factory Invoiced Options	Use Published Labor Operation Time

Please follow this diagnostic or repair process thoroughly and complete each step. If the condition exhibited is resolved without completing every step, the remaining steps do not need to be performed.

Additional SI Keywords

backup reverse shift

