

May 8, 2015

00467 Version 1

## Popping from the Speakers

### AFFECTED VEHICLES

Year	Model	Trim	VIN Range
2012-13	Civic	ALL Si with Navigation	ALL

### SYMPTOM

A popping is heard from the speakers when using the power door locks.

### POSSIBLE CAUSES

There are no noise filters on the power door lock motors.

### CORRECTIVE ACTION

Install a noise filter on each door lock.

### PARTS INFORMATION

Part Name	Part Number	Quantity
Condenser Sub Cord (Suppressor Harness) kit (4-door)	06322-TR0-305	1
Condenser Sub Cord (Suppressor Harness) kit (2-door)	06322-TS8-305	1

### TOOL INFORMATION

Part Name	Part Number	Quantity
Belt Buckle Tool	07AAF-SNAA150	1

NOTE: These items can be purchased through the Honda Tool & Equipment Program **888-424-6857**.

### WARRANTY CLAIM INFORMATION

The normal warranty applies.

Operation Number	Description	Flat Rate Time	Template ID	Failed Part Number
0121B0	Install noise filters on the door lock harness (2-door).	0.5 hr	15-029A	39186-TR0-A52
0121B1	Install noise filters on the door lock harness (4-door).	0.9 hr	15-029B	

Defect Code: 07801

Symptom Code: 04201

Skill Level: Repair Technician

**CUSTOMER INFORMATION:** The information in this bulletin is intended for use only by skilled technicians who have the proper tools, equipment, and training to correctly and safely maintain your vehicle. These procedures should not be attempted by "do-it-yourselfers," and you should not assume this bulletin applies to your vehicle, or that your vehicle has the condition described. To determine whether this information applies, contact an authorized Honda automobile dealer.

## REPAIR PROCEDURE

1. Make sure the ignition is turned to lock.
2. Do the battery terminal disconnection procedure.
3. Wait at least **3 minutes** before starting work.
4. Free the door wire harness grommet on the front driver's door.
5. Disconnect the door top connector.

### **BETWEEN THE DRIVER DOOR AND THE BODY:**

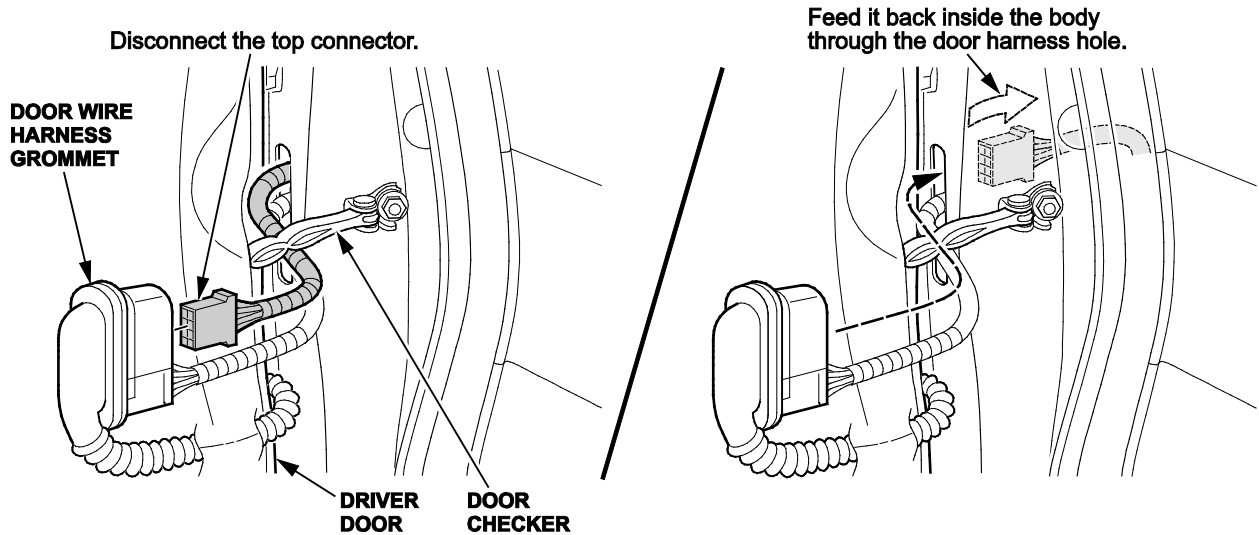

6. Connect the suppressor harness to the door connector.

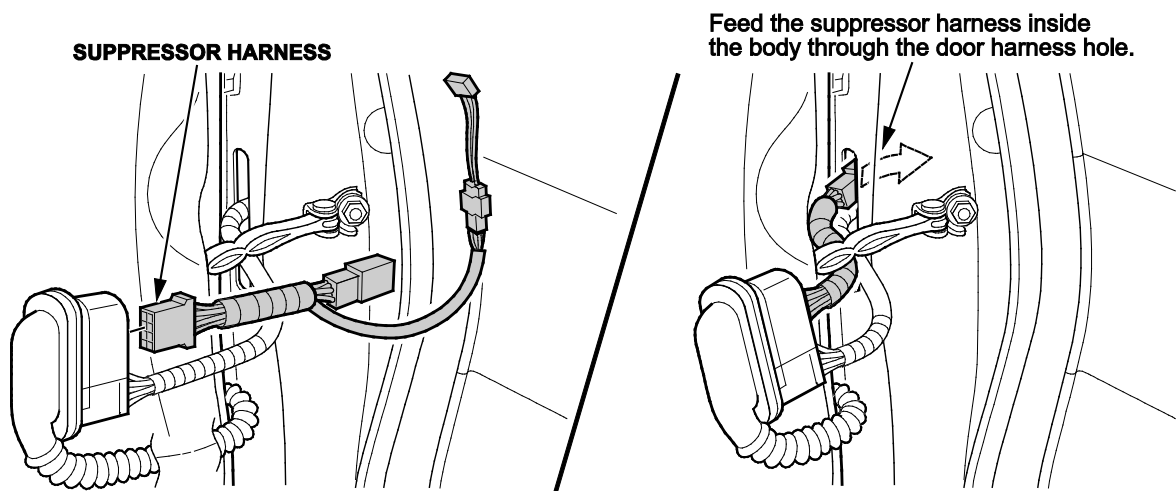

7. Feed the suppressor harness inside the passenger cabin and reinstall the door wire harness grommet.

8. Route the suppressor harness between the under-dash fuse box.

**UNDER THE DRIVER SIDE DASH:**

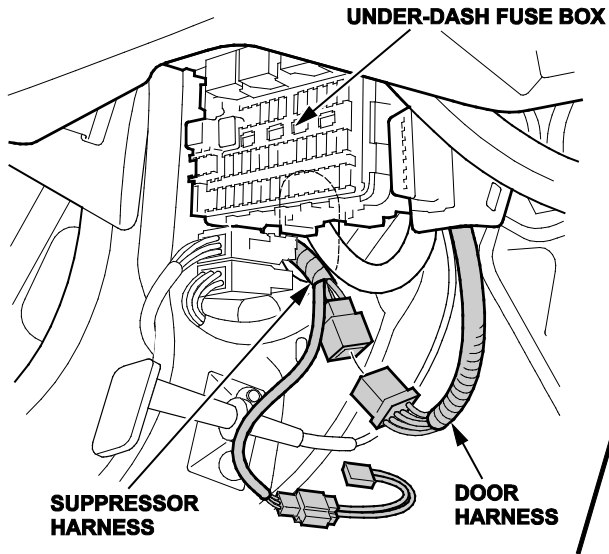

Secure the door harness to the engine harness.

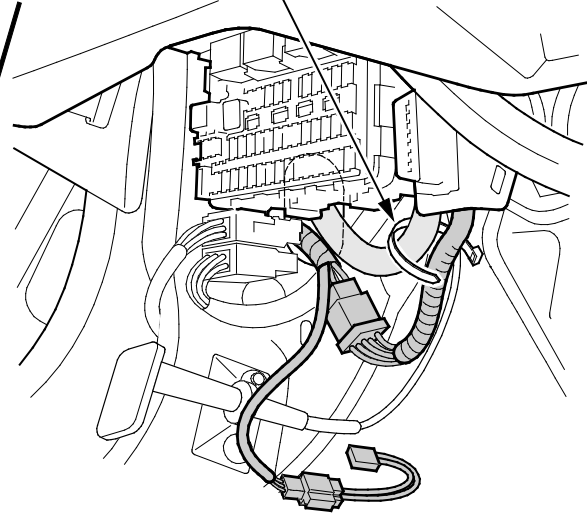

9. Connect the suppressor harness to the door harness and secure it to the engine harness.

10. Secure the suppressor harness as shown.

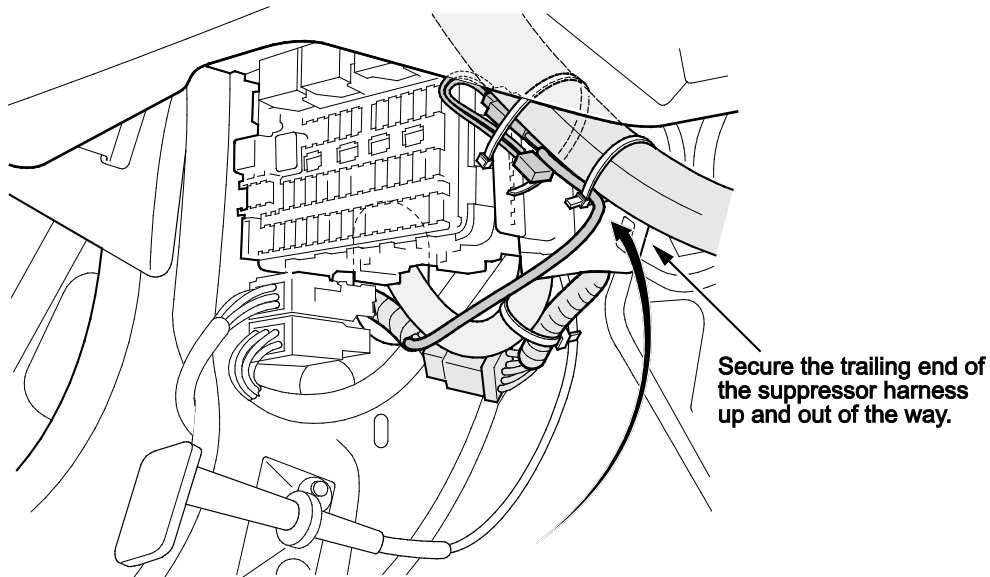

11. For the front passenger's door, remove the EPS control unit located under passenger side dash for more clearance.

**UNDER PASSENGER SIDE DASH:**

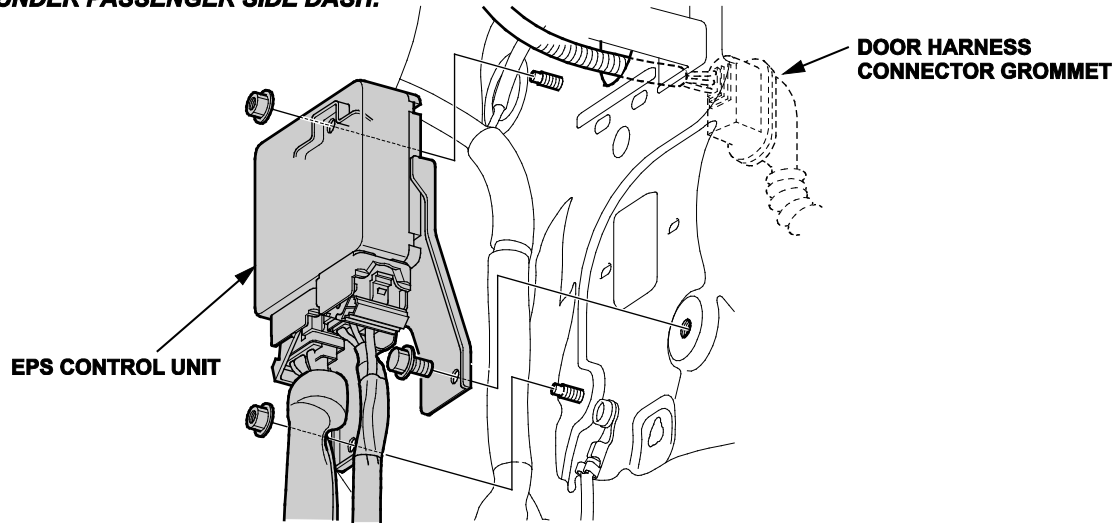

12. With the front passenger's door open, free the front passenger's door harness connector grommet from the A pillar, disconnect the body harness connector, and connect the suppressor harness to the door harness connector and grommet connector.

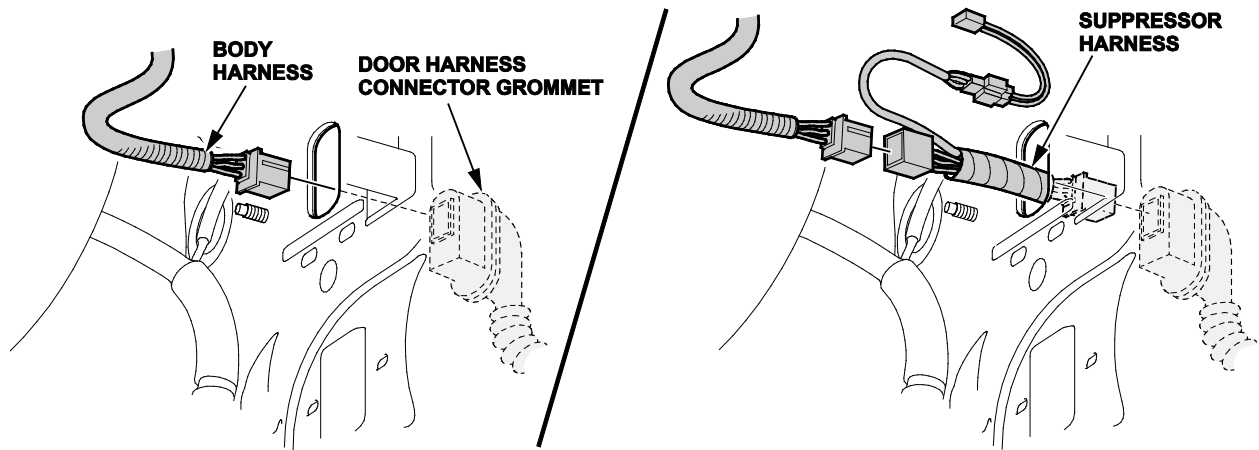

13. Attach the suppressor harness to the body harness using a wire tie.

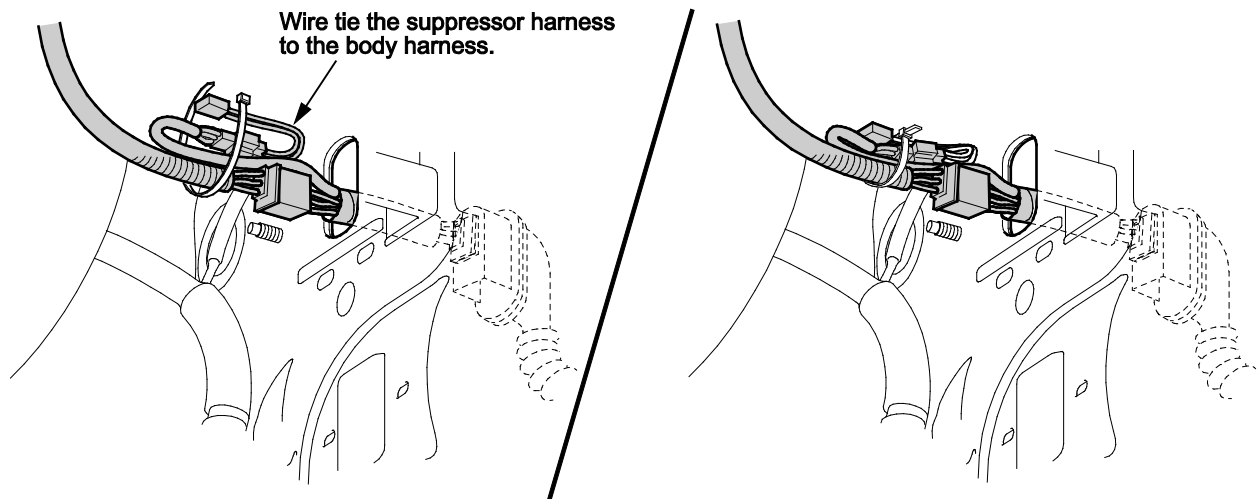

14. Feed the suppressor harness inside the passenger compartment and reinstall the harness door wire grommet.

15. Reinstall the EPS control unit.

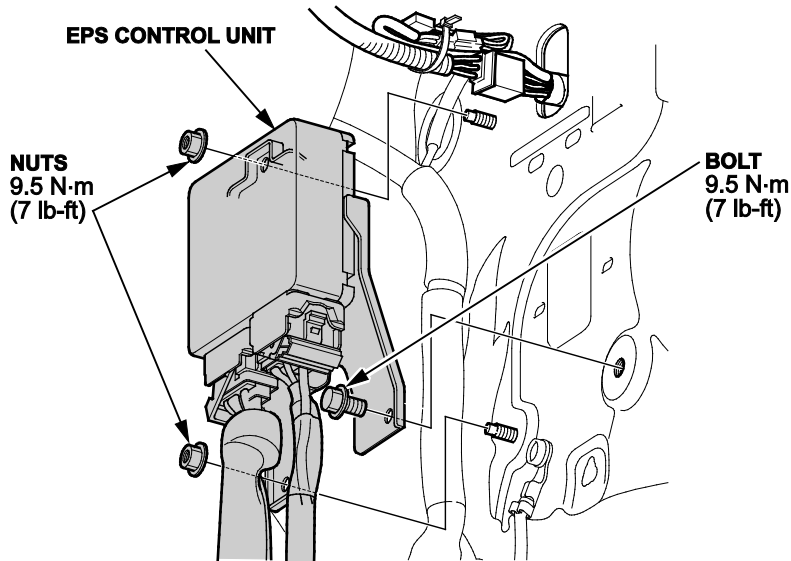

### ***Suppressor harness install on rear doors (4-door)***

**NOTE:** If only doing the corrective action on a 2-door, continue on to step 25 to complete the repair procedure.  
If you are working on a 4-door, continue to step 16.

16. Remove the front and rear door sill trims on passenger's side.

17. Remove the B-pillar lower trim.

18. Remove the seat belt retractor.

**PASSENGER SIDE B-PILLAR SHOWN, DRIVER SIDE SIMILAR:**

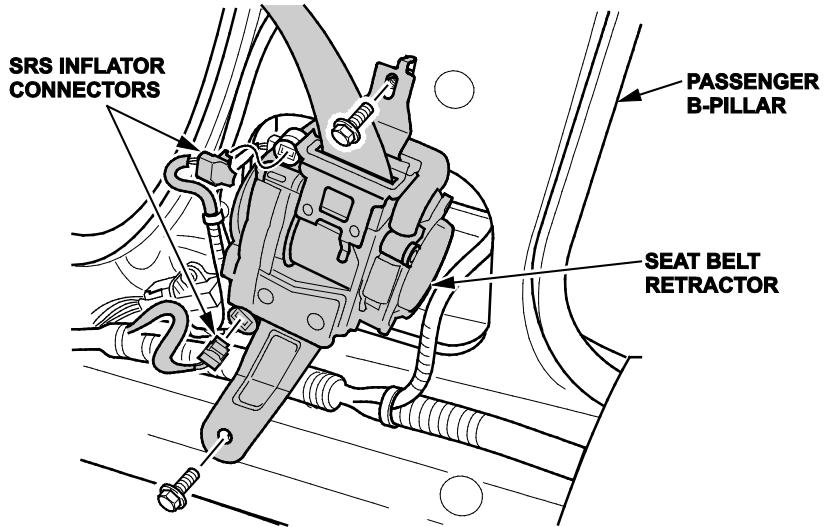

19. Disconnect the passenger rear door wire harness.

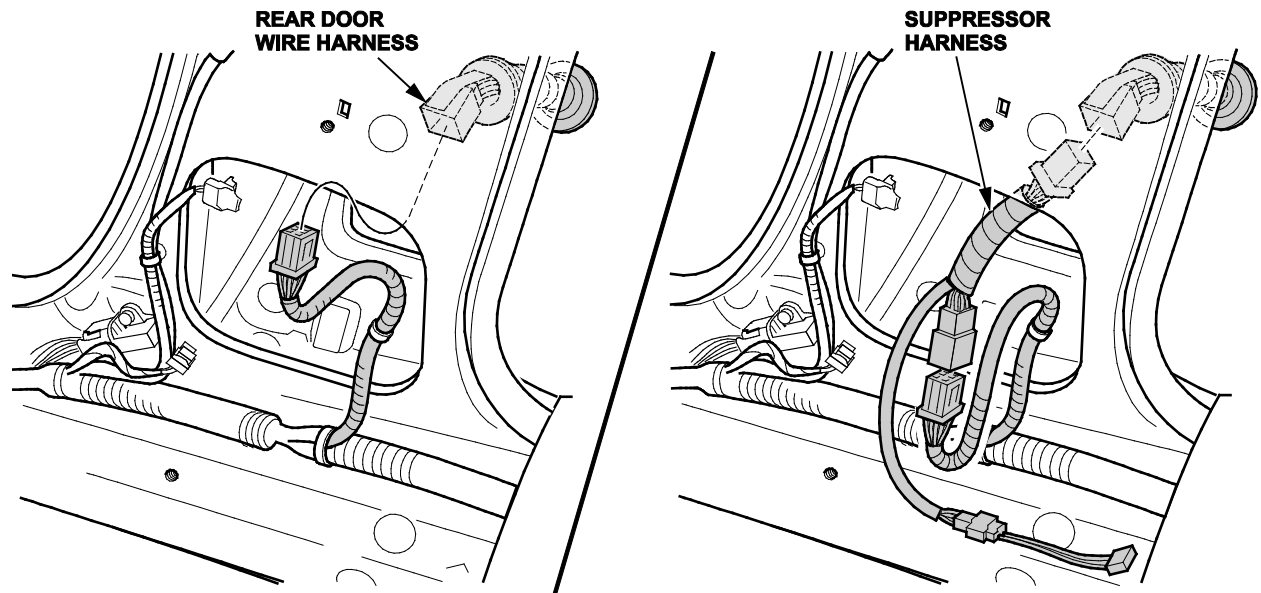

20. Connect the suppressor harness to the rear door wire harness.

21. Secure the suppressor harness to the door harness as shown using zip ties.

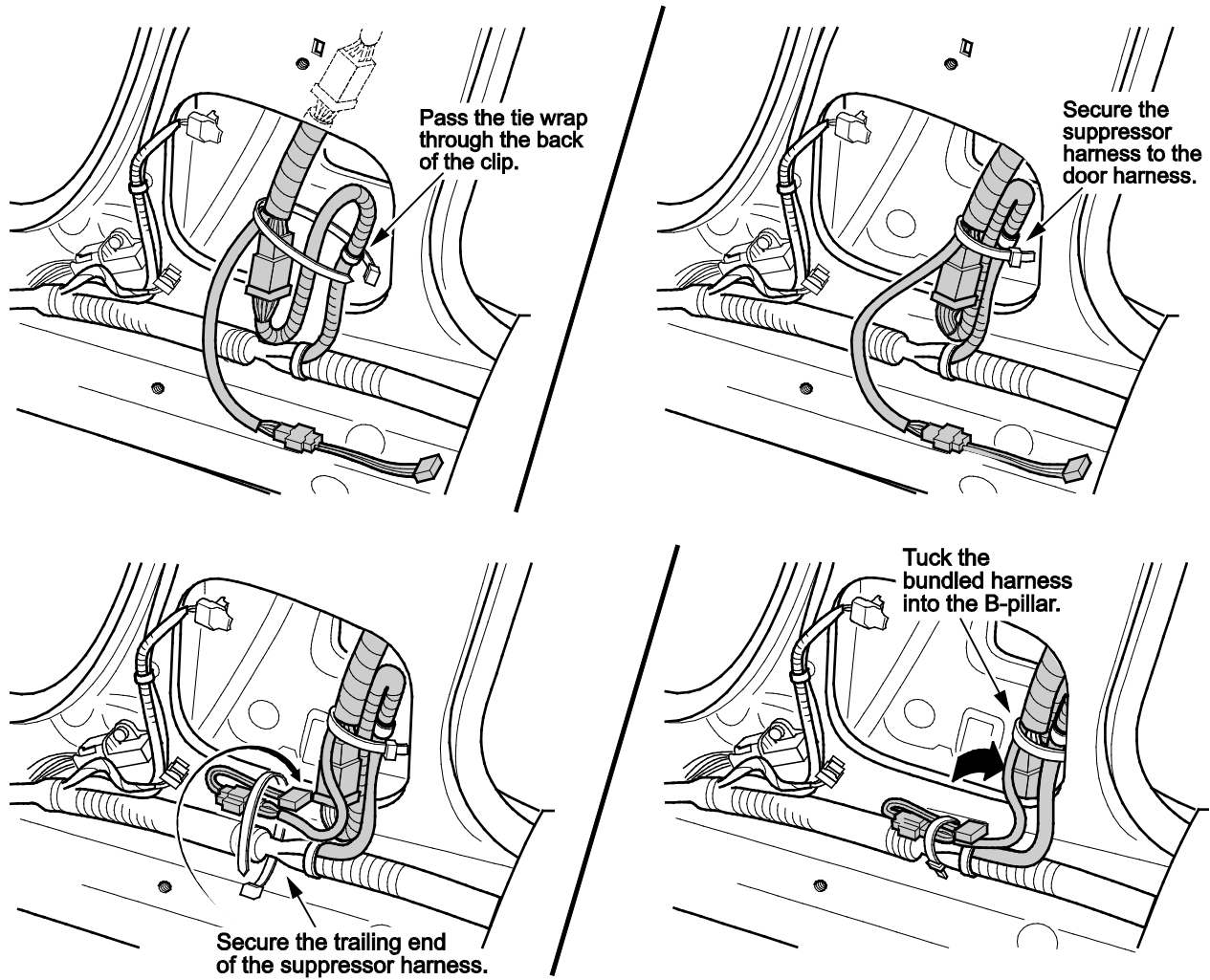

22. Reinstall the seat belt retractor and make sure there is no interference with the suppressor harness.

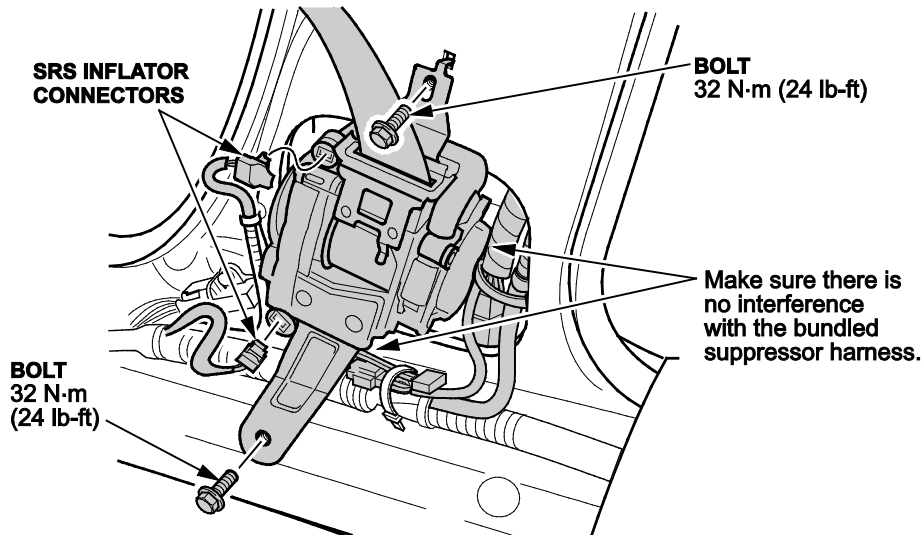

23. Reinstall the B-pillar lower trim and passenger's front and rear door sill trims.

24. For access to driver's side rear door harness, use special tool shown to release the lower anchor on the driver's side outer lap tensioner.

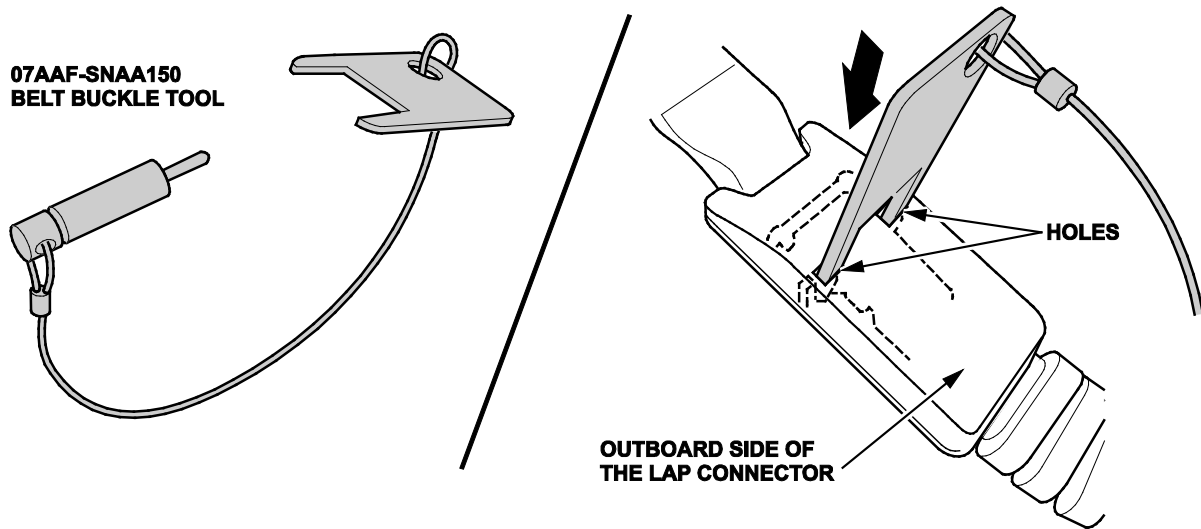

25. Slowly insert the jig into the holes in the back of the lap connector cover to release the sublatch spring. Be sure the jig is inserted vertically.
26. Leave the jig set in the lap connector cover to keep the sublatch spring open. Carefully insert the tip of a small screwdriver into the hole in the lap connector cover, and unlock the lap connector by pushing in on the screwdriver.

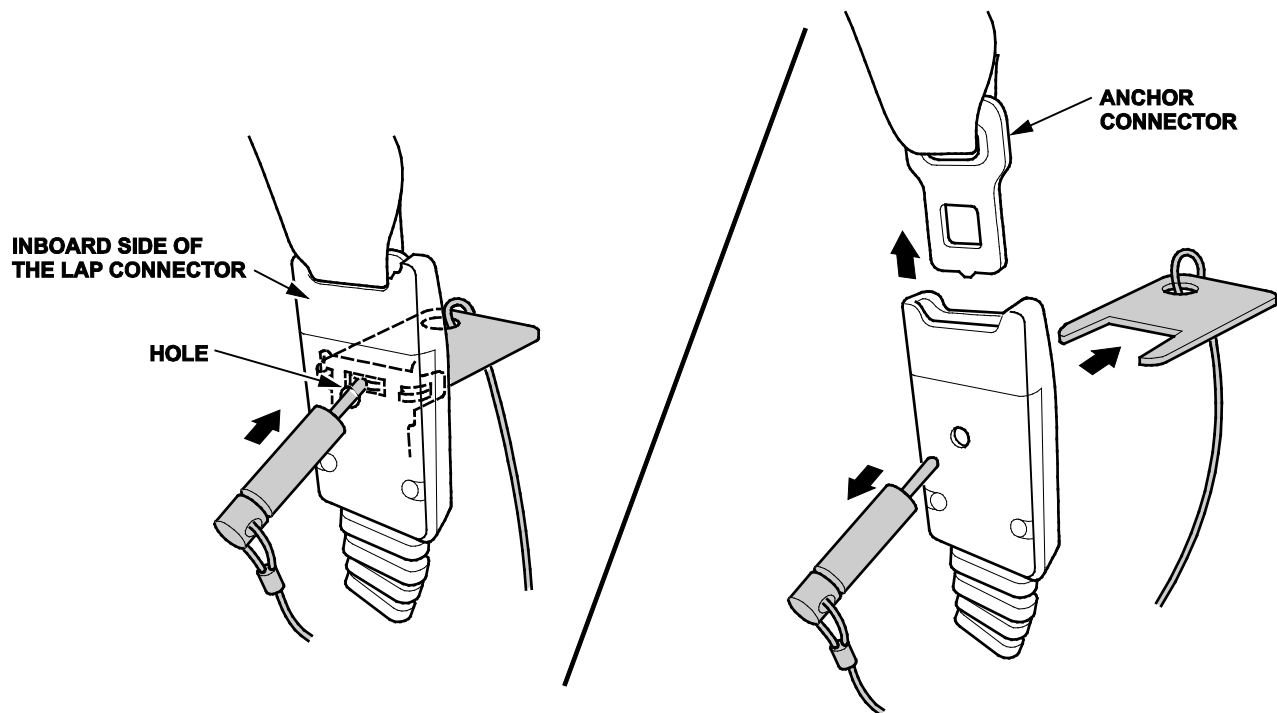

27. Remove the jig. While pulling the front seat belt upward, remove the screwdriver. As soon as you remove the screwdriver from the lap connector, the anchor connector will come off the lap connector.
28. Slide the driver's seat fully forward and remove the B-pillar lower cover.
29. Repeat steps 16–23 for the driver's side rear door harness.
30. Do the battery terminal reconnection procedure.

NOTE: To protect the battery sensor connector from damage, do not hold it when installing the negative terminal.

31. Connect the HDS and make sure no DTC were set.