

**January 28, 2015**

00409 Version 1

## Chirping from the Engine Area While Driving on Rough Roads in Hot Weather

### AFFECTED VEHICLES

Year	Model	Trim	VIN Range
2012–15	Civic	Si	ALL

### SYMPTOM

There is a chirping from the engine area while driving on rough roads in hot weather.

### POSSIBLE CAUSES

The side engine mount's internal components are rubbing together, causing a noise.

### CORRECTIVE ACTION

Replace the side engine mount.

### PARTS INFORMATION

Part Name	Part Number	Quantity
Side Engine Mount	50820-TR7-305	1
Flange Bolt (12 mm x 97 mm)	90165-SWY-E00	1
Flange Bolt (12 mm x 35 mm)	90168-S5A-000	1
Flange Bolt (12 mm x 40 mm)	95701-12040-07	1
Flange Bolt (14 mm x 47 mm)	90160-SVB-A00	1
Flange Nut (14 mm)	90371-SJD-003	1

### WARRANTY CLAIM INFORMATION

The normal warranty applies.

Operation Number	Description	Flat Rate Time	Template ID	Failed Part Number
1121A5	Replace the side engine mount (includes the test-drive).	0.7 hrs	15-009A	50820-TR7-A01

Defect Code: 03214

Symptom Code: 07303

Skill Level: Repair Technician

**CUSTOMER INFORMATION:** The information in this bulletin is intended for use only by skilled technicians who have the proper tools, equipment, and training to correctly and safely maintain your vehicle. These procedures should not be attempted by "do-it-yourselfers," and you should not assume this bulletin applies to your vehicle, or that your vehicle has the condition described. To determine whether this information applies, contact an authorized Honda automobile dealer.

## DIAGNOSIS

Test-drive the vehicle on a rough road and listen for a chirping.

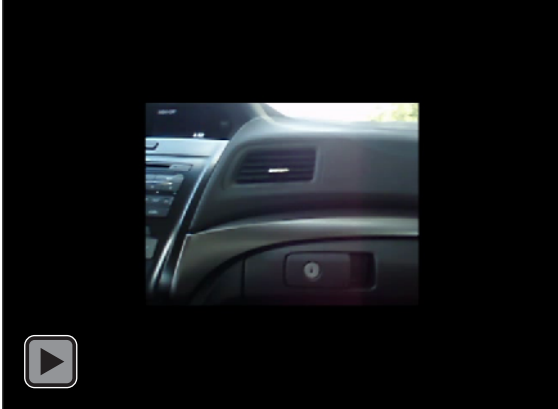

- If you hear a chirping, go to REPAIR PROCEDURE.
- If you do not hear a chirping, this bulletin does not apply. Continue with normal troubleshooting.

## REPAIR PROCEDURE

1. Remove the air cleaner assembly.

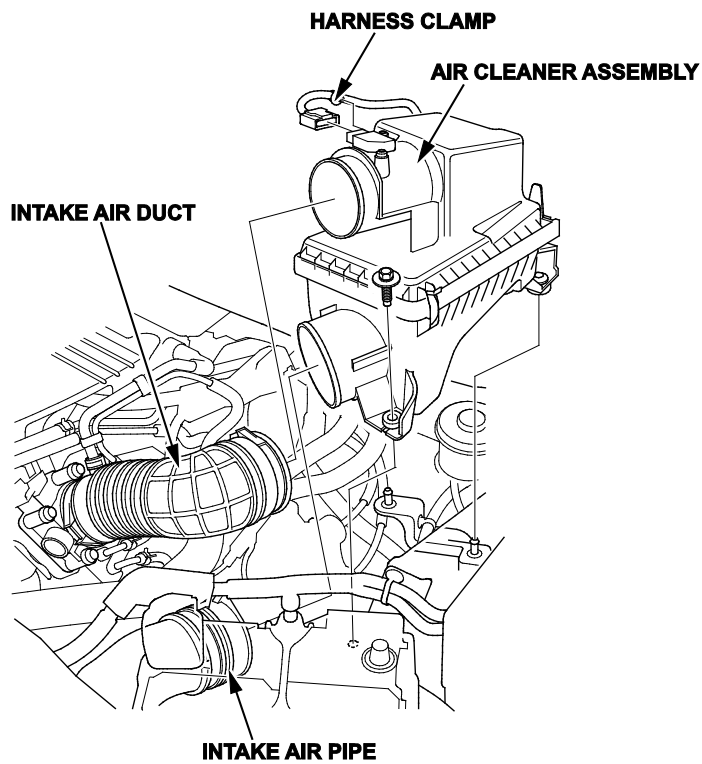

2. Lift and support the engine with a floor jack and a wood block under the oil pan.

3. Remove the upper torque rod.

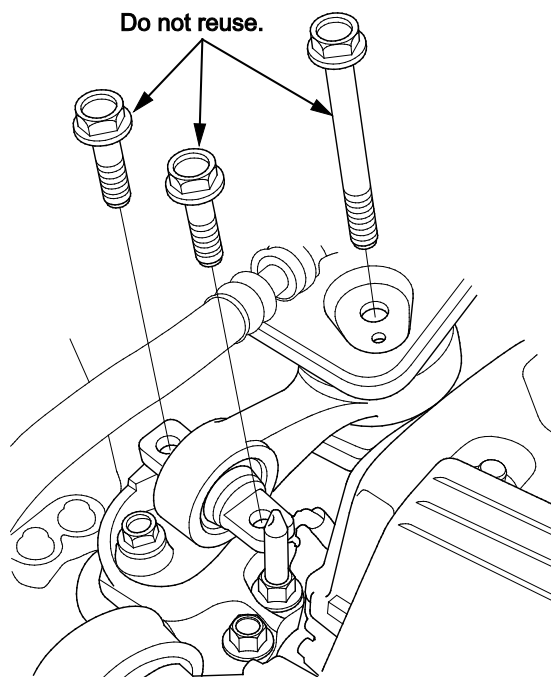

4. Remove the ground cable, the side engine mount bracket, and the side engine mount.

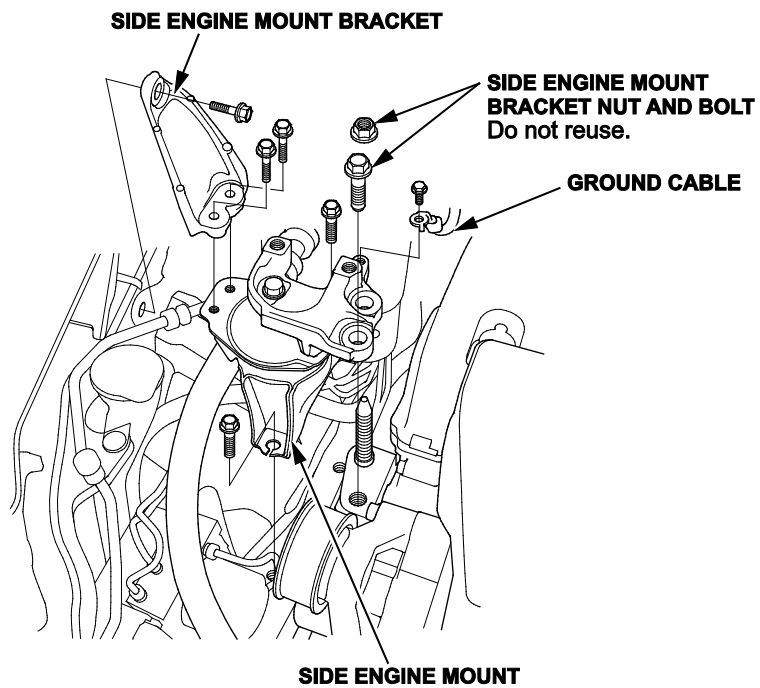

5. Install the new side engine mount mounting bolts and torque them to **64 N·m (47 lb-ft)**. Install the side engine mount bracket B using new bolts and torque them to **49 N·m (36 lb-ft)**, then loosely install the new side engine mount bracket C mounting bolt and nut. Install the ground cable and torque it to **10 N·m (9 lb-ft)**.

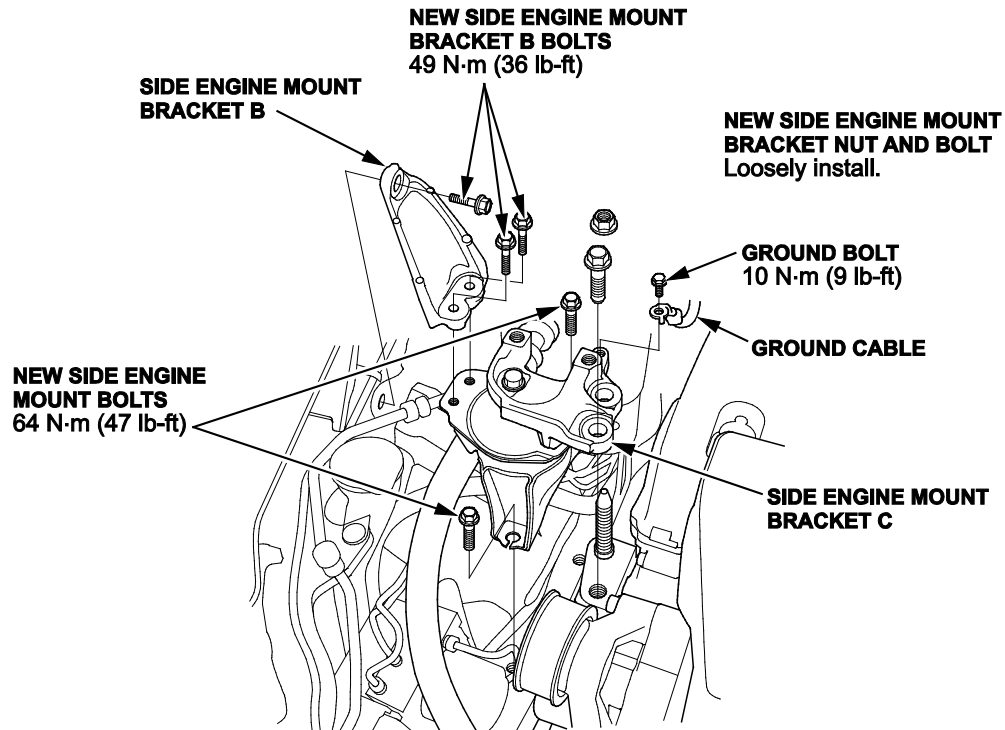

6. Remove the floor jack and wood block.
7. Loosen the transmission mount bracket nuts and bolt.

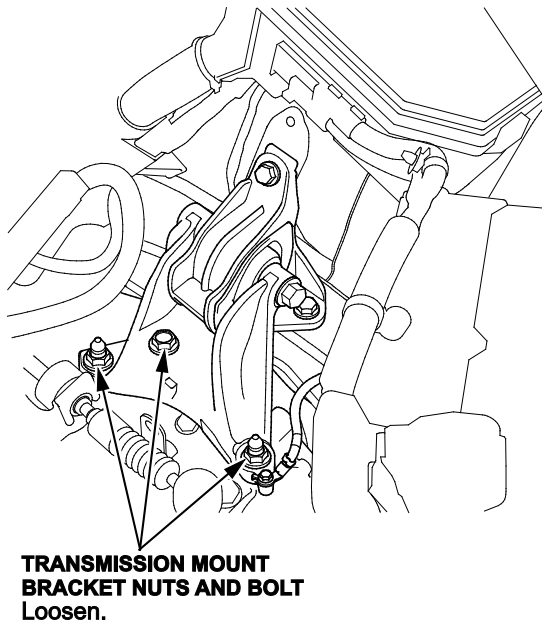

8. Raise the vehicle on a lift, and make sure it is securely supported.
9. Loosen the lower torque rod bolt.

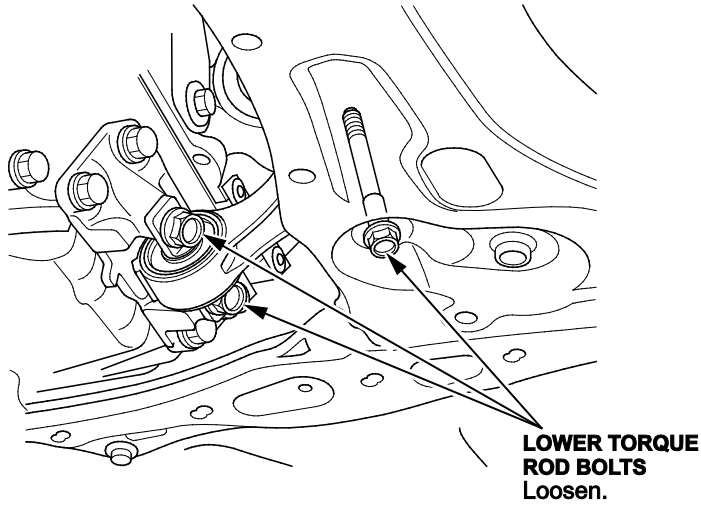

10. Torque the side engine mount bracket bolt and nut to **93 N·m (69 lb-ft)**.

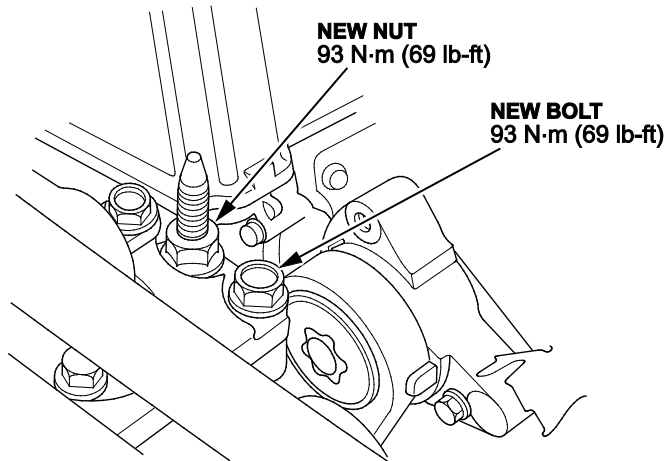

11. Torque the transmission mount bracket bolt and nuts to **83 N·m (61 lb-ft)**.

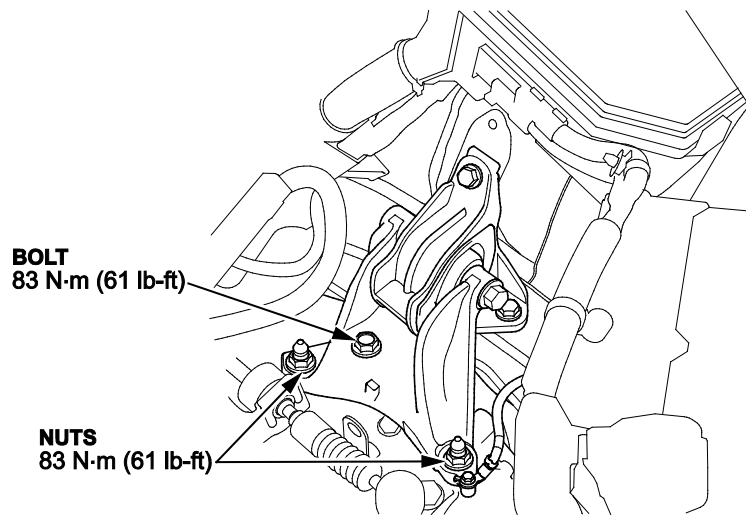

12. Loosen the two lower torque rod bolts.

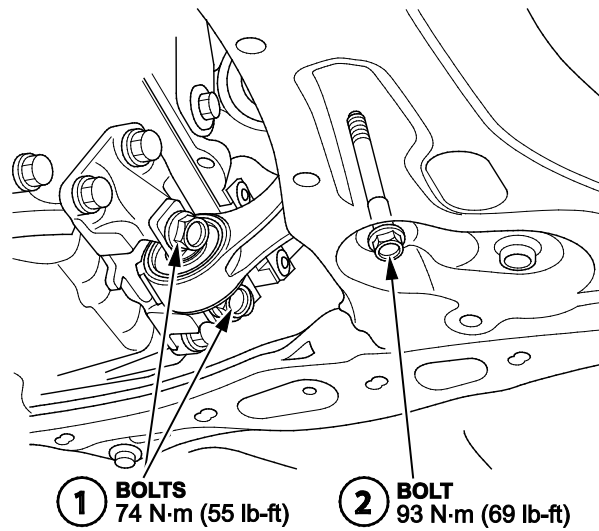

13. Torque the two lower torque rod bolts to **74 N·m (55 lb-ft)** and the longer bolt to **93 N·m (69 lb-ft)** in the numbered sequence shown.

14. Install the upper torque rod using new bolts. Torque the upper rod bolts to **64 N·m (47 lb-ft)** in the numbered sequence shown.

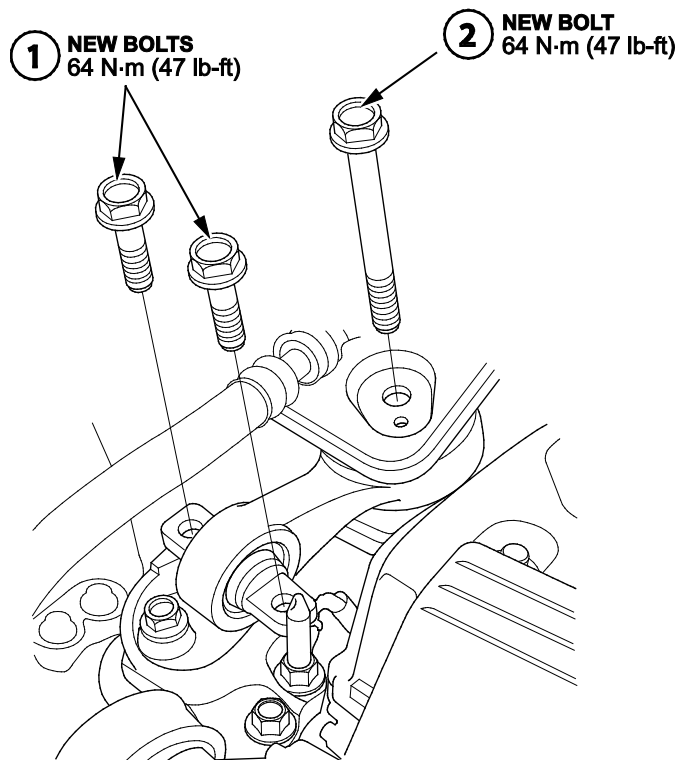

15. Install the air cleaner and torque the bolt to **10 N·m (7 lb-ft)**.

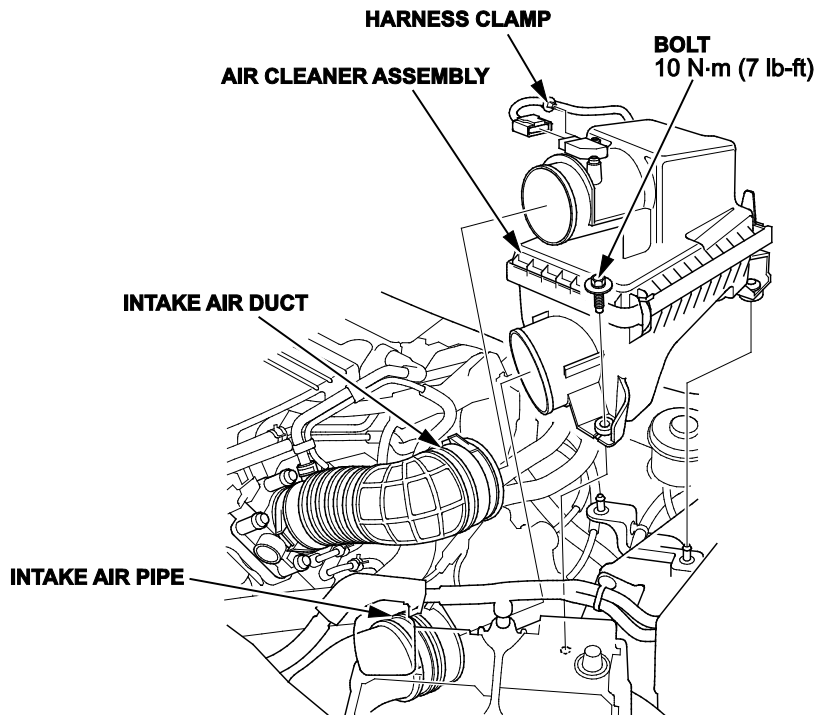

END