



Applies To: **2007–08 Fit – ALL**

January 22, 2010

A/C Switch or Rear Window Defogger Switch Does Not Work; Fuse 22 Is Blown

SYMPTOM

One or more of these symptoms are possible:

- The A/C switch button does not stay on or does not turn off.
- The rear window defogger switch button does not stay on or does not turn off.
- The indicators in the A/C or the rear window defogger switch buttons do not come on.
- The No. 22 (10 A) fuse in the under-dash fuse/relay box is blown.

PROBABLE CAUSE

The A/C and rear window defogger switch is faulty, or one or more indicator bulbs in the switch are loose.

CORRECTIVE ACTION

Replace the A/C and rear window defogger switch.

PARTS INFORMATION

A/C and Rear Window Defogger Switch:
P/N 35500-SLN-305ZA

WARRANTY CLAIM INFORMATION

The normal warranty applies.

Operation Number: 6181B1

Flat Rate Time: 0.4 hour

Failed Part: P/N 35500-SLN-A01ZC

Defect Code: 03217

Symptom Code: 03220

Skill Level: Repair Technician

REPAIR PROCEDURE

NOTE: This procedure is in an outline form that you can also use as a checklist for the repair. If you need more details, bookmark the following procedures in the *2007–2008 Fit Service Manual*, or view them online:

- Glove Box Removal/Installation
- Passenger's Dashboard Undercover Removal/Installation
- Dashboard Center Panel Removal/Installation
- Recirculation Control Cable Adjustment
- Mode Control Cable Adjustment
- Air Mix Control Cable Adjustment

1. Remove the glove box.
2. Remove the passenger's dashboard undercover.
3. Remove the dashboard center panel.

NOTE:

- Be careful not to scratch the dashboard or any other parts.
 - Do not use tools to remove the center panel.
4. Remove the A/C and rear window defogger switch from the center panel by pushing it out from the back of the panel.

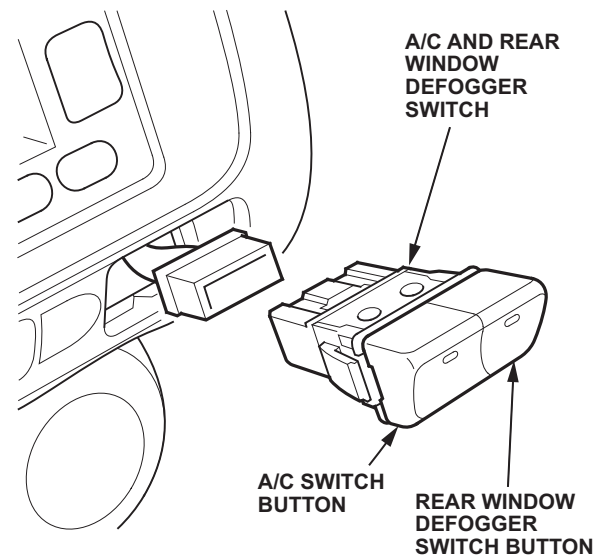

5. Install a new A/C and rear window defogger switch into the center panel by pressing it in from the front of the panel.

6. Reinstall the dashboard center panel:
 - Make sure to securely reconnect all connectors, including the 13P connector for the A/C and rear window defogger switch.
 - Replace any damaged trim clips.
 - Torque the two center panel bolts to **5 N·m (4 lb-ft)**.
 - Adjust the recirculation control cable, the mode control cable, and the air mix cable.
7. Reinstall the passenger's dashboard undercover. Replace any damaged trim clips.
8. Reinstall the glove box. Torque the two glove box bolts to **5 N·m (4 lb-ft)**.
9. Check the No. 22 fuse in the under-dash fuse/relay box. If the fuse is blown, replace it.