

 Applies To: **See VEHICLES AFFECTED**
**November 23, 2011**

## Engine Knocks or Ticks at Idle

(Supersedes 08-017, dated February 11, 2011, to revise the information marked by the black bars)

### REVISION SUMMARY

- Under VEHICLES AFFECTED, model years and VIN ranges were added
- Under PARTS INFORMATION, the applicability for the intake manifold gaskets was changed.
- Under REPAIR PROCEDURE, steps 2 thru 5 were changed.

### SYMPTOM

The engine knocks or ticks at idle. The noise is usually more noticeable when the engine is warm.

### PROBABLE CAUSE

The rocker shaft bridge has excessive clearance which causes the rocker shaft to rotate and make noise.

### VEHICLES AFFECTED

**2008–10 Accord V6 – ALL**

**2011 Accord 2-Door V6 A/T –**

From VIN 1HGCS2...BA000001 thru  
1HGCS2...BA005783

**2011 Accord 4-Door V6 M/T –**

From VIN 1HGCP3...BA000001 thru  
1HGCP3...BA005843

**2010 Accord Crosstour – ALL**

**2011 Accord Crosstour 2WD –**

From VIN 5J6TF1...BL000001 thr  
5J6TF1...BL001638

**2011 Accord Crosstour 4WD –**

From VIN 5J6TF2...BL000001 thru  
5J6TF2...BL003195

**2008–10 Odyssey EX-L/Touring – ALL**

**2011–12 Odyssey EX-L/Touring –**

From VIN 5FNRL5H..CB000001 thru  
5FNRL5H..CB021569

**2009–11 Pilot – ALL**

**2012 Pilot 2WD –**

From VIN 5FN3F3H..CB000001 thru  
5FN3F3H..CB007563

**2012 Pilot 4WD –**

From VIN 5FN3F4H..CB000001 thru  
5FN3F4H..CB001519

### CORRECTIVE ACTION

Loosen and retorque the rocker shaft bridge bolts.

### PARTS INFORMATION

Flange Bolt (Use only if a bridge bolt fails):  
P/N 95801-08060-08

Intake Manifold Cover Gasket (All):  
P/N 17146-R70-A01

Intake Manifold Gasket (Accord, Crosstour,  
'11-12 Odyssey, '09-10 Pilot 4WD, '11-12 Pilot):  
P/N 17105-RCJ-A01

Intake Manifold Gasket ('09-10 Pilot 2WD,  
'08-10 Odyssey):  
P/N 17105-RCA-A01

### WARRANTY CLAIM INFORMATION

The normal warranty applies.

Operation Number: 1100A1

Flat Rate Time: 2.7 hours

Failed Part: P/N 14632-R70-A01

Defect Code: 07405

Symptom Code: 09117

Skill Level: Repair Technician

### DIAGNOSIS

NOTE: If you are viewing this service bulletin on ISIS and the computer has sound, click the image below to hear an example of the noise.



1. Start the engine, and let it reach normal operating temperature.
2. While the engine is idling, listen for a knock or tick. Use a stethoscope to find the location of the noise.
  - If you hear knocking or ticking from either cylinder head, go to REPAIR PROCEDURE.
  - If you hear a noise coming from another location, continue with normal troubleshooting.

## REPAIR PROCEDURE

1. Remove both cylinder head covers:
  - Refer to Cylinder Head Cover Removal in Section 6 of the appropriate service manual, or
  - Online, enter keywords **COVER REM**, then select the appropriate Cylinder Head Cover Removal procedure from the list.

NOTE: To ease removal of the cylinder head cover, remove the power steering pump with its hoses connected. This allows access to the wire harness mounting bolts.

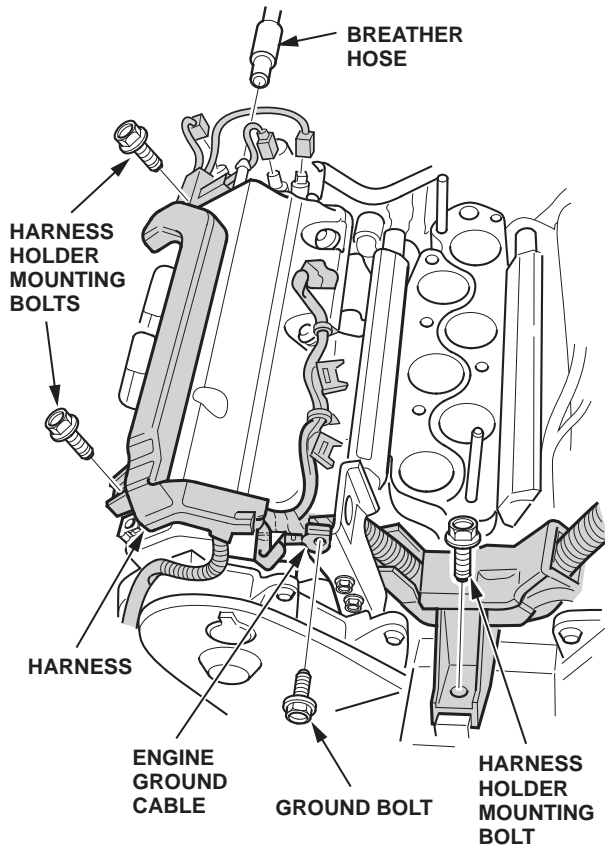

2. On the front cylinder head, loosen and then torque each rocker shaft bridge bolt one at a time in the sequence shown below. Torque the bolts to **28 N•m (21 lb-ft)** to crush the bridge around the rocker shaft.

### NOTE:

- The bridge is designed to crush around the rocker shaft, so when torquing the bolts it may initially feel like the bolt is stripped. This is normal; continue torquing bolts until the appropriate torque value is reached. Do not replace the bolt, the bridge, or the head.
- Do not over-torque the bolts. If you do, they may break and will need to be replaced.
- The bridge bolts for VCM and V-TEC engines have the same torque values and tightening sequences. Only VCM cylinder heads are shown in the illustrations.

### FRONT

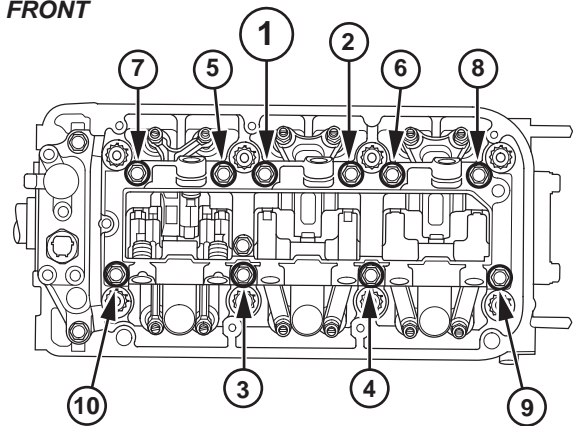

3. Loosen and then torque each rocker shaft bridge bolt again one at a time to **24.5 N•m (18 lb-ft)** in the sequence shown above for the front cylinder head.

4. On the rear cylinder head, loosen and then torque each rocker shaft bridge bolt one at a time in the sequence shown below. Torque the bolts to **28 N•m (21 lb-ft)** to crush the bridge around the rocker shaft.

**REAR**

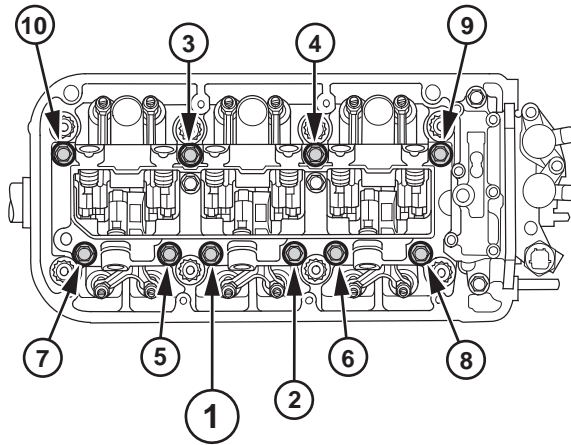

5. Loosen and then torque each rocker shaft bridge bolt again one at a time to **24.5 N•m (18 lb-ft)** in the sequence shown above for the rear cylinder head.
6. Check the valve clearances, and adjust them if needed:
  - Refer to Valve Clearance Adjustment in Section 6 of the appropriate service manual, or
  - Online, enter keywords **VALVE CLEAR**, and select the appropriate Valve Clearance Adjustment procedure from the list.
7. Reinstall the cylinder head covers:
  - Refer to Cylinder Head Cover Installation in Section 6 of the appropriate service manual, or
  - Online, enter keyword **COVER INS**, then select the appropriate Cylinder Head Cover Installation procedure from the list.
8. Reinstall all removed parts.
9. Start the engine, and let it reach normal operating temperature. Make sure the noise is gone.