

**FORD:**

2015 Edge

**LINCOLN:**

2015 MKC

This article supersedes TSB **15-0084** to add a production fix date.

**ISSUE**

Some 2015 MKC and Edge vehicles equipped with Sirius satellite radio and built on or before 7/14/2015 may exhibit an intermittent concern where the audio cuts out and the radio displays a No Signal message while driving in open sky conditions in certain locations in your area. This may be due to interference with cellular phone tower signals.

**ACTION**

Follow the Service Procedure steps to correct the condition.

**SERVICE PROCEDURE**

1. Does the Sirius satellite radio audio cut out and display a No Signal message on the radio display?
  - a. Yes - proceed to Step 2.
  - b. No - this article does not apply. Refer to Workshop Manual (WSM), Section 415-00 for normal diagnosis.
2. Does this condition occur in open sky conditions in certain locations near cellular phone towers?
  - a. Yes - proceed to Step 3.
  - b. No - this article does not apply. Refer to WSM, Section 415-00 for normal diagnosis.
3. Remove both C-pillar upper trim panels. Refer to WSM, Section 501-05.
4. Remove both rear grab handles.
5. Starting from the rear of the vehicle release the pushpins and magnets from the liftgate opening to the grab handle mounting location, to allow access to the antenna.
6. Replace the audio unit antenna.

NOTE: The information contained in Technical Service Bulletins is intended for use by trained, professional technicians with the knowledge, tools, and equipment to do the job properly and safely. It informs these technicians of conditions that may occur on some vehicles, or provides information that could assist in proper vehicle service. The procedures should not be performed by "do-it-yourselfers". Do not assume that a condition described affects your car or truck. Contact a Ford, Lincoln, or Mercury dealership to determine whether the bulletin applies to your vehicle. Warranty Policy and Extended Service Plan documentation determine Warranty and/or Extended Service Plan coverage unless stated otherwise in the TSB article. The information in this Technical Service Bulletin (TSB) was current at the time of printing. Ford Motor Company reserves the right to supersede this information with updates. The most recent information is available through Ford Motor Company's on-line technical resources.

- a. Remove the retainer and audio unit antenna and harness through the roof opening. (Figure 1)

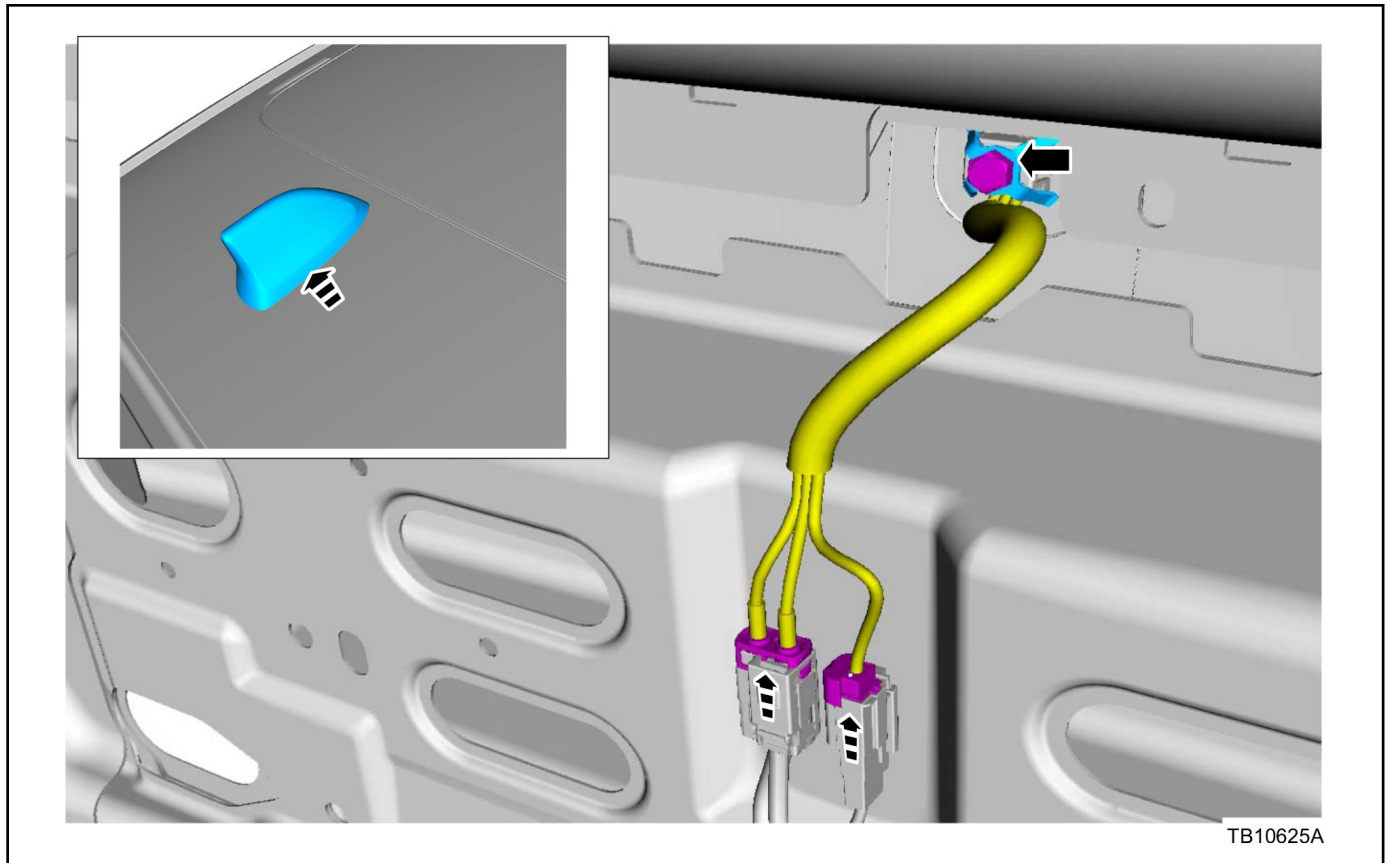

Figure 1 - Article 15-0136

- b. The new audio unit antenna must be painted to the vehicle color before installing.  
 c. Tighten the bolt to 7 Nm (62 lb-in.).  
 7. To install, reverse the removal procedure.

PART NUMBER	PART NAME
FT4Z-18936-ADPTM	Audio Unit Antenna
7831012	Right Side Rear Upper Quarter Trim Assembly - See Parts Catalog For Correct Application
7831013	Left Side Rear Upper Quarter Trim Assembly - See Parts Catalog For Correct Application
W714113-S424	Regular Retention Clip
W710338-S900	High Retention Clip

OPERATION	DESCRIPTION	TIME
150136A	2015 Edge And MKC : Diagnose And Replace Audio Unit Antenna (Can Be Claimed With Operation B) (Do Not Use With Any Operations Outside Of This Article)	1.0 Hr.
150136B	Additional Time To Paint The Audio Unit Antenna (Do Not Use With Any Operations Outside Of This Article)	1.0 Hr.

**TSB 15-0136 (Continued)**

**WARRANTY STATUS:**

Eligible Under Provisions Of New Vehicle Limited Warranty Coverage

Warranty/ESP coverage limits/policies/prior approvals are not altered by a TSB. Warranty/ESP coverage limits are determined by the identified causal part and verified using the OASIS part coverage tool.

**DEALER CODING**

<b>BASIC PART NO.</b>	<b>CONDITION CODE</b>
18936	42