

FORD:

2011-2014 F-150

This article supersedes TSB **14-0040** to update the Service Procedure and Part List.

ISSUE

Some 2011-2014 F-150 vehicles equipped with a 3.5L Gasoline Turbocharged Direct Injection (GTDI) engine may exhibit a raw fuel odor from the engine oil and/or an engine oil level indication overfull.

ACTION

Follow the Service Procedure steps to correct the condition.

SERVICE PROCEDURE

1. Determine the part level of the positive crankcase ventilation (PCV) valve by its color. Refer to Workshop Manual (WSM), Section 303-08.
 - a. If the PCV valve color is black proceed to Step 2.
 - b. If the PCV valve color is brown proceed to Step 3.
2. Replace the PCV valve. Refer to WSM, Section 303-08.
3. Change the engine oil and filter.
4. Determine the vehicle build date. Refer to WSM, Section 100-01.
 - a. If the vehicle was built on or before 10/24/2011 proceed to Step 5.
 - b. If the vehicle was built after 10/24/2011 proceed to Step 9.
5. Remove and discard the brake booster vacuum hose. (Figure 1)

NOTE: The information contained in Technical Service Bulletins is intended for use by trained, professional technicians with the knowledge, tools, and equipment to do the job properly and safely. It informs these technicians of conditions that may occur on some vehicles, or provides information that could assist in proper vehicle service. The procedures should not be performed by "do-it-yourselfers". Do not assume that a condition described affects your car or truck. Contact a Ford, Lincoln, or Mercury dealership to determine whether the bulletin applies to your vehicle. Warranty Policy and Extended Service Plan documentation determine Warranty and/or Extended Service Plan coverage unless stated otherwise in the TSB article. The information in this Technical Service Bulletin (TSB) was current at the time of printing. Ford Motor Company reserves the right to supersede this information with updates. The most recent information is available through Ford Motor Company's on-line technical resources.

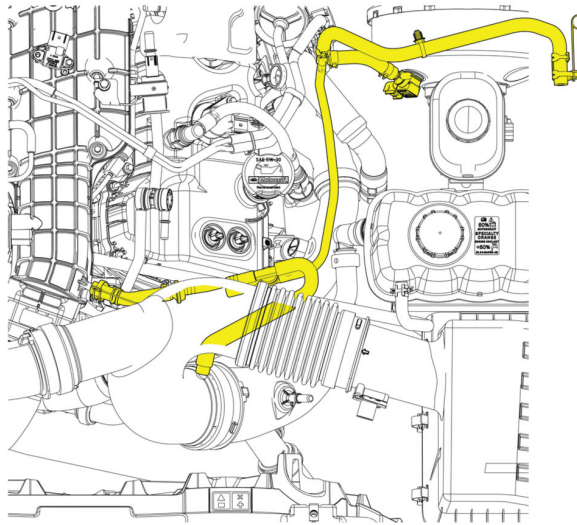

TB10513A

Figure 1 - Article 15-0003

6. Install a new brake booster vacuum hose. (Figure 2)

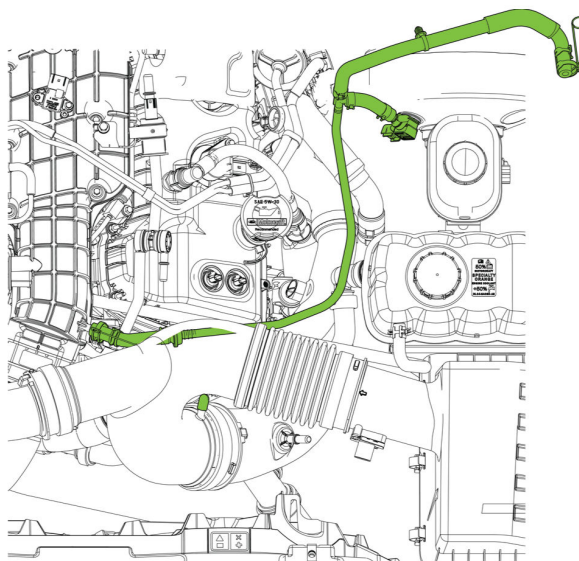

TB10514A

Figure 2 - Article 15-0003

7. Install a cap over the open port on the air cleaner outlet pipe. (Figure 2)
8. Reprogram the anti-lock brake system (ABS) module to the latest calibration using IDS release 93.02 and higher. Make sure you are connected to the internet when entering module programming to obtain the latest updates. Calibration files may also be obtained at www.motorcraftservice.com.
9. Reprogram the powertrain control module (PCM) to the latest calibration using IDS release 93.02 and higher. Make sure you are connected to the internet when entering module programming to obtain the latest updates. Calibration files may also be obtained at www.motorcraftservice.com

NOTE: ADVISE THE CUSTOMER THAT THIS VEHICLE IS EQUIPPED WITH AN ADAPTIVE TRANSMISSION SHIFT STRATEGY WHICH ALLOWS THE VEHICLE'S COMPUTER TO LEARN THE TRANSMISSION'S UNIQUE PARAMETERS AND IMPROVE SHIFT QUALITY. WHEN THE ADAPTIVE STRATEGY IS RESET, THE COMPUTER WILL BEGIN A RE-LEARNING PROCESS. THIS RE-LEARNING PROCESS MAY RESULT IN FIRMER THAN NORMAL UPSHIFTS AND DOWNSHIFTS FOR SEVERAL DAYS.

PART NUMBER	PART NAME
AA5Z-6A666-D	PCV
CL3Z-9C490-b	Vacuum Hose
W716372-S300	Vacuum Cap
FL-500S	Motorcraft® Oil Filter
XO-5W30-QSP	Motorcraft® SAE 5W-30 Premium Synthetic Blend Motor Oil

OPERATION	DESCRIPTION	TIME
150003A	2011-2014 F-150 3.5L GTDI: Inspect The PCV Valve Only, Change Engine Oil And Filter, Reprogram The PCM And ABS Module If Necessary (Do Not Use With Any Other Labor Operations)	0.8 Hr.
150003B	2011-2014 F-150 3.5L GTDI: Inspect And Replace The PCV Valve, Change Engine Oil And Filter, Reprogram The PCM And ABS Module If Necessary (Do Not Use With Any Other Labor Operations)	0.9 Hr.
150003C	2011-2014 F-150 3.5L GTDI: Inspect The PCV Valve Only, Change Engine Oil And Filter, Replace The Brake Booster Vacuum Hose And Reprogram The PCM And ABS Module If Necessary (Do Not Use With Any Other Labor Operations)	1.0 Hr.
150003D	2011-2014 F-150 3.5L GTDI: Inspect And Replace The PCV Valve, Change Engine Oil And Filter, Replace The Brake Booster Vacuum Hose And Reprogram The PCM And ABS Module If Necessary (Do Not Use With Any Other Labor Operations)	1.1 Hrs.

WARRANTY STATUS:

Eligible Under Provisions Of New Vehicle Limited Warranty Coverage

Warranty/ESP coverage limits/policies/prior approvals are not altered by a TSB. Warranty/ESP coverage limits are determined by the identified causal part and verified using the OASIS part coverage tool.

DEALER CODING

BASIC PART NO.	CONDITION CODE
6009	42