

**FORD:**

2013-2014 Escape

**ISSUE**

Some 2013-2014 Escape vehicles built on or before 9/13/2013 may exhibit loose attachment of the left or right rear door trim panel, typically near the bottom of the door. A new retaining clip is now available for service.

**ACTION**

Follow the Service Procedure steps to correct the condition.

**SERVICE PROCEDURE**

1. Is the affected rear door trim panel damaged as a result of the loose attachment?
  - a. Yes - replace the rear door trim panel. Refer to Workshop Manual (WSM), Section 501-05. Use new style retaining clips on new door panel. (Figure 1) Repair is complete.

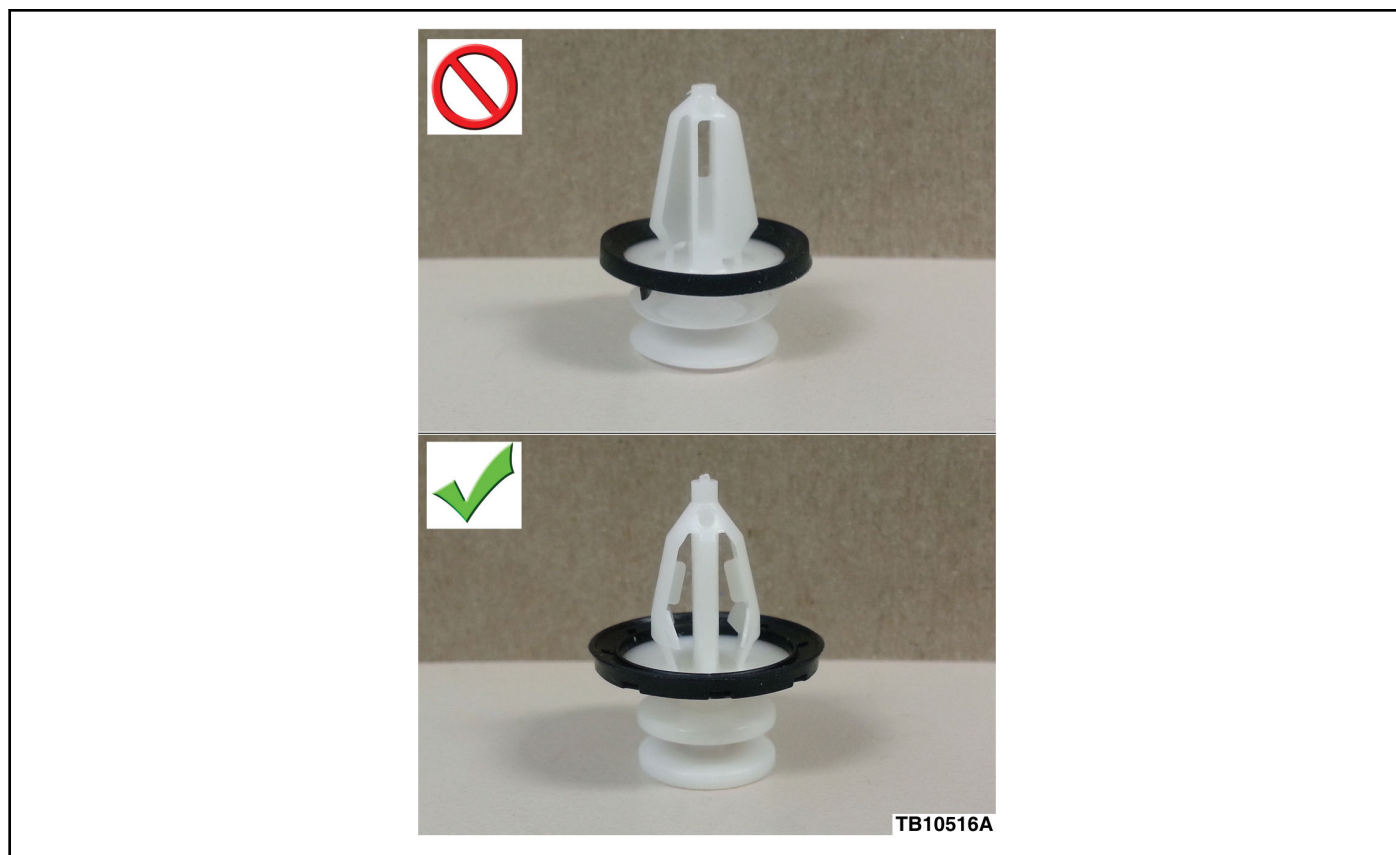

Figure 1 - Article 14-0004

- b. No - proceed to Step 2.
2. Remove the affected rear door trim panel. Refer to WSM, Section 501-05.
3. Remove the seven retaining clips from the rear door trim panel and discard.

NOTE: The information contained in Technical Service Bulletins is intended for use by trained, professional technicians with the knowledge, tools, and equipment to do the job properly and safely. It informs these technicians of conditions that may occur on some vehicles, or provides information that could assist in proper vehicle service. The procedures should not be performed by "do-it-yourselfers". Do not assume that a condition described affects your car or truck. Contact a Ford, Lincoln, or Mercury dealership to determine whether the bulletin applies to your vehicle. Warranty Policy and Extended Service Plan documentation determine Warranty and/or Extended Service Plan coverage unless stated otherwise in the TSB article. The information in this Technical Service Bulletin (TSB) was current at the time of printing. Ford Motor Company reserves the right to supersede this information with updates. The most recent information is available through Ford Motor Company's on-line technical resources.

4. Install the new retaining clips into the holes in the door trim panel.
  - a. When retaining clip is inserted in the correct position a clicking noise can be heard.
5. Install the rear door trim panel. Refer to WSM, Section 501-05.

| PART NUMBER  | PART NAME      |
|--------------|----------------|
| W713727-S300 | Retaining Clip |

| OPERATION | DESCRIPTION   | TIME    |
|-----------|---|---------|
| 140004A   | 2013-2014 Escape: Inspect And Remove One (1) Door Trim Panel Includes Time To Replace Door Trim Panel Or Retaining Clips As Necessary (Do Not Use With Any Other Labor Operations)    | 0.4 Hr. |
| 140004B   | 2013-2014 Escape: Inspect And Remove Both (2) Door Trim Panels Includes Time To Replace Door Trim Panels Or Retaining Clips As Necessary (Do Not Use With Any Other Labor Operations) | 0.6 Hr. |

**WARRANTY STATUS:**

Eligible Under Provisions Of New Vehicle Limited Warranty Coverage  
 Warranty/ESP coverage limits/policies/prior approvals are not altered by a TSB. Warranty/ESP coverage limits are determined by the identified causal part and verified using the OASIS part coverage tool.

**DEALER CODING**

| BASIC PART NO. | CONDITION CODE |
|----------------|----------------|
| 7827406        | 33             |