



NUMBER: 08-064-15

GROUP: Electrical

DATE: June 20, 2015

This bulletin is supplied as technical information only and is not an authorization for repair. No part of this publication may be reproduced, stored in a retrieval system, or transmitted, in any form or by any means, electronic, mechanical, photocopying, or otherwise, without written permission of FCA US LLC.

THIS SERVICE BULLETIN IS ALSO BEING RELEASED AS RAPID RESPONSE TRANSMITTAL (RRT) 15-070. ALL APPLICABLE SOLD AND UN-SOLD RRT VIN's HAVE BEEN LOADED. TO VERIFY THAT THIS RRT SERVICE ACTION IS APPLICABLE TO THE VEHICLE, USE VIP OR PERFORM A VIN SEARCH IN TECHCONNECT. ALL REPAIRS ARE REIMBURSABLE WITHIN THE PROVISIONS OF WARRANTY.

SUBJECT:

Roof Clearance Lamp Has Moisture Inside

OVERVIEW:

This bulletin involves inspecting the cab roof clearance lamps for moisture inside the lamp.

MODELS:

2015	(VF)	Ram Pro Master (NAFTA And Latin America)
------	------	---

NOTE: This bulletin applies to vehicles built on or after July 1, 2013 (MDH 0701XX) and on or before December 2, 2014 (MDH 1202XX) equipped with the Cab Roof Clearance Lamps (sales code LNC).

SYMPTOM/CONDITION:

The customer may describe moisture inside the front cab roof clearance lamp.

DIAGNOSIS:

If a customer's VIN is listed in VIP or your RRT VIN list, perform the repair. For all other customers that describe the symptom/condition listed above, perform the Repair Procedure.

PARTS REQUIRED:

Qty.	Part No.	Description
1-5 (AR)	68232472AB	Lamp Assy- Cab Roof Clearance & Identification / Short Harness. (H1 Low Roof)
1-5 (AR)	68232473AB	Lamp Assy- Cab Roof Clearance & Identification / Long Harness. (H2 High Roof)
6 (AR)	68073253AA	PIN, Headliner Attach (H2 High Roof)
3 (AR)	06107027AA	PUSH PIN, Absorber Attach (H2 High Roof)

INSPECTION PROCESS:

1. Visually inspect all five front cab roof clearance lamps (1) for any signs of moisture (2) inside, lamps should be dry (3) inside ([Fig. 1](#)).
2. Was moisture found in any of the five front cab roof clearance lamps?
 - a. YES >>> Continue to [Step #3](#).
 - b. NO >>> This Bulletin does not apply, use LOP (08-50-80-91) to close the active RRT.

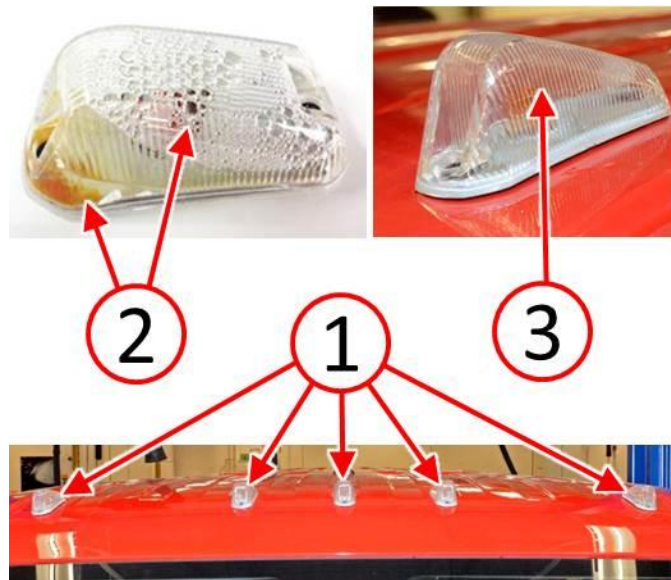

Fig. 1 Inspect Front Cab Roof Clearance Lamps For Moisture

- 1 - Front Roof Clearance Lamps
- 2 - Signs Of Moisture Inside
- 3 - Dry Inside

3. Is the vehicle an **H1 Low Roof** or **H2 High Roof** body type?
 - a. **H1 Low Roof** >>> Proceed to **REPAIR PROCEDURE - H1 LOW ROOF - LAMP REPLACEMENT: Step #1.**
 - b. **H2 High Roof** >>> Continue with **Step #4.**

NOTE: Step #4 applies to H2 High Roof vehicles only.

4. As shown in (Fig. 2), note the observed moisture level in any of the front cab clearance lamps; (1) a light foggy mist with no large water droplets, (2) large water droplets, (3) water accumulation and/or discoloration. Also inspect if any of the lamps fail to illuminate when lamps are turned on.
5. Choose the condition (a. or b.) that best represents the front cab roof clearance lamps moisture level as observed in **Step #4.**
 - a. If all five roof clearance lamps illuminate when turned on and none of the lamps have more than a light foggy mist with no large water droplets (1) as shown in (Fig. 2). Proceed to **REPAIR PROCEDURE - H2 HIGH ROOF - LAMP LENS ONLY REPLACEMENT: Step #1.**
 - b. If any of the five roof clearance lamps fail to illuminate, and/or contain large water droplets (2) and/or water accumulation and/or discoloration (3) as shown in (Fig. 2). Proceed to **REPAIR PROCEDURE - H2 HIGH ROOF - LAMP LENS AND HARNESS REPLACEMENT: Step #1.**

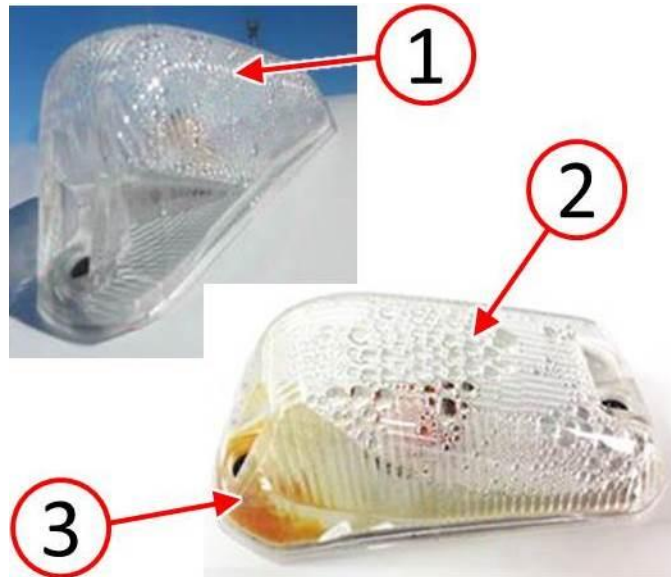

Fig. 2 Moisture Condition Examples

- 1 - Light Foggy Mist With No Large Water Droplets
 - 2 - Large Water Droplets
 - 3 - Water Accumulation And/Or Discoloration
-

REPAIR PROCEDURE - H1 LOW ROOF - LAMP REPLACEMENT:

NOTE: Perform the H1 Low Roof - Lamp Replacement procedure **ONLY** if the vehicle is the H1 Low Roof body type.

NOTE: **ONLY** lamps showing signs of moisture must be replaced. If lamp is dry and illuminates when turned on, do not replace.

1. Remove the screws (1) from the roof clearance lamp (Fig. 3).
2. Remove the roof clearance lamp (2) from the vehicle (Fig. 3).

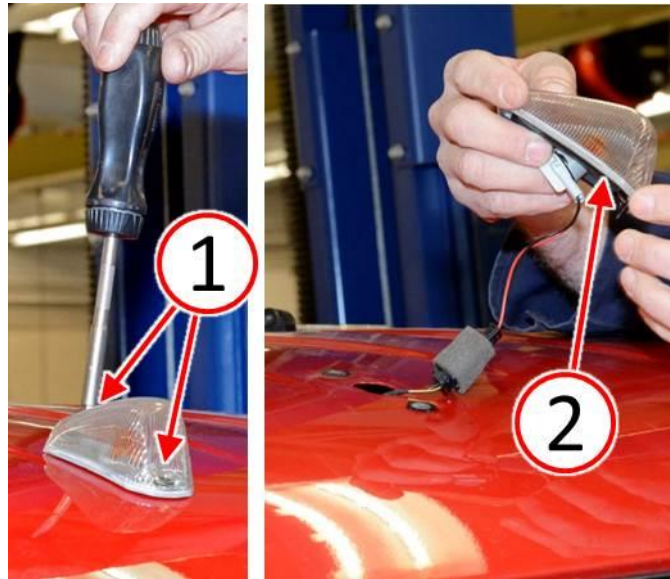

Fig. 3 Remove Roof Clearance Lamp

- 1 - Roof Clearance Lamp Screws
2 - Roof Clearance Lamp

-
3. Disconnect the electrical harness (1) from the roof clearance lamp and discard the lamp (Fig. 4).
 4. Using a plastic ink pen (2) or equivalent non-metallic object, temporally secure the wire harness connector to prevent it from falling into the roof opening while replacing the lamp assembly (Fig. 4).

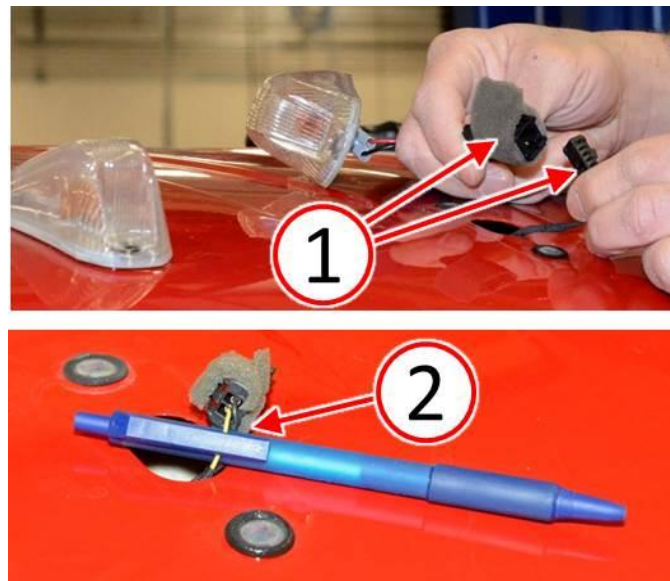

Fig. 4 Disconnect Roof Clearance Lamp

- 1 - Roof Clearance Lamp Electrical Harness
- 2 - Plastic Ink Pen Or Equivalent

5. Connect the electrical harness (1) to the NEW roof clearance lamp ([Fig. 5](#)).



Fig. 5 Connect Roof Clearance Lamp

- 1 - Roof Clearance Lamp Electrical Harness

6. Feed the electrical harness (1) into the roof opening ([Fig. 6](#)).
7. Install the roof clearance lamp (2) to the vehicle ([Fig. 6](#)).

8. Install the roof clearance lamp screws (3) and tighten to 2 N·m (18 in. lbs.) ([Fig. 6](#)).

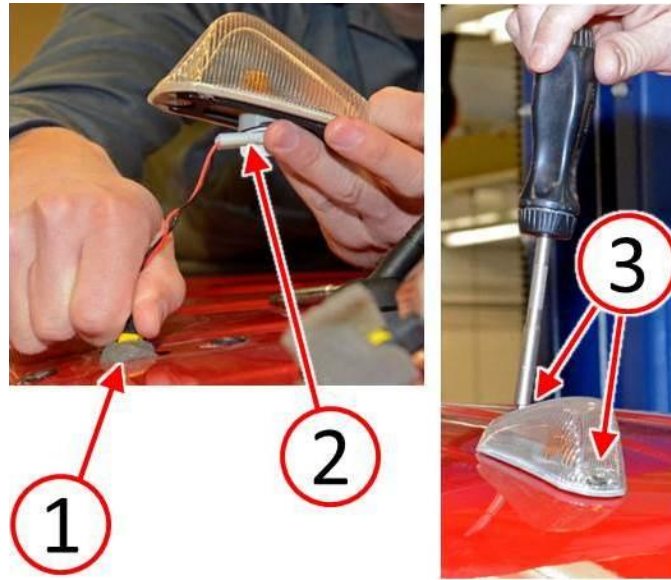

Fig. 6 Install Roof Clearance Lamp

- 1 - Roof Clearance Lamp Electrical Harness
- 2 - Roof Clearance Lamp
- 3 - Roof Clearance Lamp Screws

-
9. Repeat the H1 Low Roof - Lamp Replacement process for any front cab roof clearance lamps that show signs of moisture.
10. Test the front clearance lamps to ensure that all five lamps illuminate when lamps are turned on.
11. The H1 Low Roof front clearance lamp replacement process has been completed. Use LOP (08-50-80-92) to close the active RRT.

REPAIR PROCEDURE - H2 HIGH ROOF - LAMP LENS ONLY REPLACEMENT:

NOTE: Perform the H2 High Roof - Lamp Lens Only Replacement procedure **ONLY** if the vehicle is the H2 High Roof body type and the lamp bulb/socket is functioning properly with absolutely **NO** signs of water contamination/damage.

NOTE: **ONLY** lamps showing signs of moisture must be replaced. If lamp is dry and illuminates when turned on, do not replace.

1. Remove the screws (1) from the roof clearance lamp (Fig. 7).
2. Lift up the roof clearance lamp (2) from the vehicle (Fig. 7).

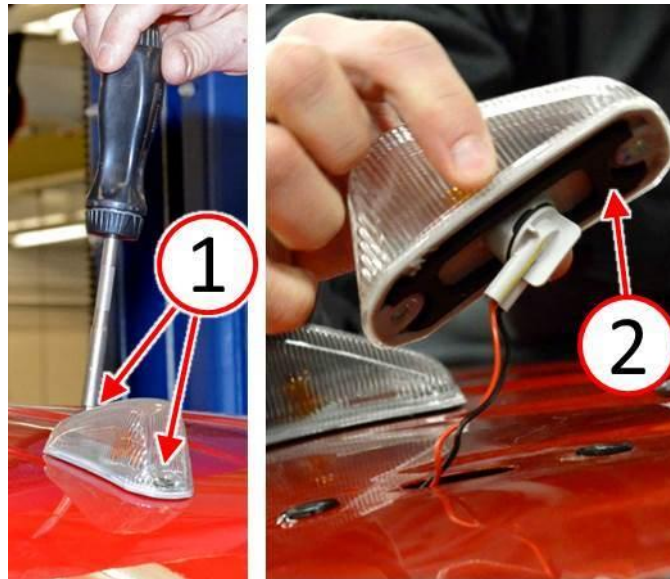

Fig. 7 Remove Roof Clearance Lamp

- 1 - Roof Clearance Lamp Screws
- 2 - Roof Clearance Lamp

NOTE: Do Not touch the lamp bulb. Touching the bulb may cause contamination resulting in early lamp failure. Bulb may also be hot.

3. Rotate the lamp bulb socket (1) 1/4 turn counter-clockwise then remove the bulb socket (1) from the lamp lens (2) (Fig. 8).
4. Discard the lamp lens (2) (Fig. 8).
5. Inspect the bulb and socket for any signs of moisture contamination.
6. Are any signs of moisture contamination visible on bulb or socket?
 - a. YES >>> STOP, do not continue lens only replacement process. Proceed directly to **H2 HIGH ROOF - LAMP LENS AND HARNESS REPLACEMENT: Step #1.**
 - b. NO >>> Continue with the repair process **Step #7.**
7. Remove and discard the bulb socket from a NEW lamp assembly.

8. Install the lamp bulb socket (1) on the vehicle roof to the NEW lamp lens (2) and rotate the bulb socket 1/4 turn clockwise to secure the bulb socket to the lens ([Fig. 8](#)).

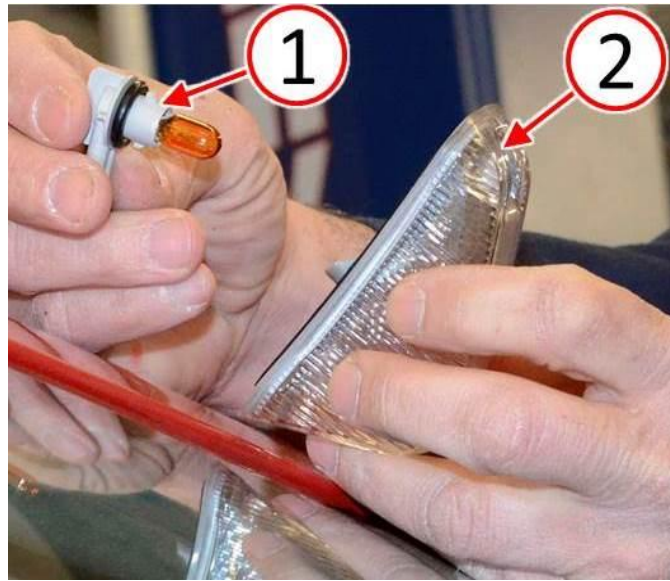

Fig. 8 Replace Roof Clearance Lamp Lens

- 1 - Roof Clearance Lamp Bulb Socket
 - 2 - Roof Clearance Lamp Lens
-

9. Install the roof clearance lamp (1) to the vehicle ([Fig. 9](#)).
10. Install the roof clearance lamp screws (2) and tighten to 2 N·m (18 in. lbs.) ([Fig. 9](#)).

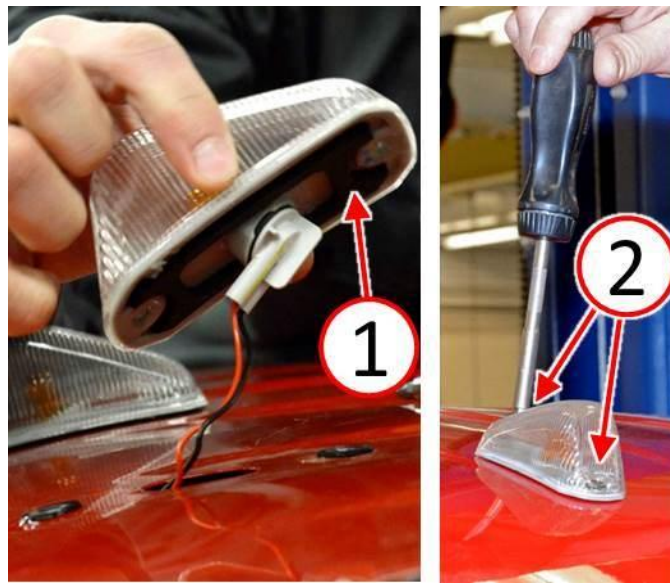

Fig. 9 Install Roof Clearance Lamp

1 - Roof Clearance Lamp

2 - Roof Clearance Lamp Screws

-
11. Repeat the H2 High Roof - Lamp Lens Only Replacement process for any front cab roof clearance lamps that show signs of moisture.
 12. Test the front clearance lamps to ensure that all five lamps illuminate when lamps are turned on.
 13. The H2 High Roof front clearance lamp lens replacement process has been completed. Use LOP (08-50-80-93) to close the active RRT.

REPAIR PROCEDURE - H2 HIGH ROOF - LAMP LENS AND HARNESS REPLACEMENT:

NOTE: Perform the H2 High Roof - Lamp Lens Only Replacement procedure **ONLY** if the vehicle is the H2 High Roof body type and lamp bulb/socket shows any signs of water contamination/damage.

NOTE: **ONLY** lamps showing signs of moisture must be replaced. If lamp is dry and illuminates when turned on, do not replace.

1. Remove the push pins (1) from the left side roof absorber ([Fig. 10](#)).
2. Remove the left side roof absorber (2) from the vehicle ([Fig. 10](#)).

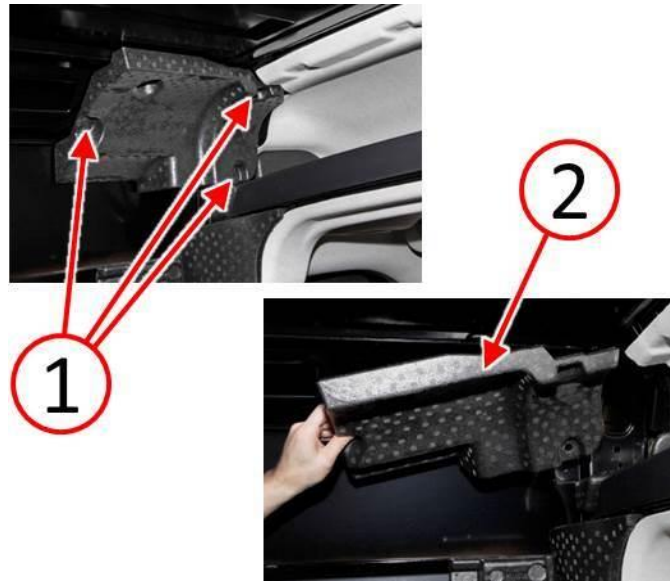

Fig. 10 Remove Roof Absorber

1 - Push Pins

2 - Roof Absorber

-
3. Remove the push pins (1) from the upper compartment roof liner ([Fig. 11](#)).



Fig. 11 Remove Push Pins From Upper Compartment Roof Liner

1 - Push Pins

-
4. Remove the left side roof absorber (1) from the upper compartment ([Fig. 12](#)).
 5. Remove the right side roof absorber (2) from the upper compartment ([Fig. 12](#)).

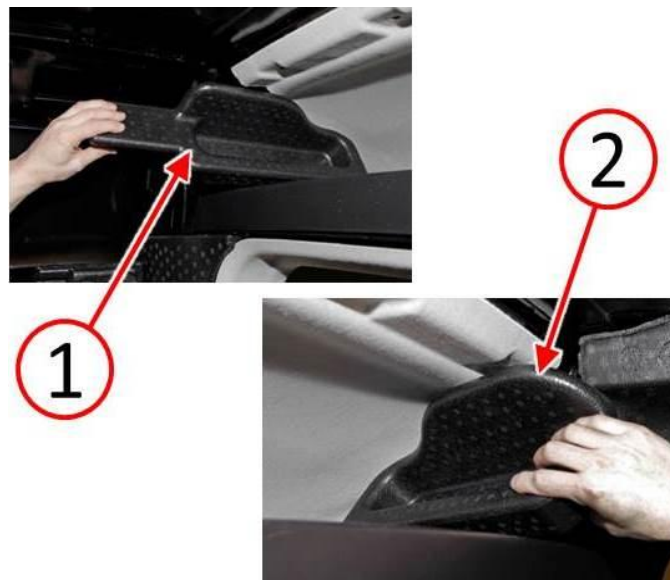

Fig. 12 Remove Roof Absorbers

1 - Left Side Upper Compartment Roof Absorber
2 - Right Side Upper Compartment Roof Absorber

6. Lower the upper compartment roof liner (1) to access the roof lamp wire harness (Fig. 13).
7. Disconnect the electrical harness connector (3) from any front roof clearance lamps (2) that require replacement (Fig. 13).

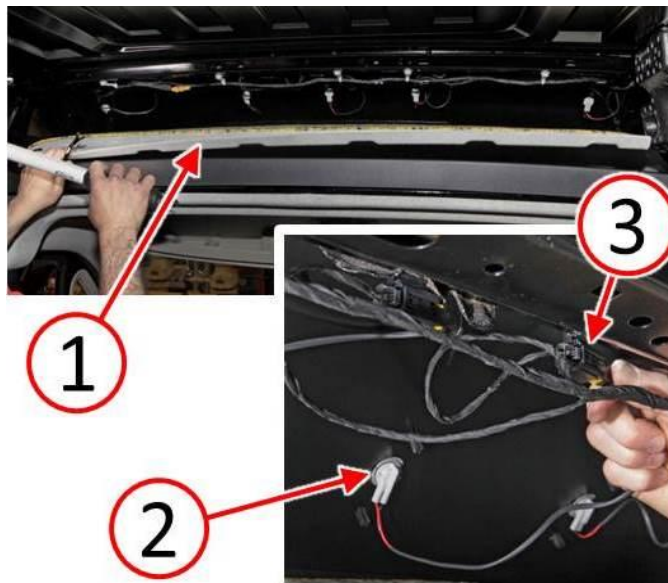

Fig. 13 Roof Clearance Lamp Wire Harness

- 1 - Upper Compartment Roof Liner
- 2 - Front Roof Clearance Lamp
- 3 - Lamp Electrical Harness Connector

-
8. Remove the screws (1) from the roof clearance lamp (Fig. 14).
 9. Remove the roof clearance lamp (2) from the vehicle and discard the lamp (Fig. 14).

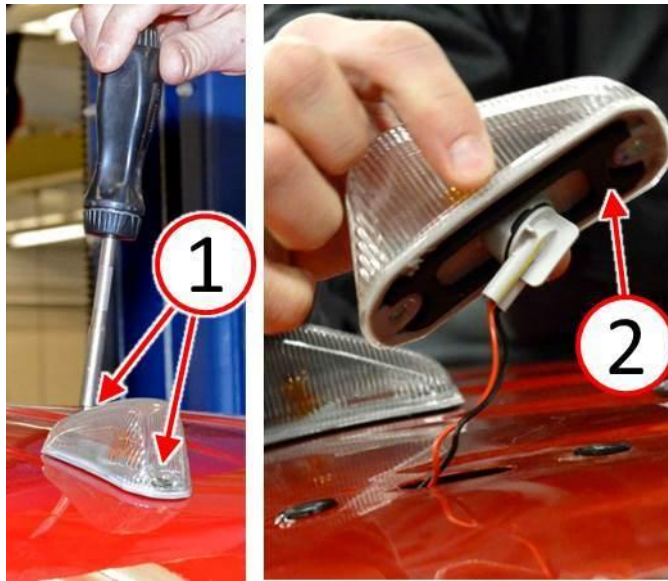

Fig. 14 Remove Roof Clearance Lamp

1 - Roof Clearance Lamp Screws

2 - Roof Clearance Lamp

10. Install the NEW roof clearance lamp (1) to the vehicle ([Fig. 15](#)).

11. Install the roof clearance lamp screws (2) and tighten to 2 N·m (18 in. lbs.) ([Fig. 15](#)).



Fig. 15 Install Roof Clearance Lamp

1 - Roof Clearance Lamp

2 - Roof Clearance Lamp Screws

12. Repeat the H2 High Roof - Lamp Lens And Harness Replacement process for any front cab roof clearance lamps that show signs of moisture.
13. Connect the electrical harness connector (3) to any front roof clearance lamps (2) that were replaced (Fig. 16).
14. Test the front clearance lamps to ensure that all five lamps illuminate when lamps are turned on.
15. Raise the upper compartment roof liner (1) back to normal installed position (Fig. 16).

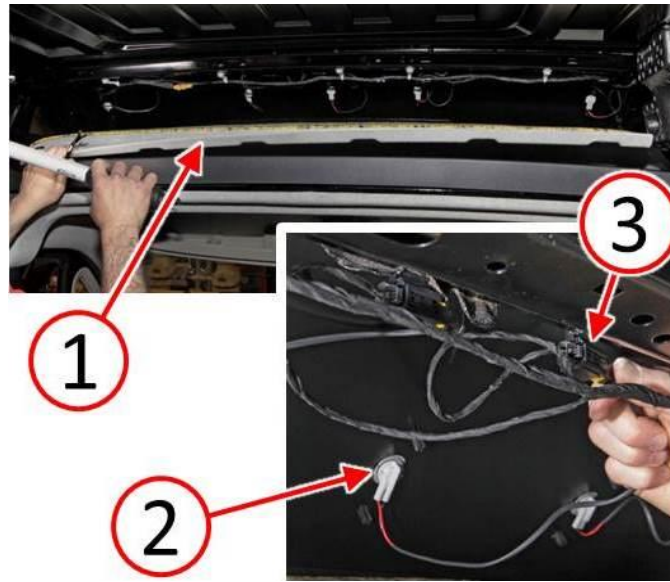

Fig. 16 Roof Clearance Lamp Wire Harness

- 1 - Upper Compartment Roof Liner
- 2 - Front Roof Clearance Lamp
- 3 - Lamp Electrical Harness Connector

-
16. Install the left side roof absorber (1) to the upper compartment
 17. Install the right side roof absorber (2) to the upper compartment

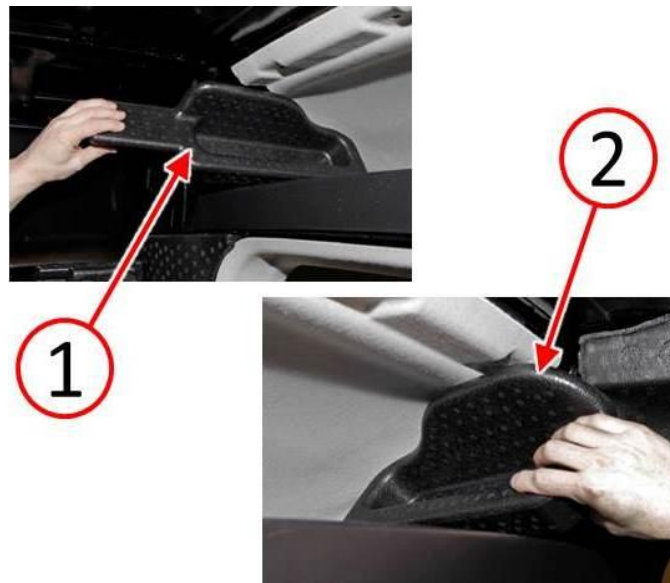

Fig. 17 Install Roof Absorbers

- 1 - Left Side Upper Compartment Roof Absorber
- 2 - Right Side Upper Compartment Roof Absorber

18. Install the push pins (1) to the upper compartment roof liner ([Fig. 18](#)).



Fig. 18 Install Push Pins To Upper Compartment Roof Liner

- 1 - Push Pins

19. Install the left side roof absorber (1) to the vehicle ([Fig. 19](#)).
20. Install the push pins (1) to the left side roof absorber ([Fig. 19](#)).

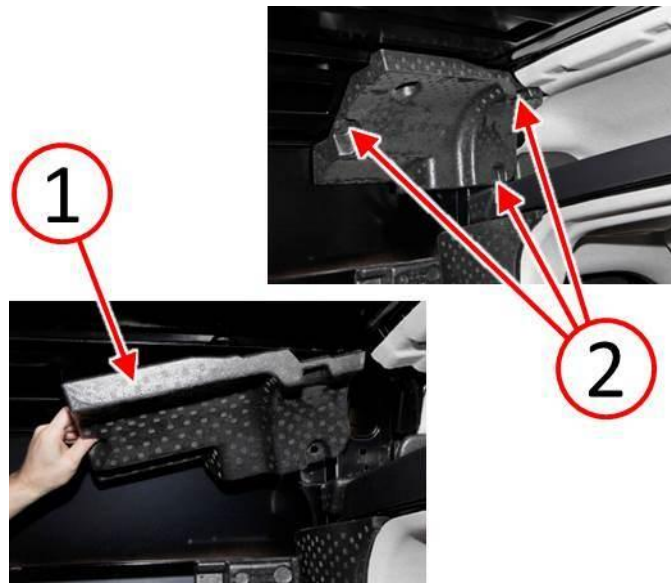

Fig. 19 Install Roof Absorber

1 - Roof Absorber

2 - Push Pins

21. The H2 High Roof front clearance lamp replacement process has been completed.
Use LOP (08-50-80-94) to close the active RRT.

POLICY:

Reimbursable within the provisions of the warranty.

TIME ALLOWANCE:

Labor Operation No:	Description	Skill Category	Amount
08-50-80-91	Lamps, Cabin Roof Clearance (H1 or H2) - Inspect for Moisture (0 - Introductory)	6 - Electrical and Body Systems	0.2 Hrs.
08-50-80-92	Lamps, Cabin Roof Clearance (H1 Only) - Inspect and Replace 1-5 Lamp Assemblies (0 - Introductory)	6 - Electrical and Body Systems	0.3 Hrs.
08-50-80-93	Lamps, Cabin Roof Clearance (H2 Only) - Inspect and Replace 1-5 Lamp Lenses (0 - Introductory)	6 - Electrical and Body Systems	0.2 Hrs.
08-50-80-94	Lamps, Cabin Roof Clearance (H2 Only) - Inspect and Replace 1-5 Lamp Assemblies (0 - Introductory)	6 - Electrical and Body Systems	0.6 Hrs.

FAILURE CODE:

ZZ	Service Action
----	----------------