



**NUMBER:** 06-006-07

**GROUP:** Clutch

**DATE:** December 5, 2007

*This bulletin is supplied as technical information only and is not an authorization for repair. No part of this publication may be reproduced, stored in a retrieval system, or transmitted, in any form or by any means, electronic, mechanical, photocopying, or otherwise, without written permission of Chrysler LLC.*

**THIS BULLETIN SUPERSEDES TECHNICAL SERVICE BULLETIN 06-001-06, DATED OCTOBER 17, 2006, WHICH SHOULD BE REMOVED FROM YOUR FILES. ALL REVISIONS ARE HIGHLIGHTED WITH **\*\*ASTERISKS\*\*** AND INCLUDES THE ADDITION OF CLEAN POINTS.**

**SUBJECT:**

Clutch Pedal Squeak

**OVERVIEW:**

This bulletin involves lubricating the clutch master cylinder pushrod ball socket (attachment at clutch pedal arm).

**MODELS:**

2007	(JS)	Sebring
2007	(PM)	Caliber
2007	(MK49)	Compass

**NOTE: \*\*This information applies to models equipped with a T-355 or BG6 Manual Transmission (Sales Code DD7 or DEF) built prior to February 8, 2007 (MDH0208XX)\*\*.**

**SYMPTOM/CONDITION:**

A squeak sound may be heard when applying or releasing the clutch pedal. This may be more noticeable in cold temperatures.

**DIAGNOSIS:**

If the customer describes a squeak sound when applying the clutch pedal, perform the Repair Procedure

**PARTS REQUIRED:**

Qty.	Part No.	Description
1	05019061AA	Grease, Silicone Based (MS7751) 1 tube will service 20 vehicles

**REPAIR PROCEDURE:**

1. Remove the lower instrument panel bezel.
2. Disconnect clutch master cylinder pushrod from clutch pedal arm ([Fig. 1](#)).

3. Lubricate the pushrod ball socket with a small amount of Silicone Grease pn 05019061AA.

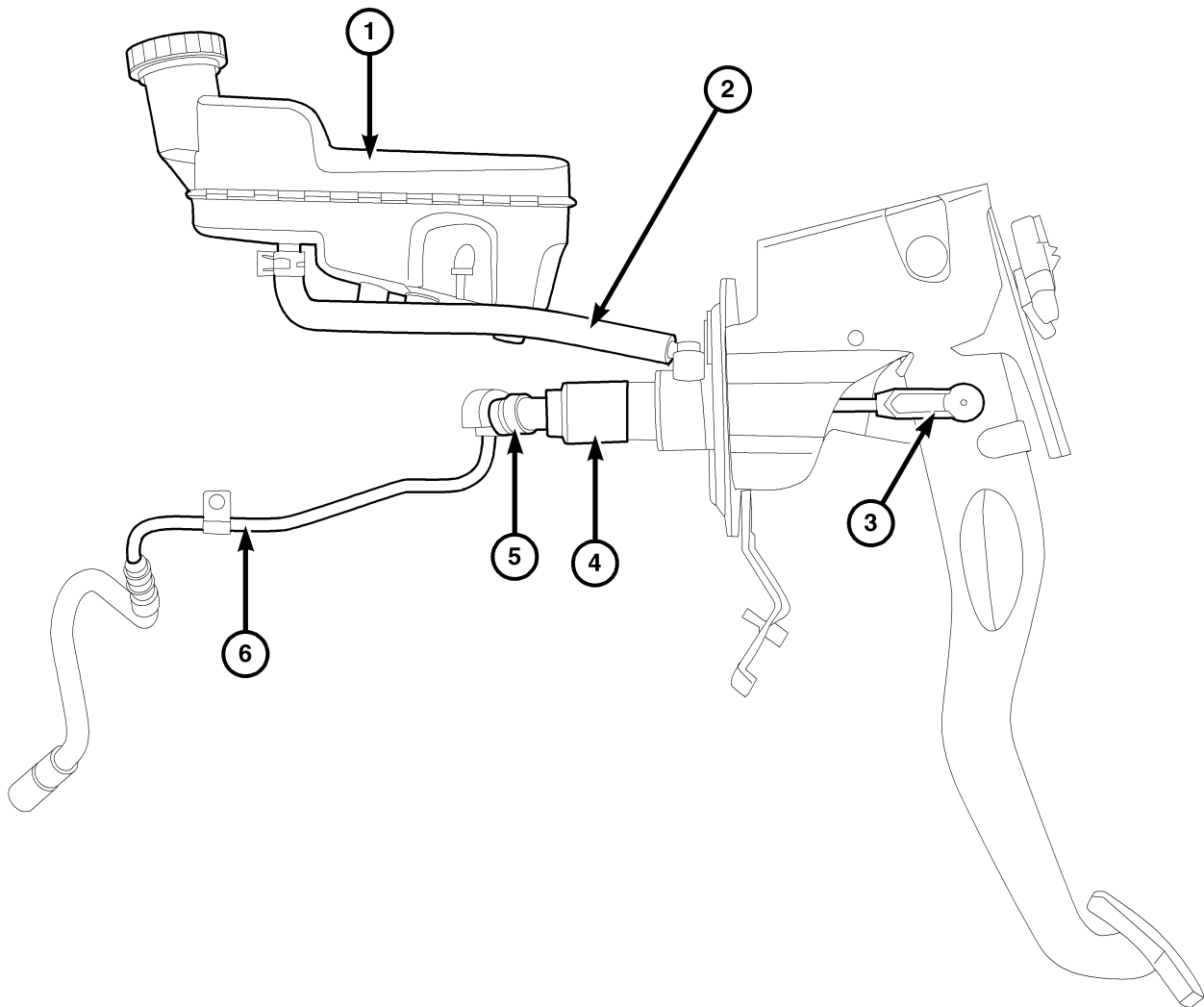

81a7d042

**Fig. 1 MASTER CYLINDER**

3 - Push Rod Ball Socket Attached to Clutch Pedal Arm

- 
4. Connect clutch master cylinder rod to clutch pedal pin. An audible “click” should be heard.
  5. Install lower instrument panel bezel.

**POLICY:**

Reimbursable within the provisions of the warranty.

**TIME ALLOWANCE:**

<b>Labor Operation No:</b>	<b>Description</b>	<b>Amount</b>
06-45-01-90	Pedal, Clutch - Lubricate (B)	0.2
	<b>Optional Equipment</b>	
06-45-01-61	PM/MK49 Models - Airbag Knee Blocker Equipped-Remove and Install	0.3

**FAILURE CODE:**

ZZ	Service Action
----	----------------