

52 25 350 Remove and install support, rear console

Overview of Activities

Additional Information

Preliminary Work

- 1 Remove the two seat surfaces
- 2 Remove both rear seats
- 3 Remove fresh air grille in rear passenger compartm...
- 4 Removing the control panel of the rear passenger com...
- 5 Removing the cup holder in the rear console
- 6 Removing the DVD player
- 7 Removing the top rear console

Main Work

- 8 Remove rear console
- 9 Install rear console

Postprocesses

- 10 Installing the rear console at the top
- 11 Installing the DVD player
- 12 Installing the cup holder in the rear console
- 13 Installing the control panel of the rear passenger compa...
- 14 Installing the fresh air grille in the rear passenger compartment
- 15 Installing both rear seats
- 16 Installing both seat surfaces

General information

PRELIMINARY WORK

1-Remove the two seat surfaces

NOTICE

Description is for left component only. Procedure on the right side is identical.

◀ Removing the seat surface

RISK OF DAMAGE

Damage to the seat belt.

If the seat surface is disassembled, the seat belt can be damaged by the seat mechanism.

- Do not operate the seat adjustment mechanism with the seat surface disassembled (unless otherwise indicated).



- Move seat angle all the way to the top.
- Set forward/back seat adjustment to maximum forward position.
- Unclip seat surface from latch mechanism from above.

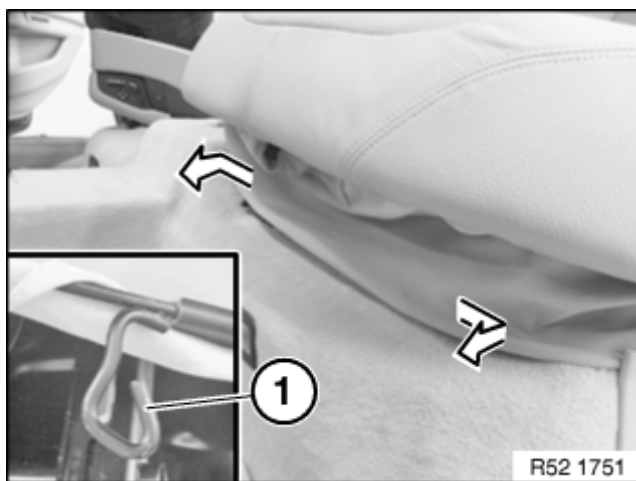

- First lever out the wire spring clip (1) to the outside (door side) in direction of arrow out of the seat mechanism.
- Then lever out the wire spring clip (1) to the inside (tunnel side) in direction of arrow out of the seat mechanism.
- Remove seat surface toward the top and disconnect all associated plug connections.

• Equipment specification with active seat:

Fold the seat surface (1) upwards.

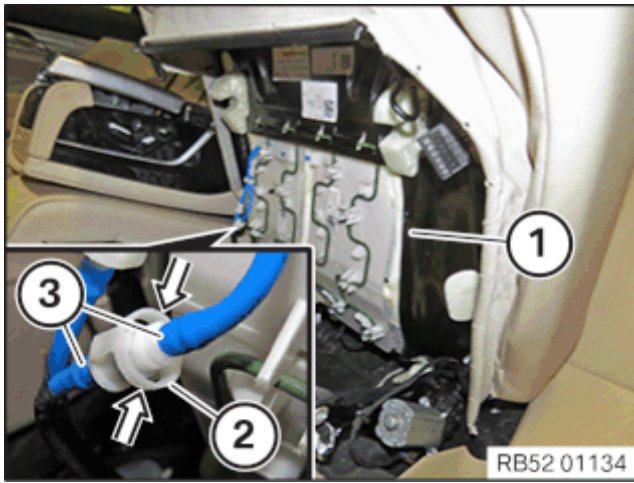

Press together the coupling (2) at the marked points and pull apart the lines (3) by gently moving them up and down.



2-Remove both rear seats

NOTICE

Description is for left component only. Procedure on the right side is identical.

◀ Removing the seat

Prerequisite

Fully move the rear seat backrest forwards.

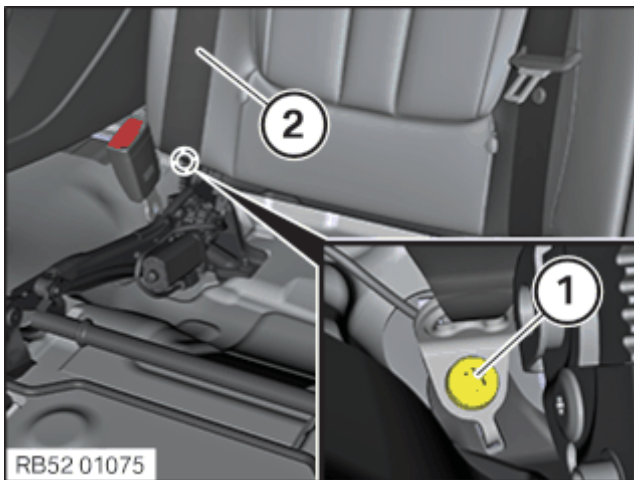

- Loosen screw (1).
- Guide out seat belt (2) and put to one side at top.

- Loosen nuts (1) to (4).

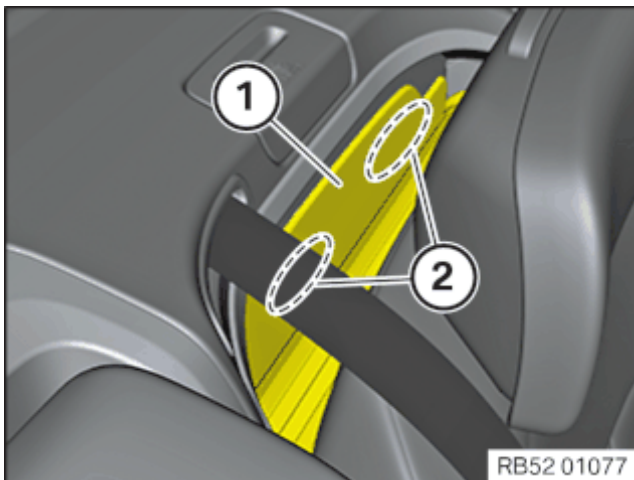
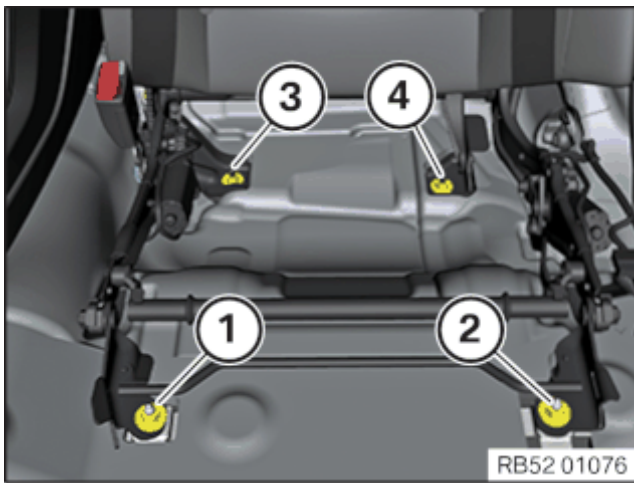

- Loosen cover (1) in the area (2) toward the inside of Velcro fastener.
- Detach cover (1) toward the top from the seat mechanism.

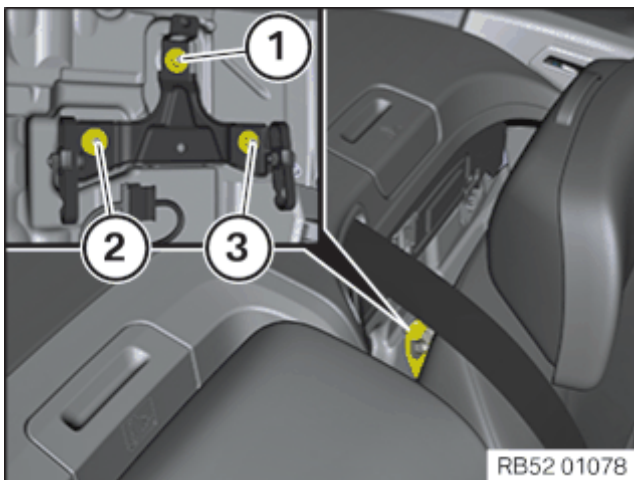

- Loosen nuts (1) to (3).

- Fold seat forward slightly.
- Unlock plug connections and disconnect.

RISK OF DAMAGE

Scratches.

Tools and sharp-edged components can cause scratches.

- Protect working area.
- Handle tools and components carefully.

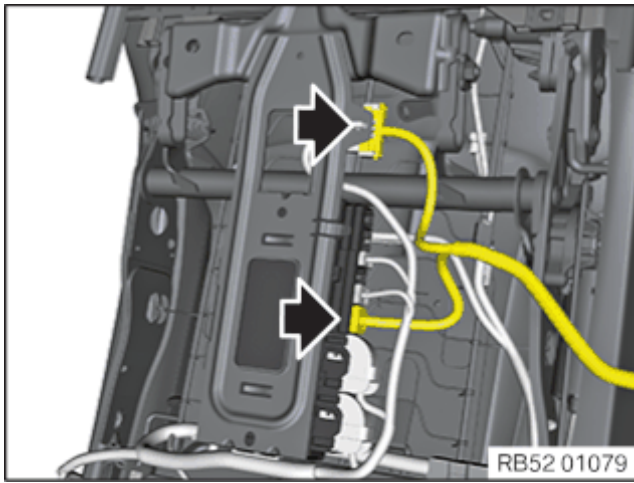

- Lift seat out.



3–Remove fresh air grille in rear passenger compartment



- Unclip the fresh air grille (1) using special tool 0 496 571 (00 9 327).
- Disconnect the associated connector and remove the fresh air grille (1).

4–Removing the control panel of the rear passenger compartment air conditioning

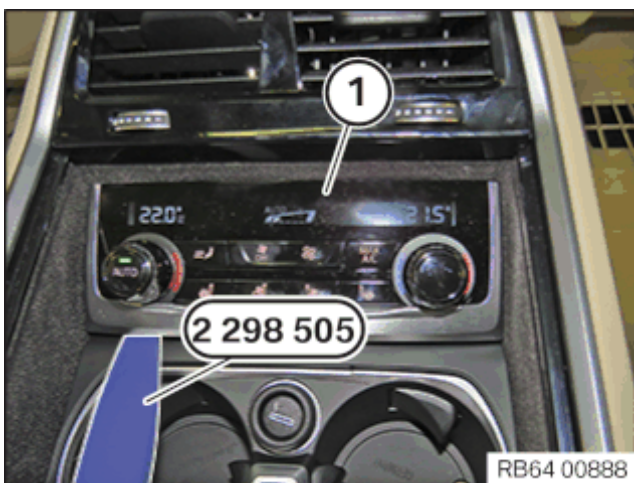

- Unclip the control panel (1) using special tool 2 298 505.
- Disconnect the associated connector and remove the control panel (1).

5–Removing the cup holder in the rear console

- Remove covers (1) upwards.

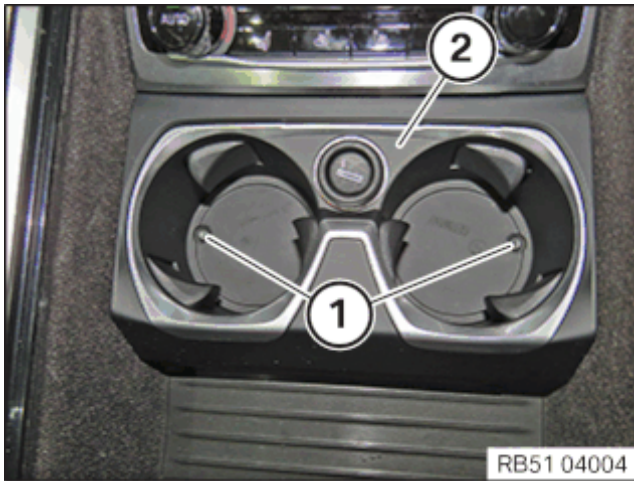

- Loosen screws (1).
- Remove the cup holder (2) towards the top and disconnect the associated connector.

6-Removing the DVD player

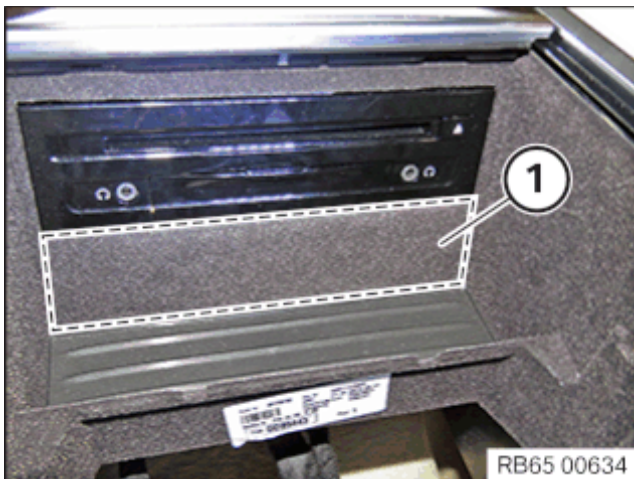

- Disengage the cover (1).

- Loosen the screws (1) and pull out the DVD player (2).

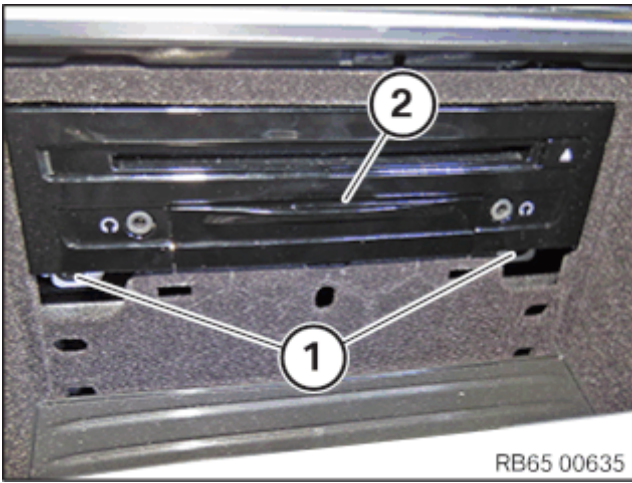

- Unlock and disconnect connector (1).
- Remove the DVD player (2).

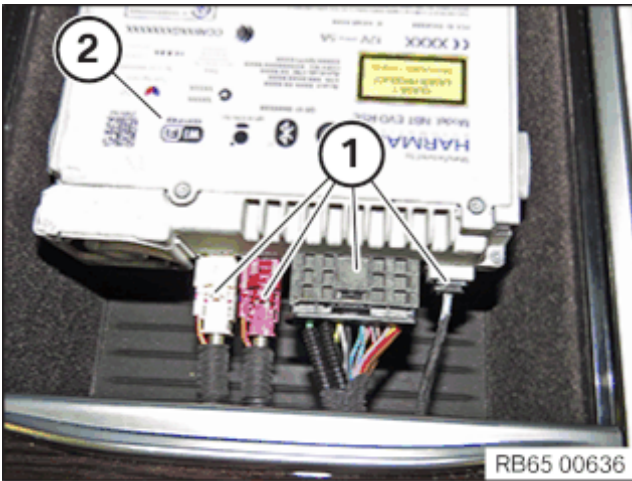

7-Removing the top rear console

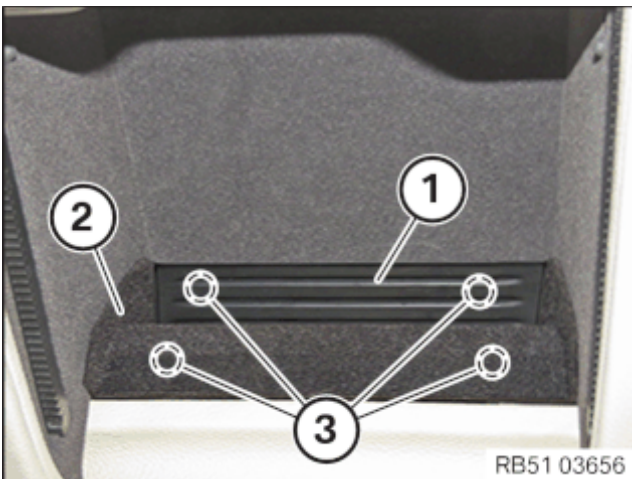

- Remove the insert (1).
- Unclip the trim (2) from the clamps towards the top in this area (3).

- Unlock plug connection (1) and disconnect.
- Loosen the nuts (2) on the left and right.

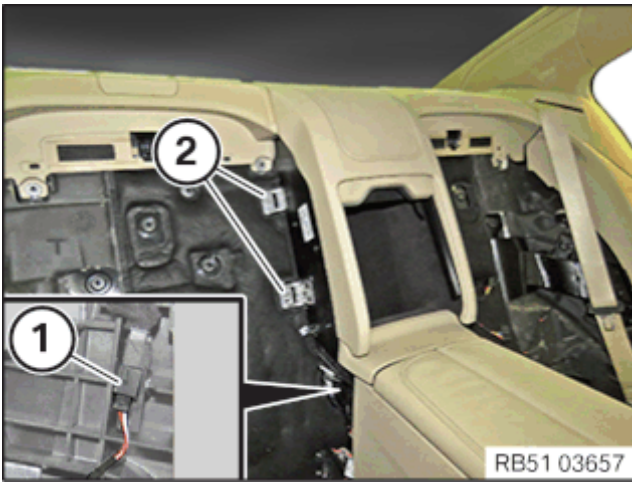

- Loosen the rear console (1) from the clamps towards the top in this area (2).

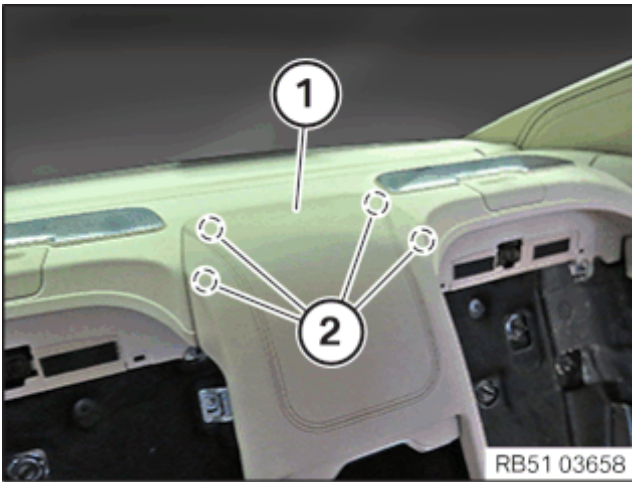

MAIN WORK

8-Remove rear console



- Remove the insert (1).
- Lever out the cover (2).

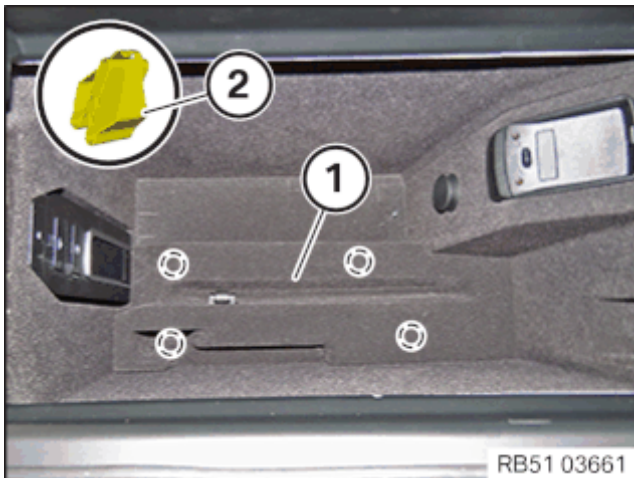

- Unclip the trim (1) from the clamps (2) towards the top.

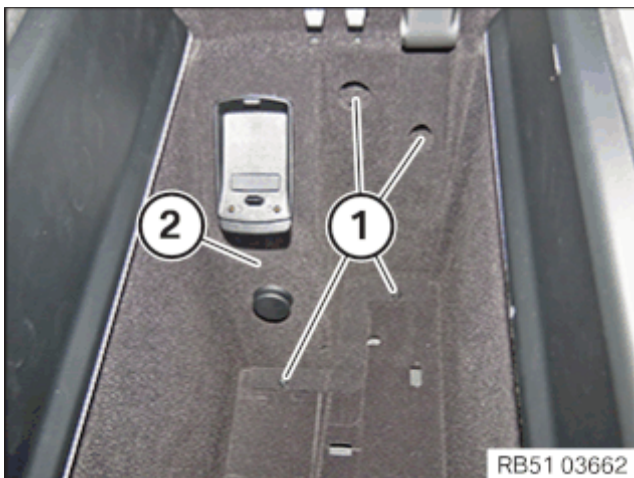

- Loosen screws (1).
- Unclip the trim (2) towards the inside and disconnect the associated plug connections.

- Unclip the trim (1) from the clamps (2) towards the rear.

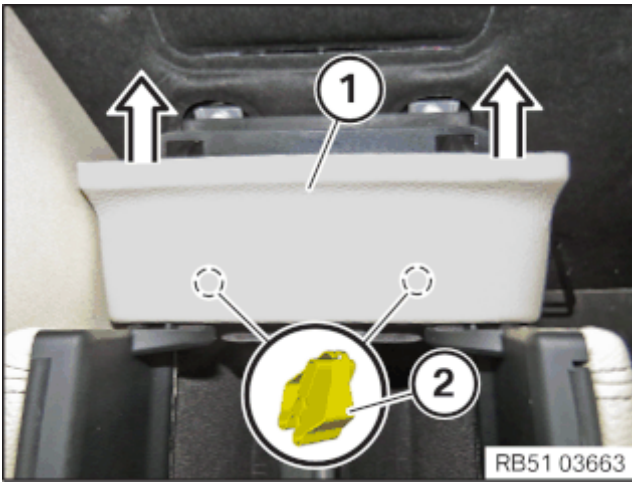

- Loosen screws (1).

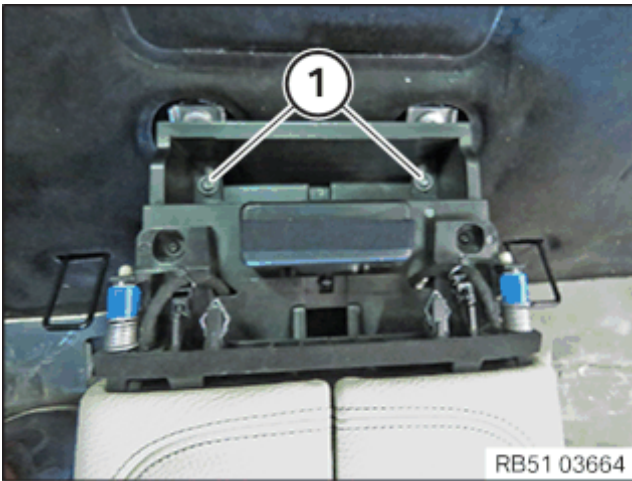

- Unlock and disconnect the plug connections (1) on the left side.
- Unlock and disconnect the plug connections (2) on the right side.

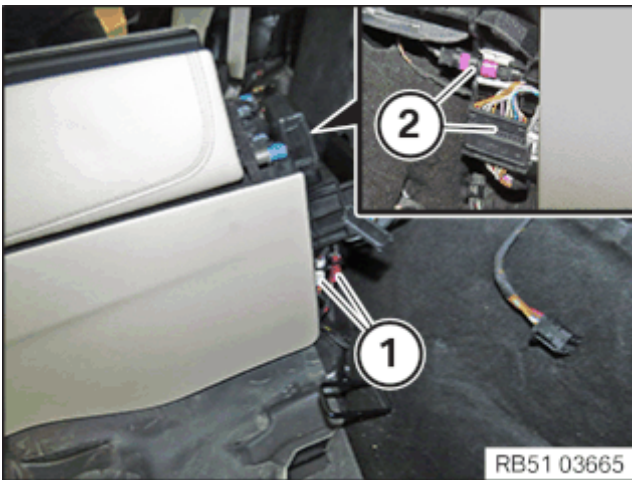

- Loosen screws (1).



- Loosen screws (1).

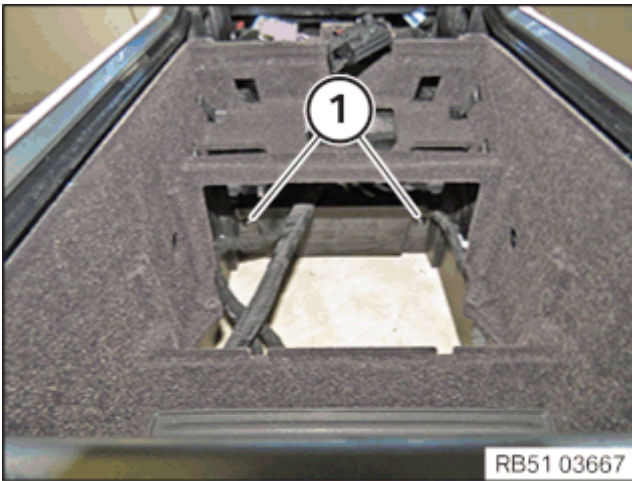

- Loosen the wiring harness on all cable clips and feed back in.

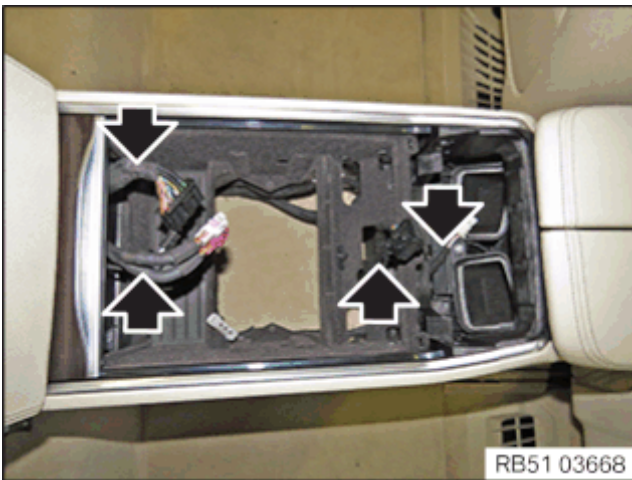

- Loosen left and right screw (1).
- Slightly lift the rear console (2) at the rear.
If necessary, unlock and disconnect additional plug connections.
- Remove the rear console (2) with an additional person.

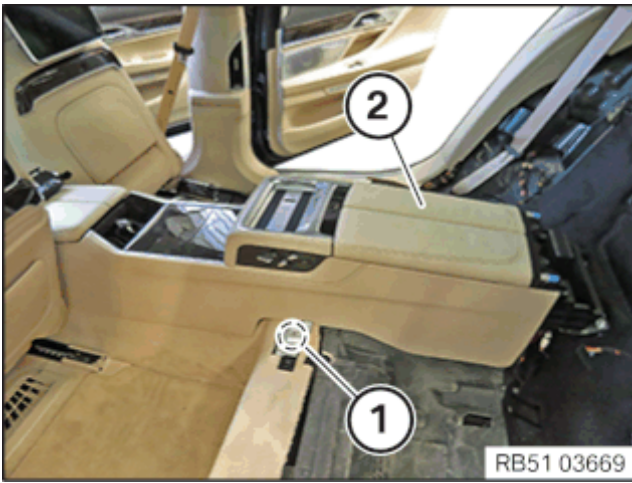

9-Install rear console

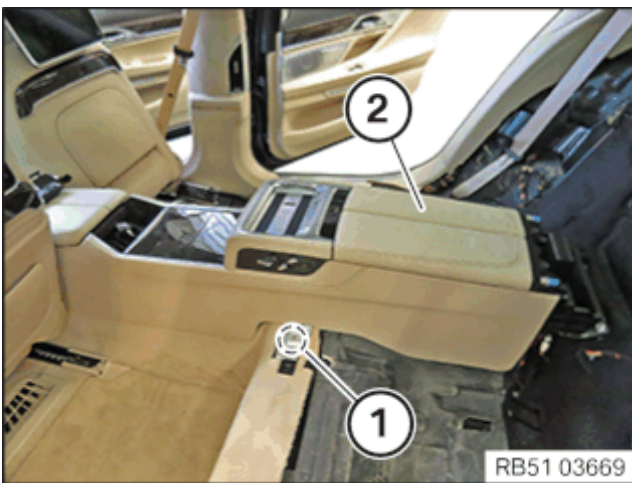

- Insert the rear console (2) with an additional person.
- Slightly lift the rear console (2) at the rear.
If required, connect relevant connector.
- Tighten the screw (1) on the left and right.

Rear console to body



4,6 Nm

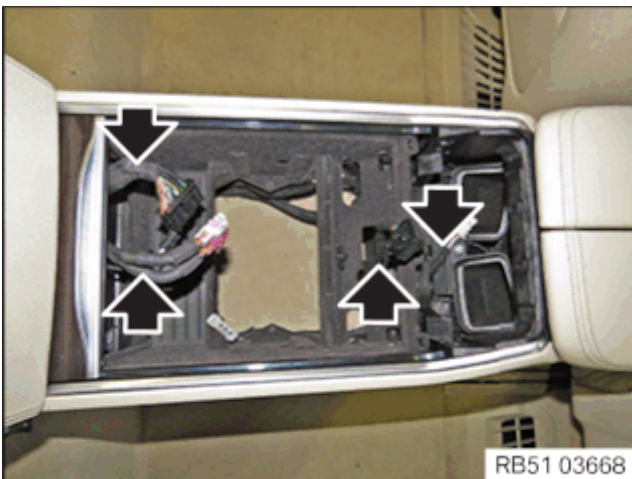

- Insert the wiring harness and secure to all cable clips.

- Tighten the screws (1).

Rear console to centre console



2,3 Nm

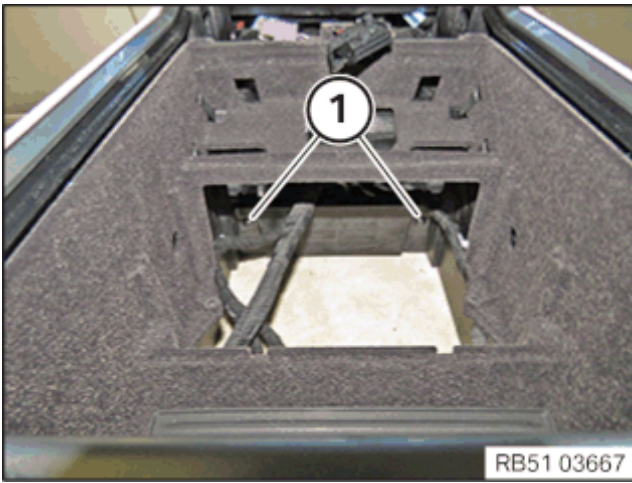

RB51 03667

- Tighten the screws (1).

Rear console to centre console



2,3 Nm

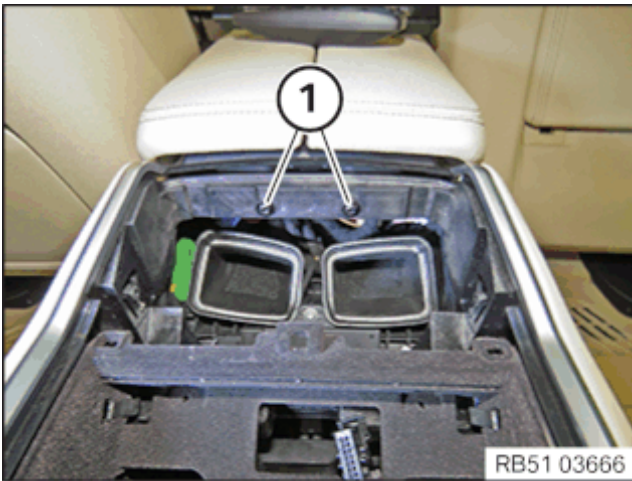

RB51 03666

- Connect the connector (1) to the left-hand side.
- Connect the connector (2) to the right-hand side.

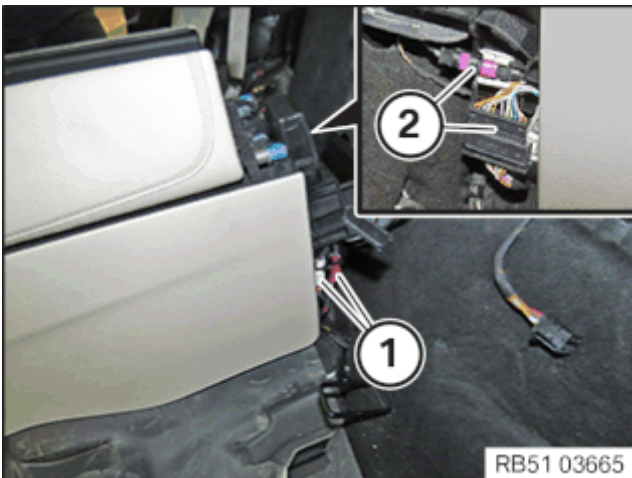

RB51 03665

- Tighten the screws (1).

Rear console to rear holder



4,6 Nm

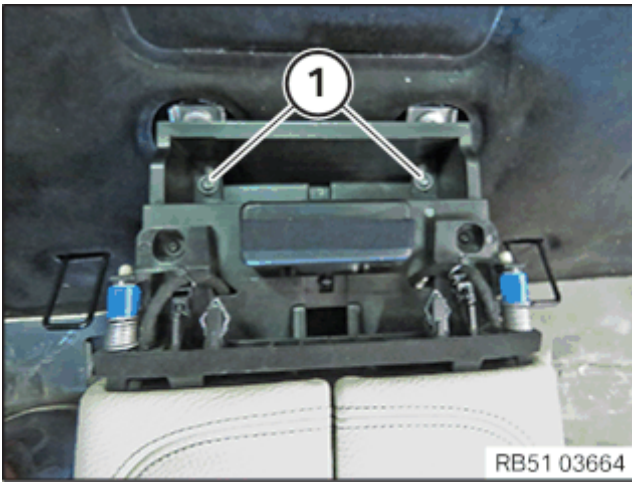

- Clip in the trim (1) into the clamps (2) from the rear.

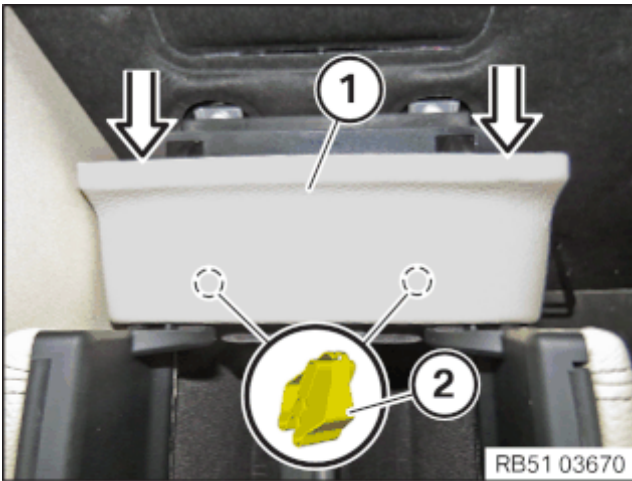

- Connect the trim (2) to the associated connectors.
- Clip in the trim (2).
- Tighten the screws (1).

Trim in rear console storage compartment

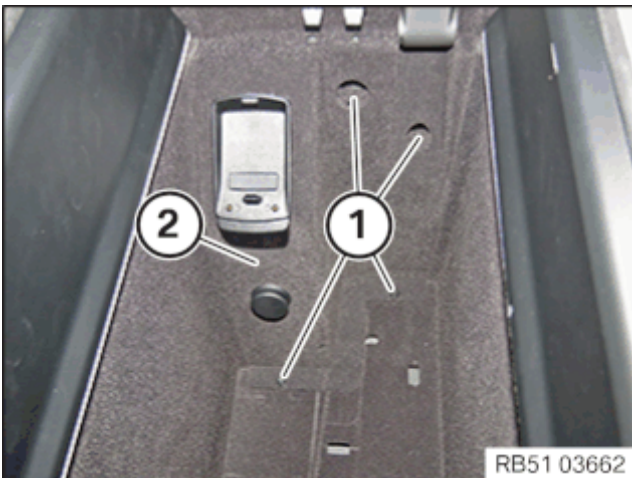

- Clip in the trim (1) into the clamps (2) from the top.

1,8 Nm

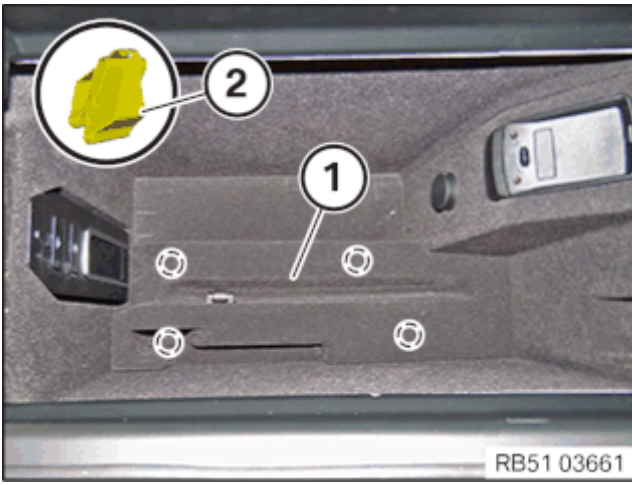

- Insert the insert (1) and cover (2).



POSTPROCESSES

10–Installing the rear console at the top

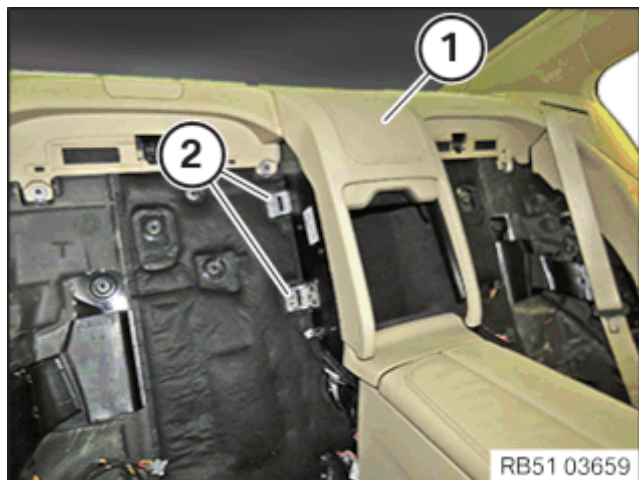

- Insert the rear console (1) and position it on the attachment points (2) on the left and right.

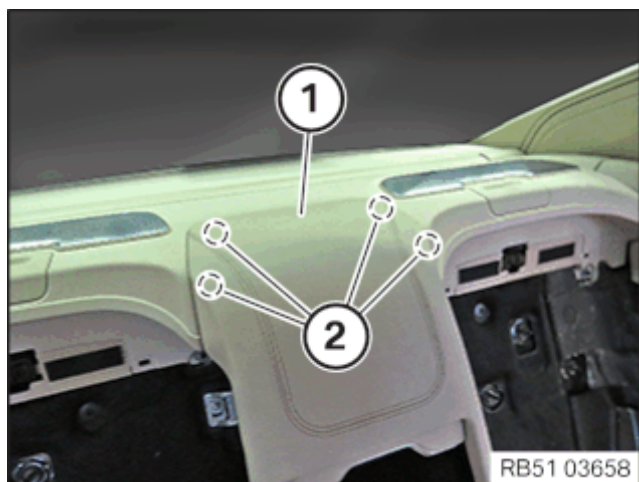

- Clip in the rear console (1) into the clamps from the top in this area (2).

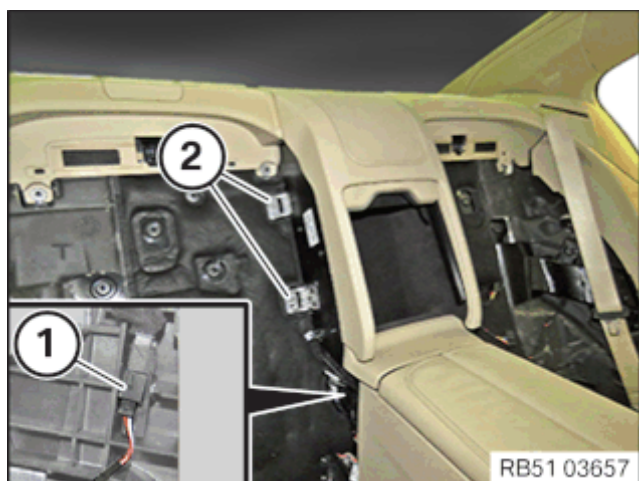

- Connect connector (1).
- Tighten the nuts (2) on the left and right.

Top rear console to body



Nut		4,6 Nm
-----	--	--------

- Clip in the trim (2) into the clamps from the top in this area (3).
- Insert the insert (1).

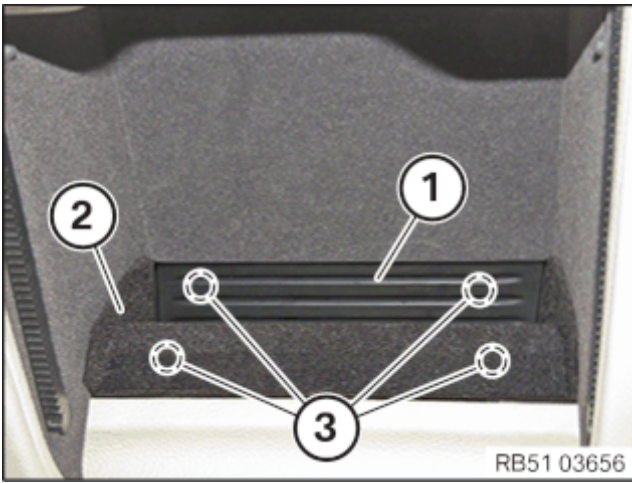

11-Installing the DVD player

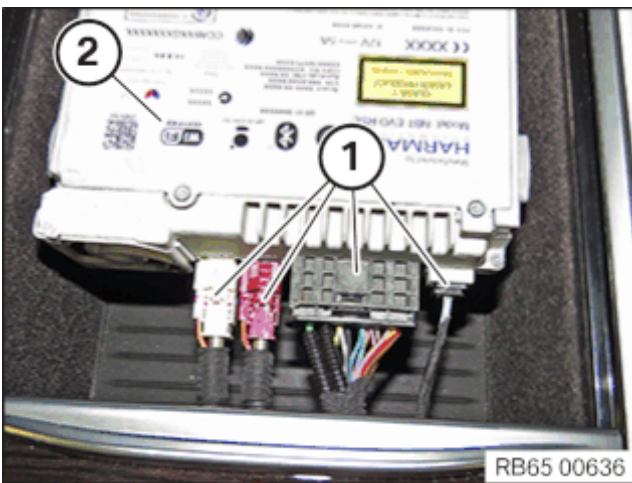

- Insert and connect the connector (1) to the DVD player (2).

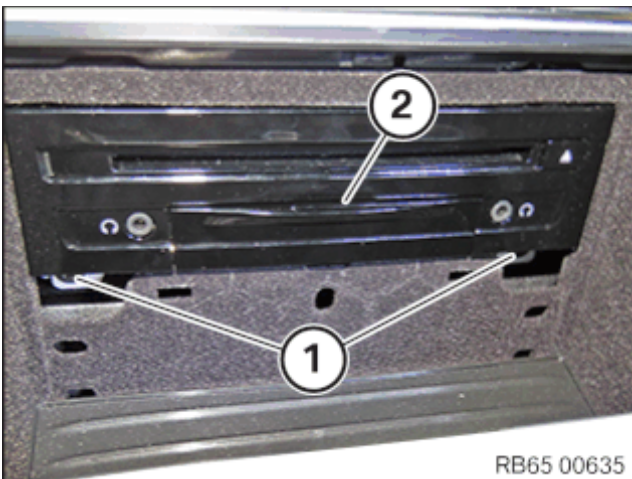

- Correctly position the DVD player (2) and tighten the screws (1).

- Correctly position and engage the cover (1).

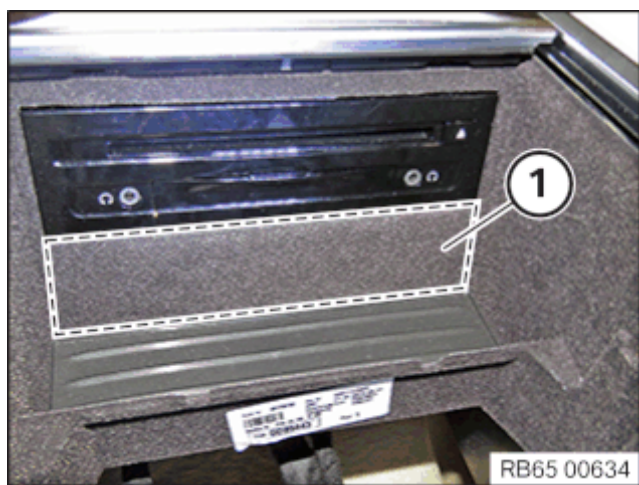

12–Installing the cup holder in the rear console

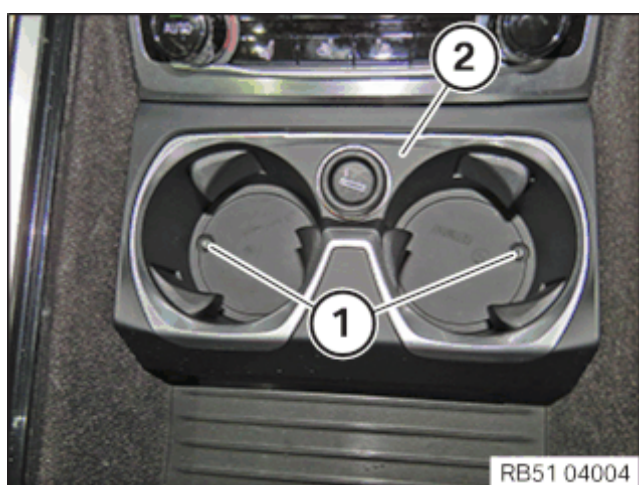

- Insert and connect the associated connector to the cup holder (2).
- Correctly position the cup holder (2) and tighten the screws (1).

Cup holder to rear console



	1,8 Nm
--	--------



- Correctly insert the covers (1).

13–Installing the control panel of the rear passenger compartment air conditioning

- Insert and connect the associated connector to the control panel (1).
- Correctly position the control panel (1) and engage with the rear console (2).



RB64 00889

14–Installing the fresh air grille in the rear passenger compartment



RB64 00887

- Insert and connect the associated connector to the fresh air grille (1).
- Correctly position the fresh air grille (1) and engage with the rear console (2).

15–Installing both rear seats

NOTICE

Description is for left component only. Procedure on the right side is identical.

◀ Installing the seat

RISK OF DAMAGE

Scratches.

Tools and sharp-edged components can cause scratches.

- Protect working area.
- Handle tools and components carefully.

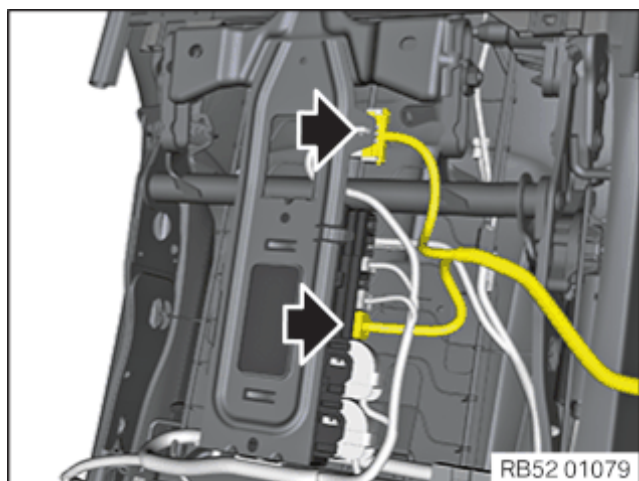

RB52 01079

- Insert the seat into the vehicle.
- Slightly fold the rear seat backrest forwards.
- Connect connector.

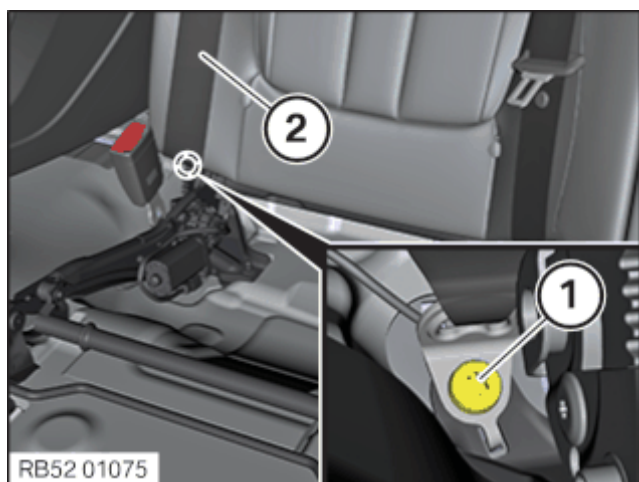

- Insert the seat belt (2) and correctly position it on the seat mechanism.
- Tighten down screw (1).

Lower strap to body



M12	Renew screw.		42 Nm
-----	--------------	--	-------

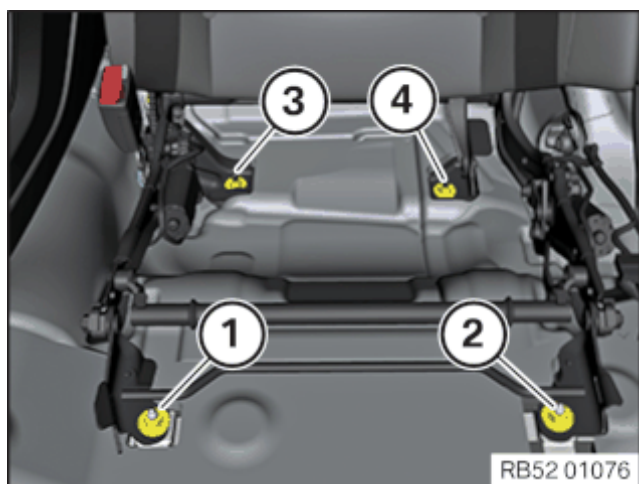

- Tighten nuts in the sequence (1), (2), (3) and (4).

Rear seat to body



Nut M8			18,5 Nm
--------	--	--	---------

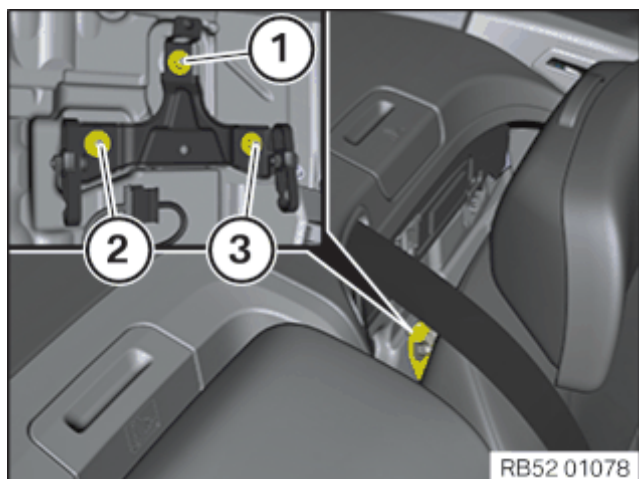

- Tighten nuts in the sequence (1), (2), and (3).

Rear seat to body



Nut M8			18,5 Nm
--------	--	--	---------

- Attach the cover (1) into the seat mechanism from the top.
- Secure the cover with Velcro fastener (1) in this area (2).

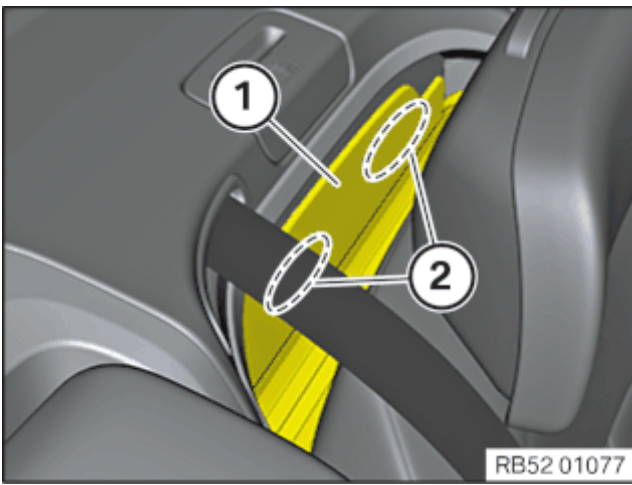

16–Installing both seat surfaces

NOTICE

Description is for left component only. Procedure on the right side is identical.

◀ Installing the seat surface

◀ Checking the seat belt (for 5-seater only)

RISK OF DAMAGE

Damage to the seat belt.

If the seat surface is disassembled, the seat belt can be damaged by the seat mechanism.

- Do not operate the seat adjustment mechanism with the seat surface disassembled (unless otherwise indicated).

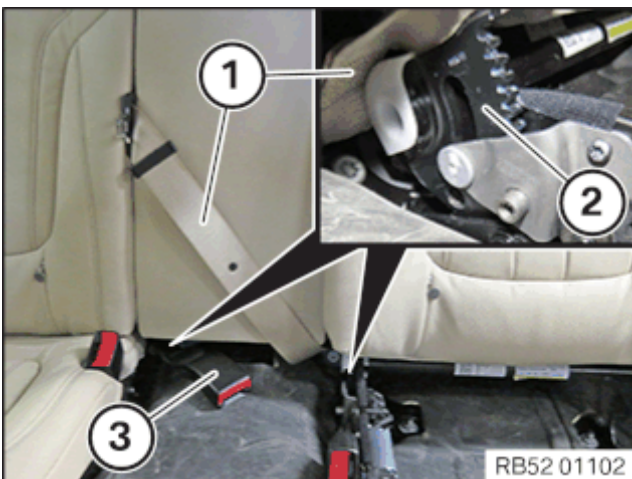

- Check seat belt (1) and lower strap (3).

Seat belt (1) and lower strap (3) must not be trapped by the seat mechanism (2).



- Equipment specification with active seat:

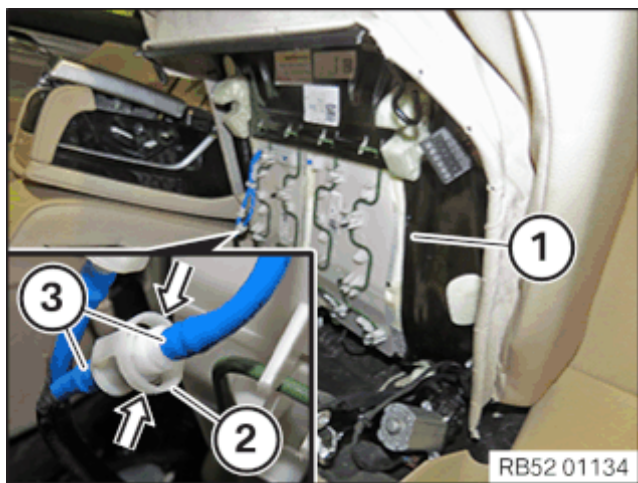

Position seat surface (1) as illustrated.

Coupling (2) must not be damaged.

Connect lines (3) together and ensure correct latch mechanism of the coupling (2).



- Connect all connectors with the seat surface.
- Attach wire spring clip (1), first inside (tunnel-side), into the fixture (2) of the seat mechanism.
- Then attach wire spring clip (1), outside (door-side), into the fixture (2) of the seat mechanism.
- Ensure correct fit of the wire spring clip (1) in the fixture (2).



- Guide seat belt buckle into seat surface.
- Clip in seat surface from above.

