

Ferrari

Ferrari North America, Inc.

September 8, 1998

Ms. Kathleen DeMeter, Director
Office of Defects Investigation
National Highway Traffic Safety Administration
400 Seventh Street, SW
Washington, D.C. 20590

RECEIVED
SEP 11 1998
DEFECTS INVESTIGATION



Dear Ms. DeMeter:

38V-223 (01)

Enclosed please find the Vehicle Safety Defect Initial Information Reports, regarding the Recall Campaign, Number 162, which we are initiating in order to correct the following:

On Ferrari vehicles, 1998 model F355 F 1 Spider with Vehicle Assembly Numbers between 29088 and 30041, damage to the fuel tank may have occurred during installation of the soft top mechanism covers.

Should such a condition occur, the result would be leakage of fuel from the damaged fuel tank. As with any type of fuel system leakage, the possibility of a vehicle fire exists.

This Ferrari factory informed us of the possibility of the above-mentioned condition.

The remedy consists of an inspection of the fuel tank for leaks as per the attached instructions. Then inspect the screws on the soft top mechanism covers (part numbers 64412600 and 64956400) for proper length. If the screws are 16-mm long, they can be re-used. If 22-mm screws were used, replace them with 16-mm screws part number 4815.

For the above campaign, it is our intention to notify each Ferrari Dealer with a comprehensive letter explaining the remedy and to notify each affected vehicle owner with a letter informing them of the required recall modification. Follow-up letters will be sent if necessary.

Enclosed are draft letters that Ferrari North America, Inc. will send to the affected owners and to the Authorized Ferrari Dealers, as well as a draft of the technical instructions.

98V-223 (02)

In an effort to proceed as expeditiously as possible with this recall, please promptly inform us that our reports comply completely with NIITSA's requirements.

Thank you.

Best regards,



William S. Story
Director of Technical Services

WSS:cc

Enclosures

FERRARI NORTH AMERICA, INC.
250 SYLVAN AVENUE
ENGLEWOOD CLIFFS, NJ 07632
September 08, 1998

VEHICLE SAFETY DEFECT
INITIAL INFORMATION REPORT
F355 FI SPIDER FUEL TANK INSPECTION
RECALL No. 162

Date Submitted: September-98
Date Received: August-98
Campaign No.: 162
Campaign Date: September-98

<u>MAKE</u>	<u>MODEL</u>	<u>MODEL YEAR</u>	<u>NO. OF VEHICLES</u>	<u>ENCLOSED MFG. DATES</u>		<u>OTHER VEHICLE IDENTIFICATION</u>
				<u>From</u>	<u>Through</u>	
FERRARI	F 355 FI SPIDER	1998	81	March 1, 1998	May 15, 1998	Vehicles Assembly Numbers between 29088 and 30041

FERRARI NORTH AMERICA, INC.
250 SYLVAN AVENUE
ENGLEWOOD CLIFFS, NJ 07632
September 8, 1998

VEHICLE SAFETY DEFECT
INITIAL INFORMATION REPORT
F355 F1 SPIDER FUEL TANK INSPECTION
RECALL No. 162

A) DESCRIPTION OF DEFECT:

On Ferrari Vehicles: Model year 1998 F355 F1 SPIDER with vehicle assembly numbers between 29088 - 30041

Damage to the fuel tank may have occurred during installation of the screws on the soft top mechanism covers (part numbers 64412600 and 64956400). Should such a condition occur, the result would be leakage of fuel from the damaged fuel tank.

B) CHRONOLOGY OF EVENTS WHICH LED TO DETERMINATION OF A SAFETY DEFECT:

The Ferrari Factory informed us of the possibility of this condition.

C) MEASURES TO BE TAKEN TO REPAIR VEHICLE:

Inspect the fuel tank for leaks as per the attached instructions. Then inspect the soft top mechanism cover (part number 64412600 and 64956400) screws to verify proper length. If the screws are found to be of an improper length of 22mm, replace them with 16mm screws part number 4815. This operation will be performed free of charge to the vehicle owner, and will require approximately 1.0 hour or approximately 5.0 hours if damage to the fuel tank exists.

ESTIMATED INITIATION OF CORRECTIVE ACTION:

September-98

DRAFT

September 1998

98V-223 (05)

Dear Ferrari Dealer:

Ferrari S.p.A., the manufacturer of Ferrari automobiles, has determined that a defect may exist in certain 1998 model year F355 F 1 Spider Ferrari vehicles.

On vehicles with the vehicle assembly numbers between 29088 and 30041 damage to the fuel tank may have occurred during installation of the soft-top mechanism covers. Should such a condition occur, the result would be leakage of fuel from the damaged fuel tank. As with any type of fuel system leakage, the possibility of a vehicle engine fire exists.

The remedy consists of an inspection of the fuel tank for leaks as per the attached instructions. Then inspect the screws on the soft top mechanism covers (part numbers 64412600 and 64956400) for proper length. If the screws are 16-mm long, they can be re used. If 22-mm screws were used, replace them with 16-mm screws part number 4815.

The corrective action will require approximately 1.0 hour for inspection or approximately 5.0 hours if damage to the fuel tank exists.

We have accordingly sent notices to all owners of the affected vehicles advising them of this potential problem and requesting that they contact any Authorized Ferrari Dealer for the repairs, as per the attached notification letter.

Upon transmittal of the repair under the normal warranty system, we will, of course, reimburse you for the labor and applicable parts necessary to carry out this campaign.

Obviously, if you have any of the affected vehicles in your stock, you must not sell them until you have performed the necessary repairs. If you have already sold any vehicles with the chassis numbers specified in the enclosed instructions and have not yet sent in the retail sales cards, please do so at once so that we may notify these owners accordingly.

Thank you for your cooperation

Best Regards,

William S. Story
Director of Technical Services

WSS:cc

DRAFT

RECALL CAMPAIGN NO. 162/1

38V-223 (16)

SUBJECT : Ferrari F355 Fuel Tank Inspection Recall No. 162/1

VEHICLES : Ferrari F 355 FI Spider M.Y. 1998 vehicles with a vehicle identification number between 29088 and 30041.

CONDITION : Damage to the fuel tank may have occurred during installation of the screws on the soft top mechanism covers (part numbers 64412600 and 64956400). Should such a condition occur, the result would be leakage of fuel from the damaged fuel tank.

REMEDY : Inspection of soft top mechanism cover screws for proper length. Replace the screws if they are 22mm with 16mm screws. If 22mm screws were used, check the fuel tank for leaks, as per the attached instructions.

PARTS : The new screws are identified by the following part number:

<u>Old Part Number</u>	<u>New Part Number</u>	<u>Quantity</u>	<u>Description</u>
	4815	2	16mm screw

COST : A) An initial supply of screws as well as one fuel cap to be used to test each vehicle will be sent to your dealership.

LABOR :

Tank inspection:	MEDEA Recall number	1621	Defect Code	01
	Component Code	1401	Cost Code	24
	Labor Operation	14011	Time	1.0 Hours

REIMBURSEMENT : Upon receipt of claim via MEDEA

DRAFT

INSTRUCTIONS FOR FUEL TANK INSPECTION

98V-223 (37)

A: Preliminary: The fuel cap p.n. 4816 will be sent to you as a tool from our spare parts department and should be modified and re-used on each vehicle which is inspected at your dealership.

B: Procedure for inspection:

WARNING: NO SMOKING

HIGHLY FLAMMABLE MATERIAL. KEEP AWAY FROM SPARKS OR OPEN FLAMES. PROVIDE ADEQUATE VENTILATION. FUEL, WHEN SATURATED ON CLOTHING, WILL CAUSE SKIN IRRITATION. PROCEED ACCORDINGLY.

DO NOT PERFORM THIS PROCEDURE ON A WARM ENGINE.

insert figure A

- 1 Disconnect battery (main switch).
- 2 Unscrew self-tapping lower fixing screws which attach interior covers p.n. 64412600 and p.n. 64956400 (reference item # 23 and item # 24 in figure A).
- 3 Cover rear fenders with fender covers.
- 4 Remove fuel tank fill cap to release pressure from the fuel tank.
- 5 Take the fuel cap p.n. 4816 and drill a hole in the center to enable the fitting of a nipple in order to connect a hand held pump with pressure gauge. We would suggest the use of a suitable coolant system pressure tester. The coolant tank fitting will have to be removed and the drilled fuel cap with fitting attached
- 6 Check all connections between pressure gauge and fuel cap.

- 7 Install the modified fuel cap onto the fuel filler neck, making sure it is properly sealed.
- 8 Using adequate hose clamp pliers, compress the hose p.n. 126919 (reference fuel line #54 in figure B.) This operation is necessary in order to avoid any loss of pressure during the test.

98V-223 (86)

- 9 Pressurize the fuel system with a max. pressure of 0,16 bar (2 32 psi)

NOTE: IT IS ABSOLUTELY PROHIBITED TO INCREASE THIS PRESSURE VALUE BECAUSE OF POSSIBLE DAMAGE TO OTHER FUEL SYSTEM COMPONENTS.

- 10 Keep the system under pressure for at least 15 minutes, monitoring the pressure gauge. If no drop of pressure is noticed within that period of time, damage to the fuel tank can be excluded. Otherwise, it will be necessary to remove the fuel tank for inspection as per the attached instructions.

NOTE: IF A DROP IN PRESSURE IS NOTICED, IT IS IMPORTANT TO FIRST CHECK ALL FUEL SYSTEM COMPONENT CONNECTIONS FOR LEAKS.

- 11 Remove modified fuel cap and the hose clamping pliers used in step 10.
- 12 Re-install the original fuel filler cap.
- 13 Re-attach battery (main switch).
- 14 Verify the length of the screws removed in step 2 (reference item # 23 and item # 24 in figure A) If they are 16mm in length, they may be reused. If they are 22mm in length, use new 16mm screws supplied under p.n. 4815.

RECALL CAMPAIGN NO. 162/2

DRAFT

98V-223 (39)

SUBJECT : Ferrari F355 Fuel Tank Replacement Recall No. 162/2

VEHICLES : Ferrari F 355 F1 Spider M.Y. 1998 vehicles with a vehicle identification number between 29088 and 30041.

CONDITION : Damage to the fuel tank may have occurred during installation of the screws on the soft top mechanism covers (part numbers 64412600 and 64956400). Should such a condition occur, the result would be leakage of fuel from the damaged fuel tank.

REMEDY : If after inspection of the fuel tank shows damage, the fuel tank needs to be replaced as per the attached instruction.

PARTS :

<u>Old Part Number</u>	<u>New Part Number</u>	<u>Quantity</u>	<u>Description</u>
	165652	1	Fuel Tank
	138453	1	O ring
	154802	1	Gasket

COST : A) If the fuel tank needs to be replaced, the above parts must be ordered overnight from our parts department.

LABOR : Tank replacement:

MEDEA Recall number	1622	Defect Code	01
Component Code	1401	Cost Code	24
Labor Operation	14010	Time	5.0 Hours

REIMBURSEMENT : Upon receipt of claim via MEDEA

INSTRUCTIONS FOR FUEL TANK REPLACEMENT

98V-223 (10)

A: Preliminary: The replacement fuel tank is supplied as a spare part by the part number, 165652 listed on the previous page.

B: Procedure for installation

WARNING: NO SMOKING

HIGHLY FLAMMABLE MATERIAL. KEEP AWAY FROM SPARKS OR OPEN FLAMES. PROVIDE ADEQUATE VENTILATION. FUEL, WHEN SATURATED ON CLOTHING, WILL CAUSE SKIN IRRITATION. PROCEED ACCORDINGLY.

NOTE: BE SURE TO UTILIZE PROPER EQUIPMENT FOR SAFE TRANSFER OF FUEL FROM CAR TO APPROVED FUEL CONTAINER.

DO NOT PERFORM THIS PROCEDURE ON A WARM ENGINE.

- 1 Disconnect battery (main switch).
- 2 Cover rear fenders with fender covers.
- 3 Remove fuel tank fill cap to release pressure from the fuel tank.
- 4 Lift vehicle and remove fuel tank access panel. Drain the fuel from the tank into an approved fuel container.
- 5 Remove fuel tank vapor lines at top of fuel tank utilizing special tool part number 95970126. (Items No.30, No.29, No. 31, and No.17 in figure A)

- 6 Loosen fuel tank fill tube clamp at top and disconnect tube from fuel tank. (Item No.27 in figure B)
- 7 Remove fuel supply and return lines from fuel pump assembly.
- 8 Shift gear box into third gear and disconnect shift rod under fuel tank.
- 9 Place a transmission type jack under the fuel tank and remove fuel tank securing straps.
- 10 Drop the fuel tank taking care to disconnect the fuel pump connections and to take note of the fuel line routing through the chassis.

NOTE: Please be aware of the location of the inlet and outlet fitting at the fuel pump due to the fact that they are the same fitting and can be installed in reverse.

- 11 Remove connections for fuel level sending unit.
- 12 Remove fuel pump assembly and install in new tank (part number 165652) with new seal, part number 138453.
- 13 Re-install fuel level sending unit with new gasket, part number 154802.
- 14 Install the new fuel tank taking care to reconnect the fuel pump fuel sending unit electrical connections and route the fuel lines through the chassis in the proper manner. Be sure to tighten fuel tank straps without overtightening and make sure wires for fuel pump are routed properly when fuel tank is installed.
- 15 Re-install shift control rod and adjust the gear shifter.
- 16 Re-connect fuel vapor lines to fuel tank and fuel tank fill tube. Please ensure that the fuel tank vapor line fitting "O" rings are in good condition before replacement of the connector and that the fill tube clamp is properly tightened.

17 Re-connect fuel feed and return lines to fuel pump, tighten to a torque of 25 Nm (18.44 lb. ft.) with a crow'sfoot wrench.

38V-223 (12)

18 Transfer about 3 gallons of fuel into car fuel tank, replace fuel tank filler cap, connect battery, start vehicle and check for leaks. **REPAIR ANY LEAKS.**

19 Re-install fuel tank access panel and transfer remainder of fuel into vehicle fuel tank.

20 Re-install fuel tank fill cap.

DRAFT

98V-223 (13)

September 1998

«MXFRST» «MXLAST»
«MXADD1»
«MXADD2»
«MXCITY», «MXST» «MXZIP»

Serial Number: «AOMAT»

Dear Ferrari Customer:

This notice is sent to you in accordance with the requirements of Title 49, United States Code, Part A, Subchapter II.

Ferrari S.p.A., the manufacturer of Ferrari automobiles, has determined that a defect may exist in certain 1998 model year F355 F1 Spider Ferrari vehicles.

On vehicles with the vehicle assembly numbers between 29088 and 30041 damage to the fuel tank may have occurred during installation of the screws on the soft top mechanism covers. Should such a condition occur, the result would be leakage of fuel from the damaged fuel tank. As with any type of fuel system leakage, the possibility of a vehicle engine fire exists.

The corrective action for the above listed repair will be performed free of charge to you and will require approximately **5.0 hours** to complete. Please plan, however, to leave your vehicle with the dealer all day to allow the dealer some flexibility for scheduling your repairs.

By the time you receive this letter, the Authorized Ferrari Dealer will have been supplied with the instructions and parts to perform the inspection and/or repair. If the Dealer fails or is unable to make the necessary repairs free of charge within a reasonable time, you should inform the National Headquarters Office of Ferrari North America, Inc.

250 Sylvan Avenue
Englewood Cliffs, NJ 07632
(201) 816-2651 (National Technical Office)

DRAFT

98U-223

14

Although we urge you to immediately call the number indicated on the previous page, if the affected vehicle is not repaired free of charge to you or within a reasonable time, you may also contact the Administrator of the National Traffic Safety Administration in Washington, D.C. 20590 or call the Auto Safety Hot line at 800-424-9393 nationally and (202) 366-0123 for Washington, D.C. area residents.

We urge you to comply with this notice promptly and we apologize for any inconvenience this may cause.

Best Regards,

William S. Story
Director of Technical Services

WSS:cc

RECEIVED

SEP 18 1998



OFFICE
DEFECTS INVESTIGATION

L. W. Camp
Director
Automotive Safety Office
Environmental And Safety Engineering

Ford Motor Company
390 Town Center Drive
Dearborn, Michigan 48126 USA

September 15, 1998

98V-233 (21)

Mr. Kenneth Weinstein
Associate Administrator for Safety Assurance
National Highway Traffic Safety Administration
400 Seventh Street, S.W.
Washington, D.C. 20590

Dear Mr. Weinstein:

Pursuant to Part 573 of Title 49 of the Code of Federal Regulations, Defect and Noncompliance Reports, Ford Motor Company submits the following information concerning a safety-related recall action that it is initiating.

573.5 (c) (2)

Certain 1995 through 1998 model year Ford Contour and Mercury Mystique vehicles built at the Cuautitlan and Kansas City Assembly Plants from July 18, 1994 through January 12, 1998.

Because these vehicles are not produced in VIN order, information as to the applicability of this action to specific vehicles can best be obtained by either calling Ford's toll-free line (1-800-392-3673) or contacting a local Ford or Lincoln/Mercury dealer, who can obtain specific information regarding the vehicles from the Ford OASIS computer system.

573.5 (c) (3)

Approximately 175,000 vehicles.

573.5 (c) (4)

Unknown.

573.5 (c) (5)

The affected vehicles have a floor shift automatic transmission control that may be damaged if subjected to



98V-233 (32)

certain vehicle interior cleaning products. If exposed to these products, the transmission gear position indicator may deteriorate and not correctly indicate the actual gear position. If this occurs, the shifter will continue to operate normally, but there is the potential for incorrect gear selection due to the malfunctioning indicator.

573.5 (c) (6)

Ford first became aware of this potential condition in late 1997 when complaints were received from a car rental company. Initial investigation concluded that the indicator either worked, or remained in one position. However, further investigation during mid-1998 revealed the potential for a one or two gear position error in the gear indication prior to the indicator ceasing to move.

573.5 (c) (8)

Owners of record of the affected vehicles will be notified by First Class Mail commencing on or about the week of October 31, 1998, to return vehicles to dealers to have the automatic transmission floor shift control replaced.

573.5 (c) (9)

Ford plans to make a public statement concerning the subject matter of this action concurrent with owner notification. Copies of the notification letters to dealers and owners will be forwarded when available.

573.5 (c) (11)

Ford has assigned campaign number 98S26 to this action.

Very truly yours,



for L. W. Camp

RECALL CAMPAIGNS

NAME OF MANUFACTURER : FERRARI

SUBJECT OF RECALL : FUEL TANK DAMAGE

RECALL CAMPAIGN NUMBER : 98V-223

ACTION THAT INFLUENCED RECALL

MANUFACTURED INFLUENCED YES

ODI INFLUENCED:

ACTION NO. :

DED INVESTIGATOR :

RAD INVESTIGATOR :

OVSC INFLUENCED:

ACTION NO. :

OVSC INVESTIGATOR :

Ferrari

Ferrari North America, Inc.

September 8, 1998

Ms. Kathleen DeMeter, Director
Office of Defects Investigation
National Highway Traffic Safety Administration
400 Seventh Street, SW
Washington, D.C. 20590

RECEIVED
SEP 11 11 21 AM
OFFICE OF DEFECTS INVESTIGATION



Dear Ms. DeMeter:

38V-223 (01)

Enclosed please find the Vehicle Safety Defect Initial Information Reports, regarding the Recall Campaign, Number 162, which we are initiating in order to correct the following:

On Ferrari vehicles, 1998 model F355 F1 Spider with Vehicle Assembly Numbers between 29088 and 30041, damage to the fuel tank may have occurred during installation of the soft top mechanism covers

Should such a condition occur, the result would be leakage of fuel from the damaged fuel tank. As with any type of fuel system leakage, the possibility of a vehicle fire exists.

This Ferrari factory informed us of the possibility of the above-mentioned condition.

The remedy consists of an inspection of the fuel tank for leaks as per the attached instructions. Then inspect the screws on the soft top mechanism covers (part numbers 64412600 and 64956400) for proper length. If the screws are 16-mm long, they can be re-used. If 22-mm screws were used, replace them with 16-mm screws part number 4815.

For the above campaign, it is our intention to notify each Ferrari Dealer with a comprehensive letter explaining the remedy and to notify each affected vehicle owner with a letter informing them of the required recall modification. Follow-up letters will be sent if necessary.

Enclosed are draft letters that Ferrari North America, Inc. will send to the affected owners and to the Authorized Ferrari Dealers, as well as a draft of the technical instructions.

98V-223 (2)

In an effort to proceed as expeditiously as possible with this recall, please promptly inform us that our reports comply completely with NHTSA's requirements.

Thank you.

Best regards,



William S. Story
Director of Technical Services

WSS:cc

Enclosures

FERRARI NORTH AMERICA, INC.
250 SYLVAN AVENUE
ENGLEWOOD CLIFFS, NJ 07632
September 08, 1998

VEHICLE SAFETY DEFECT
INITIAL INFORMATION REPORT
F355 F1 SPIDER FURL TANK INSPECTION
RECALL No. 162

Date Submitted: September-98
Date Received: August-98
Campaign No.: 162
Campaign Date: September-98

<u>MAKE</u>	<u>MODEL</u>	<u>MODEL YEAR</u>	<u>NO. OF VEHICLES</u>	<u>ENCLOSED MRG. DATES</u> <u>From</u> <u>Through</u>	<u>OTHER VEHICLE</u> <u>IDENTIFICATION</u>
FERRARI	F 355 F1 SPIDER	1998	81	March 1, 1998 May 15, 1998	Vehicles Assembly Numbers between 29088 and 30041

FERRARI NORTH AMERICA, INC.
250 SYLVAN AVENUE
ENGLEWOOD CLIFFS, NJ 07632
September 8, 1998

VEHICLE SAFETY DEFECT
INITIAL INFORMATION REPORT
F355 F1 SPIDER FUEL TANK INSPECTION
RECALL No. 162

A) DESCRIPTION OF DEFECT:

On Ferrari Vehicles: Model year 1998 F355 F1 SPIDER with vehicle assembly numbers between 29088 - 30041

Damage to the fuel tank may have occurred during installation of the screws on the soft top mechanism covers (part numbers 64412600 and 64956400). Should such a condition occur, the result would be leakage of fuel from the damaged fuel tank.

B) CHRONOLOGY OF EVENTS WHICH LED TO DETERMINATION OF A SAFETY DEFECT:

The Ferrari Factory informed us of the possibility of this condition.

C) MEASURES TO BE TAKEN TO REPAIR VEHICLE:

Inspect the fuel tank for leaks as per the attached instructions. Then inspect the soft top mechanism cover (part number 64412600 and 64956400) screws to verify proper length. If the screws are found to be of an improper length of 22mm, replace them with 16mm screws part number 4815. This operation will be performed free of charge to the vehicle owner, and will require approximately 1.0 hour or approximately 5.0 hours if damage to the fuel tank exists.

ESTIMATED INITIATION OF CORRECTIVE ACTION:

September-98

DRAFT

September 1998

58V-223 05

Dear Ferrari Dealer:

Ferrari S.p.A., the manufacturer of Ferrari automobiles, has determined that a defect may exist in certain 1998 model year F355 F1 Spider Ferrari vehicles.

On vehicles with the vehicle assembly numbers between 29088 and 30041 damage to the fuel tank may have occurred during installation of the soft-top mechanism covers. Should such a condition occur, the result would be leakage of fuel from the damaged fuel tank. As with any type of fuel system leakage, the possibility of a vehicle engine fire exists.

The remedy consists of an inspection of the fuel tank for leaks as per the attached instructions. Then inspect the screws on the soft top mechanism covers (part numbers 64412600 and 64956400) for proper length. If the screws are 16-mm long, they can be re used. If 22-mm screws were used, replace them with 16-mm screws part number 4815.

The corrective action will require approximately 1.0 hour for inspection or approximately 5.0 hours if damage to the fuel tank exists.

We have accordingly sent notices to all owners of the affected vehicles advising them of this potential problem and requesting that they contact any Authorized Ferrari Dealer for the repairs, as per the attached notification letter.

Upon transmittal of the repair under the normal warranty system, we will, of course, reimburse you for the labor and applicable parts necessary to carry out this campaign.

Obviously, if you have any of the affected vehicles in your stock, you must not sell them until you have performed the necessary repairs. If you have already sold any vehicles with the chassis numbers specified in the enclosed instructions and have not yet sent in the retail sales cards, please do so at once so that we may notify these owners accordingly.

Thank you for your cooperation

Best Regards,

William S. Story
Director of Technical Services

WSS:cc

DRAFT

RECALL CAMPAIGN NO. 162/1

98V-223 (10)

SUBJECT : Ferrari F355 Fuel Tank Inspection Recall No. 162/1

VEHICLES : Ferrari F 355 F1 Spider M.Y. 1998 vehicles with a vehicle identification number between 29088 and 30041.

CONDITION : Damage to the fuel tank may have occurred during installation of the screws on the soft top mechanism covers (part numbers 64412600 and 64956400). Should such a condition occur, the result would be leakage of fuel from the damaged fuel tank.

REMEDY : Inspection of soft top mechanism cover screws for proper length. Replace the screws if they are 22mm with 16mm screws. If 22mm screws were used, check the fuel tank for leaks, as per the attached instructions.

PARTS : The new screws are identified by the following part number:

<u>Old Part Number</u>	<u>New Part Number</u>	<u>Quantity</u>	<u>Description</u>
	4815	2	16mm screw

COST : A) An initial supply of screws as well as one fuel cap to be used to test each vehicle will be sent to your dealership

LABOR : Tank inspection:

MEDEA Recall number	1621	Defect Code	01
Component Code	1401	Cost Code	24
Labor Operation	14011	Time	1.0 Hours

REIMBURSEMENT : Upon receipt of claim via MEDEA

DRAFT

INSTRUCTIONS FOR FUEL TANK INSPECTION

98V-223 (37)

- A: Preliminary. The fuel cap p.n. 4816 will be sent to you as a tool from our spare parts department and should be modified and re-used on each vehicle which is inspected at your dealership.

- B: Procedure for inspection:

WARNING: NO SMOKING

HIGHLY FLAMMABLE MATERIAL. KEEP AWAY FROM SPARKS OR OPEN FLAMES. PROVIDE ADEQUATE VENTILATION. FUEL, WHEN SATURATED ON CLOTHING, WILL CAUSE SKIN IRRITATION. PROCEED ACCORDINGLY.

DO NOT PERFORM THIS PROCEDURE ON A WARM ENGINE.

insert figure A

- 1 Disconnect battery (main switch).
- 2 Unscrew self-tapping lower fixing screws which attach interior covers p.n. 64412600 and p.n. 64956400 (reference item # 23 and item # 24 in figure A).
- 3 Cover rear fenders with fender covers.
- 4 Remove fuel tank fill cap to release pressure from the fuel tank.
- 5 Take the fuel cap p.n. 4816 and drill a hole in the center to enable the fitting of a nipple in order to connect a hand held pump with pressure gauge. We would suggest the use of a suitable coolant system pressure tester. The coolant tank fitting will have to be removed and the drilled fuel cap with fitting attached.
- 6 Check all connections between pressure gauge and fuel cap.

- 7 Install the modified fuel cap onto the fuel filler neck, making sure it is properly sealed.
- 8 Using adequate hose clamp pliers, compress the hose p.n. 126919 (reference fuel line #54 in figure B.) This operation is necessary in order to avoid any loss of pressure during the test.

88V-223 (08)

- 9 Pressurize the fuel system with a max. pressure of 0,16 bar (2.32 psi)

NOTE: IT IS ABSOLUTELY PROHIBITED TO INCREASE THIS PRESSURE VALUE BECAUSE OF POSSIBLE DAMAGE TO OTHER FUEL SYSTEM COMPONENTS.

- 10 Keep the system under pressure for at least 15 minutes, monitoring the pressure gauge. If no drop of pressure is noticed within that period of time, damage to the fuel tank can be excluded. Otherwise, it will be necessary to remove the fuel tank for inspection as per the attached instructions.

NOTE: IF A DROP IN PRESSURE IS NOTICED, IT IS IMPORTANT TO FIRST CHECK ALL FUEL SYSTEM COMPONENT CONNECTIONS FOR LEAKS.

- 11 Remove modified fuel cap and the hose clamping pliers used in step 10.
- 12 Re-install the original fuel filler cap.
- 13 Re-attach battery (main switch).
- 14 Verify the length of the screws removed in step 2 (reference item # 23 and item # 24 in figure A) If they are 16mm in length, they may be reused. If they are 22mm in length, use new 16mm screws supplied under p.n. 4815.

RECALL CAMPAIGN NO. 162/2

DRAFT

98V-223 (39)

SUBJECT : Ferrari F355 Fuel Tank Replacement Recall No. 162/2

VEHICLES : Ferrari F 355 F1 Spider M.Y. 1998 vehicles with a vehicle identification number between 29088 and 30041.

CONDITION : Damage to the fuel tank may have occurred during installation of the screws on the soft top mechanism covers (part numbers 64412600 and 64956400). Should such a condition occur, the result would be leakage of fuel from the damaged fuel tank.

REMEDY : If after inspection of the fuel tank shows damage, the fuel tank needs to be replaced as per the attached instruction.

PARTS :

<u>Old Part Number</u>	<u>New Part Number</u>	<u>Quantity</u>	<u>Description</u>
	165652	1	Fuel Tank
	138453	1	O ring
	154802	1	Gasket

COST : A) If the fuel tank needs to be replaced, the above parts must be ordered overnight from our parts department.

LABOR : Tank replacement:

MEDEA Recall number	1622	Defect Code	01
Component Code	1401	Cost Code	24
Labor Operation	14010	Time	5.0 Hours

REIMBURSEMENT : Upon receipt of claim via MEDEA

INSTRUCTIONS FOR FUEL TANK REPLACEMENT

88V-223 (16)

A: Preliminary : The replacement fuel tank is supplied as a spare part by the part number, 165652 listed on the previous page.

B: Procedure for installation

WARNING: NO SMOKING

HIGHLY FLAMMABLE MATERIAL. KEEP AWAY FROM SPARKS OR OPEN FLAMES. PROVIDE ADEQUATE VENTILATION. FUEL, WHEN SATURATED ON CLOTHING, WILL CAUSE SKIN IRRITATION. PROCEED ACCORDINGLY.

NOTE: BE SURE TO UTILIZE PROPER EQUIPMENT FOR SAFE TRANSFER OF FUEL FROM CAR TO APPROVED FUEL CONTAINER.

DO NOT PERFORM THIS PROCEDURE ON A WARM ENGINE.

- 1 Disconnect battery (main switch).
- 2 Cover rear fenders with fender covers.
- 3 Remove fuel tank fill cap to release pressure from the fuel tank.
- 4 Lift vehicle and remove fuel tank access panel. Drain the fuel from the tank into an approved fuel container.
- 5 Remove fuel tank vapor lines at top of fuel tank utilizing special tool part number 95970126. (Items No.30, No.29, No. 31. and No.17 In figure A)

- 6 Loosen fuel tank fill tube clamp at top and disconnect tube from fuel tank.
(Item No.27 in figure B)
- 7 Remove fuel supply and return lines from fuel pump assembly.
- 8 Shift gear box into third gear and disconnect shift rod under fuel tank.
- 9 Place a transmission type jack under the fuel tank and remove fuel tank securing straps.
- 10 Drop the fuel tank taking care to disconnect the fuel pump connections and to take note of the fuel line routing through the chassis.

NOTE: Please be aware of the location of the inlet and outlet fitting at the fuel pump due to the fact that they are the same fitting and can be installed in reverse.
- 11 Remove connections for fuel level sending unit.
- 12 Remove fuel pump assembly and install in new tank (part number 165652) with new seal, part number 138453.
- 13 Re-install fuel level sending unit with new gasket, part number 154802.
- 14 Install the new fuel tank taking care to reconnect the fuel pump fuel sending unit electrical connections and route the fuel lines through the chassis in the proper manner. Be sure to tighten fuel tank straps without overtightening and make sure wires for fuel pump are routed properly when fuel tank is installed.
- 15 Re-install shift control rod and adjust the gear shifter.
- 16 Re-connect fuel vapor lines to fuel tank and fuel tank fill tube. Please ensure that the fuel tank vapor line fitting "O" rings are in good condition before replacement of the connector and that the fill tube clamp is properly tightened.

DRAFT

17 Re-connect fuel feed and return lines to fuel pump. tighten to a torque of 25 Nm (18.44 lb. ft.) with a crow'sfoot wrench.

38V-223 (12)

18 Transfer about 5 gallons of fuel into car fuel tank, replace fuel tank filler cap, connect battery. start vehicle and check for leaks. **REPAIR ANY LEAKS.**

19 Re-install fuel tank access panel and transfer remainder of fuel into vehicle fuel tank

20 Re-install fuel tank fill cap.

DRAFT

98V-223 (13)

September 1998

«MXFRST» «MXLAST»
«MXADD1»
«MXADD2»
«MXCITY», «MXST» «MXZIP»

Serial Number: «AOMAT»

Dear Ferrari Customer:

This notice is sent to you in accordance with the requirements of Title 49, United States Code, Part A, Subchapter II.

Ferrari S.p.A., the manufacturer of Ferrari automobiles, has determined that a defect may exist in certain 1998 model year F355 F1 Spider Ferrari vehicles.

On vehicles with the vehicle assembly numbers between 29088 and 30041 damage to the fuel tank may have occurred during installation of the screws on the soft top mechanism covers. Should such a condition occur, the result would be leakage of fuel from the damaged fuel tank. As with any type of fuel system leakage, the possibility of a vehicle engine fire exists.

The corrective action for the above listed repair will be performed free of charge to you and will require approximately **5.0 hours** to complete. Please plan, however, to leave your vehicle with the dealer all day to allow the dealer some flexibility for scheduling your repairs.

By the time you receive this letter, the Authorized Ferrari Dealer will have been supplied with the instructions and parts to perform the inspection and/or repair. If the Dealer fails or is unable to make the necessary repairs free of charge within a reasonable time, you should inform the National Headquarters Office of Ferrari North America, Inc.

250 Sylvan Avenue
Englewood Cliffs, NJ 07632
(201) 816-2651 (National Technical Office)

Although we urge you to immediately call the number indicated on the previous page, if the affected vehicle is not repaired free of charge to you or within a reasonable time, you may also contact the Administrator of the National Traffic Safety Administration in Washington, D.C. 20590 or call the Auto Safety Hot line at 800-424-9393 nationally and (202) 366-0123 for Washington, D.C. area residents.

We urge you to comply with this notice promptly and we apologize for any inconvenience this may cause.

Best Regards,

William S. Story
Director of Technical Services

WSS:cc

Ferrari

Ferrari North America, Inc.

September 30, 1998

Via U.S. Mail



Ms. Kathleen DeMeter, Director
Office of Defects Investigation
National Highway Traffic Safety Administration
400 Seventh Street, SW
Washington, D.C. 20590

RECEIVED
SEP 30 1998
OFFICE OF DEFECTS INVESTIGATION

Ref: Recall 162 (98V-223)

Dear Ms. DeMeter:

For your records, enclosed please find a copy of the Ferrari North America Recall booklet for Recall 162 (98V-223), "355 F 1, Fuel Tank Inspection", which was sent to all of the authorized dealerships within our network.

Best regards,

Concetta Ciaccio
Executive Assistant

Enclosure

Q98CAL162162 BOOK

RECALL CAMPAIGN

REF. NO. 162
FUEL TANK INSPECTION

F 355 F 1 SPIDER

SEPTEMBER 1998

READ, INITIAL
AND PASS ON »

Service Manager	Parts Manager	Service Writer	Technician				Warranty Clerk

September 1998

Dear Ferrari Dealer:

Ferrari S.p.A., the manufacturer of Ferrari automobiles, has determined that a defect may exist in certain 1998 model year F355 F1 Spider Ferrari vehicles.



On vehicles with the vehicle assembly numbers between 29088 and 30041 damage to the fuel tank may have occurred during installation of the soft-top mechanism covers. Should such a condition occur, the result would be leakage of fuel from the damaged fuel tank. As with any type of fuel system leakage, the possibility of a vehicle engine fire exists.

The remedy consists of an inspection of the fuel tank for leaks as per the attached instructions. Then inspect the screws on the soft top mechanism covers (part numbers 64412600 and 64956400) for proper length. If the screws are 16-mm long, they can be re used. If 22-mm screws were used, replace them with 16-mm screws part number 4815.

The corrective action will require approximately 1.0 hour for inspection or approximately 5.0 hours if damage to the fuel tank exists.

We have accordingly sent notices to all owners of the affected vehicles advising them of this potential problem and requesting that they contact any Authorized Ferrari Dealer for the repairs, as per the attached notification letter.

Upon transmittal of the repair under the normal warranty system, we will, of course, reimburse you for the labor and applicable parts necessary to carry out this campaign.

Obviously, if you have any of the affected vehicles in your stock, you must not sell them until you have performed the necessary repairs. If you have already sold any vehicles with the chassis numbers specified in the enclosed instructions and have not yet sent in the retail sales cards, please do so at once so that we may notify these owners accordingly.

Thank you for your cooperation

Best Regards,

A handwritten signature in black ink, appearing to read 'William S. Story', written over a horizontal line.

William S. Story
Director of Technical Services

WSS:cc

RECALL CAMPAIGN NO. 162/1

SUBJECT : Ferrari F355 Fuel Tank Inspection Recall No. 162/1

VEHICLES : Ferrari F 355 F1 Spider M.Y. 1998 vehicles with a vehicle identification number between 29088 and 30041.

CONDITION : Damage to the fuel tank may have occurred during installation of the screws on the soft top mechanism covers (part numbers 64412600 and 64956400). Should such a condition occur, the result would be leakage of fuel from the damaged fuel tank.



REMEDY : Inspection of soft top mechanism cover screws for proper length. Replace the screws if they are 22mm with 16mm screws. If 22mm screws were used, check the fuel tank for leaks, as per the attached instructions.

PARTS : The new screws are identified by the following part number:

<u>Old Part</u> <u>Number</u>	<u>New Part</u> <u>Number</u>	<u>Quantity</u>	<u>Description</u>
	4815	2	16mm screw

COST : A) An initial supply of screws as well as one fuel cap to be used to test each vehicle will be sent to your dealership.

LABOR :

Tank inspection:	MEDEA Recall number	1621	Defect Code	01
	Component Code	1401	Cost Code	24
	Labor Operation	14011	Time	1.0 Hours

REIMBURSEMENT : Upon receipt of claim via MEDEA

INSTRUCTIONS FOR FUEL TANK INSPECTION

A: Preliminary: The fuel cap p.n. 4816 will be sent to you as a tool from our spare parts department and should be modified and re-used on each vehicle which is inspected at your dealership.

B: Procedure for inspection:

WARNING: NO SMOKING

HIGHLY FLAMMABLE MATERIAL. KEEP AWAY FROM SPARKS OR OPEN FLAMES. PROVIDE ADEQUATE VENTILATION. FUEL, WHEN SATURATED ON CLOTHING, WILL CAUSE SKIN IRRITATION. PROCEED ACCORDINGLY.



DO NOT PERFORM THIS PROCEDURE ON A WARM ENGINE.

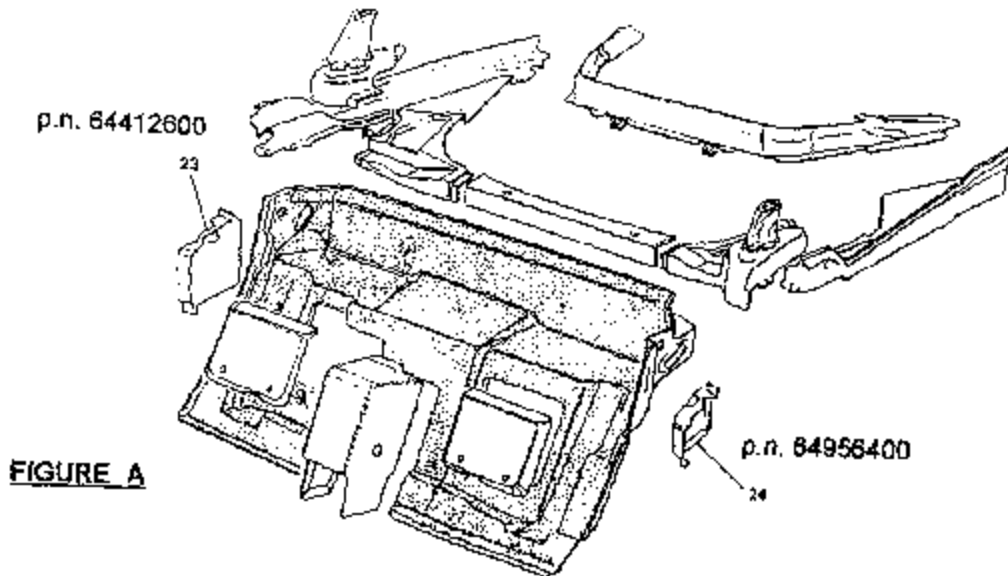

- 1 Disconnect battery (main switch).
- 2 Unscrew self-tapping lower fixing screws which attach interior covers p.n. 64412600 and p.n. 64956400 (reference item # 23 and item # 24 in figure A).
- 3 Cover rear fenders with fender covers.
- 4 Remove fuel tank fill cap to release pressure from the fuel tank.
- 5 Take the fuel cap p.n. 4816 and drill a hole in the center to enable the fitting of a nipple in order to connect a hand held pump with pressure gauge. We would suggest the use of a suitable coolant system pressure tester. The coolant tank fitting will have to be removed and the drilled fuel cap with fitting attached.
- 6 Check all connections between pressure gauge and fuel cap.

- 7 Install the modified fuel cap onto the fuel filler neck, making sure it is properly sealed.
- 8 Using adequate hose clamp pliers, compress the hose p.n. 126919 (reference fuel line #54 in figure B.) This operation is necessary in order to avoid any loss of pressure during the test.

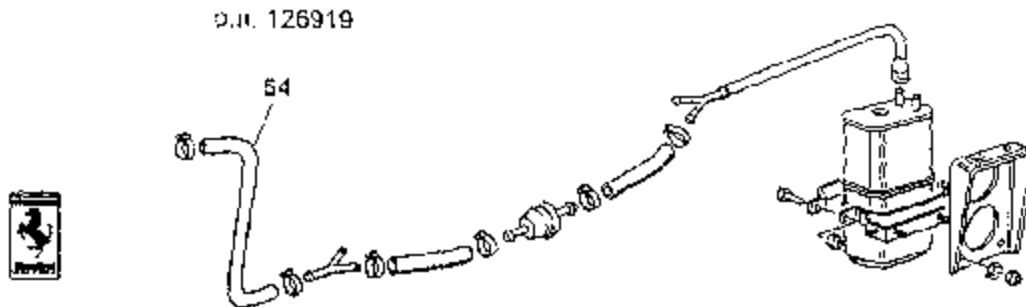

FIGURE B

- 9 Pressurize the fuel system with a max. pressure of 0,16 bar (2.32 psi)

NOTE: IT IS ABSOLUTELY PROHIBITED TO INCREASE THIS PRESSURE VALUE BECAUSE OF POSSIBLE DAMAGE TO OTHER FUEL SYSTEM COMPONENTS.

- 10 Keep the system under pressure for at least 15 minutes, monitoring the pressure gauge. If no drop of pressure is noticed within that period of time, damage to the fuel tank can be excluded. Otherwise, it will be necessary to remove the fuel tank for inspection as per the attached instructions.

NOTE: IF A DROP IN PRESSURE IS NOTICED, IT IS IMPORTANT TO FIRST CHECK ALL FUEL SYSTEM COMPONENT CONNECTIONS FOR LEAKS.

- 11 Remove modified fuel cap and the hose clamping pliers used in step 10.
- 12 Re-install the original fuel filler cap.
- 13 Re-attach battery (main switch).
- 14 Verify the length of the screws removed in step 2 (reference item # 23 and item # 24 in figure A) If they are 16mm in length, they may be reused. If they are 22mm in length, use new 16mm screws supplied under p.n. 4815.

RECALL CAMPAIGN NO. 162/2

SUBJECT : Ferrari F355 Fuel Tank Replacement Recall No. 162/2

VEHICLES : Ferrari F 355 F1 Spider M.Y. 1998 vehicles with a vehicle identification number between 29088 and 30041.

CONDITION : Damage to the fuel tank may have occurred during installation of the screws on the soft top mechanism covers (part numbers 64412600 and 64956400). Should such a condition occur, the result would be leakage of fuel from the damaged fuel tank.



REMEDY : If after inspection of the fuel tank shows damage, the fuel tank needs to be replaced as per the attached instruction.

PARTS :

<u>Old Part</u>	<u>New Part</u>		
<u>Number</u>	<u>Number</u>	<u>Quantity</u>	<u>Description</u>
	165652	1	Fuel Tank
	138453	1	O ring
	154802	1	Gasket

COST : A) If the fuel tank needs to be replaced, the above parts must be ordered overnight from our parts department.

LABOR : Tank replacement:

MEDEA Recall number	1622	Defect Code	01
Component Code	1401	Cost Code	24
Labor Operation	14010	Time	5.0 Hours

REIMBURSEMENT : Upon receipt of claim via MEDEA

INSTRUCTIONS FOR FUEL TANK REPLACEMENT

A: Preliminary: The replacement fuel tank is supplied as a spare part by the part number, 165652 listed on the previous page

B: Procedure for installation

WARNING: NO SMOKING

HIGHLY FLAMMABLE MATERIAL. KEEP AWAY FROM SPARKS OR OPEN FLAMES. PROVIDE ADEQUATE VENTILATION. FUEL, WHEN SATURATED ON CLOTHING, WILL CAUSE SKIN IRRITATION. PROCEED ACCORDINGLY.



BE SURE TO UTILIZE PROPER EQUIPMENT FOR SAFE TRANSFER OF FUEL FROM CAR TO APPROVED FUEL CONTAINER.

DO NOT PERFORM THIS PROCEDURE ON A WARM ENGINE.

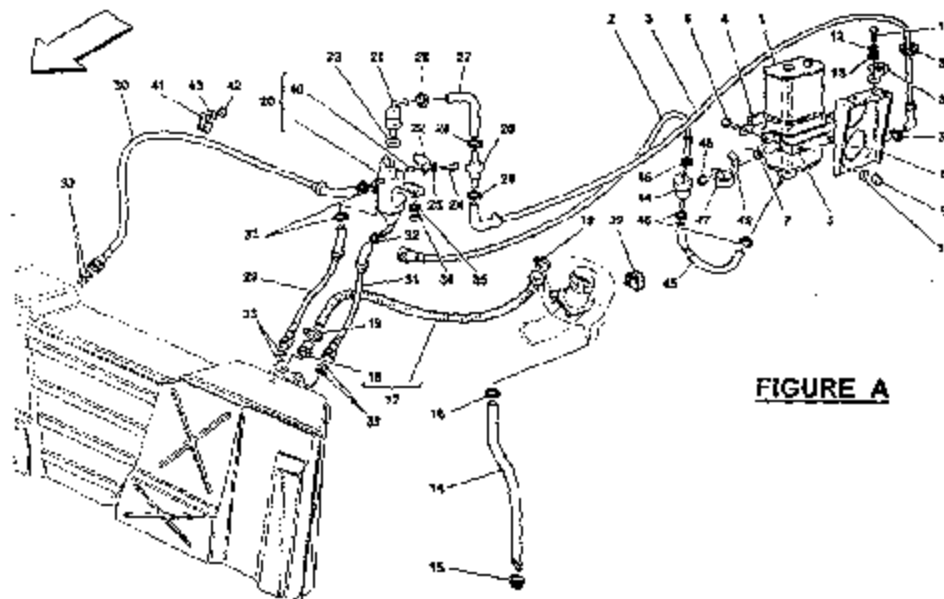

- 1 Disconnect battery (main switch).
- 2 Cover rear fenders with fender covers.
- 3 Remove fuel tank fill cap to release pressure from the fuel tank.
- 4 Lift vehicle and remove fuel tank access panel. Drain the fuel from the tank into an approved fuel container.
- 5 Remove fuel tank vapor lines at top of fuel tank utilizing special tool part number 95970126. (Items No.30, No.29, No. 31, and No.17 In figure A)

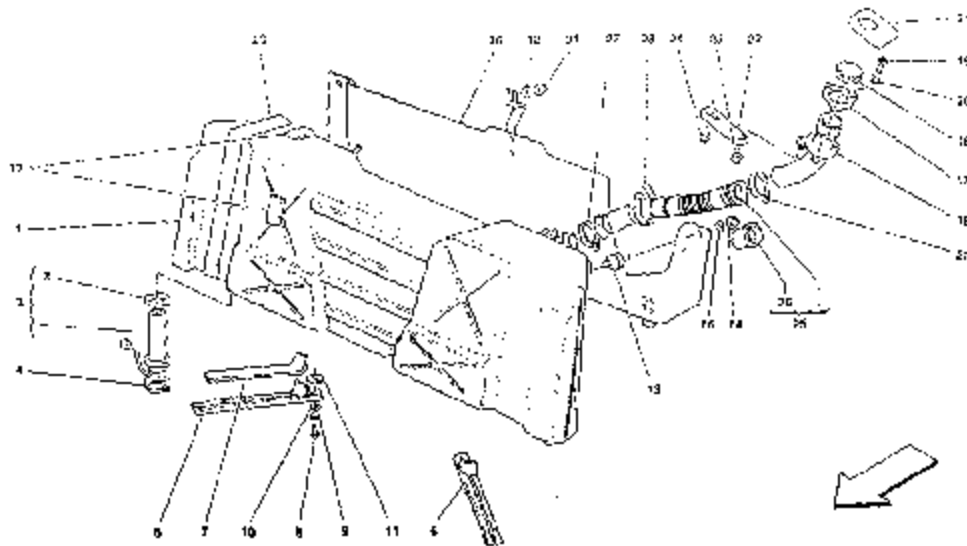

FIGURE B

- 6 Loosen fuel tank fill tube clamp at top and disconnect tube from fuel tank. (Item No.27 in figure B)
- 7 Remove fuel supply and return lines from fuel pump assembly.
- 8 Shift gear box into third gear and disconnect shift rod under fuel tank.
- 9 Place a transmission type jack under the fuel tank and remove fuel tank securing straps.
- 10 Drop the fuel tank taking care to disconnect the fuel pump connections and to take note of the fuel line routing through the chassis.

NOTE: Please be aware of the location of the inlet and outlet fitting at the fuel pump due to the fact that they are the same fitting and can be installed in reverse.

- 11 Remove connections for fuel level sending unit.
- 12 Remove fuel pump assembly and install in new tank (part number 165652) with new seal, part number 138453.
- 13 Re-install fuel level sending unit with new gasket, part number 154802.
- 14 Install the new fuel tank taking care to reconnect the fuel pump fuel sending unit electrical connections and route the fuel lines through the chassis in the proper manner. Be sure to tighten fuel tank straps without overtightening and make sure wires for fuel pump are routed properly when fuel tank is installed.
- 15 Re-install shift control rod and adjust the gear shifter.
- 16 Re-connect fuel vapor lines to fuel tank and fuel tank fill tube. Please ensure that the fuel tank vapor line fitting "O" rings are in good condition before replacement of the connector and that the fill tube clamp is properly tightened.

- 17 Re-connect fuel feed and return lines to fuel pump, tighten to a torque of 25 Nm (18.44 lb. ft.) with a crowfoot wrench.
- 18 Transfer about 3 gallons of fuel into car fuel tank, replace fuel tank filler cap, connect battery, start vehicle and check for leaks. **REPAIR ANY LEAKS.**
- 19 Re-install fuel tank access panel and transfer remainder of fuel into vehicle fuel tank.
- 20 Re-install fuel tank fill cap.



Recall 162
Fuel Tank Inspection

List of Affected Serial Numbers

<u>Serial No.</u>	<u>Assembly No.</u>	<u>Vehicle Description</u>
111964	29089	F355F1 SP USA MY98
111965	29091	F355F1 SP USA MY98
111981	29105	F355F1 SP USA MY98
111982	29107	F355F1 SP USA MY98
111998	29119	F355F1 SP USA MY98
112012	29136	F355F1 SP USA MY98
112013	29138	F355F1 SP USA MY98
112029	29167	F355F1 SP USA MY98
112030	29153	F355F1 SP USA MY98
112045	29189	F355F1 SP USA MY98
112161	29371	F355F1 SP USA MY98
112162	29373	F355F1 SP USA MY98
112163	29380	F355F1 SP USA MY98
112164	29386	F355F1 SP USA MY98
112215	29297	F355F1 SP CDN MY98
112254	29344	F355F1 SP CDN MY98
112292	29391	F355F1 SP CDN MY98
112304	29395	F355F1 SP USA MY98
112305	29401	F355F1 SP USA MY98
112319	29409	F355F1 SP USA MY98
112320	29414	F355F1 SP USA MY98
112333	29423	F355F1 SP USA MY98
112334	29431	F355F1 SP USA MY98
112346	29449	F355F1 SP USA MY98
112349	29444	F355F1 SP USA MY98
112350	29459	F355F1 SP CDN MY98
112366	29454	F355F1 SP USA MY98
112367	29461	F355F1 SP USA MY98
112380	29469	F355F1 SP USA MY98
112381	29476	F355F1 SP USA MY98
112382	29484	F355F1 SP CDN MY98
112397	29482	F355F1 SP USA MY98
112398	29490	F355F1 SP USA MY98
112413	29498	F355F1 SP USA MY98
112414	29508	F355F1 SP USA MY98
112415	29510	F355F1 SP CDN MY98
112424	29517	F355F1 SP USA MY98
112425	29524	F355F1 SP USA MY98
112426	29528	F355F1 SP CDN MY98
112440	29533	F355F1 SP USA MY98
112441	29541	F355F1 SP USA MY98
112457	29548	F355F1 SP USA MY98
112458	29556	F355F1 SP USA MY98

<u>Serial No.</u>	<u>Assembly No.</u>	<u>Vehicle Description</u>
112459	29560	F355F1 SP CDN MY98
112473	29563	F355F1 SP USA MY98
112474	29570	F355F1 SP USA MY98
112488	29579	F355F1 SP USA MY98
112489	29591	F355F1 SP USA MY98
112503	29589	F355F1 SP USA MY98
112504	29593	F355F1 SP USA MY98
112518	29810	F355F1 SP USA MY98
112519	29614	F355F1 SP USA MY98
112520	29624	F355F1 SP USA MY98
112634	29736	F355F1 SP USA MY98
112635	29738	F355F1 SP USA MY98
112647	29750	F355F1 SP USA MY98
112648	29752	F355F1 SP USA MY98
112662	29760	F355F1 SP USA MY98
112663	29764	F355F1 SP USA MY98
112676	29782	F355F1 SP USA MY98
112677	29785	F355F1 SP USA MY98
112690	29796	F355F1 SP USA MY98
112691	29798	F355F1 SP USA MY98
112706	29810	F355F1 SP USA MY98
112707	29812	F355F1 SP USA MY98
112720	29826	F355F1 SP USA MY98
112721	29828	F355F1 SP USA MY98
112735	29840	F355F1 SP USA MY98
112736	29842	F355F1 SP USA MY98
112747	29850	F355F1 SP USA MY98
112748	29852	F355F1 SP USA MY98
112762	29877	F355F1 SP USA MY98
112763	29878	F355F1 SP USA MY98
112778	29892	F355F1 SP USA MY98
112779	29894	F355F1 SP USA MY98
112795	29908	F355F1 SP USA MY98
112796	29910	F355F1 SP USA MY98
112809	29923	F355F1 SP USA MY98
112810	29925	F355F1 SP USA MY98
112826	29940	F355F1 SP CDN MY98
112827	29942	F355F1 SP CDN MY98

***Highlighted serial numbers have already had Recall 152 performed.

Ferrari

Ferrari North America, Inc.

September 1998

«MXFRST» «MXLAST»
«MXADD1»
«MXADD2»
«MXCITY», «MXST» «MXZIP»

Serial Number: «AOMAT»



Dear Ferrari Customer:

This notice is sent to you in accordance with the requirements of Title 49, United States Code, Part A, Subchapter II.

Ferrari S.p.A., the manufacturer of Ferrari automobiles, has determined that a defect may exist in certain 1998 model year F355 F1 Spider Ferrari vehicles.

On vehicles with the vehicle assembly numbers between 29088 and 30041 damage to the fuel tank may have occurred during installation of the screws on the soft top mechanism covers. Should such a condition occur, the result would be leakage of fuel from the damaged fuel tank. As with any type of fuel system leakage, the possibility of a vehicle engine fire exists.

The corrective action for the above listed repair will be performed free of charge to you and will require approximately 5.0 hours to complete. Please plan, however, to leave your vehicle with the dealer all day to allow the dealer some flexibility for scheduling your repairs.

By the time you receive this letter, the Authorized Ferrari Dealer will have been supplied with the instructions and parts to perform the inspection and/or repair. If the Dealer fails or is unable to make the necessary repairs free of charge within a reasonable time, you should inform the National Headquarters Office of Ferrari North America, Inc.

250 Sylvan Avenue
Englewood Cliffs, NJ 07632
(201) 816-2651 (National Technical Office)

Although we urge you to immediately call the number indicated on the previous page, if the affected vehicle is not repaired free of charge to you or within a reasonable time, you may also contact the Administrator of the National Traffic Safety Administration in Washington, D.C. 20590 or call the Auto Safety Hot line at 800-424-9393 nationally and (202) 366-0123 for Washington, D.C. area residents.

We urge you to comply with this notice promptly and we apologize for any inconvenience this may cause.

Best Regards,



A handwritten signature in black ink, appearing to read "William S. Story". The signature is written in a cursive style with a long horizontal stroke extending to the right.

William S. Story
Director of Technical Services

WSS:cc



U.S. Department
of Transportation

**National Highway
Traffic Safety
Administration**

SEP 14 1998

400 Seventh St., S.W.
Washington, D.C. 20590

Mr. William S. Story
Director, Technical Services
Ferrari North America, Inc.
250 Sylvan Avenue
Englewood Cliffs, NJ 07632

NSA-11paw
98V-223

Dear Mr. Story:

This acknowledges receipt of your Defect Information Report dated September 8, 1998, submitted in accordance with 49 CFR Part 573, "Defect and Noncompliance Reports." This recall involves 81 Ferrari North America, Inc. (Ferrari) 1998 F355 F1 Spider model vehicles manufactured from March 1, 1998 through May 15, 1998. Damage to the fuel tank may have occurred during installation of the soft top mechanism cover screws. **The assigned ID Number for this recall campaign is 98V-223 (Ferrari Recall No. 162).**

Ferrari is responsible for the remedy of these vehicles from this date forward, regardless of vehicle age, mileage, or ownership.

Quarterly Status Reports

As stated in Part 573.6, submission of the first of six consecutive quarterly status reports is required within one month after the close of the calendar quarter **in which notification to purchasers occurs.** As stated in your report, owner notification was expected to begin during September 1998. If owner notification was mailed out near the end of September, the first quarterly report will be due by January 30, 1999.

If you have any questions, please contact Mrs. Pat Wallace at (202) 366-5232 or fax at (202) 366-7882.

Sincerely,

Jonathan D. White, Chief
Recall Analysis Division
Office of Defects Investigation
Safety Assurance

