



Installation Instructions

#127834-AP1: Reinforcement Parts Kit, Fiberlite Pod Replaceable Tongue Frame, Front Corner Welds

Introduction

These instructions are to help guide the installation of the Reinforcement Parts Kit for Pods and XL units.

NOTE: The procedure described by these instructions shall only be undertaken by those with a reasonable level of experience in general mechanics and with some knowledge of overall trailer design and construction. No certification is necessary.

Required Equipment: Impact Driver, Power Drill, 1/2" drill bit (and smaller sizes for incremental drilling), Angle Grinder

Installation Steps

- Utilizing the parts list (Figure 1a) and the Parts diagram (Figures 1b & 1c), ensure that all of the necessary components are included in the kit prior to undertaking the installation.

PARTS LIST: #127834-AP1 POD CORNER CAPS REPAIR ASSEMBLY KIT			
ITEM #	PART #	DESCRIPTION	
3	127834-PD1	WELDMENT - CORNER CAP, POD CURBSIDE, RT FRAME REINFORCEMENT	1
4	127834-PD2	WELDMENT - CORNER CAP, POD STREETSIDE, RT FRAME REINFORCEMENT	1
5	118501-325	SCREW - CAP, HEX HEAD, 1/2-20 UNF X 3-1/4" LONG, GRADE 8, PLATED	4
6	118501-001	SCREW - CAP, HEX HEAD, 1/2-20 UNF X 1-1/2" LONG, GRADE 8, PLATED	10
7	119660-001	NUT - STOVER, 1/2-20 UNF, GRADE 8, PLATED	14
8	119661-001	WASHER - FLAT, 1/2", HARDENED, FOR GRADE 8 HARDWARE, PLATED	28

Figure 1a) Parts List Table

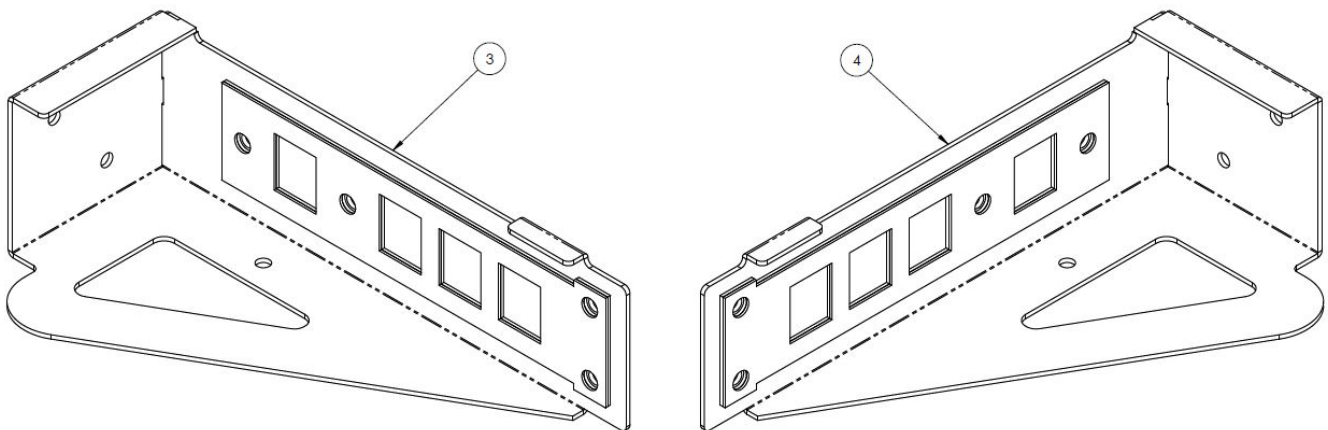

Figure 1b) Corner Caps, items #3 and #4

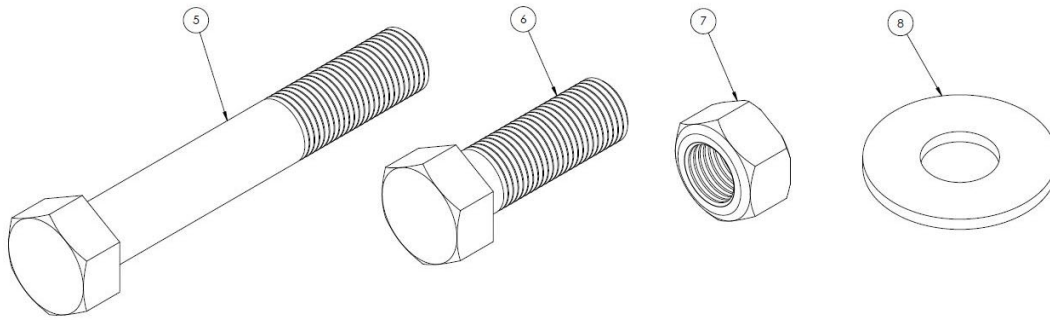

Figure 1c) Fastening hardware, items #5-8

2. Ensure the trailer's tongue jack is properly deployed to support the tongue weight of the trailer, and that wheel chocks are utilized to prevent any unwanted movement. Release any load from the trailer jacks mounted at the front of the rectangular frame and uninstall these jacks along with their mounts (powder-coated in a textured black). *NOTE: Some trailers may not have the front jack mounts. If the trailer being worked on does not have these mounts, then disregard this step.*
3. Ensure there are no protruding weld beads along the top, bottom, front, and side faces of the rectangular frame in the area shown in Figure 2. The proper fitment of the Corner Caps requires that these faces are flat and the corners are not jagged. Grind these weld areas down if necessary. See the picture below for an example of how this area should look.



Figure 2) Welds on the front curbside corner of the frame

4. Set the Corner Cap on the front corner of the frame with the diagonal face on the bottom of the trailer as shown in Figure 3a and 3b. The top face of the Corner Cap has tabs that will keep the piece in place until it is secured. Check to make sure no welds in the area shown in Figure 2 are interfering with the placement of the Corner Cap.



Figure 3a) Streetside Corner Cap top view



Figure 3b) Streetside Corner Cap bottom view

5. Place the trailer jack mount up against the two corresponding holes in the Corner Cap, in the same location the jack was in previously. Using 2X of the 1-1/2" screws (Item #6), 4X of the washers (Item #8), and 2X of the stover nuts (Item #7), securely fasten all parts to the trailer frame. The top face of the trailer frame is likely covered with an aluminum deck plate and other equipment. The underside of the Corner Cap should provide a large enough cutout for accessing the inside face of the trailer frame. *NOTE: If this trailer did not have front jack mounts, then fasten the Corner Cap to the trailer frame as instructed but without the jack mounts.*

6. With the Corner Cap securely in place, mark the center positions of the remaining holes in the Corner Cap. There will be two in a diagonal pattern on the front face, two on the side face to the rear of the jack mount holes, and one on the bottom face centered between the jack mount holes. Drill out holes up to 1/2" completely through the aluminum material. The front beam is a tube, drill through both walls. *NOTE: Depending on imperfections in the manufacturing process, it may be necessary to drill a hole incrementally larger than 1/2" to ensure the screws fit properly.*

7. When the remaining holes have been sufficiently drilled, fully secure the Corner Cap. This will require 2X of the 3-1/4" screws (Item #5) for the front face, 3X of the 1-1/2" screws (Item #6) for the side/bottom faces, 5X of the stover nuts (Item #7), and 10X of the washers (Item #8). **IMPORTANT: DO NOT over-torque the two front screws when installing the Corner Cap (Item #5).** Putting too much torque on these screws may cause the front aluminum tube of the frame to buckle inwards, compromising its strength. Check the shape of the tube as the screws are tightened to ensure it is not being bent. When fully secured, the Corner Cap should appear as in Figure 4a and 4b. *NOTE: Figure 4a/b does not show the trailer jack mounts as described in Step 5.*



Figure 4a) Secured streetside Corner Cap top view



Figure 4b) Secured streetside Corner Cap bottom view

8. Repeat Steps 4 through 7 for the other corner. Ensure that both Corner Caps are securely installed and are not interfering with any functions of the generator or other frame-mounted equipment.



2500 S Tejon Street
 Englewood, CO 80110
 (303) 936-7432
 sales@pelsue.com