



SIB 32 01 23

RECALL 23V-123 Milled Handbrake Lever Pivot

2023-03-21

Model	Model Description
K67	S 1000 RR
KM3	M 1000 R

The affected vehicles have been marked with campaign number **0000321300** in AIR.

In order to determine if a specific vehicle is affected by this campaign it will be necessary to verify the vehicle VIN in AIR (Aftersales Information Research). Based on the response of the system, either proceed with the repair or take no further action. Please note, open campaigns or vehicle stops may not appear in DCS Warranty Vehicle Inquiry or sales systems until 24-72 hours after they are announced, therefore AIR is always the recommended method for determining open campaigns and vehicle stops.

## NHTSA STATEMENT

Please be reminded that it is a violation of federal law (The Safety Act) for you to sell, lease or deliver any new motorcycle covered by this notification until the recall repair has been performed. This means that dealers may not legally deliver new motorcycles to consumers until they are fixed or use/sell replacement equipment/parts subject to this recall. Note also that substantial civil penalties apply to violations of the Safety Act. Also, you should not sell, lease or deliver any used motorcycles subject to a safety recall until the repair is completed. Please follow any special instructions that we provide to you for the return or disposition of recall parts.

## SITUATION

The affected vehicles have been built with a milled hand brake lever with part number 37 72 8103376.

This lever is installed as standard equipment for the M 1000 R's and is part of the Billet pack with option code 079E on the S 1000 RR's.

A dimensionally incorrect pivot pin of that hand brake lever can cause a reduction in blowby clearance. The pressure in the brake system can then be insufficient. In specific riding situations a changing pressure point in the hand brake lever can be noticed.

## PROCEDURE

For vehicles that have not been delivered, the service campaign must be carried out before delivery to customers.

The pivot pin of the handbrake lever will be replaced according to the attached repair manual "00 60 419 Replace fulcrum pin handbrake lever." The new pivot pin is marked with more than one groove or furrow for

a better identification when compared to the old construction stage

Note: No other repair solution will be accepted as a warranty claim.

Since February 9th, 2023, only vehicles without this fault pattern are delivered in the series.

## **PARTS INFORMATION**

Obtain and confirm the part numbers for your specific vehicle by entering the chassis number in ETK which takes into account specific equipment and/or options.

Additional parts like gaskets, hardware and chemicals may be required for the complete repair.

### **Part Number**

32 72 4 A2D 330	Pivot Pin
-----------------	-----------

## **CLAIM INFORMATION**

Please submit claims via the normal claim process using the information below:

### **Defect code**

00 00 32 13 00	Rework Handbrake Lever
----------------	------------------------

### **Labor Operation**

00 60 419	Replace pivot pin of handbrake lever	5 FRU
+00 60 919	Replace pivot pin of handbrake lever	4 FRU

FRUs includes all repair procedures to complete the task with allowance for necessary ancillary tasks (e.g., visual inspection, lubrication, cleaning parts etc.) and administrative tasks.

Labor operation code 00 60 419 is a Main labor operation. If you are using a Main labor code for another repair, use the Plus code labor operation instead.

## **TREAD Act Reimbursement - Qualifying Prior Customer-Pay Repairs**

If your center is presented with a reimbursement request, BMW of North America, LLC will reimburse qualifying customer-pay repairs that were performed on affected vehicles up to 10 days after the date the owner notification letter was sent out by BMW.

If the customer previously paid for a qualifying repair, verify in AIR that the VIN is affected by the recall campaign and proceed as applicable:

### **The customer arrives with an affected vehicle to your workshop**

- Perform the open Recall repair outlined in this bulletin, regardless of previous repair history.
- If the prior repair qualifies (see below), submit for both the Recall repair and the customer-pay reimbursement (Separate repair line items/separate defect codes).

Or:

### **The customer only presents your center with a customer-pay invoice for the prior repair**

- If the vehicle and the prior repair qualifies (see below), submit for the customer-pay reimbursement

Copyright ©2023 MOTORRAD USA, a division of BMW of North America, LLC. All Rights Reserved

## Customer-pay Invoice Review and Reimbursement Qualification and Procedure

Review and verify that the prior customer-pay invoice (BMW center or independent repair shop) contains a repair that pertains to the recall campaign. Only the repair outlined in the published safety recall service bulletin is eligible for reimbursement.

If this prior repair qualifies, submit a claim for reimbursement:

- Verify in AIR that the VIN was affected by the recall campaign
- Use defect code 85 99 00 45 NA for the amount requested under sublet 03.
- Comment: (32 01 23 Recall 23V-123 Milled Handbrake lever pivot) - Reimbursement for allowable expenses that relate to performing the prior qualifying customer-pay repair.
- Use current repair date and mileage for claim submission.
- Retain copies of the customer paid invoice and the current repair invoice in your records.
- Reimburse the customer directly (parts and labor).

Contact warranty via an IDS ticket with any questions.

Retain the original customer pay invoice in your files; this documentation may be requested by BMW during the claim review process.

**Note:** A repair performed on a non-affected vehicle or the diagnosis and repair of other unrelated issues do not qualify for reimbursement.

This claim submission for the prior customer-pay reimbursement, when it is submitted as outlined under Defect Code 85 99 00 45 NA, **will not close** the Open Safety Recall on the vehicle.

## QUESTIONS REGARDING THIS BULLETIN

Technical inquiries	Contact the BMW Technical Support Group via TSARA
Warranty inquiries	Submit an IDS ticket to the Warranty Department
Parts inquiries	Submit an IDS ticket to the Motorrad Parts Department

### Supporting Materials

[picture\\_as\\_pdf RECALL 23V-123 Milled Handbrake Levers.pdf](#)

[picture\\_as\\_pdf RM\\_0000321300\\_EN.pdf](#)



## OE81 - M 1000 R

### 00 60 419 Replacing fulcrum pin for handbrake lever



#### ATTENTION

##### Hard or sharp-edged components

Painting can be scratched or damaged

- Use underlay and mask the critical area.

Additional work: 52 510 Mounting and dismounting the rear-wheel stand with special tools (for motorbikes without a centre stand)

# 1

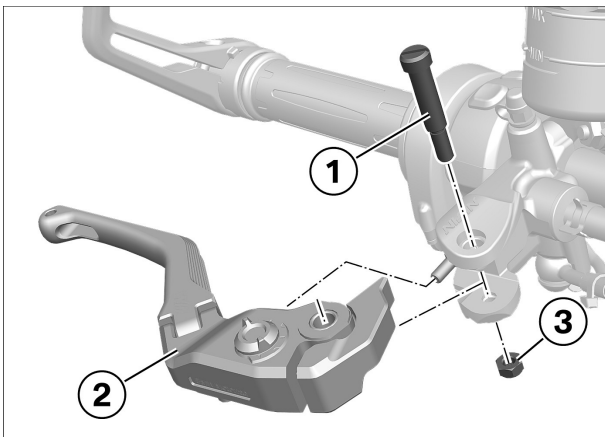

#### ► Removing hinged brake lever for front-wheel brake

- Remove nut (3).
- Remove bolt (1).
- Remove brake lever (2).

# 2

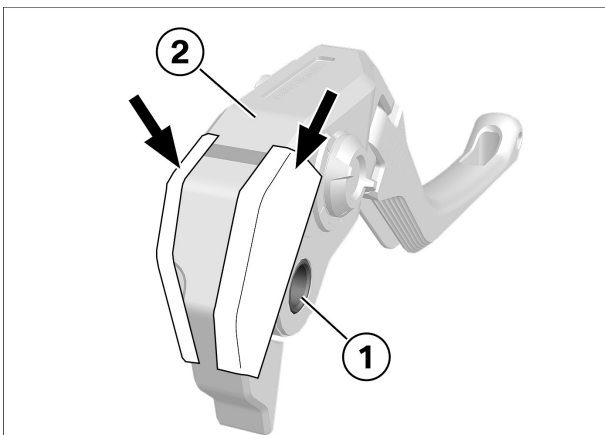

#### ► Remove fulcrum pin of handbrake lever

- Press plain bearing bush (1) half out of hand brake lever (2) with a suitable tool  
(for example with M8 cylinder head screw in bench vise) until intermediate lever can be removed
- Protect hand brake lever (2) from damages in the appropriate areas (arrows).

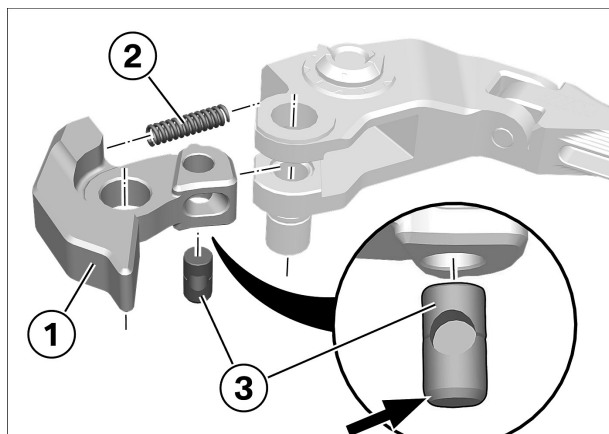

- Remove brake actuation **(1)** with pressure spring **(2)**.
- Remove fulcrum pin **(3)** and replace.

### 3

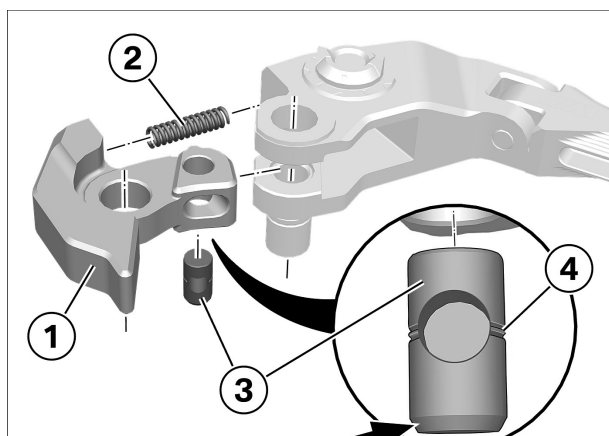

#### ► Install fulcrum pin in hand brake lever

- Pay attention that **new** fulcrum pin **(3)** with more than one channel **(4)** will be installed.
- Install **new** fulcrum pin **(3)** with bevel at **bottom side (arrow)** into brake actuation **(1)** and grease **slightly**.



#### Grease

Staburags NBU 30 PTM	07 55 9 056 992
----------------------	-----------------

- Position opening of fulcrum pin **(3)** in direction to hand brake lever /plunger.
- Install pressure spring **(2)** with brake actuation **(1)**.

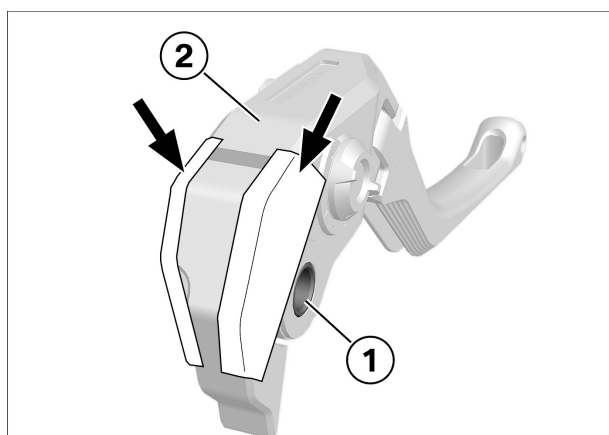

- Press plain bearing bush **(1)** **flush** into hand brake lever **(2)** with suitable tool (for example with M8 cylinder head screw in bench vise).
- Protect hand brake lever **(2)** from damages in appropriate areas **(arrows)**.

4

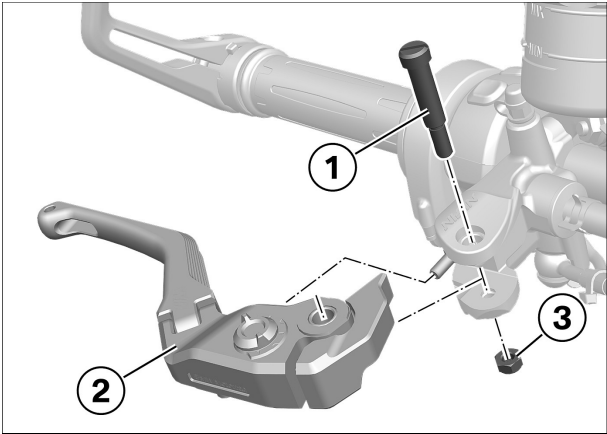

► Install brake lever for front brake

- Lubricate screw (1), spare the thread.

 Grease	
Universal-Gleitspray	81 22 9 407 711

- Install folding brake lever (2).
- Install screw (1) and nut (3).

 Tightening torques		
Hand lever to handbrake fitting		
M6, screw	1 Nm	
M6, renew nut Thread-locking compound (mechanical)	<b>Tightening sequence:</b> <b>Tighten the nut, counter-holding the bolt</b>	
	6 Nm	

5

► Final check of work performed

- Check the following:
  - \_ The work as performed achieved the intended purpose
  - \_ All reservoirs and containers have been filled and all fluids and lubricants are at their correct levels.
  - \_ All threaded fasteners released beforehand have been correctly retightened.
  - The fuel system is free of leaks.
  - \_ The lights and signalling equipment are fully operational and the vehicle is roadworthy.
  - \_ The brake pads of the front and rear brakes are bedded against the brake discs.

▷ Function test, engine start suppression  
Check

- Set the emergency-off switch (kill switch) to the operating position ("ON"). Getriebe in
- Select neutral.
  - » Switch on the ignition.
- Neutral indicator light "N" lights up.
  - » Select a gear.
- Neutral indicator light "N" goes out.
  - » Press the starter button.
- Starter does **not** operate.
- Extend the side stand.
- Pull the clutch lever.
  - Press the starter button.

- » Starter does **not** operate.
- Retract the side stand..
- Press the starter button without releasing the clutch lever.
- » Starter operates.

**Result**

Not all test steps completed successfully.

**Measure**

- Check the appropriate parts with the BMW Motorrad diagnostic system.