

Recall Inspection and Repair Instructions

Cahaba Suspension Springs

NHTSA Recall # 23V-104

Tiffin Motorhomes Recall # TIF-128

Models Involved: 2021 – 2022 Cahaba

Tools Needed:

Floor Jack
Jack Stands
Wheel Chocks
13mm Wrench or Socket

Parts Needed:

5124403, front 4WD spring kit
5126748, front 2WD spring kit
5145042, rear spring 2WD & 4WD kit

FLAT RATE CODE & TIME ALLOWED: *When filing the warranty claim for payment, please use the appropriate flat rate code and time. Please note that stacking flat rate codes is **NOT** allowed.*

For 2WD units ONLY – CH9869RC01, 0.25 hours unit is equipped with stock Mercedes Benz springs and NOT INVOLVED in the recall.

All rear springs removed from the motorhome, even damaged springs or remaining parts of a missing spring, must be returned to SuperSprings using the return label included in the box with the new parts.

For units with upgraded suspension system – **CH9870RC01** 1.00 hour to replace rear springs with correct size and to relocate & replace the front springs.

Front 4WD axles will need to be inspected by a Mercedes Benz repair facility to determine if there is any damage present. The MB dealer is required to contact Tiffin Motorhomes to discuss the results of the inspection prior to any repairs. If needed, a sublet for the inspection or replacement can be filed using flat rate code **CH9871RC01**.

Inspection Procedure for 2WD units:

1. Determine if stock or the upgraded suspension springs are installed on the unit.



Front Stock Spring



Rear Stock Spring



Front Upgraded Spring



Rear Upgraded Spring

2. If Mercedes Benz stock springs are installed, no further work is needed. Please file a warranty claim using the flat rate code CH9869RC01 to Tiffin Motorhomes to clear the recall.
3. If the upgraded suspension springs are installed, please complete the repair procedure below.

Repair Procedure for units with Upgraded Suspension:

Rear Springs:

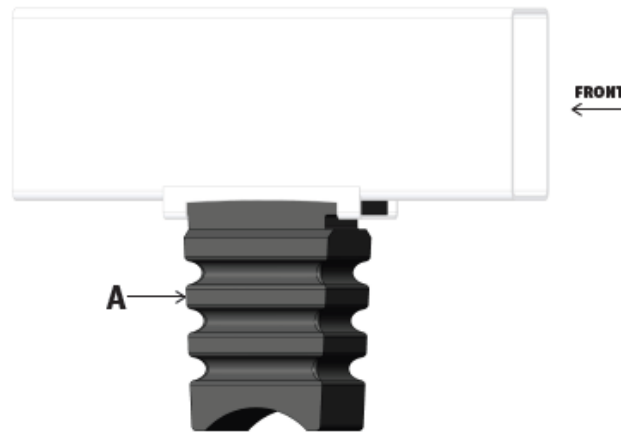

DRIVER SIDE (PASSENGER SIDE SIMILAR)

BEFORE INSTALLATION: Ensure the vehicle is on a level surface, the parking brake is ON, with the ignition OFF, and place blocks in front of and behind the front tires to prevent the vehicle from moving.

DURING AND/OR AFTER INSTALLATION: Ensure emergency brake cables are not touching the SuperSprings. Secure any cables out of the way with zip ties or by re-routing. Ensure all A/C lines, brake cables, and frame are clear of contact or interference.

1. Park the vehicle on a hard, level surface and engage the emergency brake. Place chocks in front and behind wheels to prevent rolling. Observe all safety precautions and wear safety glasses.
2. Raise the rear of the vehicle allowing the axle to hang free and rest the frame on the safety jack stands rated for the vehicle.
3. Remove the incorrect sized springs from the underside of the frame by pulling and twisting the rubber tabs out of the frame brackets.
4. Remove new SumoSPrings (see "A" above) from the box.
5. Working from forward of the axle, insert the top rear tab (end with the cut-out notch) at an angle, into the rear part of the frame bracket. Push the SumoSPring to the rear so the tab is seated as far back into the frame bracket as possible.
6. With the cut-out notch seated fully rearward, grab one corner of the front tab of the SumoSPrings with long nosed pliers or vice-grips and turn it up under force to just start the front tab into the front frame bracket.
7. Once the corner of the tab is started into the bracket, use a flat spade screwdriver or small handheld pry tool to continue pushing the remaining portion of the tab into place.

8. Once the front tab is in place in the frame bracket, push the whole SumoSPring forward to seat it in place.
9. The SumoSPring should now be fully seated and centered over axle.
10. Repeat steps 3-9 for the other side of the vehicle.
11. Jack up vehicle, remove safety jack stands and carefully lower the vehicle to the hard surface. Remove wheel chocks.

Front Springs:

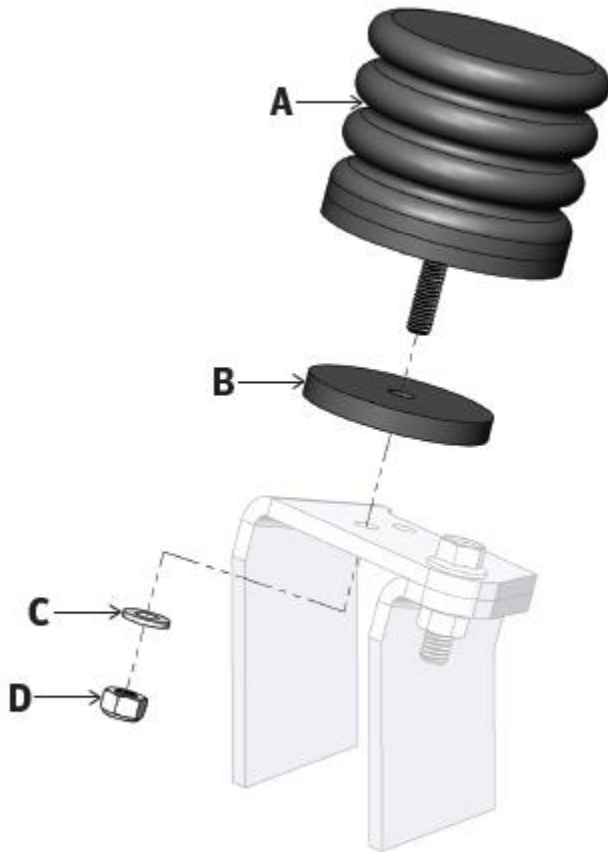

DRIVER SIDE (PASSENGER SIDE SIMILAR)

PARTS LIST

Item	Part #	Discription	QTY
A	511426	SumoSPrings Black -47	2
B	512009	2 ½" Spacer	2
C	512215	M8 Flat Washer	2
D	512214	M8 Hex Nut	2

1. Park the vehicle on a hard, level surface and engage the emergency brake. Place chocks in front and behind wheels to prevent rolling. Observe all safety precautions and wear safety glasses.
2. Raise the front of the vehicle allowing the suspension to unload approximately 50% and rest the frame on the safety jack stands rated for the weight of the vehicle. Turning the wheels left or right will aid in providing more room for installation.
3. Starting on the driver's side, remove the existing SumoSPring from the mounting bracket and discard.
4. Remove the new SumoSPring from the box and place the spacer (item B) on the stud of the SumoSPring (item A).
5. Apply the blue thread locker to the stud of the SumoSPring and install onto the factory mounting bracket. Ensure the stud is inserted into the **upper** hole of the mounting bracket.

6. Place the flat washer (item C) over the stud and thread on the M8 hex nut (item D) and torque to 20 ft. lbs. Do not over tighten the nut.
7. Repeat steps 3 through 6 on the passenger side of the vehicle.
8. Raise the vehicle, remove safety jack stands and carefully lower vehicle to the hard surface. Remove the wheel chocks in front and back of the rear wheels.
9. **On 4WD units ONLY:** Front 4WD axles will need to be inspected by a Mercedes Benz repair facility to determine if there is any damage present. The MB dealer is required to contact Tiffin Motorhomes to discuss the results of the inspection prior to any repairs.