



PREVOST

SAFETY RECALL

SR22-10

DATE :	Month 2022	SECTION :	18 BODY
SUBJECT:	REAR CROSS SEAT HARDWARE		

First Release

mm-dd-yy

APPLICATION

NOTICE TO SERVICE CENTERS

*Verify vehicle eligibility by checking warranty bulletin status with **SAP** or via **ONLINE WARRANTY SYSTEM** available on Service / Warranty tab of PrevoSt website.*

Model	VIN
X3-45 Commuter Model Year: 2021 - 2022	 From [REDACTED] up to [REDACTED] incl.

This Safety Recall does not necessarily apply to all the above-mentioned vehicles, some vehicles may have been modified before delivery. The owners of the vehicles affected by this recall will be advised by a letter indicating the Vehicle Identification Number (VIN) of each vehicle concerned.

DESCRIPTION

On vehicles affected by this recall, the rear bench seat frame could be loose. Follow the instructions to properly tighten the bolts on the rear bench. In case of missing hardware, refer to the parts list below.

MATERIAL

Parts may be required depending on seat condition.

Part No.	Description	Qty
868067	SCR CAP HEX 1/2-13X3 G5 ZP	A/R
868066	SCR CAP HEX 1/2-13X1 1/4 G5 ZP	A/R
865780	NUT	A/R
868070	SCR CAP HEX 3/8-16X1 G5	A/R
868116	WSH FL 3/8 X 1 X 11GA	A/R

NOTE
Material can be obtained through regular channels.

SAFETY PRECAUTIONS

- Eye protection should always be worn when working in a shop.
- Rules for Personal Protection Equipment should always be respected. Wear your PPE including but not limited to the following:



Safety First!



PROCEDURE



DANGER

Park vehicle safely, apply parking brake, stop the engine. Prior to working on the vehicle, set the ignition switch to the OFF position and trip the main circuit breakers equipped with a trip button. On Commuter type vehicles, set the battery master switch (master cut-out) to the OFF position.

Lockout & Tag out (LOTO) must be performed during set-up, maintenance or repair activities. Refer to your local procedure for detailed information regarding the control of hazardous energy.

Removing the Cushions

1. Undo single bolt at the front of the cushion.

Tip: Screw back into frame to avoid losing screw!

2. Pull cushion towards you to free the 2 clips at the back and set aside.

Note: All 5 cushions are identical!

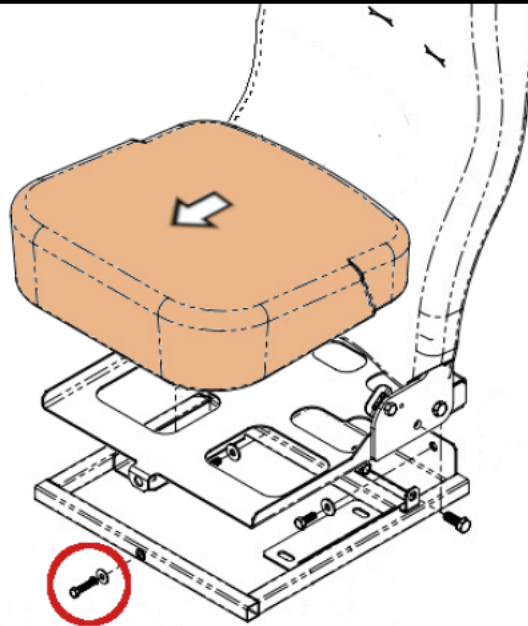

Figure 1 : CUSHION REMOVAL

3. If hardware is missing, refer to table and image below.

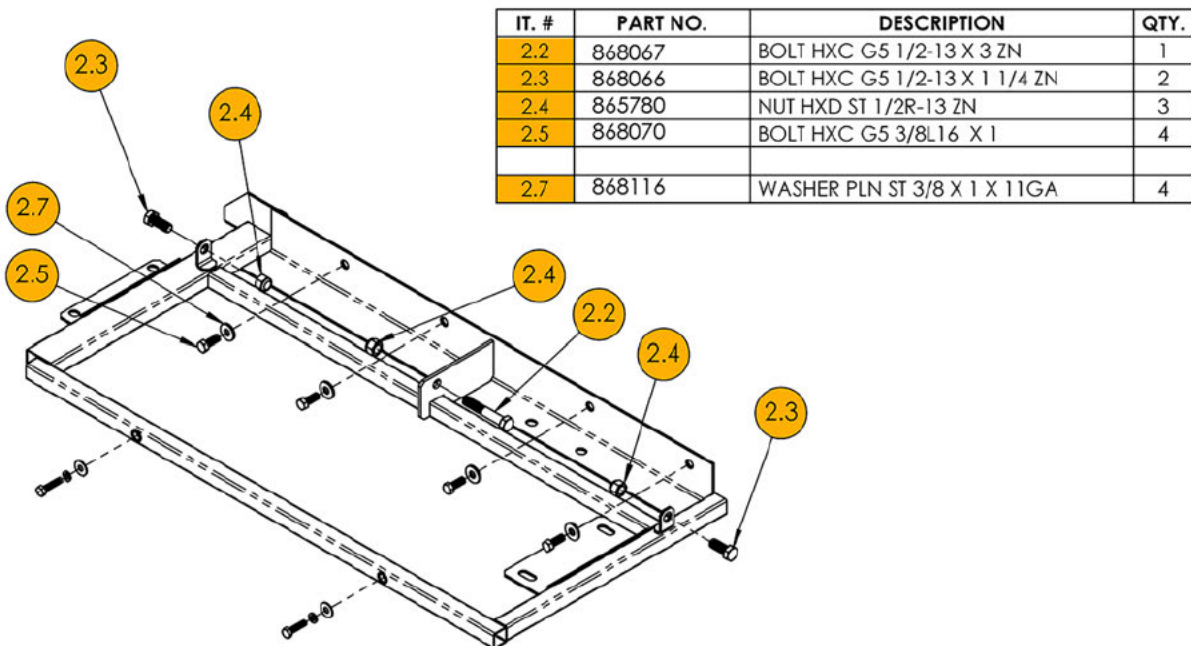

Figure 2 : HARDWARE LOCATIONS

Torquing the 5 Backrests – FOLLOW THE SEQUENCE

Curb side double seat is shown BUT REPEAT TORQUING FOR EVERY SEAT POSITION!

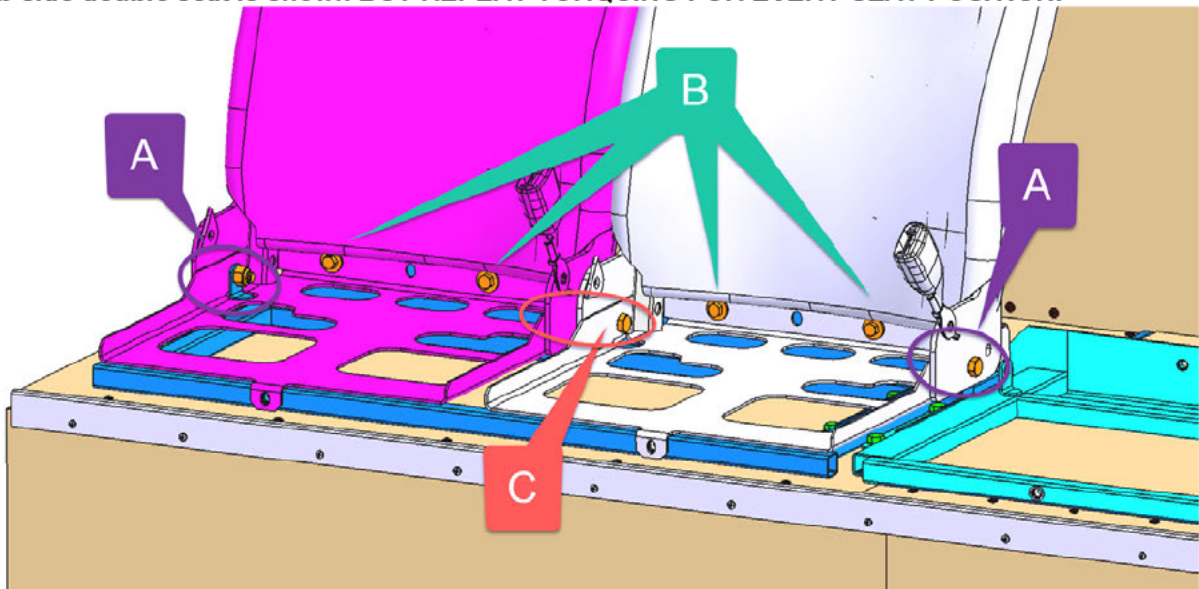
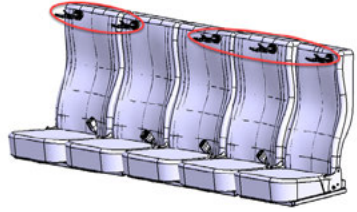
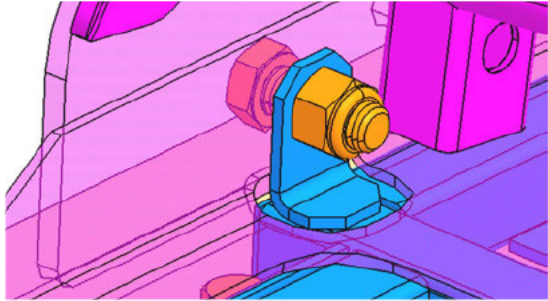
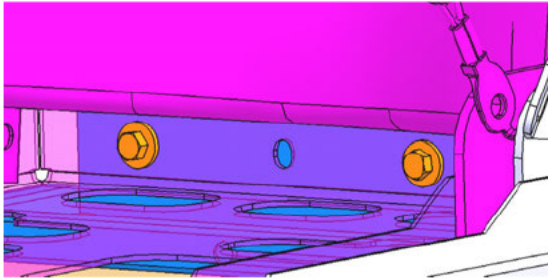
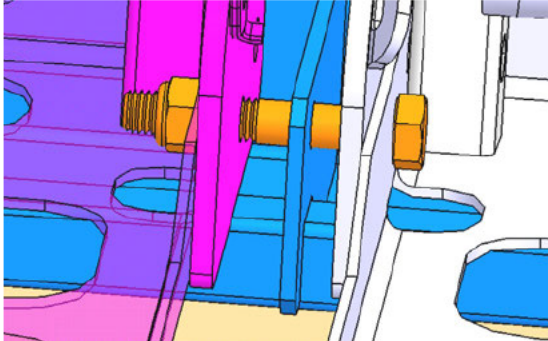

Figure 3 : HARDWARE POSITION KEY IMAGE

4	Backrest w/ RH belt, note number and position	qty 2	 <p>Figure 4</p>					
5	Backrest w/ LH belt, note number and position	qty 3						
6	A) Side bolt 1/2 x 1.25"	qty 2/seat	 <p>Figure 5 : POSITION A</p>					
7	A) Nut 1/2	qty 2/seat						
8	<table border="1" style="width: 100%; border-collapse: collapse;"> <tr> <td style="background-color: #4a4a8a; color: white; padding: 5px;">A - Side Torque (supplier value)</td> <td style="text-align: center; padding: 5px;">60 lb-ft 6x</td> </tr> <tr> <td colspan="2" style="text-align: center; padding: 5px;"><u>Manual torque</u></td> </tr> </table>	A - Side Torque (supplier value)		60 lb-ft 6x	<u>Manual torque</u>			
A - Side Torque (supplier value)	60 lb-ft 6x							
<u>Manual torque</u>								
9	B) Back bolt 3/8 x 1"	qty 2/seat	 <p>Figure 6 : POSITION B</p>					
10	B) Flat washer	qty 2/seat						
11	<table border="1" style="width: 100%; border-collapse: collapse;"> <tr> <td style="background-color: #008080; color: white; padding: 5px;">B - Back Torque (supplier value)</td> <td style="text-align: center; padding: 5px;">25 lb-ft 10x</td> </tr> <tr> <td colspan="2" style="text-align: center; padding: 5px;"><u>Manual torque</u></td> </tr> </table>	B - Back Torque (supplier value)		25 lb-ft 10x	<u>Manual torque</u>			
B - Back Torque (supplier value)	25 lb-ft 10x							
<u>Manual torque</u>								
12	C) Middle bolt (long) 1/2 x 3"	qty 1 /double seat	 <p>Figure 7 : POSITION C</p>					
13	C) Nut 1/2	qty 1 /double seat						
14	<table border="1" style="width: 100%; border-collapse: collapse;"> <tr> <td style="background-color: #ff0000; color: white; padding: 5px;">C - Middle Torque (supplier value)</td> <td style="text-align: center; padding: 5px;">60 lb-ft 2x</td> </tr> <tr> <td colspan="2" style="text-align: center; padding: 5px;"><u>Manual torque</u></td> </tr> <tr> <td colspan="2" style="padding: 5px;"> <p style="color: red; margin: 0;">Caution: This is a soft joint!!!</p> <p style="color: red; margin: 0;">If you struggle to reach the desired torque, don't push it - you don't want to start bending the frames! Make sure the bolt is tight and cannot be moved with fingers whatsoever.</p> </td> </tr> </table>	C - Middle Torque (supplier value)		60 lb-ft 2x	<u>Manual torque</u>		<p style="color: red; margin: 0;">Caution: This is a soft joint!!!</p> <p style="color: red; margin: 0;">If you struggle to reach the desired torque, don't push it - you don't want to start bending the frames! Make sure the bolt is tight and cannot be moved with fingers whatsoever.</p>	
C - Middle Torque (supplier value)	60 lb-ft 2x							
<u>Manual torque</u>								
<p style="color: red; margin: 0;">Caution: This is a soft joint!!!</p> <p style="color: red; margin: 0;">If you struggle to reach the desired torque, don't push it - you don't want to start bending the frames! Make sure the bolt is tight and cannot be moved with fingers whatsoever.</p>								

Reinstalling the Seat Cushions		
15	Seat cushion	qty 5/veh
16	<p>Once everything is tight, torqued and torque sealed</p> <p>Slide the cushions back in place, making sure the 2 clips engage, and secure with the front bolt. (see below for upside down picture)</p>	
17	Bolt 5/16 x 1.25	qty 1/cushion
18	Split lock	qty 1/cushion
19	Flat washer	qty 1/cushion

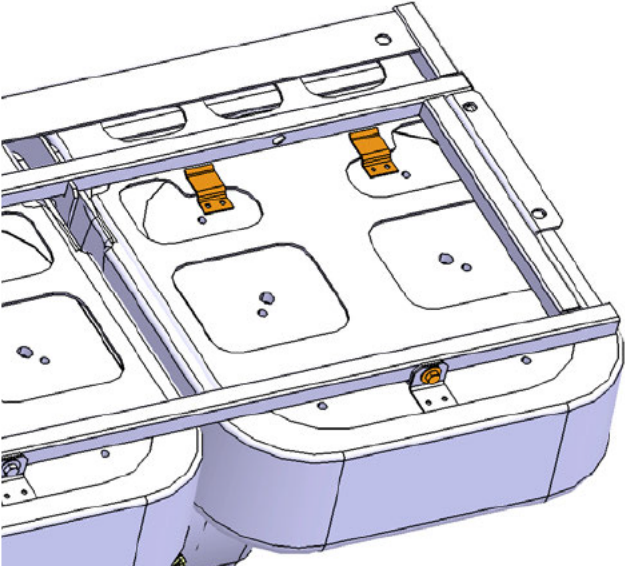

Figure 9

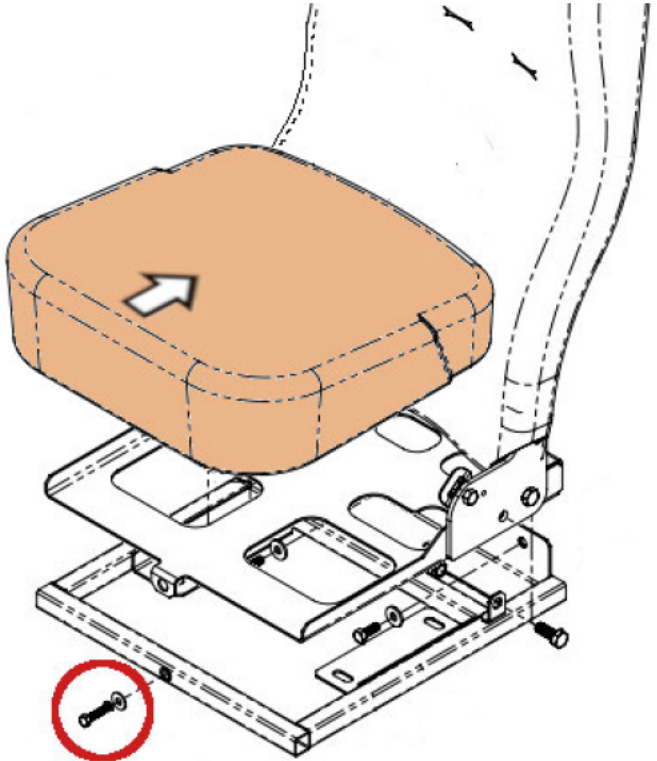

Figure 8

PARTS DISPOSITION

DO NOT RETURN THE REPLACED PARTS. Discard waste according to applicable environmental regulations (Municipal/State[Prov.]/ Federal)

WARRANTY

This modification is covered by Prevest's normal warranty. We will reimburse you the parts and thirty minutes (30 min) of labor upon receipt of a completed A.F.A. Please submit claim via our Online Warranty System, available at www.prevestcar.com (under service \ warranty section). Use Claim Type: "Bulletin/Recall" and select "Safety Recall 0BSR22-10".

Should you only wish to close the safety recall (without reimbursement), fill-in the "Safety Recall Certification Sheet" provided with this bulletin and return it to our warranty department by Email at prevost.onlinewarranty@volvo.com or by fax at 418-831-9301.

OTHER

VBC Bulletin	N/A
Fail Code	18.03-2
Defect Code	09
Syst.Cond	R
Causal Part	868085

Access all our Service Bulletins on <http://techpub.prevostcar.com/en/> or scan the QR-Code with your smart phone.
E-mail us at technicalpublications_prev@volvo.com and type "ADD" in the subject to receive our warranty bulletins by e-mail.





**Safety Recall
Certification Sheet
(Ref: SR22-10)**

VEHICLE SERIAL NUMBER:

2	P	C																	
---	---	---	--	--	--	--	--	--	--	--	--	--	--	--	--	--	--	--	--

PERFORMED BY		OWNER/OPERATOR	
We hereby certify that Safety Recall Instructions with regard to Safety Recall SR18-XX have been performed.			
Name: _____		Name: _____	
Addr: _____		Addr: _____	
Phone: _____		Phone: _____	
Fax: _____		Fax: _____	
Signature : _____	_____	Signature : _____	_____
Date: _____	_____	Date: _____	_____

If the information mentioned above is incorrect or you are not the owner of this vehicle anymore, please fill this section and return to sender.

NEW OWNER:

BUSINESS:

ADDRESS (including County):

TELEPHONE: _____

FAX: _____

Please return this completed document with your A.F.A. form