

RECALL 21V876 REMEDY INSTRUCTIONS



Make(s): CARGO MATE & CONTINENTAL CARGO
 Model(s): MANY, SEE BELOW
 Model Year(s): 2021 - 2022

Concern:
 The 2 5/16" coupler may have components only spot-welded to it by the coupler manufacturer. This condition may lead to trailer separation from the tow vehicle.

Repair Code: RC-062-01-00-004116
 Allotted Time: 2.00 HRS.
 Inspection Code: RC-062-05-00-004117
 Allotted Time: .10 HRS.

Photo(s) Required: YES, BEFORE & AFTER
 Prior Authorization Required: NO
 Part(s) Kit Number: CA-5400-B
 Part(s) Return: NO

Disconnect the vehicles' battery Positive and Negative, disconnect any House battery(s) Positive and Negative, if equipped with a generator ensure it is off and lastly, ensure the vehicle is disconnected from shore power. Block any tires/wheels to prevent the vehicle from rolling. Failure to do so may result in electrocution, fire or other personal injury, property damage and/or death.

CARGO MATE: TXBL616TA2, TXBL712TA2, TXBL714TA2, TXBL814TA2, TXBL816TA2, TXBL816TA5, TXBL820TA3, TXBL824TA5, TXBL828TA3, TXEHW612TA2, TXEHW712TA2, TXEHW714TA2, TXEHW716TA2, TXEHW716TA3, TXEHW8.520TA2, TXEHW8.520TA3, TXEHW8.520TA5, TXEHW8.524TA3, TXEHW816TA2, TXEHW820TA5, TXEHW824TA5, TXEL8.524TA3, TXEL8.528TA4, TXLEEH612TA2, TXLEEH714TA2 & TXLEEH716TA2

CONTINENTAL CARGO: TXAM8.526TA4, TXAM8.528TA4, TXAM8.530TA4, TXAM8.532TA4, TXLVVH714TA2, TXLVVH716TA2, TXNS8.524TA3, TXNS8.524TA4, TXNS8.528TA3, TXNS8.528TA4, TXTW712TA2, TXTW714TA2, TXTW814TA2, TXTW816TA2, TXVH8.528TA5, TXVH818TA2, TXVHW612TA2, TXVHW712TA2, TXVHW714TA2, TXVHW716TA2, TXVHW718TA2, TXVHW8.516TA2, TXVHW8.516TA3, TXVHW8.518TA3, TXVHW8.520TA2, TXVHW8.520TA3, TXVHW8.524TA3, TXVHW8.526TA3, TXVHW8.528TA3, TXVHW816TA2, TXVHW816TA3 & TXVHW820TA3

INSPECT THE 2 5/16" COUPLER

STEP 1: LOOKING AT THE BOTTOM SIDE OF THE COUPLER. DOES THE COUPLE LOOK LIKE FIGURE 1 OR FIGURE 2?

FIGURE 1 (GOOD)



NORMAL WELDS ON COUPLER UP THE ENTIRE LENGTH OF THE BOTTOM BALL CLAMP

FIGURE 2 (BAD)



SPOT WELDS LIKE ON THIS COUPLER WILL REQUIRE A COMPLETE COUPLER REPLACEMENT.

IF THE COUPLE HAS SPOT WELDS LIKE FIGURE 2, THE COUPLE IN WHOLE NEEDS TO BE REPLACED. PHOTOGRAPH THE COUPLER'S MISSING WELDS (IF MISSING) PRIOR TO AND POST THE REMEDY. Contact Pacific Rim @ 360-859-3828 and order part number - CA-5400-B. Claims should be filed on Dealer

Connect with Forest River

PLEASE MOVE ON TO THE REMEDY STEPS ON THE NEXT PAGE.

RECALL 21V876 REMEDY INSTRUCTIONS



Make(s): CARGO MATE & CONTINENTAL CARGO
Model(s): MANY, SEE BELOW
Model Year(s): 2021 - 2022

Concern:
The 2 5/16" coupler may have components only spot-welded to it by the coupler manufacturer. This condition may lead to trailer separation from the tow vehicle.

Repair Code: RC-062-01-00-004116
Allotted Time: 2.00 HRS.
Inspection Code: RC-062-05-00-004117
Allotted Time: .10 HRS.

Photo(s) Required: YES, BEFORE & AFTER
Prior Authorization Required: NO
Part(s) Kit Number: CA-5400-B
Part(s) Return: NO

REMEDY COUPLER:

STEP 1: ENSURE THE UNIT IS LEVEL THEN SUPPORT THE FRONT CROSS-MEMBER OF THE CHASSIS BY USING TWO (2) JACK STANDS, ROUGHLY EQUAL DISTANCE APART ACROSS THE FRAME (IN 1/3RDS);

STEP 2: RETRACT THE FRONT JACK, REMOVE THE SANDPAD/FOOTPAD FROM THE FRONT JACK;

STEP 3: THERE ARE THREE – 3/8" BOLTS THAT SECURE THE JACK TO THE COUPLER, REMOVE THESE BOLTS AND SET ASIDE. IF THE JACK IS AN ELECTRIC JACK, DISCONNECT THE WIRE AT THE BATTERY. NOW LIFT THE JACK UP VERTICALLY AND REMOVE THE JACK. SET THE JACK ASIDE;

STEP 4: CUT THE EXISTING WELDS INDICATED IN *FIGURE 3 IN RED*. **DO NOT CUT INTO THE A-FRAME TUBES!** GRIND DOWN THE ROUGH EDGES AFTER THE COUPLER IS REMOVED. REMOVE AND DISCARD THE COUPLER APPROPRIATELY. ENSURE ALL AREAS ARE SMOOTH AND SHOW SHINY METAL WHERE THE NEW COUPLER WILL BE WELDED TOO;

STEP 5: THE REPLACEMENT IS VIRTUALLY IDENTICAL TO THE COUPLER YOU REMOVED. **DO NOT MIX THEM UP.** THE DIFFERENCE IS THAT THE WELDS FOR THE COUPLER TONGUE ARE PRESENT AND NOT TACK WELDED. THE LOAD RATING REMAINS THE SAME AS DOES THE BALL SIZE OF 2 5/16";

STEP 6: INSTALL THE REPLACEMENT COUPLER TO THE A-FRAME. WELD SMOOTHLY WHERE THE GREEN LINES ARE IN *FIGURE 4*. **DO NOT WELD AROUND THE TUBE RADIUS OF THE A-FRAME TUBES;**

FIGURE 3

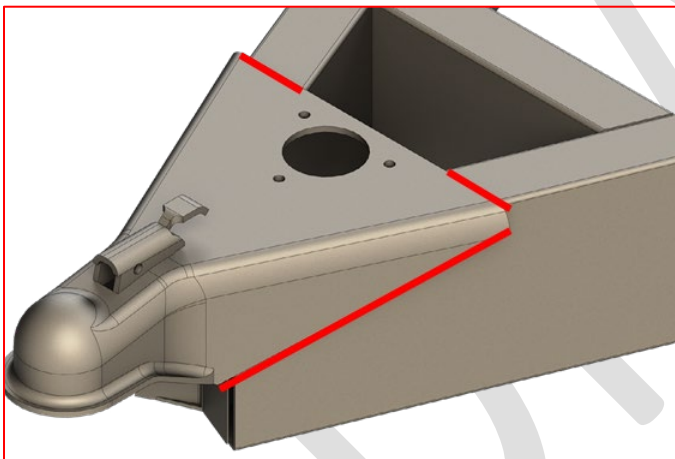
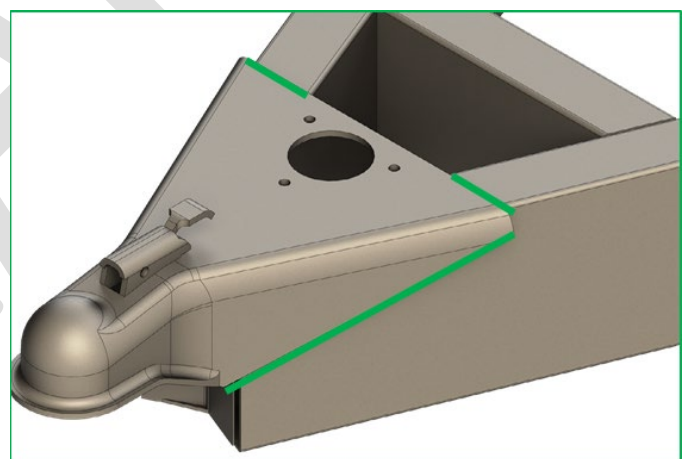

FIGURE 4



STEP 7: ALLOW THE WELDS TO COOL. INSPECT FOR CLEANLINESS AND SMOOTHNESS, FIX AS NEEDED.

STEP 8: APPLY TOUCH UP BLACK SPRAY PAINT TO THE ENTIRE COUPLER AND WELDED AREAS;

STEP 9: REINSTALL FRONT JACK, BOLT IT DOWN TO THE COUPLER USING THE THREE 3/8" BOLTS AND IF ELECTRIC, HOOK BACK UP TO THE BATTERY;

STEP 10: VERIFY FUNCTIONALITY. REINSTALL THE SANDPAD/FOOTPAD;

STEP 11: CLAIM REPAIR CODE.