



FIELD KIT

Vermeer Corporation

Environmental
Pella, Iowa 50219 USA

FIELD CAMPAIGN KIT #:	IK004126	DATE:	7 October 2021
<i>For Dealer Reference: Service Bulletin #: SVC2021-147</i>			

Discharge Chute Retainer Block Replacement Kit

CAMPAIGN TYPE:	Mandatory – Product Safety
CAMPAIGN CATEGORY:	Kit and Bulletin

MACHINE/ ATTACHMENT MODEL(S):	SERIAL NUMBERS:		
	Included	Excluded	Kit version
BC1000XL	34638 – 34666	34646 – 34649, 34654, 34665	IK01
BC1200XL	6043 – 6047	None	IK01
BC900XL	3583 – 3586	None	IK02



Purpose: Vermeer Corporation has decided that a defect that relates to motor vehicle safety exists in certain model year 2021 Vermeer BC900XL, BC1000XL and BC1200XL brush chippers.

Possible loss of discharge chute and risk of crash. The retainer blocks which secure the discharge chute may not have been properly manufactured, which could result in loose bolts and possible separation of discharge chute from the brush chipper.

Death or serious injury. When towing the brush chipper on public roadways, **death or serious injury** may result if discharge chute becomes separated from the brush chipper and strikes another vehicle or pedestrian on the roadway. While operating the brush chipper on jobsites, crew member(s) may be injured if struck by the discharge chute. Property or equipment damage may also occur.

Immediate machine modifications required. This kit has been created to provide the necessary parts and instructions to replace the discharge chute retainer block. **The kit must be installed as soon as possible.**

Special tools and conditions:

- Red thread locker

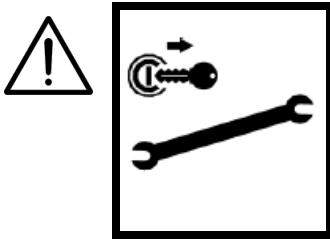

WARNING: Failure to use shutdown procedure can result in unexpected hazard(s). Death or serious injury could result due to entanglement, crushing, cutting, or other hazardous contact. Follow shutdown procedure after operating, before performing any service or maintenance, and before transporting.

Shutdown procedure for BC900XL:

NOTICE: For your safety and the safety of others, use the shutdown procedure before working on the machine for any reason, including servicing, cleaning, unclogging, inspecting or transporting the chipper.

A variation of this procedure may be used if so instructed within this manual, or if an emergency requires it.

1. Return upper feed-control bar to neutral.
2. Reduce engine speed to idle. For machines equipped with centrifugal clutch, cutter disc will disengage clutch handle **(B)** (if equipped).

NOTICE: Whenever practical and safe, allow engine to idle for one to five minutes before shutting down after operating at full power. Please consult machine's engine manual for details.

3. Shut off engine and remove key.
4. Wait for cutter disc and belt to stop.

NOTICE: Cutter disc rotation can be checked by looking through the viewing slots **(A)** on belt housing shield. Cutter disc will continue to turn for a short time after engine has stopped.

5. Close and latch feed table.

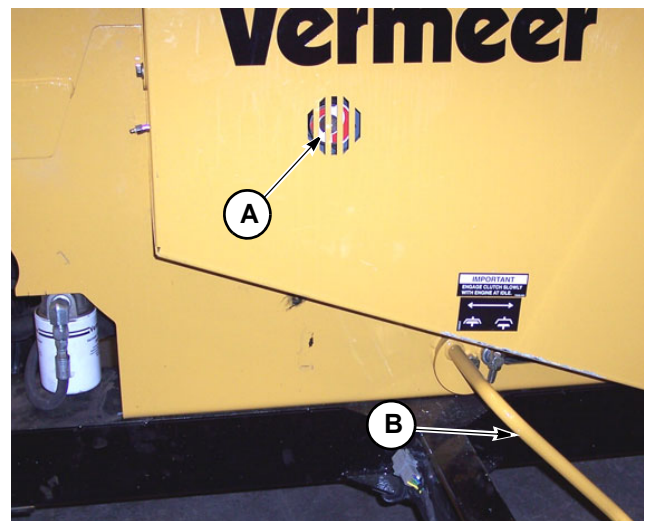
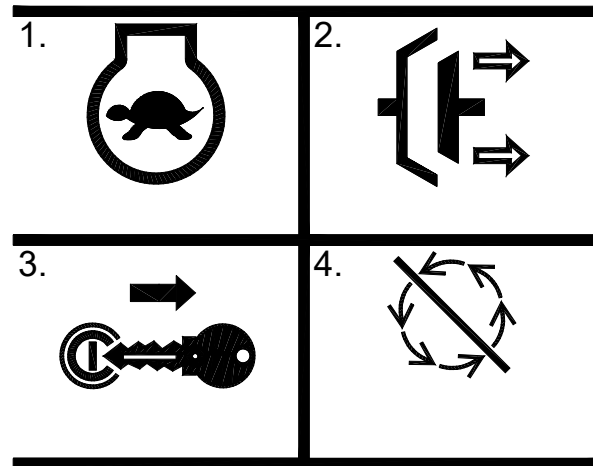

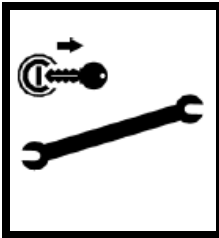

WARNING: Failure to use shutdown procedure can result in unexpected hazard(s). Death or serious injury could result due to entanglement, crushing, cutting, or other hazardous contact. Follow shutdown procedure after operating, before performing any service or maintenance, and before transporting.

Shutdown procedure for BC1000XL and BC1200XL:

NOTICE: For your safety and the safety of others, use the shutdown procedure before working on the machine for any reason, including servicing, cleaning, unclogging, inspecting or transporting the chipper.

A variation of this procedure may be used if so instructed within this manual, or if an emergency requires it.

1. Return upper feed-control bar to top stop position.
2. Move cutter engage/throttle lever to engaged/low rpm position.

NOTICE: Whenever practical and safe, allow engine to idle for one to five minutes before shutting down after operating at full power. Please consult machine's engine manual for details.

3. Wait for cutter drum to slow.
4. Place cutter engage/throttle lever in the disengage/low position.
5. If so equipped, shut off remote control if in use.
6. Turn ignition key to off position.
7. Wait for the cutter drum and belt to stop.

NOTICE: Cutter drum rotation can be checked by looking at the end of the shaft (**A**) on the left side of the cutter wheel housing. The cutter drum will continue to turn for a short time after the engine has stopped.

8. Remove ignition key.
9. Close and latch feed table.

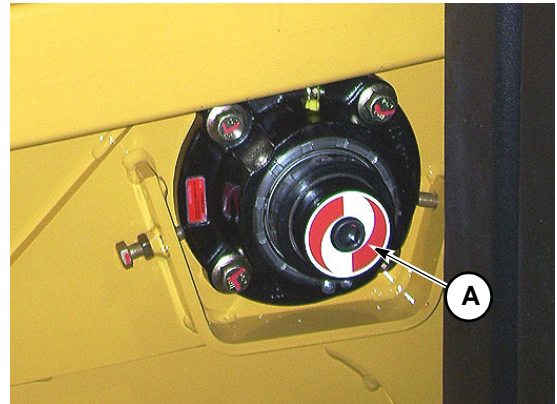
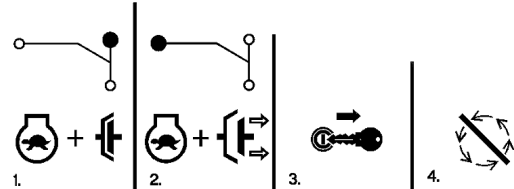



Unless indicated, new parts from kit have callouts with numbers. Callouts with letters indicate existing parts or general items.

Procedure 1: Replace discharge chute retainers

1. Position machine discharge chute to get clear access to all discharge chute clamps (A).
2. Do work on one clamp at a time. Remove and discard screws (C) that attach clamp retainer (B), then remove and discard retainer.
3. Apply red thread locker to two screws (2) included with kit.
4. Install new retainer (1) included in kit on top of discharge chute clamp, then attach with screws from step 3 and tighten screws.
5. **For BC900XL – IK02:**
Repeat steps 2 – 4 for next three discharge chute clamps.
For BC1000XL or BC1200XL – IK01:
Repeat steps 2 – 4 for next two discharge chute clamps.
6. Remove Figure 1 and attach to invoice or place in manual storage box so unit owner can place with existing parts manual.

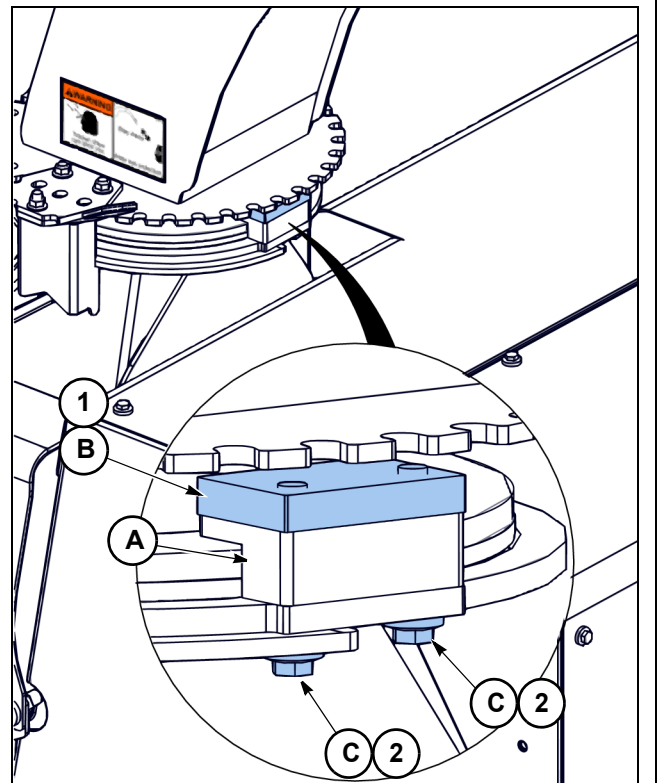

UNIT OWNER COPY
 Insert into parts manual
 for future reference.

Figure 1

BC1000XL – IK01
BC1200XL – IK01

BC900XL – IK02

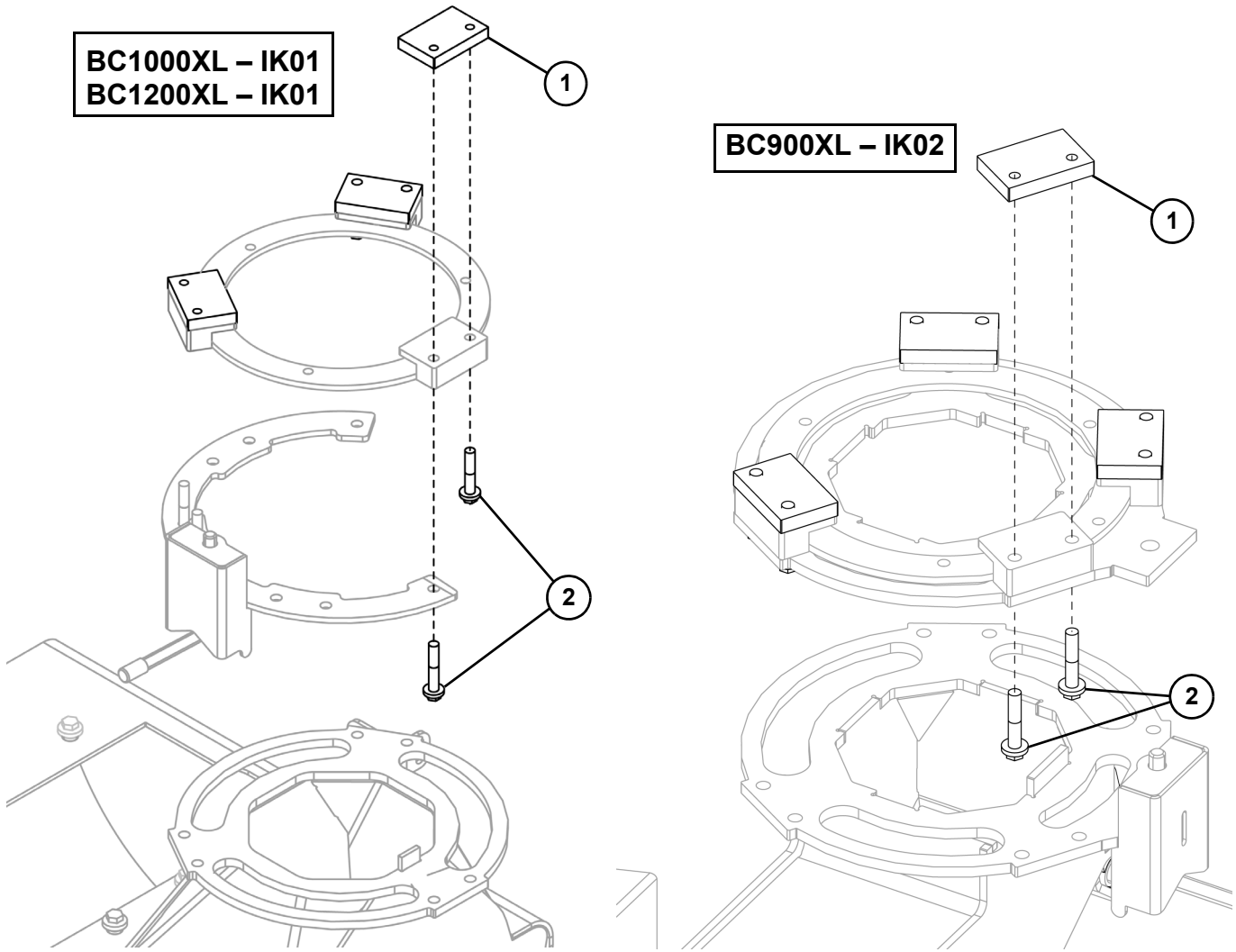

Figure 1 parts list

REF. NO.	PART NO.	DESCRIPTION	IK01 QTY.	IK02 QTY.
1	180014644	NUT BAR - FOR PLASTIC CAP	3	4
2	507612050	SCREW HFS,M10,1.50X50,10.9, ANSI,B18.2.3.9M,PT	6	8
		Kit includes all items in Figure 1 parts list.		