

# RECALL 21V575, 2021-459 - REMEDY INSTRUCTIONS

	Make(s): TRACER Model(s): TRT22RBS Model Year(s): 2021	Repair Code: RC-028-01-00-004084 Allotted Time: 3.50 HRS. Inspection Code: N/A Allotted Time: N/A
	Concern: The water heater exhaust may melt and cause distortion on the passenger side rear tail lamp. Replace Tail lamps with new tail lamps.	Photo(s) Required: YES Prior Authorization Required: YES Part(s) Kit Number: F100282000 Part(s) Return: NO

Disconnect the vehicles' battery Positive and Negative, disconnect any House battery(s) Positive and Negative, if equipped with a generator ensure it is off and lastly, ensure the vehicle is disconnected from shore power. Block any tires/wheels to prevent the vehicle from rolling. Failure to do so may result in electrocution, fire or other personal injury, property damage and/or death.

**STEP 1:**

- A. REMOVE THE LENS FROM BOTH TAIL LAMPS TO GAIN ACCESS TO THE FASTENERS;
- B. REMOVE FASTENERS AND SET ASIDE FOR REUSE;
- C. MAKE A NOTE OR TAKE A PHOTO OF WHICH WIRES ARE CONNECTED TO THE TAIL LAMPS;
- D. CUT OR DISCONNECT THE WIRES ON THE TAIL LAMPS FROM THE WIRES COMING OUT OF THE REAR WALL OF THE UNIT;  
**\*NOTE – DO NOT CUT AND REUSE THE TAIL LAMP WIRES\***
- E. DISCARD THE TAIL LAMPS.

**STEP 2:**

- A. REMOVE ANY SEALANT THAT IS ON THE REAR WALL WITH A RAZOR;

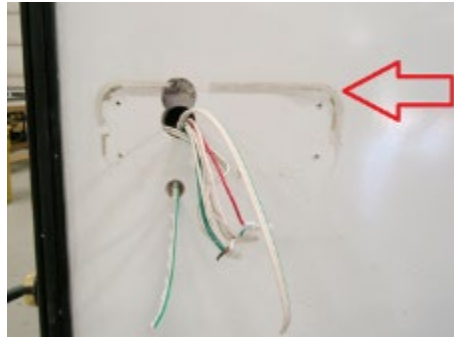

- B. TAPE PAPER OVER PRE-BEND MOLDING, WATER HEATER AND BUMPER TO PROTECT FROM ANY OVERSPRAY;

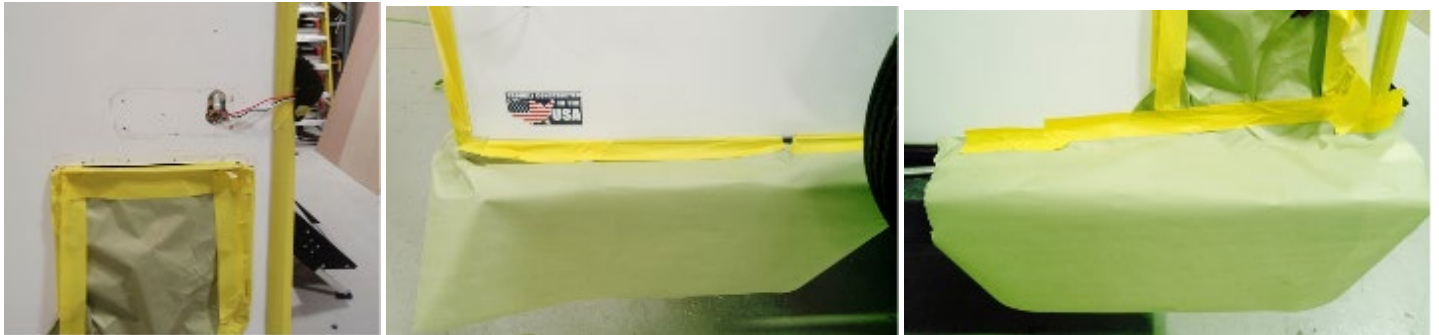

- C. USING A CIRCULAR GRINDING TOOL, GRIND DOWN THE SCREWS HOLES THAT WILL NOT BE COVERED BY THE TAIL LAMP;  
**\*PLEASE NOTE: THE NEW TAIL LAMP WILL BE INSTALLED VERTICALLY\***

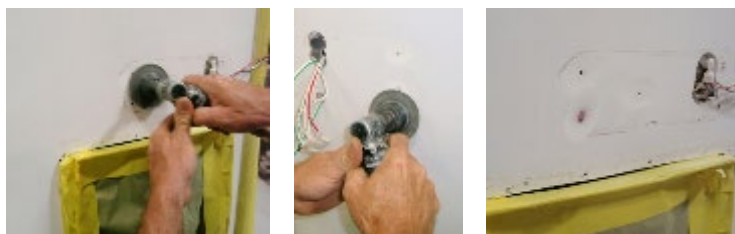

# RECALL 21V575, 2021-459 - REMEDY INSTRUCTIONS



Make(s): TRACER  
Model(s): TRT22RBS  
Model Year(s): 2021

Concern:  
The water heater exhaust may melt and cause distortion on the passenger side rear tail lamp. Replace Tail lamps with new tail lamps.

Repair Code: RC-028-01-00-004084  
Allotted Time: 3.50 HRS.  
Inspection Code: N/A  
Allotted Time: N/A  
Photo(s) Required: YES  
Prior Authorization Required: YES  
Part(s) Kit Number: F100282000  
Part(s) Return: NO

D. FILL IN THE HOLES WITH BONDO AND THE SURROUNDING AREA AND ALLOW TO DRY;



E. SAND THE BONDO AREA UNTIL SMOOTH AND REAPPLY BONDO WHERE NEEDED, SAND AGAIN;



F. CLEAN OFF THE AREA WITH AN AIR NOZZLE AND PRIME THE AREA;



G. USING A SCOWLING PAD, SCUFF THE AREA SO THE PAINT WILL STICK TO THE WALL;

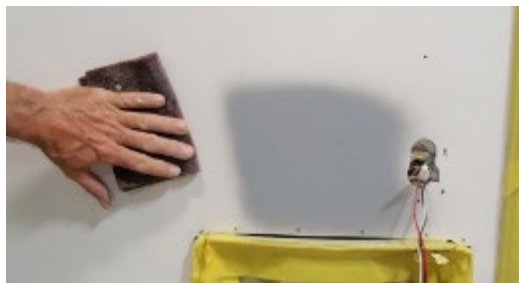
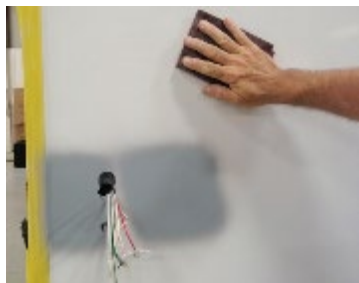

# RECALL 21V575, 2021-459 - REMEDY INSTRUCTIONS



Make(s): TRACER  
 Model(s): TRT22RBS  
 Model Year(s): 2021

Concern:  
 The water heater exhaust may melt and cause distortion on the passenger side rear tail lamp. Replace Tail lamps with new tail lamps.

Repair Code: RC-028-01-00-004084  
 Allotted Time: 3.50 HRS.  
 Inspection Code: N/A  
 Allotted Time: N/A  
 Photo(s) Required: YES  
 Prior Authorization Required: YES  
 Part(s) Kit Number: F100282000  
 Part(s) Return: NO

H. CLEAN OFF AREA WITH AN AIR NOZZLE, PAINT THE AREA AND ALLOW TO DRY;

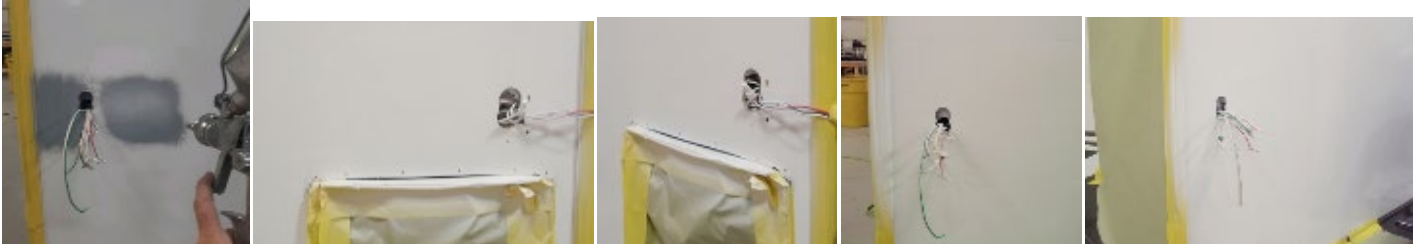

I. APPLY CLEAR COAT TO THE AREA;



STEP 3:

A. DRILL WIRE OPENING ABOUT AN 1 – 1 ¼" ABOVE EXISTING HOLE, JUST THROUGH THE GLASS AND NOT ALL THE WAY THROUGH THE WALL;



B. YOU MAY HAVE TO USE A TOOL TO REMOVE SOME OF THE ALUMINUM TUBING TO ALLOW SPACE FOR THE WIRING ON THE BACK SIDE OF THE NEW TAIL LAMP;



## RECALL 21V575, 2021-459 - REMEDY INSTRUCTIONS



Make(s): TRACER  
Model(s): TRT22RBS  
Model Year(s): 2021

Concern:  
The water heater exhaust may melt and cause distortion on the passenger side rear tail lamp. Replace Tail lamps with new tail lamps.

Repair Code: RC-028-01-00-004084  
Allotted Time: 3.50 HRS.  
Inspection Code: N/A  
Allotted Time: N/A  
Photo(s) Required: YES  
Prior Authorization Required: YES  
Part(s) Kit Number: F100282000  
Part(s) Return: NO

- C. CONNECT NEW TAIL LAMP ABOVE WATER HEATER; \*REFER TO THE NOTES OR PHOTO FROM STEP 1-C TO CONNECT THE WIRING\*



- D. INSTALL NEW TAIL LAMP VERTICALLY SO IT COVERS THE TWO SCREW HOLES CLOSEST TO THE PRE-BEND MOLDING;



- E. INSTALL COSMETIC SNAP RING FOR NEW TAIL LAMP AND CAP SEAL WITH SILICONE.



## RECALL 21V575, 2021-459 - REMEDY INSTRUCTIONS



Make(s): TRACER  
Model(s): TRT22RBS  
Model Year(s): 2021

Concern:  
The water heater exhaust may melt and cause distortion on the passenger side rear tail lamp. Replace Tail lamps with new tail lamps.

Repair Code: RC-028-01-00-004084  
Allotted Time: 3.50 HRS.  
Inspection Code: N/A  
Allotted Time: N/A  
Photo(s) Required: YES  
Prior Authorization Required: YES  
Part(s) Kit Number: F100282000  
Part(s) Return: NO

- F. REPEAT STEPS 3, A-E ON THE OFF DOOR SIDE REAR TAIL LAMP;



- G. DRILL  $\frac{3}{4}$ " HOLE BELOW THE TAIL LAMP HOLE A MINIMUM OF 2";



- H. INSTALL JUMPER WIRE TO LICENSE PLATE BRACKET HOLE FROM OFF DOOR SIDE TAIL LAMP HOLE;



- I. CONNECT WIRING FROM THE NEW TAIL LAMP FROM THE WIRES COMING OUT OF THE REAR WALL OF THE UNIT;
- J. BEFORE INSTALLING NEW TAIL LAMP MAKE SURE YOUR MEASUREMENT MATCHES THAT ON THE DOOR SIDE REAR TAIL LAMP;
- K. INSTALL NEW TAIL LAMP VERTICALLY SO IT COVERS THE TWO SCREW HOLES CLOSEST TO THE PRE-BEND MOLDING;
- L. INSTALL COSMETIC SNAP RING FOR NEW TAIL LAMP AND CAP SEAL WITH SILICONE;
- M. LOCATE THE NEW LICENSE PLATE BRACKET AND APPLY BUTYL TAPE TO THE BACK SIDE;
- N. CONNECT THE WIRES TO THE LICENSE PLATE BRACKET;
- O. INSTALL LICENSE PLATE BRACKET BELOW THE TAIL LAMP USING THE FASTENERS THAT WERE SET ASIDE AND CAP SEAL;
- P. CLAIM REPAIR CODE.