



N607NAS1

TECHNICAL BULLETIN

15 JUL 2021

© Jaguar Land Rover North America, LLC

NOTE: The information in Technical Bulletins is intended for use by trained, professional Technicians with the knowledge, tools, and equipment required to do the job properly and safely. It informs these Technicians of conditions that may occur on some vehicles, or provides information that could assist in proper vehicle service. The procedures should not be performed by 'do-it-yourselfers'. If you are not a Retailer, do not assume that a condition described affects your vehicle. Contact an authorized Land Rover service facility to determine whether this bulletin applies to a specific vehicle.

SECTION:

100-00

SUBJECT/CONCERN:

SAFETY RECALL: Startup Battery Ground Stud - Insufficient Ground Contact

AFFECTED VEHICLE RANGE:

MODEL:	MODEL YEAR:	VIN:
Discovery (LR)	2020-2021	427521-453141

MARKETS:

CANADA, USA

CONDITION SUMMARY:

SITUATION:

A potential issue has been identified on certain Land Rover vehicles within the listed Affected Vehicle Range where, due to insufficient contact of the battery ground stud to the chassis, the vehicle may exhibit various electrical faults. The vehicle could cut out while in motion, may lose all electrical power and lighting without warning to the driver. and could lead to an increased risk of an accident.

ACTION:

Retailers are required to HOLD affected new vehicles that are within your control and refrain from releasing the vehicles for new vehicle sale pending completion of the procedure(s) detailed in this Technical Bulletin. Unsold vehicles should have this performed as part of the Pre-Delivery Inspection (PDI) process but must have it completed prior to vehicle handover to the customer.

Affected vehicles already in the hands of customers should be updated at the next available opportunity.

SPECIAL TOOLS

NOTE:

To make sure the correct clamp load is achieved when installing the new ground stud, only the mandatory special tool ground stud repair kits listed below can be used for the N607 repair.

Special Tool Ground Stud Repair Kits

- JLR-MRPK4075
- JLR-MRPK4081

PARTS INFORMATION

DESCRIPTION	PART NUMBER	QUANTITY
M6 Ground stud	LR149837	1

SROS

DESCRIPTION	SRO	TIME
Ground stud - Renew	05.10.20	0.2
Drive in/drive out	02.02.02	0.2

NOTES:

- Repair procedures are under constant review, and therefore times are subject to change; those quoted here must be taken as guidance only. Always refer to TOPIx to obtain the latest repair time.
- The option that contains the drive in/drive out allowance may only be claimed when the vehicle has been brought back into the workshop for this action alone to be undertaken.

WARRANTY INFORMATION

Warranty claims should be submitted quoting Program Code N607 with the relevant Option Code from the table below. As Option Codes are used there is no requirement for you to enter SROs or parts, these are included for information only.

PROGRAM CODE	OPTION	DESCRIPTION	SRO	TIME	PART NUMBER	QTY
N607	A	Ground stud - Renew	05.10.20	0.2	LR149837	1
N607	B	Ground stud - Renew Drive in/drive out	05.10.20 02.02.02	0.2 0.2	LR149837	1

Warranty claims should be submitted in accordance with the current Jaguar Land Rover (JLR) Global Warranty Compliance and Procedures Manual, and its amendments, unless stated otherwise in this bulletin.

CUSTOMER REIMBURSEMENT PROCESS

If a customer has indicated that they have already paid for this concern as a normal retail repair (vehicle outside warranty period), a copy of the repair invoice must be produced as proof of the repair. The retailer must directly reimburse the customer and a claim for recovery of this cost should be made using the related damage procedure.

Claims for related damages can only be made when this bulletin has been paid/accepted.

Claims should be submitted quoting Program Code N607 and by clicking the 'Related Damage' radio button on the claim submission screen. The warranty claim should be submitted using Option Code X as detailed in the table shown below and entering the cost to be reimbursed against the Sundry Code of 'ZZZ999'. All costs should be entered in local currency.

PROGRAM CODE	OPTION	DESCRIPTION	SRO	TIME	SUNDRY ITEM CODE	VALUE
N607	X	Reimbursement to owner	N/A	N/A	ZZZ999	Retailer entered

A copy of the invoice must be attached to the repair order for Warranty Audit purposes.

A brief comment should be entered in the 'Technician Comments' field on the claim to itemize and explain the charges.

Only vehicles eligible for Recall Action N607 are included in this process. Only one claim per vehicle for related damages will be accepted.

SERVICE INSTRUCTION

NOTES:

- Some variation in the illustrations may occur, but the essential information is always correct.
- Some components are shown removed for clarity.

1. Open the tailgate.

2. Remove the right loadspace trim panel (see TOPIx Workshop Manual section 501-05: Interior Trim and Ornamentation - Removal and Installation - Right Loadspace Trim Panel).

3. Disconnect the startup battery ground cable (see TOPIx Workshop Manual section 414-00: Battery and Charging System - General Information - Specifications).

4.

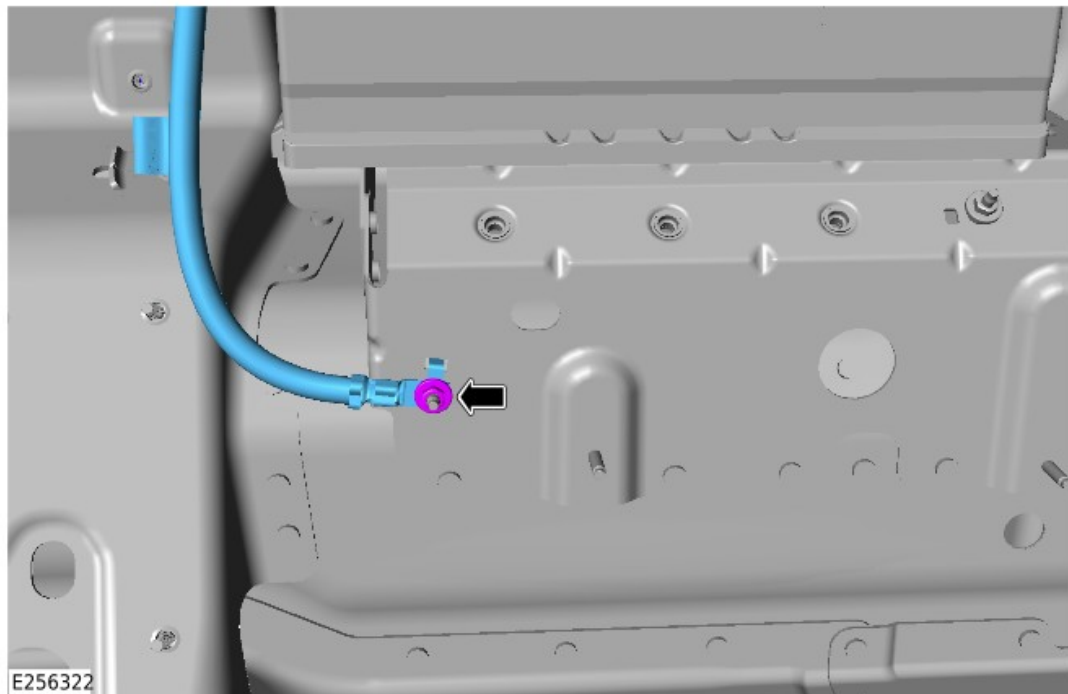

Remove the startup battery ground cable from the body ground stud (G4D178).

5.

NOTE:

Only mandatory special tool numbers **JLR-MRPK4075** or **JLR-MRPK4081** should be used to install a new ground stud.

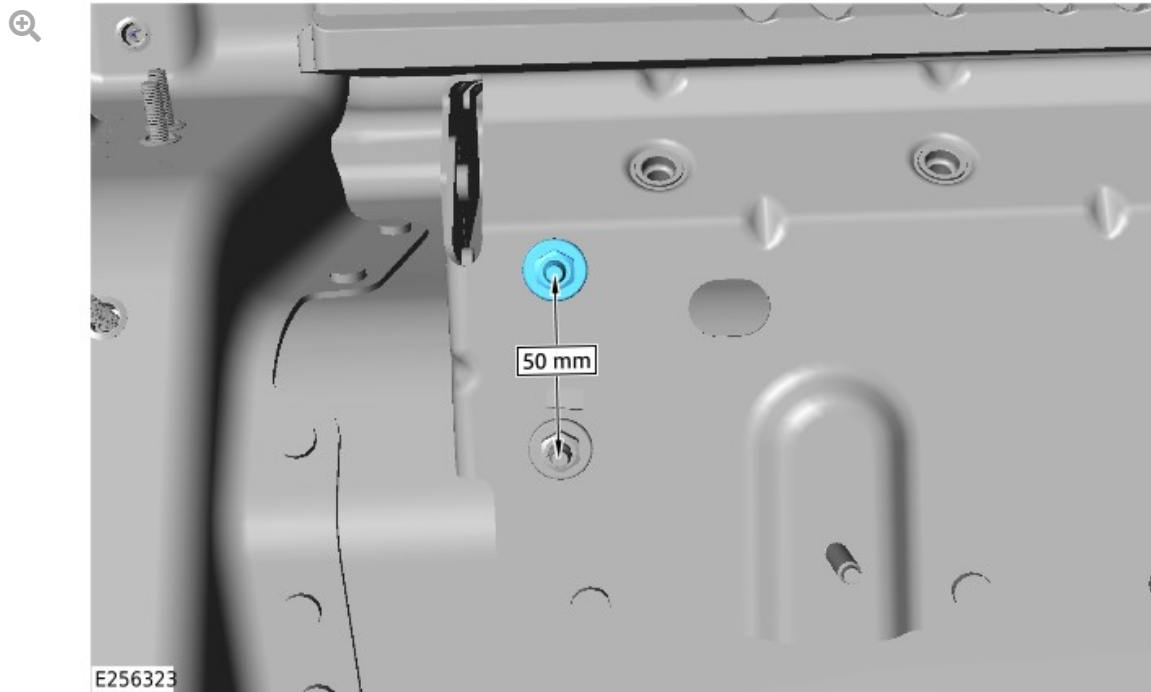

Install a new body ground stud (LR149837) 50 mm above the existing ground stud (G4D178) (see TOPIx Workshop Manual section 501-25A: Body Repairs General Information - General Procedures - Body Earth Stud Repair).

6.

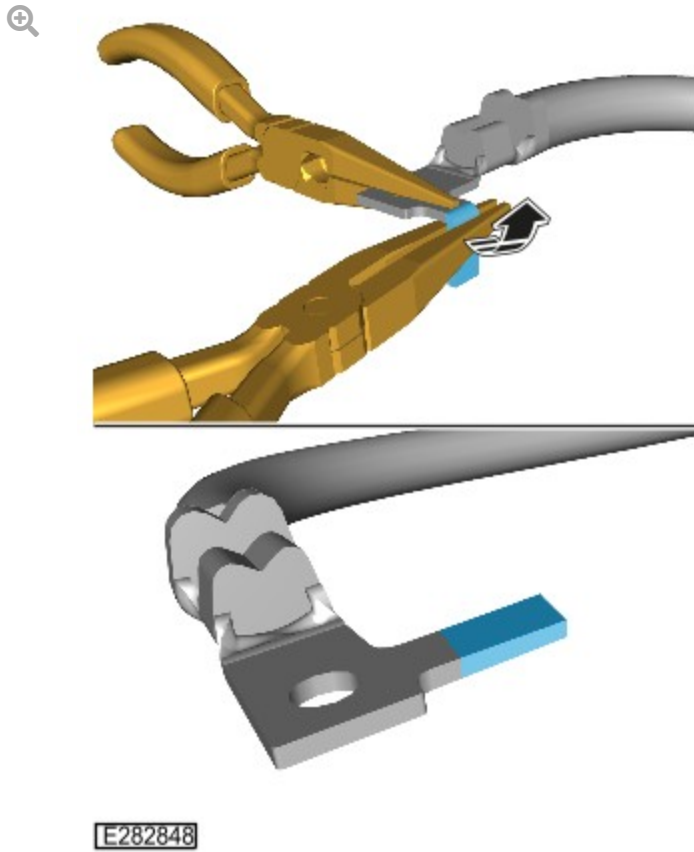
**E282848**

Using 2 pairs of suitable pliers, carefully straighten the startup battery ground cable locating tab, making sure the eyelet is held securely so the surface remains level while the locating tab is straightened.

7.

NOTE:

Make sure the surface of the startup battery ground cable eyelet is flat prior to installation.

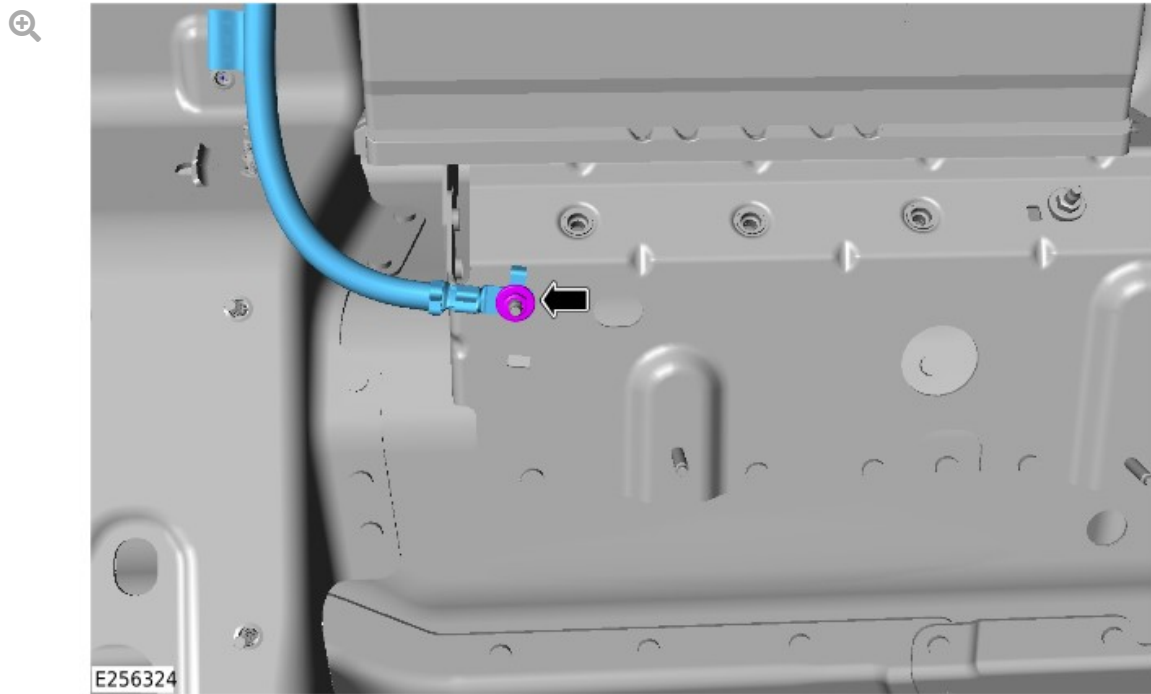

Install the startup battery ground cable to the new body ground stud.

- Torque: **8 Nm**

8.

NOTE:

Make sure the battery terminal is in the correct position.

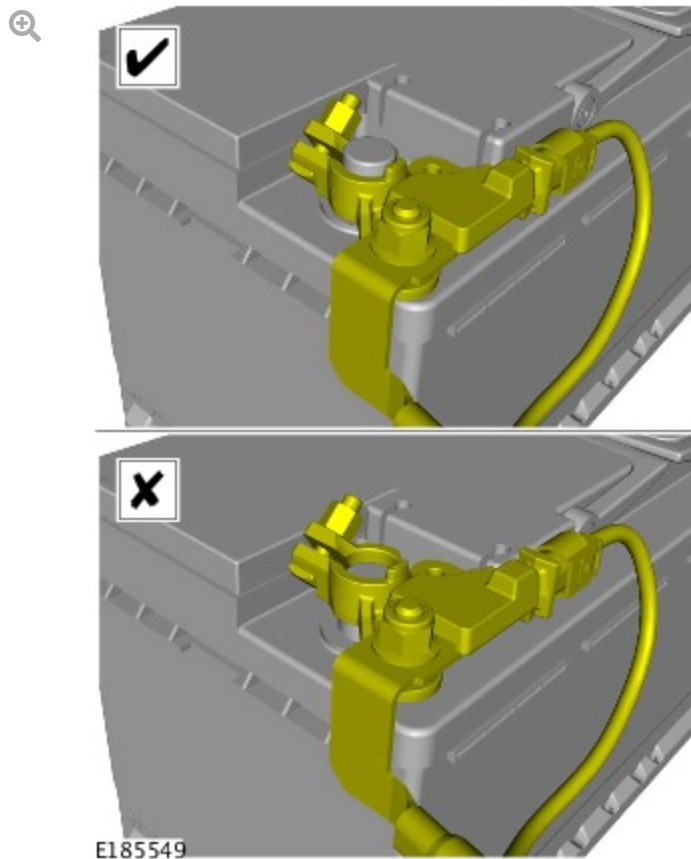

Connect the startup battery ground cable (see TOPIx Workshop Manual section 414-00: Battery and Charging System - General Information - Specifications).

9. Install the right loadspace trim panel (see TOPIx Workshop Manual section 501-05: Interior Trim and Ornamentation - Removal and Installation - Right Loadspace Trim Panel).

10. Close the tailgate.