



FIELD KIT

Vermeer Corporation

Environmental
Pella, Iowa 50219 USA

FIELD CAMPAIGN KIT #:	IK004055	DATE:	6 April 2021
For Dealer Reference: Service Bulletin #: SVC2021-081			
Axle Mounting Hardware Update Kit			

CAMPAIGN TYPE:	Mandatory – Product Safety DEALER INSTALLATION ONLY
CAMPAIGN CATEGORY:	Kit and Bulletin

MACHINE/ ATTACHMENT MODEL(S):	SERIAL NUMBERS:		
	Included	Excluded	Kit version
BC900XL	3568 – 3587	None	IK01



PURPOSE: POSSIBLE LOSS OF WHEEL AND RISK OF CRASH. During manufacturing, axle mounting bolts may not have been properly torqued which may cause loose bolts resulting in loss of stability/ swaying and axle loss. When towing the brush chipper on public roadways, death or serious injury may result due to loss of control of the brush chipper and towing vehicle. Property or equipment damage may also occur. IK00-4055 has been created to provide the necessary parts and instructions to replace the axle mounting hardware.

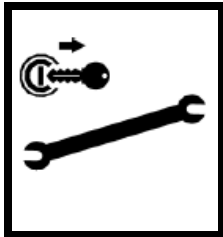

SPECIAL TOOLS AND CONDITIONS:

- None

		<p>WARNING: Failure to use shutdown procedure can result in unexpected hazard(s). Death or serious injury could result due to entanglement, crushing, cutting, or other hazardous contact. Follow shutdown procedure after operating, before performing any service or maintenance, and before transporting.</p>
---	---	---

Shutdown procedure

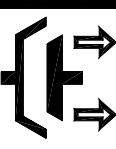
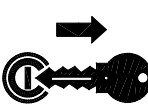
1. Return upper feed control bar to Neutral.
 2. Reduce engine speed to idle. For machines equipped with centrifugal clutch, cutter disc will disengage clutch handle **(2)** (if equipped).
 3. Shut off engine and remove key.
 4. Wait for cutter disc and belt to stop.
- NOTICE:** Cutter disc rotation can be checked by looking through the viewing slots **(1)** on belt housing shield. Cutter disc will continue to turn for a short time after engine has stopped.
5. Close and latch feed table.

<p>1.</p> 	<p>2.</p> 
<p>3.</p> 	<p>4.</p> 

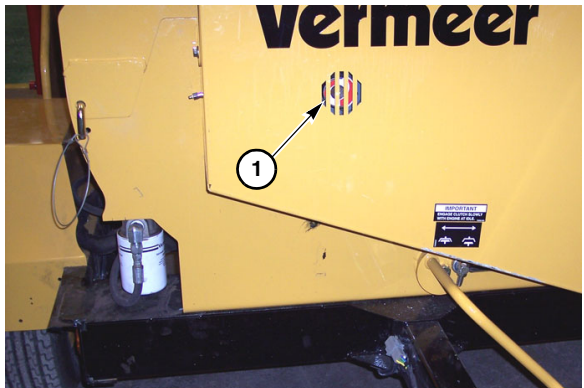

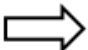
 Unless indicated, new parts from kit have callouts with numbers. Callouts with letters indicate existing parts or general items.

PROCEDURE:

1. Park machine on level ground and chock wheels. Use jack to support tongue.
2. Remove and discard existing bolt, washer and nut at each mounting location, one location at a time.
3. Using existing spacers, install screw (1), washer (2), and nut (3). The order of the hardware layout from top to bottom is as follows:

New M16 Bolt (1)
New M16 Washer (2)
Existing Top Spacer (A)
BC900XL Frame (B)
Dexter Axle Frame (C)
Existing Bottom Spacer (D)
New M16 Washer (2)
M16 Nut (3)
4. Using hand tools only, torque the nut (3) to 196 ft-lb (266 Nm). Do not use an impact tool to tighten hardware.
5. Remove Figure 1 and attach it to the invoice or place them in the manual storage box so unit owner can place them with existing Parts Manual.

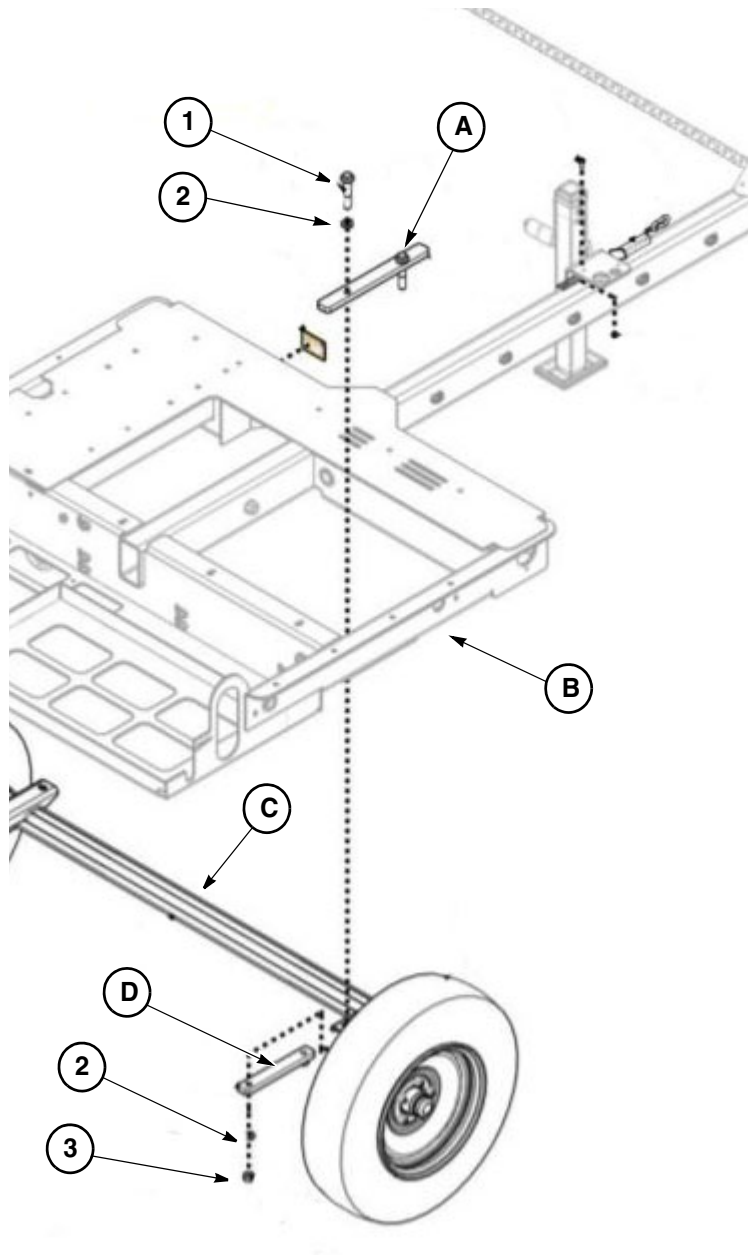

UNIT OWNER COPY
 Insert into Parts Manual
 for future reference.

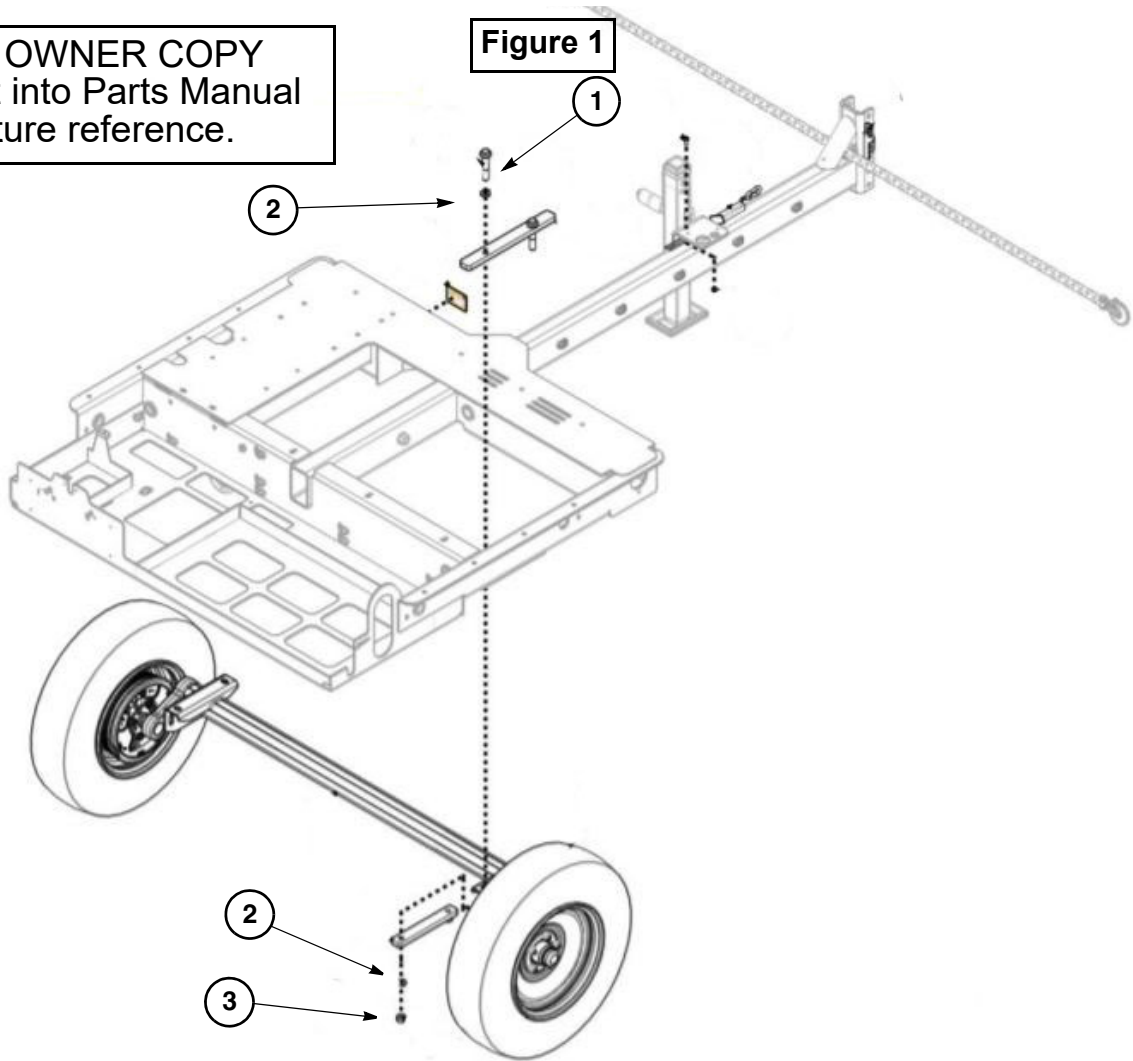

Figure 1 Parts List

REF. NO.	PART NO.	DESCRIPTION	IK01 QTY.
1	507614090	SCREW,HFS,M16,2.00X90,10.9,ANSI,B18.2.3.9M,PT	4
2	508486016	WASHER - FLAT, HARDENED, M16, DIN6916	8
3	507090016	NUT-HEX-M16-2.00-10	4
		Kit includes all items in Figure 1 parts list.	