

SAFETY RECALL

VOLVO Trucks North America
Greensboro, NC USA

VOLVO

Date	Number	Page
09/20	RVXX2004	1 (31)

Pedal Carrier Date Code Inspection

SAFETY RECALL INFORMATION

(September 2020)

Volvo Trucks has determined that a defect that relates to motor vehicle safety exists in certain VN model vehicles fitted with the part 82754992 with the date code September, 2019 OR October, 2019.

The die cast pedal plate may have a casting process issue that can result in failure of the pedal plate at one of three attachment ears that support the brake pedal shaft. If the attachment ear fails and the brake pedal shaft works its way out of one of the two other attachment holes, the brake pedal may dislodge, making the brake pedal inoperable. An inoperable brake pedal presents a risk of a vehicle crash.

There are no reports of an inoperable brake pedal or a vehicle crash related to this issue. Volvo considers this a proactive measure to protect the public and Volvo's customers from the potential risk associated with this defect.

VEHICLES AFFECTED

Volvo: 2020 & 2021 VAH, VHD, VNL, & VNR model vehicles manufactured from October 15, 2019 through July 24, 2020.

VEHICLE QUANTITIES:

13,209 (Canada 1,825, Mexico 257, and 11,127 USA)

SOLUTION

Follow Inspection, Test and Repair procedures as necessary in this Recall.

INSPECTION PROCEDURE:

DECOMMISSIONING THE TRUCK FOR REPAIR



Do not attempt to repair or service this vehicle without having sufficient training, the correct service literature and the proper tools. Failure to follow this could make the vehicle unsafe and lead to serious personal injury or death.

NOTE

Wear safety glasses during the duration of this repair to protect from possible inadvertent glass breakage

1. Secure the vehicle for service by parking on a flat and level surface.
2. Apply parking brake.
3. Place the transmission in neutral or park.
4. Install the wheel chocks.

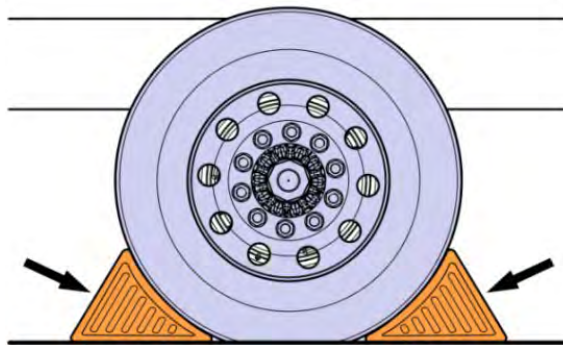

5. Disconnect the cable from the battery's negative (ground) terminal.

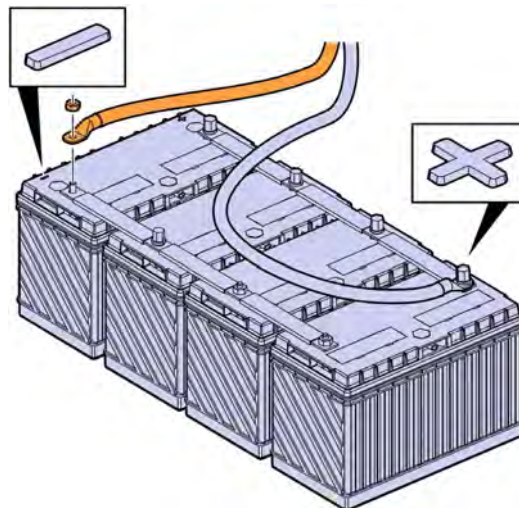

6. Unlatch and raise the hood.
7. Remove the splash shields.
8. Loosen the adjustment nut.

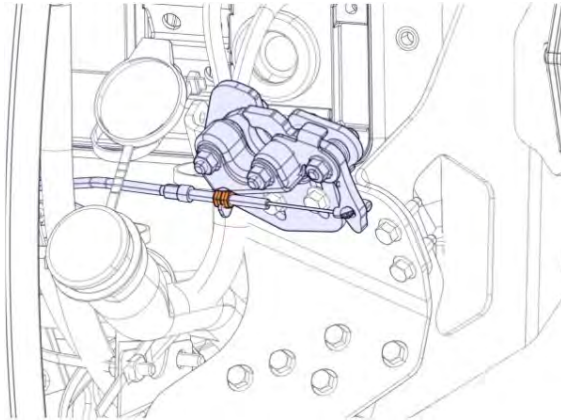

9. Remove the release cable.

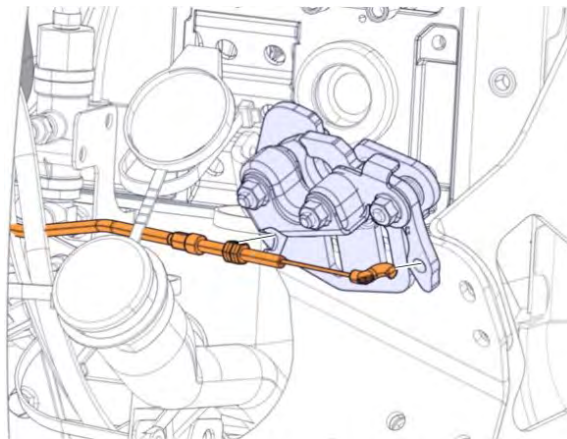

10. Pull back the passenger side panel to gain access for the center panel.



11. Remove the screws.

12. Remove the panel.

Note: Use caution not to damage the panel.

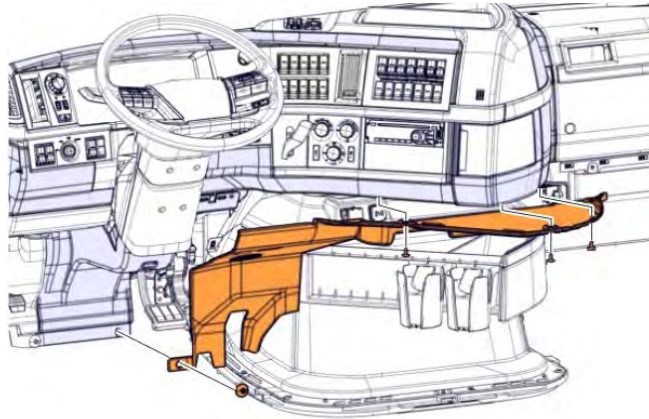

13. Remove the screws.

14. Remove the cover.

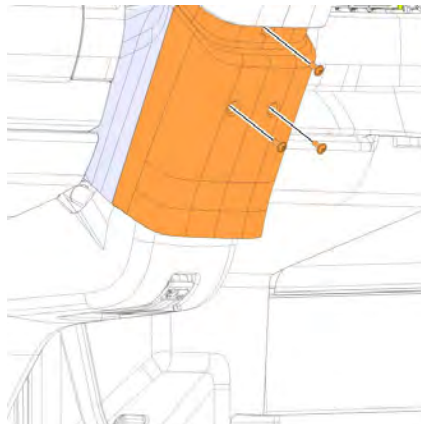

15. Remove the screw cover.

16. Remove the screws.

17. Remove the handle.

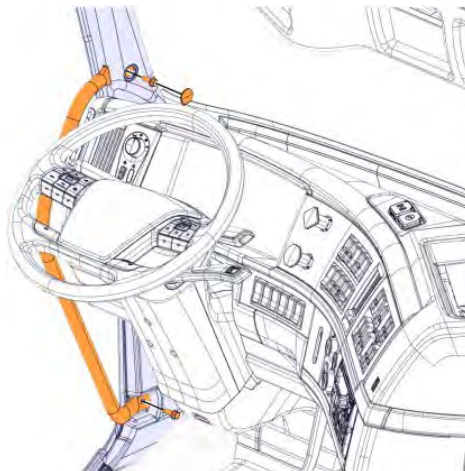

- 18. Remove the screws.
- 19. Remove the panel.

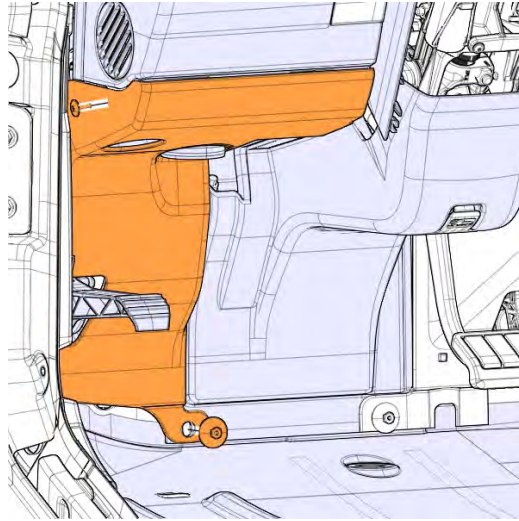

- 20. Disconnect hood release cable.

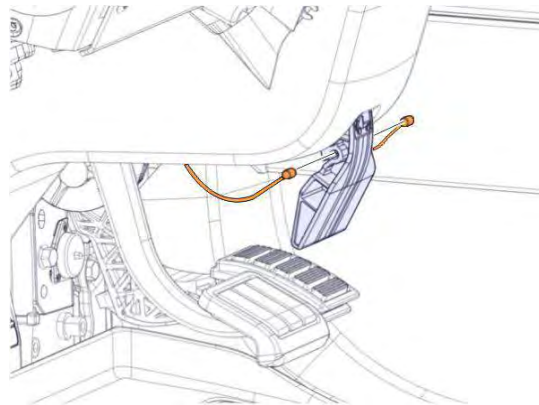

- 21. Remove the screws.
- 22. Remove the panel.

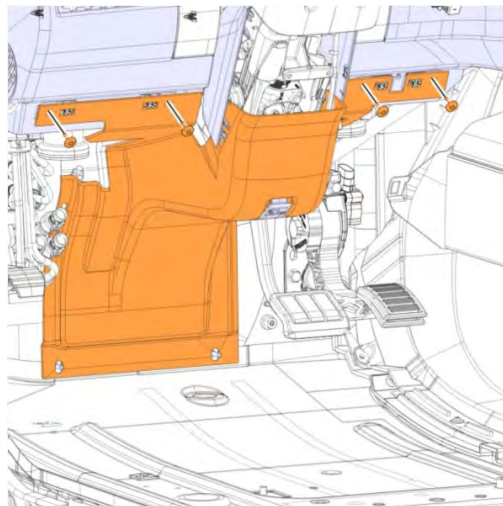

23. Check the date code on the pedal carrier.

Note: A) Find the row which indicates the year.

For example: the row under 18 is 19 and indicates year 2019.

B) Count the number of dots or the position of the dots.

For example: One dot in the first position is January.

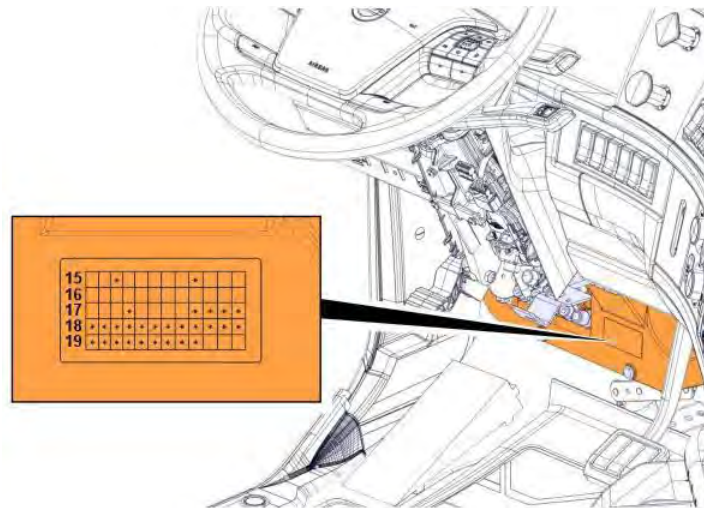

Photo shows an example of September, 2019 date code

24. If the date code shows 9 or 10 dots in row 19 this indicates September, 2019 or October, 2019. Then continue to the Test Procedure next.

25. If date code IS **NOT** 9 or 10 dots, then replace all removed components in reverse order and return the truck to service. File claim as Part "A" Only.

TEST PROCEDURE:

1. Start the vehicle and allow air pressure to build to 120 psi or connect to shop air.
2. Perform 12 simulated emergency stops.



3. Remove the bolt.
4. Pull the brake pedal shaft out enough to inspect casting.



- From the driver's perspective; thoroughly inspect both sides of the right most ear for possible defects. The defects seem to resemble a crack with some discoloration. Use examples below to determine defective parts See Fig. 1 and Fig. 2 (circled line/cracks show the signs of defective parts)



Figure 1

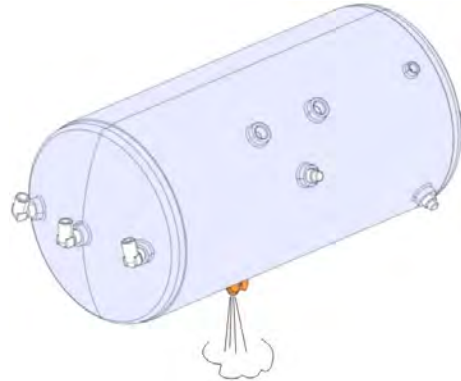

Figure 2

- Before continuing, create an ARGUS case with RVXX2004 in the Summary field, choose Reliability in the App/Service field and add photos of the right most, mounting ear from both sides of the ear. In the Description field indicate whether the Pedal Carrier Plate was replaced or there were no defects found.
- If defects are found, then continue to the Repair Procedure next.
- If defects are **NOT** found then replace all removed components in reverse order and return the truck to service. File claim as Part "A" + Part "B" Only.

REPAIR PROCEDURE:

1. Drain the compressed air tanks.



2. Secure the steering wheel.

Note: Make sure the steering wheel is straight and the front wheels are pointed straight ahead.

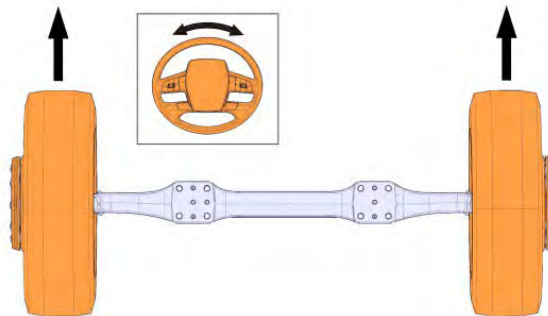

3. Remove the screws.
4. Remove the column cover mounting bracket.

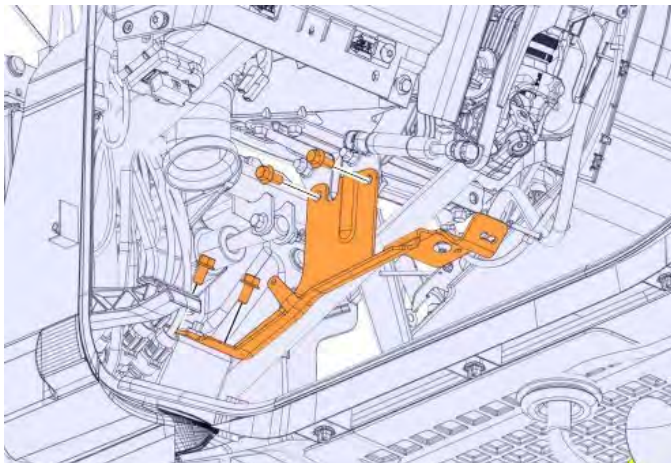

5. Remove dash support rod.

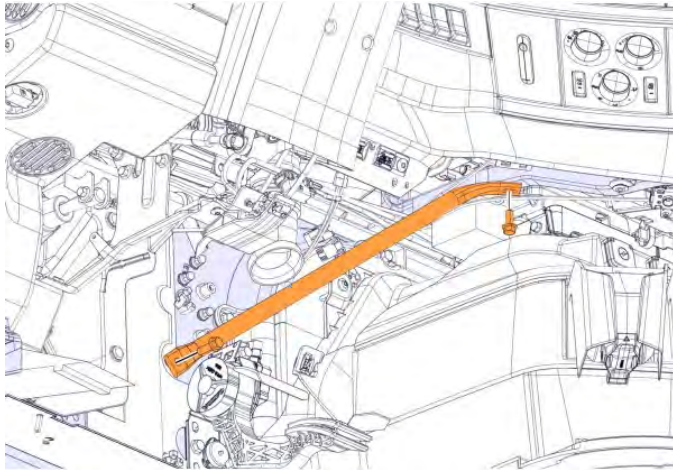

6. Mark the position.
7. Remove the screw and the nut.
8. Remove the steering shaft.

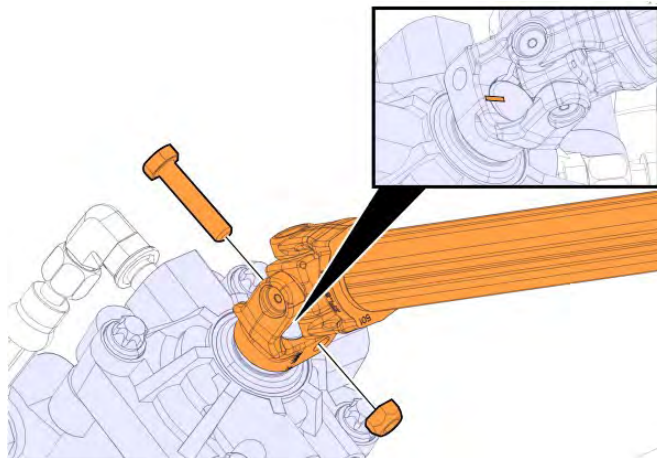

9. Remove the tie.

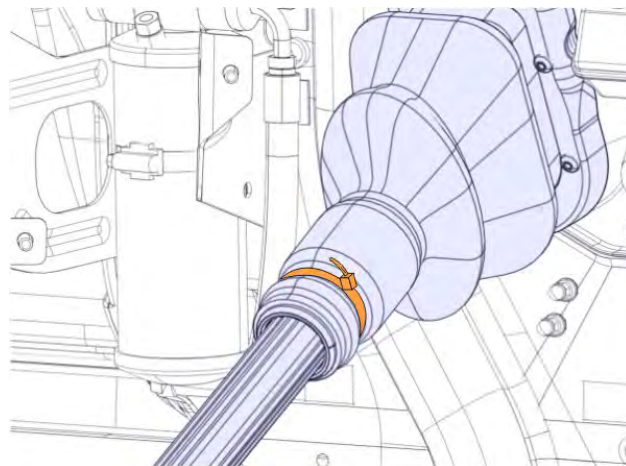

10. Remove the sleeve bushing.

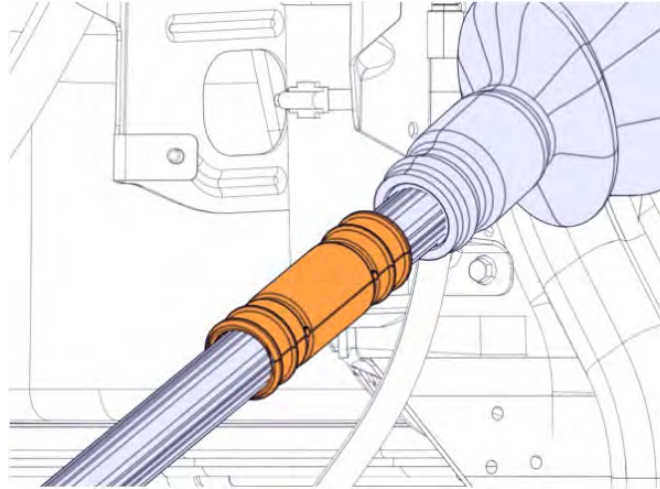

11. Remove the screws.

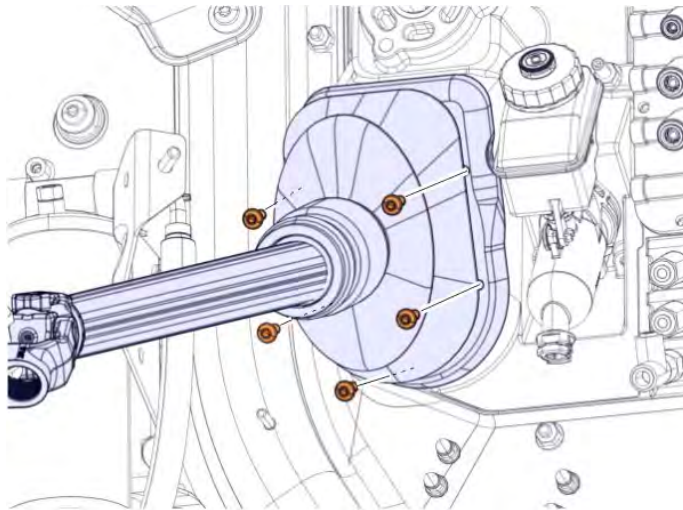

12. Remove the boot.

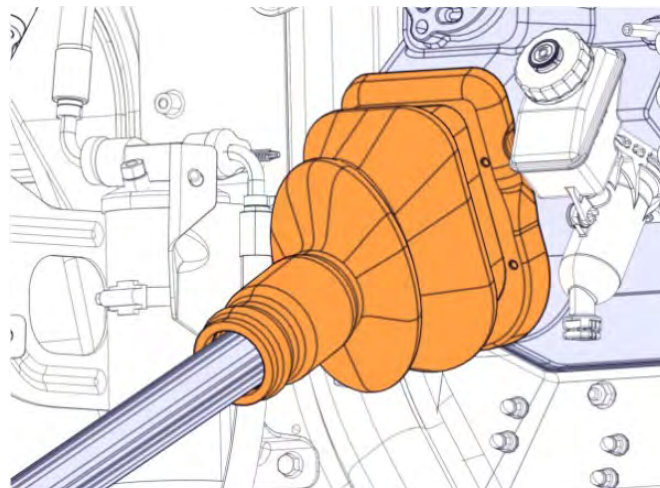

13. Mark the position.

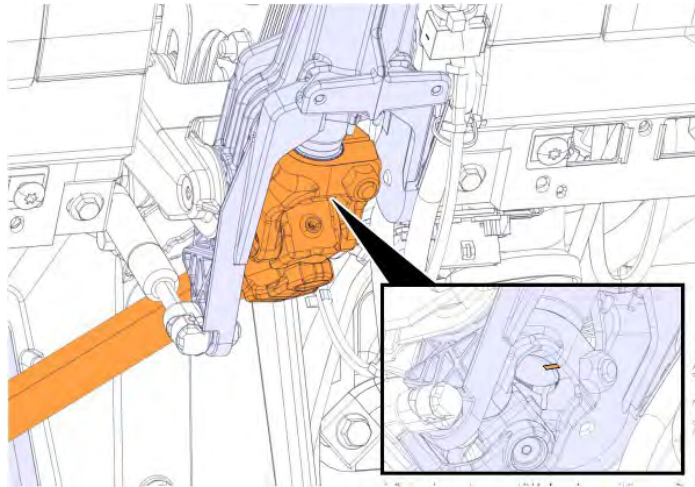

14. Remove the screw and nut.

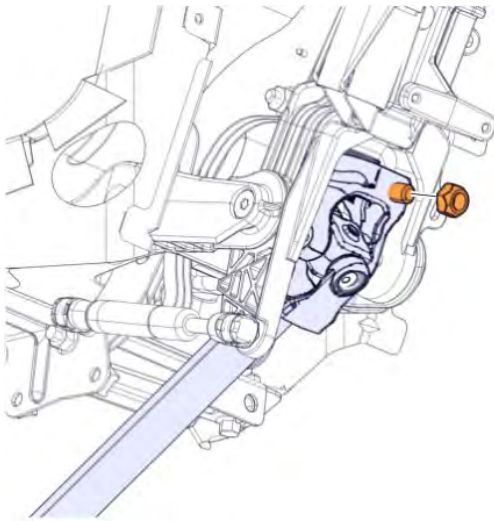

15. Remove the steering shaft.

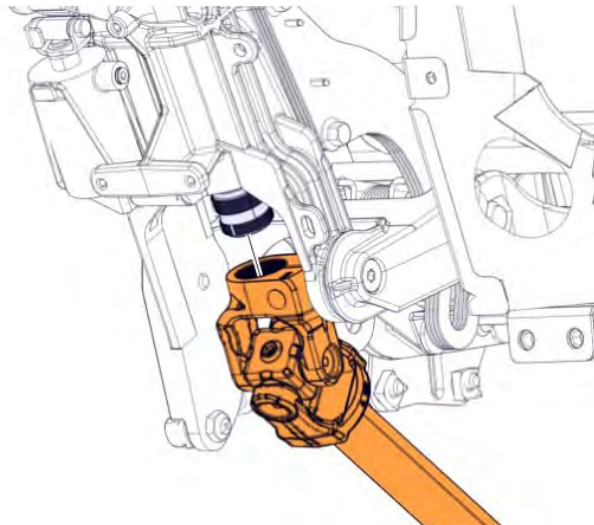

16. Remove the steering shaft.

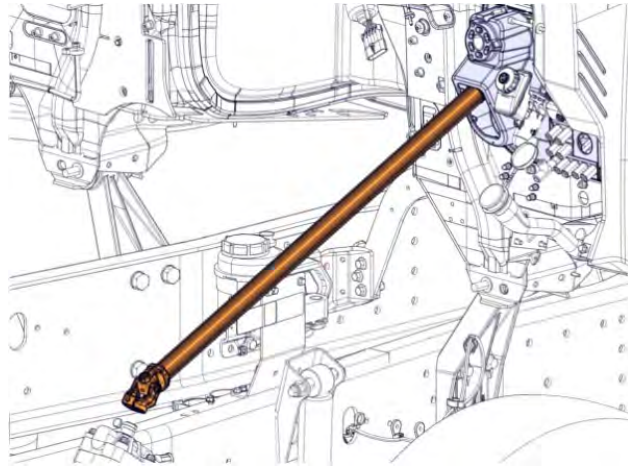

17. Remove upper left side cowl screws.

Note: Install a small wedge to make an access slot.

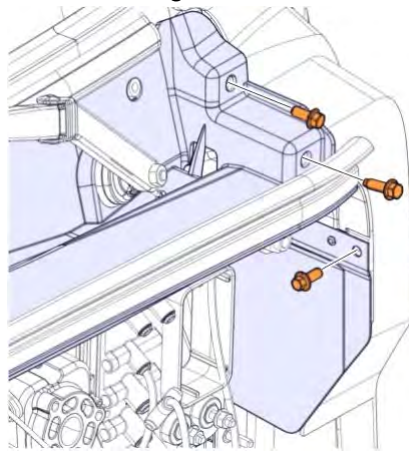

18. Remove the screws.

19. Remove left side hood latch with bracket.

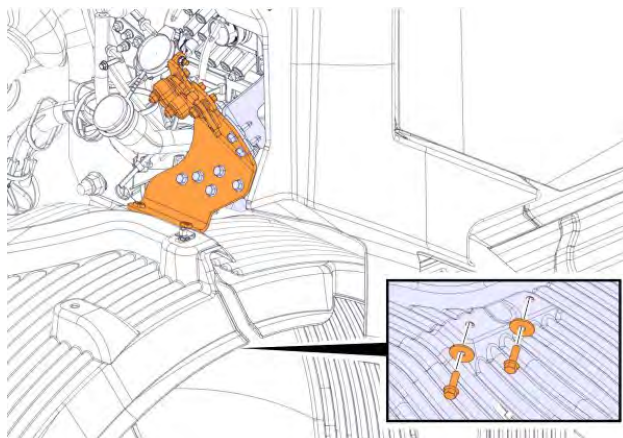

20. Label and take photos of all electrical and air connections on the pass-through.

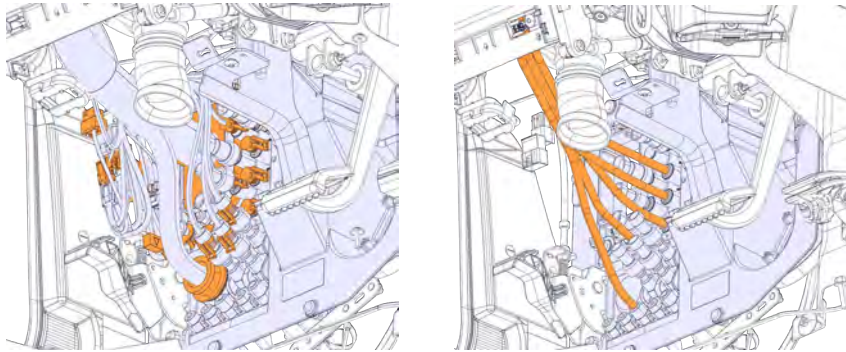

Electrical and Pneumatic connections inside the cab

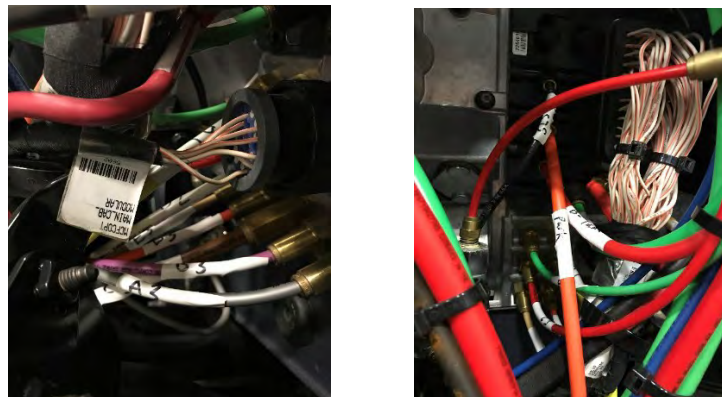
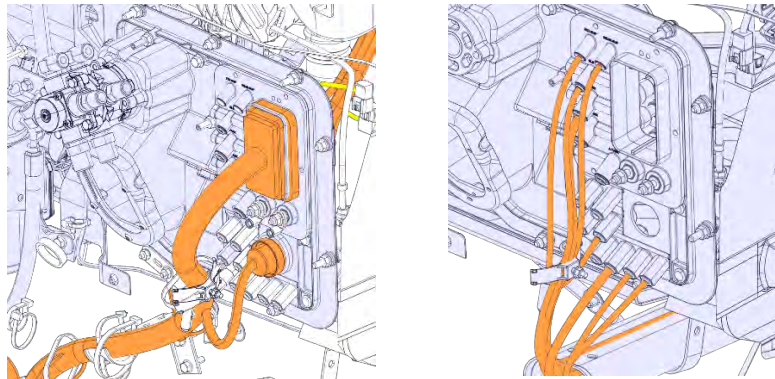

Electrical and Pneumatic connections outside of the cab
(Engine compartment)

21. Disconnect the electrical connections and airlines.
22. Remove the nuts.

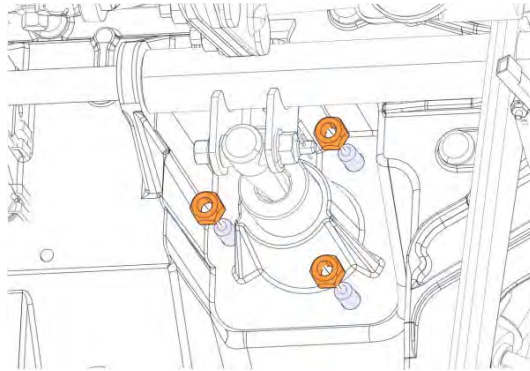

23. Remove brake valve leaving all air lines attached.



24. Remove all electrical and air connections inside and outside of the truck strap everything up and out of the way.



25. Remove the nuts.

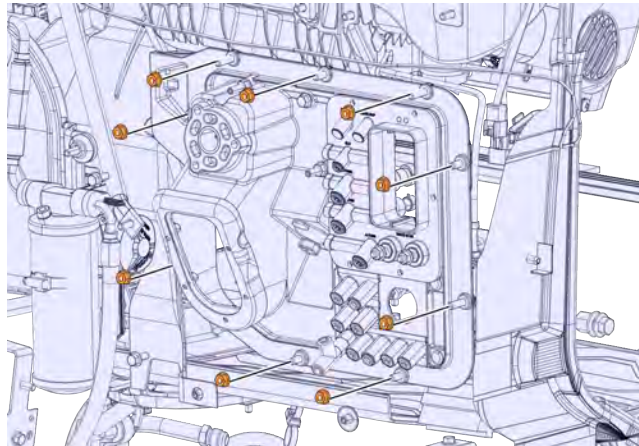

26. Pull the pedal plate away from the firewall.

27. Remove the nut.

28. Remove the bracket.

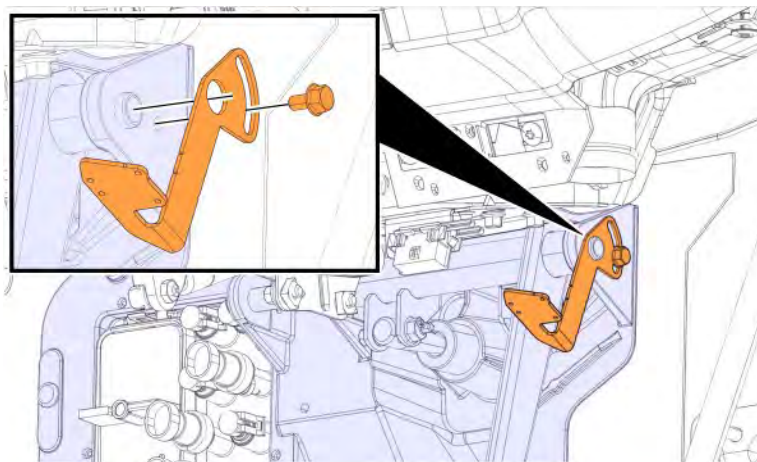

29. Remove the brake pedal and brake pedal shaft from the pedal plate.

Note: The pedal plate will not clear the steering column brackets without removing the brake pedal.

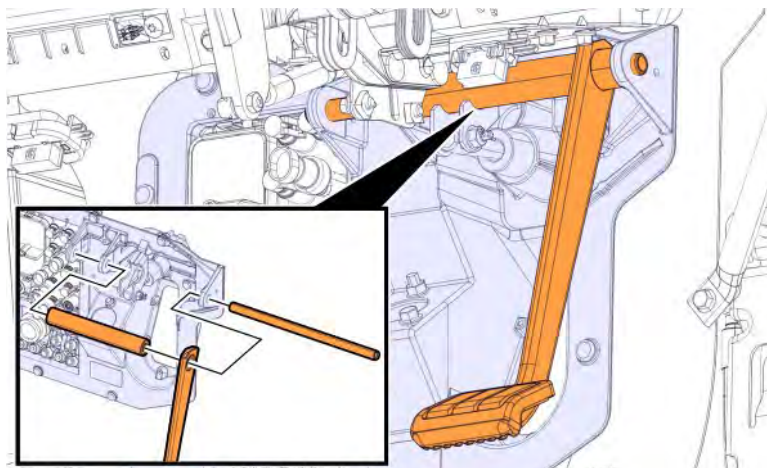

30. Transfer all parts to the new pedal plate.

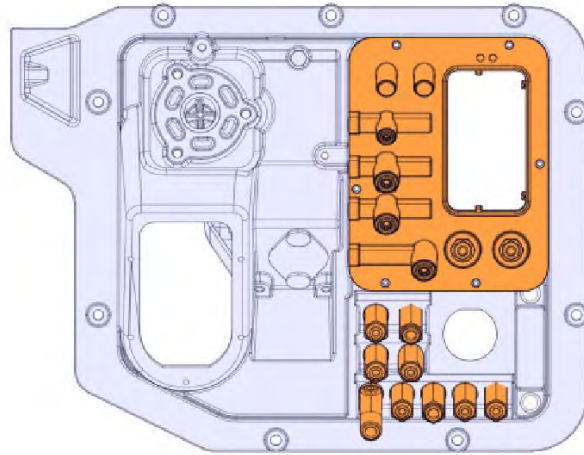

31. Apply Butyl tape to plate along the outside of flanges.

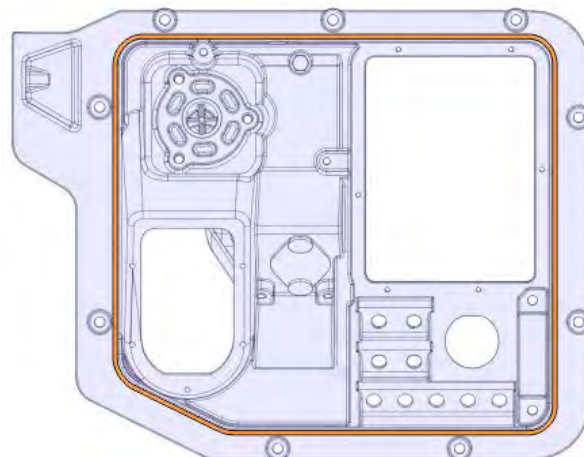

- 32. Install the pedal plate into the foot well, but not attached to firewall yet.
- 33. Install the brake pedal shaft and brake pedal on the pedal plate.

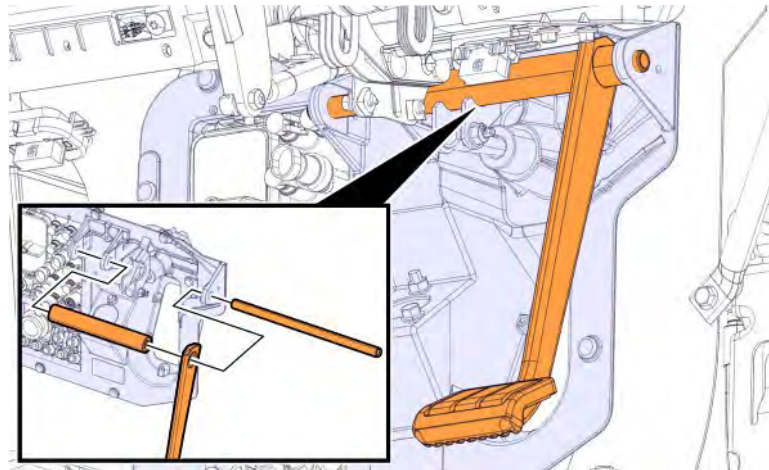

- 34. Install the bracket. (No specific adjustment is required)
- 35. Install the screw.

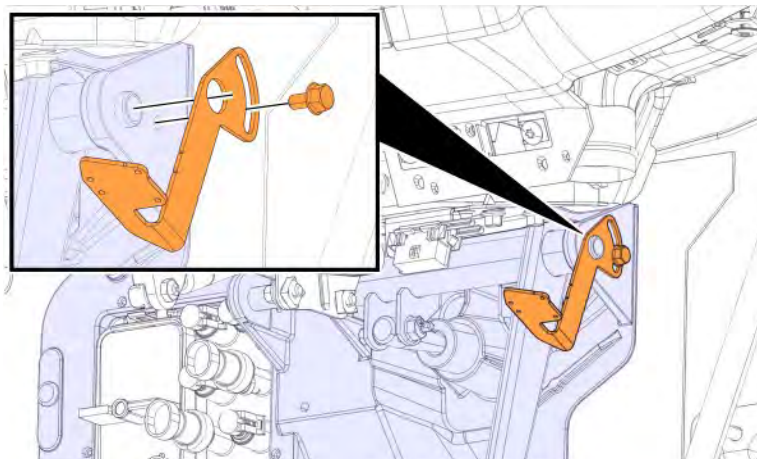

- 36. Install the pedal plate onto the firewall
- 37. Install the nuts.

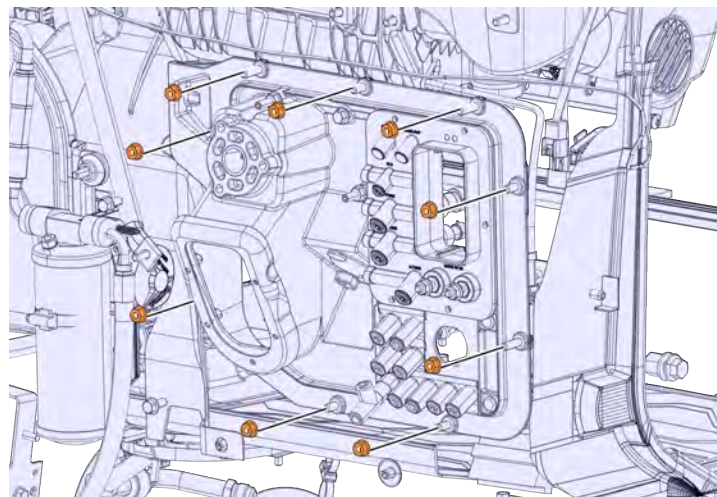

38. Connect the electrical connections and airlines.

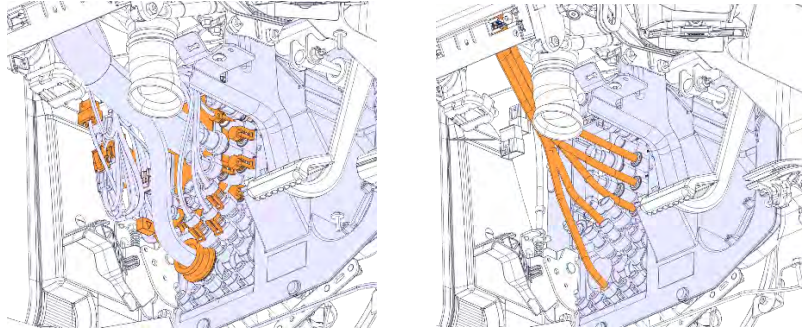

Electrical and Pneumatic connections inside the cab

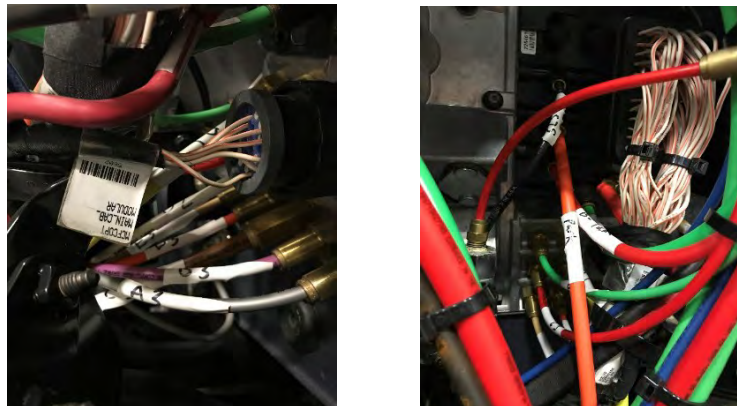
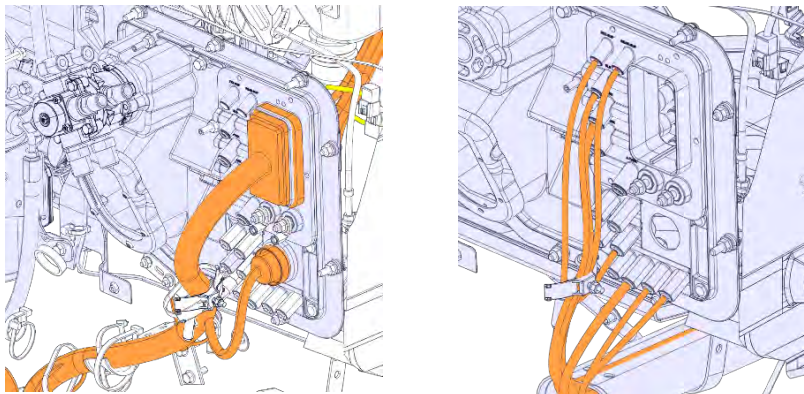

Electrical and Pneumatic connections outside of the cab

39. Install the foot brake valve.



40. Install the mounting nuts.

41. Torque tighten the nuts.

Tightening torque	
Footbrake valve, nut	24 ±4 Nm

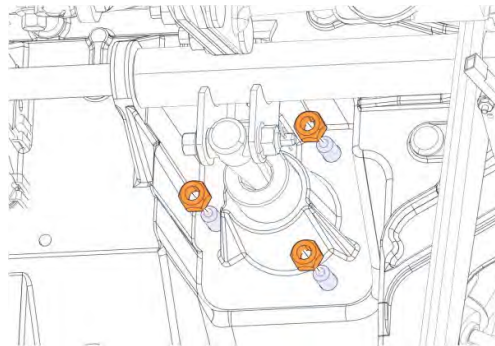

42. Install the steering shaft.

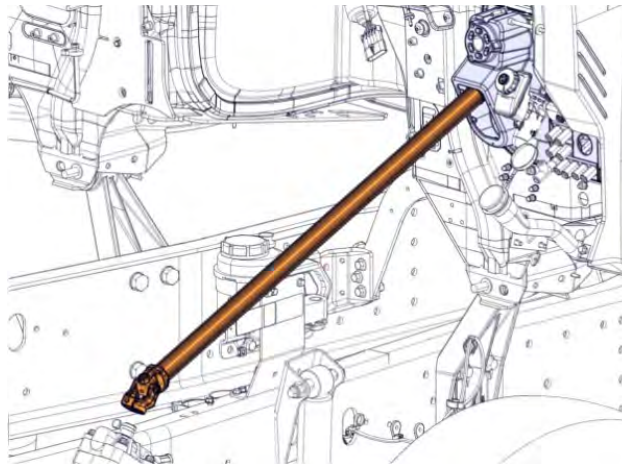

43. Install the steering shaft as marked.

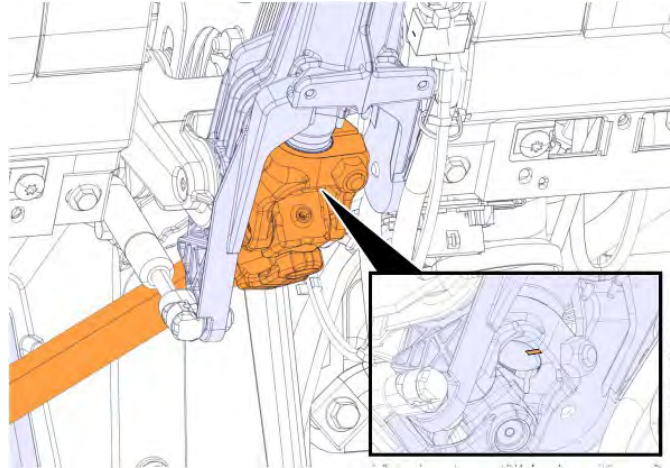

44. Install the screw and nut.

45. Torque tighten the screw.

Tightening torque		
Steering shaft, joint, screw	1.	30 ±3 Nm
	2.	60 ±5°

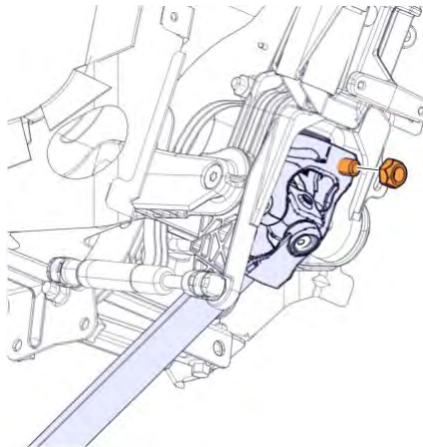

46. Install the boot.

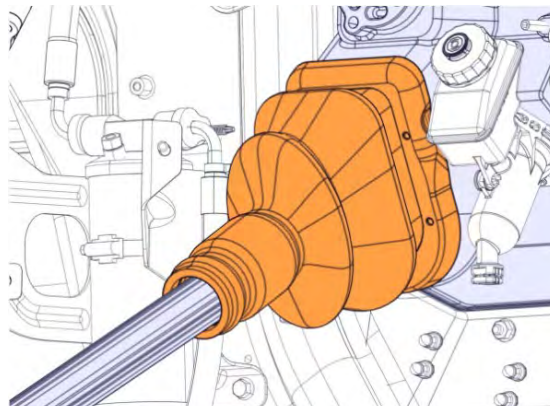

- 47. Install the screws.
- 48. Torque tighten the screws.

Tightening torque	
Screw	6 ±1 Nm

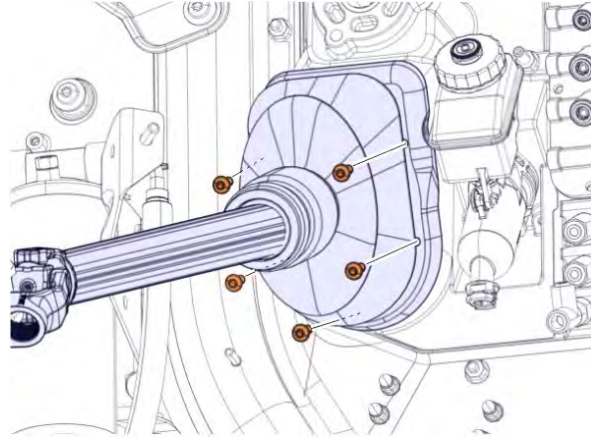

- 49. Install the sleeve bushing.

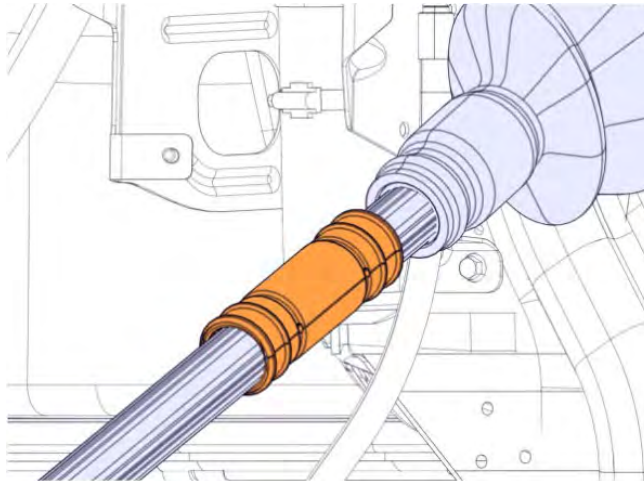

- 50. Install the tie.

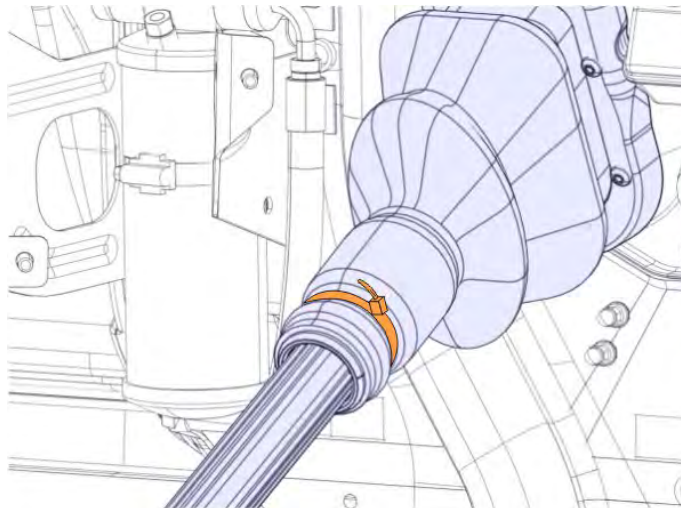

51. Install the steering shaft as marked.
52. Install the screw and nut.
53. Torque tighten the screw.

Tightening torque		
Steering shaft, joint, screw	1.	30 ±3 Nm
	2.	60 ±5°

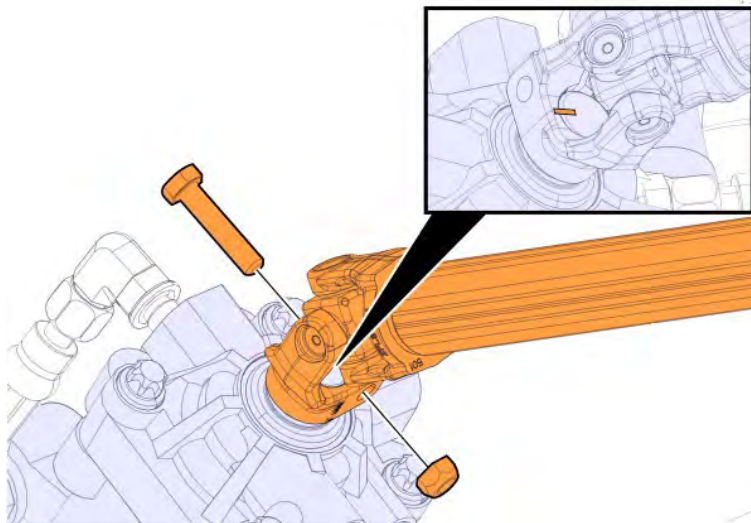

54. Install the upper left side cowl screws.
55. Torque tighten the screws.

Tightening torque	
Screw	24 ±4 Nm

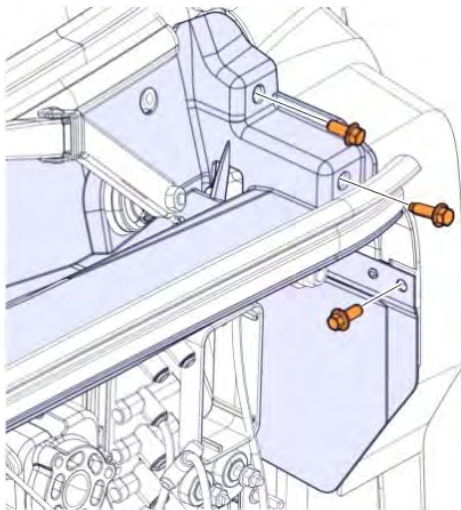

56. Install the left side hood latch with bracket.

57. Install the screws.

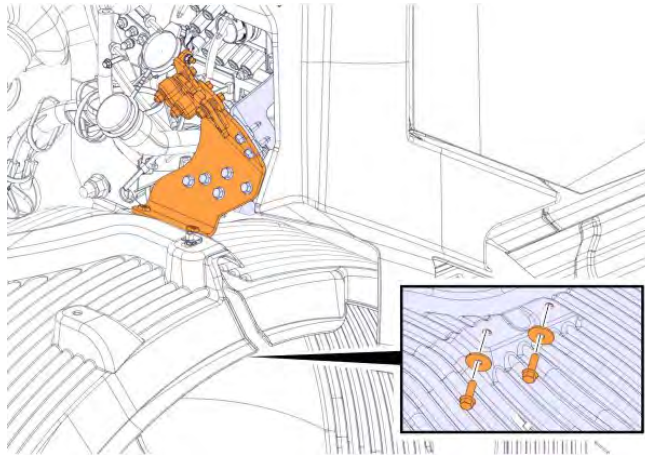

58. Install the column cover mounting bracket.

59. Install the screws.

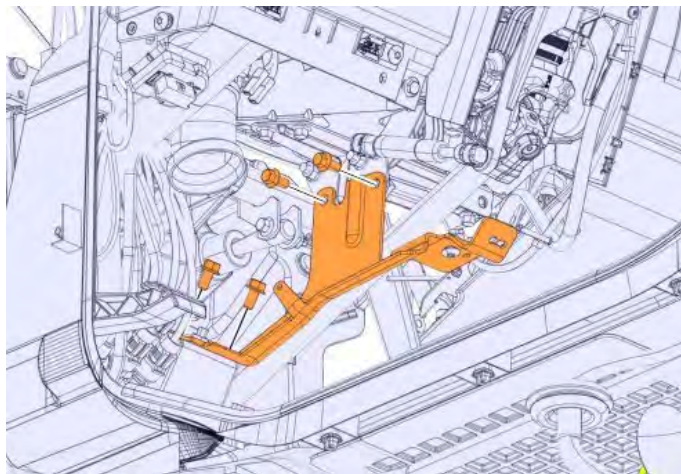

60. Remove dash support rod.

61. Install the screw.

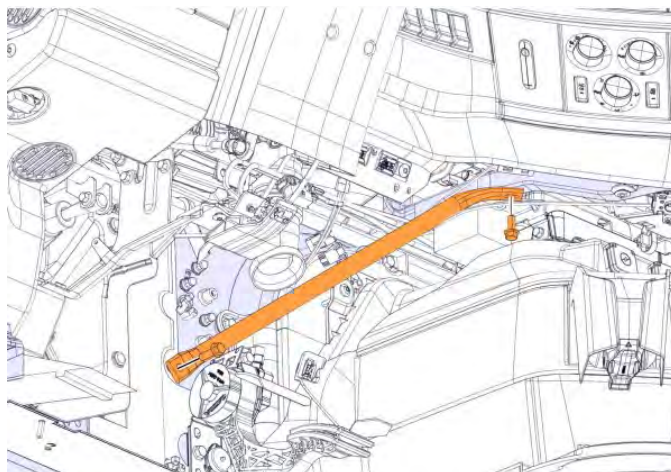

- 62. Install the panel.
- 63. Install the screws.
- 64. Torque tighten the screws.

Tightening torque	
Screw	M4
	1.5 ±0.5 Nm

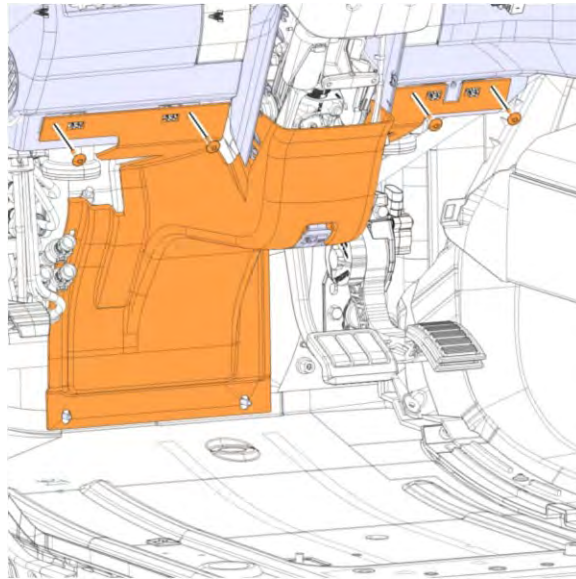

- 65. Install the hood release cable.
Note: Install the cable tie as needed.

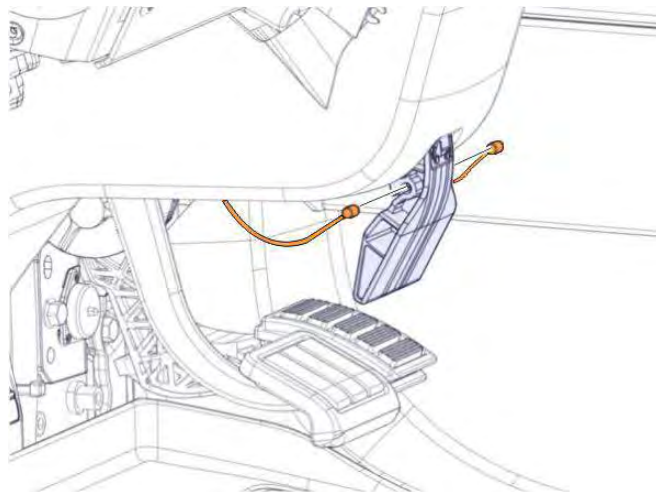

- 66. Install the panel.
- 67. Install the screws.
- 68. Torque tighten the screws.

Tightening torque	
Screw	M4
	1.5 ±0.5 Nm

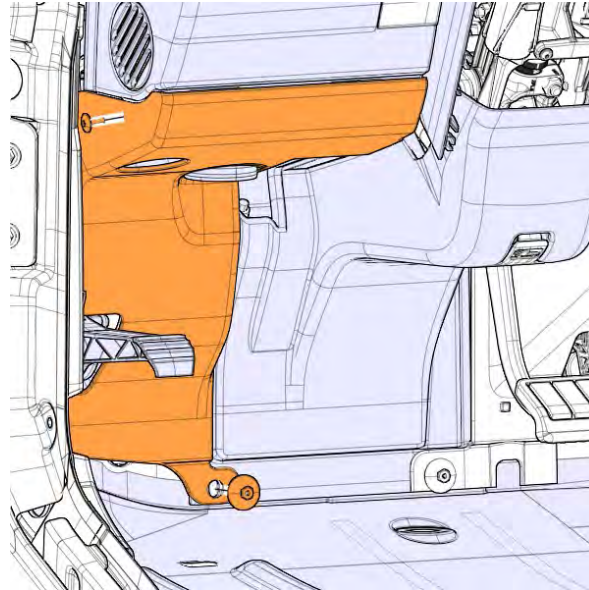

- 69. Install the handle.
- 70. Install the screws.
- 71. Torque tighten the screws.

Tightening torque	
Screw	M8
	24 ±4 Nm

- 72. Install the screw cover.

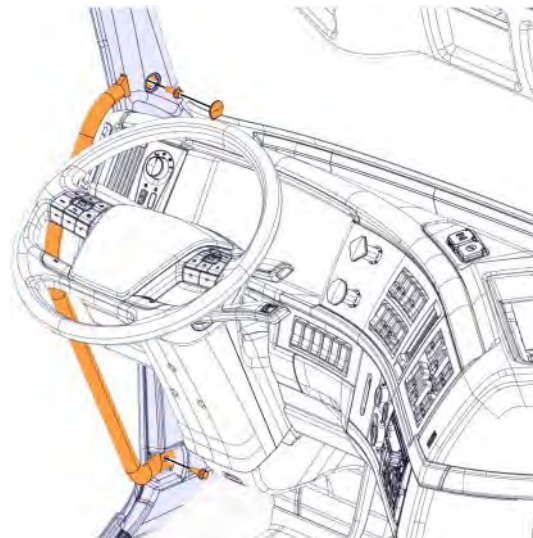

- 73. Install the cover.
- 74. Install the screws.
- 75. Torque tighten the screws.

Tightening torque	
Screw	M4
	1.5 ±0.5 Nm

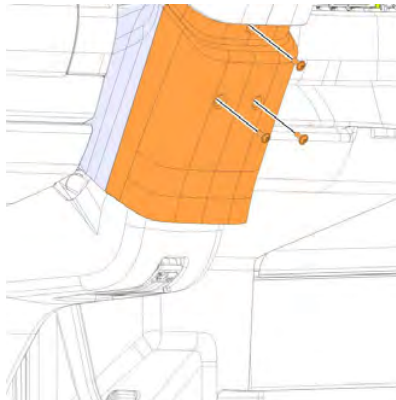

- 76. Install the panel.
- 77. Install the screws.
- 78. Torque tighten the screws.

Tightening torque	
Screw	M6
	10 ±1.5 Nm

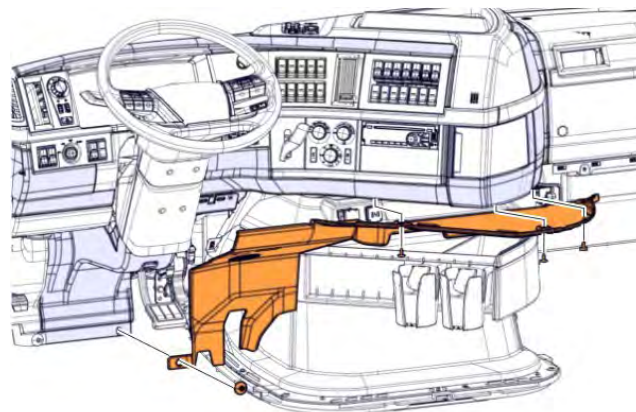

- 79. Push the passenger side panel to the original position.



80. Route the cable to the latch.

Note: Install the cable ties as needed.

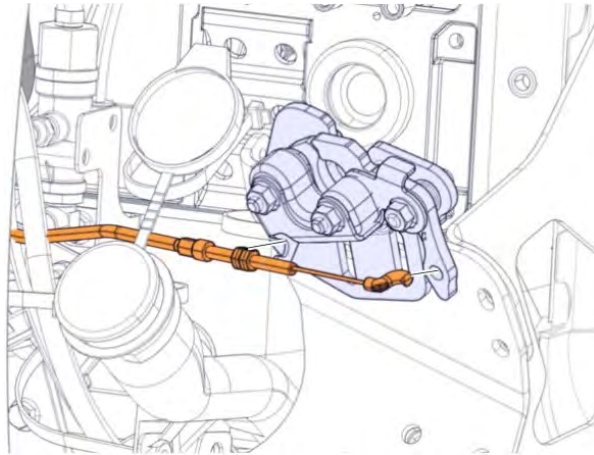

81. Tighten the adjuster.

Note: a) Check release cable adjustment and readjust if necessary.
b) Check the hood for operation.

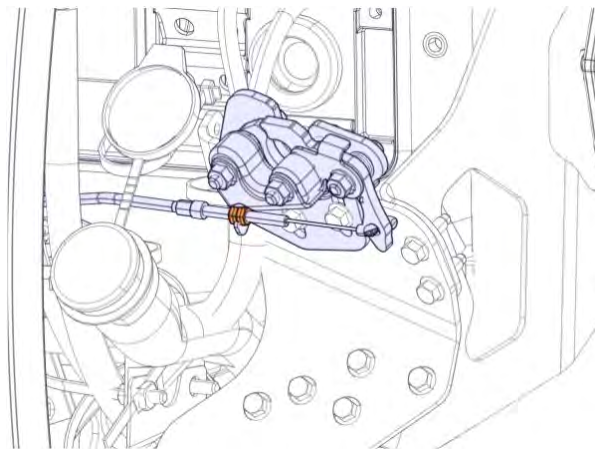

82. Connect the cable to the negative terminal.

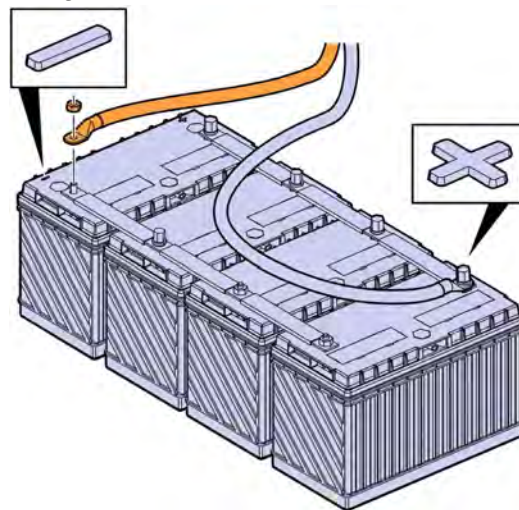

83. Start the engine.
84. Idle engine until the pneumatic system is at operating pressure.
Note: The pneumatic system is full when the compressor unloads.
85. Check for leaks.
86. Lower the hood.
Note: Ensure that the hood is latched.
87. Remove the wheel chocks.

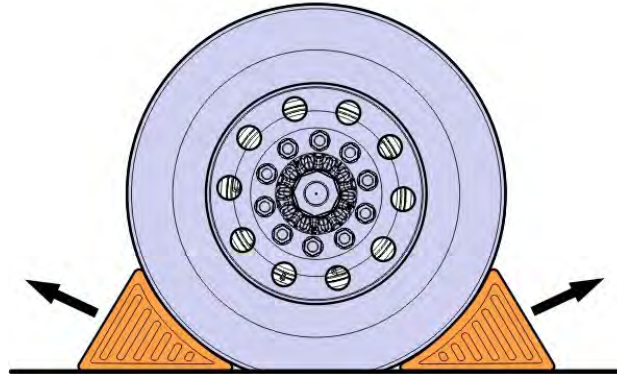

Note:
Upon completion of the recall please forward these instructions to your warranty administrator for proper claim filing and reimbursement.

REIMBURSEMENT:

Claim Instructions:

If **Inspection ONLY** was completed and specific date code on the Pedal Carrier Plate was NOT found, (See Pg 6, Step 25)

Labor code for the claim is: 5240-06-09-01 "A" Only

NOTE: When the Pedal Carrier has NOT been replaced. Under claim "Material" for Causal part...."REPAIRED" must be selected, see below. **ALSO WHEN ONLY INSPECTION** was completed.

Claim job information	Labour	Material	Other costs	Remarks	Attachment	History
Causal part						
Prefix	Part no.	Description	Func. group	Serial no.		
VO	82754992	PEDAL CARRIER	5241			
<input type="radio"/> Replaced <input checked="" type="radio"/> Repaired						

If **Inspection AND Functional Test** has been completed but no defect found, (See Pg 8, Step 9)

Labor codes for the claim are: 5240-06-09-01 "A" +
5240-08-09-01 "B"

NOTE: When the Pedal Carrier has NOT been replaced. Under claim "Material" for Causal part...."REPAIRED" must be selected, see below.

Claim job information	Labour	Material	Other costs	Remarks	Attachment	History
Causal part						
Prefix	Part no.	Description	Func. group	Serial no.		
VO	82754992	PEDAL CARRIER	5241			
<input type="radio"/> Replaced <input checked="" type="radio"/> Repaired						

If **Inspection, Functional Test AND Repair** has been completed

Labor codes for the claim are:

5240-06-09-01 "A" +
 5240-08-09-01 "B" +
 5240-03-09-01 "C"

NOTE: When the Pedal Carrier has been removed and replaced. Under the claim "Material" for Causal part...."REPLACED" must be selected, see below.

Claim job information	Labour	Material	Other costs	Remarks	Attachment	History
Causal part						
Prefix	Part no.	Description	Func. group	Serial no.		
VO	82754992	PEDAL CARRIER	5241			
<input checked="" type="radio"/> Replaced <input type="radio"/> Repaired						
Included material						
New	Prefix	Part no.	Description	Func. group	Serial no.	Quantity
<input checked="" type="radio"/>	VO	82754992	PEDAL CARRIER	5241		1

This repair is covered by an authorized Safety Recall campaign. Reimbursement is obtained through the normal claim handling process.	
Claim Type (used only when uploading from the Dealer Business System)	R
Recall Status	
Vehicle repaired per instructions	Modified per instructions
Labor Codes	
Part A: Primary Labor Code, Pedal Plate Date Code Inspection	5240-06-09-01 0.6 Hrs
Part B: Additional Labor Code, Pedal Plate Functional Test	5240-08-09-01 0.4 Hrs
Part C: Additional Labor Code, Pedal Plate Replacement	5240-03-09-01 3.5 Hrs
Parts Disposition	Replaced parts will be triggered for return
Causal Part	82754992
Authorization Number	C6619

Note: Dealers are to perform Safety Recall Campaigns on all subject vehicles at no charge to the vehicle owner regardless of mileage, age of vehicle or ownership (original purchaser or subsequent purchasers). Whenever vehicles are subject to a safety recall are brought to your dealership for service, or taken into your dealership vehicle inventory, it is strongly recommended that every effort be made to perform the recall correction before the vehicle is sold or released to the owner.