



## Safety Recall Action Notice 584 Issue 2 - 10.2020

Subject: VIN Label Protector Fitment			
Bulletin Number	Models Affected	VIN Range	Markets Affected
584	Street Scrambler	From VIN 914448 to VIN AC6893	All Markets Except China
584	Street Twin	From VIN 914973 to VIN AC6893	All Markets Except China

### Background Information

Internal investigations have identified that the current harness routing can cause damage to the ignition branch and switch housing wiring.

To rectify this, a new VIN label protector will need fitting to the motorcycle and some motorcycles will need a rework of the harness.

Dealers are requested to fit a VIN label protector and to check and if necessary reroute/repair the harness as described in the procedure below.

### Customer Contact Instructions

#### Notice

STOP DELIVERY OF AFFECTED MOTORCYCLES IMMEDIATELY.

DO NOT deliver a motorcycle affected by this Safety Recall Action Notice to a customer until you have completed, or confirmed completion of, the procedures described in this Safety Recall Action Notice.

Delivering a motorcycle subject to an outstanding Safety Recall Action Notice may contravene local or national laws in your market, territory or country.

Triumph subsidiaries and distributors must instigate a Safety Recall Action in their country in accordance with the national recall code of practice. For vehicles in dealer stock, the safety recall MUST be actioned before delivery to the customer.

Dealers are to prioritise repair of customer owned motorcycles before any unsold motorcycles.

---

## Identification of Affected Motorcycles

Street Twin and Street Scrambler models in the VIN ranges shown above.

### Note:

- Some affected motorcycles listed in the VIN range will have been modified and repaired by Triumph prior to their release from the factory.
- Unmodified motorcycles can be identified by checking the 'VIN Enquiry' on [www.triumphonline.net](http://www.triumphonline.net).

## Warranty Claim Instructions

Bulletin Number	Market	Fault Code	Repair Code	Description	Repair Time Allowance
584	All Markets Except Brazil and India	02501090	995841	Install VIN label protector and reorientation of main harness	0.70 Hrs
584	Brazil and India only	02501090	995842	Install VIN label protector and reorientation of main harness	0.70 Hrs

### Parts Ordering Instructions

**For Triumph Subsidiary and Overseas Distributor dealers using Triumph Warranty On-Line with Parts Auto Ordering Flag switched on:** Order all repair parts by submitting a New Prior through the Warranty On-Line system. Entering the above repair code in a New Prior will automatically add the parts required and labour times for this Safety Recall Action Notice.

**For Overseas Distributor dealers NOT using Triumph Warranty On-Line or for Overseas Distributor dealers using Triumph Warranty On-Line with Parts Auto Ordering Flag switched off:** Orders should be placed using the normal parts ordering procedure.

### Genuine Parts Return

Dealer to retain parts for 90 days. All parts must be stored in a secure, non-public accessed area and correctly identified with a completed warranty label. Thereafter the parts must be rendered unusable prior to scrapping.

---

## Genuine Parts Information

Bulletin Number	Market	Part Number	Description	Quantity
584	All Markets Except Brazil and India	T2076949	<b>Parts Kit, Harness Rework</b> Consisting of: Screw, button, M5 x 12, Enc - Qty 2 Screw, Pan/Hd, Tx, M5 x 12, Slv - Qty 2 Lock nut, flanged, M6 x 1 - Qty 2 VIN label protector - Qty 1	1
584	Brazil and India only	T2076999	<b>Parts Kit, Harness Rework</b> Consisting of: Screw, button, M5 x 12, Enc - Qty 2 Screw, Pan/Hd, Tx, M5 x 12, Slv - Qty 2 Lock nut, flanged, M6 x 1 - Qty 2 VIN label protector - Qty 1 Screw, Pan/Hd, TX, M6 x 35, Slv - Qty 1 Flange Sleeve, 6.4 x 8.8 x 7.5 - Qty 1	1

The tape required in this bulletin has been free-issued to you as a roll, Triumph part number T2502518

## Other Instructions

Once completed, please mark the Service Record Book that the requirements of this Safety Recall Action Notice have been complied with.

Before returning the motorcycle to the customer, download the latest calibration to the engine electronic control module, chassis electronic control module (if fitted), keyless electronic control module (if fitted) and instruments (if applicable) using the current version of the Triumph diagnostic software.

## VIN Label Protector Installation

### **Warning**

Make sure the motorcycle is stabilised and adequately supported.  
A correctly supported motorcycle will help prevent it from falling.  
An unstable motorcycle may fall, causing injury to the operator or damage to the motorcycle.

The instrument branch of the harness should be checked for orientation and, if necessary, modified to the correct orientation as described in the harness rework procedure below.

#### **All markets except Brazil and India**

1. Turn the handle bars to the left to allow access to the VIN label protector fixings.
2. Remove the lock nut, flanged sleeve and screw and remove the VIN label protector from the motorcycle. Discard the lock nut and VIN label protector.

#### **All markets**

3. Align the new VIN label protector to the frame as shown. Fit the flanged sleeve, screw and new lock nut to the VIN label protector and tighten the screw to **3 Nm** whilst holding the lock nut.

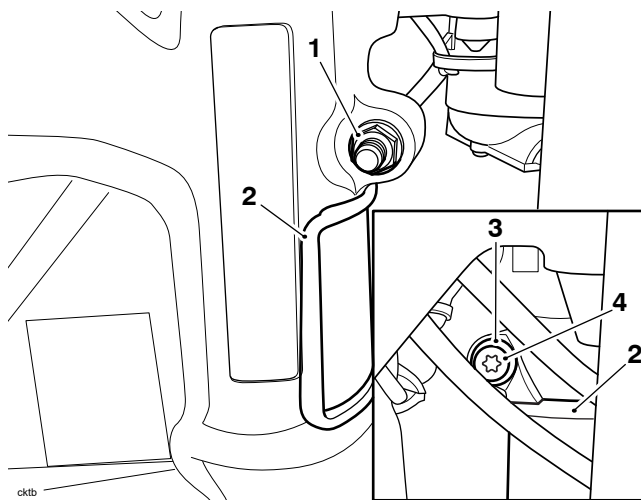

1. Lock nut
2. VIN label protector
3. Flanged sleeve
4. Screw

## Harness Rework

### **Warning**

Make sure the motorcycle is stabilised and adequately supported.  
A correctly supported motorcycle will help prevent it from falling.  
An unstable motorcycle may fall, causing injury to the operator or damage to the motorcycle.

1. Remove the seat as described in the Service Manual.
2. Disconnect the battery as described in the Service Manual.
3. Remove the fuel tank as described in the Service Manual.
4. Remove the headlight and headlight bowl as described in the Service Manual.

- 
5. Remove the instruments cover and discard the two fixings.

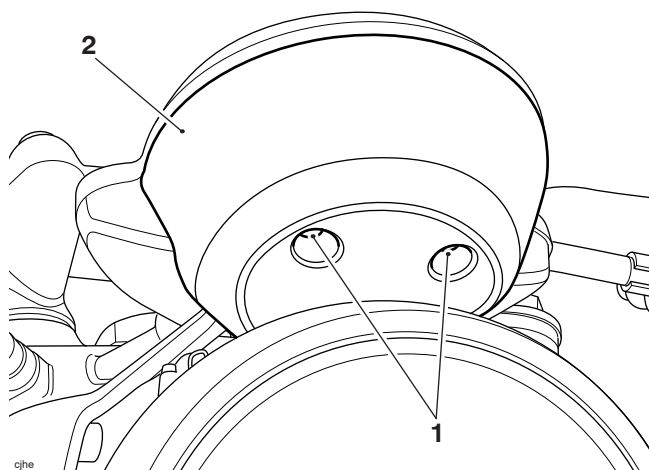

**1. Fixings**

**2. Instruments cover**

6. Disconnect the instruments electrical connector.
7. Remove the two fixings securing the harness guide to the frame. Discard the fixings.
8. Remove the two rubber bands securing the harness to the brake hose.

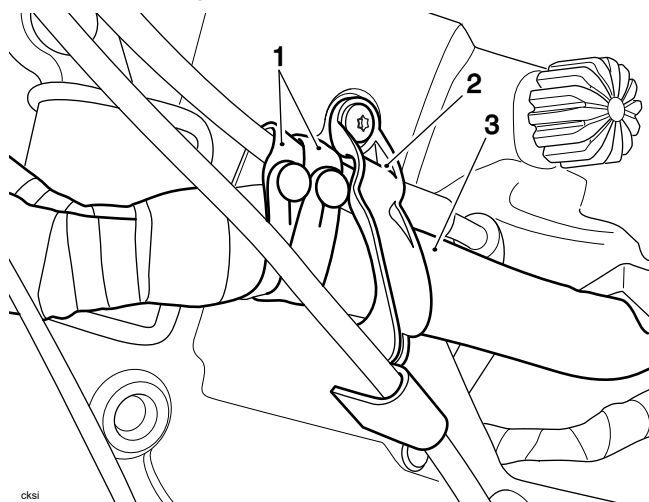

**1. Rubber bands**

**2. Harness guide**

**3. Harness**

9. Feed the harness from behind the clutch cable and allow to rest to one side.
10. Inspect the harness, particularly the ignition branch and switch housing wiring, for any signs of damage or chafing.
11. If no damage exists on the harness, continue with the rework. If damage exists, contact Triumph Service for further instructions.

12. Check the orientation of the harness. The switch housing branch should sit behind the ignition branch and the headlight and DRL branches should be situated above. The DRL branch should be inboard of the headlight branch. The instrument branch should be situated above as shown in the illustration below.

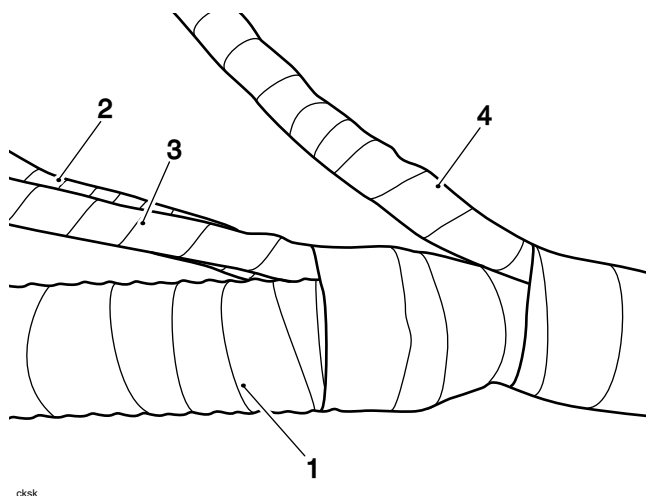

cksk

Side view

1. Ignition branch (switch housing branch behind, not shown)
2. Headlight branch
3. DRL branch
4. Instruments branch

13. Check the ignition branch conduit has been correctly taped. The tape covering the four branches (Ignition branch, Switch Housing branch, Headlight branch and DRL branch) should overlap the ignition branch conduit by 10 - 15 mm.

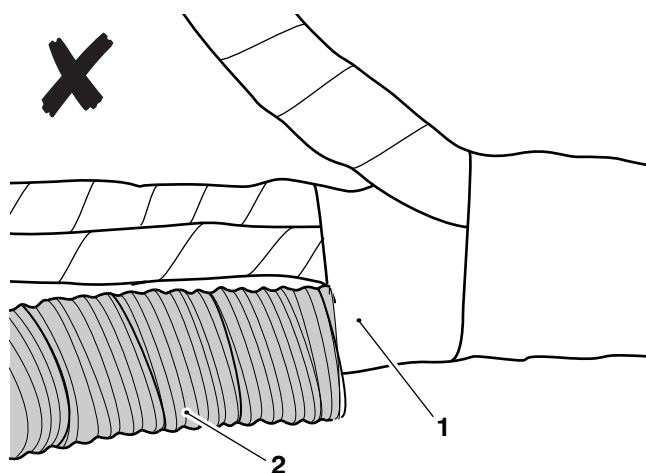

cksd\_1

Graphic showing incorrect taping of ignition branch conduit

1. Fabric tape
2. Ignition branch conduit

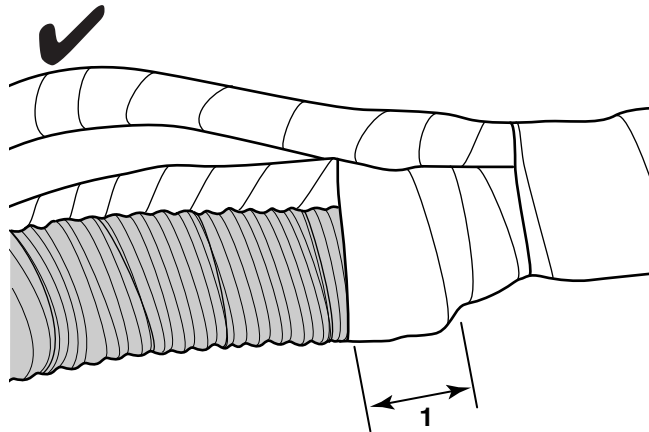

ckse\_1

Graphic showing correct taping of ignition branch conduit

**1. 10 - 15 mm fabric tape overlap**

14. If the ignition branch conduit taping is incorrect, apply tape to all four branches forward of the instruments branch. The tape should be overlapped by at least 10 mm working forward until the ignition branch conduit is overtaped by 10-15 mm as in the illustration above.
15. If the ignition branch conduit taping is correct or has been corrected, continue from the next step.
16. Lift the headlight and DRL branches upwards and apply tape across the ignition and switch housing branches. The tape should wrap round at least twice, be one tape width wide, with the tape squarely aligned with itself.

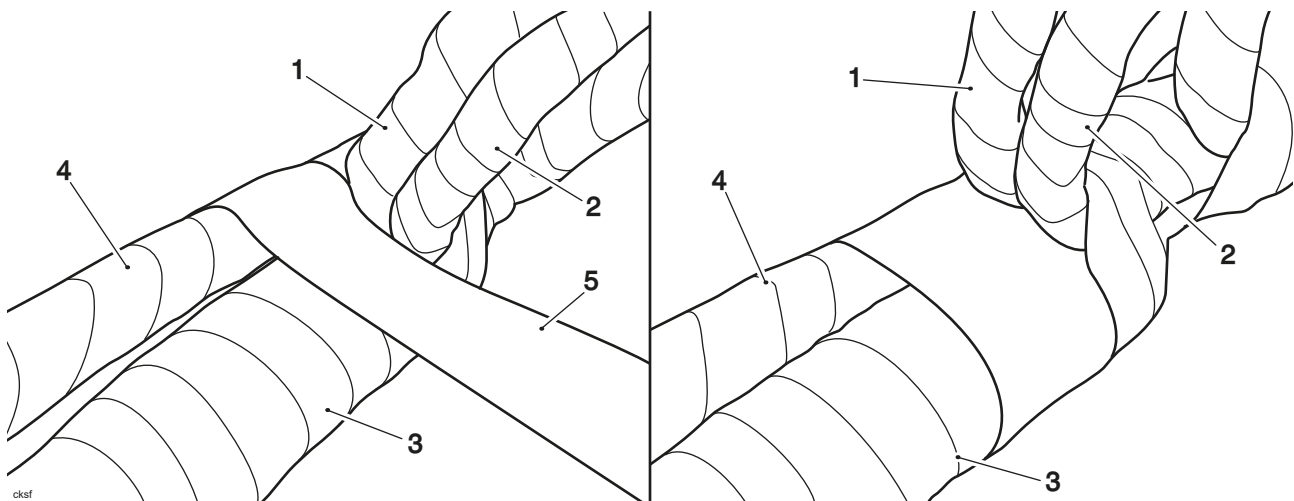

cksf

- 1. Headlight branch**
- 2. DRL branch**
- 3. Ignition branch**
- 4. Switch housing branch**
- 5. Fabric tape**

17. Feed the harness behind the clutch cable then in between the left hand fork leg and headstock.
18. Reconnect the harness instruments connector.
19. Refit the instrument cover with two new fixings and tighten to **3 Nm**.
20. Refit the headlight and headlight bowl as described in the Service Manual.
21. Refit the harness guide with two new fixings and tighten to **1.5 Nm**.

22. Refit the two rubber bands securing the harness to the brake hose.

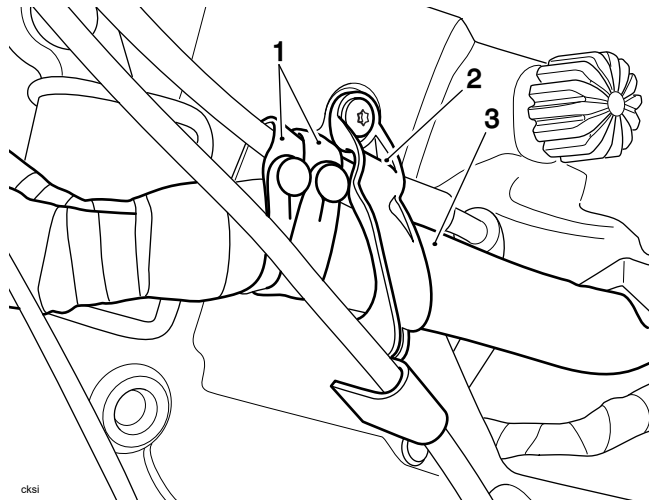

- 1. Rubber bands
- 2. Harness guide
- 3. Harness

- 23. Refit the fuel tank as described in the Service Manual.
- 24. Reconnect the battery as described in the Service Manual.
- 25. Refit the seat as described in the Service Manual.

**⚠ Warning**

Move the handlebars to left and right full lock while checking that the brake hose, clutch cable and electrical harnesses do not bind or that the steering feels tight or difficult to turn. A hose, cable or harness that binds, or steering that is tight/difficult to turn will restrict the steering and may cause loss of control and an accident.

Check for correct operation of the front brake, clutch and twist grip. Check that the brake hose, clutch cable and electrical harnesses do not bind or restrict the steering when the handlebars are turned from lock-to-lock. Rectify as necessary.

- 26. Move the handlebars from lock to lock repeatedly and examine the area around the headstock. With the new VIN label protector fitted, it is not necessary to have clearance between the harness and VIN protector plate.
- 27. Readjust the headlight as required, as described in the Service Manual.

**Circulation**

Initial and date when read and return to central file holder

Service Manager	Parts Manager	Sales Manager	Workshop Supervisor	Technician 1	Technician 2