



SIB 65 11 20 RECALL 20V-283: ROLLOVER SENSOR

2020-05-29

This Service Information Bulletin (Revision 2) replaces SI B65 11 20 **dated May 2020**.

What's New (Specific text highlighted):

- All sections updated except Model and Situation
- Repair instructions attached.

Please perform the procedure outlined in this Service Information on all affected vehicles before customer delivery. In the event the customer has already taken delivery of the vehicle, please perform the procedure the next time the vehicle is in the shop.

MODEL

E-Series	Model Description	Production Date
F39	X2 Sports Activity Coupe	March 18, 2020 – March 19, 2020
F48	X1 Sports Activity Vehicle	March 18, 2020 – March 19, 2020

AFFECTED VEHICLES

Affected vehicles which require this Campaign to be completed will show it as "Open" when checked either in AIR, the "Service Menu" of DCSnet (Dealer Communication System), ISPA NEXT or Warranty Vehicle Inquiry.

SITUATION

BMW AG has upgraded this campaign to a Safety Recall (effective May 20, 2020) which was initially released as a Delivery Stop on May 8, 2020. This recall affects a small number of Model Year 2020 BMW X1 SAV and X2 SAC vehicles that were produced on March 18, 2020 and March 19, 2020.

The rollover sensor may not have been produced to specifications by the supplier. In a rollover, the head air bag and safety belt pretensioner may not deploy as intended which could increase the risk of injury.

The Recall notice and Q&A have been attached for further information.

CAUSE

The rollover sensor, internal to the Air Bag Control Unit (ACSM), may not have been produced to specifications by the supplier.

CORRECTION

Replace the ACSM Air Bag Control Unit.

PROCEDURE

Perform diagnosis with the latest version of ISTA.

Replace airbag control unit according to Repair Instructions 65 77 016.

Program the vehicle using the latest version of ISTA.

Note that ISTA 4 will automatically reprogram and code all programmable control modules that do not have the latest software.

Always connect a BMW-approved battery charger/power supply (SI B04 23 10). For information on programming and coding with ISTA, refer to CenterNet / TIS / Technical Documentation / Diagnostics and Programming / Programming Documentation.

PARTS INFORMATION

Only use and invoice the part number below that apply.

Performing a part number look-up in ETK (EPC) by VIN or model in place of using/invoicing the following part number may result with the wrong part number being invoiced and installed, this could delay the payment of the claim.

Please refer to the Parts Matrix for the parts ordering information.

Part Number	Description	Quantity
65 77 9 873 244	Control Unit Airbag	1

Additionally, other small parts that are not specified above, such as one-time use screws, nuts and seals, which must be replaced according to the ISTA repair instructions/ETK, must be selected from the Electronic Parts Catalogue according to the respective vehicle type and invoiced under the special defect code.

WARRANTY INFORMATION

During this workshop visit, the affected vehicle may also show one or more programming and encoding Technical Campaign repairs open, the programming and encoding procedure may only be invoiced one time.

Replace the air bag control unit and update the vehicle to the required i-level by performing and submitting for this Recall Campaign.

For the other open campaign repairs, please be sure to also perform any additional work (before and/or after) these repairs require and/or close the remaining programming and encoding Technical Campaign repairs as outlined in the corresponding Service Information Bulletin.

Reimbursement for this Recall will be via normal claim entry utilizing the applicable work package information below that applies and the part number listed above:

Defect Code:	0065350300
---------------------	-------------------

Completion before the first vehicle delivery to a customer or the vehicle is already in the workshop

Work Pkg	Labor Operation	Description (Plus work)	Labor Allowance
# 1	00 69 666	Replacing air bag control unit, programming/encoding vehicle control units (includes connecting an approved battery charger/power supply and performing a vehicle test)	23 FRU
Or:			
# 2	00 69 667	Replacing air bag control unit, (programming/encoding vehicle control units was performed in conjunction with another campaign or repair during the same workshop visit)	15 FRU

Or:

The vehicle arrives at your center and this Recall shows open (No other main work will be performed or claimed during this workshop visit)

Work Pkg	Labor Operation	Description (Main work)	Labor Allowance
# 3	00 69 155	Replacing air bag control unit, programming/encoding vehicle control units (includes connecting an approved battery charger/power supply and performing a vehicle test)	25 FRU

Only one of the flat rate labor operation codes listed above can be used for claim submission/reimbursement purposes. Also, only one Main work flat rate labor operation code can be claimed per workshop visit.

Claim Repair Comments

Only reference the SIB number and the work package (Pkg) number performed in the RO technician notes and the claim comments (For example: B65 11 20 WP 1), unless otherwise required by State law.

And, as applicable:

Alternative Mobility Solution (AMS) for Vehicle Owners (RO and Claim Comments Required)

This Recall repair qualifies for Alternative Mobility Solution (AMS) expense reimbursement, claim this item under the Defect Code noted above as follows:

Sublet Code 2 - Itemize the AMS sublet amount on the repair order and in the claim comment section.

Please refer to [SI B01 29 16](#) for additional information.

Programming and Encoding - Vehicle Control Units (RO and Claim Comments Required)

The programming procedure automatically reprograms and encodes all vehicle control modules which do not have the latest software I-level. If one or more control module failures occur during this programming procedure:

- Please claim this consequential control module-related repair work (including performing the IRAP Control Unit Recovery procedure first as required, refer to the SIB in AIR) under the defect code listed in this bulletin with the applicable AIR labor operations.

Please explain this additional work (The why and what) on the repair order and in the claim comments section

For control module failures that occurred prior to performing this programming procedure:

- When covered under an applicable limited warranty, claim the applicable test plan and the corresponding control module-related repair work using the applicable defect code and labor operations in AIR (including diagnosis with separate punch times).

Supporting Materials

[picture_as_pdf B651120 Recall Notice.pdf](#)

[picture_as_pdf B651120_2020-BMW-MY2020-Fxx-RolloverSensor-QA-\(20May2020\).pdf](#)

[picture_as_pdf B651120_REP 65 77 016.pdf](#)

SAFETY RECALL NOTICE

To: All Center Operators, Sales Managers, Service Manager, Parts Manager and Warranty Processor

RE: Recall 20V-283: Rollover Sensor – B65 11 20

BMW AG is conducting a Voluntary Safety Recall (effective May 20, 2020) for a small number of Model Year 2020 BMW X1 SAV and X2 SAC vehicles that were produced on March 18, 2020 and March 19, 2020.

Please be reminded that it is a violation of federal law (The Safety Act) for you to sell, lease or deliver any new motor vehicle covered by this notification until the recall repair has been performed. This means that centers may not legally deliver new motor vehicles to consumers until they are fixed or use/sell replacement equipment/parts subject to this recall. Note also that substantial civil penalties apply to violations of the Safety Act.

Also, you should not sell, lease or deliver any Certified Pre-Owned or used vehicles subject to a safety recall until the repair is completed.

Please follow any special instructions that we provide to you for the return or disposition of recall parts.

We appreciate all your assistance with this Recall.

Removing and installing airbag control unit (with centre armrest) »



RISK OF DAMAGE

Scratches.

Tools and sharp-edged components can cause scratches.

- Protect working area.
- Handle tools and components carefully.

Preliminary work

Disconnecting all battery ground leads

Further information is available.



- See additional information.

Removing the instrument panel trim at bottom right

- Loosen nuts (1).
- Lower the instrument panel trim slightly at the bottom right (2) and disconnect the plug connection behind it.
- Guide the instrument panel trim at the bottom right (2) from the front guides and remove it.

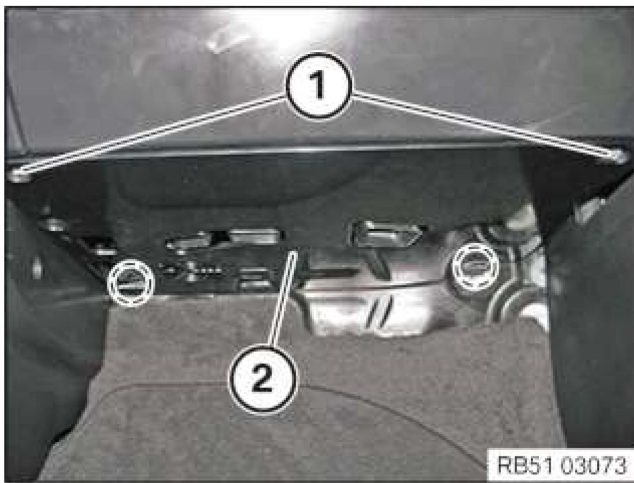

Removing the side trim panel for the left and right centre console

► Removing side trim panel for the left centre console

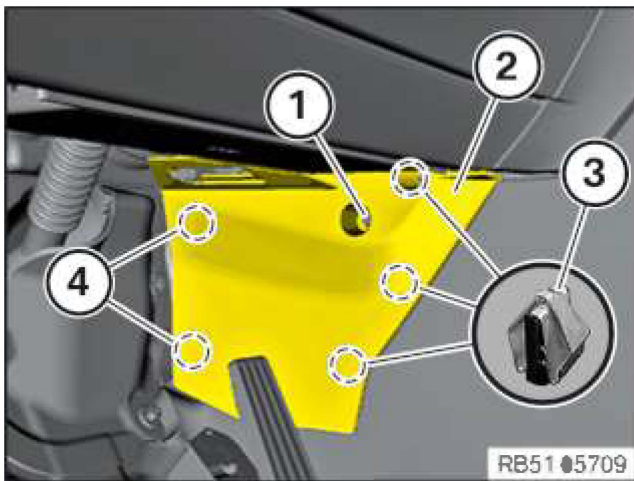

- Loosen screw (1).
- Release side trim panel (2) for the centre console from retaining clips (3).
- Remove side trim panel (2) for the centre console from guides (4) and remove it.



► Removing the side trim panel for the right center console

- Loosen screw (1).
- Release the side trim panel for the center console (2) from the retaining clips (3).
- Remove the side trim panel for the center console (2) from the guides (4).

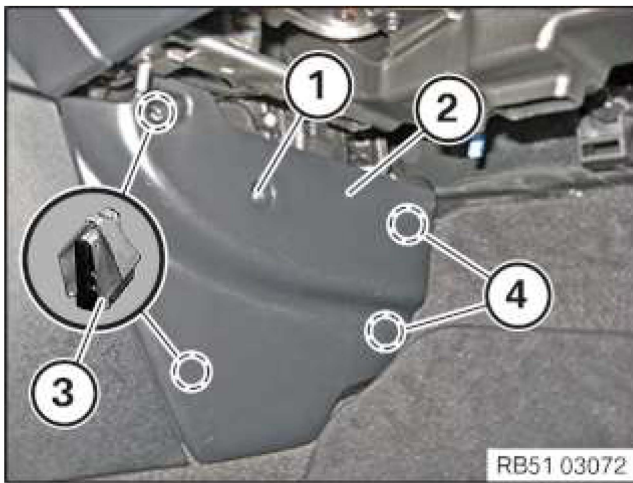

Remove gearshift lever cover



- Use wedges (1) to unclip the gaiter and pull it off upward.



- Remove the gearshift lever knob and the gaiter by means of a powerful jolt vertically upwards.
In doing so, the tie rod must not be bent or damaged.
- Ensure that the gearshift lever knob is not twisted when removing, otherwise the anti-twist lock in the gearshift lever knob will be sheared off.

Remove the decorative trim from the centre console



RISK OF DAMAGE

Scratches.

Tools and sharp-edged components can cause scratches.

- Protect working area.
- Handle tools and components carefully.



- Lever out and remove cover (1) with the special tool 0 496 571 (00 9 327).
- Loosen screws (2).

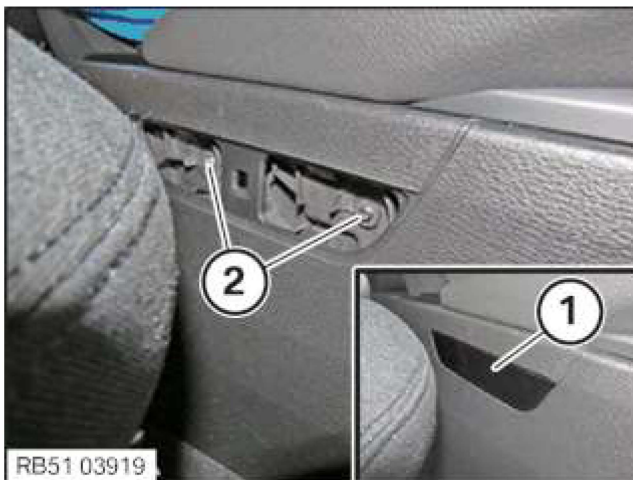

- Lever out and remove cover (1) with the special tool 0 496 571 (00 9 327).
- Loosen screws (2).

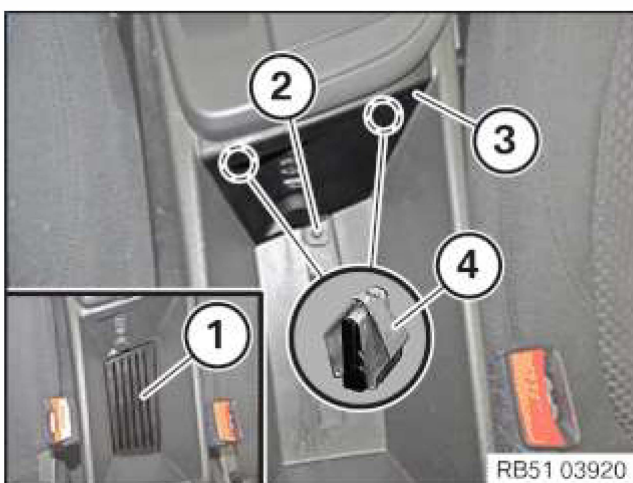

- Remove insert (1) with the special tool 0 496 571 (00 9 327).
- Loosen screw (2).
- Lever out trim (3) from clamps (4) towards the rear with the special tool 0 496 571 (00 9 327).
- Unfasten plug connection.
- Remove the trim (3).

- Loosen screw (1).
- Remove decorative trim (2) and disconnect all the plug connections.
- Remove decorative trim (2).



Remove the centre console trim

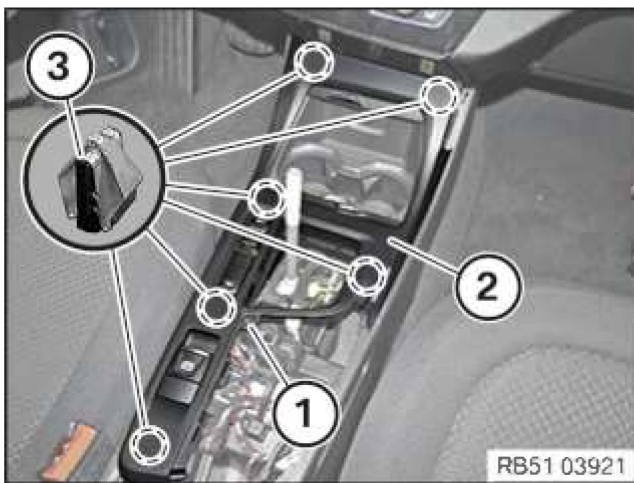

- Loosen screw (1).
- Release centre console trim (2) from clamps (3) with the special tool 0 496 569 (00 9 325).
- Lift centre console trim (2).

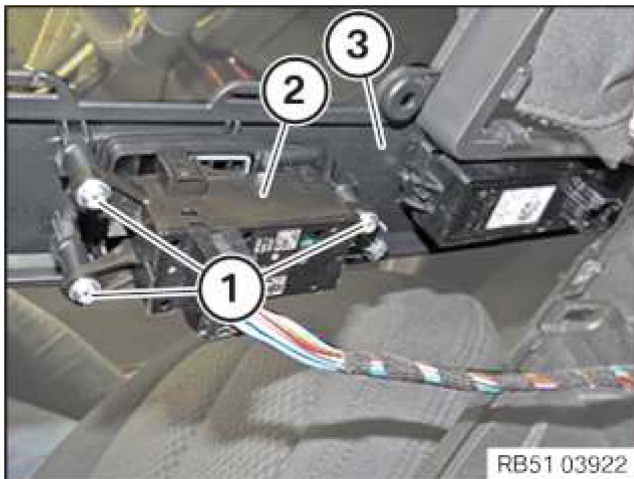

- Loosen screws (1).
- Remove parking brake button (2) from centre console trim (3) and place it down.
The plug connection must not be disconnected.
- Disconnect the remaining plug connections and remove centre console trim (3).

Removing the front storage compartment

- Lever storage compartment (1) at top from the clamps (2).
- Fold storage compartment (1) so far back that it can be lifted from the guides (3).

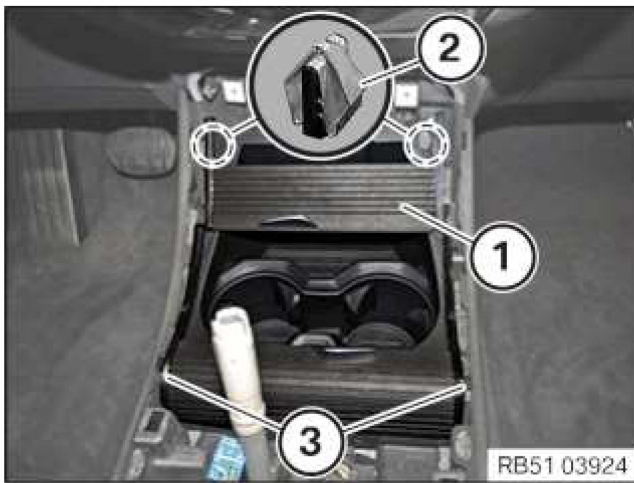

- Disconnect plug connections and remove the storage compartment (1).

Removing the rear centre console trim

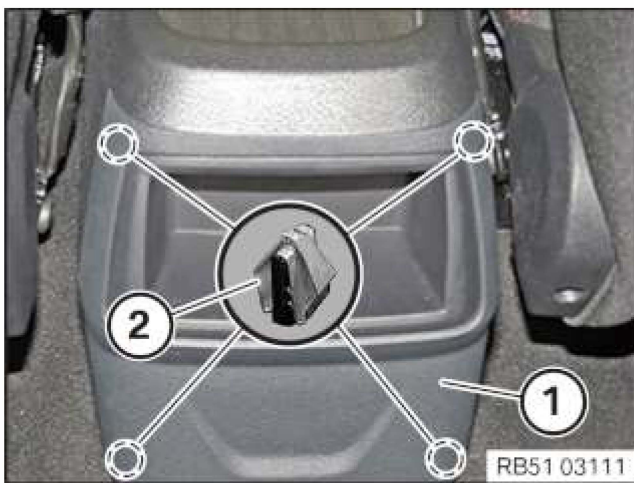

- Lever out and remove centre console trim (1) with the special tool 0 496 569 (00 9 325) from the clamps (2).

Removing centre console fully with centre armrest

► Removing the centre armrest



- Release nuts (1) and remove centre armrest upwards.



- Loosen screws (1).

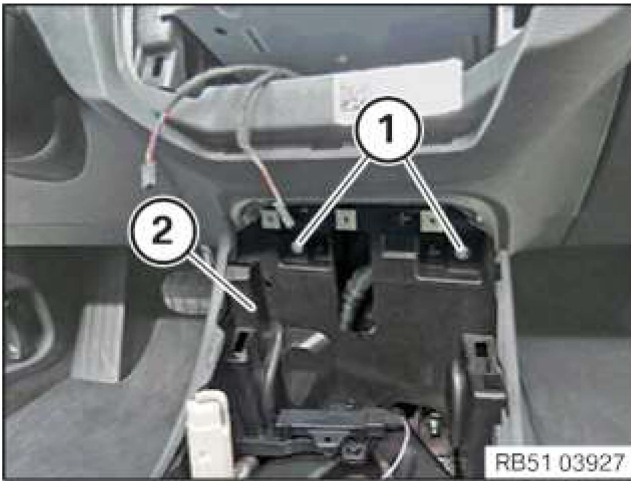
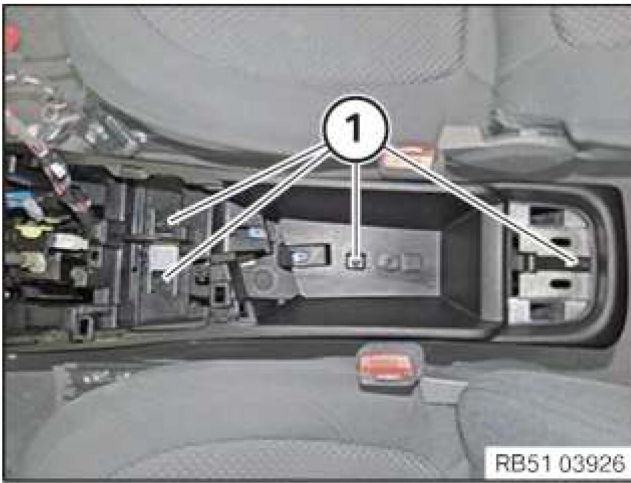

- Loosen screws (1).
- Lift the rear centre console (2) and in this process, disconnect all plug connections.
- Guide out the wiring harness and remove centre console (2) from the vehicle.

For equipment specification with air duct for rear passenger compartment: Remove the air duct

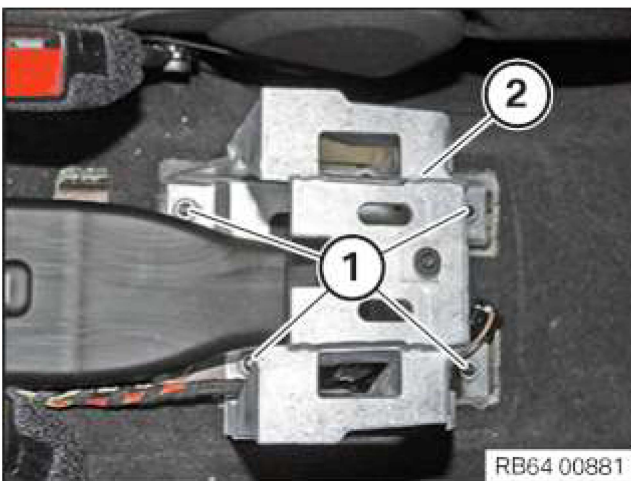

- Loosen the nuts (1) and remove the holder (2).

- Unfasten nut (1).
- Detach the cable clip (2).
- Loosen the screw (3) and remove the holder (4).

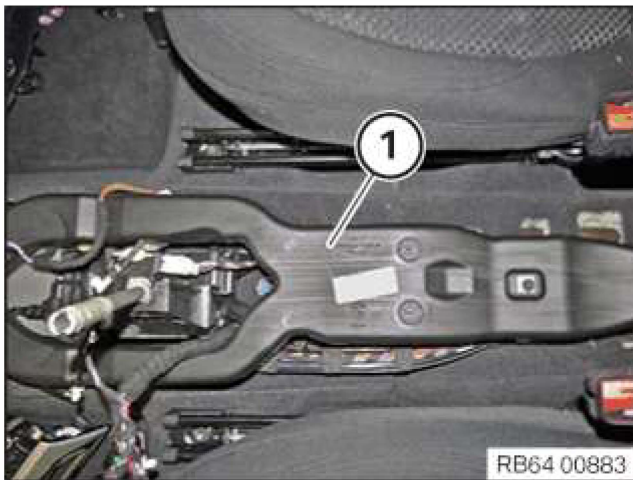
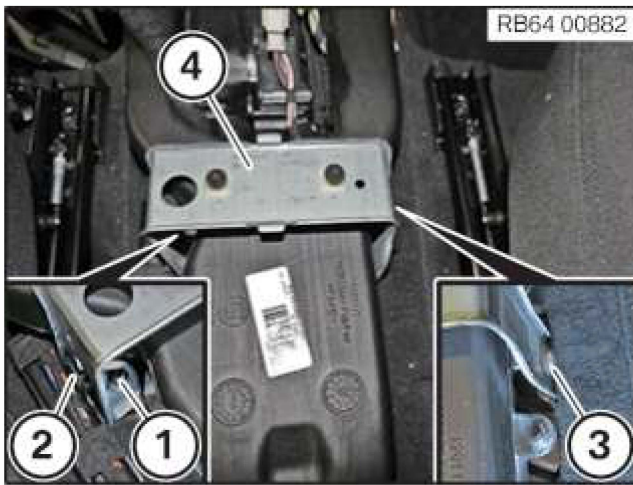

- Remove the air duct (1).

Main Works

Removing the airbag control unit

Further information is available.

WARNING

Airbag unit.

Danger! Immobilization period-threatening injuries!

- Before performing any work on the airbag, always disconnect the battery ground lead from the battery.
- Airbag unit may only be set down with the cushion (airbag itself) facing upwards.
- For additional information see: 72 00 ... Safety regulations on handling airbag system components/gas generators



RISK OF DAMAGE



Damage to or destruction of electrical components.

- Leave electrical components in original packaging until just before they are installed. Use the original packaging only for any return shipments. Always package removed components straight away.
- Read and comply with user information on using the associated special tool 12 7 060.
- Only tap the housings of electrical components. Do not tap pins or multi-pin connectors directly.
- Wear electrically conductive clothing and antistatic shoes (with ESD symbol).
- For additional information see: 61 35 ... Notes on ESD (electrostatic discharge) protection

61 35 ... Notes on ESD protection (Electro Static Discharge)

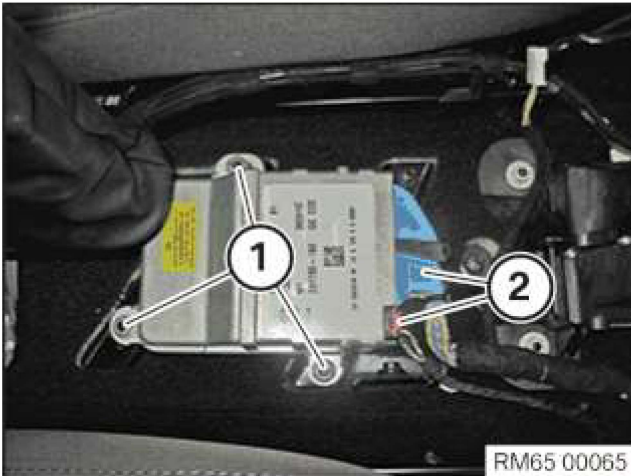

- Loosen nuts (1).
- Unlock and disconnect plug connections (2).
- Remove airbag control unit (3).

Installing the airbag control unit

Further information is available.

WARNING

Airbag unit.

Danger! Immobilization period-threatening injuries!

- Before performing any work on the airbag, always disconnect the battery ground lead from the battery.
- Airbag unit may only be set down with the cushion (airbag itself) facing upwards.
- For additional information see: 72 00 ... Safety regulations on handling airbag system components/gas generators

RISK OF DAMAGE



Electrostatic discharge.

Damage to or destruction of electrical components.

- Leave electrical components in original packaging until just before they are installed. Use the original packaging only for any return shipments. Always package removed components straight away.
- Read and comply with user information on using the associated special tool 12 7 060.
- Only tap the housings of electrical components. Do not tap pins or multi-pin connectors directly.
- Wear electrically conductive clothing and antistatic shoes (with ESD symbol).
- For additional information see: 61 35 ... Notes on ESD (electrostatic discharge) protection

61 35 ... Notes on ESD protection (Electro Static Discharge)

- Position the airbag control unit (3).
- Tighten nuts (1).

Tightening torques

Airbag control unit to body

screw

Tightening torque

8Nm

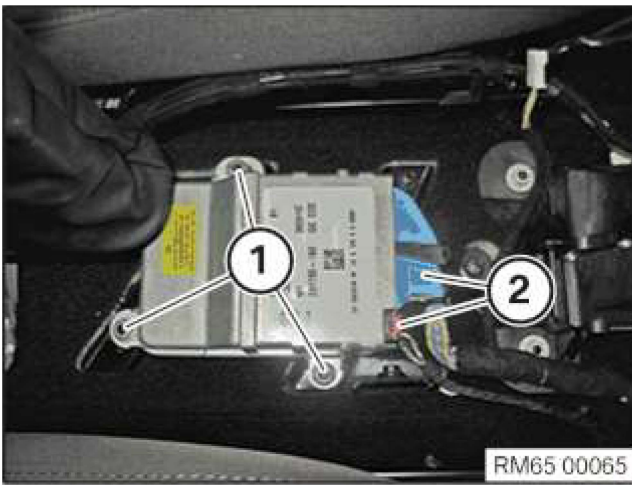

- Connect connectors (2) and lock.

Follow-up works

For equipment specification with air duct for rear passenger compartment: Install air duct

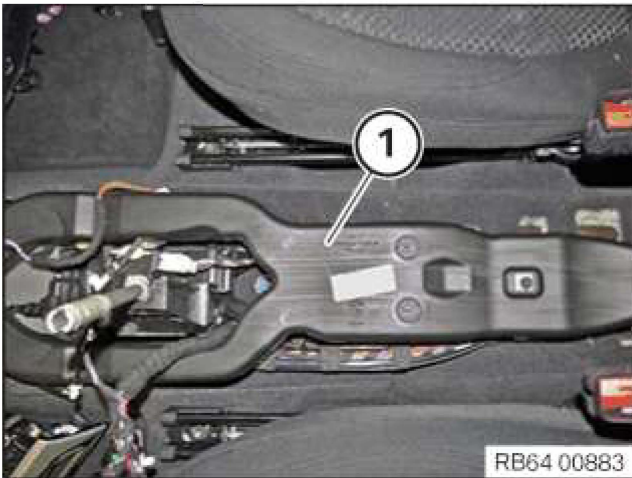

- Insert the air duct (1).

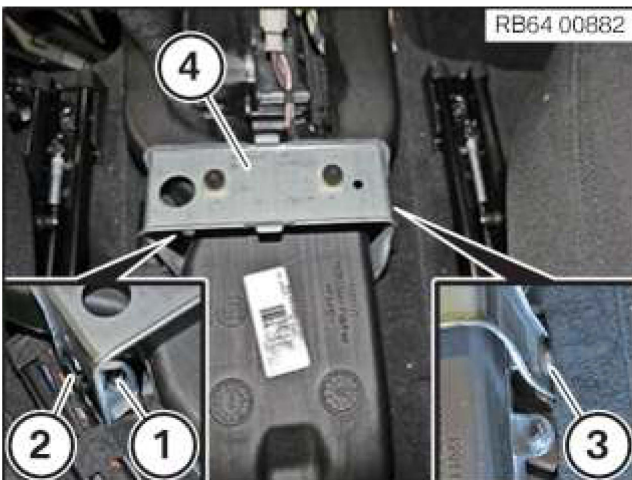

- Position the holder (4) correctly and tighten the screw (3).

Tightening torques

Center console bracket to bodyshell

Nut

tightening torque
8Nm

Screw

tightening torque
8Nm

- Tighten the nut (1) and attach the cable clip (2).

Tightening torques

Center console bracket to bodyshell

Nut	tightening torque 8Nm
Screw	tightening torque 8Nm

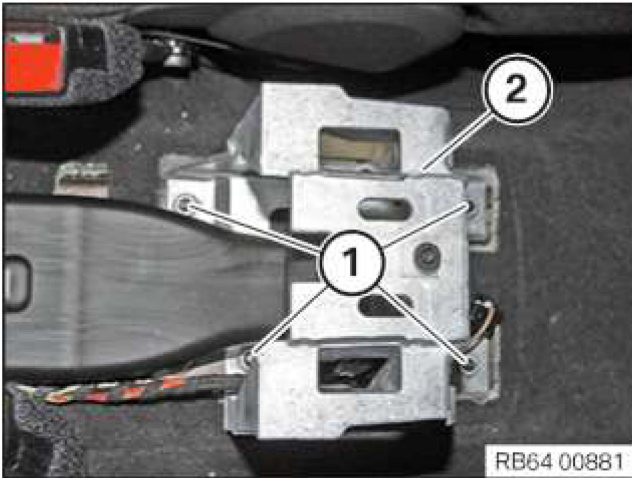

- Position the holder (2) correctly and tighten the nuts (1).

Tightening torques

Center console bracket to bodyshell

Nut	tightening torque 8Nm
Screw	tightening torque 8Nm

Installing centre console fully with centre armrest

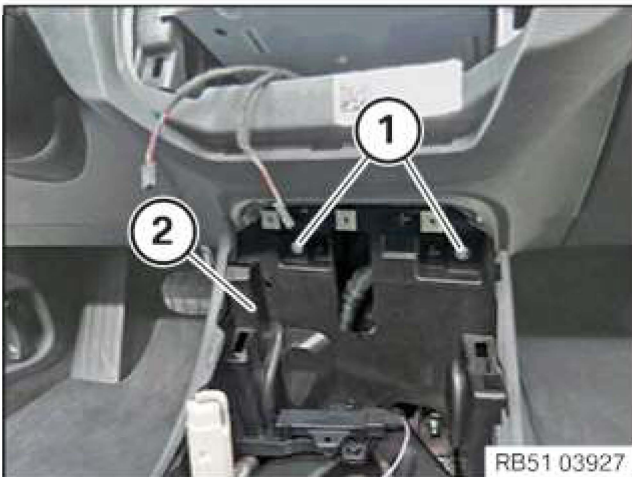

- Lift rear centre console (2), guide it forwards and connect all the connectors.
- Insert the wiring harness into the centre console (2).
- Tighten the screws (1).

Tightening torques

Screw connection for centre console

Oval-head screw	Tightening torque 1,8Nm
-----------------	----------------------------

- Tighten the screws (1).

Tightening torques

Screw connection for centre console

--	--

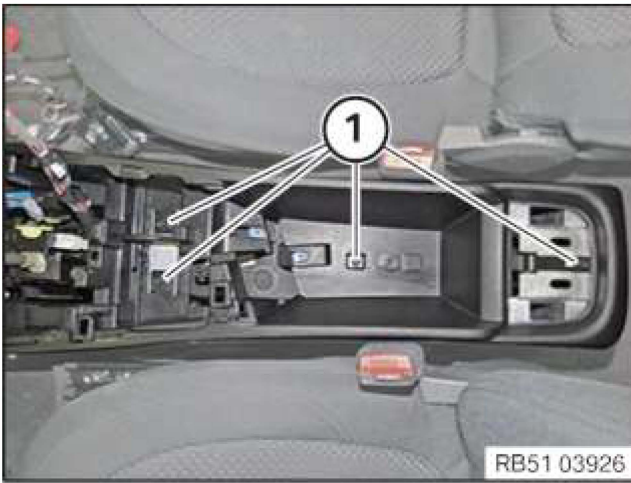

Tightening torque 1,8Nm

► Installing the centre armrest

- Install the centre armrest and tighten nuts (1).

Tightening torques

Centre armrest to support

Nut M8

Tightening torque 21,4Nm



Installing the front storage compartment

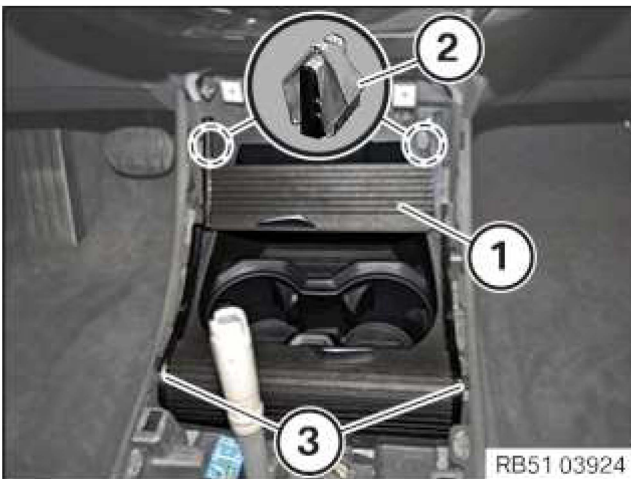

- Install storage compartment (1) and connect the connectors.
- Insert the storage compartment (1) into the guides (3) and fold forward.
- Engage storage compartment (1) in the clamps (2) at top.

Install the centre console trim

- Install centre console trim (3) and connect and lock the

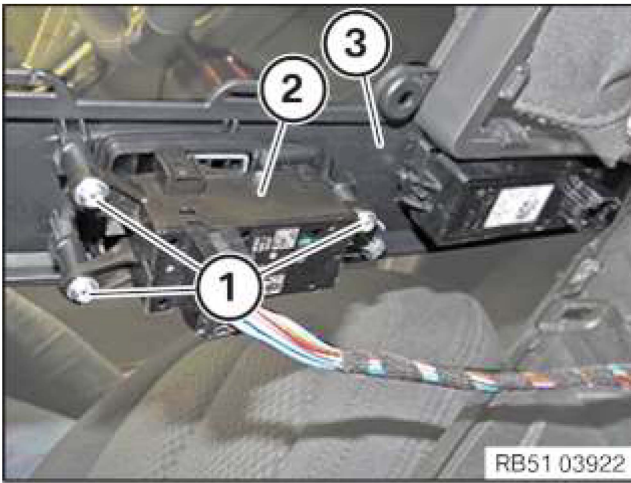

corresponding connectors.

- Install parking brake button (2) on centre console trim (3).
- Tighten the screws (1).

Tightening torques

Parking brake button

Oval-head screw

Tightening torque
1,5Nm

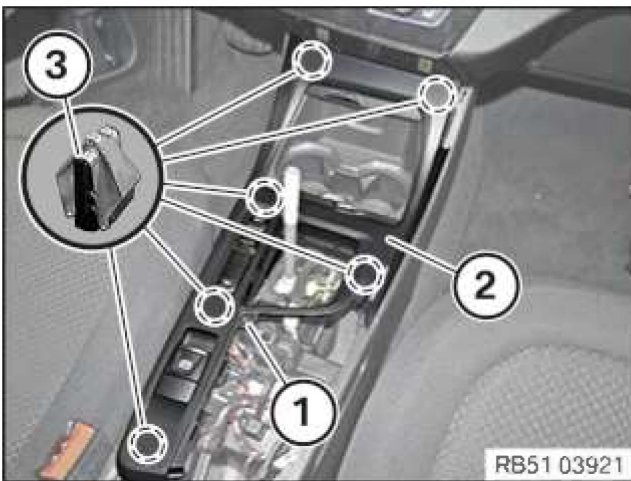

- Install centre console trim (2) and engage it into clamps (3).
- Tighten down screw (1).

Tightening torques

Screw connection for centre console

Oval-head screw

Tightening torque
1,8Nm

Installing the decorative trim to the centre console



- Connect all connectors.
- Install decorative trim (2).
- Tighten down screw (1).

Tightening torques

Screw connection for centre console

Oval-head screw

Tightening torque
1,8Nm

- Position trim (3) and connect all the connectors.
- Install trim (3) and engage it into clamps (4).
- Tighten down screw (2).

Tightening torques

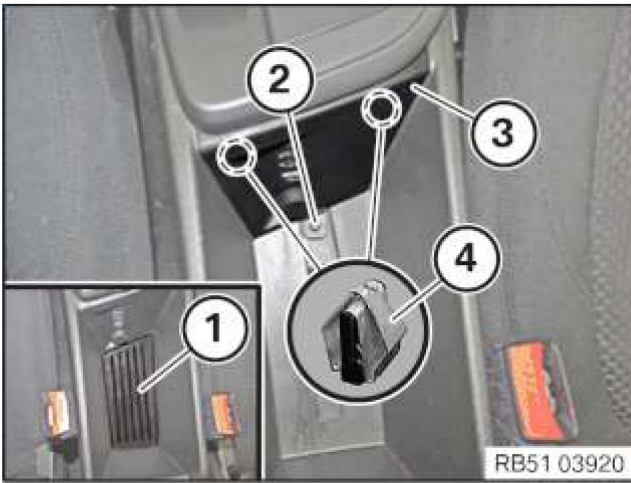

Trim to center console

Oval-head screw

tightening torque
1,8Nm

- Insert the insert (1).

- Tighten down screws (2).

Tightening torques

Screw connection for centre console

Oval-head screw

Tightening torque
1,8Nm

- Install cover (1) and engage.

- Tighten down screws (2).

Tightening torques

Screw connection for centre console

Oval-head screw

Tightening torque
1,8Nm

- Install cover (1) and engage.



Installing the gearshift lever cover

- Place the gearshift lever knob on gearshift lever and align by lightly pressing in the direction of travel.

The anti-twist lock must bite.

- Press the gearshift lever knob with the palm of the hand until it can be felt to engage.

When installing, the tie rod of the gearshift lever must not be bent.

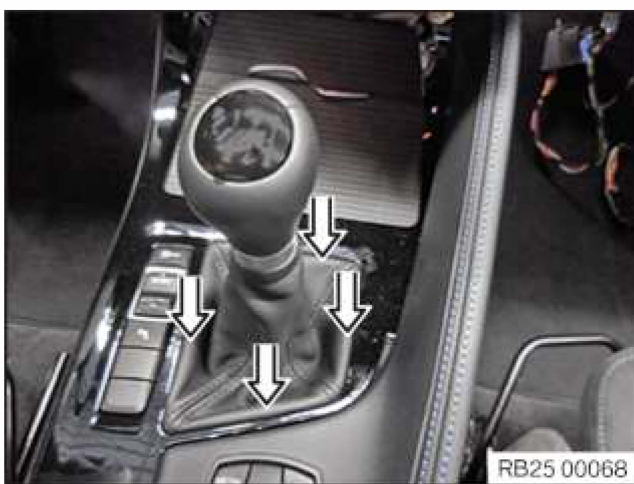

- Clip in gaiter (arrows).

Installing the rear centre console trim

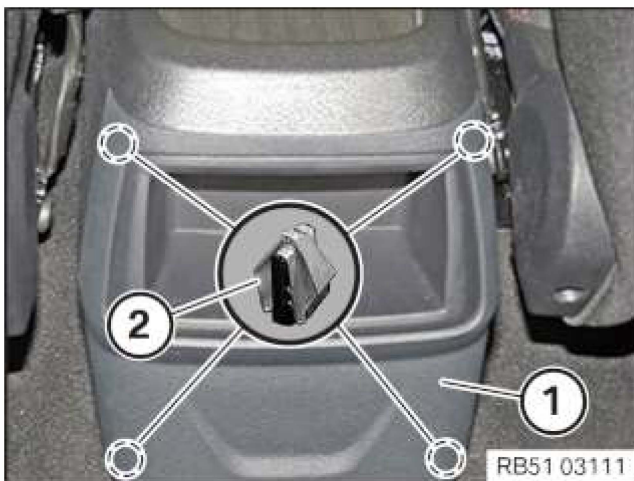

- Install centre console trim (1) and engage it into clamps (2).

Installing side trim panel for the left and right centre console

- Installing side trim panel for the left centre console

Detents, guides and mounting elements must not be damaged or missing.

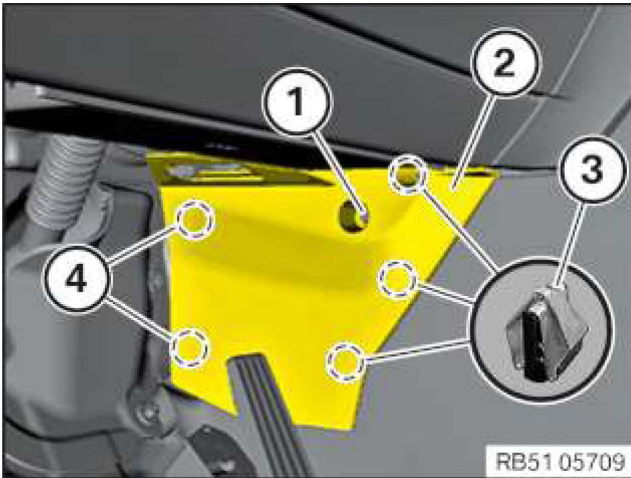

- Install the side trim panel (2) for the centre console and feed it into the guides (4).
- Engage the side trim panel (2) for the centre console into retaining clips (3).
- Tighten down screw (1).

Tightening torques

Trim to center console

Oval-head screw

tightening torque
1.8Nm



► Installing the side trim panel for the right center console

i TECHNICAL INFORMATION

Detents, guides and mounting elements must not be damaged or missing.

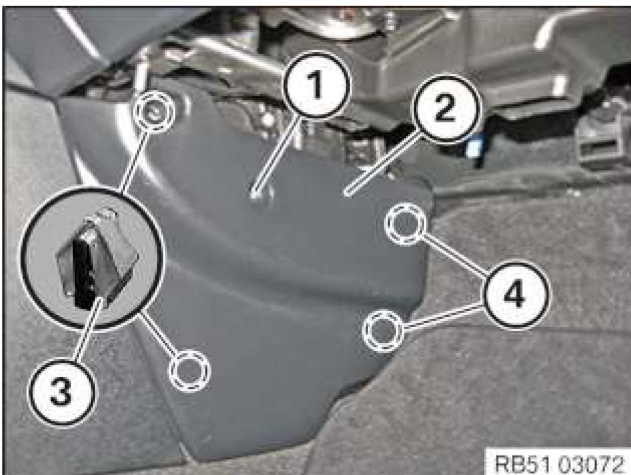

- Install the side trim panel for the center console (2) and feed into the guides (4).
- Engage the side trim panel for the center console (2) on the retaining clips(3).
- Tighten down screw (1).

Tightening torques

Trim to center console

Oval-head screw

tightening torque
1.8Nm



i TECHNICAL INFORMATION

Detents, guides and mounting elements must not be damaged or missing.

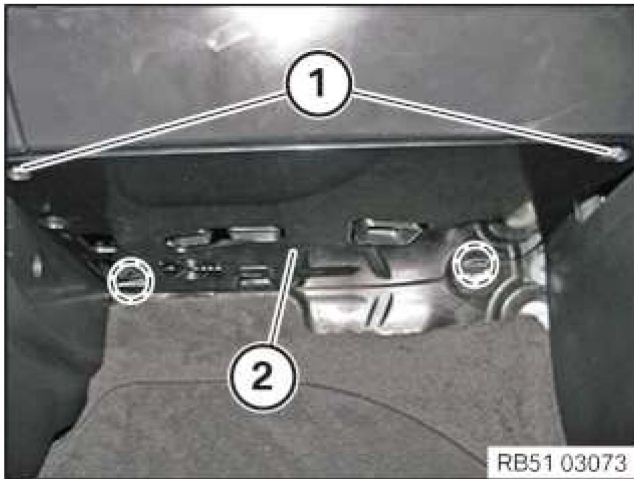

- Install the lower right instrument panel trim (2) and connect and lock the plug connection.
- Insert the lower right instrument panel trim (2) into the front guides.
- Tighten nuts (1).

Tightening torques

Bottom right footwell trim to dashboard

hexagon nutM5

Tightening torque
2Nm

Disconnecting all battery ground leads
Further information is available.



- See additional information.

**Safety Recall 20V-283
Rollover Sensor
Model Year 2020
BMW X1, X2
Last Update: 05/20/2020**

Q1. Which BMW models in the US are potentially affected by this Safety Recall?

Certain Model Year 2020 BMW X1 SAV and X2 SAC models in the US, produced between March 18, 2020 and March 19, 2020, are potentially affected.

Q2. What is the specific issue?

The rollover sensor may not have been produced to specifications by the supplier. In a rollover, the head air bag and safety belt pretensioner may not deploy as intended which could increase the risk of injury.

Q3. Why are other models / vehicles not included in this Safety Recall?

The rollover sensor in other models was produced to specifications by the supplier.

Q4. Can I continue to drive my vehicle?

Yes. However, when you receive a letter requesting you to make an appointment to have this Safety Recall performed by an authorized BMW center, please do so as soon as possible. If you are not the only driver of this vehicle, please advise all other drivers of this important information.

Q5. Can I determine if this issue exists in my vehicle?

No.

Q6. How did BMW become aware of the issue?

BMW Group became aware of the issue through our quality control procedures.

Q7. How will I be informed of this Safety Recall?

Letters will be mailed to owners in July via First Class mail to advising them of this Safety Recall and requesting them to schedule an appointment with an authorized BMW center to have the repair performed. You can locate your nearest authorized BMW center at www.bmwusa.com/dealer. To ensure BMW has the most recent contact and vehicle information, owners should register their vehicle at www.bmwusa.com/myBMW. Registration is free, and will give them access to factory initiated campaigns and other information specific to their BMW.

Q8. How will my vehicle be repaired?

The air bag control unit (which contains the rollover sensor) will be replaced for free and will take about one hour.

Q9. Do I have to wait for my letter to have my vehicle serviced?

Yes. BMW is in the process of ensuring that the necessary tools, parts, and procedures are available prior to contacting you to schedule an appointment with your authorized BMW center to have this important Safety Recall performed. For the latest updates to this Safety Recall, please visit www.bmwusa.com/recall.