



# FIELD KIT

## Vermeer Corporation

Environmental

Pella, IA 50219 USA

<b>FIELD CAMPAIGN KIT#</b>	<b>IK003941</b>	<b>DATE:</b>	<b>16 July 2020</b>
<i>For Dealer Reference: Service Bulletin #SVC2020-093</i>			
<b>BC1200XL Wheel and Tire Assembly Replacement Kit</b>			

<b>CAMPAIGN TYPE:</b>	Mandatory - Product Safety <b>DEALER INSTALLATION ONLY</b>
<b>CAMPAIGN CATEGORY:</b>	Kit and Bulletin

MACHINE/ ATTACHMENT MODEL(S):	Serial Numbers		
	Included	Excluded	Kit Version
BC1200XL	See listing on the following pages of this IK for specific VIN and Serial/Unit numbers <b>(Equipped with Floatation Tires: LT285/75R16 E)</b>	Units included in IK02, IK03 and IK04 and machines equipped without Floatation Tires: LT285/75R16 E	<b>IK01: Solid Steel Wheels</b> 8 on 6 1/2", 5/8" studs; <b>Heavy Duty Tires</b> 235/75R17.5 LRJ 18 ply; safety sign and <b>English Supplemental Manual.</b>
BC1200XL	3037, 3045, 3054, 3055, 3061, 3062, 3083, 3090, 3115, 3130, 3140, 3187, 3302, 3325, 3390, 3415, 3420, 3483, 3482, 3497, 3498, 3505, 3528, 3553–3556, 3600 <b>(Equipped with Standard Tires: ST235/80R16 LRE)</b>	Units included in IK01, IK03 and IK04 and machines equipped without Floatation Tires: LT285/75R16 E	<b>IK02: Solid Steel Wheels</b> 8 on 6 1/2", 5/8" studs; <b>Heavy Duty Tires</b> 235/75R17.5 LRJ 18 ply; safety sign and <b>English + Translated Supplemental Manual</b>
BC1200XL Temporary wheel/tire assembly solution (Assembly PN 163769457) previously installed	See listing on the following pages of this IK for specific VIN and Serial/Unit numbers <b>(Equipped with Floatation Tires: LT285/75R16 E)</b>	Units included in IK01, IK02 and IK04 and machines equipped without Floatation Tires: LT285/75R16 E	<b>IK03: Safety sign and English Supplemental Manual.</b>
BC1200XL Temporary wheel/tire assembly solution (Assembly PN 163769457) previously installed	<b>NONE</b> <b>(Current location of machines indicate IK04 is not required.)</b> <b>(Equipped with Standard Tires: ST235/80R16 LRE)</b>	Units included in IK01, IK02 and IK03 and machines equipped without Floatation Tires: LT285/75R16 E	<b>IK04: Safety sign and English + Translated Supplemental Manual.</b>

**AFFECTED MACHINES - IK01-IK3941**

MODEL	VIN	MODEL	VIN	MODEL	VIN
BC1200XL	1VR7141Y8D1001176	BC1200XL	1VR7141Y5H1003070	BC1200XL	1VR7141Y5H1003120
BC1200XL	1VR7141Y0E1001285	BC1200XL	1VR7141Y7H1003071	BC1200XL	1VR7141Y7H1003121
BC1200XL	1VR7141YXG1001541	BC1200XL	1VR7141Y9H1003072	BC1200XL	1VR7141Y9H1003122
BC1200XL	1VR7141Y7H1003023	BC1200XL	1VR7141Y0H1003073	BC1200XL	1VR7141Y0H1003123
BC1200XL	1VR7141Y0H1003025	BC1200XL	1VR7141Y2H1003074	BC1200XL	1VR7141Y2H1003124
BC1200XL	1VR7141Y2H1003026	BC1200XL	1VR7141Y4H1003075	BC1200XL	1VR7141Y4H1003125
BC1200XL	1VR7141Y4H1003027	BC1200XL	1VR7141Y6H1003076	BC1200XL	1VR7141Y6H1003126
BC1200XL	1VR7141Y6H1003028	BC1200XL	1VR7141Y8H1003077	BC1200XL	1VR7141Y8H1003127
BC1200XL	1VR7141Y4H1003030	BC1200XL	1VR7141YXH1003078	BC1200XL	1VR7141YXH1003128
BC1200XL	1VR7141Y6H1003031	BC1200XL	1VR7141Y1H1003079	BC1200XL	1VR7141Y1H1003129
BC1200XL	1VR7141Y8H1003032	BC1200XL	1VR7141Y8H1003080	BC1200XL	1VR7141YXH1003131
BC1200XL	1VR7141YXH1003033	BC1200XL	1VR7141YXH1003081	BC1200XL	1VR7141Y1H1003132
BC1200XL	1VR7141Y1H1003034	BC1200XL	1VR7141Y1H1003082	BC1200XL	1VR7141Y3H1003133
BC1200XL	1VR7141Y3H1003035	BC1200XL	1VR7141Y5H1003084	BC1200XL	1VR7141Y5H1003134
BC1200XL	1VR7141Y9H1003038	BC1200XL	1VR7141Y7H1003085	BC1200XL	1VR7141Y7H1003135
BC1200XL	1VR7141Y0H1003039	BC1200XL	1VR7141Y9H1003086	BC1200XL	1VR7141Y9H1003136
BC1200XL	1VR7141Y9H1003041	BC1200XL	1VR7141Y0H1003087	BC1200XL	1VR7141Y0H1003137
BC1200XL	1VR7141Y0H1003042	BC1200XL	1VR7141Y2H1003088	BC1200XL	1VR7141Y2H1003138
BC1200XL	1VR7141Y2H1003043	BC1200XL	1VR7141Y4H1003089	BC1200XL	1VR7141Y4H1003139
BC1200XL	1VR7141Y4H1003044	BC1200XL	1VR7141Y4H1003092	BC1200XL	1VR7141Y2H1003141
BC1200XL	1VR7141Y8H1003046	BC1200XL	1VR7141Y6H1003093	BC1200XL	1VR7141Y4H1003142
BC1200XL	1VR7141Y3H1003049	BC1200XL	1VR7141Y8H1003094	BC1200XL	1VR7141Y6H1003143
BC1200XL	1VR7141YXH1003050	BC1200XL	1VR7141YXH1003095	BC1200XL	1VR7141Y8H1003144
BC1200XL	1VR7141Y1H1003051	BC1200XL	1VR7141Y3H1003097	BC1200XL	1VR7141YXH1003145
BC1200XL	1VR7141Y5H1003053	BC1200XL	1VR7141Y5H1003098	BC1200XL	1VR7141Y1H1003146
BC1200XL	1VR7141Y0H1003056	BC1200XL	1VR7141Y3H1003102	BC1200XL	1VR7141Y3H1003147
BC1200XL	1VR7141Y2H1003057	BC1200XL	1VR7141Y5H1003103	BC1200XL	1VR7141Y5H1003148
BC1200XL	1VR7141Y4H1003058	BC1200XL	1VR7141Y7H1003104	BC1200XL	1VR7141Y7H1003149
BC1200XL	1VR7141Y6H1003059	BC1200XL	1VR7141Y9H1003105	BC1200XL	1VR7141Y3H1003150
BC1200XL	1VR7141Y2H1003060	BC1200XL	1VR7141Y0H1003106	BC1200XL	1VR7141Y5H1003151
BC1200XL	1VR7141Y8H1003063	BC1200XL	1VR7141Y2H1003107	BC1200XL	1VR7141Y7H1003152
BC1200XL	1VR7141YXH1003064	BC1200XL	1VR7141Y4H1003108	BC1200XL	1VR7141Y9H1003153
BC1200XL	1VR7141Y1H1003065	BC1200XL	1VR7141Y6H1003109	BC1200XL	1VR7141Y2H1003155
BC1200XL	1VR7141Y3H1003066	BC1200XL	1VR7141Y2H1003110	BC1200XL	1VR7141Y4H1003156
BC1200XL	1VR7141Y5H1003067	BC1200XL	1VR7141Y4H1003111	BC1200XL	1VR7141Y6H1003157
BC1200XL	1VR7141Y7H1003068	BC1200XL	1VR7141Y6H1003112	BC1200XL	1VR7141YXH1003159
BC1200XL	1VR7141Y9H1003069	BC1200XL	1VR7141Y8H1003113	BC1200XL	1VR7141Y6H1003160
		BC1200XL	1VR7141YXH1003114	BC1200XL	1VR7141Y8H1003161
		BC1200XL	1VR7141Y3H1003116	BC1200XL	1VR7141YXH1003162
		BC1200XL	1VR7141Y5H1003117	BC1200XL	1VR7141Y1H1003163
		BC1200XL	1VR7141Y7H1003118	BC1200XL	1VR7141Y3H1003164
		BC1200XL	1VR7141Y9H1003119	BC1200XL	1VR7141Y5H1003165

**AFFECTED MACHINES - IK01-IK3941**

MODEL	VIN	MODEL	VIN	MODEL	VIN
BC1200XL	1VR7141Y7H1003166	BC1200XL	1VR7141Y3J1003221	BC1200XL	1VR7141Y1J1003265
BC1200XL	1VR7141Y9H1003167	BC1200XL	1VR7141Y5J1003222	BC1200XL	1VR7141Y3J1003266
BC1200XL	1VR7141Y0H1003168	BC1200XL	1VR7141Y7J1003223	BC1200XL	1VR7141Y5J1003267
BC1200XL	1VR7141Y2H1003169	BC1200XL	1VR7141Y9J1003224	BC1200XL	1VR7141Y7J1003268
BC1200XL	1VR7141Y9H1003170	BC1200XL	1VR7141Y0J1003225	BC1200XL	1VR7141Y9J1003269
BC1200XL	1VR7141Y0H1003171	BC1200XL	1VR7141Y2J1003226	BC1200XL	1VR7141Y5J1003270
BC1200XL	1VR7141Y2H1003172	BC1200XL	1VR7141Y4J1003227	BC1200XL	1VR7141Y7J1003271
BC1200XL	1VR7141Y4H1003173	BC1200XL	1VR7141Y8J1003229	BC1200XL	1VR7141Y9J1003272
BC1200XL	1VR7141Y6H1003174	BC1200XL	1VR7141Y4J1003230	BC1200XL	1VR7141Y0J1003273
BC1200XL	1VR7141Y8H1003175	BC1200XL	1VR7141Y6J1003231	BC1200XL	1VR7141Y2J1003274
BC1200XL	1VR7141YXH1003176	BC1200XL	1VR7141Y8J1003232	BC1200XL	1VR7141Y4J1003275
BC1200XL	1VR7141Y1H1003177	BC1200XL	1VR7141YXJ1003233	BC1200XL	1VR7141Y8J1003277
BC1200XL	1VR7141Y6H1003188	BC1200XL	1VR7141Y1J1003234	BC1200XL	1VR7141YXJ1003278
BC1200XL	1VR7141Y4H1003190	BC1200XL	1VR7141Y3J1003235	BC1200XL	1VR7141Y1J1003279
BC1200XL	1VR7141Y6H1003191	BC1200XL	1VR7141Y5J1003236	BC1200XL	1VR7141Y8J1003280
BC1200XL	1VR7141Y0J1003192	BC1200XL	1VR7141Y7J1003237	BC1200XL	1VR7141YXJ1003281
BC1200XL	1VR7141Y2J1003193	BC1200XL	1VR7141Y9J1003238	BC1200XL	1VR7141Y1J1003282
BC1200XL	1VR7141Y4J1003194	BC1200XL	1VR7141Y0J1003239	BC1200XL	1VR7141Y3J1003283
BC1200XL	1VR7141Y6J1003195	BC1200XL	1VR7141Y7J1003240	BC1200XL	1VR7141Y5J1003284
BC1200XL	1VR7141Y8J1003196	BC1200XL	1VR7141Y9J1003241	BC1200XL	1VR7141Y7J1003285
BC1200XL	1VR7141YXJ1003197	BC1200XL	1VR7141Y0J1003242	BC1200XL	1VR7141Y9J1003286
BC1200XL	1VR7141Y1J1003198	BC1200XL	1VR7141Y2J1003243	BC1200XL	1VR7141Y0J1003287
BC1200XL	1VR7141Y3J1003199	BC1200XL	1VR7141Y4J1003244	BC1200XL	1VR7141Y2J1003288
BC1200XL	1VR7141Y6J1003200	BC1200XL	1VR7141Y6J1003245	BC1200XL	1VR7141Y4J1003289
BC1200XL	1VR7141Y8J1003201	BC1200XL	1VR7141Y8J1003246	BC1200XL	1VR7141Y0J1003290
BC1200XL	1VR7141YXJ1003202	BC1200XL	1VR7141YXJ1003247	BC1200XL	1VR7141Y2J1003291
BC1200XL	1VR7141Y1J1003203	BC1200XL	1VR7141Y1J1003248	BC1200XL	1VR7141Y4J1003292
BC1200XL	1VR7141Y3J1003204	BC1200XL	1VR7141Y3J1003249	BC1200XL	1VR7141Y6J1003293
BC1200XL	1VR7141Y5J1003205	BC1200XL	1VR7141YXJ1003250	BC1200XL	1VR7141Y8J1003294
BC1200XL	1VR7141Y7J1003206	BC1200XL	1VR7141Y1J1003251	BC1200XL	1VR7141YXJ1003295
BC1200XL	1VR7141Y9J1003207	BC1200XL	1VR7141Y3J1003252	BC1200XL	1VR7141Y1J1003296
BC1200XL	1VR7141Y0J1003208	BC1200XL	1VR7141Y5J1003253	BC1200XL	1VR7141Y3J1003297
BC1200XL	1VR7141Y9J1003210	BC1200XL	1VR7141Y7J1003254	BC1200XL	1VR7141Y5J1003298
BC1200XL	1VR7141Y0J1003211	BC1200XL	1VR7141Y9J1003255	BC1200XL	1VR7141Y7J1003299
BC1200XL	1VR7141Y2J1003212	BC1200XL	1VR7141Y0J1003256	BC1200XL	1VR7141YXJ1003300
BC1200XL	1VR7141Y4J1003213	BC1200XL	1VR7141Y2J1003257	BC1200XL	1VR7141Y1J1003301
BC1200XL	1VR7141Y6J1003214	BC1200XL	1VR7141Y4J1003258	BC1200XL	1VR7141Y5J1003303
BC1200XL	1VR7141YXJ1003216	BC1200XL	1VR7141Y6J1003259	BC1200XL	1VR7141Y7J1003304
BC1200XL	1VR7141Y1J1003217	BC1200XL	1VR7141Y2J1003260	BC1200XL	1VR7141Y9J1003305
BC1200XL	1VR7141Y3J1003218	BC1200XL	1VR7141Y4J1003261	BC1200XL	1VR7141Y0J1003306
BC1200XL	1VR7141Y5J1003219	BC1200XL	1VR7141Y8J1003263	BC1200XL	1VR7141Y2J1003307
BC1200XL	1VR7141Y1J1003220	BC1200XL	1VR7141YXJ1003264	BC1200XL	1VR7141Y4J1003308

**AFFECTED MACHINES - IK01-IK3941**

MODEL	VIN	MODEL	VIN	MODEL	VIN
BC1200XL	1VR7141Y6J1003309	BC1200XL	1VR7141Y0J1003354	BC1200XL	1VR7141Y9K1003399
BC1200XL	1VR7141Y4J1003311	BC1200XL	1VR7141Y2J1003355	BC1200XL	1VR7141Y1K1003400
BC1200XL	1VR7141Y6J1003312	BC1200XL	1VR7141Y4J1003356	BC1200XL	1VR7141Y3K1003401
BC1200XL	1VR7141Y8J1003313	BC1200XL	1VR7141Y6J1003357	BC1200XL	1VR7141Y5K1003402
BC1200XL	1VR7141YXJ1003314	BC1200XL	1VR7141Y8J1003358	BC1200XL	1VR7141Y7K1003403
BC1200XL	1VR7141Y1J1003315	BC1200XL	1VR7141YXJ1003359	BC1200XL	1VR7141Y9K1003404
BC1200XL	1VR7141Y3J1003316	BC1200XL	1VR7141Y6J1003360	BC1200XL	1VR7141Y0K1003405
BC1200XL	1VR7141Y5J1003317	BC1200XL	1VR7141Y8J1003361	BC1200XL	1VR7141Y2K1003406
BC1200XL	1VR7141Y7J1003318	BC1200XL	1VR7141YXJ1003362	BC1200XL	1VR7141Y4K1003407
BC1200XL	1VR7141Y9J1003319	BC1200XL	1VR7141Y1J1003363	BC1200XL	1VR7141Y6K1003408
BC1200XL	1VR7141Y5J1003320	BC1200XL	1VR7141Y3J1003364	BC1200XL	1VR7141Y8K1003409
BC1200XL	1VR7141Y7J1003321	BC1200XL	1VR7141Y5J1003365	BC1200XL	1VR7141Y4K1003410
BC1200XL	1VR7141Y9J1003322	BC1200XL	1VR7141Y7J1003366	BC1200XL	1VR7141Y6K1003411
BC1200XL	1VR7141Y0J1003323	BC1200XL	1VR7141Y9J1003367	BC1200XL	1VR7141Y8K1003412
BC1200XL	1VR7141Y6J1003326	BC1200XL	1VR7141Y0J1003368	BC1200XL	1VR7141YXK1003413
BC1200XL	1VR7141Y8J1003327	BC1200XL	1VR7141Y9J1003370	BC1200XL	1VR7141Y1K1003414
BC1200XL	1VR7141YXJ1003328	BC1200XL	1VR7141Y0J1003371	BC1200XL	1VR7141Y5K1003416
BC1200XL	1VR7141Y1J1003329	BC1200XL	1VR7141Y2J1003372	BC1200XL	1VR7141Y7K1003417
BC1200XL	1VR7141Y8J1003330	BC1200XL	1VR7141Y4J1003373	BC1200XL	1VR7141Y9K1003418
BC1200XL	1VR7141YXJ1003331	BC1200XL	1VR7141Y6J1003374	BC1200XL	1VR7141Y0K1003419
BC1200XL	1VR7141Y1J1003332	BC1200XL	1VR7141Y8J1003375	BC1200XL	1VR7141Y9K1003421
BC1200XL	1VR7141Y3J1003333	BC1200XL	1VR7141YXJ1003376	BC1200XL	1VR7141Y0K1003422
BC1200XL	1VR7141Y5J1003334	BC1200XL	1VR7141YXK1003377	BC1200XL	1VR7141Y2K1003423
BC1200XL	1VR7141Y7J1003335	BC1200XL	1VR7141Y1K1003378	BC1200XL	1VR7141Y4K1003424
BC1200XL	1VR7141Y9J1003336	BC1200XL	1VR7141Y3K1003379	BC1200XL	1VR7141Y6K1003425
BC1200XL	1VR7141Y0J1003337	BC1200XL	1VR7141YXK1003380	BC1200XL	1VR7141Y8K1003426
BC1200XL	1VR7141Y2J1003338	BC1200XL	1VR7141Y1K1003381	BC1200XL	1VR7141YXK1003427
BC1200XL	1VR7141Y4J1003339	BC1200XL	1VR7141Y3K1003382	BC1200XL	1VR7141Y1K1003428
BC1200XL	1VR7141Y0J1003340	BC1200XL	1VR7141Y5K1003383	BC1200XL	1VR7141Y3K1003429
BC1200XL	1VR7141Y2J1003341	BC1200XL	1VR7141Y7K1003384	BC1200XL	1VR7141YXK1003430
BC1200XL	1VR7141Y4J1003342	BC1200XL	1VR7141Y9K1003385	BC1200XL	1VR7141Y1K1003431
BC1200XL	1VR7141Y6J1003343	BC1200XL	1VR7141Y0K1003386	BC1200XL	1VR7141Y3K1003432
BC1200XL	1VR7141Y8J1003344	BC1200XL	1VR7141Y2K1003387	BC1200XL	1VR7141Y5K1003433
BC1200XL	1VR7141YXJ1003345	BC1200XL	1VR7141Y4K1003388	BC1200XL	1VR7141Y7K1003434
BC1200XL	1VR7141Y1J1003346	BC1200XL	1VR7141Y6K1003389	BC1200XL	1VR7141Y9K1003435
BC1200XL	1VR7141Y3J1003347	BC1200XL	1VR7141Y4K1003391	BC1200XL	1VR7141Y0K1003436
BC1200XL	1VR7141Y5J1003348	BC1200XL	1VR7141Y6K1003392	BC1200XL	1VR7141Y4K1003438
BC1200XL	1VR7141Y7J1003349	BC1200XL	1VR7141Y8K1003393	BC1200XL	1VR7141Y6K1003439
BC1200XL	1VR7141Y3J1003350	BC1200XL	1VR7141YXK1003394	BC1200XL	1VR7141Y2K1003440
BC1200XL	1VR7141Y5J1003351	BC1200XL	1VR7141Y1K1003395	BC1200XL	1VR7141Y4K1003441
BC1200XL	1VR7141Y7J1003352	BC1200XL	1VR7141Y3K1003396	BC1200XL	1VR7141Y6K1003442
BC1200XL	1VR7141Y9J1003353	BC1200XL	1VR7141Y5K1003397	BC1200XL	1VR7141Y8K1003443
		BC1200XL	1VR7141Y7K1003398		

**AFFECTED MACHINES - IK01-IK3941**

MODEL	VIN	MODEL	VIN	MODEL	VIN
BC1200XL	1VR7141YXK1003444	BC1200XL	1VR7141Y8K1003488	BC1200XL	1VR7141YXK1003542
BC1200XL	1VR7141Y1K1003445	BC1200XL	1VR7141YXK1003489	BC1200XL	1VR7141Y1K1003543
BC1200XL	1VR7141Y3K1003446	BC1200XL	1VR7141Y6K1003490	BC1200XL	1VR7141Y3K1003544
BC1200XL	1VR7141Y5K1003447	BC1200XL	1VR7141Y8K1003491	BC1200XL	1VR7141Y5K1003545
BC1200XL	1VR7141Y7K1003448	BC1200XL	1VR7141Y1K1003493	BC1200XL	1VR7141Y7K1003546
BC1200XL	1VR7141Y9K1003449	BC1200XL	1VR7141Y3K1003494	BC1200XL	1VR7141Y9K1003547
BC1200XL	1VR7141Y5K1003450	BC1200XL	1VR7141Y5K1003495	BC1200XL	1VR7141Y0K1003548
BC1200XL	1VR7141Y7K1003451	BC1200XL	1VR7141Y2K1003499	BC1200XL	1VR7141Y2K1003549
BC1200XL	1VR7141Y9K1003452	BC1200XL	1VR7141Y5K1003500	BC1200XL	1VR7141Y9L1003551
BC1200XL	1VR7141Y0K1003453	BC1200XL	1VR7141Y9K1003502	BC1200XL	1VR7141Y0L1003552
BC1200XL	1VR7141Y2K1003454	BC1200XL	1VR7141Y0K1003503	BC1200XL	1VR7141YXL1003557
BC1200XL	1VR7141Y4K1003455	BC1200XL	1VR7141Y2K1003504	BC1200XL	1VR7141Y1L1003558
BC1200XL	1VR7141Y6K1003456	BC1200XL	1VR7141Y6K1003506	BC1200XL	1VR7141Y3L1003559
BC1200XL	1VR7141Y8K1003457	BC1200XL	1VR7141Y8K1003507	BC1200XL	1VR7141YXL1003560
BC1200XL	1VR7141YXK1003458	BC1200XL	1VR7141YXK1003508	BC1200XL	1VR7141Y1L1003561
BC1200XL	1VR7141Y1K1003459	BC1200XL	1VR7141Y1K1003509	BC1200XL	1VR7141Y3L1003562
BC1200XL	1VR7141Y8K1003460	BC1200XL	1VR7141Y8K1003510	BC1200XL	1VR7141Y5L1003563
BC1200XL	1VR7141YXK1003461	BC1200XL	1VR7141YXK1003511	BC1200XL	1VR7141Y7L1003564
BC1200XL	1VR7141Y1K1003462	BC1200XL	1VR7141Y1K1003512	BC1200XL	1VR7141Y9L1003565
BC1200XL	1VR7141Y3K1003463	BC1200XL	1VR7141Y3K1003513	BC1200XL	1VR7141Y0L1003566
BC1200XL	1VR7141Y5K1003464	BC1200XL	1VR7141Y5K1003514	BC1200XL	1VR7141Y2L1003567
BC1200XL	1VR7141Y7K1003465	BC1200XL	1VR7141Y9K1003516	BC1200XL	1VR7141Y4L1003568
BC1200XL	1VR7141Y9K1003466	BC1200XL	1VR7141Y0K1003517	BC1200XL	1VR7141Y2L1003570
BC1200XL	1VR7141Y0K1003467	BC1200XL	1VR7141Y4K1003519	BC1200XL	1VR7141Y4L1003571
BC1200XL	1VR7141Y2K1003468	BC1200XL	1VR7141Y4K1003522	BC1200XL	1VR7141Y6L1003572
BC1200XL	1VR7141Y4K1003469	BC1200XL	1VR7141Y6K1003523	BC1200XL	1VR7141Y8L1003573
BC1200XL	1VR7141Y0K1003470	BC1200XL	1VR7141Y8K1003524	BC1200XL	1VR7141YXL1003574
BC1200XL	1VR7141Y2K1003471	BC1200XL	1VR7141YXK1003525	BC1200XL	1VR7141Y1L1003575
BC1200XL	1VR7141Y4K1003472	BC1200XL	1VR7141Y1K1003526	BC1200XL	1VR7141Y3L1003576
BC1200XL	1VR7141Y6K1003473	BC1200XL	1VR7141Y3K1003527	BC1200XL	1VR7141Y5L1003577
BC1200XL	1VR7141Y8K1003474	BC1200XL	1VR7141Y7K1003529	BC1200XL	1VR7141Y7L1003578
BC1200XL	1VR7141YXK1003475	BC1200XL	1VR7141Y3K1003530	BC1200XL	1VR7141Y9L1003579
BC1200XL	1VR7141Y1K1003476	BC1200XL	1VR7141Y5K1003531	BC1200XL	1VR7141Y5L1003580
BC1200XL	1VR7141Y3K1003477	BC1200XL	1VR7141Y7K1003532	BC1200XL	1VR7141Y7L1003581
BC1200XL	1VR7141Y5K1003478	BC1200XL	1VR7141Y9K1003533	BC1200XL	1VR7141Y9L1003582
BC1200XL	1VR7141Y7K1003479	BC1200XL	1VR7141Y0K1003534	BC1200XL	1VR7141Y0L1003583
BC1200XL	1VR7141Y3K1003480	BC1200XL	1VR7141Y2K1003535	BC1200XL	1VR7141Y4L1003585
BC1200XL	1VR7141Y5K1003481	BC1200XL	1VR7141Y6K1003537	BC1200XL	1VR7141Y8L1003587
BC1200XL	1VR7141Y0K1003484	BC1200XL	1VR7141Y8K1003538	BC1200XL	1VR7141YXL1003588
BC1200XL	1VR7141Y2K1003485	BC1200XL	1VR7141YXK1003539	BC1200XL	1VR7141Y8L1003590
BC1200XL	1VR7141Y4K1003486	BC1200XL	1VR7141Y6K1003540	BC1200XL	1VR7141YXL1003591
BC1200XL	1VR7141Y6K1003487	BC1200XL	1VR7141Y8K1003541	BC1200XL	1VR7141Y3L1003593

**AFFECTED MACHINES - IK01-IK3941**

MODEL	VIN	MODEL	VIN	MODEL	VIN
BC1200XL	1VR7141Y5L1003594	BC1200XL	1VR7141Y5L1003613	BC1200XL	1VR7141Y0L1004507
BC1200XL	1VR7141Y7L1003595	BC1200XL	1VR7141Y7L1003614	BC1200XL	1VR7141Y2L1004508
BC1200XL	1VR7141Y9L1003596	BC1200XL	1VR7141Y2L1003617	BC1200XL	1VR7141Y4L1004509
BC1200XL	1VR7141Y0L1003597	BC1200XL	1VR7141Y4L1003618	BC1200XL	1VR7141Y0L1004510
BC1200XL	1VR7141Y4L1003599	BC1200XL	1VR7141Y6L1003619	BC1200XL	1VR7141Y2L1004511
BC1200XL	1VR7141Y9L1003601	BC1200XL	1VR7141Y2L1003620	BC1200XL	1VR7141Y4L1004512
BC1200XL	1VR7141Y2L1003603	BC1200XL	1VR7141Y4L1003621	BC1200XL	1VR7141Y6L1004513
BC1200XL	1VR7141Y4L1003604	BC1200XL	1VR7141Y6L1003622	BC1200XL	1VR7141Y8L1004514
BC1200XL	1VR7141Y6L1003605	BC1200XL	1VR7141Y8L1003623	BC1200XL	1VR7141YXL1004515
BC1200XL	1VR7141Y8L1003606	BC1200XL	1VR7141YXL1003624	BC1200XL	1VR7141Y1L1004516
BC1200XL	1VR7141YXL1003607	BC1200XL	1VR7141YXL1004501	BC1200XL	1VR7141Y3L1004517
BC1200XL	1VR7141Y1L1003608	BC1200XL	1VR7141Y1L1004502	BC1200XL	1VR7141Y5L1004518
BC1200XL	1VR7141Y3L1003609	BC1200XL	1VR7141Y3L1004503	BC1200XL	1VR7141Y7L1004519
BC1200XL	1VR7141YXL1003610	BC1200XL	1VR7141Y5L1004504	BC1200XL	1VR7141Y3L1004520
BC1200XL	1VR7141Y1L1003611	BC1200XL	1VR7141Y7L1004505		
BC1200XL	1VR7141Y3L1003612	BC1200XL	1VR7141Y9L1004506		

**AFFECTED MACHINES - IK03-IK3941**

MODEL	VIN	MODEL	VIN	MODEL	VIN
BC1200XL	1VR7141Y0A1000244	BC1200XL	1VR7141Y2J1003324	BC1200XL	1VR7141Y2L1003584
BC1200XL	1VR7141Y2G1003011	BC1200XL	1VR7141Y2J1003369	BC1200XL	1VR7141Y6L1003586
BC1200XL	1VR7141Y0H1003154	BC1200XL	1VR7141Y2K1003437	BC1200XL	1VR7141Y1L1003589
BC1200XL	1VR7141Y8H1003189	BC1200XL	1VR7141Y7K1003482	BC1200XL	1VR7141Y1L1003592
BC1200XL	1VR7141Y2J1003209	BC1200XL	1VR7141Y7K1003496	BC1200XL	1VR7141Y2L1003598
BC1200XL	1VR7141Y8J1003215	BC1200XL	1VR7141Y7K1003501	BC1200XL	1VR7141Y0L1003602
BC1200XL	1VR7141Y6J1003228	BC1200XL	1VR7141Y2K1003518	BC1200XL	1VR7141Y9L1003615
BC1200XL	1VR7141Y6J1003262	BC1200XL	1VR7141Y4K1003536	BC1200XL	1VR7141Y0L1003616
BC1200XL	1VR7141Y6J1003276	BC1200XL	1VR7141Y7L1003550		
BC1200XL	1VR7141Y2J1003310	BC1200XL	1VR7141Y6L1003569		

	<p><b>PRODUCT</b></p> <p><b>SAFETY ALERT</b></p>
---	--

**PURPOSE:** Specific wheels (steel rim) with bolt pattern 8 on 6-1/2" (165 mm) circle to be used with 5/8" studs provided by a supplier:

- have an incorrect lug nut contact area causing wheel lug nuts to loosen and/or
- can develop possible cracks causing the tire to loose air pressure.

Both conditions may increase the risk of wheel loss and the risk of a crash. **Death or serious injury** is possible. Property damage may also occur. This kit provides the necessary parts and instructions to replace the wheel/tire assembly, install a new safety sign, a new wheel/tire specification placard decal and provides supplemental manuals.

**SPECIAL TOOLS AND CONDITIONS:**

- None



**WARNING:** Raised load can shift or fall. Death or serious injury could be possible if struck or crushed by falling load. Never allow anyone under a raised load unless load is securely supported to prevent it from shifting or falling.

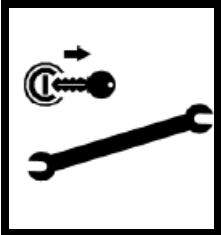

**WARNING:** Failure to use shutdown procedure can result in unexpected hazard(s). Death or serious injury could result due to entanglement, crushing, cutting, or other hazardous contact. Follow Shutdown Procedure after operating, before performing any service or maintenance, and before transporting.



# BC1200XL SHUTDOWN PROCEDURE

## STOPPING THE MACHINE

**NOTICE:** For your safety and safety of others, use shutdown procedure before servicing, cleaning, unclogging, or transporting the chipper. A variation of this procedure may be used if so instructed within this document or if an emergency requires it.

1. Return *Upper Feed Control Bar* to center STOP position.
2. Move *Cutter Engage / Throttle Lever* to ENGAGED/LOW RPM position.

**NOTICE:** Whenever practical and safe, allow engine to idle for 1–5 minutes before shutting down after operating at full power. Please consult machine's engine manual for details.

3. Wait for cutter drum to slow.
4. Move *Cutter Engage / Throttle Lever* to DISENGAGED/LOW RPM position.
5. If so equipped, shut off remote control if in use.
6. Turn ignition key to OFF position and remove key.
7. Wait for the cutter drum and belt to stop.

**NOTICE:** Cutter drum rotation can be checked by looking at the end of shaft (1) on left side of cutter wheel housing. The cutter drum will continue to turn for a short time after the engine has stopped.

8. Close and latch feed table.

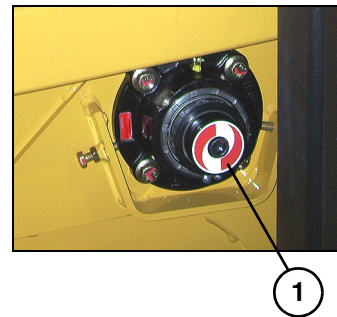
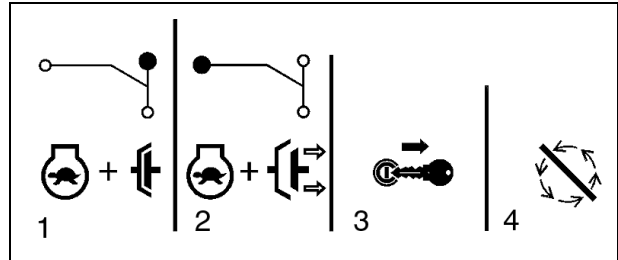

## PROCEDURE: WHEELS, AXLES, AND SUSPENSION MAINTENANCE

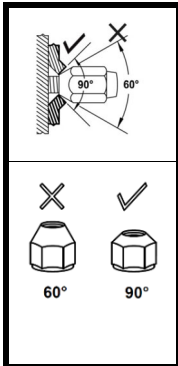

**WARNING:** Incompatible lug nuts may loosen and cause wheel loss.

Use only 5/8-18 lug nuts with a 90° conical taper.

**NOTICE:** Improper or mismatched lug nuts and wheels can cause wheel loss leading to a crash. The conical taper of the lug nuts must properly engage the wheel lug nut seats.

The wheels and axle hubs on this trailer use special 5/8"-18 lug nuts with a 90° conical taper.

Never use incompatible lug nuts, such as those with a 60° taper or a flat face.

Never use wheels intended for a 9/16" wheel lugs.

Never use wheels that do not utilize a 90° conical lug nut seat taper.

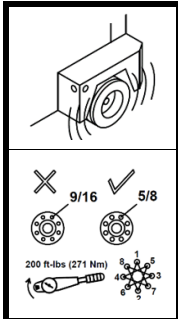

**WARNING:** Incompatible wheels or loose lug nuts can cause wheel loss and machine damage.

Use only wheels that are compatible with 5/8 lug studs and 90° conical nuts. Check lug nut torque regularly.

Properly tighten lug nuts in a star pattern using only hand tools. DO NOT use impact wrenches which can damage the lug nuts, lug nut seats, and hub studs. Torque and check every 500 miles (800km).

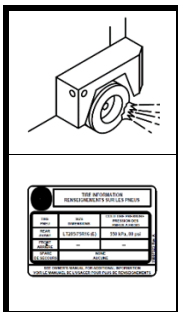

**WARNING:** Improper tire pressure can cause a blowout..

Set cold tire pressure according to tire placard. Check pressure monthly.

**NOTICE:** Under-inflation causes tire damage and can lead to a blowout.

Set the tire air pressure to the value listed on the machine's tire placard, NOT the pressure printed on the sidewall of the tire. Recheck monthly. Tires normally lose 1–2 psi (6.9–13.8 kPa) per month.

Tire pressure can also drop if the temperature outside has dropped significantly, so check more often in cold weather.

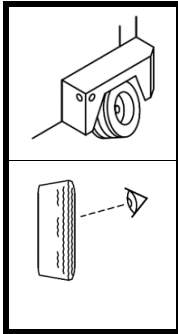

**WARNING:** Worn or damaged suspension can cause premature tire wear and machine damage.

Uneven wear on tires can be an indication of worn suspension or poor alignment.

**NOTICE:** Axle or suspension damage can cause pre-mature tire wear and tire failure, or axle failure.

Have your trailer checked if you suspect misalignment, if your tires have suffered any type of impact, or if you observe uneven tire wear.

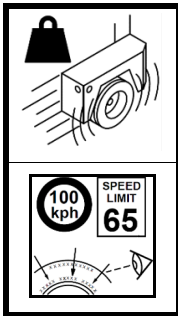

**WARNING:** Avoid overloading or excess speed.

Follow manufacturer's load and speed ratings.

**NOTICE:** High speed and overloading cause tire, axle, and suspension failure.

DO NOT exceed the speed rating of the tires.

DO NOT exceed the load rating of the tires, axles, and suspension.

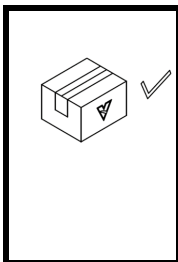

**WARNING:** Always use Vermeer authorized wheels, lug nuts, tires, and suspension components.

Improper or mismatched parts can lead to component failure, resulting in a crash.

# PROCEDURE: 17.5 WHEEL AND TIRE ASSEMBLY ENGLISH

## MANUALS IK01

1. Using a suitable lifting device capable of lifting approximately 6,000 lb (2722 kg), raise machine off ground to allow adequate room to remove tire.
2. Place suitable blocking under trailer frame and remove lifting device.
3. Remove wheel, and 8 wheel nuts, from each side of machine. Weight of each wheel is approximately 91 lb (42 kg).
4. Deflate tire or remove tire from wheel.
5. Torch cut wheels across the wheel nut area.
6. Take a photo(s) of destroyed wheels and attach to campaign warranty claim.
7. Discard wheel nuts so they can no longer be used or sold.
8. The removed used tires may be retained in your used tire inventory or disposed of. Cost of tire removal is included in labor hours.
9. Install supplied wheel assemblies (1), and clamp rings (2) on axle using 16 supplied wheel nuts (3). Weight of each wheel is approximately 91 lb (42 kg). Torque wheel nuts in a star pattern to 200 ft-lb (271 Nm).
10. Check to ensure tire pressure is 85 psi (590 kPa).

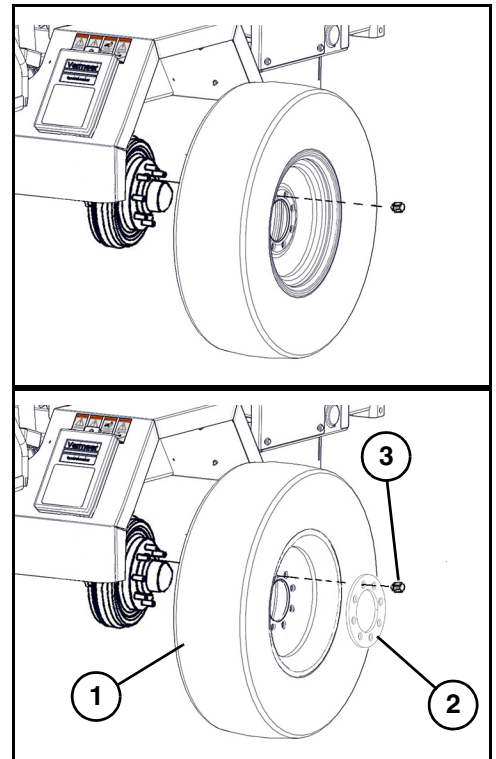

11. On the left side of the machine, apply new supplied wheel and tire warning decal (4) to the side of the metal fuel tank (machine equipped with gas engine), or to the side shield of the engine if machine is equipped with a plastic fuel tank (diesel engine).

12. On the right side of the machine, apply new supplied wheel and tire information decal (5) to the top of the fender.

13. Provide additional Supplemental Manual to owner.

14. Install Operator's Manual with ring in manual storage box.

**4**

**WARNING**

Wheel loss, the blowout, and loss of vehicle control can occur, causing death or serious injury.

Incompatible lug nuts may loosen and cause wheel loss.

Use only S&B 18 nuts with a 90° conical taper.

Incompatible wheels or loose lug nuts can cause wheel loss.

Use only proper wheels. Check torque regularly.

Improper tire pressure can cause a blowout.

Worn or damaged suspension can reduce pressure on the wheel and machine damage.

Avoid overloading or excess speed.

Get cold tire pressure according to the amount of air inflation as shown on the label.

Uniform wear on tires is an indication of poor maintenance and poor alignment.

Always follow manufacturer's load and speed ratings.

**100 kph**  
**SPEED LIMIT 65**

ALWAYS use Vermeer approved wheels, lug nuts, tires, and suspension components.

**5**

TIRE INFORMATION RENSEIGNEMENTS SUR LES PNEUS		
TAG / PNEU	SIZE / DIMENSIONS	COLD TIRE PRESSURE / PRESSIONS FROIDES
REAR / ARRIERE	285/70R17.5 H43	5.8 MPa, 85 psi
FRONT / AVANT	---	---
SPEED / VELOCITE	---	---

# PROCEDURE: 17.5 WHEEL AND TIRE ASSEMBLY INTERNATIONAL IK02

1. Using a suitable lifting device capable of lifting approximately 6,000 lb (2722 kg), raise machine off ground to allow adequate room to remove tire.
2. Place suitable blocking under trailer frame and remove lifting device.
3. Remove wheel, and 8 wheel nuts, from each side of machine. Weight of each wheel is approximately 91 lb (42 kg).
4. Deflate tire or remove tire from wheel.
5. Torch cut wheels across the wheel nut area.
6. Take a photo(s) of destroyed wheels and attach to campaign warranty claim.
7. Discard wheel nuts so they can no longer be used or sold.
8. The removed used tires may be retained in your used tire inventory or disposed of. Cost of tire removal is included in labor hours.
9. Install supplied wheel assemblies (1), and clamp rings (2) on axle using 16 supplied wheel nuts (3). Weight of each wheel is approximately 91 lb (42 kg). Torque wheel nuts in a star pattern to 200 ft-lb (271 Nm).
10. Check to ensure tire pressure is 85 psi (590 kPa).

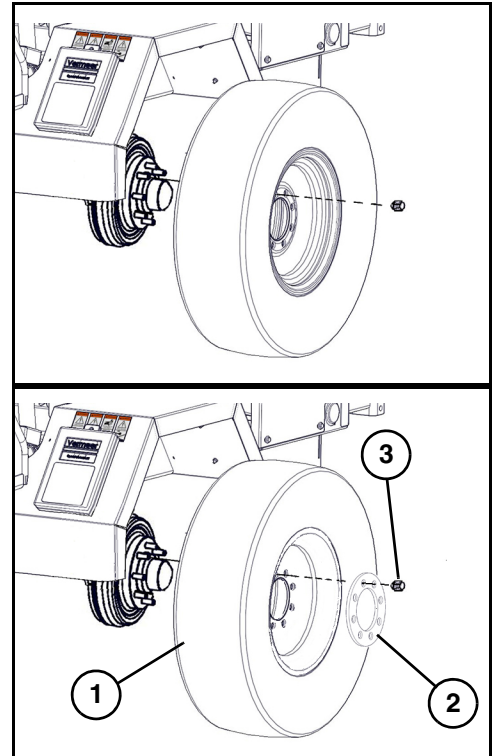

11. On the left side of the machine, apply new supplied wheel and tire warning decal (4) to the side of the metal fuel tank (machine equipped with gas engine), or to the side shield of the engine if machine is equipped with a plastic fuel tank (diesel engine).

12. On the right side of the machine, apply new supplied wheel and tire warning decal (4) and tire information decal (5) to the top of the fender.

13. Provide additional Supplemental Manual to owner.

14. Install Operator's Manual with ring in manual storage box.

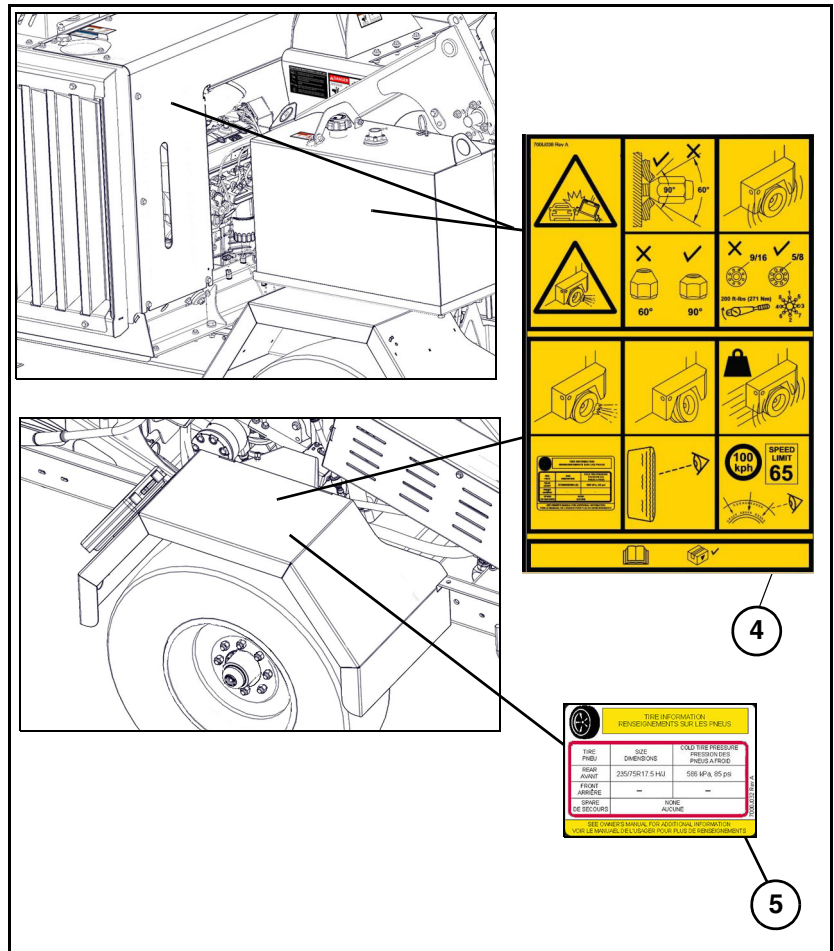

# PROCEDURE: SAFETY SIGN, TIRE SPECIFICATION PLACARD, MANUAL INSTALLATION IK03

1. Machines with wheel and tire assembly (PN 163759457) previously installed must have new decals installed. On the left side of the machine, apply new supplied wheel and tire warning decal (1) to the side of the metal fuel tank (machine equipped with gas engine), or to the side shield of the engine if machine is equipped with a plastic fuel tank (diesel engine).
2. On the right side of the machine, apply new supplied wheel and tire information decal (2) to the top of the fender.
3. Provide additional Supplemental Manual to owner.
4. Install Operator's Manual with ring in manual storage box.

**WARNING**

Incorrect fit

Wheel nuts are loosened, and loss of vehicle control can occur, causing death or serious injury.

Incompatible lug nuts may loosen and cause wheel loss.

Use only 5/16-18 nuts with a 90° conical taper.

Incompatible wheels or loose lug nuts can cause wheel loss.

Use only proper wheels. Check torque regularly.

Use only 9/16" x 5/8" lug nuts.

Use only proper wheels. Check torque regularly.

Improper tire pressure can cause a blowout.

Worn or damaged suspension can cause premature tire wear and machine damage.

Avoid overloading or excess speed.

Set cold tire pressure according to tire placard. NOT maximum pressure printed on sidewall.

Excess wear on tires is an indication of worn suspension or poor alignment.

Always follow manufacturer's load and speed ratings.

100 MPH SPEED LIMIT 65

ALWAYS use Vermeer authorized wheels, lug nuts, tires, and suspension components.

TIRE INFORMATION		RENSEIGNEMENTS SUR LES PNEUS	
TIRE PNEU	SIZE DIMENSIONS	COLD TIRE PRESSURE PRESSION DES PNEUS A FROID	
REAR ARRIERE	235/75R17 5 H2	588 kPa (85 psi)	
FRONT AVANT			
SPARE DE SECOURS	TUNE AJUSTE		

SEE OWNER'S MANUAL FOR ADDITIONAL INFORMATION. VOIR LE MANUEL DE L'OPERATEUR POUR PLUS DE RENSEIGNEMENTS.

2



# PROCEDURE: SAFETY SIGN, TIRE SPECIFICATION PLACARD, MANUAL INSTALLATION IK04

1. On the left side of the machine, apply new supplied wheel and tire warning decal (1) to the side of the metal fuel tank (machine equipped with gas engine), or to the side shield of the engine if machine is equipped with a plastic fuel tank (diesel engine).
2. On the right side of the machine, apply new supplied wheel and tire warning decal (1) and tire information decal (2) to the top of the fender.
3. Provide additional Supplemental Manual to owner.
4. Install Operator's Manual with ring in manual storage box.

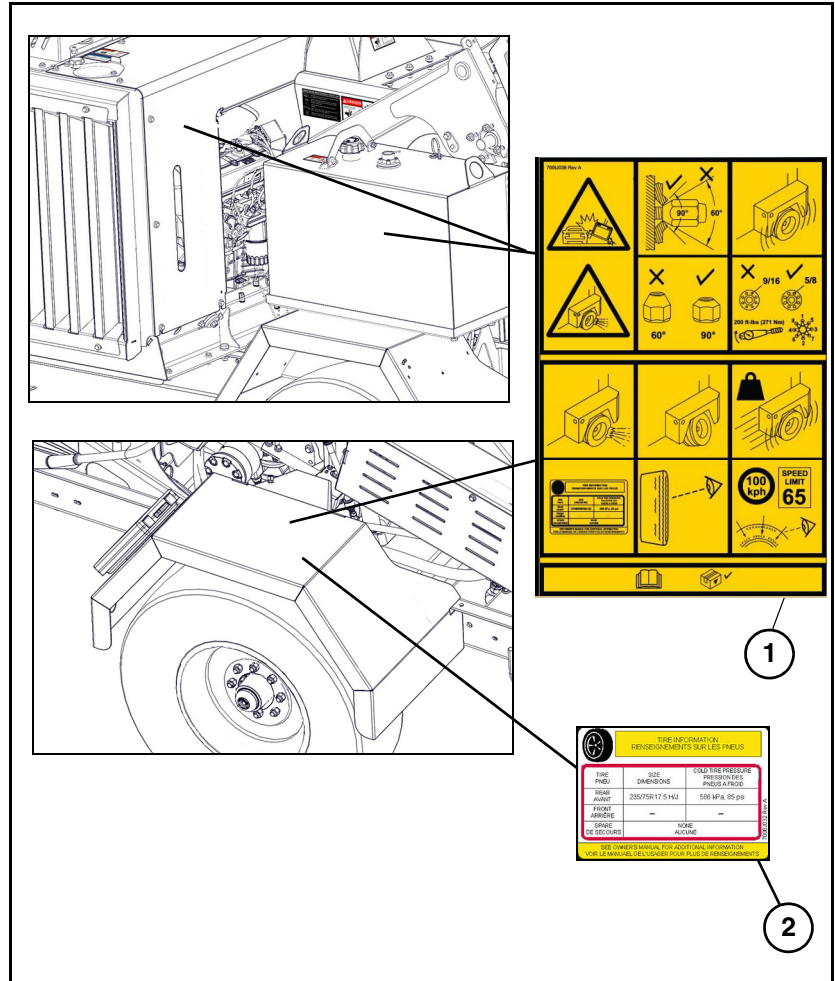

**Figure 1**

UNIT OWNER COPY:  
Insert into Parts Manual  
for future reference

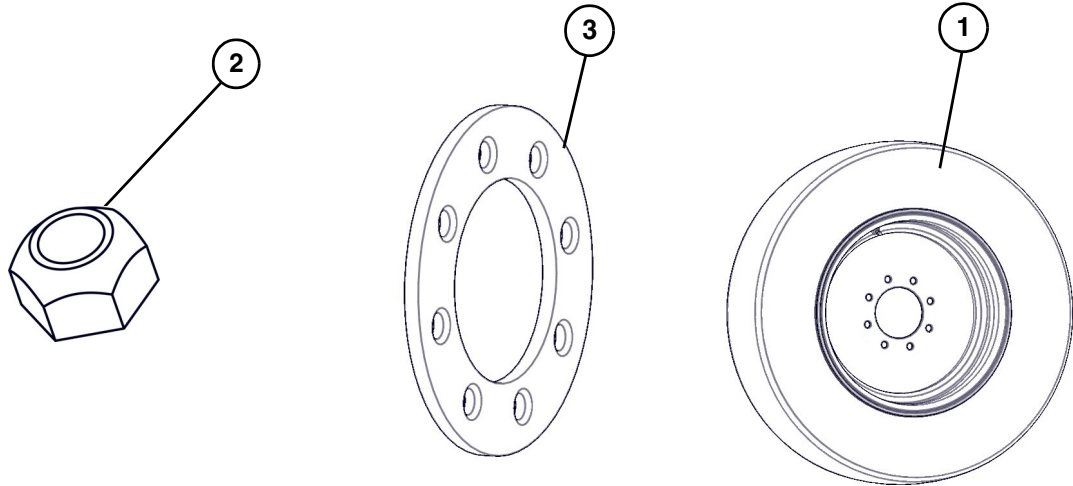

**FIGURE 1 Parts List**

<b>REF. NO.</b>	<b>PART NO.</b>	<b>DESCRIPTION</b>	<b>IK01 QTY.</b>	<b>IK02 QTY.</b>
<b>1</b>	<b>163713905</b>	HEAVY DUTY-WHEEL ASSEMBLY-235/75R17.5H/J; 5/8 S	2	2
<b>2</b>	<b>116621009</b>	WHEEL NUT 5/8in 18 CONE 90°	16	16
<b>3</b>	<b>215490049</b>	CLAMP RING	2	2
		Kit includes all items in Figure 1 Parts List.		

UNIT OWNER COPY:  
Insert into Parts Manual  
for future reference

Figure 2

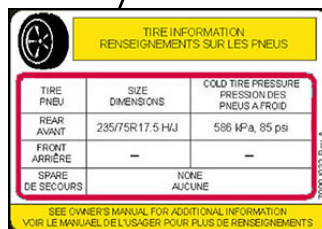
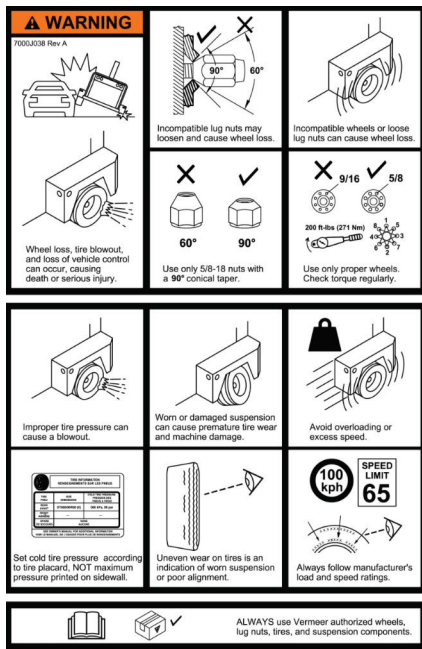

FIGURE 2 Parts List

REF. NO.	PART NO.	DESCRIPTION	IK01 QTY.	IK02 QTY.	IK03 QTY.	IK04 QTY.
1	7000J038	DECAL-WARNING, WHEEL & TIRE	2		2	
2	700IJ038	DECAL-WARNING, WHEEL & TIRE		2		2
3	7000J032	DECAL- TIRE INFORMATION	1	1	1	1
		Kit includes all items in Figure 2 Parts List.				

UNIT OWNER COPY:  
Insert into Parts Manual  
for future reference

**Figure 3**

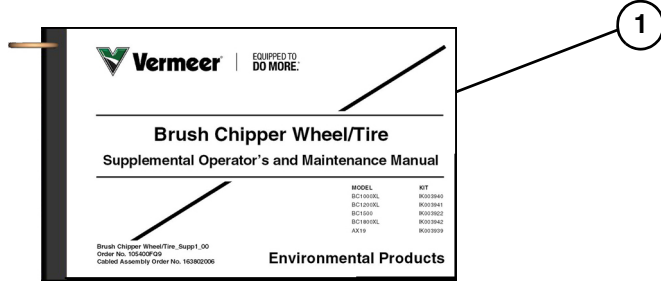
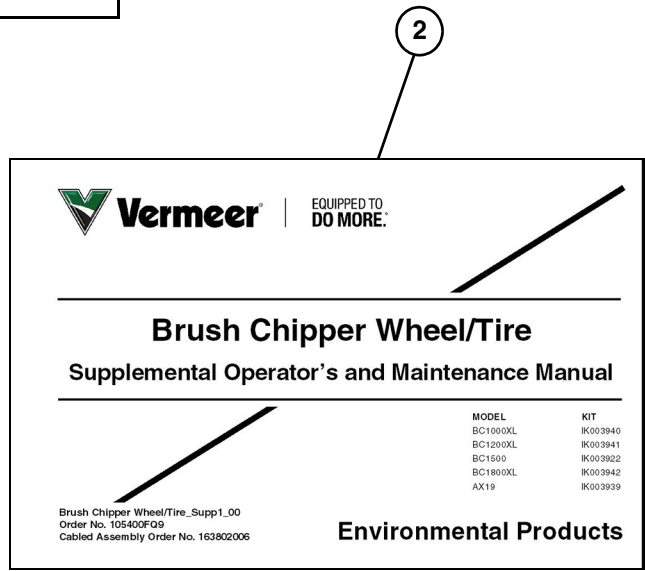

FIGURE 3 Parts List						
REF. NO.	PART NO.	DESCRIPTION	IK01 QTY.	IK02 QTY.	IK03 QTY.	IK04 QTY.
1	163802006	BRUSH CHIPPER WHL/TIR SUPPLEMENTAL MANUAL	1	1	1	1
2	105400FQ9	BRUSH CHIPPER WHEEL/TIRE SUPPLEMENTAL MANUAL	1	1	1	1
		Kit includes all items in Figure 3 Parts List.				