

Safety Recall N335 Care Points



- There has been enhancements made to the SDD software released on 157.05 that improve the flow of testing with the IDU2 diagnostic unit.

These include:

- Improved test voltage range to accommodate all approved battery maintainers.
 - Improved vehicle fuse call outs to guide technicians to the correct fuse location.
 - Improved test pop-up messages for improved clarity when performing the tests.
- In addition to these SDD software, the service instructions on the recall bulletin have been enhanced.
 - SSM74498 has been published to provide care points for ensuring the IDU2 testing runs smoothly.
 - There is another enhancement for RFA updates scheduled for SDD 157.06. Should you have any concerns with RFA updates, please submit a TA case for the concern.





E197752

Item	Description	Item	Description
1	Inline Diagnostic Unit (IDU2)	2	Primary battery cable (IDU02)
3	USB connection cable	4	Test cable (IDU04)



These are the IDU2 diagnostic unit components required to perform the Remote Actuator Function (RFA) testing.

The IDU2 diagnostic kit and its individual components are sold and serviced by Bosch as part of the Special Tools program.

Before starting the IDU2 testing on the vehicle, ensure that the power door locks operate properly with the key fob, as the doors must be locked to start the RFA test on each door latch.



E197761

Item	Description	Item	Description
1	Connect the Inline Diagnostic Unit 2 (IDU2) output cable (IDU04)	2	IDU04 cable connection instructions
3	Cable connection illustration	4	IDU04 not connected icon
5	IDU04 connected icon	6	Exit test button



Upon starting the IDU2 tests process it is important to read and follow the on screen prompts.

Failure to do so may cause the test to fail and need to be rerun or even damage to the test equipment.

When the IDU04 cable is connected to the IDU2 module the screen will automatically advance to the next screen, unless there is a concern reading the cable that is connected.

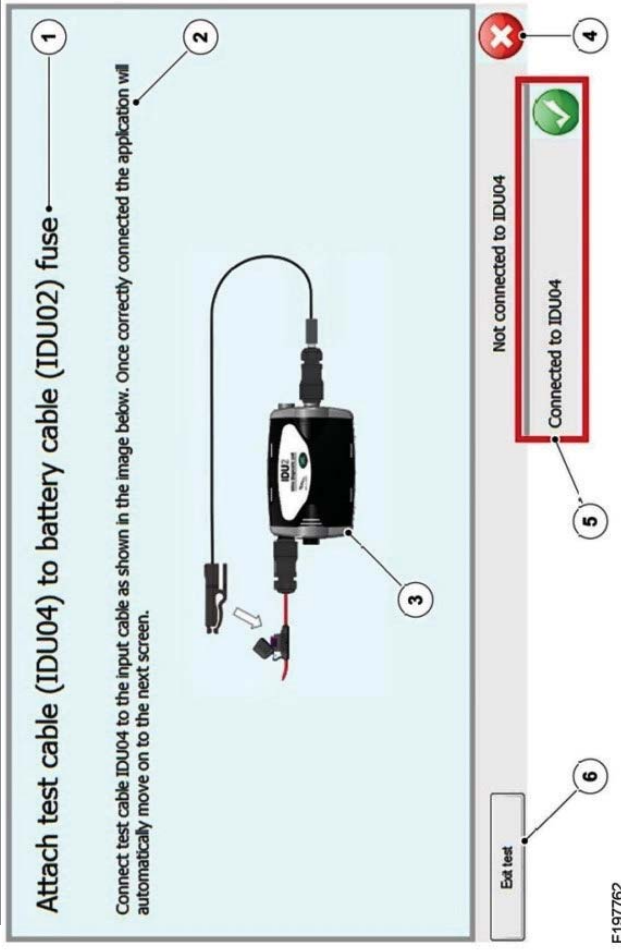

E197762

Item	Description	Item	Description
1	Attach test cable (IDU04) to battery cable (IDU02) fuse	2	IDU04 cable connection instructions
3	Cable connection illustration	4	IDU04 not connected icon
5	IDU04 connected icon	6	Exit test button



When performing the in-line fuse test, ensure that the IDU04 cable fuse test lead is connected to a genuine Land Rover fuse.

Some after-market fuses do not have open terminals for back probe testing of the fuse.

Others have a different spacing of the terminals to that of a genuine Land Rover fuse.

Forcing the test lead onto a non genuine fuse could result in damage to your IDU04 cable terminal pins.

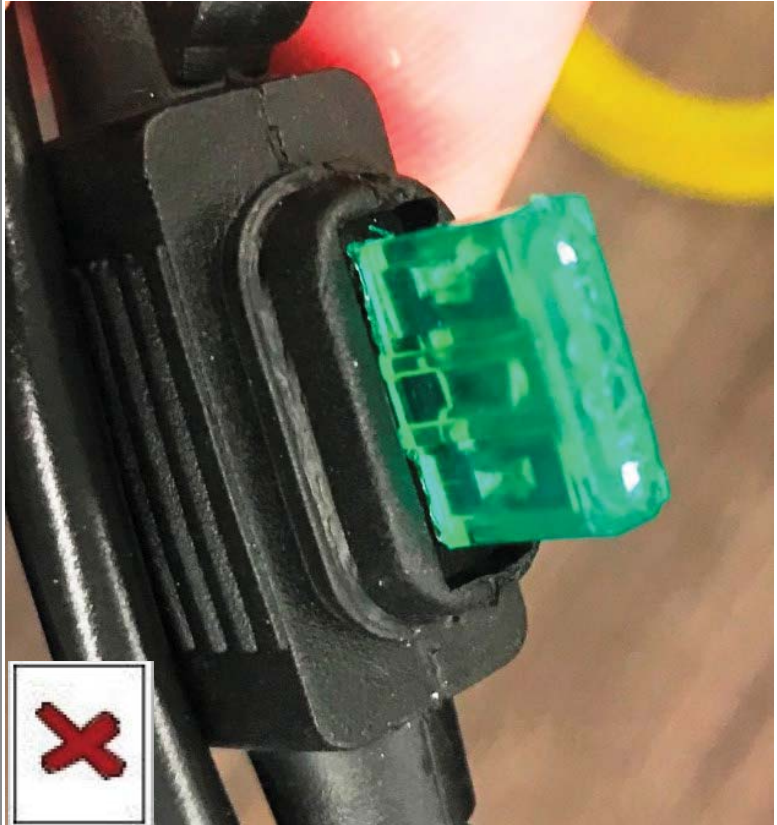
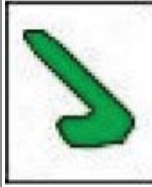

After-market fuses are often easy to identify by the translucent color.



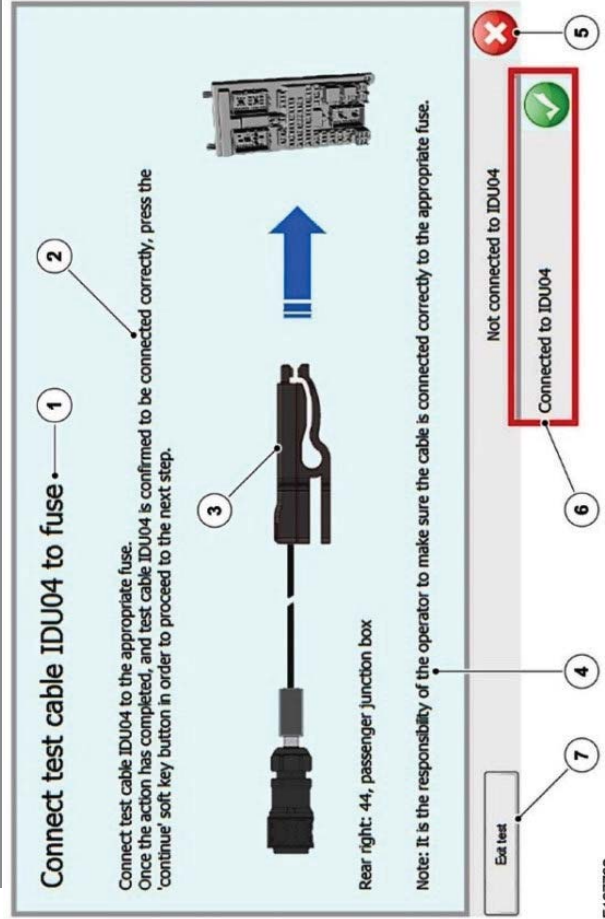

E197766

Item	Description	Item	Description
1	Connect test cable (IDU04) to fuse	2	IDU04 cable connection instructions
3	Cable connection illustration	4	Cable connection note
5	IDU04 not connected icon	6	IDU04 connected icon
7	Exit test button		



When connecting the IDU04 cable fuse test lead to the vehicle fuse, ensure that you are connecting to the vehicle fuse that is listed on screen.

The fuse number and location varies by vehicle model year, always read the on screen prompts.

The fuse location callout has been enhanced on SDD 157.05.

Again, ensure that a genuine Land Rover fuse is installed in the vehicle fuse cavity required for the testing to ensure proper contact for the test lead.