



E197752

Item	Description	Item	Description
1	Inline Diagnostic Unit (IDU2)	2	Primary battery cable (IDU02)
3	USB connection cable	4	Test cable (IDU04)

Once the IDU04 cable is connected to the IDU2 unit the screen will automatically advance to the IDU04 fuse test screen.

If this test fails, check the cable bent or broken pins and repeat the connection test.

If this test does not pass the cable connection, try another cable or diagnostic unit and contact Bosch technical support.

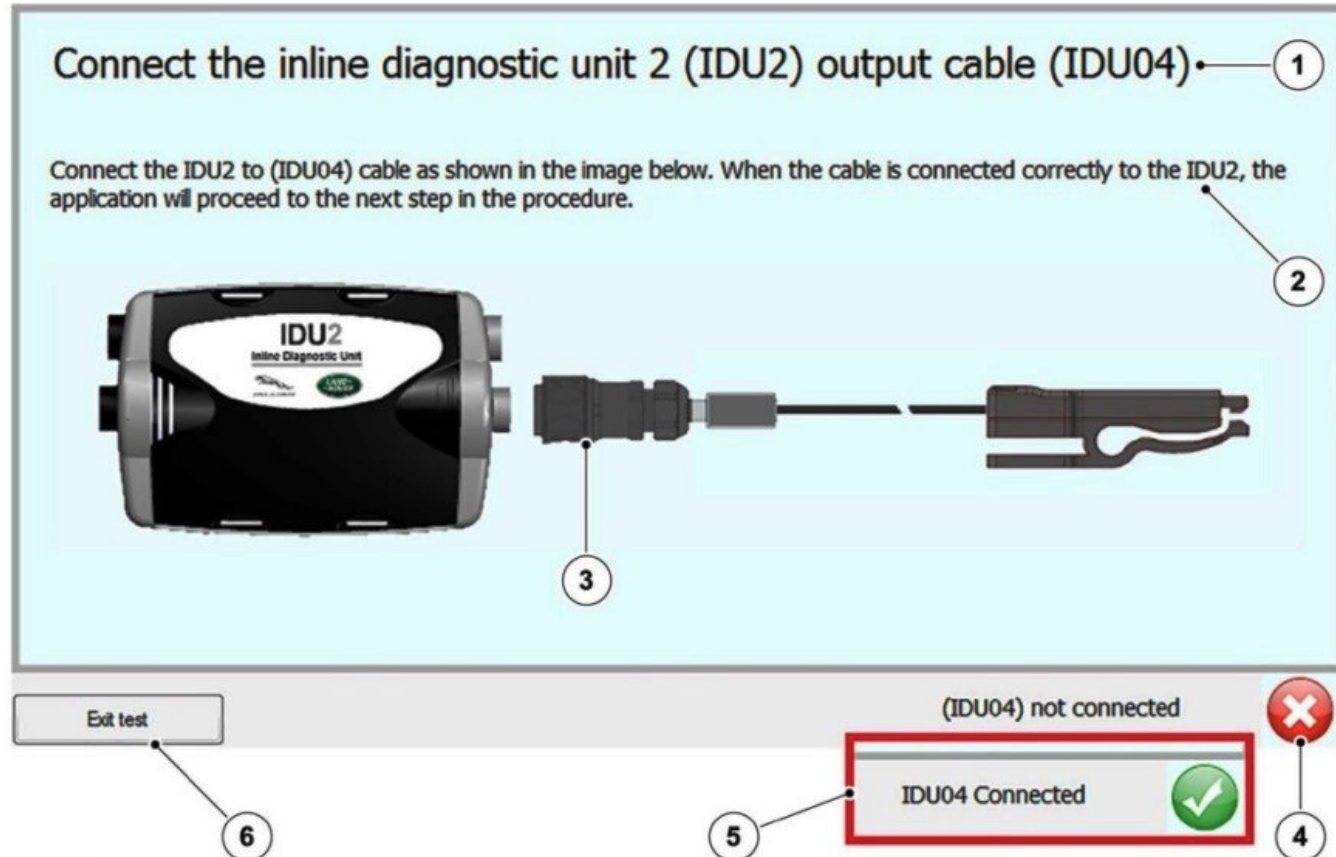

E197761

Item	Description	Item	Description
1	Connect the Inline Diagnostic Unit 2 (IDU2) output cable (IDU04)	2	IDU04 cable connection instructions
3	Cable connection illustration	4	IDU04 not connected icon
5	IDU04 connected icon	6	Exit test button

Attach test cable (IDU04) to battery cable (IDU02) fuse 1

Connect test cable IDU04 to the input cable as shown in the image below. Once correctly connected the application will automatically move on to the next screen.

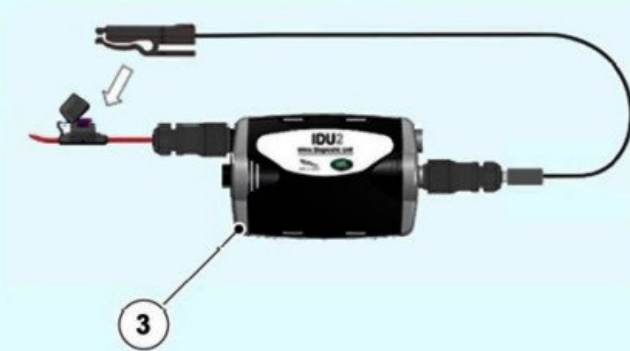

Ensure that a genuine Land Rover/ compatible fuse is used to complete the IDU04 to battery cable IDU02 cable fuse test.

This screen will clear automatically once a good connection is made and the measured voltage is within the test range of 12.5 – 13.8 volts as measured at the fuse terminal.

If this screen does not clear, check the type of fused used, the use terminal lead and the voltage at the fuse terminal to be in the test range.

Exit test 6

Not connected to IDU04 4

Connected to IDU04 5



E197762

Item	Description	Item	Description
1	Attach test cable (IDU04) to battery cable (IDU02) fuse	2	IDU04 cable connection instructions
3	Cable connection illustration	4	IDU04 not connected icon
5	IDU04 connected icon	6	Exit test button

When connecting the IDU04 cable to the vehicle fuse, ensure that you are following the on-screen prompts as to the correct fuse to connect to.

The fuse varies by model and model year.

2013 & 2014 models will be in the passenger junction box.

2015 & 2016 models will be in the rear junction box.

Connect test cable IDU04 to fuse ① ②

Connect test cable IDU04 to the appropriate fuse. Once the action has completed, and test cable IDU04 is confirmed to be connected correctly, press the 'continue' soft key button in order to proceed to the next step.

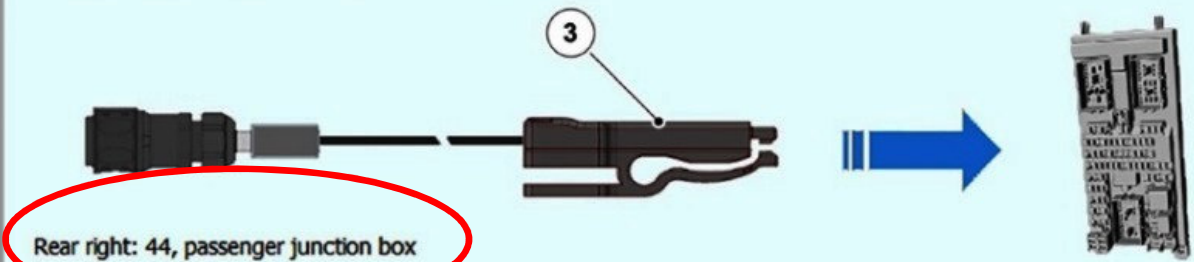

Rear right: 44, passenger junction box

Note: It is the responsibility of the operator to make sure the cable is connected correctly to the appropriate fuse.

Exit test ⑦

Not connected to IDU04 ⑤

Connected to IDU04 ⑥

E197766

Item	Description	Item	Description
1	Connect test cable (IDU04) to fuse	2	IDU04 cable connection instructions
3	Cable connection illustration	4	Cable connection note
5	IDU04 not connected icon	6	IDU04 connected icon
7	Exit test button		



After-market fuses are often translucent in color; while the color of the Land Rover original equipment fuses are a more solid color.

Some after-market fuses do not have open terminal access for back probing fuses, others that due may have a different spacing between the terminals that are not compatible with the IDU04 cable fuse terminal lead.

Ensure only compatible fuses are used when testing with the IDU04 cable lead, both in the IDU02 fuse holders and in the vehicle fuse box.