



Safety Recall Action Notice SB 560 Issue 1 - 03.2019

Subject: Headstock Tidy Replace				
Bulletin Number	Models Affected	VIN Range		Markets Affected
560	Street Scrambler	From 798290	to 910740	All Markets
	Street Twin	From 731919	to 913928	All Markets
	Street Twin A2 Licence Version	From 799237	to 831934	All Markets
	Street Cup	From 780697	to 896532	All Markets
	Bonneville T100	From 759204	to 935306	All Markets
	Bonneville T100 Black	From 765369	to 935286	All Markets
	Bonneville T120	From 739727	to 935318	All Markets
	Bonneville T120 Black	From 741136	to 933769	All Markets

Background Information

The headstock tidy has been refined to allow the main harness and clutch cable to locate in a more natural position during operation and avoid the possibility of the clutch cable damaging the main harness. Dealers are requested to replace the headstock tidy and it's fixings as described in the procedure below.

Customer Contact Instructions

Notice

STOP DELIVERY OF AFFECTED MOTORCYCLES IMMEDIATELY.

DO NOT deliver a motorcycle affected by this Safety Recall Action Notice to a customer until you have completed, or confirmed completion of, the procedures described in this Safety Recall Action Notice.

Delivering a motorcycle subject to an outstanding Safety Recall Action Notice may contravene local or national laws in your market, territory or country.

Triumph subsidiaries and distributors must instigate a Safety Recall Action in their country in accordance with the national recall code of practice. For vehicles in dealer stock, the safety recall MUST be actioned before delivery to the customer.

Dealers are to prioritise repair of customer owned motorcycles before any unsold motorcycles.

Identification of Affected Motorcycles

Bonneville T100, Bonneville T100 Black, Bonneville T120, Bonneville T120 Black, Street Twin, Street Twin A2 Licence Version, Street Cup and Street Scrambler.

Note:

- Some affected motorcycles listed in the VIN range will have been modified and repaired by Triumph prior to their release from the factory.
- Unmodified motorcycles can be identified by checking the 'VIN Enquiry' on www.triumphonline.net.

Warranty Claim Instructions

Bulletin Number	Fault Code	Repair Code	Description	Repair Time Allowance
560	025010994	99560	Bonneville T100, Bonneville T100 Black, Bonneville T120, Bonneville T120 Black, Street Twin, Street Twin A2 Licence Version and Street Cup SB560 - Remove and replace the headstock tidy	0.09
	025010994	99560	Street Scrambler SB560 - Remove and replace the headstock tidy	0.11

Genuine Parts Information

Note:

- The headstock tidies in the two kits listed below are different, and are not interchangeable between models. Make sure the correct kit is fitted to the motorcycle you are working on.

Bulletin Number	Part Number	Description	Quantity
560	T2502437	Headstock Tidy Kit : Street Twin, Street Twin A2 Licence Version, Street Cup and Street Scrambler Kit contents: <ul style="list-style-type: none">• Headstock Tidy x 1• Fixings, M5 x 0.8 x 12 x 2• Lock nut, Flanged, M6 x 1.0 x 1	1
560	T2502687	Headstock Tidy Kit : Bonneville T100, Bonneville T100 Black, Bonneville T120, Bonneville T120 Black Kit contents: <ul style="list-style-type: none">• Headstock Tidy x 1• Fixings, M5 x 0.8 x 12 x 2• Lock nut, Flanged, M6 x 1.0 x 1	1

Parts Ordering Instructions

For Triumph Subsidiary and Overseas Distributor dealers using Triumph Warranty On-Line with Parts Auto Ordering Flag switched on: Order all repair parts by submitting a New Prior through the Warranty On-Line system. Entering the above repair code in a New Prior will automatically add the parts required and labour times for this Service Bulletin.

For Overseas Distributor dealers NOT using Triumph Warranty On-Line or for Overseas Distributor dealers using Triumph Warranty On-Line with Parts Auto Ordering Flag switched off: Orders should be placed using the normal parts ordering procedure.

Genuine Parts Return

Dealer to retain parts for 90 days. All parts must be stored in a secure, non-public accessed area and correctly identified with a completed warranty label. Thereafter the parts must be rendered unusable prior to scrapping.

Other Instructions

Once completed, please mark the Service Record Book that the requirements of this Safety Recall Action Notice have been complied with.

Before returning the motorcycle to the customer, download the latest calibration to the engine control module using the current version of the Triumph diagnostic software.

Warning

Before starting work, ensure the motorcycle is stabilised and adequately supported. This will help prevent it from falling and causing injury to the operator or damage to the motorcycle.

Removal - All Models

1. Remove the seat as described in the Service Manual.
2. Disconnect the battery as described in the Service Manual.
3. Release the lock nut and retain as described in the Genuine Parts Return section, remove the bolt and detach the fuel tank from the rear fixing.

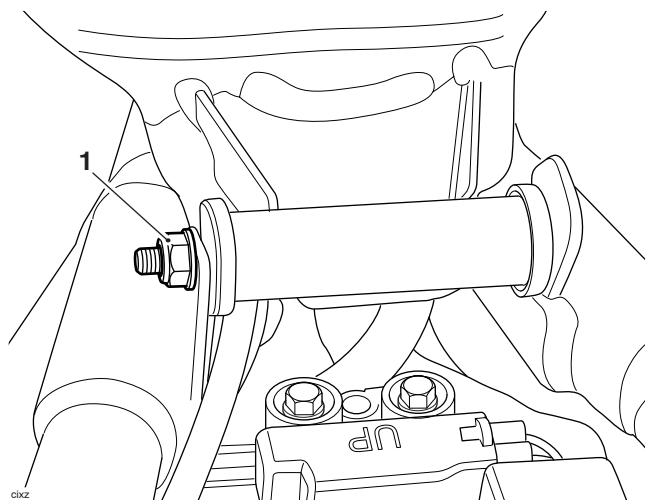

1. Lock nut, flanged, M6 x 1.0

Note:

- Use a suitable heavy cloth or tape (such as masking tape) to protect the frame and fuel tank.
4. Slide the fuel tank rearwards approximately 25 mm to gain access to the headstock tidy fixings.
 5. Remove the headstock tidy fixings and then remove the headstock tidy, retain the parts as described in the Genuine Parts Return section.

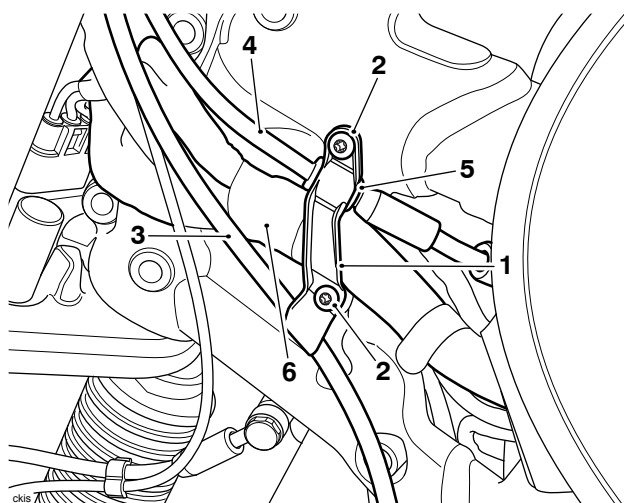

1. Headstock tidy
2. Fixings, M5 x 0.8 x 12
3. Clutch cable
4. Brake line
5. Grommet (brake line)
6. Main wiring harness

Installation - Bonneville T100, Bonneville T100 Black, Bonneville T120, Bonneville T120 Black

Note:

- The brake line grommet must be fitted with the raised rear edge aligned with the rear of the headstock tidy as shown in the illustration below.
1. Position the clutch cable, brake line and main wiring harness in their respective positions on the headstock tidy, position it to the frame with the raised edge of the brake line grommet visible to the front of the headstock tidy as shown below.
 2. Tighten the new fixings to 1.5 Nm.

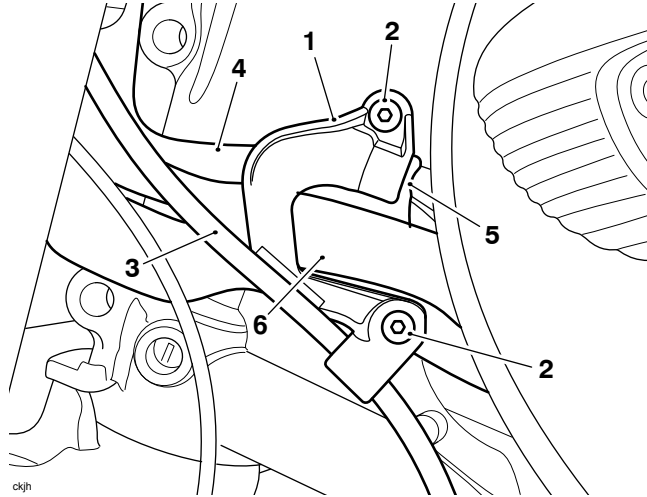

1. **Headstock tidy**
2. **Fixings, M5 x 0.8 x 12**
3. **Clutch cable**
4. **Brake line**
5. **Grommet (brake line)**
6. **Main wiring harness**

3. With the aid of an assistant, turn the handlebars lock to lock, making sure there is no hard contact between the clutch cable, main harness and brake line. Make sure the main harness is free to move.
4. Reposition the fuel tank to its original position and remove any protective measures used during removal.
5. Refit the rear fuel tank mounting retaining bolt.
6. Fit a new locknut from the kit, counterhold the bolt and tighten to 8 Nm.

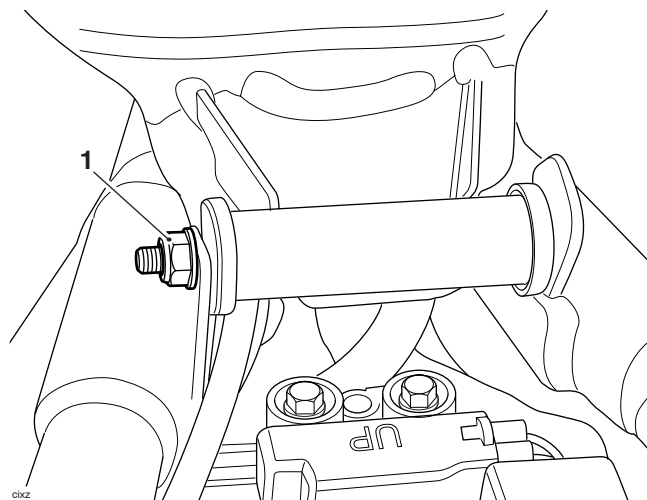

1. **Lock nut, flanged, M6 x 1.0**
7. Reconnect the battery as described in the Service Manual.
8. Start the engine.

9. With the engine running, turn the handlebars lock to lock, and check that the headlight, direction indicators, rear lights and brake lights operate in all positions, and that the engine continues to idle.
10. Refit the seat as described in the Service Manual.

Installation - Street Twin, Street Twin A2 Licence Version, Street Cup and Street Scrambler

Note:

- **The brake line grommet must be fitted with the raised front edge aligned with the front of the headstock tidy as shown in the illustration below.**
1. Position the clutch cable, brake line and main wiring harness in their respective positions on the headstock tidy, position it to the frame with the raised edge of the brake line grommet visible to the front of the headstock tidy as shown below.
 2. Tighten the new fixings to 1.5 Nm.

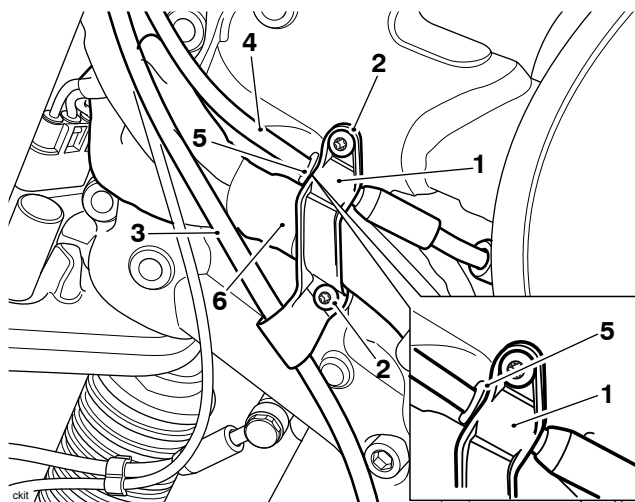

1. **Headstock tidy**
2. **Fixings, M5 x 0.8 x 12**
3. **Clutch cable**
4. **Brake line**
5. **Grommet (brake line)**
6. **Main wiring harness**

3. With the aid of an assistant, turn the handlebars lock to lock, making sure there is no hard contact between the clutch cable, main harness and brake line. Make sure the main harness is free to move.
4. Reposition the fuel tank to its original position and remove any protective measures used during removal.
5. Refit the rear fuel tank mounting retaining bolt.

6. Fit a new locknut from the kit, counterhold the bolt and tighten to 8 Nm.

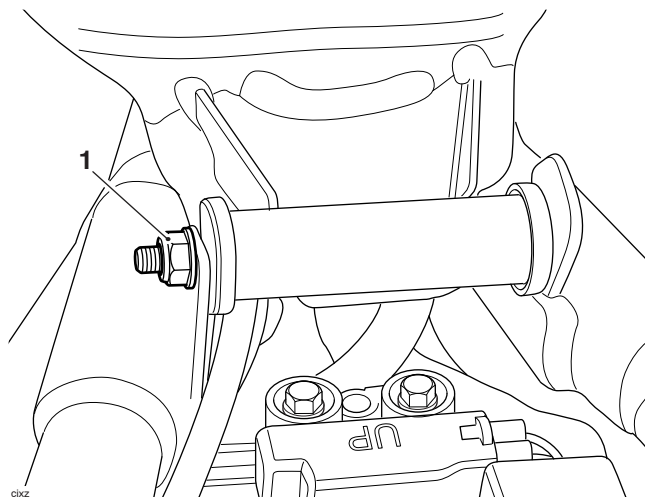

1. Lock nut, flanged, M6 x 1.0

7. Reconnect the battery as described in the Service Manual.
8. Start the engine.
9. With the engine running, turn the handlebars lock to lock, and check that the headlight, direction indicators, rear lights and brake lights operate in all positions, and that the engine continues to idle.
10. Refit the seat(s) as described in the Service Manual.

Circulation

Initial and date when read and return to central file holder

Service Manager	Parts Manager	Sales Manager	Workshop Supervisor	Technician 1	Technician 2