



# SAFETY RECALL V07 ADJUSTABLE BRAKE PEDAL REINFORCEMENT OF REPAIR PROCEDURE

Based on recent investigations we have found instances of the repair procedure for Safety Recall V07 not being performed correctly which could create reduced clearance between the accelerator pedal and the floor mats.

Please pay special attention to step 3 on page 6 of the Dealer Instructions. If the electrical connector is not disconnected this could cause difficulty in getting the pedal to align properly for reassembly.

3. Disconnect the electrical connector from the accelerator pedal (Figures 5, 6).  
**NOTE: This is a slide style connector.**

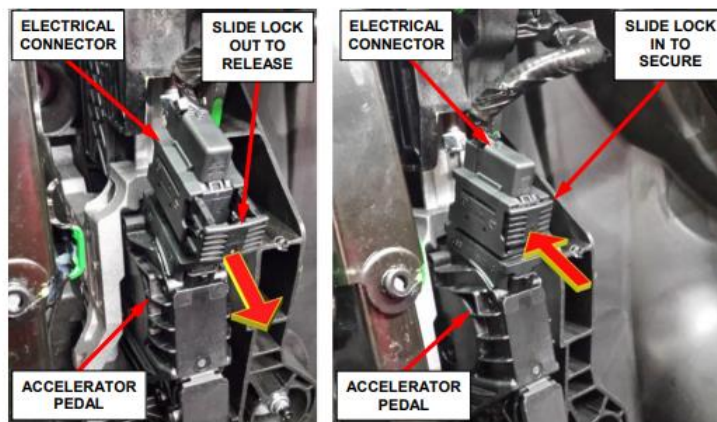

Figure 5 – Accelerator Pedal Electrical Connector Slide Lock Style

When performing step 12 on page 9 of the Dealer Instructions it is important to ensure that per figure 11 the “Upper Edge Lip” is fully engaged. Failure to do so could result in the pedal not having the intended clearance between it and the floor mat.

12. Connect the accelerator pedal electrical connector (Figure 11).

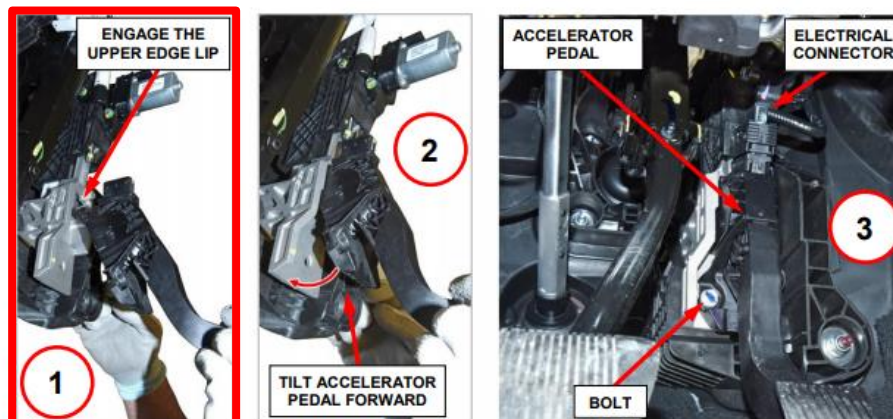

Figure 11 – Install Accelerator Pedal to Adjustable Pedal Assembly