



## Safety Recall Action Notice SB568 Issue 1 - 11.2019

Subject: Gear Linkage Clamp Assembly Replace				
Notice Number	Models Affected	VIN Range		Markets Affected
568	Speed Triple S	From	867685	All markets
		Up to	957570	
568	Speed Triple RS	From	867601	All markets except US and Canada
		Up to	971378	
Dealer Stock Accessory Kits To Be Returned				
Part Number		Description		
A9930469		Accessory Quickshifter Kit, TSA		

## Background Information

Dealers are required to repair all motorcycles within the above VIN ranges previously fitted with Accessory Quickshifter Kit, TSA (A9930469) by replacing the Linkage Clamp Assembly (T2085085) with remedy part (T2085100). Dealers are also required to return to Triumph any unsold Accessory Quickshifter Kits, TSA (A9930469) via the MRN process.

Internal investigations have identified a need to replace the gear linkage clamp assembly (T2085085) on some of the above models that are fitted with an Accessory Quickshifter Kit, TSA, Triumph Part Number (A9930469).

Initially, dealers are to check if the motorcycle has an Accessory Quickshifter Kit, TSA fitted. If no Accessory Quickshifter Kit, TSA is fitted, no repair is required.

If an Accessory Quickshifter Kit, TSA is fitted, dealers must check for a scallop on the gear linkage clamp assembly as illustrated below.

The gear linkage clamp assembly does not need to be removed for this check as the scallop is clearly visible.

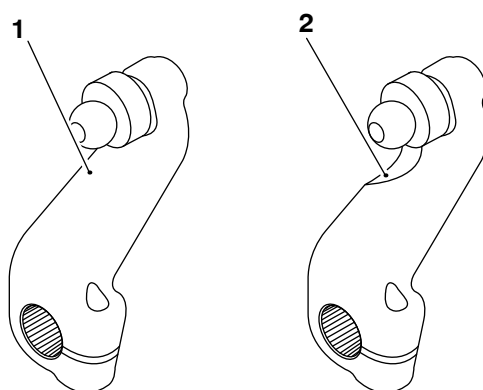

1. **Recalled part - Linkage clamp assembly, T2085085 (without scallop) - Referred to throughout as Gear Linkage Clamp Assembly**
2. **Remedy part - Linkage clamp assembly, T2085100 (with scallop) - Referred to throughout as Gear Linkage Clamp Assembly**

If a scallop exists on the gear linkage clamp assembly, no further action is necessary.

If no scallop exists, dealers are required to replace the gear linkage clamp assembly as described in the procedure below.

## Unsold Dealer Stock Accessory Kit A9930469 Returns

For all unsold accessory kits in dealer stock (Accessory Quickshifter Kit, TSA, Triumph Part Number A9930469), dealers are required to return these to Triumph for a full credit via the MRN process. Dealers can order the replacement accessory kits (Accessory Quickshifter Kit, TSA, Triumph Part Number A9770425).

## Customer Contact Instructions

### Notice

STOP DELIVERY OF AFFECTED MOTORCYCLES IMMEDIATELY.

DO NOT deliver a motorcycle affected by this Safety Recall Action Notice to a customer until you have completed, or confirmed completion of, the procedures described in this Safety Recall Action Notice.

Delivering a motorcycle subject to an outstanding Safety Recall Action Notice may contravene local or national laws in your market, territory or country.

Triumph subsidiaries and distributors must instigate a Safety Recall Action in their country in accordance with the national recall code of practice. For vehicles in dealer stock, the safety recall MUST be actioned before delivery to the customer.

Dealers are to prioritise repair of customer owned motorcycles before any unsold motorcycles.

---

## Identification of Affected Motorcycles

Speed Triple S and Speed Triple RS models listed in the VIN ranges above.

### Note:

- Some affected motorcycles listed in the VIN range will have been modified and repaired by Triumph prior to their release from the factory.
- Unmodified motorcycles can be identified by checking the 'VIN Enquiry' on [www.triumphonline.net](http://www.triumphonline.net).

## Warranty Claim Instructions

Dealers must submit a warranty claim using repair code 995681 for those VINs within the affected VIN range, checked and found **NOT** to have an Accessory Quickshifter Kit, TSA fitted.

Notice Number	Fault Code	Repair Code	Description	Repair Allowance	Time
568	011932992	995681	SB568 - Check for TSA	0.01 hours	
568	011932992	995682	SB568 - Remove and replace Clamp	0.08 hours	

## Genuine Parts Information

Notice Number	Part Number	Parts Kit Description	Quantity
568	T2085100	Linkage Clamp Assembly	1

## Parts Ordering Instructions

**For Triumph Subsidiary and Overseas Distributor dealers using Triumph Warranty On-Line with Parts Auto Ordering Flag switched on:** Order all repair parts by submitting a New Prior through the Warranty On-Line system. Entering the above repair code in a New Prior will automatically add the parts required and labour times for this Safety Recall Action Notice.

**For Overseas Distributor dealers NOT using Triumph Warranty On-Line or for Overseas Distributor dealers using Triumph Warranty On-Line with Parts Auto Ordering Flag switched off:** Orders should be placed using the normal parts ordering procedure.

## Genuine Parts Return

Dealer to retain parts for 90 days. All parts must be stored in a secure, non-public accessed area and correctly identified with a completed warranty label. Thereafter the parts must be rendered unusable prior to scrapping.

## Gear Linkage Clamp Assembly - Removal

### **Warning**

Make sure the motorcycle is stabilised and adequately supported.  
A correctly supported motorcycle will help prevent it from falling.  
An unstable motorcycle may fall, causing injury to the operator or damage to the motorcycle.

1. Remove the wire clip retaining the TSA shift force sensor front ball joint. Retain the wire clip for reuse.

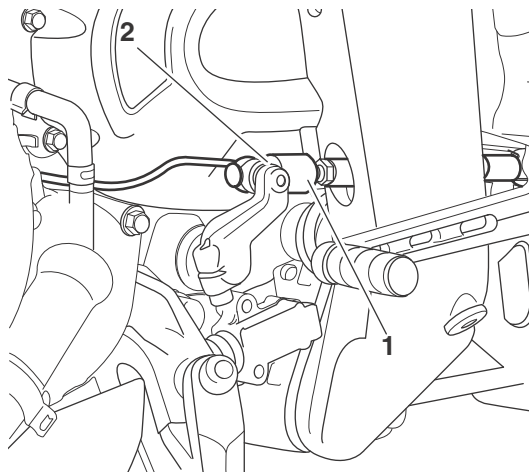

1. **TSA shift force sensor**
2. **Front wire clip position**

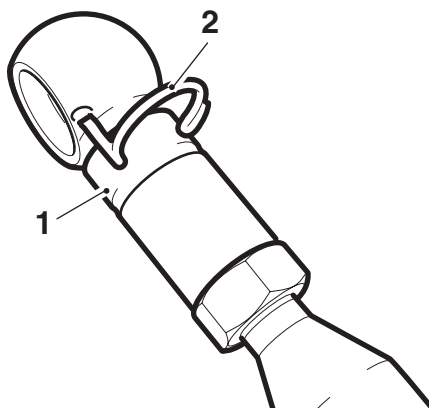

1. **TSA shift force sensor**
  2. **Wire clip**
2. Release the TSA shift force sensor from the gear linkage clamp assembly and allow the TSA shift force sensor to move rearwards and rest inside the frame.

- 
3. Remove and retain the gear linkage clamp assembly fixing. Remove the gear linkage clamp assembly (T2085085).

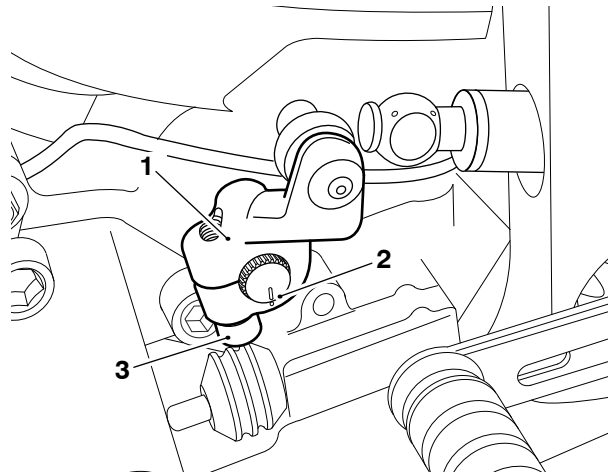

1. Gear linkage clamp assembly (T2085085)
2. Alignment marks
3. Fixing

#### Gear Linkage Clamp Assembly - Installation

1. Make sure the alignment mark on the gear shaft assembly aligns with the alignment mark on the gear linkage clamp assembly (T2085100) and install the clamp to the shaft.

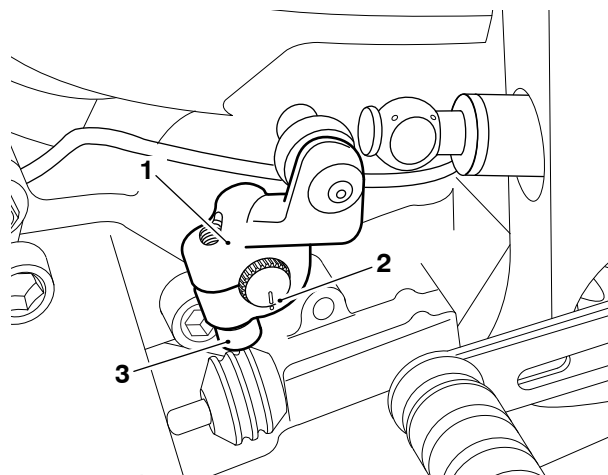

1. Gear linkage clamp assembly (T2085100)
  2. Alignment marks
  3. Fixing
2. Install the clamp fixing and tighten to **8 Nm**.

3. Make sure the ball joint is clean and free from debris and attach the TSA shift force sensor front ball joint to the gear linkage clamp assembly.

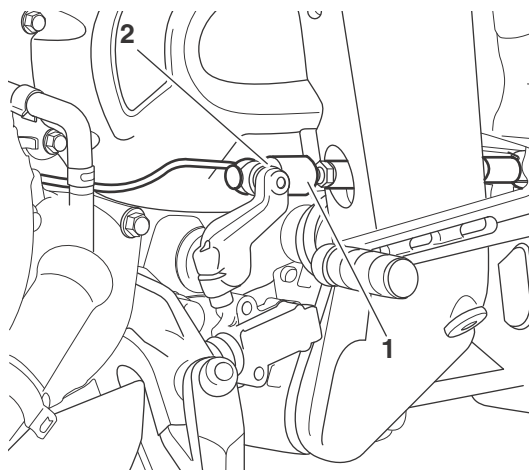

1. TSA shift force sensor
2. Front wire clip position

4. Refit the wire clip to retain the front ball joint. Make sure the wire clip locates correctly in the ball joint before rotating the clip to lock in place.

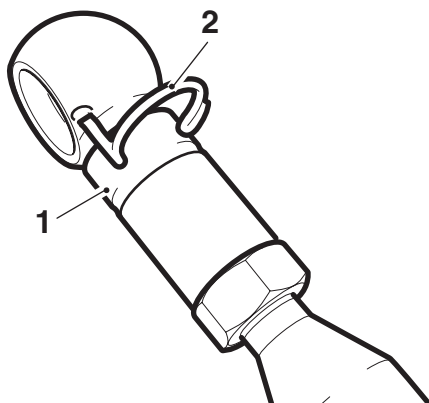

1. TSA shift force sensor
2. Wire clip

5. Make sure the gear change mechanism operates smoothly.

### Other Instructions

Once completed, please mark the Service Record Book that the requirements of this Safety Recall Action Notice have been complied with.

Before returning the motorcycle to the customer, download the latest calibration to the engine electronic control module, chassis electronic control module (if fitted), keyless electronic control module (if fitted) and instruments (if applicable) using the current version of the Triumph diagnostic software.

### Circulation

Initial and date when read and return to central file holder

Service Manager	Parts Manager	Sales Manager	Workshop Supervisor	Technician 1	Technician 2