 HYUNDAI Technical Service Bulletin	GROUP RECALL	NUMBER 18-01-030
	DATE SEPTEMBER, 2018	MODEL(S) SONATA (YF) SONATA HYBRID (YF HEV)
SUBJECT: 2011-2013 SONATA (YF) AND 2011-2012 SONATA HYBRID (YF HEV) AIRBAG CONTROL UNIT (RECALL CAMPAIGN 174)		

★ IMPORTANT

***** Retail Vehicles Only *****

Dealers must perform this Service Campaign whenever an affected vehicle is in the shop for any maintenance or repair.

When a vehicle arrives at the Service Department, access Hyundai Motor America's "Warranty Vehicle Information" screen via WEBDCS to identify open Campaigns.

Description:

Sonata (YF) and Sonata Hybrid (YF HEV) vehicles are equipped with an airbag control unit (or module) which detects collisions and commands deployment of the airbags and seat belt pretensioners as necessary. If the control unit's circuitry is damaged, the airbags and seat belt pretensioners may not deploy in some collisions where deployment is warranted, increasing the risk of injury.

This bulletin describes the procedure to install an airbag control unit wiring filter kit to prevent the damage to the control unit's circuitry.

Applicable Vehicles:

Certain 2011-2013MY Sonata (YF) vehicles produced from December 11, 2009 through August 31, 2012 by Hyundai Motor Manufacturing Alabama ("HMMA")

Certain 2011-2012MY Sonata Hybrid (YF HEV) vehicles produced from December 7, 2010 through September 4, 2012 by Hyundai Motor Company ("HMC")

SUBJECT: AIRBAG CONTROL MODULE (RECALL CAMPAIGN 174)

Parts Information:

Sonata (YF):

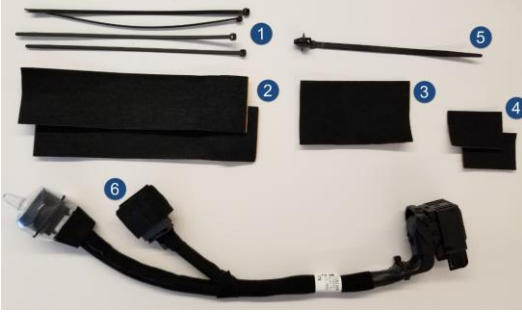
Part Name	Part Image	Part Number	Remarks																								
Wiring Filter Kit		91700-3S000QQH	<table border="1"> <thead> <tr> <th>NO</th> <th>PART</th> <th>EA</th> </tr> </thead> <tbody> <tr> <td>1</td> <td>BAND STRAP</td> <td>4</td> </tr> <tr> <td>2</td> <td>PAD</td> <td>200x50mm</td> <td>2</td> </tr> <tr> <td>3</td> <td>PAD</td> <td>100x60mm</td> <td>1</td> </tr> <tr> <td>4</td> <td>PAD</td> <td>50x35mm</td> <td>2</td> </tr> <tr> <td>5</td> <td>BAND CABLE</td> <td>1</td> </tr> <tr> <td>6</td> <td>DIODE MODULE</td> <td>1</td> </tr> </tbody> </table>	NO	PART	EA	1	BAND STRAP	4	2	PAD	200x50mm	2	3	PAD	100x60mm	1	4	PAD	50x35mm	2	5	BAND CABLE	1	6	DIODE MODULE	1
NO	PART	EA																									
1	BAND STRAP	4																									
2	PAD	200x50mm	2																								
3	PAD	100x60mm	1																								
4	PAD	50x35mm	2																								
5	BAND CABLE	1																									
6	DIODE MODULE	1																									

Sonata Hybrid (YF HEV):

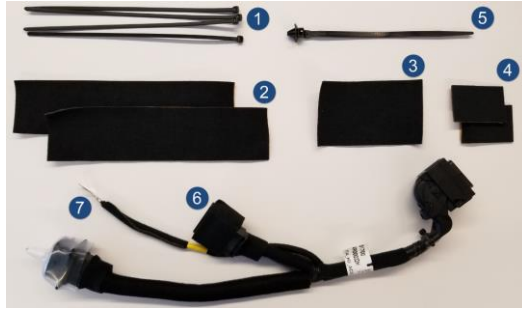
Part Name	Part Image	Part Number	Remarks																											
Wiring Filter Kit		91700-4R000QQH	<table border="1"> <thead> <tr> <th>NO</th> <th>PART</th> <th>EA</th> </tr> </thead> <tbody> <tr> <td>1</td> <td>BAND STRAP</td> <td>4</td> </tr> <tr> <td>2</td> <td>PAD</td> <td>200x50mm</td> <td>2</td> </tr> <tr> <td>3</td> <td>PAD</td> <td>100x60mm</td> <td>1</td> </tr> <tr> <td>4</td> <td>PAD</td> <td>50x35mm</td> <td>2</td> </tr> <tr> <td>5</td> <td>BAND CABLE</td> <td>1</td> </tr> <tr> <td>6</td> <td>DIODE MODULE</td> <td>1</td> </tr> <tr> <td>7</td> <td>GROUND EXTENSION WIRING</td> <td>1</td> </tr> </tbody> </table>	NO	PART	EA	1	BAND STRAP	4	2	PAD	200x50mm	2	3	PAD	100x60mm	1	4	PAD	50x35mm	2	5	BAND CABLE	1	6	DIODE MODULE	1	7	GROUND EXTENSION WIRING	1
NO	PART	EA																												
1	BAND STRAP	4																												
2	PAD	200x50mm	2																											
3	PAD	100x60mm	1																											
4	PAD	50x35mm	2																											
5	BAND CABLE	1																												
6	DIODE MODULE	1																												
7	GROUND EXTENSION WIRING	1																												

Tools & Equipment Required:

Tool Name	Image
Clip/Trim Tool	

Warranty Information:

Model	Op. Code	Operation	Op. Time	Causal Part	Nature Code	Causal Code
Sonata (YF) Sonata Hybrid (YF HEV)	81C049R0	ACU MAIN WIRING HARNESS INSTALLATION	0.6 M/H	95910-3Q110	I11	ZZ3

NOTE 1: Submit Claim on Campaign Claim Entry Screen

NOTE 2: If a part is found in need of replacement while performing Recall 174 and the affected part is still under warranty, submit a separate claim using the same Repair Order. If the affected part is out of warranty, submit a Prior Approval Request for goodwill consideration prior to performing the work.

Wiring Preparation Procedure:

1. Lay the diode module (A) toward the main wiring connector (B).
2. Using one of the 200X50mm pads (C) from the wiring filter kit, wrap the diode module and the wiring (D) together.

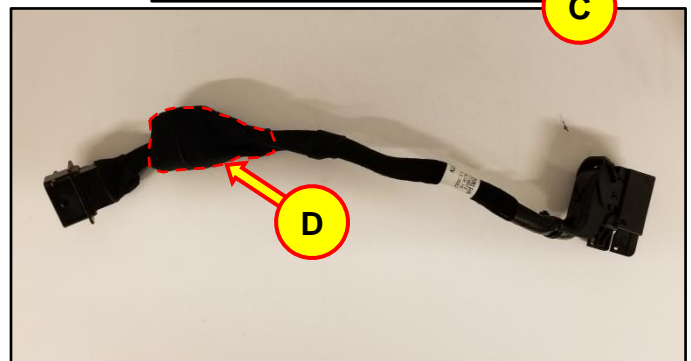
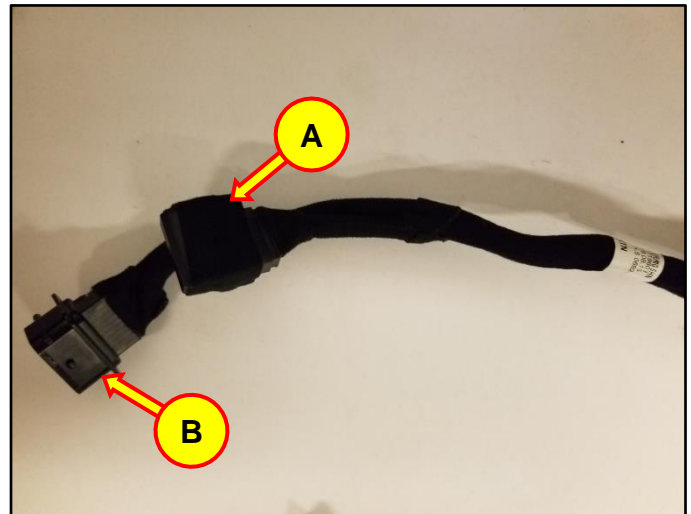

Service Procedure:

1. Record the customer's radio presets.
2. Apply the parking brake.
3. Place the ignition key in the 'OFF' position.
4. Remove the floor console (E) following procedures detailed in (Body (Interior and Exterior)) section of 2011-2014 Sonata Service Manual or 2011-2015 Sonata Hybrid Service Manual.

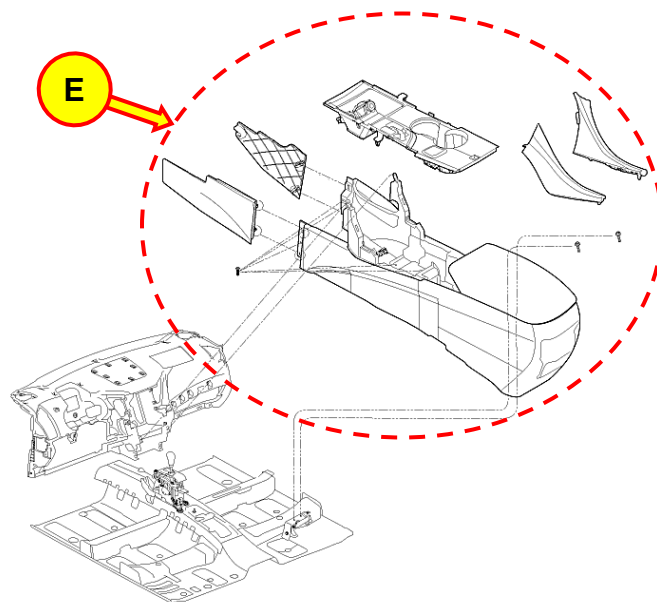

5. Open the hood (YF) or the trunk (YF HEV) and disconnect Negative (-) terminal (F) from the battery.

NOTICE

NOTE: Wait at least 3 minutes before proceeding to make sure voltage is discharged.

Negative battery terminal tightening torque:

4.0 ~ 6.0 N.m (0.4 ~ 0.6 kgf.m, 3.0 ~ 4.4lb-ft)

WARNING

Not removing the Negative (-) terminal from the battery may result in accidental airbag deployment and possible physical injury.



6. Remove the heater duct (G).

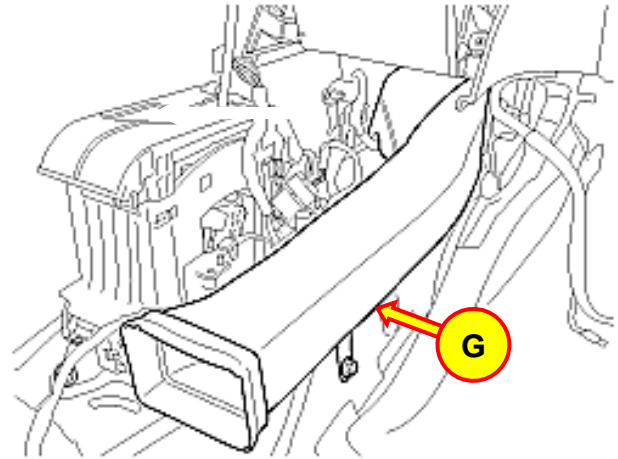

7. Carefully uninstall the mounting clip (H) on the LH connector wiring using a clip/trim tool.

NOTE: The mounting clip will be reused in Step 9.

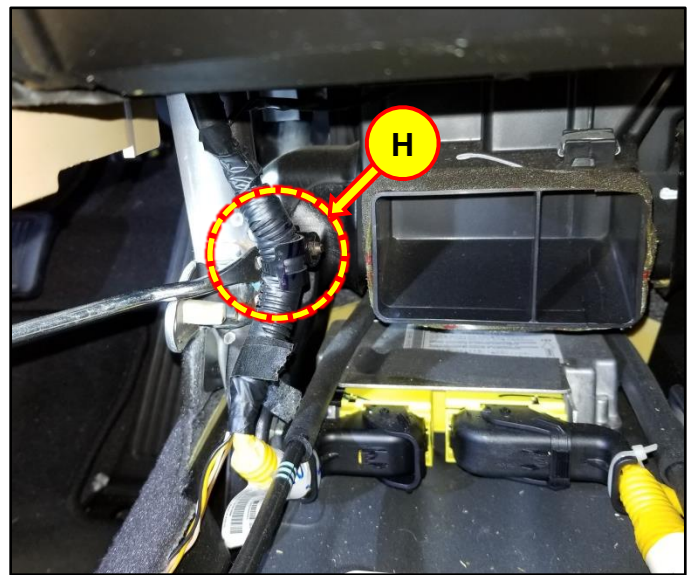

8. Carefully remove the mounting clip completely from the LH connector wiring by sliding the tab (I) inward.

NOTE: The mounting clip will be reused in the next step.

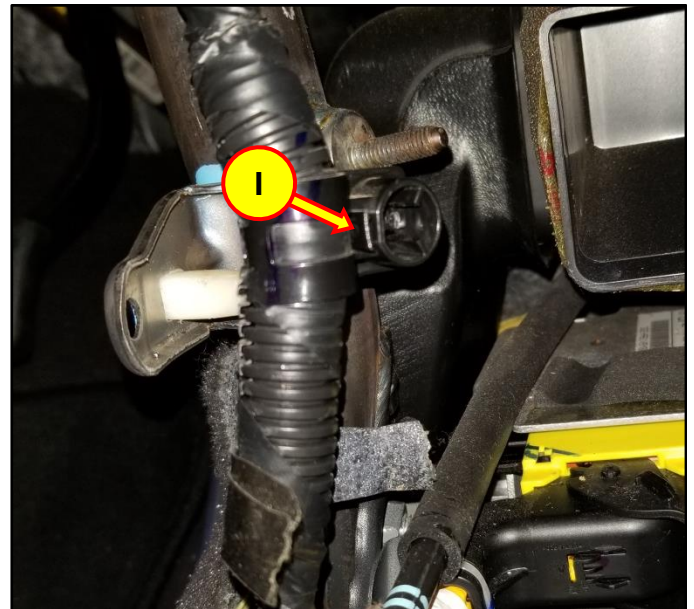

9. Rotate the mounting clip to face the opposite side (J) and reinstall the mounting clip.

NOTE : Mounting clip direction

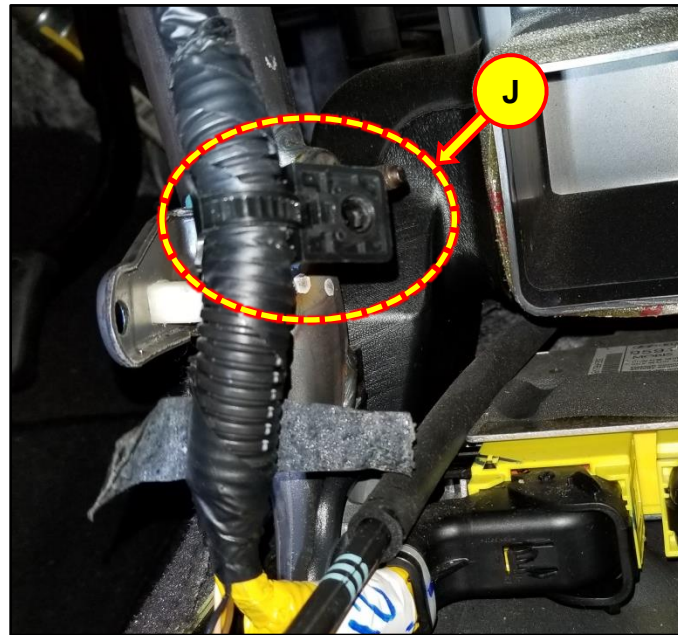
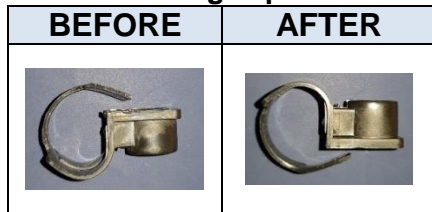

10. Install the mounting clip to the main wiring mounting terminal (K) and make sure the main wiring is located behind the mounting terminal.

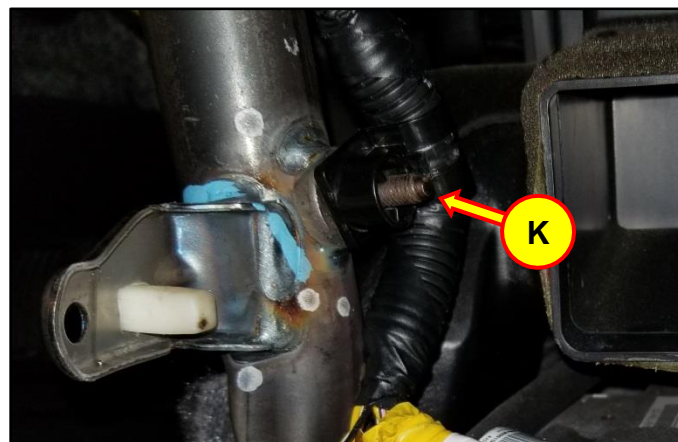

11. Disconnect the LH connector (L) of the main wiring.



SUBJECT: AIRBAG CONTROL MODULE (RECALL CAMPAIGN 174)

12. Gently move the LH connector above the cable assembly-ATM/MTM (M).

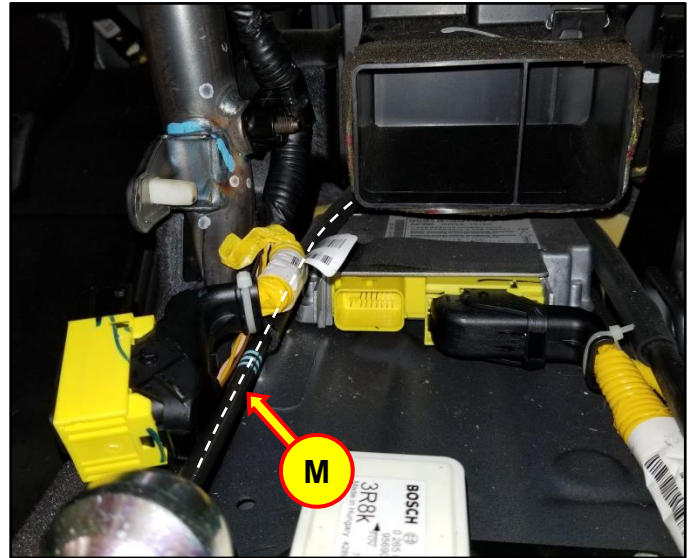

13. Connect and lock the Airbag Control Unit (ACU) connector (N) of the wiring filter kit to the ACU.



14. Install the main wiring connector (O) of the wiring filter kit to the LH connector of the main wiring (P).

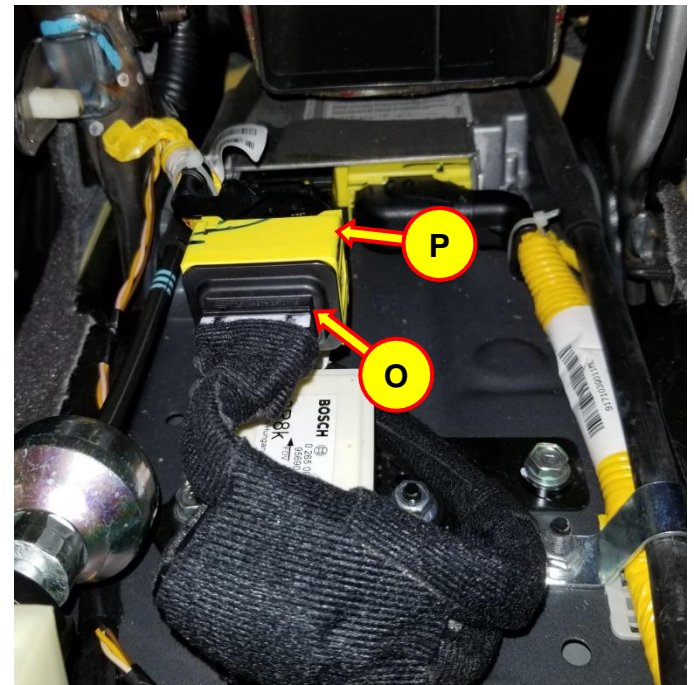

SUBJECT: AIRBAG CONTROL MODULE (RECALL CAMPAIGN 174)

15. Wrap the main wiring connector (Q) using the 200X50 mm pad (R).



16. Place the 100X60 mm pad (S) on the main wiring connector along the wiring (T).



17. Carefully move the wiring filter kit connection (without the ground extension wiring (U) intended for Sonata Hybrid Only) to store left (V) of the heater duct opening (W).

NOTE: The wiring filter kit connection must be stowed away from the heater duct opening to re-install the heater duct without any interference.

NOTICE

Ground Extension Wiring Installation for the Sonata Hybrid can be found on [Page 12](#).



SUBJECT: AIRBAG CONTROL MODULE (RECALL CAMPAIGN 174)

18. Install the band cable (X) from the wiring filter kit to the mounting hole (Y) and wrap around the wiring to keep it in place.

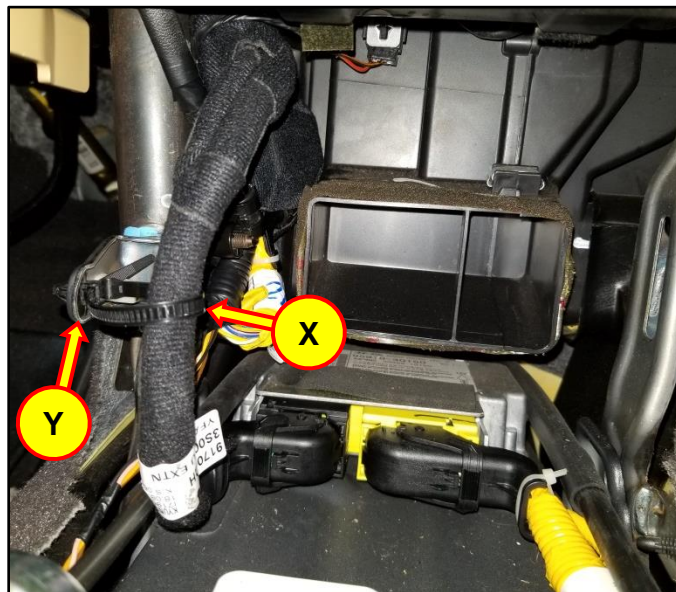

19. Tighten the band cable and trim the excess band cable (Z).

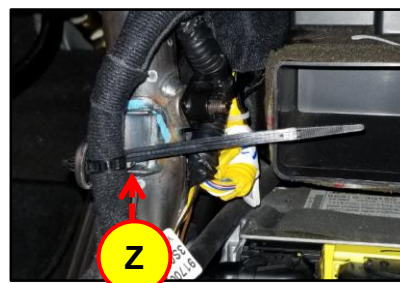

SUBJECT: AIRBAG CONTROL MODULE (RECALL CAMPAIGN 174)

20. Wrap the band cable and mounting hole using 2 (50X35mm) pads (AA) to prevent wiring interference.

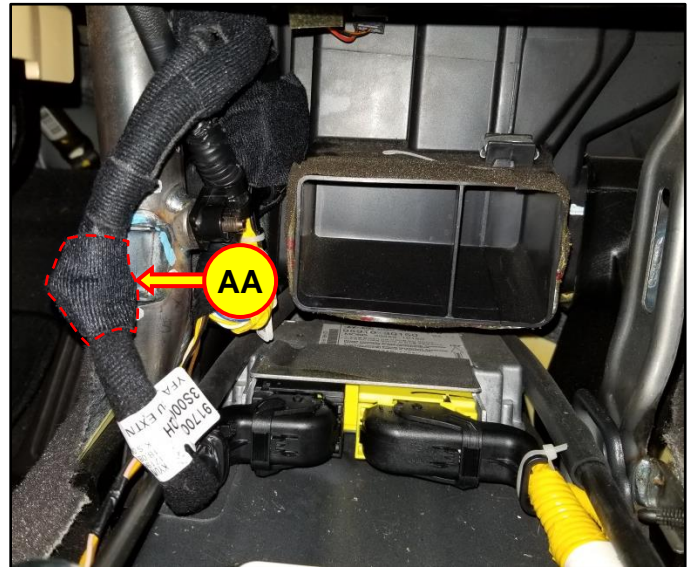
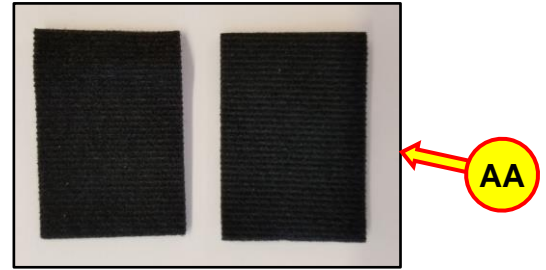

21. Gently tie the band strap(s) (AB) from the wiring filter kit around the wirings and the metal brace (AC) and trim the excess band strap(s).

Note: Use a necessary amount of the band straps in the wiring filter kit to keep the wiring in place.

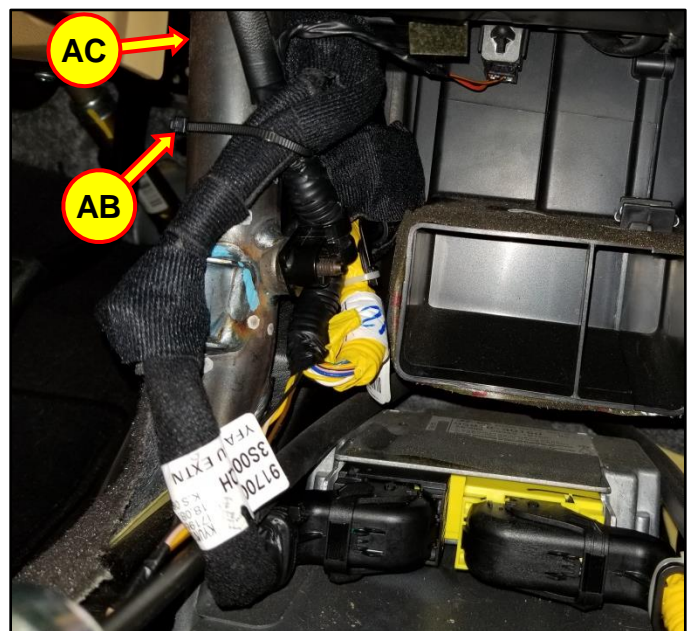

**Ground Extension Wiring
Installation,**
for Sonata Hybrid ONLY.

For Sonata,
***Proceed to Page 13, Step 25 for the
remaining procedures.**



22. Disconnect the ACU RH connector (AD).

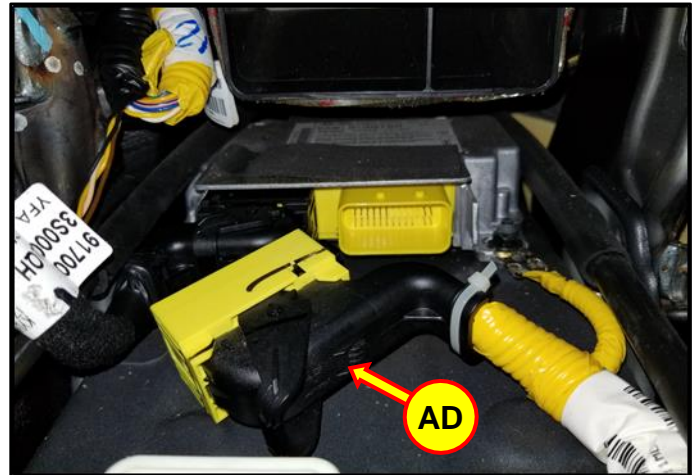

23. Uninstall the mounting bolt (AE) located next to the RH connector of ACU and install the ground extension wiring (AG) with the mounting bolt.

Tightening torque:
9.8 ~ 13.7 N.m (1.0 ~ 1.4 kgf.m, 7.2 ~ 10.1 lb-ft)



24. Connect the ACU RH connector (AH).



25. Reinstall the heater duct.
26. Reconnect the Negative (-) terminal to the battery.

**Negative battery terminal tightening torque:
4.0 ~ 6.0 N.m (0.4 ~ 0.6 kgf.m, 3.0 ~ 4.4lb-ft)**

27. Reinstall all removed components in reverse order of removal.
28. Check for any diagnostic trouble codes (DTC) and erase any DTC(s) present. Confirm no DTC(s) return after being erased.