

QUARTER PANEL AIRBAG SENSOR LH & RH NX300h/NX200t

*Illustrations only show the LH side.

REMOVAL

1. RECORD SETTINGS OF THE AUDIO SYSTEM, AIR CONDITIONER, ETC.

- For devices such as the audio system, air conditioner, etc, record current settings before disconnecting the negative battery cable.

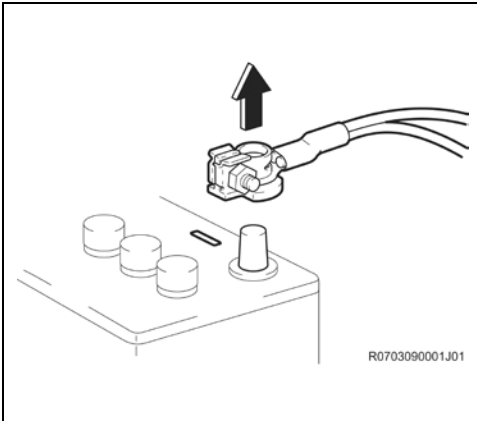

2. DISCONNECT NEGATIVE BATTERY CABLE



- Wait at least 90 seconds after disconnecting the cable from the negative battery terminal to prevent airbag and seat belt pretensioner deployment.
- For models with a HDD navigation system, wait at least 6 minutes before disconnecting the battery. It takes approximately 6 minutes for the system to save information and settings after the engine switch is turned off.
- Follow all precautions as outlined on TIS before servicing the SRS system.

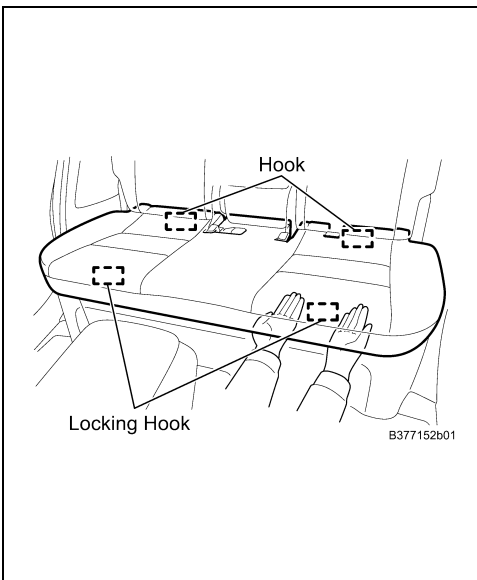

3. REMOVE REAR SEAT CUSHION

- Lift the front edge of the rear seat cushion and disengage the 2 locking hooks. (Locking hooks may be difficult to disengage)



If you DO NOT lift near the locking hook, the cushion frame may be deformed.

- Disengage the 2 hooks on the rear edge of the rear seat cushion frame.
- Remove the rear seat cushion.



Be careful not to damage the seat cushion, vehicle body, and vehicle interior parts.

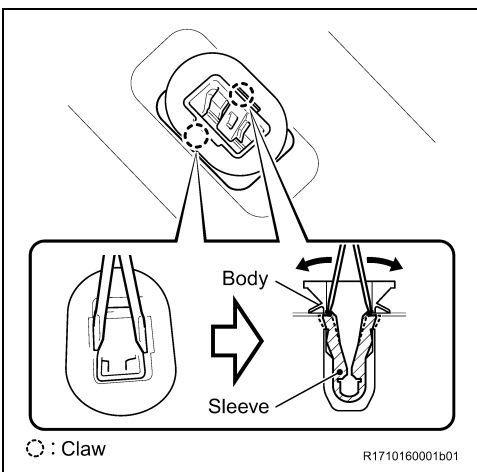

4. REMOVE REAR SEAT CUSHION LOCK

- Insert 2 thin flathead screwdrivers between the sleeve of the locking hook and the body as shown in the illustration
- Raise the 2 thin flathead screwdrivers to disengage the 2 claws and remove the locking hook
- Mark and store the removed locking hook in a separate container so as not to reinstall in error



DO NOT REINSTALL THE ORIGINAL SEAT CUSHION LOCK.

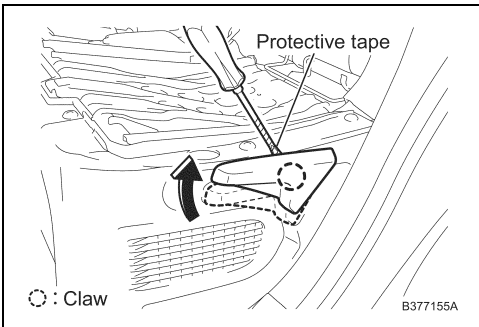

5. REMOVE RECLINING ADJUSTER RELEASE HANDLE (FOR MANUAL SEAT)

- d. Raise and hold the release handle.
- e. Use a thin flathead screwdriver wrapped in protective tape to disengage the claw.
- f. Protect the metal handle with a shop towel and protective tape.

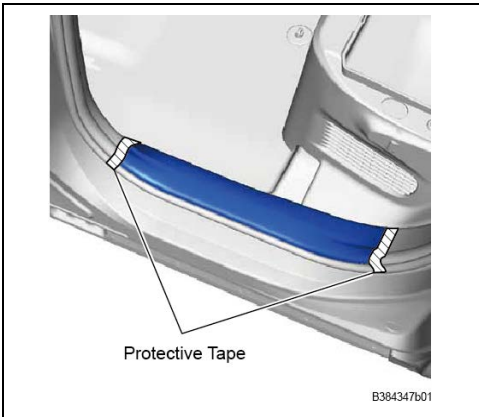

6. REMOVE REAR DOOR SCUFF PLATE

- a. Apply protective tape around the rear door scuff plate.

b. Disengage claw A, claw B, and the guide by pulling in the directions shown below.

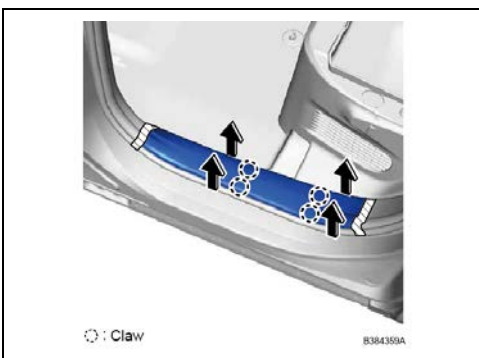
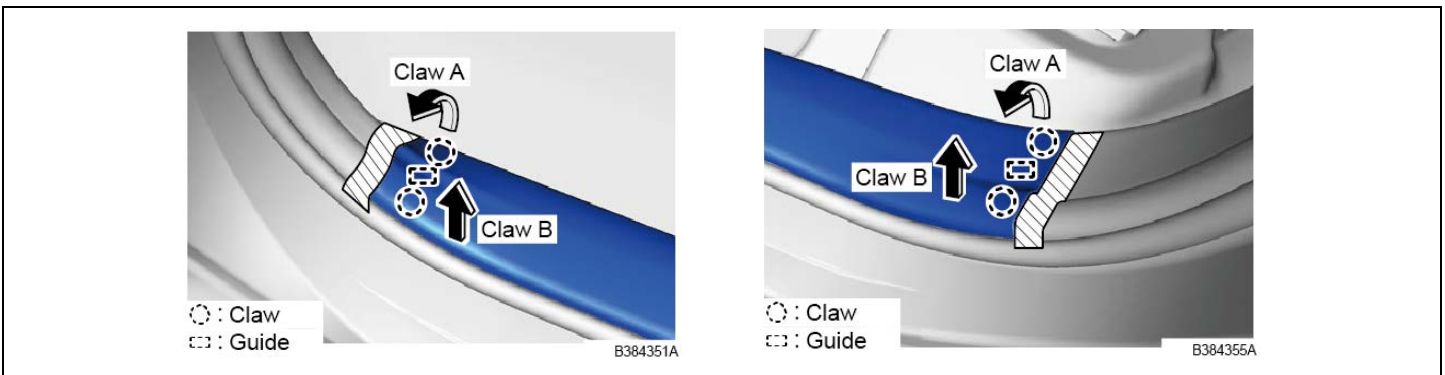

- c. Disengage the 4 claws by pulling the rear door scuff plate straight up.

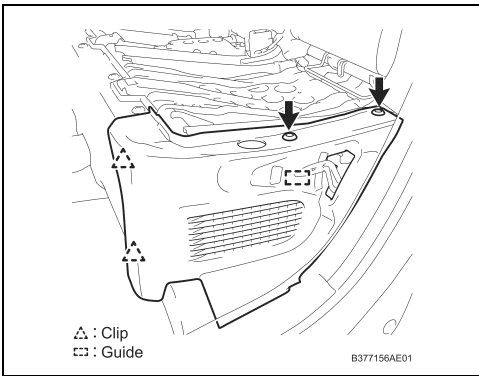

7. REMOVE BATTERY SERVICE COVER

- a. Remove the 2 clips.
- b. Disengage the 2 clips and guide to remove the battery service cover.

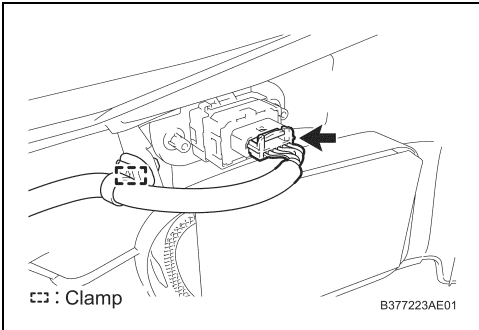

- c. Disengage the clamp and disconnect the connector for the power seat.

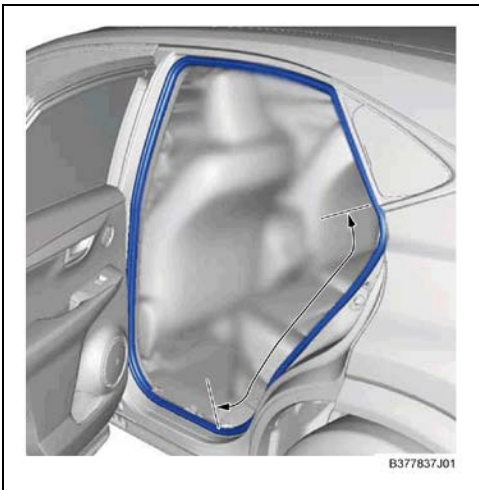

8. REMOVE REAR DOOR WEATHERSTRIP

- a. Only remove the weatherstrip between the arrows shown in the illustration.

9. REMOVE QUARTER PANEL AIR BAG SENSOR

- a. Disengage the 2 clamps and lift the side trim panel so the quarter panel air bag sensor can be removed.

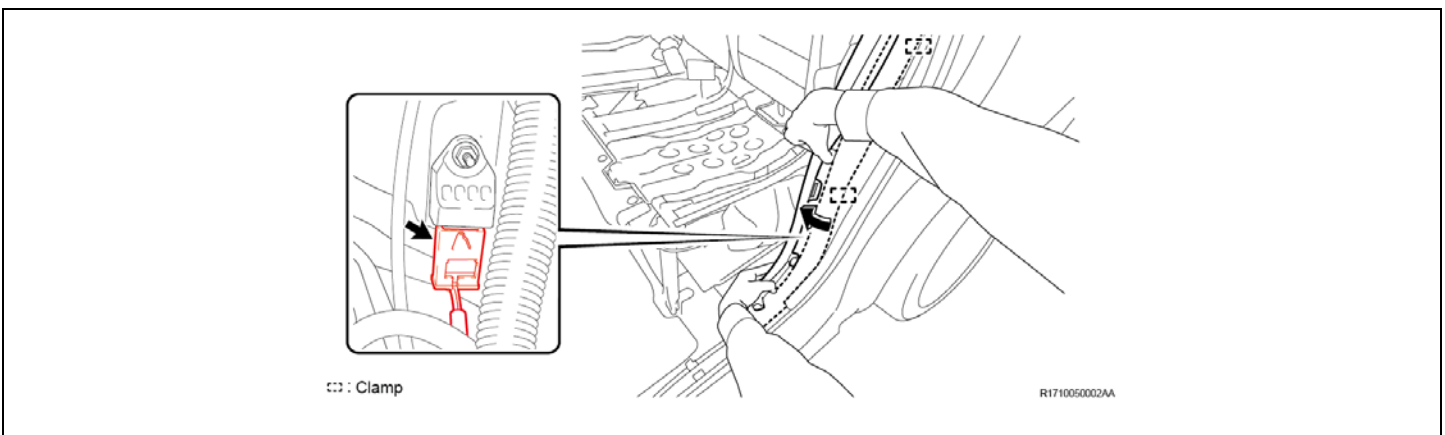

b. Disconnect the connector following the steps below.



- This special connector has a double locking mechanism and needs to be handled with care.
- DO NOT apply pressure on the wire harness.

- (1) To unlock the first lock, keep pushing down the white housing lock and then slide the yellow CPA towards the wire harness.
- (2) To unlock the second lock, keep pushing down the white housing lock again and disconnect the connector.

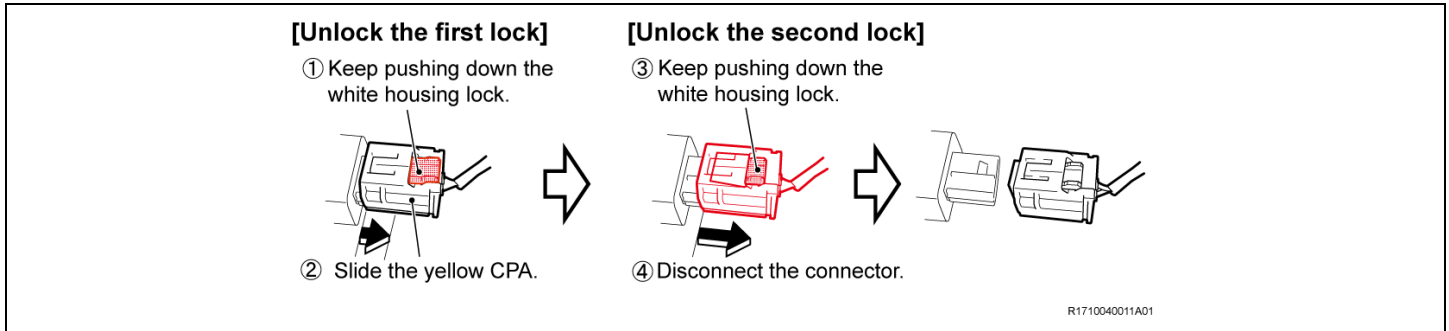

c. Remove the nut while holding the quarter panel air bag sensor.

d. Mark and store the removed quarter panel air bag sensor in a separate container.



If you DO NOT hold the sensor, it may be rotated together with the nut and the guide pin may be broken.

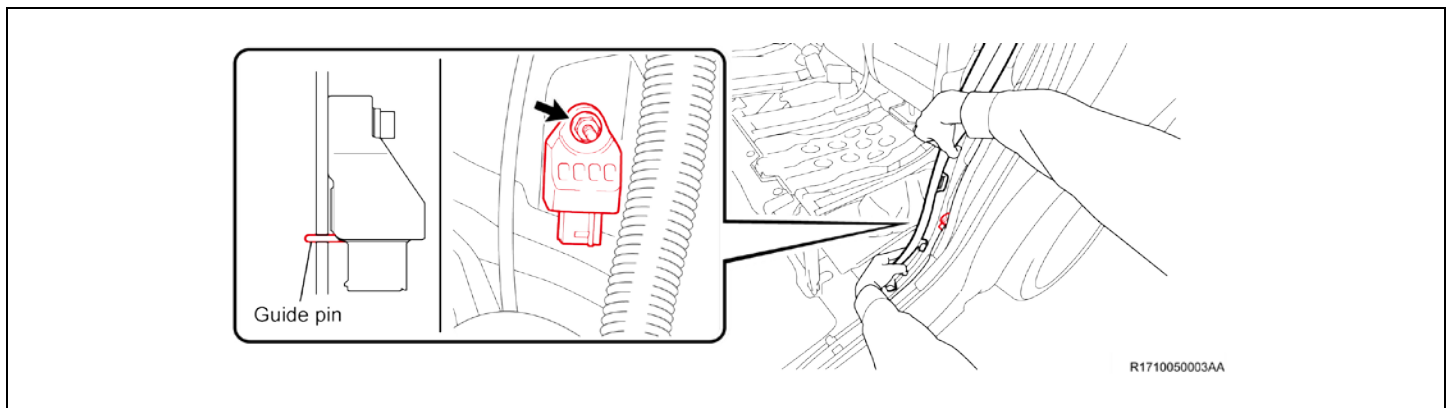

INSTALLATION

1. INSTALL A **NEW** QUARTER PANEL AIR BAG SENSOR

- Lift the side trim panel.
- Engage the guide pin of a **NEW** quarter panel air bag sensor and hold it in place.
- Install the nut.

Torque: 80 in.lb {9.0 N·m, 92 kgf·cm}



- DO NOT** use a sensor which has been affected by strong shocks such as being dropped.
- If you DO NOT** hold the sensor, it may be rotated together with the nut and the guide pin may be broken.

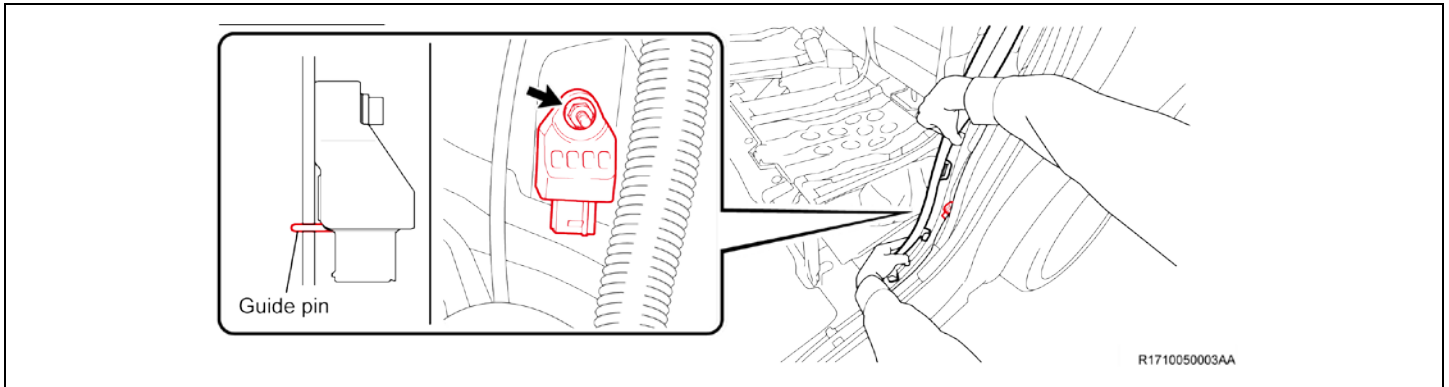

- Engage the connector of the **NEW** quarter panel air bag sensor holding the sides of its yellow CPA (a click sound can be heard).

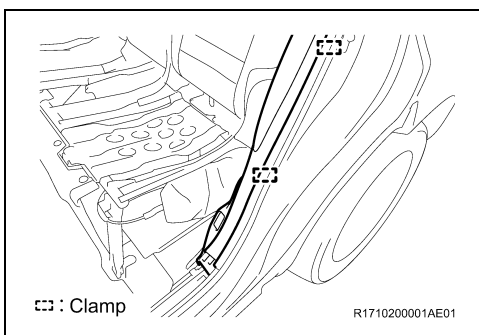
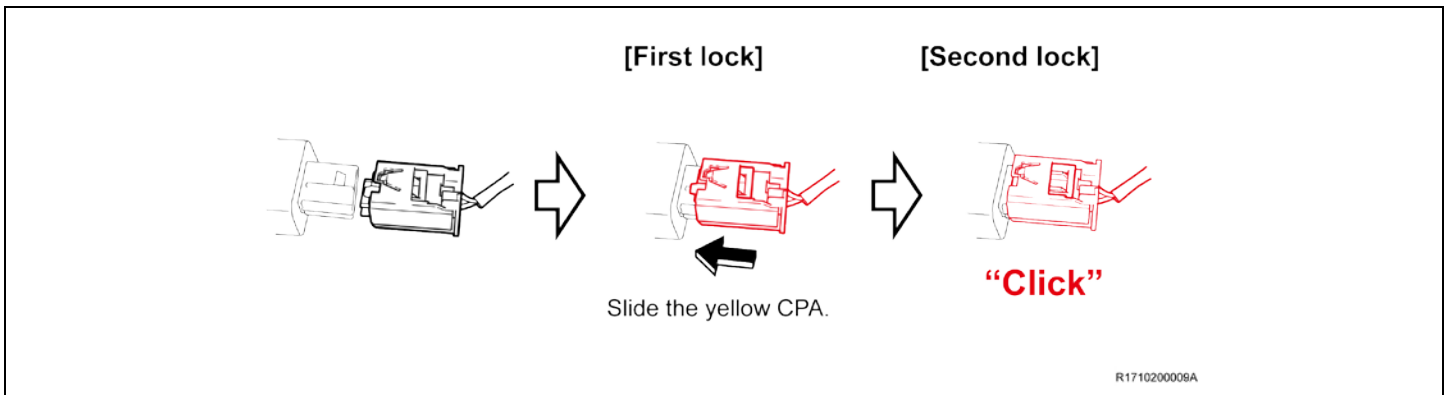

- Engage the 2 clamps to reinstall the side trim panel.

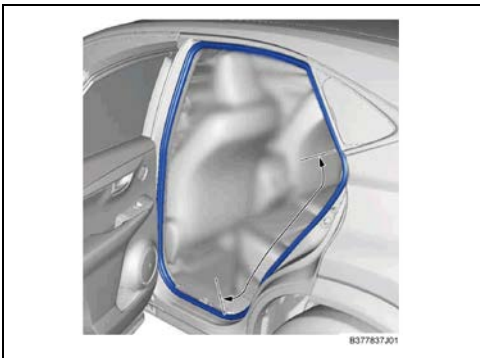

2. INSTALL REAR DOOR WEATHERSTRIP

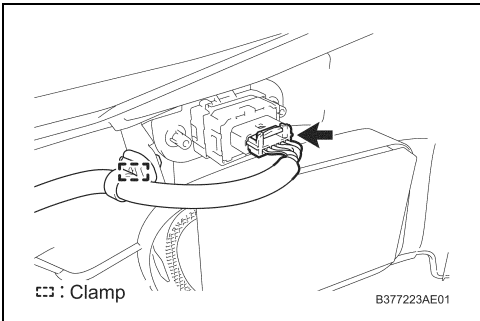

3. INSTALL BATTERY SERVICE COVER

a. Engage the clamp and reconnect the connector for the power seat.

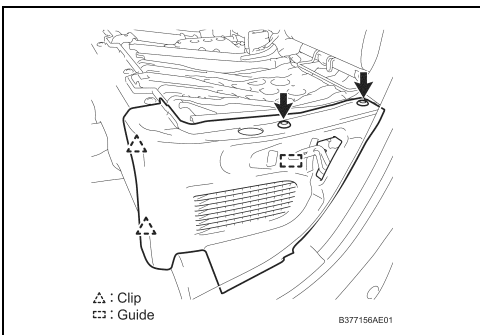

b. Engage the 2 clips and guide to install the battery service cover.

c. Install the 2 clips.



4. INSTALL REAR DOOR SCUFF PLATE

a. Engage the 2 guides and 8 claws to install the rear door scuff plate.

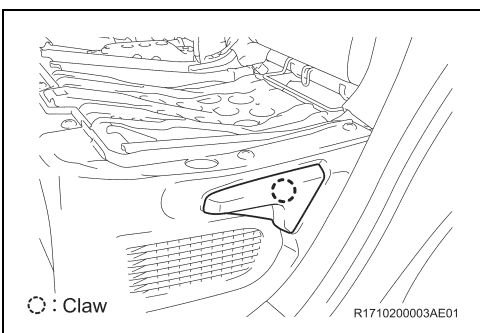

5. INSTALL RECLINING ADJUSTER HANDLE (FOR MANUAL SEAT)

a. Engage the claw to install the reclining adjuster handle.

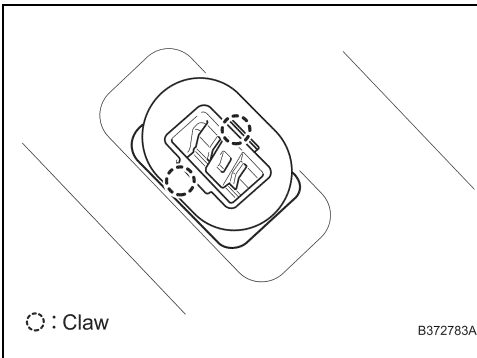

6. INSTALL *NEW* REAR SEAT CUSHION LOCK

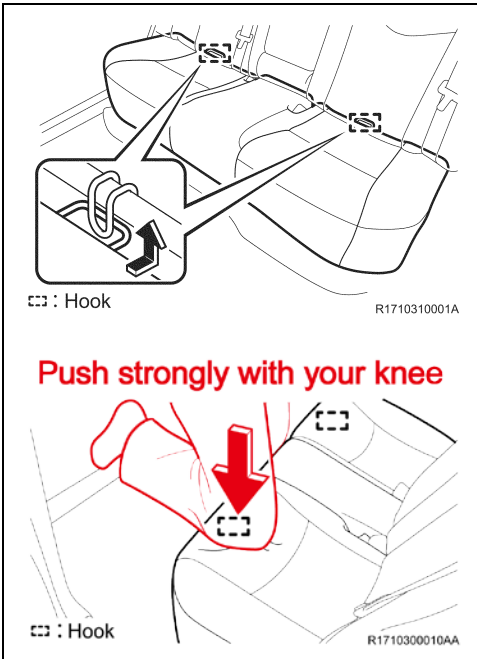

7. INSTALL REAR SEAT CUSHION

- a. Set the seatbelts in place on the rear seat cushion.

STOP DO NOT let the belts become twisted or caught.

- b. Engage the 2 hooks on the rear.
- c. Align the 2 hooks on the front of the seat cushion.
- d. Push straight down on the seat cushion to engage the hooks.

STOP Confirm that the hooks have been securely engaged by lifting the seat cushion.

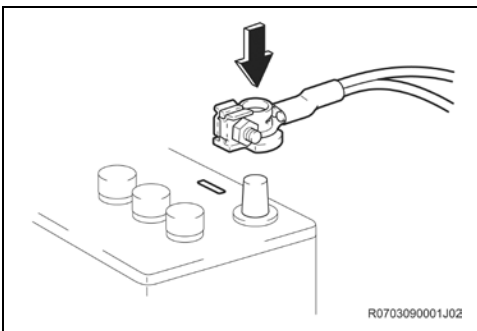

8. RECONNECT NEGATIVE BATTERY CABLE

9. INSPECT THE AIR BAG SENSORS USING THE JUDGMENT SOFTWARE

10. RESTORE VEHICLE

- a. Perform system initializations.