

CERTAIN 2011 MODEL YEAR FIESTA VEHICLES — BATTERY JUNCTION BOX CLEAN AND SEAL

OVERVIEW

In the affected vehicles, an opening between the Battery Junction Box (BJB) and its cover could allow water and debris containing road de-icing salts to enter into the BJB. This could result in corrosion inside the BJB, which may cause a variety of symptoms including loss of function of exterior lights, vehicle stall, vehicle no start, or loss of function of interior lights. Dealers are to clean and seal the BJB, and replace any damaged fuses or terminals as needed, following the Service Procedure and Terminal Repair Information.

Recommended Tool List:

1/4" Drive Ratchet
1/4" Drive 10mm Socket
1/4" Drive Torque Wrench
Pneumatic Blow Gun
Needle Nose Pliers
Pick Tools

SERVICE PROCEDURE

1. Disconnect the battery. Please use the Workshop Manual Procedures (WSM) in Section 414-01.



2. Remove the BJB cover and use compressed shop air to blow out any dirt and debris from the BJB.
See Figure 1.

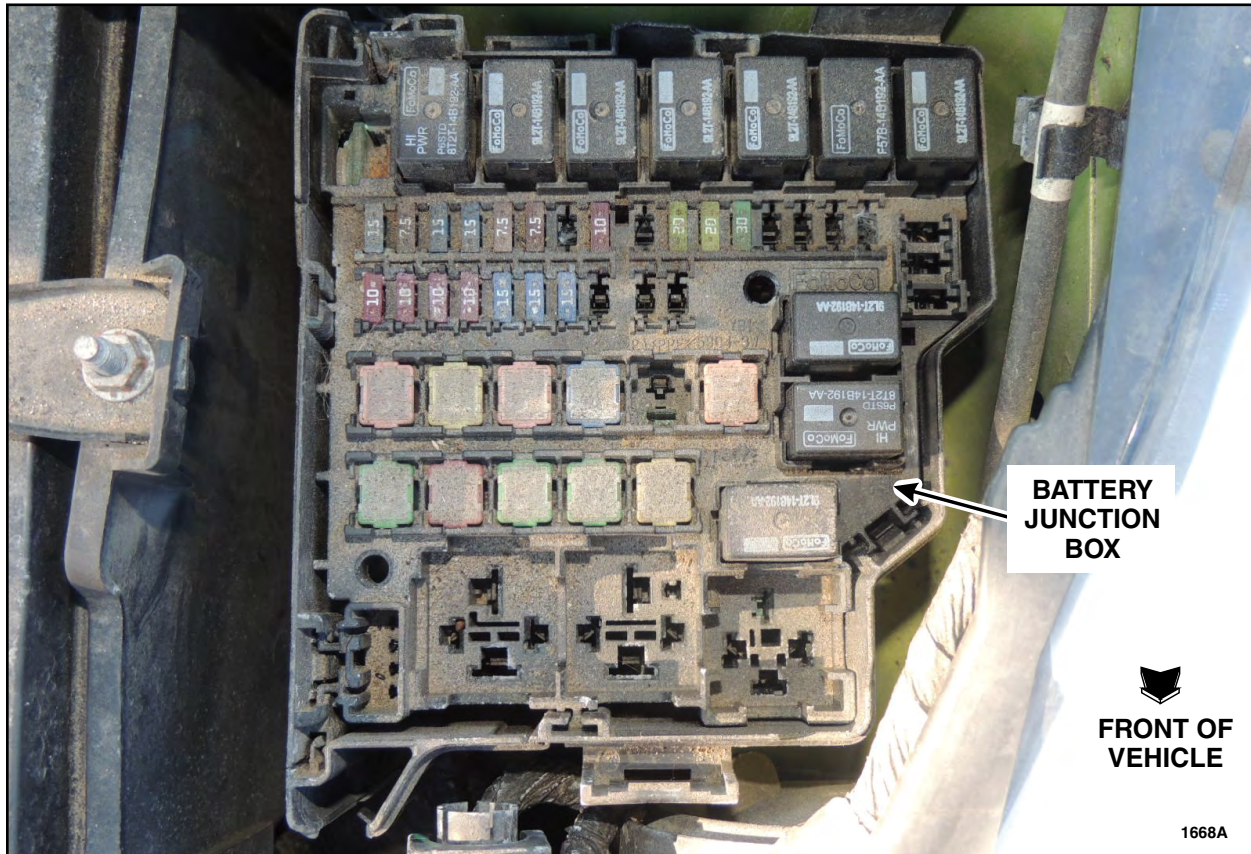

FIGURE 1



3. Remove each fuse and relay one at a time, apply Motorcraft® XG-12 to the cavity/terminal of the BJB, and re-install the fuse/relay. See Figure 2.

NOTE: Due to the metal composition of the mini-fuse, the mini-fuse acts as the sacrificial anode for corrosion, and usually results in fuse failure or separation during removal before damaging the BJB terminals.

- For mini-fuses that come apart during removal:
 - Remove any remaining fuse pieces, as necessary, from the BJB using needle nose pliers. See Figure 3.
 - Install a *new* fuse, as needed. Refer to the chart on Page 4 for mini-fuse part information.
- For box fuses or relays that become damaged during removal, replace as necessary. Refer to the chart on Page 4 for box fuse part information.

NOTE: One tube of Motorcraft® XG-12 electrical grease should service approximately seven vehicles. Do not add grease to unused or open terminals in the BJB.

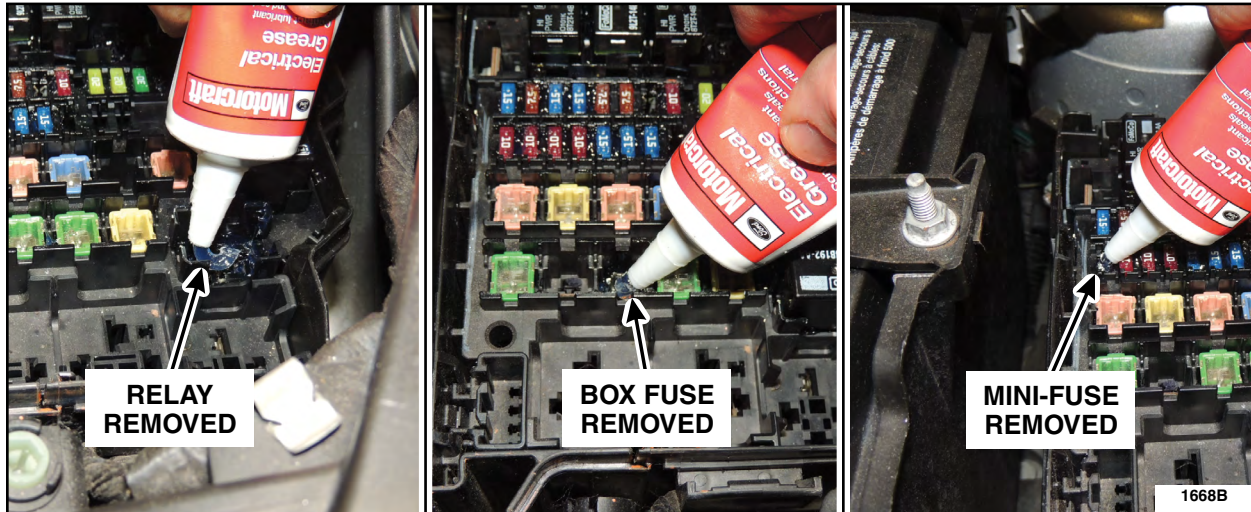

FIGURE 2

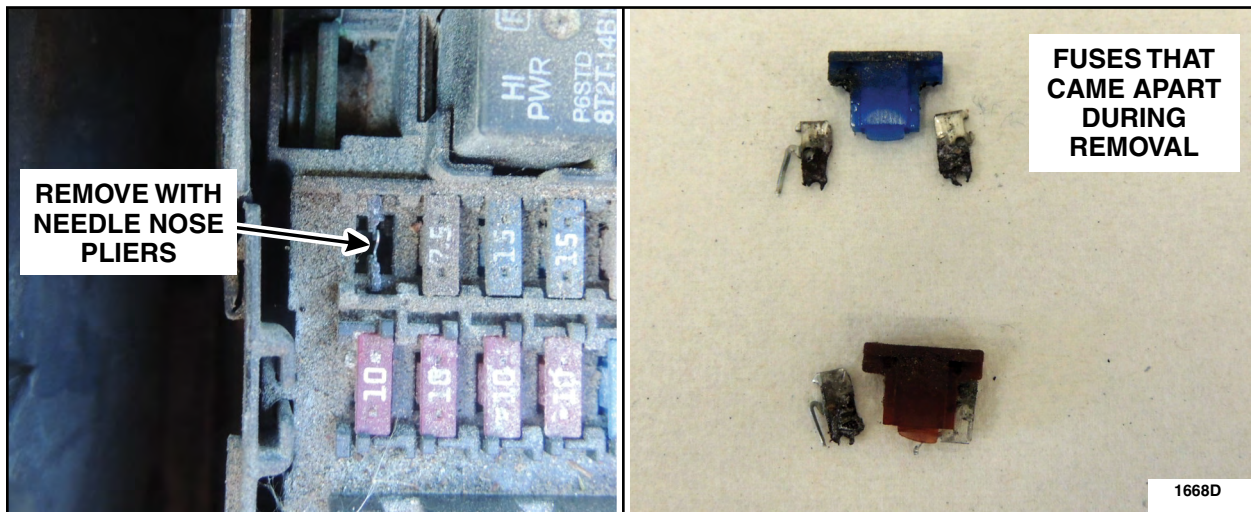

FIGURE 3



FUSE PART INFORMATION CHART			
Box Fuses (F1 - F11)		Mini-Fuses (F12 - F40)	
20 amp	6E5Z-14526-AA	2 amp	9L3Z-14526-HA
30 amp	6E5Z-14526-BA	5 amp	9L3Z-14526-AA
40 amp	6E5Z-14526-CA	7.5 amp	9L3Z-14526-BA
50 amp	6E5Z-14526-DA	10 amp	9L3Z-14526-CA
60 amp	6E5Z-14526-EA	15 amp	9L3Z-14526-DA
		20 amp	9L3Z-14526-EA
		25 amp	9L3Z-14526-FA
		30 amp	9L3Z-14526-GA

- Clean the inside cover of the BJB, as necessary, using a damp cloth or alcohol wipe to remove any dirt.
- Remove the backing and attach the individual pieces of the foam seal kit to the inside of the BJB cover in the specified locations. See Figure 4.

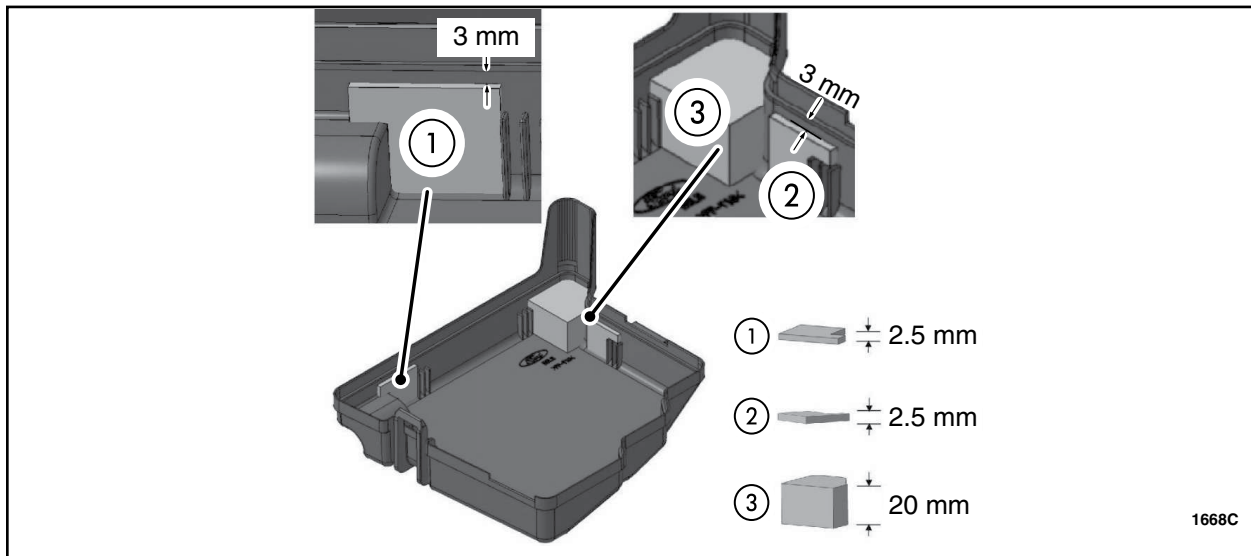

FIGURE 4

- Reinstall the BJB cover and verify the cover snaps in place.
- Connect the battery. Please use the WSM procedures in Section 414-01.

NOTE: For electrical concerns that are present after the service procedure is completed, refer to Attachment IV.

