

- ATTENTION:**
- GENERAL MANAGER
 - PARTS MANAGER
 - CLAIMS PERSONNEL
 - SERVICE MANAGER

IMPORTANT - All Service Personnel Should Read and Initial in the boxes provided, right.

© 2024 Subaru of America, Inc. All rights reserved.



QUALITY DRIVEN® SERVICE

SERVICE BULLETIN

APPLICABILITY: 2019-24MY Ascent
2020-24MY Outback & Legacy 2.4L

NUMBER: 09-130-25R

DATE: 02/11/25

SUBJECT: Exhaust Manifold Flange Nut / Torque & Design Change

REVISED: 06/03/26

INTRODUCTION:

This bulletin announces the design change made to the exhaust manifold flange nuts. The material has been changed from **stainless steel** to **medium carbon steel**. This change also necessitates a revised tightening torque specification. When replacement of the flange nuts is required, follow the part and service procedure information outlined in this bulletin.

PRODUCTION CHANGE INFORMATION:

The NEW flange nuts have been incorporated into vehicle production as per the VIN table below.

Model	Starting VIN
ASCENT	R3440123
OUTBACK	R3295292
LEGACY	R3028785

DESCRIPTION OF DESIGN CHANGE:

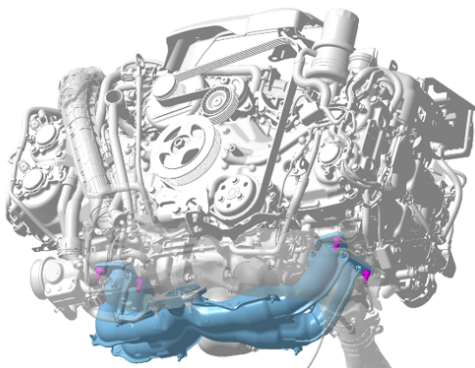

CAUTION: VEHICLE SERVICING PERFORMED BY UNTRAINED PERSONS COULD RESULT IN SERIOUS INJURY TO THOSE PERSONS OR TO OTHERS.

Subaru Service Bulletins are intended for use by professional technicians ONLY. They are written to inform those technicians of conditions that may occur in some vehicles, or to provide information that could assist in the proper servicing of the vehicle. Properly trained technicians have the equipment, tools, safety instructions, and know-how to do the job correctly and safely. If a condition is described, DO NOT assume that this Service Bulletin applies to your vehicle, or that your vehicle will have that condition.

Subaru of America, Inc. is ISO 14001 Compliant

ISO 14001 is the international standard for excellence in Environmental Management Systems. Please recycle or dispose of automotive products in a manner that is friendly to our environment and in accordance with all local, state and federal laws and regulations.

Continued...

PART INFORMATION:

REMINDER: Always order the most up-to-date replacement parts based on the specific VIN being repaired.

Part Name	Part Number
FLANGE NUT	902370029

NOTE: The new and old flange nuts should not be interchanged and always replaced as a set.

SERVICE PROCEDURE / INFORMATION:

The torque procedure has been changed from a one-time torque of 65 Nm (6.6 kgf-m, 47.9 ft-lbs) to a two-step procedure with an initial torque of 55 Nm (5.6 kgf-m, 40.6 ft-lbs) then a final torque of 65 Nm (6.6 kgf-m, 47.9 ft-lbs). A section of the Service Manual is pictured below. The added service procedure (4.) has been outlined in **RED** and will be added to the applicable Service Manual in the future.

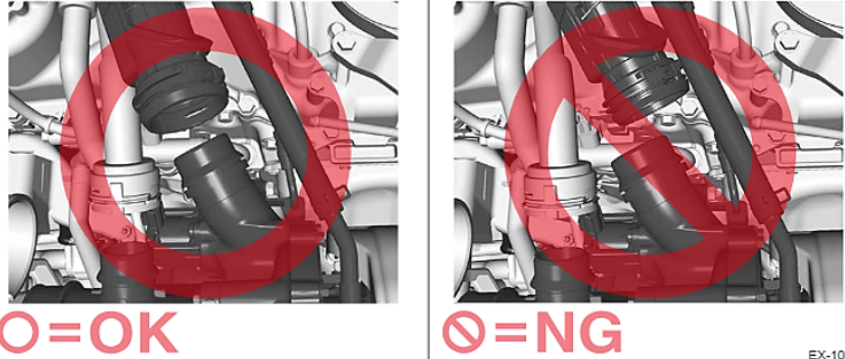

O=OK **X=NG**

EX-10383

4. Tighten the nuts in the numerical order as shown in the figure.
Tightening torque:
55 N·m (5.6 kgf-m, 40.6 ft-lb)

5. Tighten the nuts again in the numerical order as shown in the figure.
Tightening torque:
65 N·m (6.6 kgf-m, 47.9 ft-lb)

Added Step

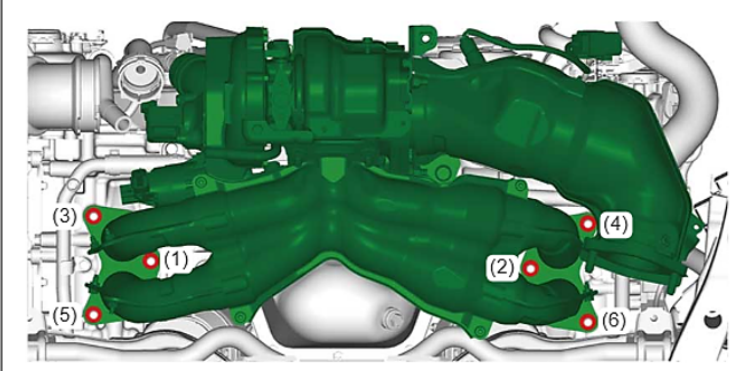

EX-10326

WARRANTY / CLAIM INFORMATION:

There have been no changes made to the Labor Time Guide for this repair.

Continued...

IMPORTANT REMINDERS:

- SOA strongly discourages the printing and/or local storage of service information as previously released information and electronic publications may be updated at any time.
- Always check for any open recalls or campaigns anytime a vehicle is in for servicing.
- Always refer to STIS for the latest service information before performing any repairs.