

General Service Bulletin (GSB):	All - Wheel Drive PTU Sealing
GSB Overview:	This bulletin is intended to assist with the diagnosis and repair of All-wheel Drive Power Transfer Unit (PTU)-related fluid leaks.
NOTE: This information is not intended to replace or supersede any warranty, parts and service policy, Work Shop Manual (WSM) procedures or technical training or wiring diagram information.	

Contents:

2007-Current Vehicles with a 6F50/55 Transmission
and
2008-2012 Vehicles with an Aisin AW21 Transmission _____ Page 2

2009-2012 Escape with a 6F35 Transmission _____ Page 4

2010-2012 Fusion with a 6F35 Transmission _____ Page 6

2013-Current Vehicles with 6F35 Transmission _____ Page 8

All-Wheel Drive PTU Sealing

2007– Current Vehicles with 6F50/55 Transmission

2008 – 2012 Vehicles with Aisin AW21 Transmission

Input Shaft Seals- 7H469-A
Prevents transmission fluid from leaking into the PTU, and PTU fluid from leaking into the transmission.

Intermediate Shaft Seal- Prevents
transmission fluid from leaking out of the right side of the PTU. Serviced with the 7275-B Kit.

Cover Seal-7R284-
Prevents PTU fluid from leaking out of the right side of the PTU.

Compression Seal- 7H469-B (7086)
Prevents transmission fluid from leaking out between the PTU case and the transmission case.

Deflector-7H459- Reduces the likelihood of cover seal and intermediate shaft seal damage from external debris. Included with the 7275-B kit.

—PTU Fluid
—Transmission Fluid

PTU Output Shaft

Output Shaft Seal Kit 7275-A
Prevents PTU leakage from rear of PTU. Kit includes Seal, collapsible spacer, and pinion nut.

Output Shaft Pinion Flange - 7B214-
Service only required if damaged.
Comes with a deflector

2007 - Current Edge/MKX

2008 - Sable

2008 - 2009 Taurus X

2008 - Current Taurus

2009 - Current Flex, MKS

2010 - Current MKT

2011 - Current Explorer

2013 - Current MKZ (3.7L only)

2008 - 2012 Fusion, Milan, MKZ (with Aisin AW21 transmission)

All-Wheel Drive PTU Sealing

2007 – Current Vehicles with 6F50/55 Transmission

2008 – 2012 Vehicles with Aisin AW21 Transmission

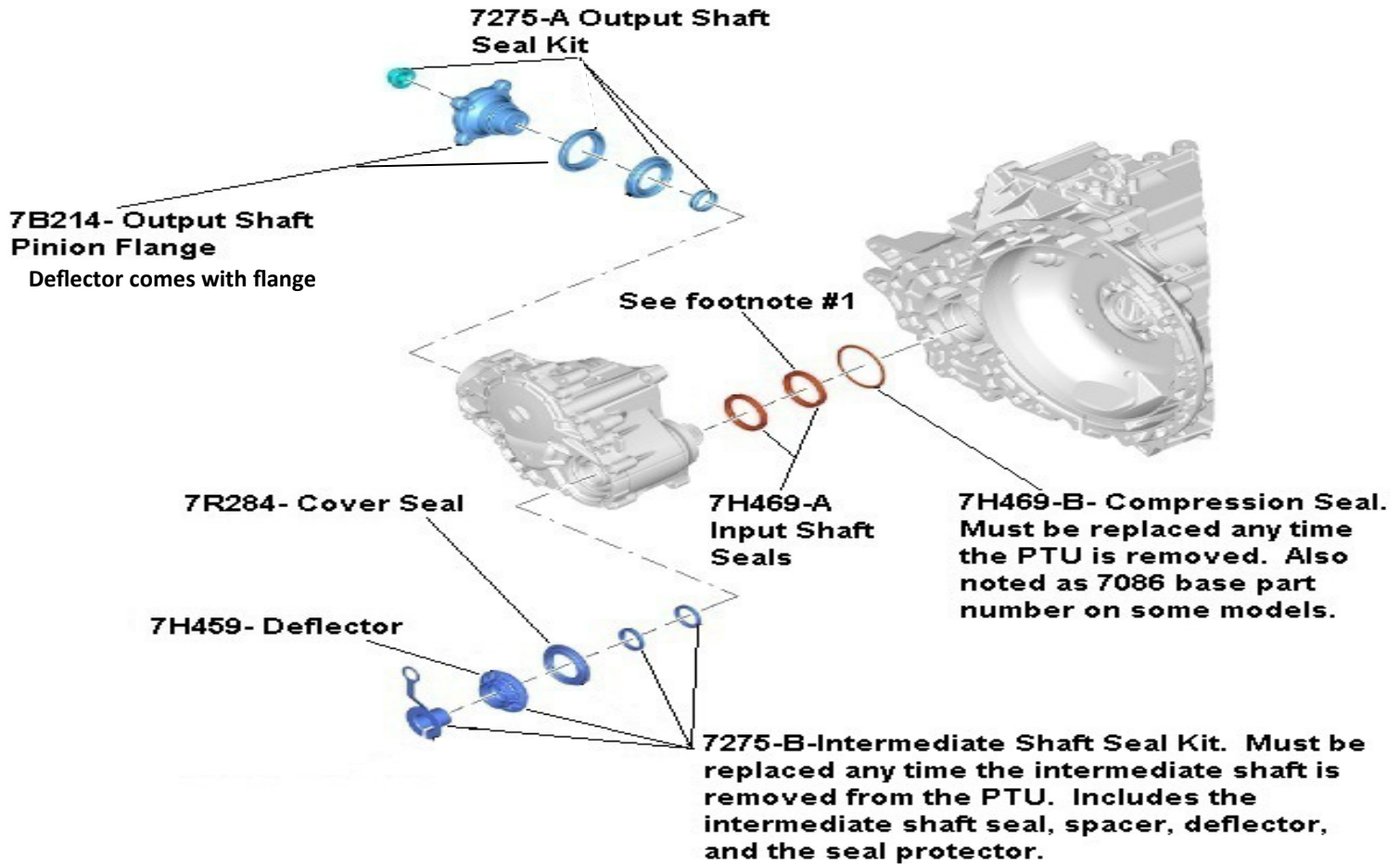

Seal Name	Base Part Number	Fluid Leak	Location of Leak	PTU Removal Required for Replacement	Other PTU Seals Required for Re - placement	Labor Operation
Intermediate Shaft Seal	7275B kit		Right side of the PTU	No	None	7275B
Cover Seal	7R284 (3)		Right side of the PTU	No	7275B Kit	7275C
Deflector	7H459		None	No	7275B Kit	7275B
Input Shaft Seal	7H469		Transmission fluid leaks into PTU ⁽²⁾	Yes	7086, 7275B Kit	7003B+ 7003B6
Output Shaft Seal	7275A kit		Rear of PTU	No	None	7275A
Compression Seal	7086/7H469B		Between PTU and Transmission	Yes	7275B Kit	7003B

(1) This seal omitted from vehicles with Aisin AW21 transmission.

(2) Typically results in fluid coming out of PTU vent.

(3) See Catalog. Part of 7275B kit on some vehicles.

All-Wheel Drive PTU Sealing

2009 – 2012 Escape with 6F35 Transmission

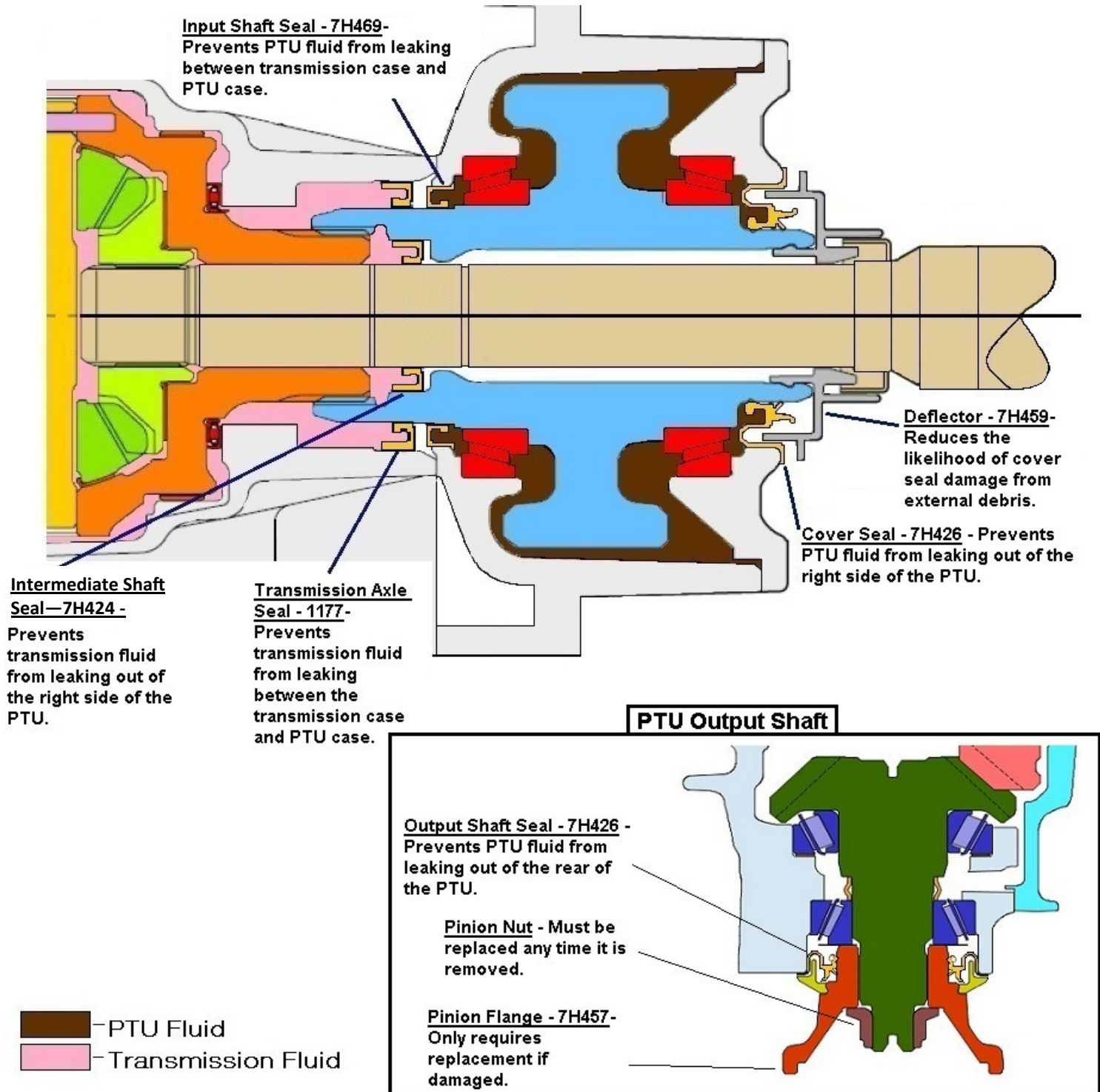

2009 – 2012 Escape 2.5L, 3.0L

All-Wheel Drive PTU Sealing

2009 – 2012 Escape with 6F35 Transmission

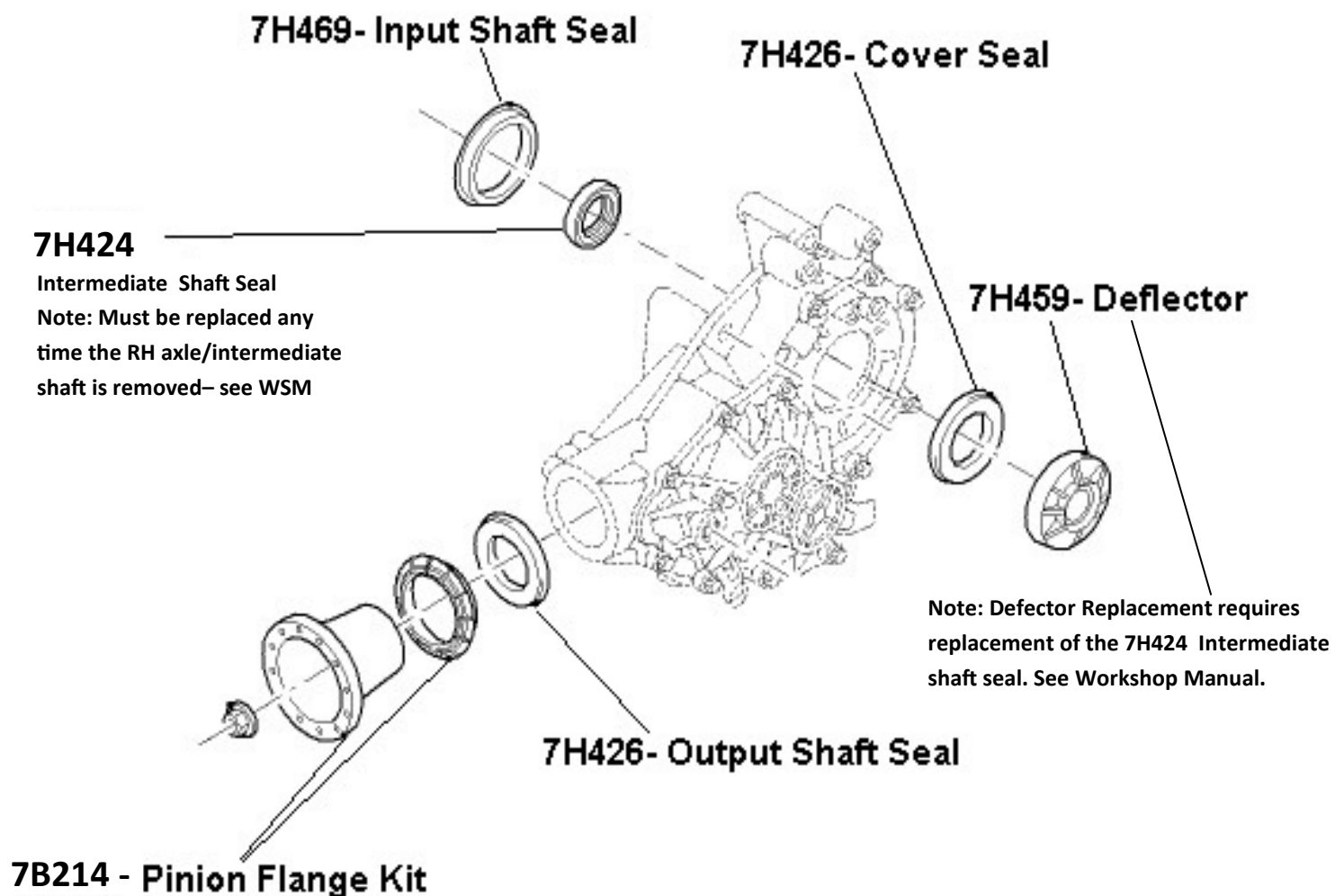

Seal Name	Base Part Number	Fluid Leak	Location of Leak	PTU Removal Required for Replacement	Other PTU Seals Required for Replacement	Labor Operation
Intermediate Shaft Seal	7H424		Right side of PTU	Yes	None	7003B+ 7003B3
Cover Seal	7H426		Right side of PTU	Yes	7H459+7H424	7003B+ 7003B4
Deflector	7H459		None	No	7H424	7003B + 7003B4
Input Shaft Seal	7H469		Between PTU and Transmission ⁽¹⁾	Yes	7H424	7003B+ 7003B6
Output Shaft Seal	7H426		Rear of PTU	No	None	7275A
Transmission Axle Seal	1177		Between PTU and Transmission	Yes	7H424	7003B

1 - PTU disassembly required to replace the input shaft seal. Refer to WSM, Section 308-07.

All-Wheel Drive PTU Sealing

2010-2012 Fusion with a 6F35 Transmission

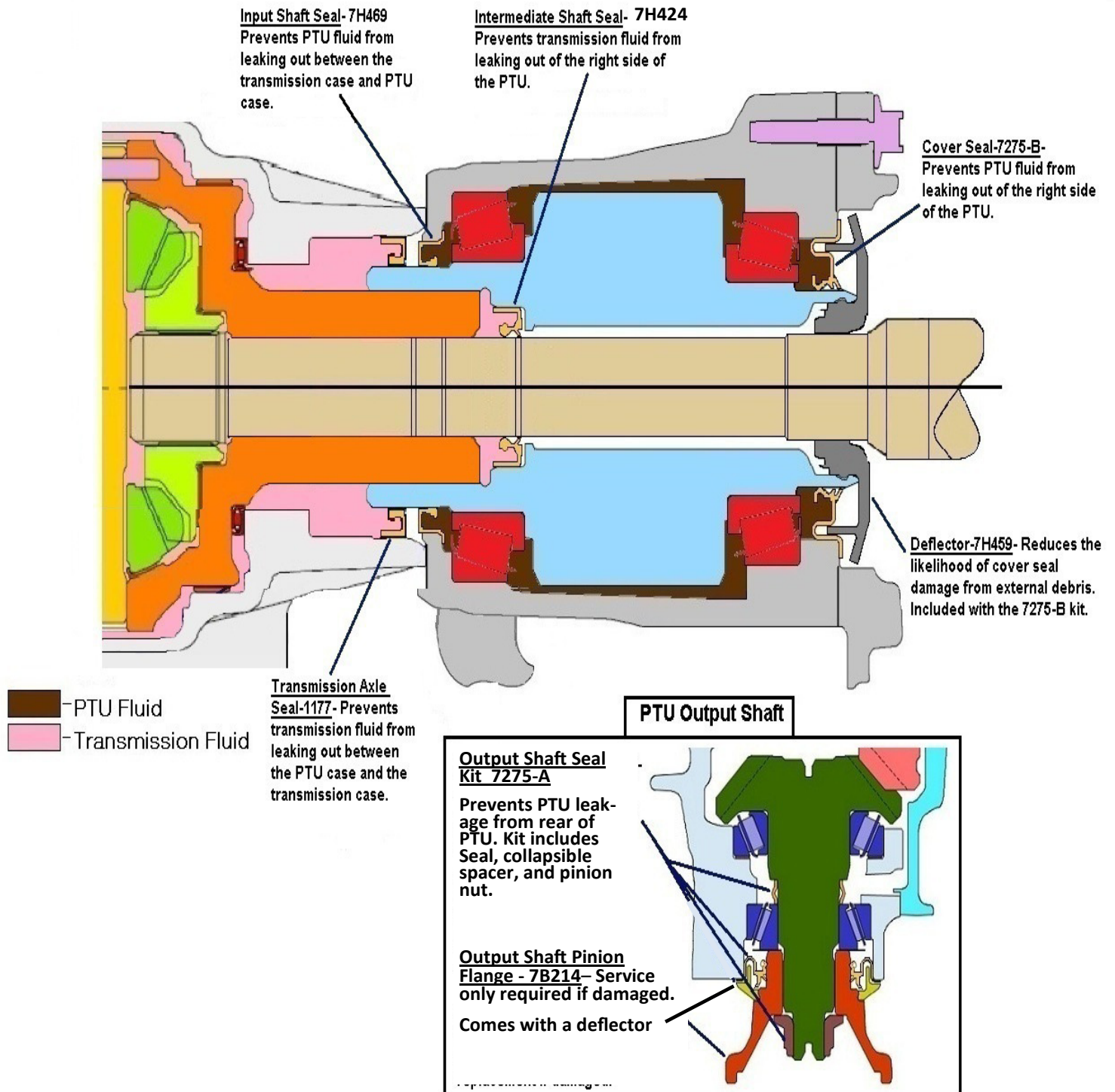

2010 - 2012 Fusion 2.5L, 3.0L

All-Wheel Drive PTU Sealing

2010-2012 Fusion with a 6F35 Transmission

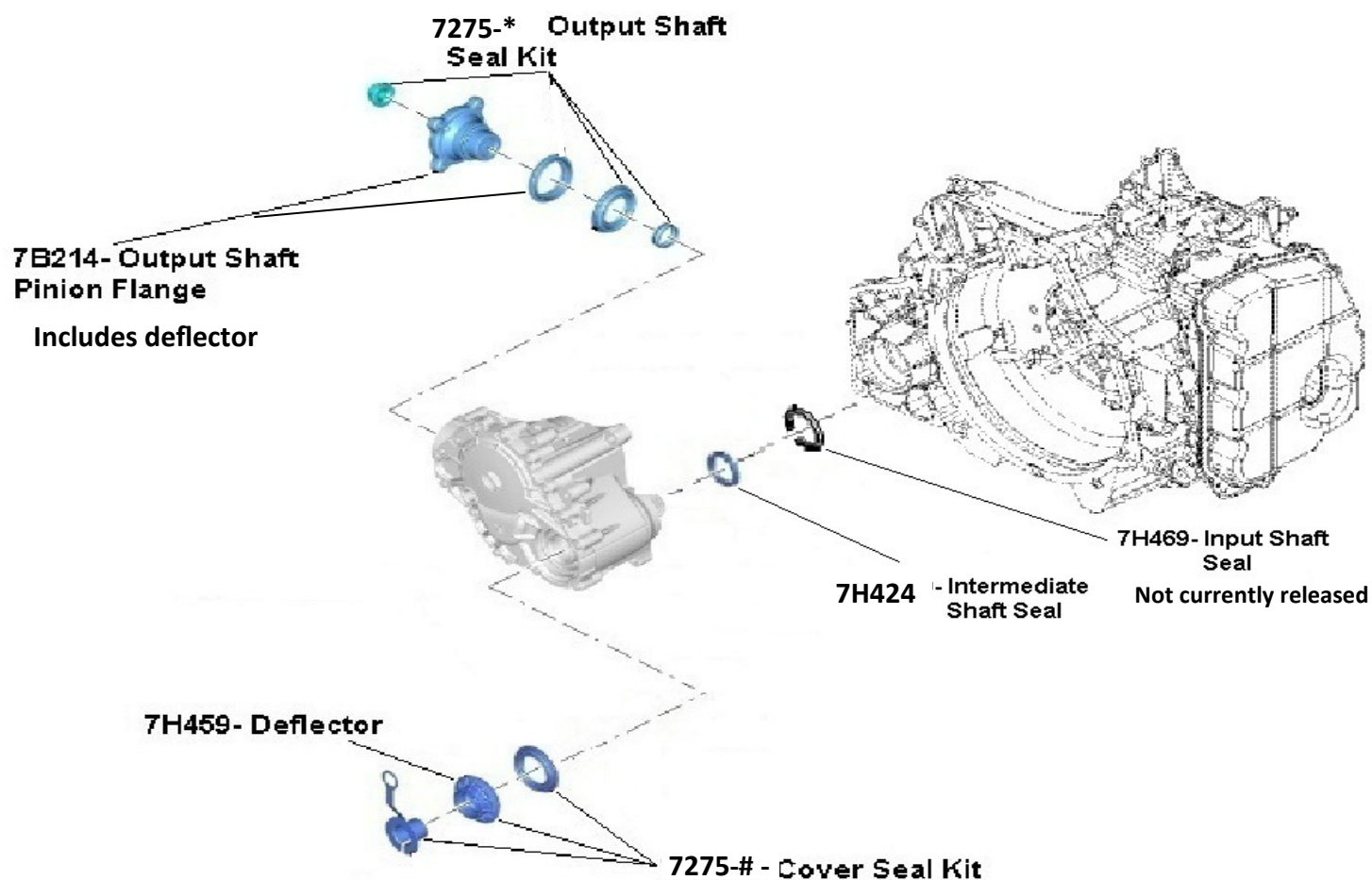

Seal Name	Base Part Number	Fluid Leak	Location of Leak	PTU Removal Required for Replacement	Other PTU Seals Required for Replacement	Labor Operation
Intermediate Shaft Seal	7H424		Right side of PTU	Yes	None	7003B
Cover Seal	7275-# kit		Right side of PTU	Yes	7H424	7003B +7275C
Deflector	7H459		None	Yes	7H424	7003B +7275C
Input Shaft Seal	7H469		Between PTU and Transmission ⁽¹⁾	Yes	7H424 + 7275-# kit	7003B
Output Shaft Seal	7275-* kit		Rear of PTU	No	None	7275A
Transmission Axle Seal	1177		Between PTU and Transmission	Yes	7H424	7003B

(1) - PTU disassembly required to replace the input shaft seal. Refer to WSM, Section 308-07.

All-Wheel Drive PTU Sealing

2013 – Current Vehicles with 6F35 Transmission

Compression Seal-7086- The compression seal only prevents dust and dirt from reaching the PTU and transmission seals. If a fluid leak is noted between the transmission case and PTU case, please refer to WSM section 308-07B for leak diagnostics.

■ - PTU Fluid
■ - Transmission Fluid

Transmission Axle Seal-1177- Located in the transmission case. Prevents transmission fluid from leaking between the PTU and transmission case. May not leak externally due to the compression seal.

LH Input Shaft Seal-7275-B- Prevents PTU fluid from leaking between the transmission case and PTU. May not leak externally due to the compression seal. If PTU fluid is found when the PTU is removed, this seal requires replacement.

Output Shaft Seal-7275A- Prevents PTU fluid from leaking out of the rear of the PTU.

Intermediate Shaft Seal-7H426- Prevents Transmission fluid from leaking out of the right side of the PTU. Does not require PTU removal to service.

RH Input Shaft Seal-7275B- Prevents PTU fluid from contaminating the transmission fluid. This seal will not leak externally. A RH input shaft seal leak will result in transmission fluid in the PTU, or PTU fluid in the transmission only.

Cover Seal - 7275-C- Prevents PTU fluid from leaking out of the PTU cover to case interface. Includes the 7H426 intermediate shaft seal in this kit.

2013 – Current Escape 1.6L GTDI, 2.0L GTDI
2013 – Current Fusion 1.6L GTDI, 2.0L GTDI
2013 – Current MKZ 2.0L GTDI (not used on 3.7L MKZ)
2015 – Current MKC 2.0L GTDI, 2.3L GTDI
2015 – Current Edge 2.0L GTDI

All-Wheel Drive PTU Sealing

2013 – Current Vehicles with 6F35 Transmission

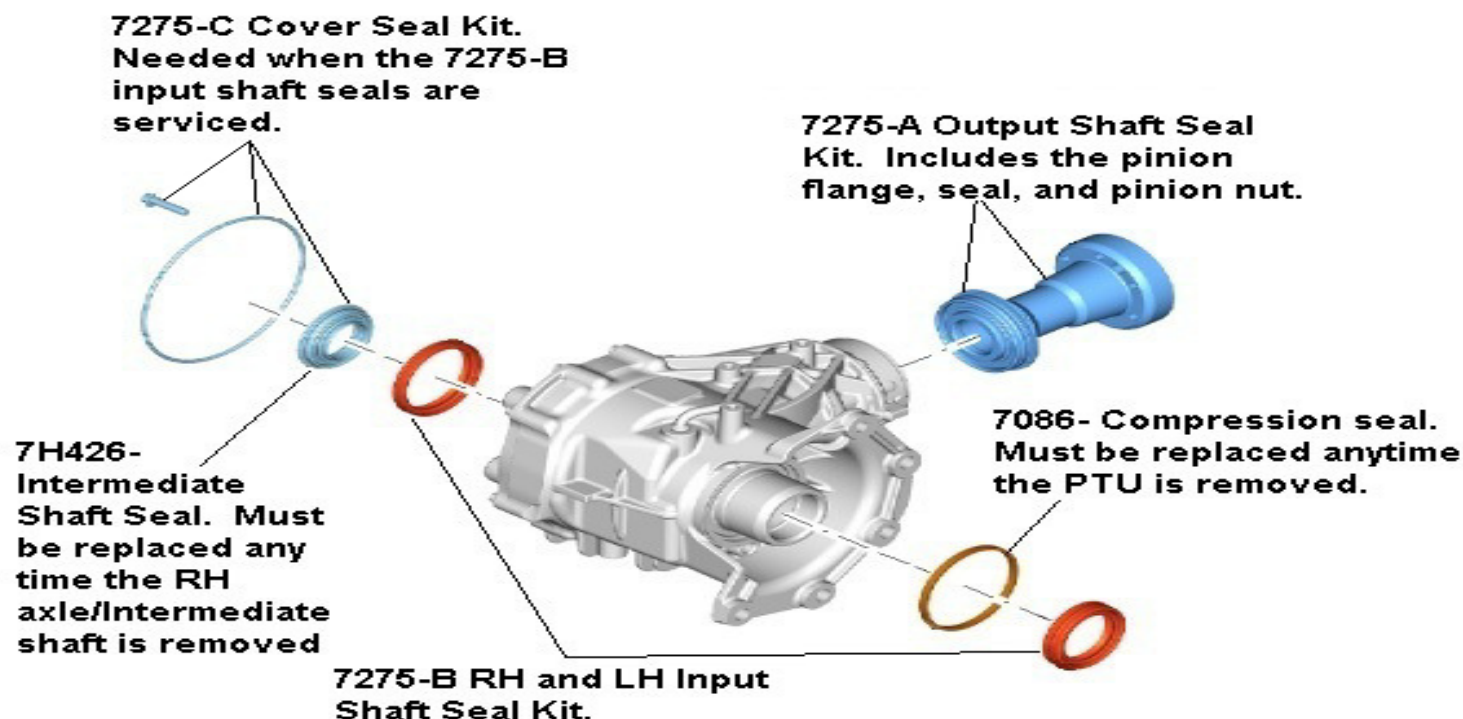

Seal Name	Base Part Number	Fluid Leak	Location of Leak	PTU Removal Required for Replacement	Other PTU Seals Required for Replacement	Labor Operation
Intermediate Shaft Seal	7H426		RH Side of PTU	No	None	7275B
Cover Seal	7275C kit		RH Side of PTU	Yes	7275C + 7086	7003B + 7003B4
RH Input Shaft Seal	7275B kit		Internal	Yes	7275C + 7086	7003B + 7003B6
LH Input Shaft Seal	7275B kit		Between Transmission and PTU (1)	Yes	7275C + 7086	7003B + 7003B6
Output Shaft Seal	7275A kit		Rear of PTU	See WSM	7H426 if PTU is removed	7003B + 7003B7
Transmission Axle Seal	1177		Between Transmission and PTU (2)	Yes	7086 + 7H426	7003B
Compression Seal	7086		Between Transmission and PTU (3)	Yes	7H426	7003B

(1) The LH input shaft seal may not result in an external leak. If PTU fluid is found after PTU removal, replace the LH input shaft seal.

(2) The transmission axle seal may not result in an external leak. If transmission fluid is found after PTU removal, replace the transmission axle seal.

(3) The compression seal only prevents dirt and debris from reaching the PTU and transmission seals. However, it may temporarily seal a leak in this location. If a leak is noted between the transmission and PTU, refer to WSM, Section 308-07.