



Center Console Trim Panels - Ultrasuede CVT

Genuine Part Number : J1310VC622

Applicable Model : WRX (2022MY~)

For Installation Operator

This manual describes how to install and handle the Center Console Trim Panels - Ultrasuede CVT. Please make sure to read this manual before installation for the correct installation. Please hand this manual to the customer after the installation.

⚠ Precautions

1. For your safety, stop the vehicle on a flat place, turn off the engine switch and ensure that the parking brake is applied before starting the installation process.
2. Since connector to be detached and attached, make sure to disconnect the power cord of battery (-) negative side before handling electrical components such as the connector. Follow the instructions in the latest service manual for removing and installing the cord of (-) negative side.
3. When installing, be careful not to damage the vehicle and the Center Console Trim Panels parts with tools.
4. Follow the items described using **⚠ Caution** mark in the "Installation procedure" on the following pages for installation.

Advice

This document uses the **👉 Advice** mark to indicate items to be followed and useful tips for the products.

Component Part

No.	Component Part No.	Quantity
①	Center Console Trim Panels RH	1
②	Center Console Trim Panels LH	1

Tools to be used

- Handy remover
- Phillips screwdriver

Completion drawing

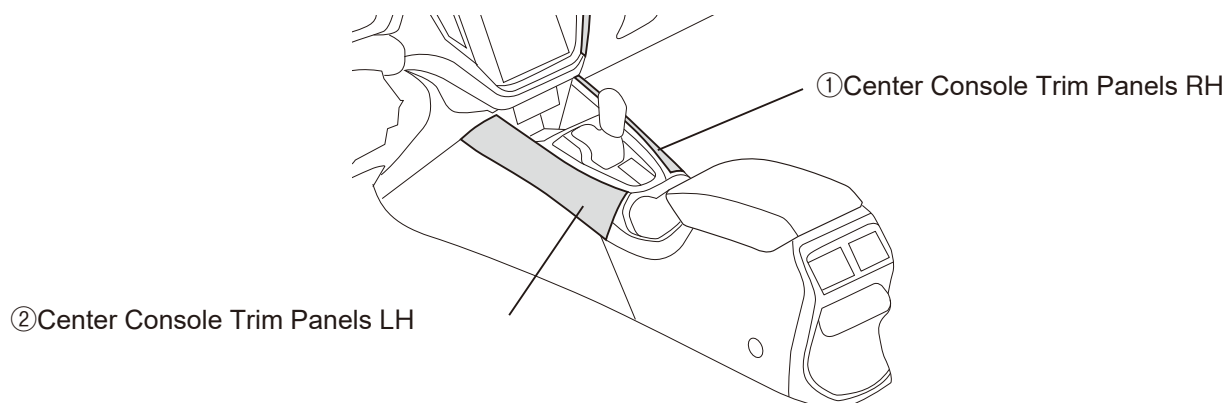

Installation procedure

Installation of Center Console Trim Panels RH / LH

Caution : Since connector to be detached and attached, make sure to disconnect the power cord of battery (-) negative side before handling electrical components such as the connector.

Reference : Set the select lever to the "N" position before removing the negative terminal of the battery.
For vehicles with a power seat, move the seat to the front most position before removing the negative terminal of the battery.

1. Remove the Cover ASSY Front.

(1) Remove the Tray ASSY Center Lower.

⚠ Caution

Tray ASSY Center Lower consists of Mat and base material.
Be careful not to remain the base material on the vehicle.
Tip portion of the base material is inserted into the Instrument Panel.

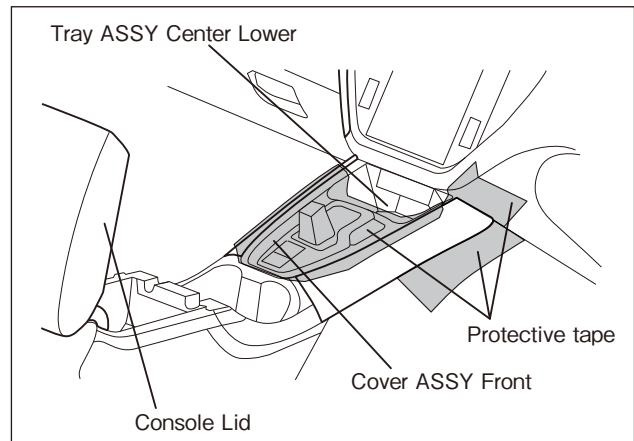

(2) Remove the shift knob according to the procedure shown in the figure below.

Shift knob

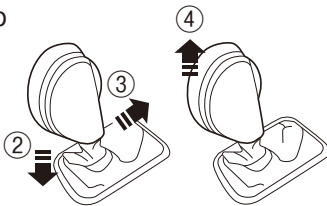

- ① Release the shift lock using a screwdriver, etc. Shift the select bar to "N range".
- ② Push the shift boot downward to remove it.
- ③ Pull out the pin.
- ④ Pull out the shift knob upward.

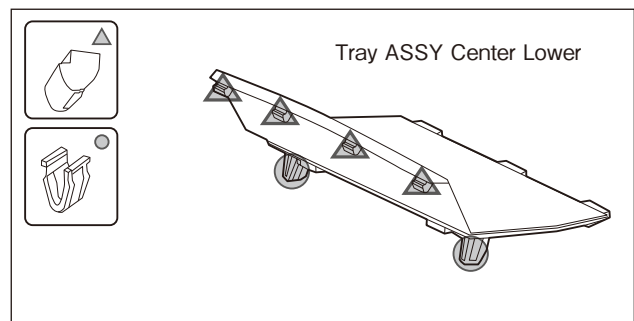

(3) Open the Console Lid, pull up the Cover ASSY Front, and disengage the clips (18 places).

👉 Advice

Please pull the Cover ASSY Front upward from the rear end of cup holder and rotate it as shown by the arrow in the illustration to disengage the clip.
Since the Instrument Panel is overlapped, pull it out backward after the clips are disengaged.

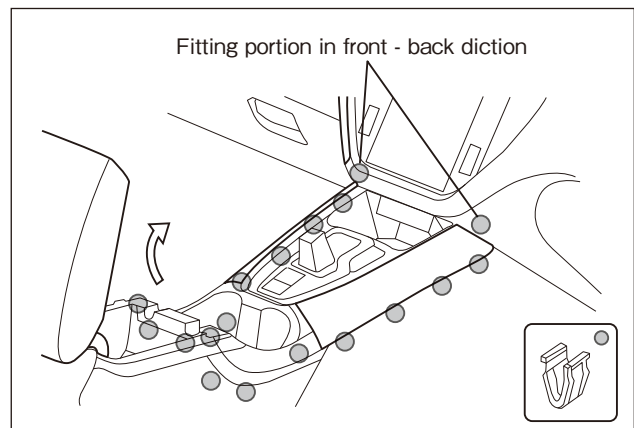

⚠ Caution

Tip of the Cover ASSY Front is engaged with the Instrument Panel in the front-rear direction, so pulling the tip straight up may damage parts.
(Notes in the illustration)

(4) Remove each connector and remove the Cover ASSY Front.

2. Remove the Center Console Trim Panels from the Cover ASSY Front, which is removed from the vehicle.

※The illustration shows RH.

Please remove LH in the same way.

- (1) Remove the screws (2places).
- (2) Remove the resin claws (4places) and remove the Center Console Trim Panels.

⚠ Caution

In the portion marked by ■ in the illustration, the pin of the Center Console Trim Panels is inserted in the Cover Front, so please remove the pin carefully not to damage the part. Please keep the removed screw in a safe place as it will be used when assembling.

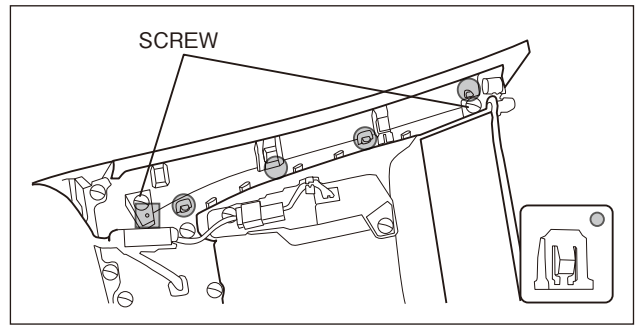

3. ③ Attach it to the Cover Front in the reverse order of removing the Center Console Trim Panels.

⚠ Caution

The cover assembly front will be attached to the vehicle after replacing the console lid, so keep it in a safe place to prevent from scratches.

4. Restore the Cover ASSY Front in the reverse order of removing.

5. Restore the Tray ASSY Center Lower in the reverse order of removing.

⚠ Caution

Pay attention to the positions of the circles and triangles markings on the mat and base material of the Tray ASSY Center Lower.

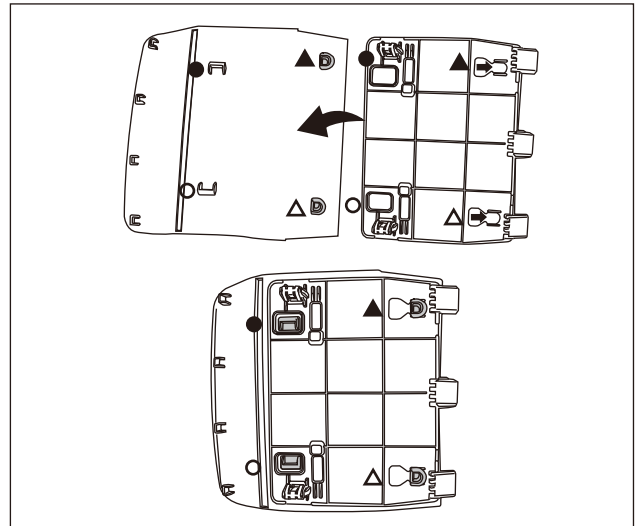

6. The work is completed by restoring the Shift Knob work in the reverse order of removing.

7. Make sure that there are no assembly mistakes or scratches on the removed and restored vehicle parts.

8. Connect the removed battery terminal to the battery.

9. After confirming the operation of each electrical component to which the connector has been attached and detached, the work is completed.

⚠ Caution

If the setting is back to a default by removing the battery terminal or the data is lost, please re-enter the data.

