



SUBARU

PART NUMBER

NUMERO DE PIECE

J101SFN500

DESCRIPTION

Impreza & -RS Mud Flaps

DESCRIPTION

Garde-Boue: Impreza et -RS

INSTALLATION INSTRUCTIONS

INSTRUCTIONS D'INSTALLATION

KIT CONTENTS:

CONTENU DE L'ENSEMBLE

FRONT ASSEMBLY ASSEMBLAGE AVANT

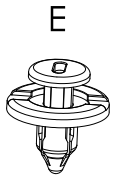
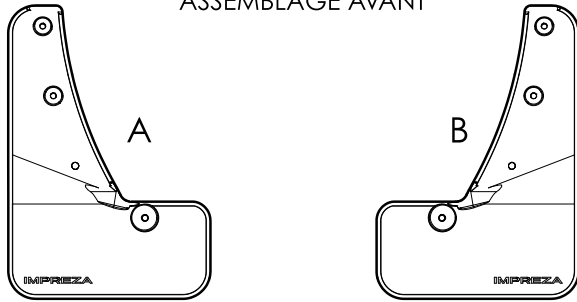

x 6

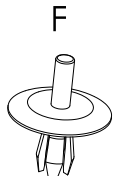

x 2

Only for
Impreza
Seulement pour
Impreza

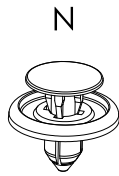

x 2

Only for
Impreza RS
Seulement pour
Impreza RS

REAR ASSEMBLY ASSEMBLAGE ARRIÈRE

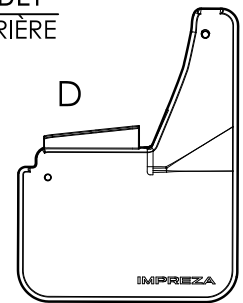
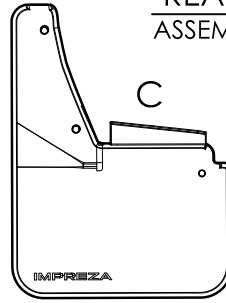

x 4



x 4



x 2



x 2

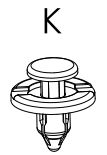

x 2

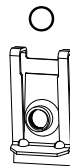

x 2



L

Rear Left Side
Côté Arrière Gauche



M

Rear Right Side
Côté Arrière Droit

TOOLS REQUIRED:
OUTILS REQUIS



Wipe clean
Essuyer

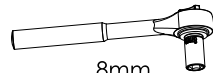
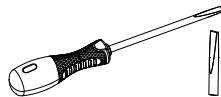

8mm
5/16"



$\phi 2\text{mm}$
3/32"

$\phi 7\text{mm}$
9/32"

$\phi 8\text{mm}$
5/16"

NOTE: Mud flaps will decrease vehicle ground clearance. Use caution when driving over obstacles such as curbs and when entering automatic car washes.

REMARQUE: Les garde-boue réduisent la garde au sol du véhicule. Soyez prudent lorsque vous franchissez des obstacles tels que des bordures de trottoir et lorsque vous entrez dans les lave-autos automatiques.

OVER-TIGHTENING THE SCREWS IS NOT ADVISED AS THIS MAY CAUSE THE MUD-FLAP TO LOCALLY DEFORM.
IL EST DÉCONSEILLÉ DE TROP SERRER LES VIS CAR CELA POURRAIT DÉFORMER LOCALEMENT LE GARDE-BOUE.

MEANING OF CHARACTERS:
SIGNIFICATION DES SYMBOLES

REMOVE
Enlever



INSTALL
Installer



DISCARD
Jeter / recycler



ISSUE

EDITION A

DATE

JUN 06, 2022

SUBARU OF AMERICA

PAGE

1/3



SUBARU

PART NUMBER

NUMERO DE PIECE

J101SFN500

DESCRIPTION

Impreza & -RS Mud Flaps

DESCRIPTION

Garde-Boue: Impreza et -RS

INSTALLATION INSTRUCTIONS

INSTRUCTIONS D'INSTALLATION

1 Front Installation Installation a l'avant

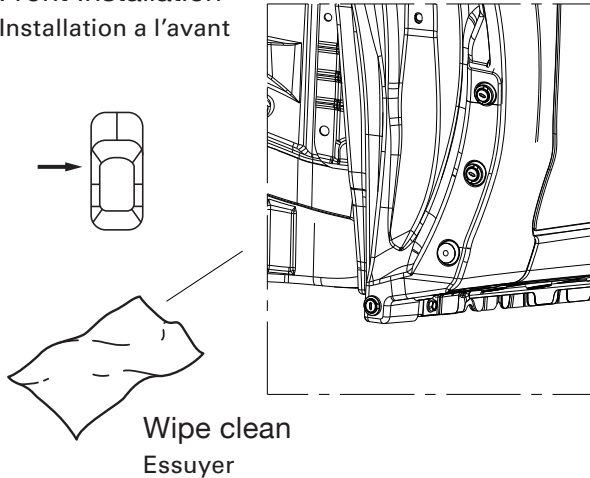

2

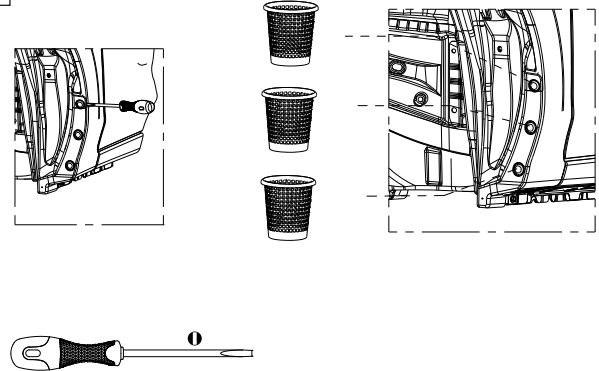

3

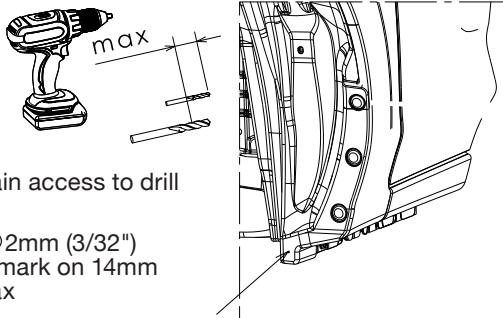

1. Turn wheel to gain access to drill location
 2. Drill two holes $\varnothing 2$ mm (3/32") through use premark on 14mm (9/16") depth max
 3. Re-drill to $\varnothing 7$ mm (9/32") two holes up to 14mm (9/16") depth max
1. Tournez la roue pour accéder à l'emplacement de la perceuse
 2. Percez deux trous $\varnothing 2$ mm (3/32") à travers l'utilisation de la prémarque sur une profondeur maximale de 14 mm (9/16")
 3. Re-percez à $\varnothing 7$ mm (9/32") deux trous jusqu'à 14 mm (9/16") de profondeur max

4

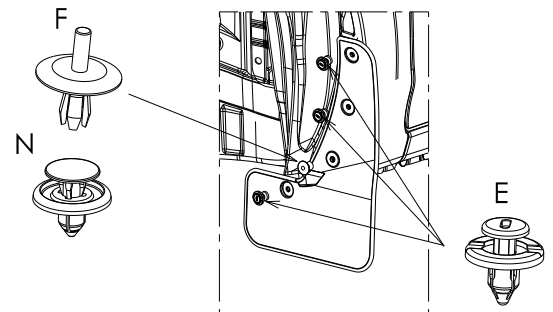

Impreza RS Trim Packages require additional Panel Thickness:
Pushpin "N" should be used instead of Pushpin "F" on RS variants
Les ensembles de garnitures Impreza RS nécessitent une épaisseur de panneau supplémentaire :
La punaise "N" doit être utilisée à la place de la punaise "F" sur les variantes RS

5

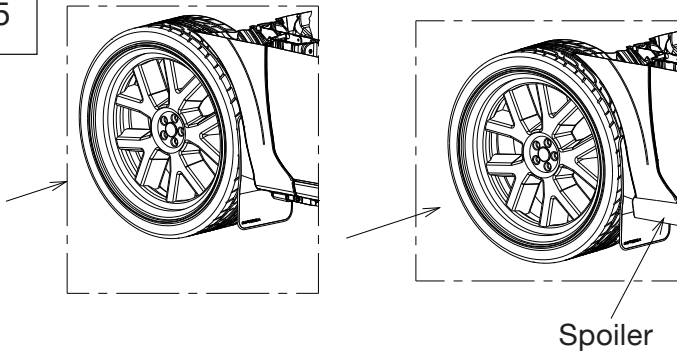

This instruction shows pictures for Impreza
-RS version has spoiler
Cette instruction montre des images pour Impreza
-La version RS a un spoiler

ISSUE

EDITION A

DATE

JUN 06, 2022

SUBARU OF AMERICA

PAGE

2/3



SUBARU

PART NUMBER

NUMERO DE PIECE

J101SFN500

DESCRIPTION

Impreza & -RS Mud Flaps

DESCRIPTION

Garde-Boue: Impreza et -RS

INSTALLATION INSTRUCTIONS

INSTRUCTIONS D'INSTALLATION

6 Rear Installation Installation a l'arriere

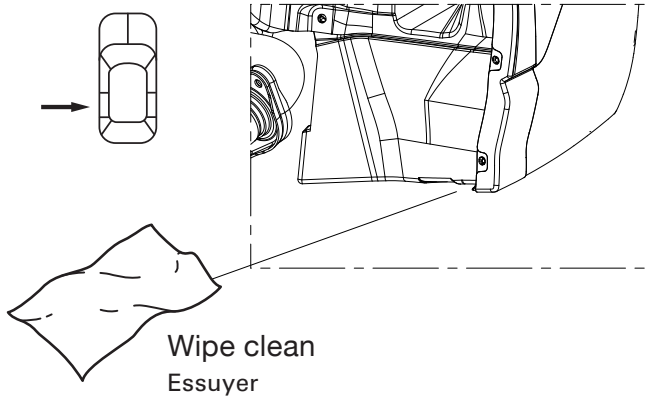

7

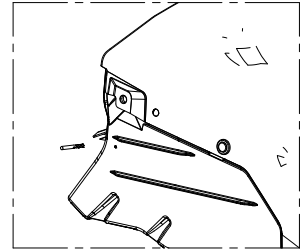
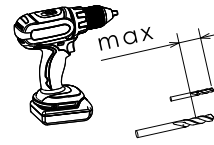

1. Turn wheel to gain access to drill location
 2. Drill two holes $\varnothing 2$ mm (3/32") through use premark on 14mm (9/16") depth max
 3. Re-drill to $\varnothing 8$ mm (5/16") two holes up to 14mm (9/16") depth max
1. Tournez la roue pour accéder à l'emplacement de la perceuse
 2. Percez deux trous $\varnothing 2$ mm (3/32") à travers l'utilisation de la prémarque sur une profondeur maximale de 14 mm (9/16")
 3. Re-percez à $\varnothing 8$ mm (5/16") deux trous jusqu'à 14 mm (9/16") de profondeur max

8

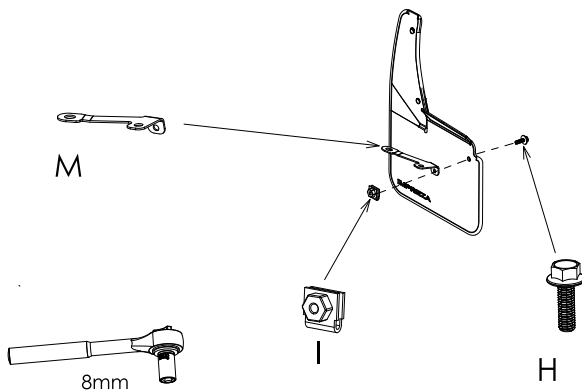

Screw torque:
0.5 - 0.75 Nm (4.5~6.5 in-lb)

Couple de serrage des vis:
0,5 à 0,75 N.m (4,5 à 6,5 po-lb)

9

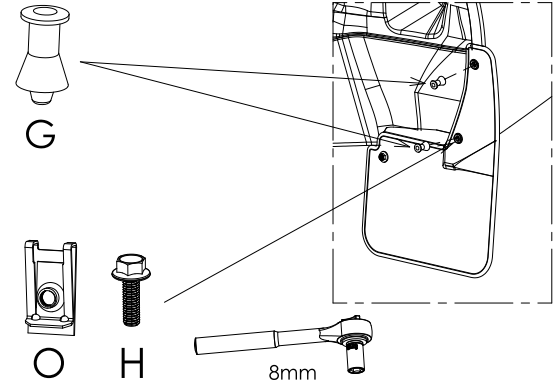

Optional Subaru Accessory may require the use of nut "O" and bolt "H"
L'accessoire Subaru en option peut nécessiter l'utilisation d'un écrou "O" et d'un boulon "H"

Screw torque:
0.5 - 0.75 Nm (4.5~6.5 in-lb)

Couple de serrage des vis:
0,5 à 0,75 N.m (4,5 à 6,5 po-lb)

10

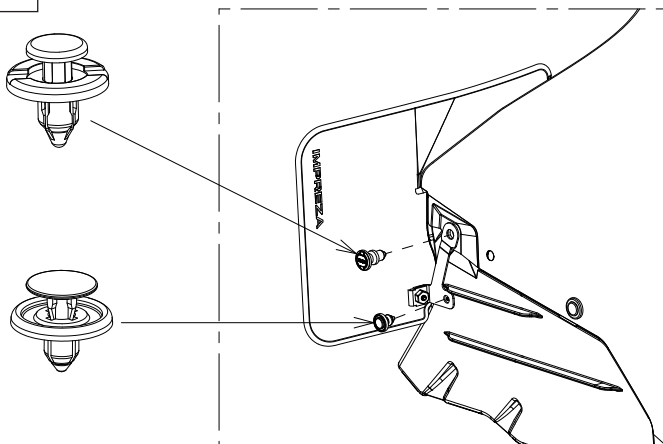

11

Repeat steps for the other side of the vehicle

Reprendre les memes etapes l'autre cote de vehicle

ISSUE

DATE

SUBARU OF AMERICA

PAGE

EDITION A

JUN 06, 2022

3/3