



# SUBARU

## FORESTER

## Front Grille

### Installation Instruction

PART No.

J1010SG101

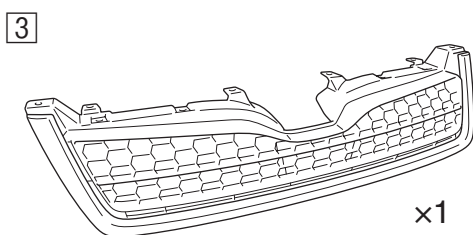
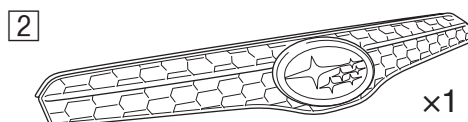
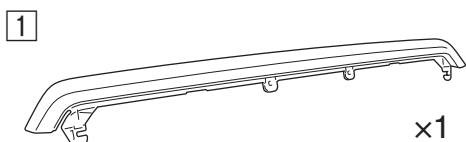
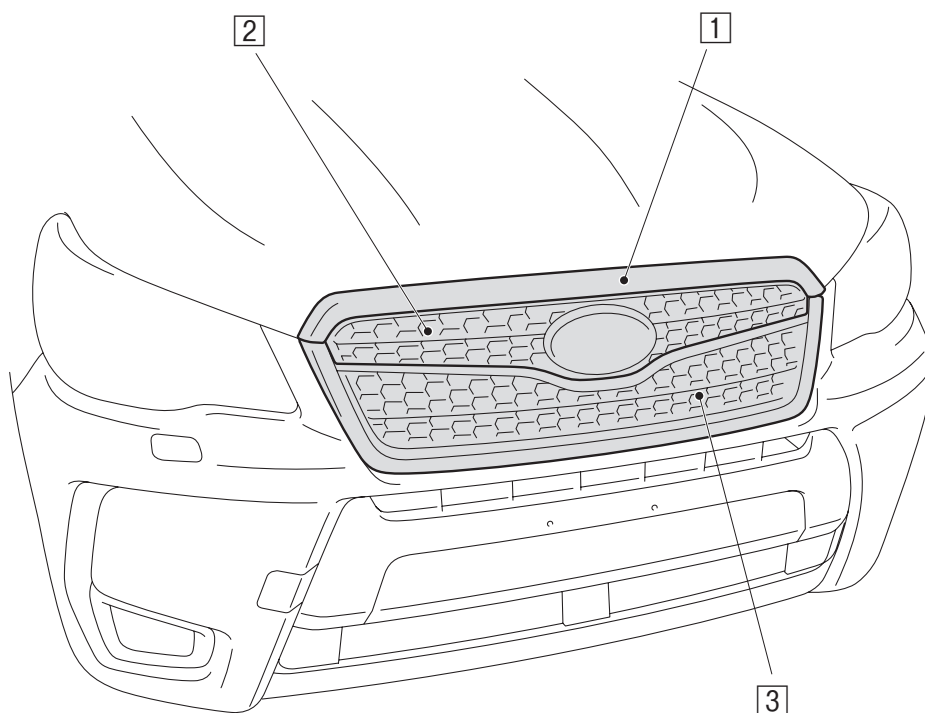

※ Due to the redesign of the original front grille upper, the 2 slide bolts and the 2 nuts have been eliminated from the vehicle. For that reason, only 6 cushions will be used for models equipped with the redesigned front grille upper.

## TOOLS REQUIRED

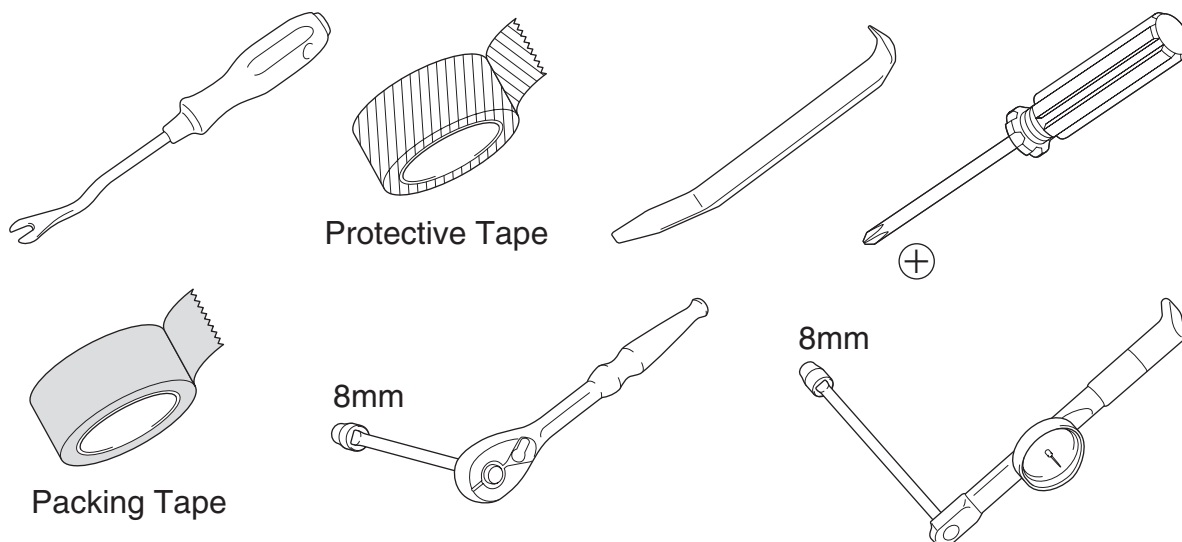

1

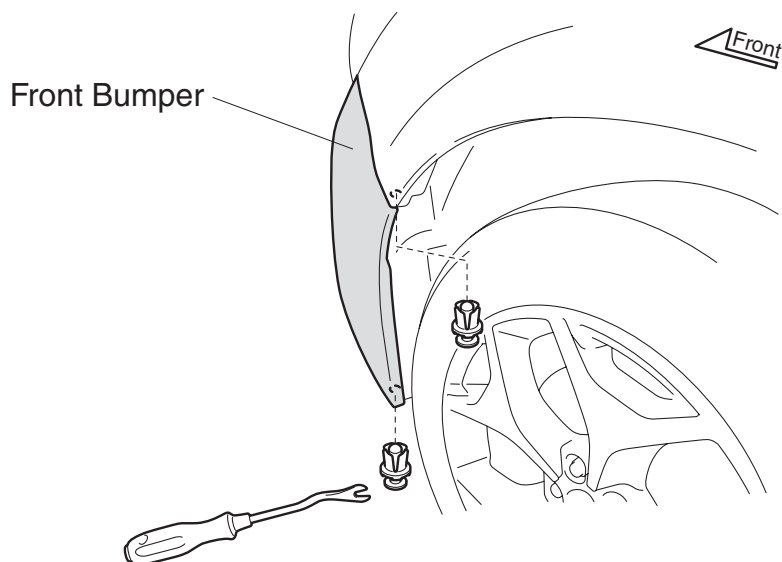

2

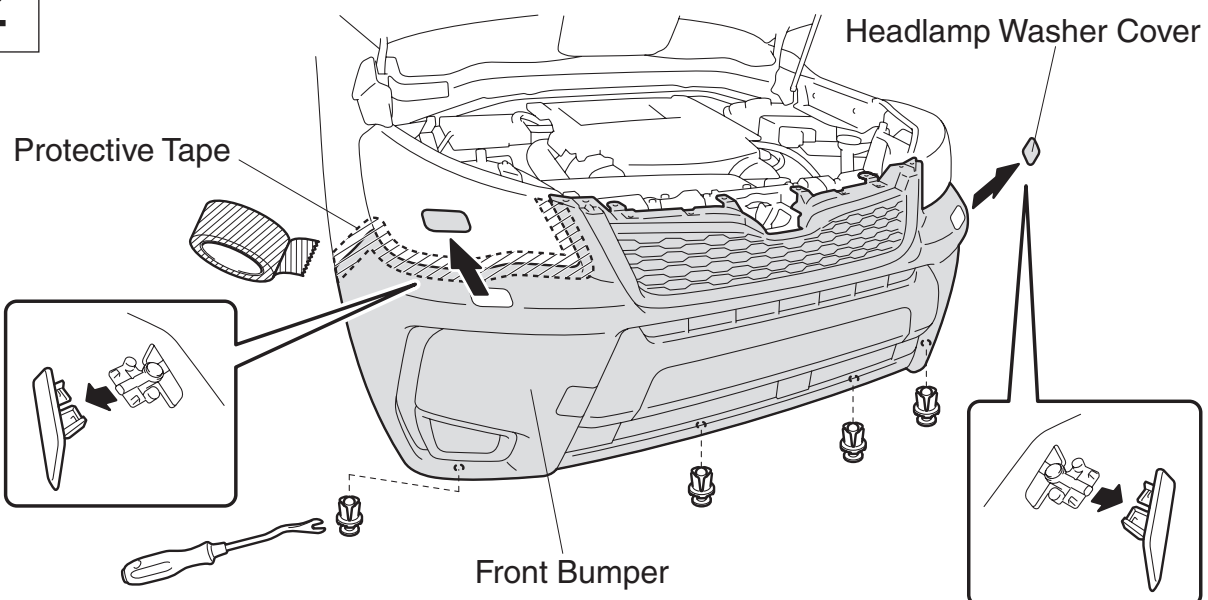

3

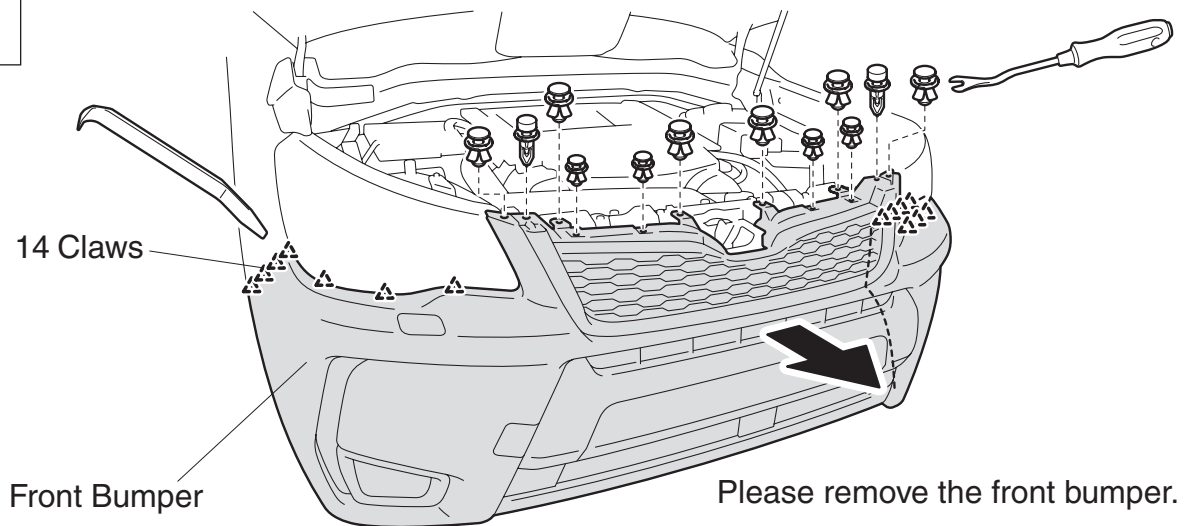

Before removing the front bumper, disconnect the fog lamp connectors.

4

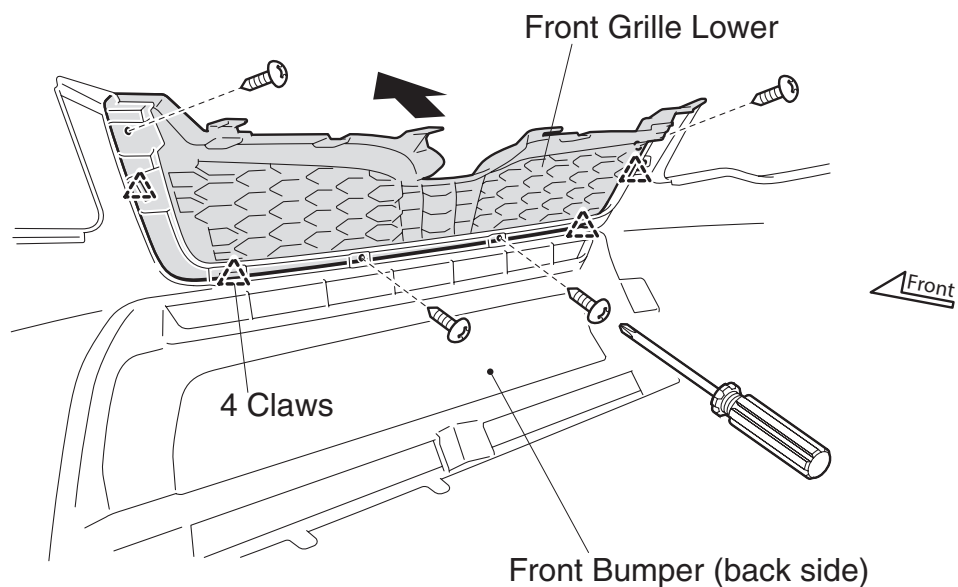

5

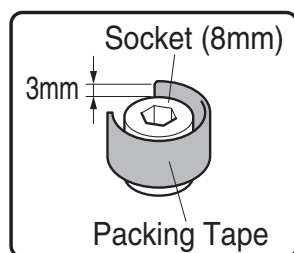

※ The number of nuts is different between the models before and after the original front grille upper is redesigned.

The nuts indicated by a dotted circle shown in the illustration have been discontinued from the models equipped with the redesigned front grille upper.

Do not allow any of the nuts to drop into the engine compartment.

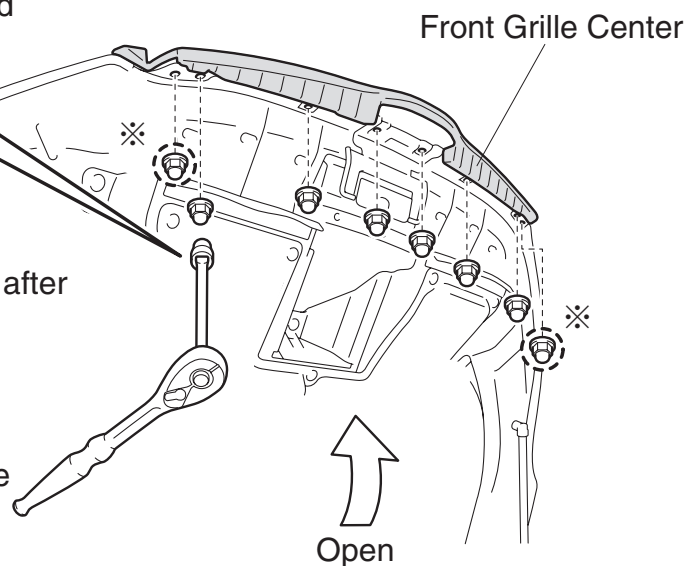

6

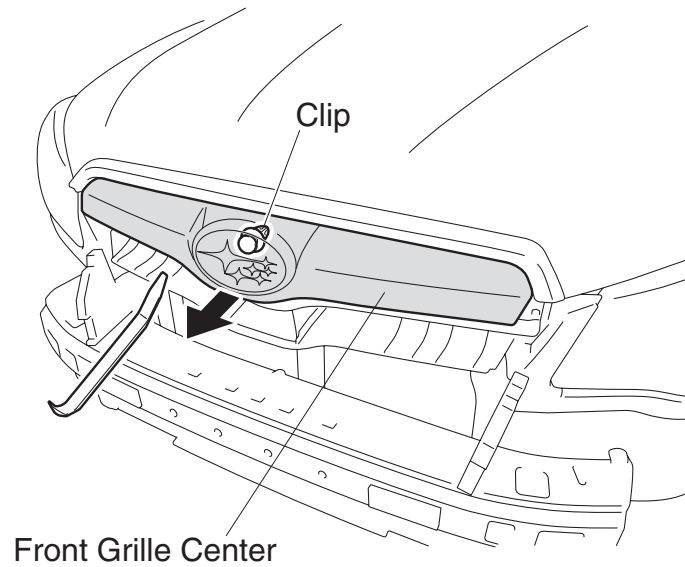

7

Do not allow any of the screws to drop into the engine compartment.

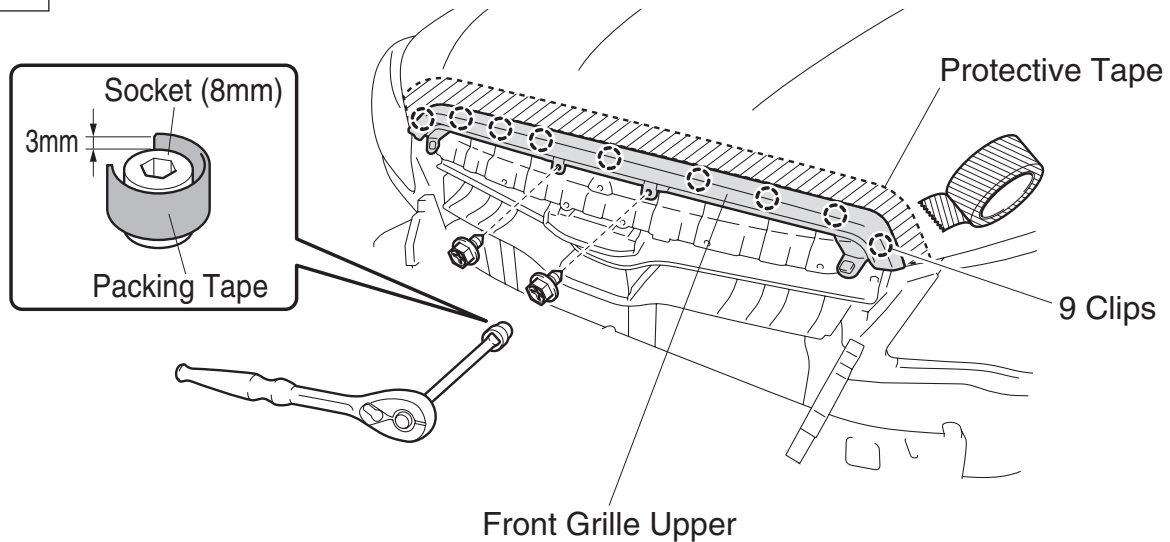

8

If the slide bolts are used to fasten the original front grille upper:  
(This step can be skipped when no slide bolts are provided)

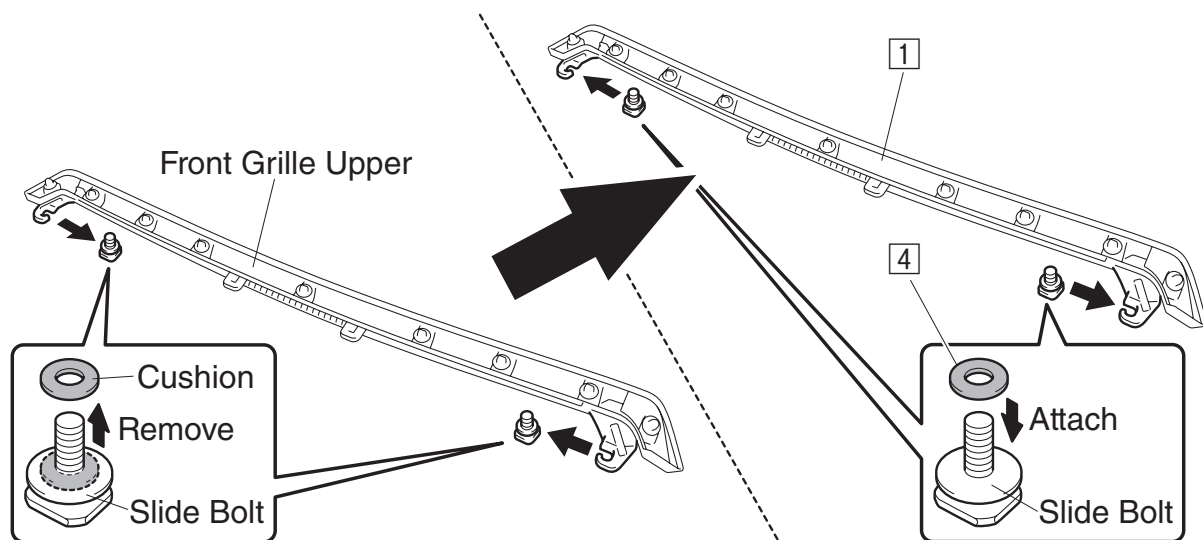

9

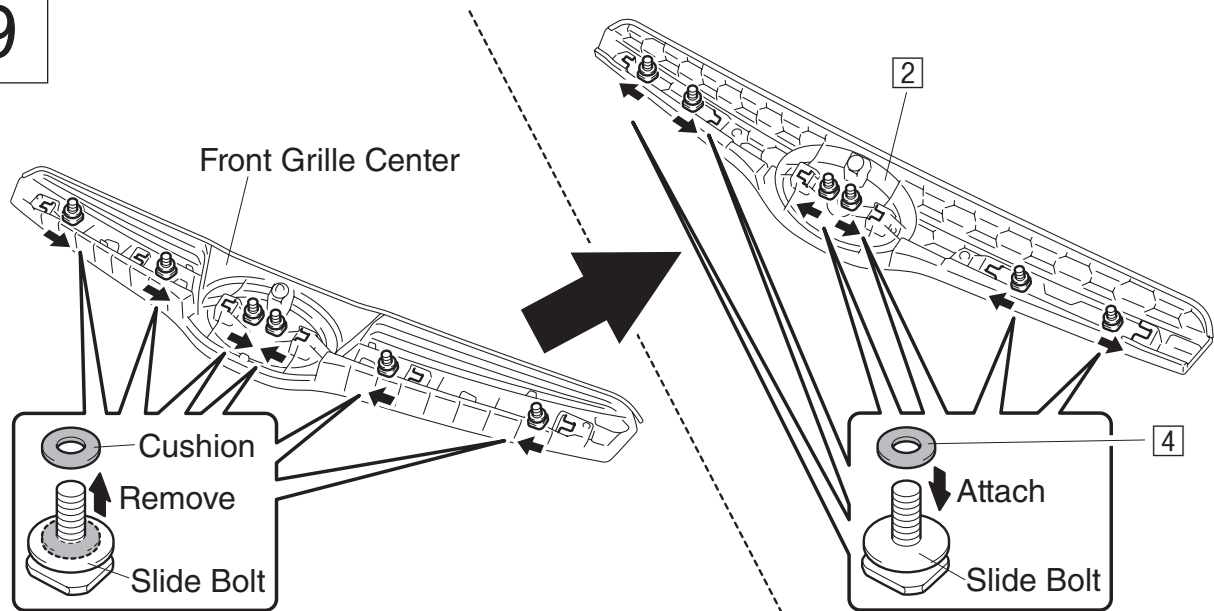

10

Do not allow any of the screws to drop into the engine compartment.

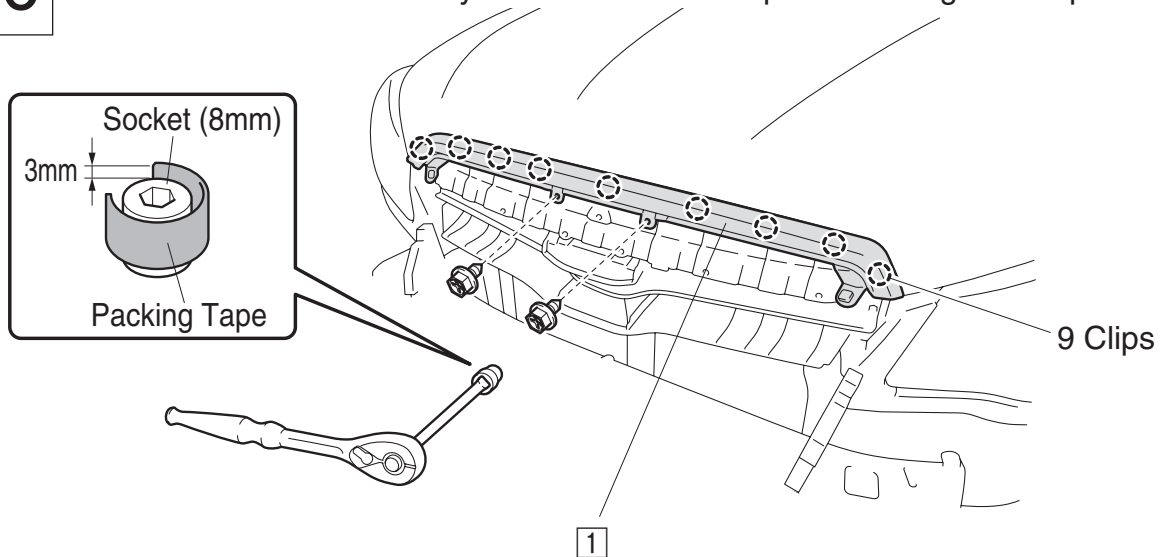

11

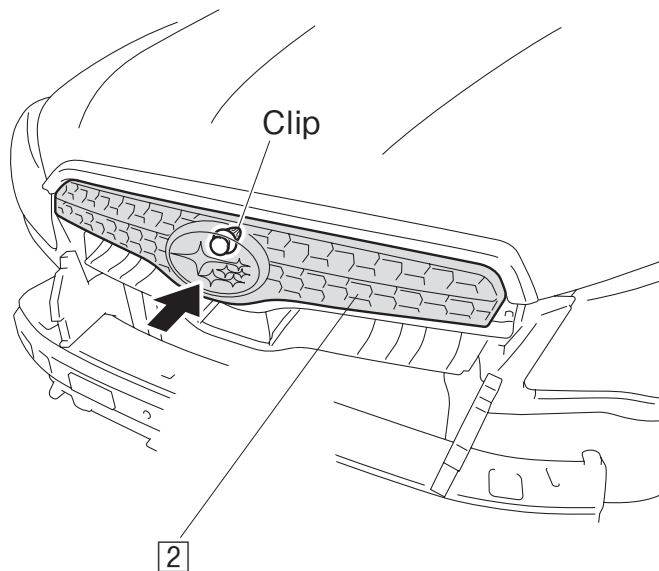

# 12

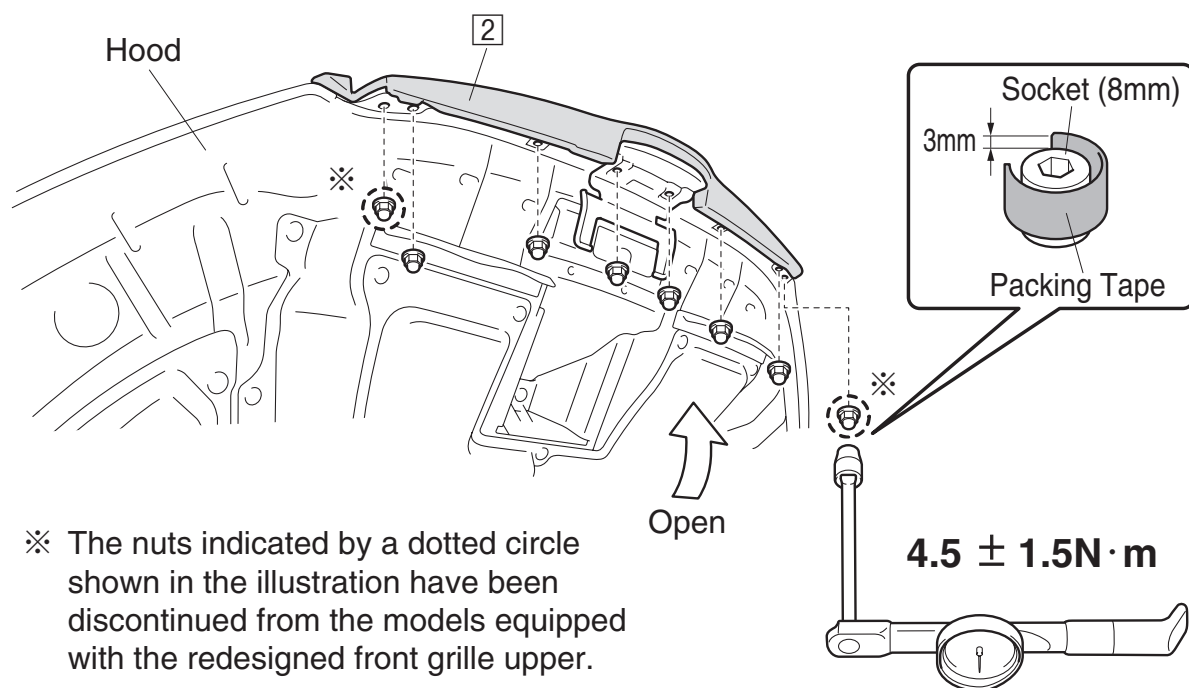

Do not allow any of the nuts to drop into the engine compartment.

# 13

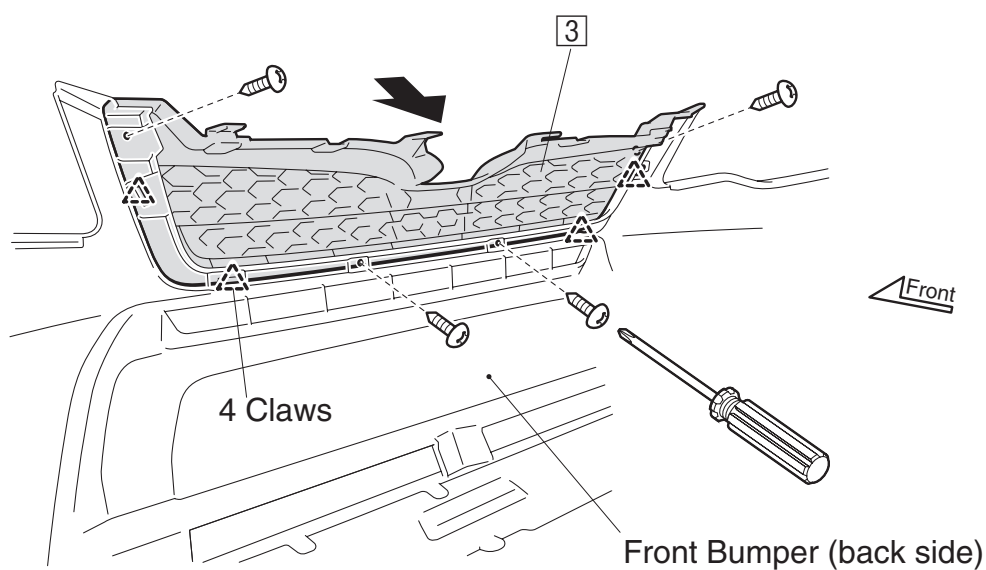

14

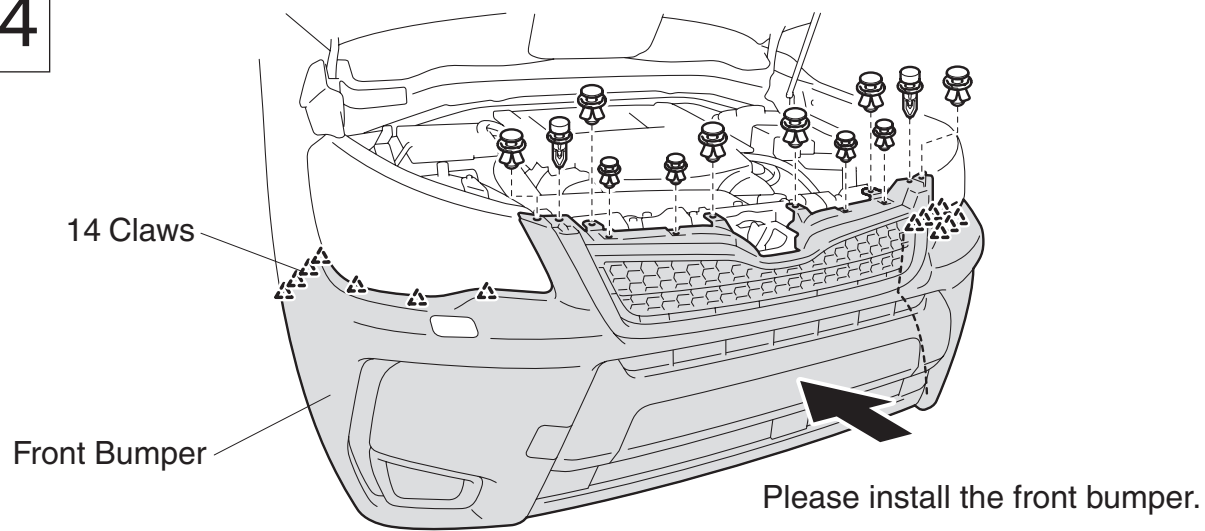

Before reinstalling the front bumper, reconnect the fog lamp connectors.

15

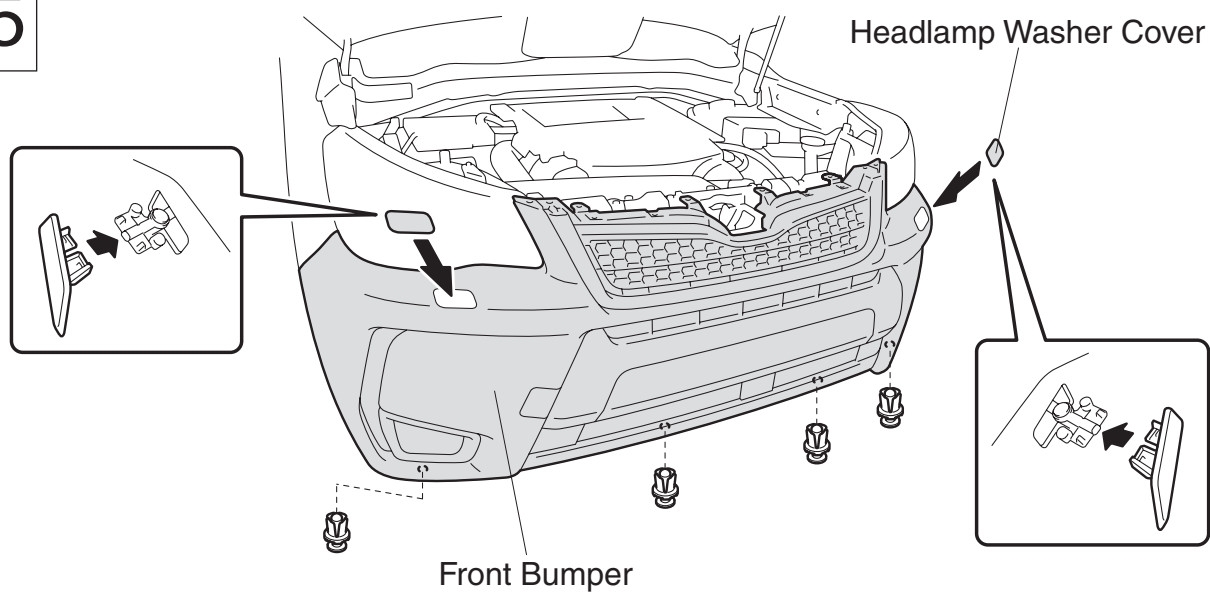

16

