





SIDE WINDOW DEFLECTOR

INSTALLATION MANUAL

This manual describes how to install and handle the side window deflector.
 Before installing the part, please be sure to read this manual for proper installation.

 **Precautions**

1. Be sure to observe the contents in  **CAUTION** for installation described in the main text during the work. Failure to observe them may cause coming-off or peeling-off on the part. It may also prevent the vehicle from functioning.
2. Never use thinner or the like, otherwise the surface of the side window deflector may be corroded. Also, keep the side window deflector away from fire, otherwise it may be deformed.
3. When the ambient temperature is 15°C or lower, warm up all strips of the double-sided tape and around the installation portion of the side window deflector to approximately 40°C using a tool such as a dryer or infrared lamp.
 Local warm-up may deform the part. Do not use an industrial dryer.
4. After installing the side window deflectors, leave them for 2 to 3 hours, and do not drive the vehicle. Avoid washing the vehicle or exposing it to rain or the like for 24 hours.

Revision history

Δ	Content	Date
	Newly created	October 2021

Side Window Deflector

Genuine part number: F0010VC010

Applicable model: WRX 2022MY~

Components

No.	Part name	Qty.
①	RH front side window deflector	1
②	LH front side window deflector	1
③	RH rear side window deflector	1
④	LH rear side window deflector	1
⑤	Bracket (a packet of 8 pcs)	8
⑥	Cushion (a set of 4 pcs)	4
⑦	Instruction Manual	1

Repair part No.:

RH front side window deflector (F0010FL001): ①×1, ⑤×8, ⑥×4, ⑦×1

LH front side window deflector (F0010FL002): ②×1, ⑤×8, ⑥×4, ⑦×1

RH rear side window deflector (F0010VC013): ③×1, ⑤×8, ⑥×4, ⑦×1

LH rear side window deflector (F0010VC014): ④×1, ⑤×8, ⑥×4, ⑦×1

Bracket set (F0010FL005): ⑤×8, ⑥×4, ⑦×1

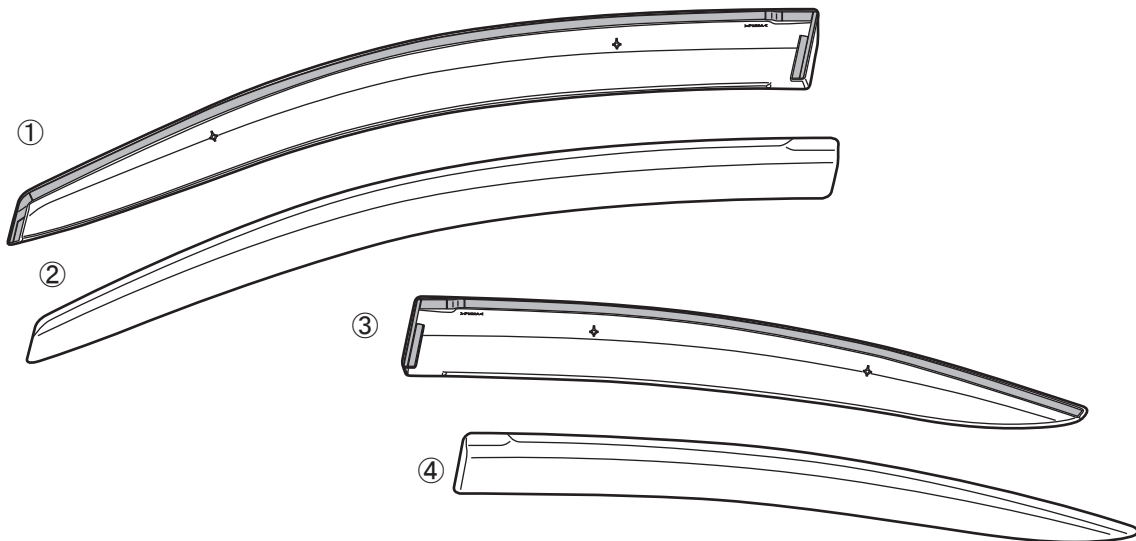

Bracket (a packet of metal fittings)



Cushion

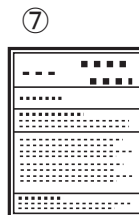
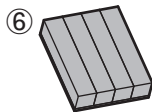

Tools to be used

- Waste cloth →Used in [Fig. 4] and [Fig. 10]
- Detergent or cleaning agent →Used in [Fig. 4] and [Fig. 10]
(Alcohols solvent (isopropyl alcohol, etc.) or Nonane)
- Dryer →Used in [Fig. 8] and [Fig. 14]

Completion image

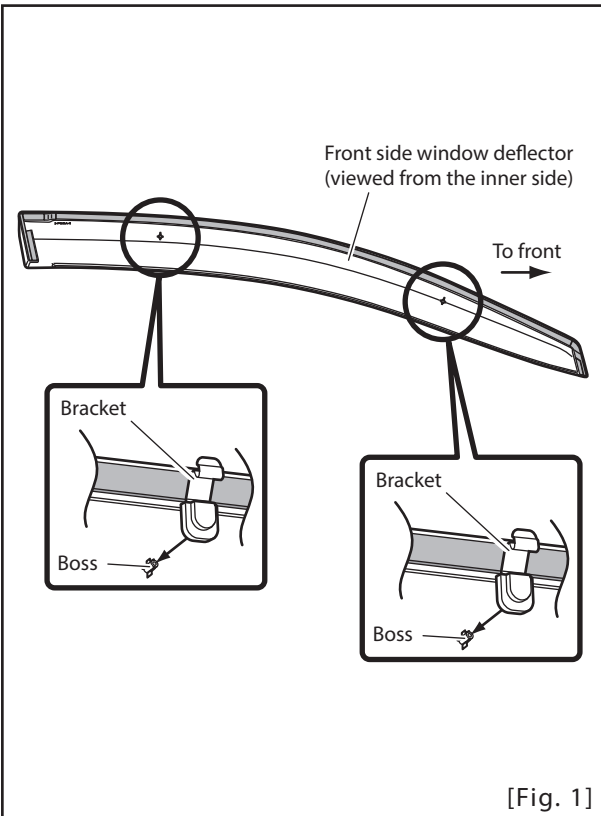
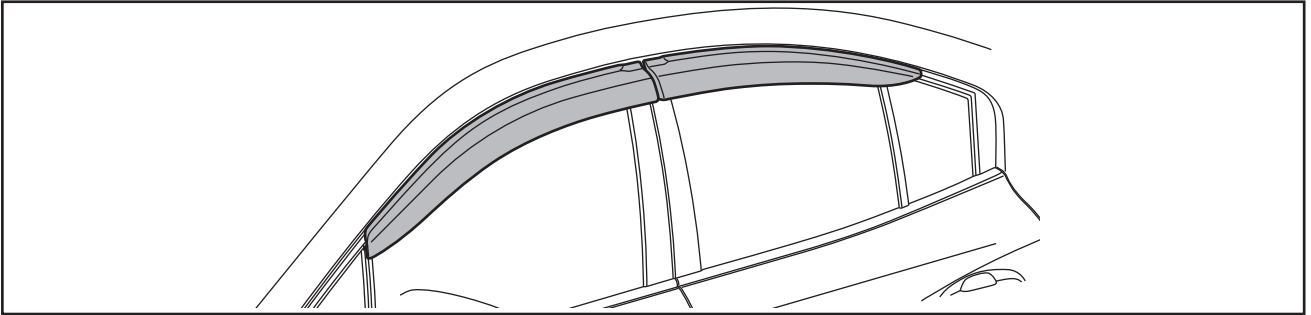

Installation procedure (Explains the installation on the LH side.)

CAUTION

- To perform the work safely, park the vehicle on a flat place with sufficient space for the installation work. Then, switch off the engine and apply the parking brake so that the vehicle will not move.

Preparation

1. Installing the brackets

(1) Insert the brackets to the bosses on the inner side of the front side window deflector. (2 locations)

[Fig.1]

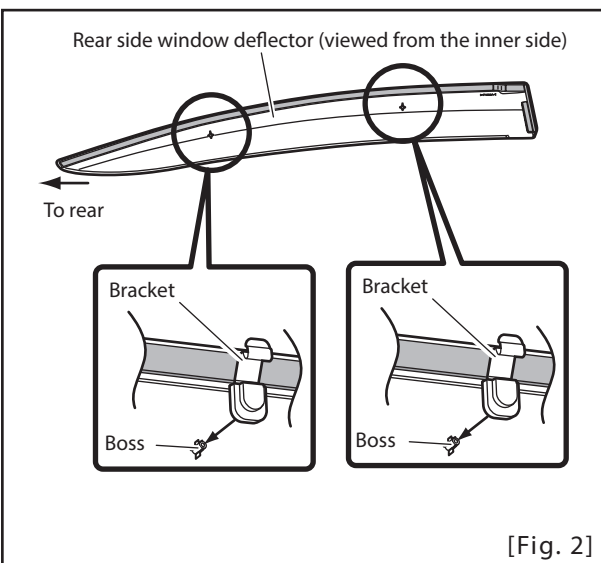
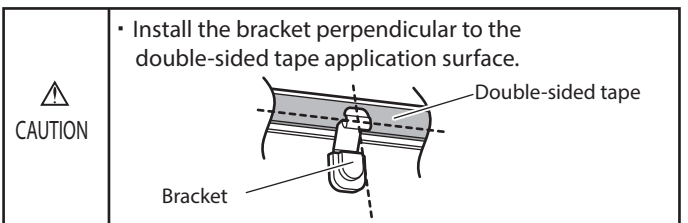

(2) Insert the brackets to the bosses on the inner side of the rear side window deflector. (2 locations)

[Fig.2]

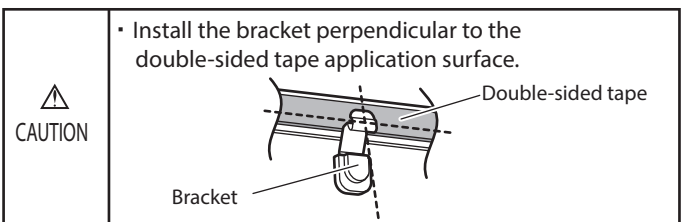

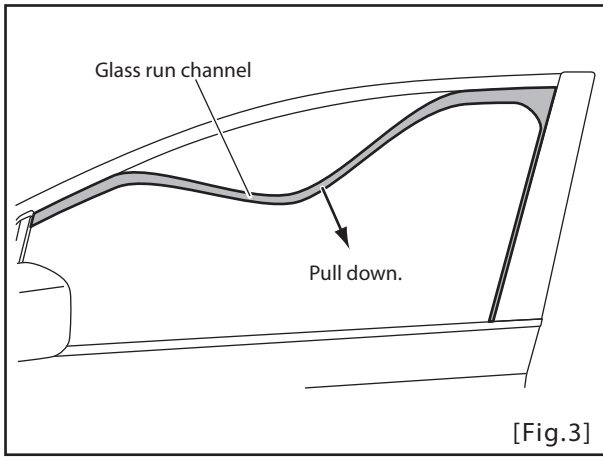

[Fig.3]

2. Preparation for installation of front side window deflector

- (1) Open the front door, and fully open the window glass. Then, pull down the glass run channel.

[Fig.3]

 CAUTION	<ul style="list-style-type: none"> • When the room lamp is lit, turn it off. • When pulling down the glass run channel, be careful not to apply too much force locally, otherwise the glass run channel may break.
-------------	--------------------------------------------------------------------------------------------------------------------------------------------------------------------------------------------------------------------------------------------

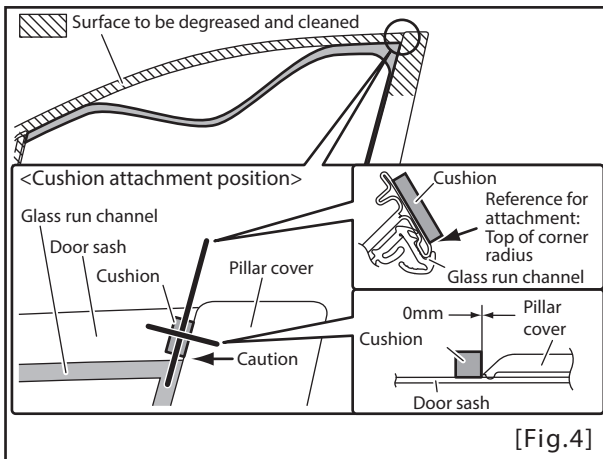

[Fig.4]

- (2) Remove stain or wax on the front side window deflector installation portion (hatched area in Fig. 4) with detergent (or cleaning agent), and let it completely dry.

[Fig.4]

- (3) Attach a cushion to the pillar cover step portion of the front door sash.

When attaching, use the lower side as the reference, and align the cushion to the top of the sash corner radius while paying attention not to make a contact with the glass run channel.

[Fig.4]

 CAUTION	<ul style="list-style-type: none"> • Attach the cushion so that no gap will be made on the pillar cover and also the upper side of the cushion will not protrude from the side window deflector.
-------------	-----------------------------------------------------------------------------------------------------------------------------------------------------------------------------------------------------------------

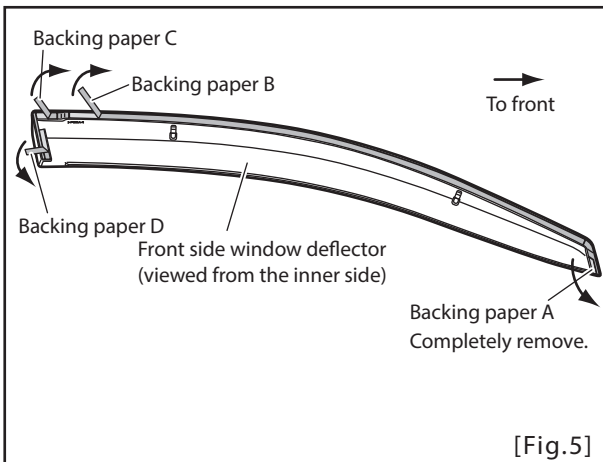

[Fig.5]

- (4) Completely remove the backing paper A at the end of the double-sided tape on the inner side of the front side window deflector. For each of the backing paper B, C, and D, remove approximately 3 to 10 cm from the end, and bend it outward.

[Fig.5]

 CAUTION	<ul style="list-style-type: none"> • Be sure to remove the backing paper as shown in Fig. 5, otherwise they cannot be removed during installation.
-------------	-------------------------------------------------------------------------------------------------------------------------------------------------------------------

Installation

3. Installation of the front side window deflector

- (1) Insert the tips of the brackets installed to the side window deflector in Section 1 (1) into the front door sash.

[Fig.6][Fig.7]

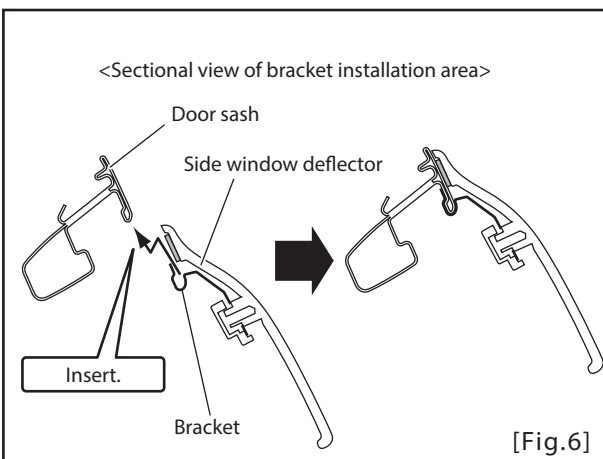

[Fig.6]

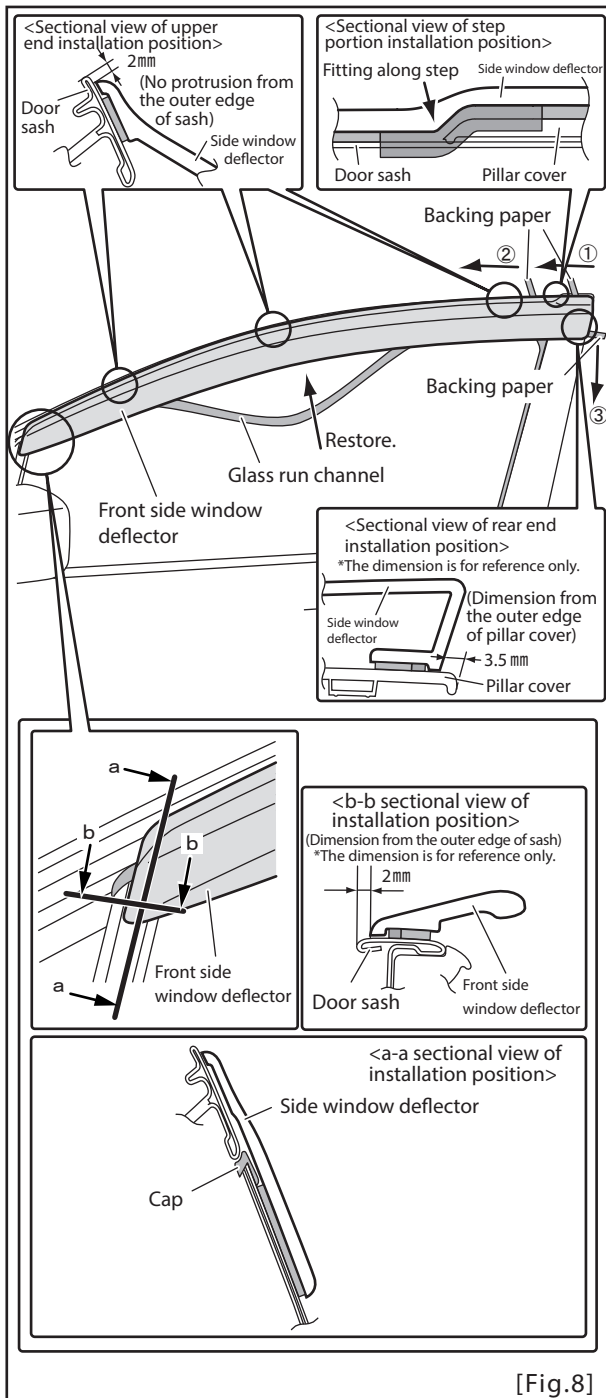
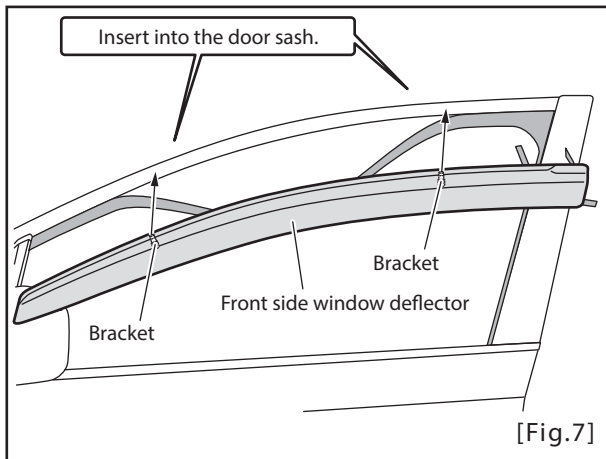

- (2) When installing the front side window deflector in Section 3 (1), fit the rear end of the side window deflector along the step of the front door sash and pillar cover, and make adjustment so that the side window deflector will not protrude from the outer edge of the sash and pillar cover. The installation tolerance must be within ± 0.5 mm.

[Fig.8]

 CAUTION	<ul style="list-style-type: none"> Install the side window deflector so that it will not protrude from the outer edge of the sash and pillar cover. Otherwise, it may cause interference with the vehicle or injury. Avoid making any gap at the step of the sash and pillar cover, when installing. Otherwise, rain or water may intrude inside.
-------------	---------------------------------------------------------------------------------------------------------------------------------------------------------------------------------------------------------------------------------------------------------------------------------------------------------------------------------------------------------------------------

- (3) While holding the side window deflector at the installation position, slowly remove each of the baking paper in the order of ①, ②, and ③ shown in the figure. At that time, be careful not to allow the backing paper of the double-sided tape to break at midpoint.

[Fig.8]

- (4) Apply a firm pressure with a force of 49 N or more (at least to the extent that the vehicle body is moved) evenly onto the entire double-sided tape application surface on the front door sash and pillar cover. [Fig.8]

 CAUTION	<ul style="list-style-type: none"> To apply the double-sided tape onto the pillar cover at the rear end of the front door, firmly press the area around the corner of the side window deflector.

- (5) Restore the glass channel.
The installation work has been completed. [Fig.8]
- (6) Install the RH side window deflector in the same way.

Check

- Visually check the side window deflector from the above and below to make sure that the double-sided tape adhesive surfaces adhere well.
- If the side window deflector surface is dirty after the installation work, wipe it off to clean up with a waste cloth or the like.

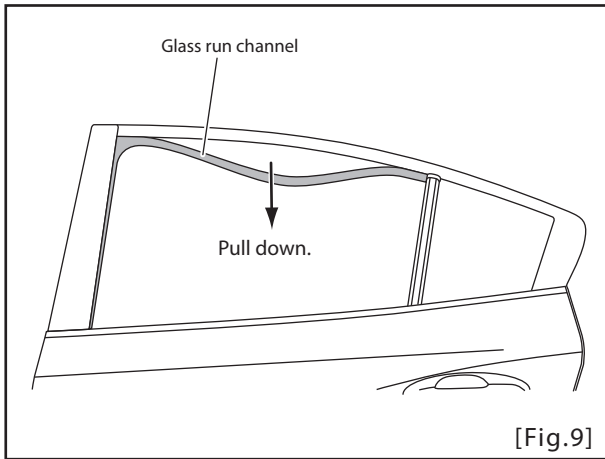

Preparation (Explains the installation on the LH side.)

4. Preparation for installation of rear side window deflector

- (1) Open the rear door, and fully open the window glass. Then, pull down the glass run channel.

[Fig.9]

 CAUTION	<ul style="list-style-type: none"> • When the room lamp is lit, turn it off. • When pulling down the glass run channel, be careful not to apply too much force locally, otherwise the glass run channel may break.
--------------------	--------------------------------------------------------------------------------------------------------------------------------------------------------------------------------------------------------------------------------------------

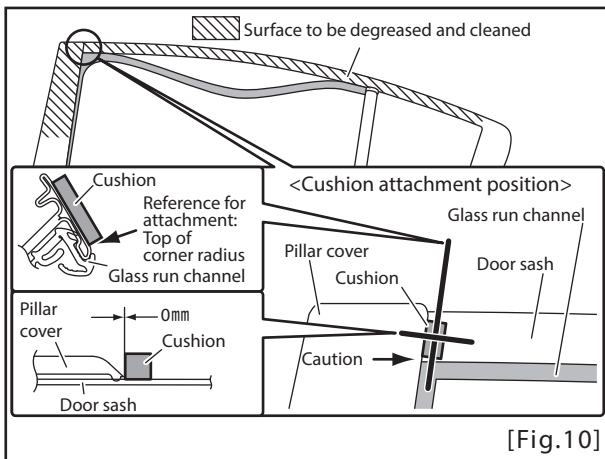

- (2) Remove stain or wax on the rear side window deflector installation portion (hatched area in Fig. 10) with detergent (or cleaning agent), and let it completely dry.

[Fig.10]

- (3) Attach a cushion to the pillar cover step portion of the rear door sash. When attaching, use the lower side as the reference, and align the cushion to the top of the sash corner radius while paying attention not to make a contact with the glass run channel. [Fig.10]

 CAUTION	<ul style="list-style-type: none"> • Attach the cushion so that no gap will be made on the pillar cover and also the upper side of the cushion will not protrude from the side window deflector.
--------------------	-----------------------------------------------------------------------------------------------------------------------------------------------------------------------------------------------------------------

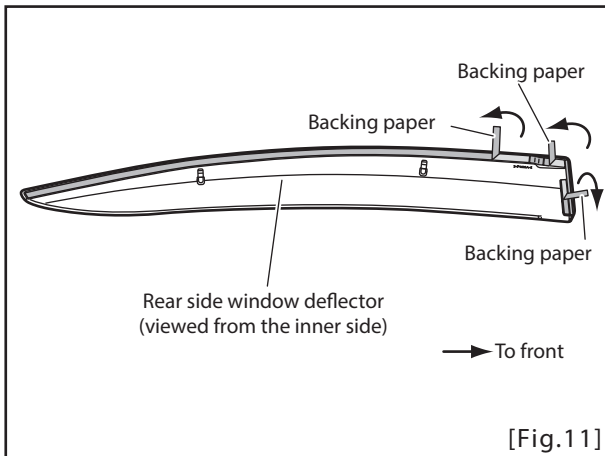

- (4) Remove each of the backing paper of the double-sided tape on the inner side of the rear side window deflector approximately 3 to 10 cm from the end, and bend it outward.

[Fig.11]

 CAUTION	<ul style="list-style-type: none"> • Be sure to remove the backing paper as shown in Fig. 11, otherwise they cannot be removed during installation.
--------------------	--------------------------------------------------------------------------------------------------------------------------------------------------------------------

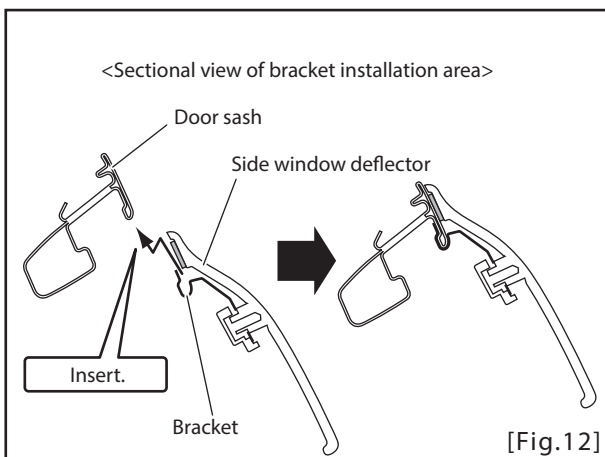

Installation

5. Installation of the rear side window deflector

- (1) Position the rear side window deflector so that its front and rear end positions will be well balanced, and then insert the tips of the brackets installed to the side window deflector in Section 1 (2) into the rear door sash.

[Fig.12][Fig.13]

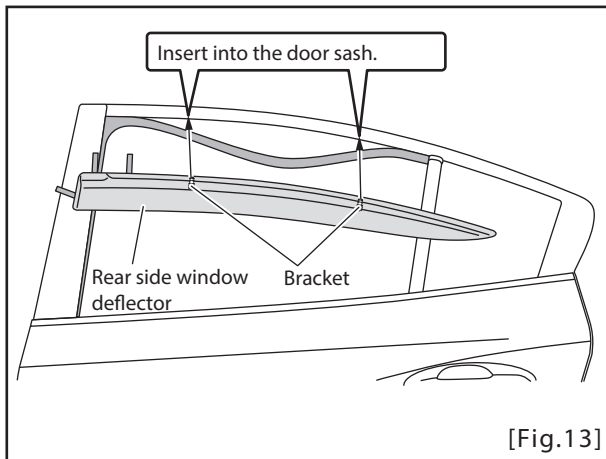

[Fig.13]

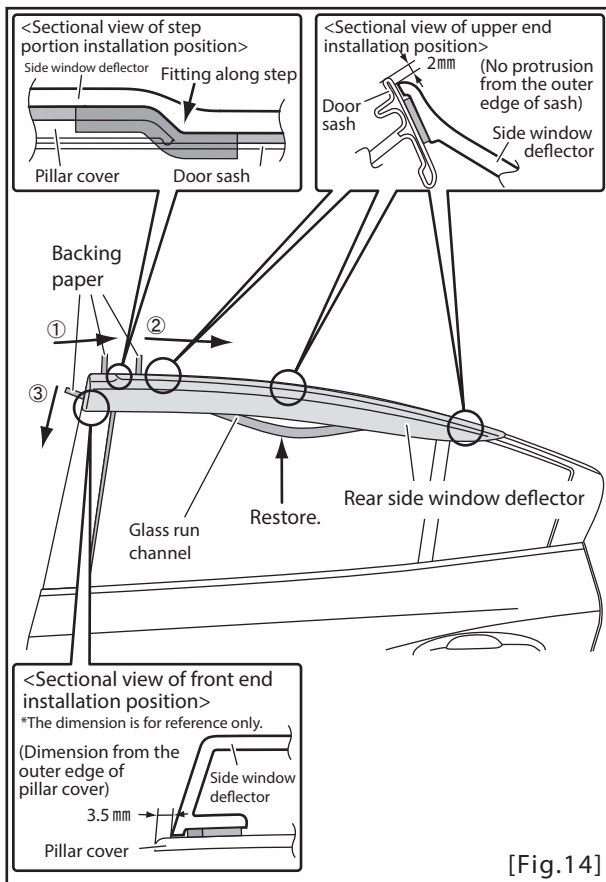

[Fig.14]

- (2) When installing the rear side window deflector in Section 5 (1), fit the front end of the side window deflector to the step of the rear door sash and pillar cover, and make adjustment so that the side window deflector will not protrude from the outer edge of the sash and pillar cover.
The installation tolerance must be within ± 0.5 mm.

[Fig.14]

 CAUTION	<ul style="list-style-type: none"> Install the side window deflector so that it will not protrude from the outer edge of the sash and pillar cover. Otherwise, it may cause interference with the vehicle or injury. Avoid making any gap at the step of the sash and pillar cover, when installing. Otherwise, rain or water may intrude inside.
-------------	---------------------------------------------------------------------------------------------------------------------------------------------------------------------------------------------------------------------------------------------------------------------------------------------------------------------------------------------------------------------------

- (3) While holding the side window deflector at the installation position, slowly remove each of the backing paper in the order of ①, ②, and ③ shown in the figure. At that time, be careful not to allow the backing paper of the double-sided tape to break at midpoint.

[Fig.14]

- (4) Apply a firm pressure with a force of 49 N or more (at least to the extent that the vehicle body is moved) evenly onto the entire double-sided tape application surface on the rear door sash and pillar cover. [Fig.14]

 CAUTION	<ul style="list-style-type: none"> To apply the double-sided tape onto the pillar cover at the front end of the rear door, firmly press the area around the corner of the side window deflector.
-------------	-----------------------------------------------------------------------------------------------------------------------------------------------------------------------------------------------------------------

- (5) Restore the glass channel.
The installation work has been completed.

[Fig.14]

- (6) Install the RH side window deflector in the same way.

Check

- Visually check the side window deflector from the above and below to make sure that the double-sided tape adhesive surfaces adhere well.
- If the side window deflector surface is dirty after the installation work, wipe it off to clean up with a waste cloth or the like.