

SUBARU

DOOR VISOR

INSTALLATION INSTRUCTION

Genuine part number : F0010SL000

Applicable model : FORESTER (2024MY~)

This manual explains about the attachment procedure of the door visor.

Attention

1. Read this manual thoroughly first in order to attach the door visor correctly.
Never attach the modified door visors.
2. ⚠ Caution marks used in this manual indicate the safety caution for the attachment. Be sure to observe these cautions.
3. Please note that we may not accept responsibilities for troubles occurred by neglecting to observe the cautions.

⚠ CAUTION

1. Before starting the attachment procedure, turn off the ignition switch and be sure to operate the parking brake.
2. For attaching this product, we are adopting the adhesion method by using double-sided tape. Before attaching the product, wipe dirt, dust, and oil with clean cloth from the attaching surface.
The oil can be wiped well by using neutral detergent, etc.
3. This product is made of resin. Be careful when handling for not forcibly bending or damaging.
4. When the ambient temperature is low (15°C or lower), warm the surface of double-sided tape to approximately 40°C with an infrared lamp or a dryer (do not use an industrial dryer).
5. The double-sided tape needs to be pressed in order to make it adhere well. Pressure-bond the visor as strongly as the vehicle shakes a little. In addition, if the visor is removed and attached again, the adhesion power significantly deteriorates. In order to avoid repetitive attachment, decide the position before the first attachment.
6. The adhesion power of the double-sided tape gradually increases after pasting. Avoid washing the vehicle for 24 hours from the attachment.
7. After checking the attachment, open and close the window glass for a few times. Check that the window opens/closes smoothly.

Revision content

△	Content	Date of creation
△ 0	New	2023.10.5

Component parts

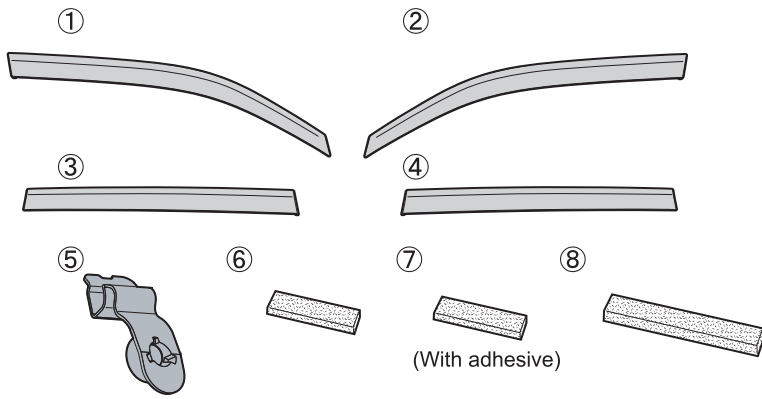

No.	Part name	Quantity
①	Front door visor RH	1
②	Front door visor LH	1
③	Rear door visor RH	1
④	Rear door visor LH	1
⑤	Bracket	8
⑥	Sealer (t3 x 5 x 30)	2
⑦	Sealer (t3 x 5 x 30) (With adhesive)	2
⑧	Sealer (t5 x 5 x 55)	4

Tools to be used

- Neutral detergent (Recommended nonaneum)
- Cloth
- Scale
- Masking tape
- Infrared lamp or dryer (when the environment temperature is 15°C or lower)

Completion drawing after the installation

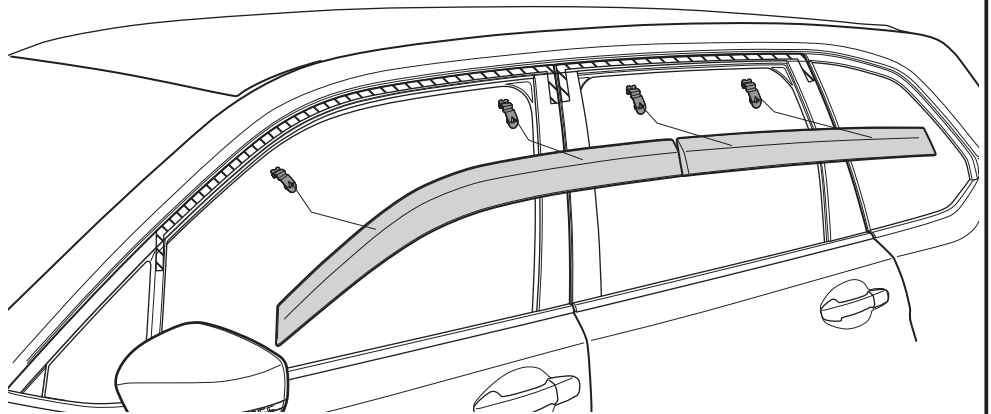

Installation procedure

⚠ Caution

- Park the vehicle at a level and sufficiently open space for the safe operations.
- Stop the engine and operate the parking brake, so the vehicle does not move during the operation.
- This procedure describes the operation for the left side.
- Conduct the same operation for the right side as well.

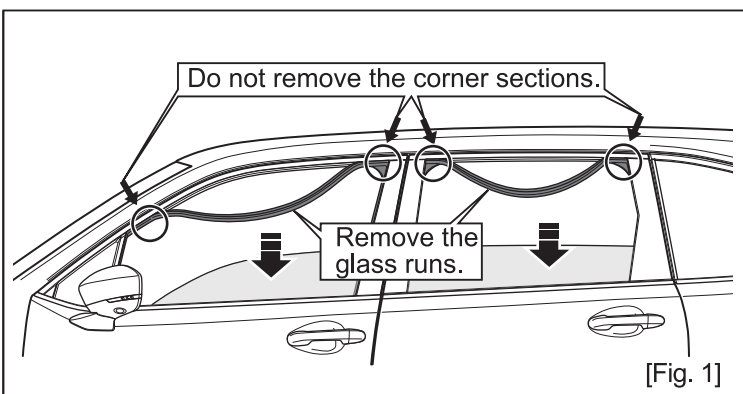

1. Preparation for installation

- (1) Open the door, open the window glass, and remove the glass run. [Fig. 1]

⚠ Caution

- Remove the glass run according to the explanation in the service manual.
- Do not remove the corner sections of the glass run. Otherwise, the recovery becomes difficult.

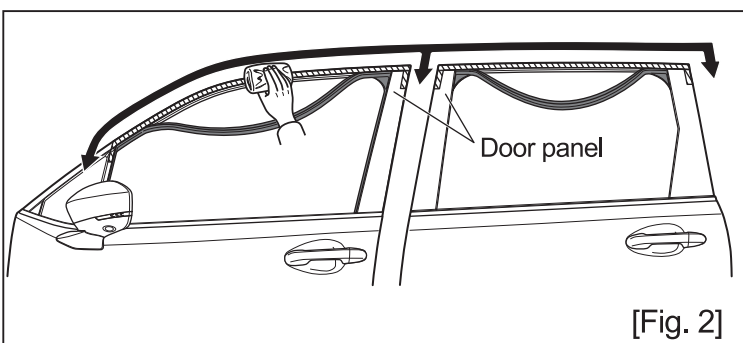

- (2) Be sure to wipe water, oil, and dirt on the door visor attachment surfaces (▨ sections on the door panel) by a cloth soaked with neutral detergent. Then, dry the wiped surfaces completely. [Fig. 2]

⚠ Caution

- Attach the main body by the double-sided tape. Make sure that the attachment surfaces are clean.

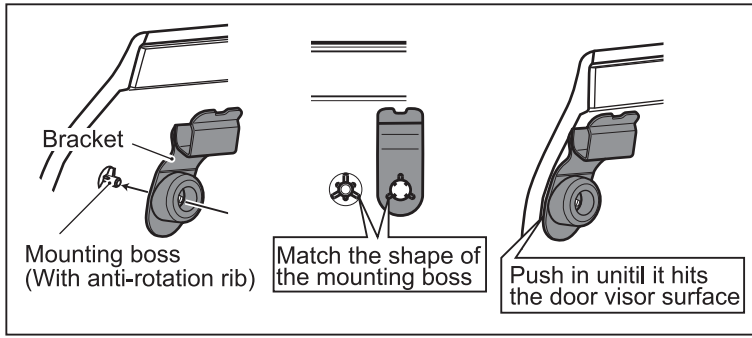

2. Installing the brackets

- (1) Insert the bracket into the mounting boss on the back of the door visor and push it in until it hits the door visor surface. [Fig.4]

⚠ Caution

- Do not turn reattach the bracket as this may cause it to come off.

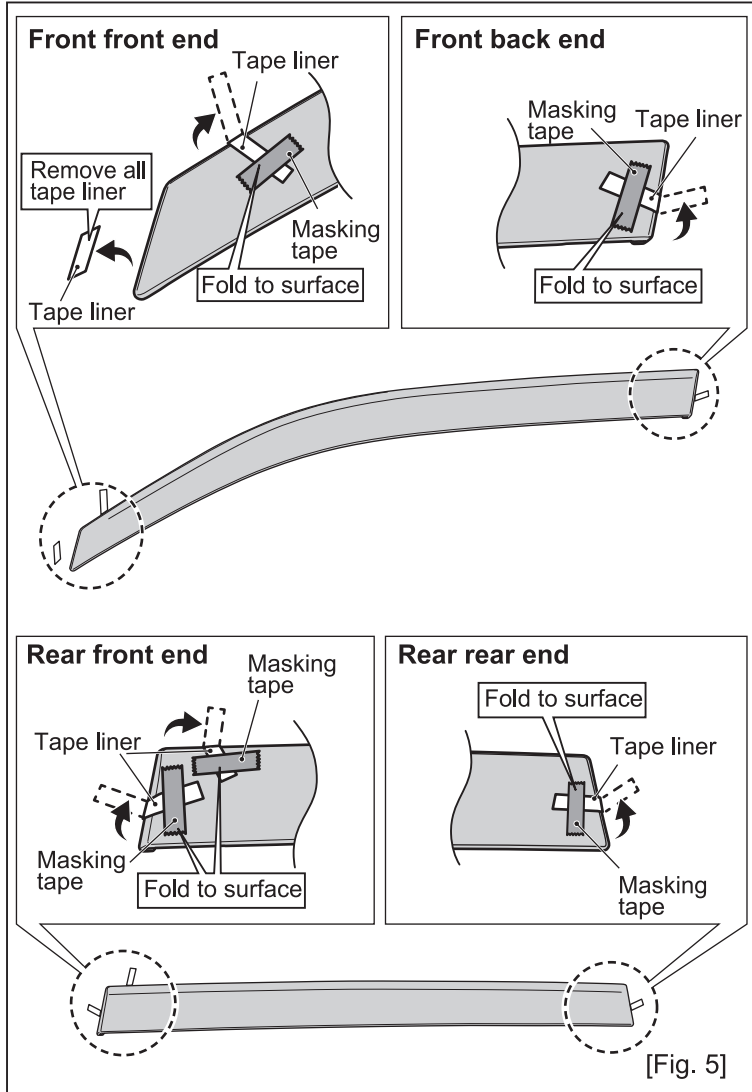
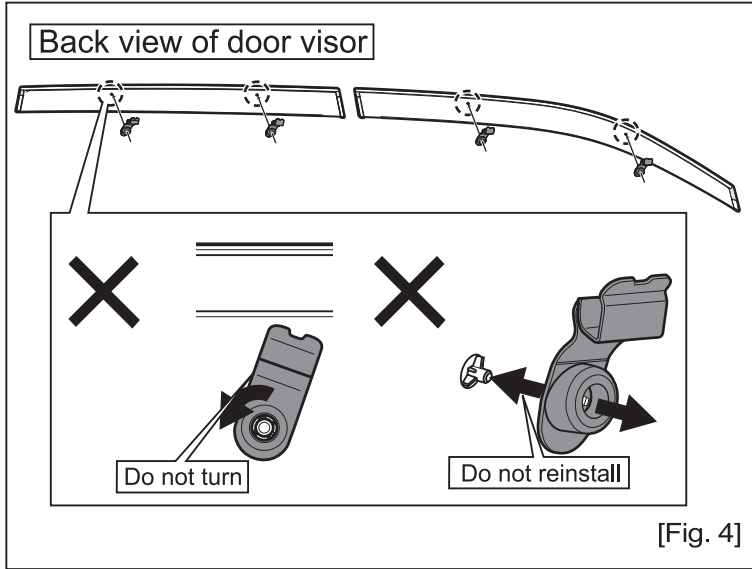

3. Preparation for door visor installation

- (1) Remove about 30mm of tape liner from the front and rear edge of the door visor from the terminal. [Fig.5]

*The removed tape liner can be attached to the surface with masking tape to facilitate further work.

4. Temporary attachment of the door visor

Front

- (1) Insert the bracket into the door molding .
[Fig. 6]
- (2) Align the front edge of the door visor (①) with the edge of the partition's rubber molding.
- (3) Align with the outer edge of the door visor (②) 1.7 mm inside from the outer edge of the door molding and temporarily adhere.

⚠ Caution

- Repeated temporary installation will significantly reduce the adhesive strength double-sided tape.
- Be careful not to turn the bracket when inserting it into the door molding.
- Make sure that the door visor does not extend beyond the outer edge of the door molding. If the product is installed overhung, it may interfere with the vehicle or cause injury.

Glue the bracket in place with the bracket securely inserted all the way to the back of the door molding.
If not securely plugged in, it may cause water to enter.

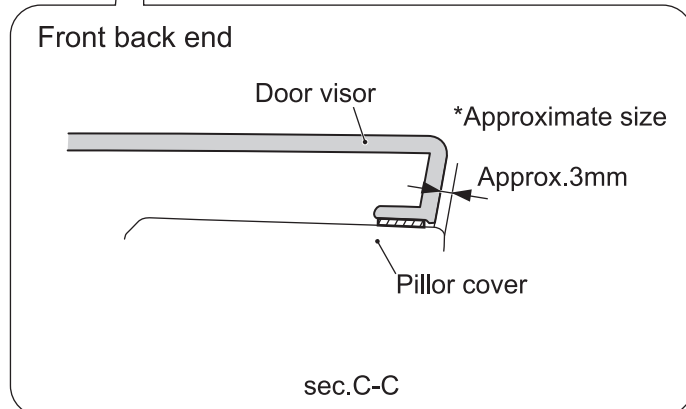
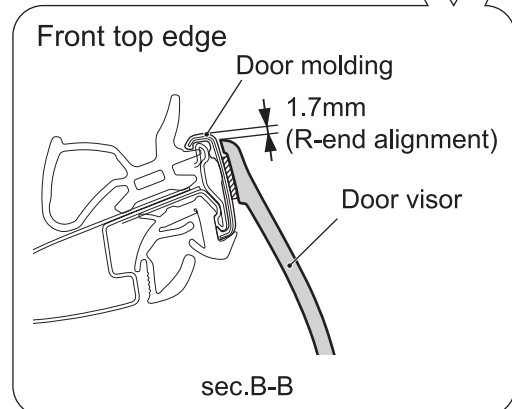
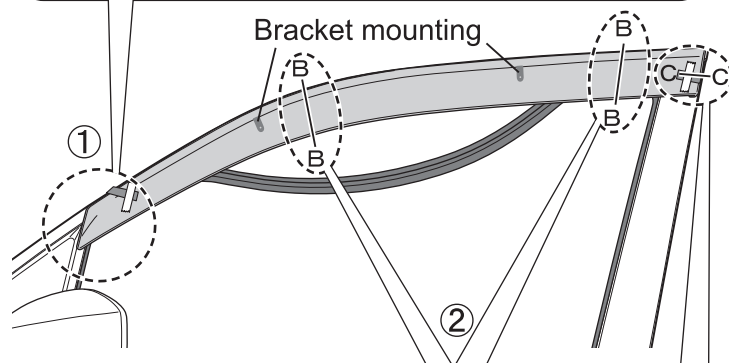
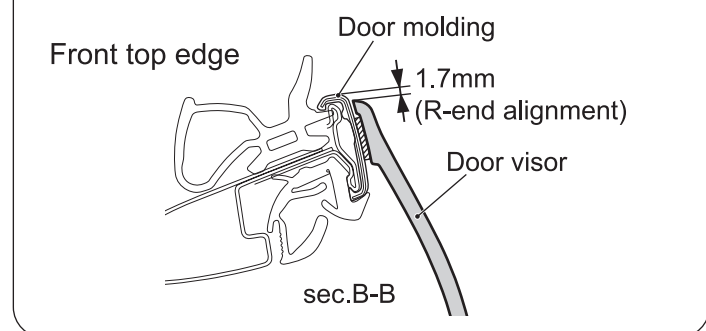
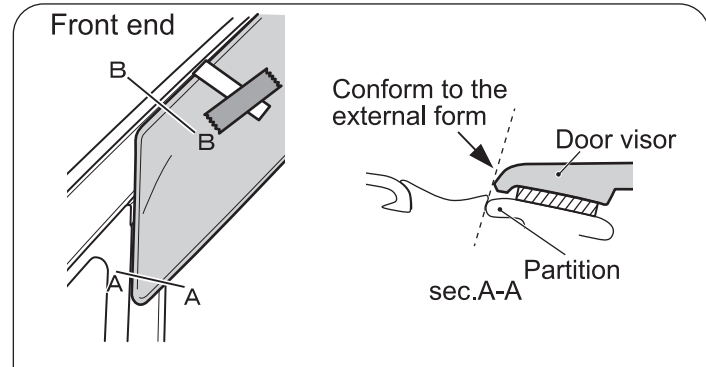
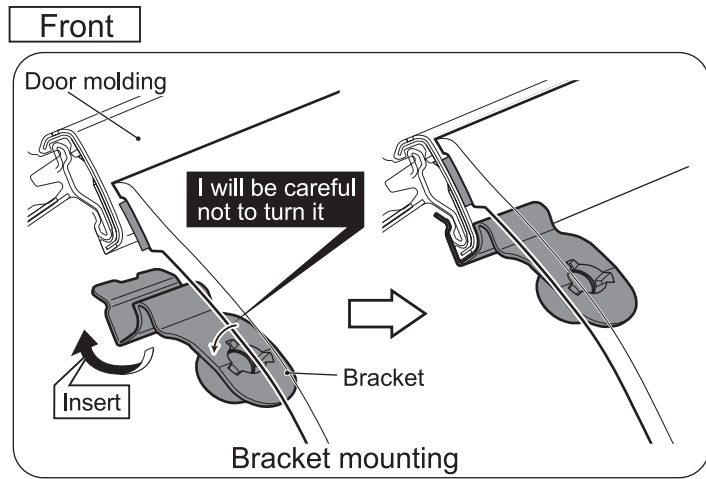

[Fig. 4]

Rear

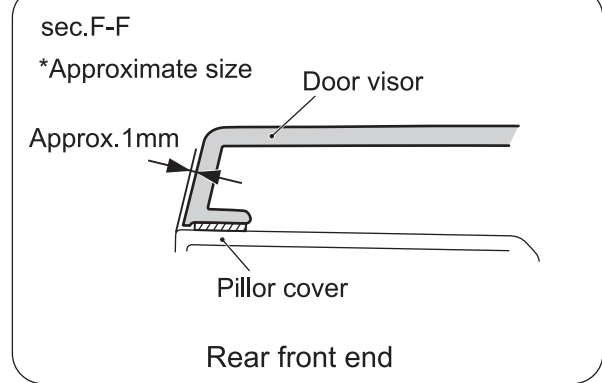
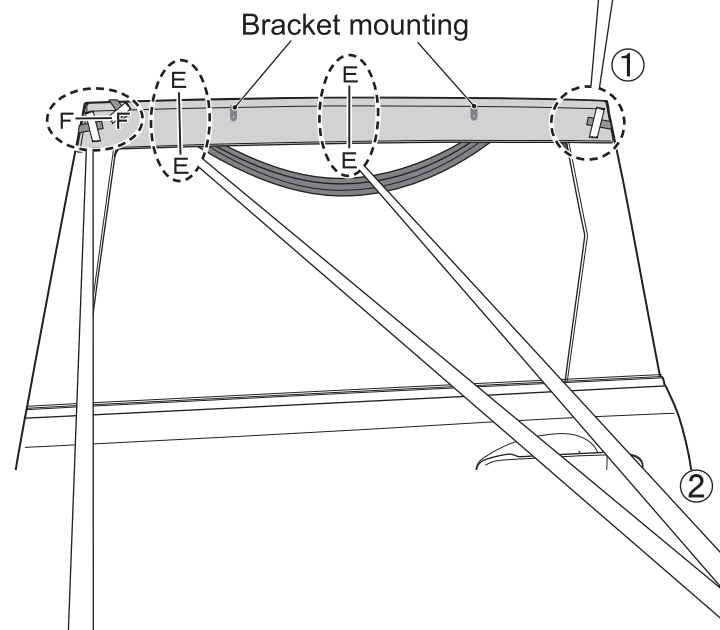
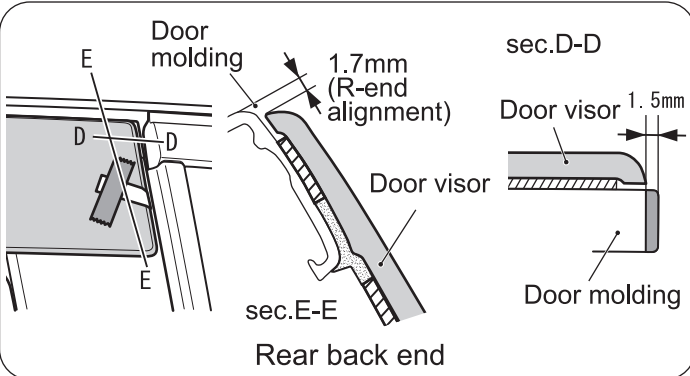
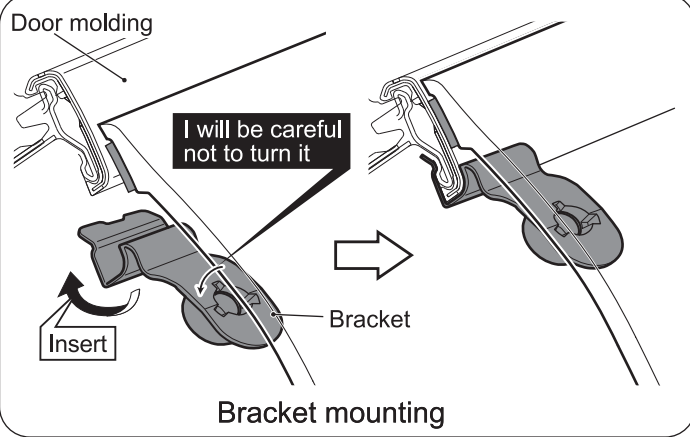

Rear

- (1) Insert the bracket into the door molding . [Fig. 5]
- (2) Align the back edge (①) 1.5mm inward from the rear end of the door molding. [Fig. 5]
- (3) Align the top edge (②) with the outer edge of the door molding (1.7mm inside from the terminal) and temporarily adhere. [Fig. 5]

⚠ Caution

- Repeated temporary installation will significantly reduce the adhesive strength double-sided tape.
- Be careful not to turn the bracket when inserting it into the door molding.
- Make sure that the door visor does not extend beyond the outer edge of the door molding. If the product is installed overhung, it may interfere with the vehicle or cause injury.

Glue the bracket in place with the bracket

- securely inserted all the way to the back of the door molding. If not securely plugged in, it may cause water to enter.

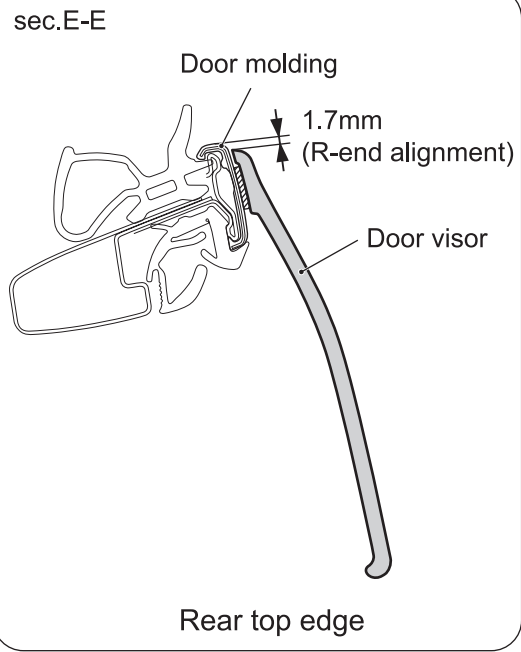

[Fig. 5]

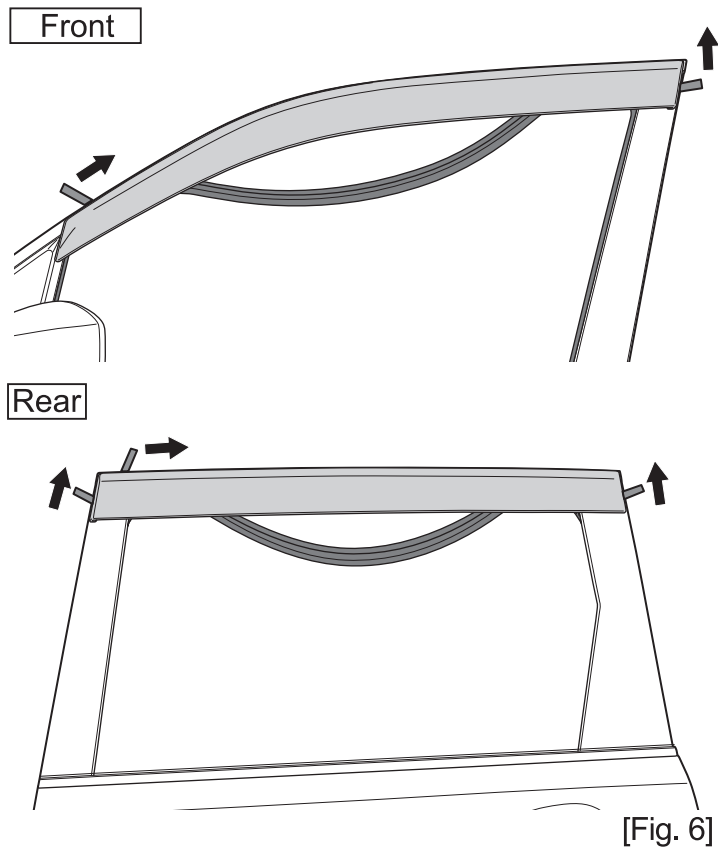

5. Adhesion of door visor

- (1) Remove all masking tapes which were temporarily pasted. [Fig. 6]
- (2) After checking that the positioning is securely conducted, remove the release paper of the double-sided tape to the arrow ← direction without twisting, and adhere the door visor to the door panel. [Fig. 6]

⚠ Caution

- If it is attached without being properly aligned, it may cause interference with the vehicle, injury, peeling, water intrusion, and abnormal sound.
- Always hold the root of the releasing paper and remove slowly.
- Please note that twisting the releasing paper may cause the paper to tear.
- When a clearance is made between the release paper and the vehicle, it becomes easier to remove the release paper.

[Fig. 6]

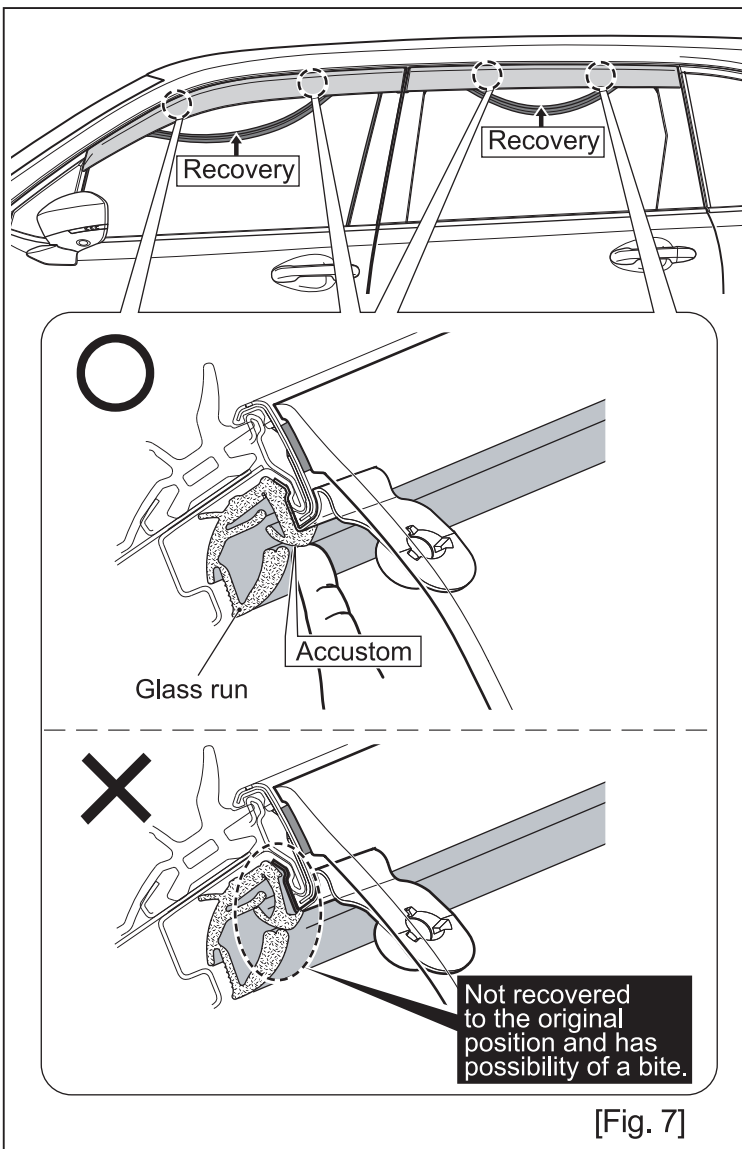

6. Recovery of glass run

- (1) Attach the glass run and accustom to the door panel and the bracket. [Fig. 7]

⚠ Caution

- When recovering the glass run, the bracket sections are especially difficult to be recovered. Use fingers to accustom the glass run.
If not fitted correctly, the glass run may get damaged due to up/down movement of the window glass.

[Fig. 7]

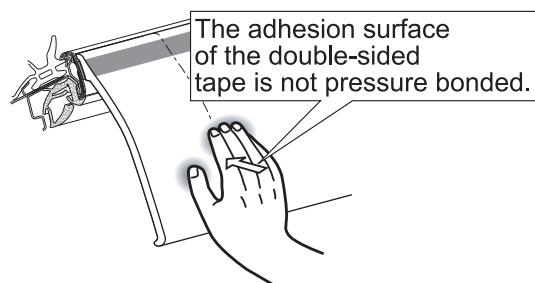
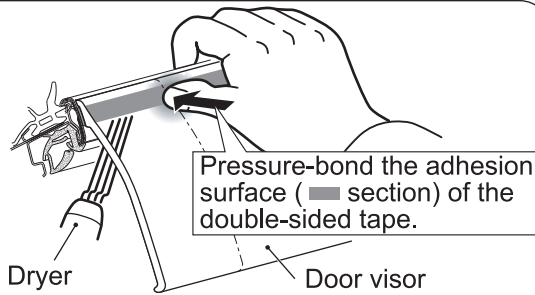

Pressure-bond the entire circumference of the door visor.

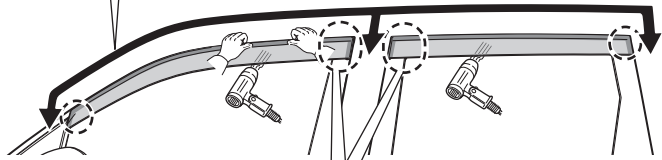

Door visor

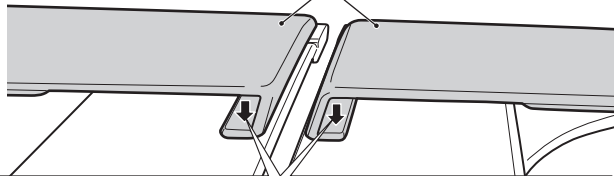

Hold the rear side directly when pressure-bonding.

[Fig. 8]

7. Pressure-bonding of door visor

- (1) Press bond the adhesion surface of the double-sided tape in the arrow ← direction evenly with a force of 49N or more (at least the force which shakes the vehicle). [Fig. 8]

⚠ Caution

- Securely pressure-bond the adhesion surface of the double-sided tape, especially the ends (∩) section). In addition, when pressure bonding the double-sided tape to the pillar, directly hold the rear side of the double-sided tape adhering surface of the door visor. If there is any floated section due to insufficient pressure-bonding, it may cause injury, peeling, water intrusion, and abnormal sound.
- If the ambient temperature is 15°C or lower, warm up the door panel at which the door visor is adhered to and the double-sided tape of the door visor to a body temperature (approx. 40°C) by using a dryer, etc.
- Be very careful with a burn.

8. Check after attaching of the door visor

- (1) Look at the door visor from above and from underneath to check the adhesion section (■ section) of the double-sided tape is tightly adhered to the entire attachment surface. [Fig. 9]
- (2) Lightly pull the door visor to check that the door visor is securely adhered. [Fig. 9]
- (3) Check that the door visor is properly attached. If any part is dirty, clean with a cloth, etc.

⚠ Caution

- Make sure that the attached visors can be protected from getting wet by rain or water for 24 hours from the attachment. Peeling of the double-sided tapes may occur.

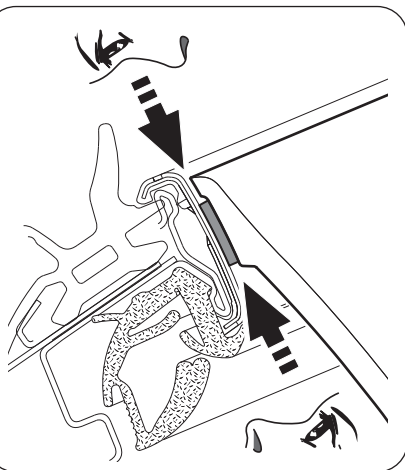

Check whether the adhesion area (■ section) is tightly adhered.

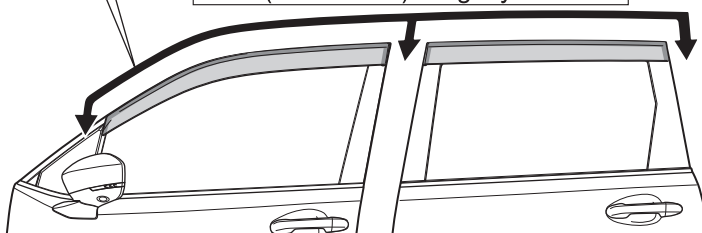

[Fig. 9]

9. Applying sealer to the door frame

(1) Using Fig.10 as a guide, flip up the weatherstripping and insert the sealer into the three door frame locations.

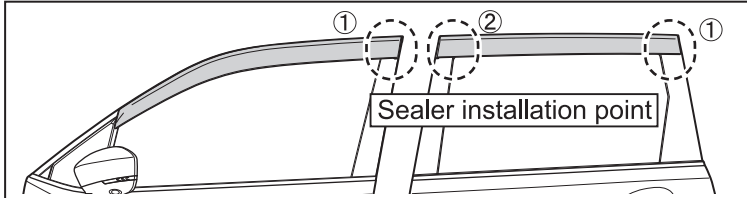

Sealer installation point

Sealer installation procedure

Front / Rear back end

Finger presses down on the clip section.

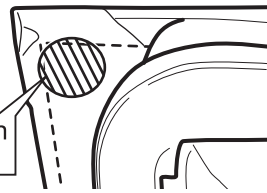

Sealer⑧



Sealer installation start position

Sealer insertion point

Sealer installation end position
(Put everything in)

Hold firmly with the thumb

Flip up the weatherstrip

After applying the sealer

Front / Rear back end

Sealer⑧

Put everything in

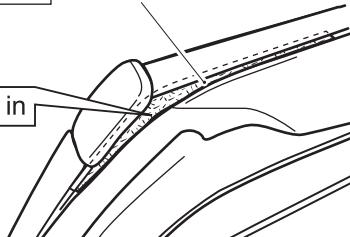

Rear front end

Finger presses down on the clip section.

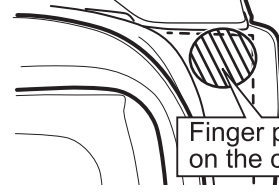

Sealer⑥ insertion point

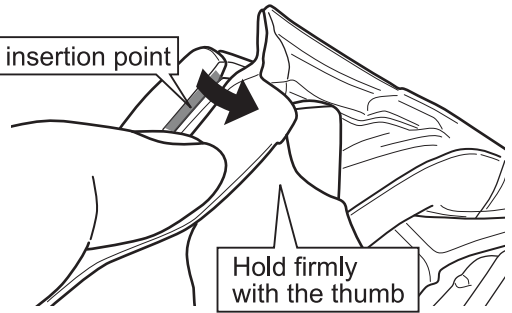

Hold firmly with the thumb

Sealer⑦ application point

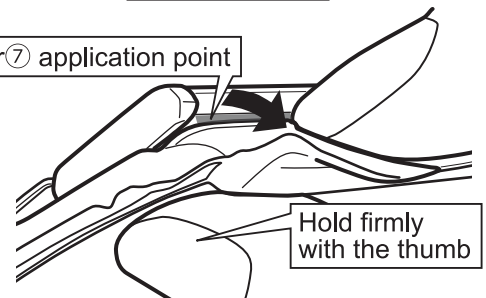

Hold firmly with the thumb

After applying the sealer

Rear front end

Sealer(With adhesive)⑦

Sealer⑥

Put in

Sealer 6 is applied over sealer 7

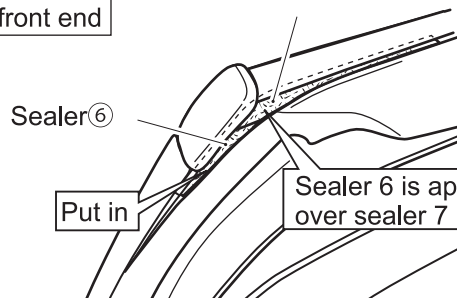

[Fig. 10]

Advice

- When turning the weatherstrip do not remove the clips at the door corners.
- Always hold the corners of the door frame with your thumbs.

⚠ 注意

- When turning up the weather strip, be careful not to cut at the edge of the door frame.
- If the weather strip is turned up too far, the corner of the base may interfere with the weather strip and cause it to break through.
- If the weatherstrip edge rubber is pulled excessively, it may break. If the rubber at the end of the weatherstrip is pulled excessively, it may break off.
- Insert the sealer, apply it, and make sure there are no gaps.
- Make sure that the sealer does not stick out from the weather strip.

(2) The operation completes.