



STI SHIFT KNOB - AT

TOOLS REQUIRED:

None

PARTS IDENTIFICATION:

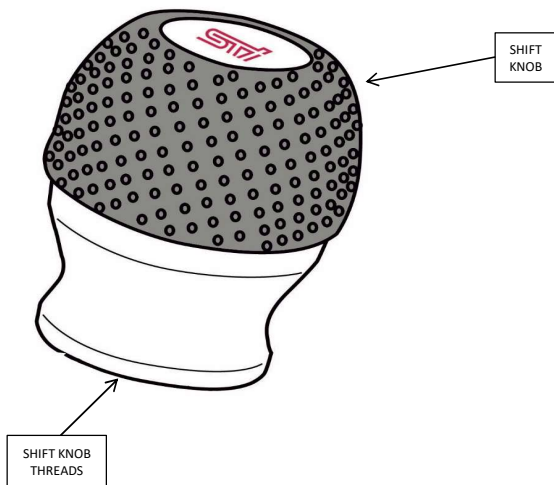



STEP 1: Park vehicle on level surface. Apply parking brake. Make sure vehicle is in "P" and ignition is off.

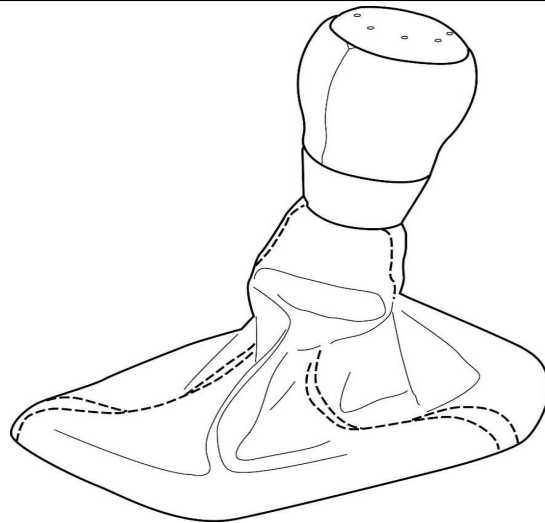

STEP 2: Use both hands and firmly grip the top of the shift boot and pull downward.

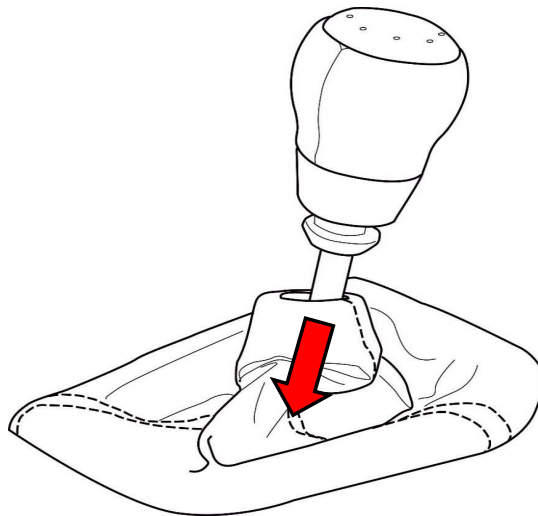

STEP 3: Unscrew the factory shift knob by turning counter-clockwise.

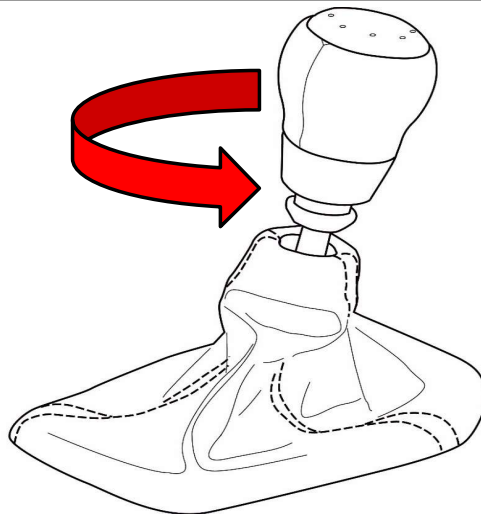

STEP 4: Removed factory shift knob.

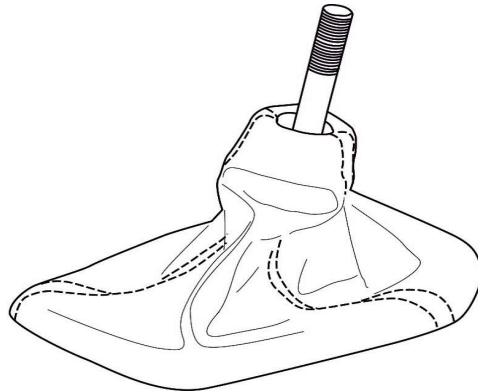

STEP 5: Gently position STI Shift Knob on shift lever. Ensure knob is straight and level. **Note:** Do not tighten if the knob is crooked, doing so may damage the threads or cause them to crossthread.

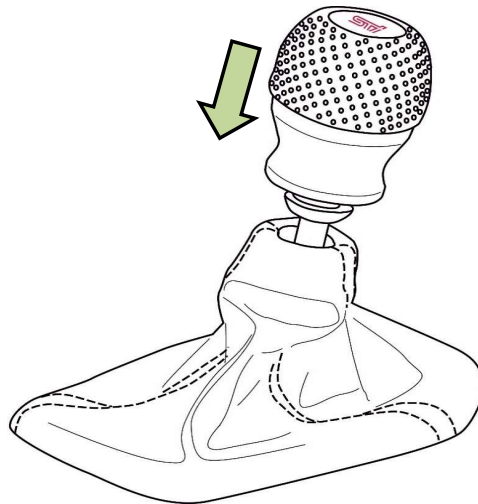

STEP 6: Turn STI Shift Knob clockwise until tight. Do not overtighten. If needed, turn the knob slightly counter-clockwise until the STI logo is in the correct orientation.

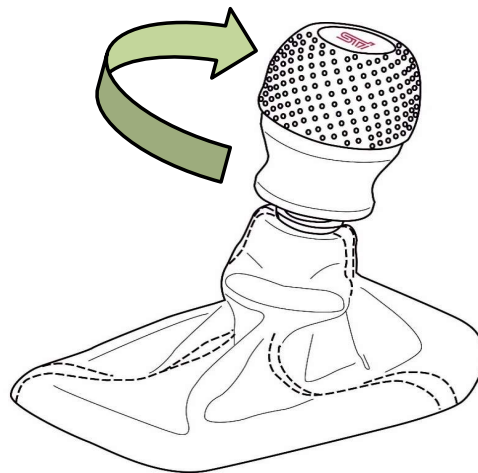



STEP 7: Use both hands to lift shift boot up evenly to mate with the knob.

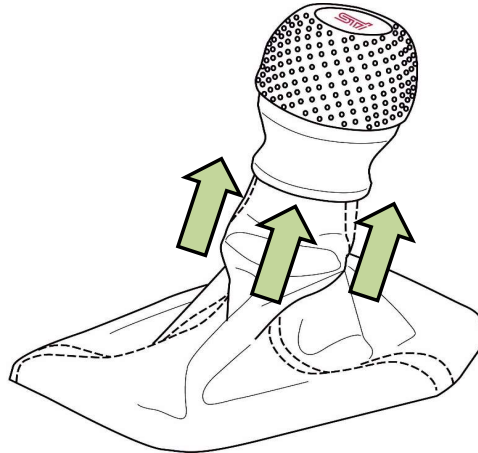

STEP 8: Turn on vehicle and with your foot on the brakes, check the operation of the shift lever by moving it into different positions.

Installation Complete